

ComforTek Seating Summit 661 Key Features



SUPERIOR CHASSIS

Mandrel Bends
18 ga. Steel
1" Steel – Legs
3/4" Steel – Back



METAL ON METAL

StaFast "T-nuts" are used to attach the seat / back to the frame, providing superior holding power.



PLYWOOD SEAT & BACK

Superior plywood is used on all chairs. The seat features a 5/8" thick and the back is 1/2" for extra support.



3" DUAL-DENSITY FOAM

Two different density foams are combined to create a comfortable seat.



ROLLED SEAT CUSHION

We take comfort very seriously. Our rolled seat cushion provides comfort to guest for long periods of time.



GANGING

Chairs have the ability to connect to each other with this standard feature.

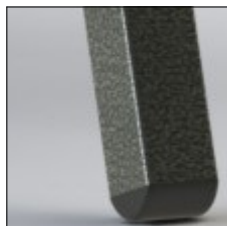

NYLON GLIDES

Non-Marring glides designed for delicate floors such as tile.



SUPERIOR COMFORT

The radius back has 1 1/2" of foam and lumbar support, for long term comfort.

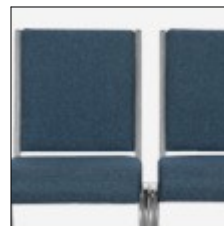

PERSONAL SPACE

When connected, the 2" gap between each chair gives users their own "individual seat" or "personal space".



STACKING

The 661 Multi-Purpose chair has the ability to stack up to 6-8 high.

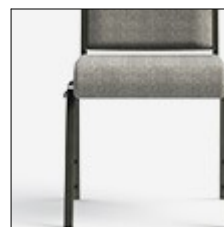

DIMENSIONS

Width: 18.5"
Seat Width: 16.5"
Depth: 24"
Height: 33 1/2"
Weight: 17 lbs.
C.O.M.: 1.1 yards



CHAIR TESTING

CAL 117 – Passes
ANSI / BIFMA Approved
CAL 133 (Optional)



FABRIC SELECTION

ComforTek stocks some of today's top colors, patterns, and finishes.

Visit www.ctsfabrics.com to view all fabrics.



UNMATCHED WARRANTY

Lifetime warranty on frame
5 years on standard foam
5 years on fabric