

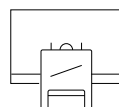

## Formulários



Salas de aula



Cuidados de saúde

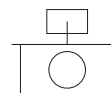

Escritórios



Grandes superfícies



Início



Hotéis









Restaurantes

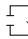

Retalho

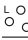

## Especificações (Luminárias da série)

	<b>Tensão (V)</b>	220-240V
Hz	<b>Frequência (Hz)</b>	50/60Hz
	<b>Intensidade (A)</b>	500mA
$\phi$	<b>Fator de Potência (Cos fi)</b>	>0,9
	<b>Regulação</b>	Não
	<b>Índice de estanqueidade IP</b>	IP20
	<b>IK Proteção contra impactos</b>	IK02
	<b>Material Difusor</b>	PC
	<b>Corpo</b>	AL
K	<b>Temperatura de cor</b>	3000K-4000K
	<b>CRI Índice de repr. cromática</b>	>80

	<b>Dimensão</b>	1.205x57x76mm
	<b>Peso</b>	0.00212Kg
	<b>Posição de montagem</b>	Parede Superficial, Suspensão
	<b>Temperatura de trabalho</b>	-20°C ~ +45°C
$\phi_{LUM}$	<b>Fluxo (lm)</b>	3 350lm
	<b>Isolamento elétrico</b>	CI
	<b>Vida</b>	L70>50000h

Prilux garante uma tolerância de  $\pm 10\%$  nas medições de fluxo de luz.

## Dimensões

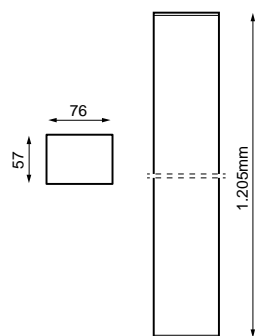

## Referências

	W		$\phi_{LUM}$	$\Delta$	K		
628013	32W	500mA	3350lm	100°	3000K 4000K	1.205x57x76mm	>80

## A pedido



Kit de emergência 3h (mod. 1x/2x  
1.200mm/1.500mm)



Dali

## Acessórios



**662895**

ACCESORIO DE  
SUSPENSION LYNX  
PRO



**662901**

ACC. DE  
SUSPENSION CON  
ALIMENTACION LYNX



**700269**

ACCESORIO  
CONEXION LINEAL  
ADOSADO LYNX PRO



**700276**

ACCESORIO  
CONEXION LINEAL  
SUSPENSION LYNX

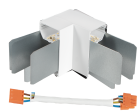
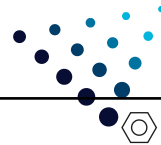

---

**700283**

---

ACCESORIO  
CONEXION L LYNX  
PRO OPAL R9016



---

**700306**

---

ACCESORIO  
CONEXION X LYNX  
PRO OPAL+PRISM



---

**700320**

---

ACCESORIO  
CONEXION T LYNX  
PRO OPAL+PRISM



---

**700344**

---

ACCESORIO  
ANCLAJE A PARED  
LYNX PRO R9016