

CITY OF NORWOOD

4645 Montgomery Road, Norwood, Ohio 45212

Phone 513-458-4510 Fax 513-458-4511

Permit No. _____

BUILDING/ZONING PERMIT APPLICATION

Associated BP # _____

1. STREET ADDRESS & SUITE #: _____ (Name of Business)

2. ZONING: _____ OCCUPANCY: _____ PARCEL NUMBER: _____

3. Residential Property (RCO) Commercial Property (OBC)

	NAME	STREET ADDRESS	CITY	STATE	ZIP	PHONE/FAX
OWNER						
CONTRACTOR						
PLANS BY						

4. TYPE OF IMPROVEMENT

- New Building
- Alteration
- Addition
- Repair/Replacement
- Change of Use
- Change of Occupancy
- Fire Alarm
- Fire Suppression
- Garage
- Hood System
- HVAC # of Units: _____
 _____ Furnace _____ Air Conditioner
 _____ Commercial _____ Residential
 _____ Replacement _____ New
 _____ Electric _____ Gas _____ Oil
 _____ New System; drawings & specs required
- Deck
- Pool (Above-Ground)
- Pool (In-Ground)
- Fence
- Shed
- Sign ID: _____ SQ FT: _____
- Wrecking/Moving
- Other (specify) _____

5. DESCRIPTION OF WORK: _____

6. COST: Estimate cost of construction/improvement for which this application is being made: \$ _____

7. USE OF THIS BUILDING AND PREMISES:

Existing Use: _____ Proposed Use: _____

8. TOTAL FLOOR AREA FOR NEW BUILDINGS/GARAGES/SHEDS/ADDITIONS/DECKS: _____

The owner of this building and undersigned, do hereby covenant and agree with all the laws of the State of Ohio and the ordinances of the City of Norwood pertaining to building(s), and to construct the proposed building(s) or structure(s) or make the proposed change or alteration in accordance with the plans and specifications submitted herewith, and certify that the information and statements given on this application, drawing and specifications to the best of their knowledge, true and correct.

Application by _____ Date: _____
Owner or Agent's Name (Print & Sign) (phone number)

DO NOT WRITE BELOW THIS LINE (Office Use Only)

Required Review/upfront Fee \$ _____
 Permit or Zoning Fee \$ _____
 Fine \$ _____
 OBC 3% (Commercial) \$ _____
 RCO 1% (Residential) \$ _____
 Total \$ _____
 Balance Due \$ _____

Payment: Cash Check Credit Card Receipt # _____

Plans Examiner Approval: _____ Date Plans Approved: _____

Construction Type: _____ Use Group: _____

Building/Zoning Official Approval _____ Date Permit Issued: _____

CITY OF NORWOOD
BUILDING DEPARTMENT
4645 MONTGOMERY ROAD, NORWOOD OHIO 45212
(513) 458-4510 FAX (513) 458-4511

HEATING AND COOLING DATA SHEET
TO BE SUBMITTED ALONG WITH HVAC APPLICATION
(Please fill out as applies)

① DESCRIPTION OF EXISTING CONDITIONS:

- A. Type of heating system: Forced Air Gravity Steam Water Other
B. Fuel type: Natural Gas Electric Propane Other
C. Existing Venting: Interior Chimney Exterior Chimney "B" Vent Direct Vent Other
D. Does the existing heating system contain hazardous material? YES NO
E. Is the existing furnace located in habitable areas? YES NO

② DESCRIPTION OF PROPOSED WORK:

- A. Location of new heating system:
B. Type of heating system: Forced Air Gravity Steam Water Other
C. BTU input rating: _____ BTU output rating: _____ Efficiency Rating: _____
D. Fuel type: Natural Gas Electric Propane Other _____
E. Chimney & Venting System: _____
F. Location of new air-conditioning system: **SITE PLAN REQUIRED:** _____
G. SEER Rating: _____ COP Rating: _____
H. Are any existing gas lines to be extended or replaced? YES NO

③ CONDITIONS OF THE PERMIT:

- A. All flue gases are to be vented in accordance with the manufacturer's instructions.
B. The location of exhaust vents from windows and air intakes must be in accordance with the manufacturer's instruction and/or the Residential Code of Ohio.
C. The manufacturer's installation instructions and operation instructions are to be permanently attached to the units
D. All furnaces are to be supplied by dedicated circuit, **PERMIT BY IBI REQUIRED.**

NOTE; The new **2013 Residential Code of Ohio; Chapter 3 Building and Planning** requires that carbon monoxide alarms be installed per:

SECTION 315

CARBON MONOXIDE ALARMS

315.1 Carbon monoxide alarms. For new construction, an approved carbon monoxide alarm shall be installed outside of each separate sleeping area in the immediate vicinity of the bedrooms in dwelling units within which fuel-fired appliances are installed and in dwelling units that have attached garages

315.2 Where required. Where work requiring a permit occurs in existing dwellings that have attached garages or in existing dwellings within which fuel fired appliances exist, carbon monoxide alarms shall be provided in accordance with Section 315.1.

315.3 Alarm requirements. Single station carbon monoxide alarms shall be listed as complying with UL 2034 and shall be installed in accordance with this code and the manufacturer's installation instructions.

NORWOOD BUILDING DEPARTMENT
PLOT/SITE PLAN

ADDRESS _____

PERMIT # _____

LOT WIDTH _____ DEPTH _____

- A. Show set back dimension
- B. Show distance from property line and adjacent buildings
- C. Show dimensions of and setbacks for *existing* and *proposed* structures, additions, driveways, sheds and fences

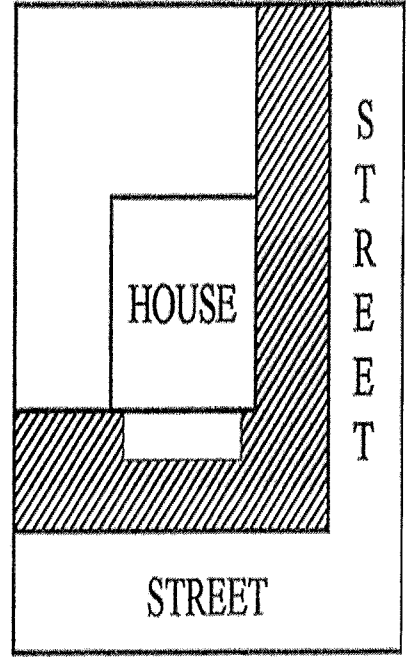
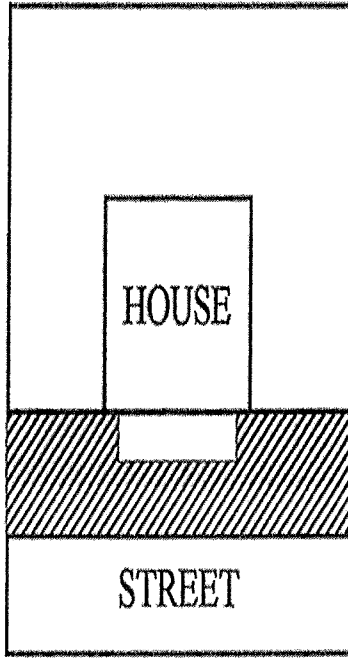
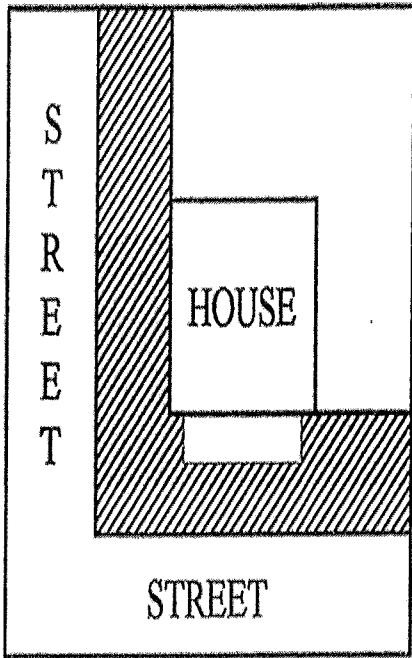

Address

Name

Signature

Date