



MY TOWN HOUSE BLOCK

Size: 5½" x 7"

Making Camp
a Cozier Place!



Fabric needed for a block:

- 2 print charm squares (1 for the house and 1 for the roof/door)
- **Background fabric**
 - One - 4" square (cut in half on the diagonal)
 - Two - 1" x 4½" rectangles

Cutting:

- For the **"house"** fabric, you will need:
 - One - 2½" x 4½" rectangles
 - Two - 2" x 2½" rectangles
- For the **"roof/door"** fabric, you will need:
 - One - 5" square cut in half on the diagonal
 - One - 1½" x 2½" rectangle.
- If cutting from a charm square, you will cut the rectangle from one the triangles created when cutting on the diagonal.

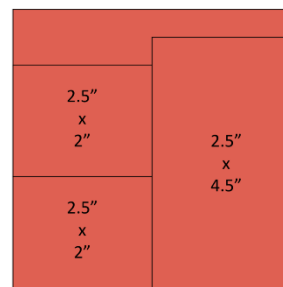

House Cutting Diagram

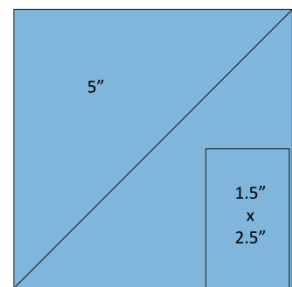

Roof and Door Cutting Diagram

NOTE: You will notice in my blocks that I mixed up the doors and roofs in each block to make them even more scrappy

House Assembly:

- To make the roof, select your roof triangle and the 4" background triangles.
- Sew a 4" background triangle to the roof triangle as shown below, press and trim. Add a 4" background triangle to the same roof triangle and press.

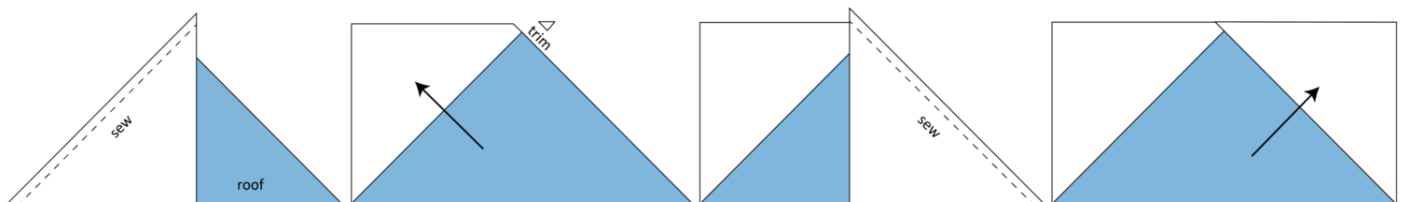

- Trim your roof section to measure 3" x 5½" as shown below in the trimming diagram.

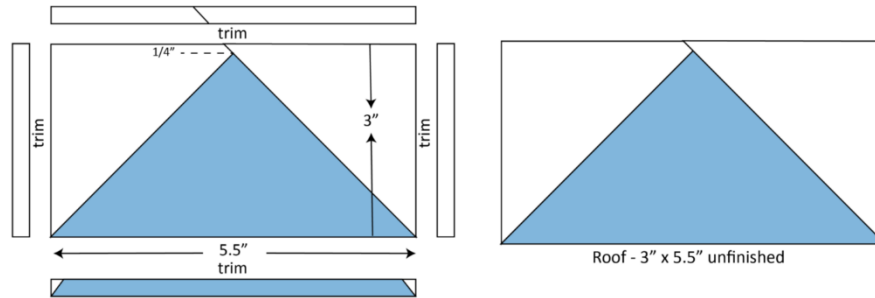

- Then select the following:
 - One - 2½" x 4½" house rectangle
 - Two - 2" x 2½" house rectangles
 - One - 1½" x 2½" door
 - Two - 1" x 4½" background rectangles
- Sew the small house rectangles to each side of the door.
- Sew the large house rectangle to the top of the prior pieced section.
- Sew the background rectangles to each side of the pieced house section.
- Sew the roof to the top of the house.
- Your completed My Town House Block should measure 5½" x 7".

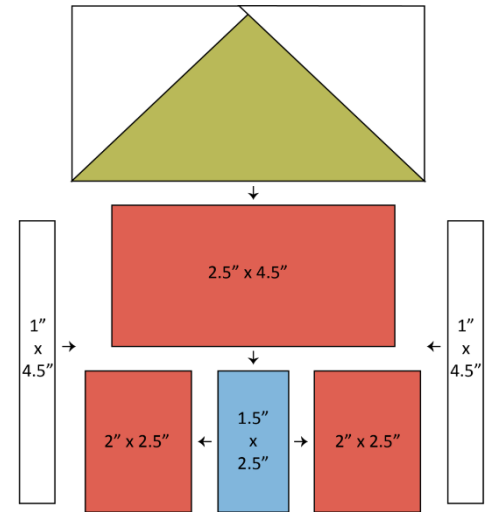

This pattern is from: [Material Girl Quilts](#)

Please feel free to use these tutorials and free patterns to make and sell similar items (in small quantities). **Thank you!**

Phone: Kyle H = 419-989-0672
 E-Mail: snuggledinhopequilts@outlook.com
 Website: snuggledinhopequilts.com
 Facebook: Snuggled In Hope Quilts



P.O. BOX 541
 Marion, Ohio 43301