

Next Generation

Ball-Plex™ Duplex Strainers



Mueller Steam Specialty™

A **WATTS** Brand

Next Generation

Ball-Plex™ Duplex Strainers

The series 792MF and 794MF incorporate all the best design elements of the previous versions and add several features:

- 3-piece design with central body and two separate symmetrical basket housings
- Repair and maintenance can be done from either side of the piping by removing either housing
- Offers more flexibility in piping design and layout
- All repairable parts are easily accessible after removing either basket housing
- Support legs and/or bosses for custom legs incorporated into standard design

Target use: Applications where service intervals are shorter than more benign services. Available from 2" to 6" in carbon steel and stainless steel with 150# and 300# flanged ends.

High Temperature option available

- Live-loaded PEEK seats for temperatures above 400°F (204°C)
- High-temperature graphite packing for positive stem seal at high temperatures (Garlock™ EVSP Simplified Set)

Standard Features

- 3-way 316SS balls and PTFE seats for long life and positive, safe shutoff
- Gear operator is standard on sizes 4" to 6", 180-degree handle operator for smaller sizes
- Access to the chamber that needs servicing is safe and easy
- Support legs can be made to any specified length
- Quick-open knobs and swing-away chamber covers facilitate cleaning

High-capacity design

Models 792MFHC, 794MFHC

- Extra large basket housings hold oversized baskets for 2 – 3 times straining capacity (depending on unit size)
- Standard oversized fabricated baskets available
- Custom sizes available as specified—we can build to virtually any application requirement

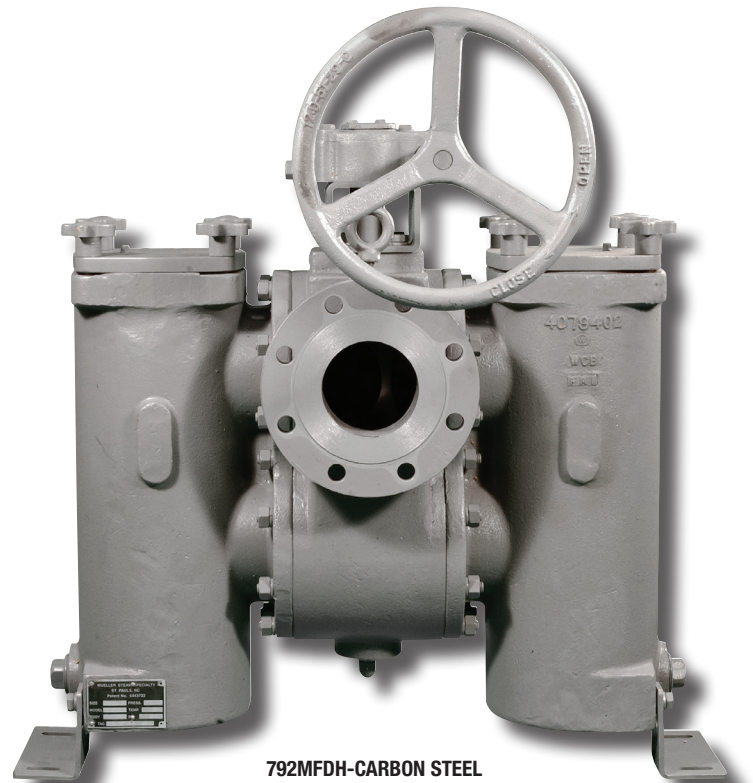

792MFDH-CARBON STEEL



792MFHH-STAINLESS STEEL

Exploded View

Model 792MFDH

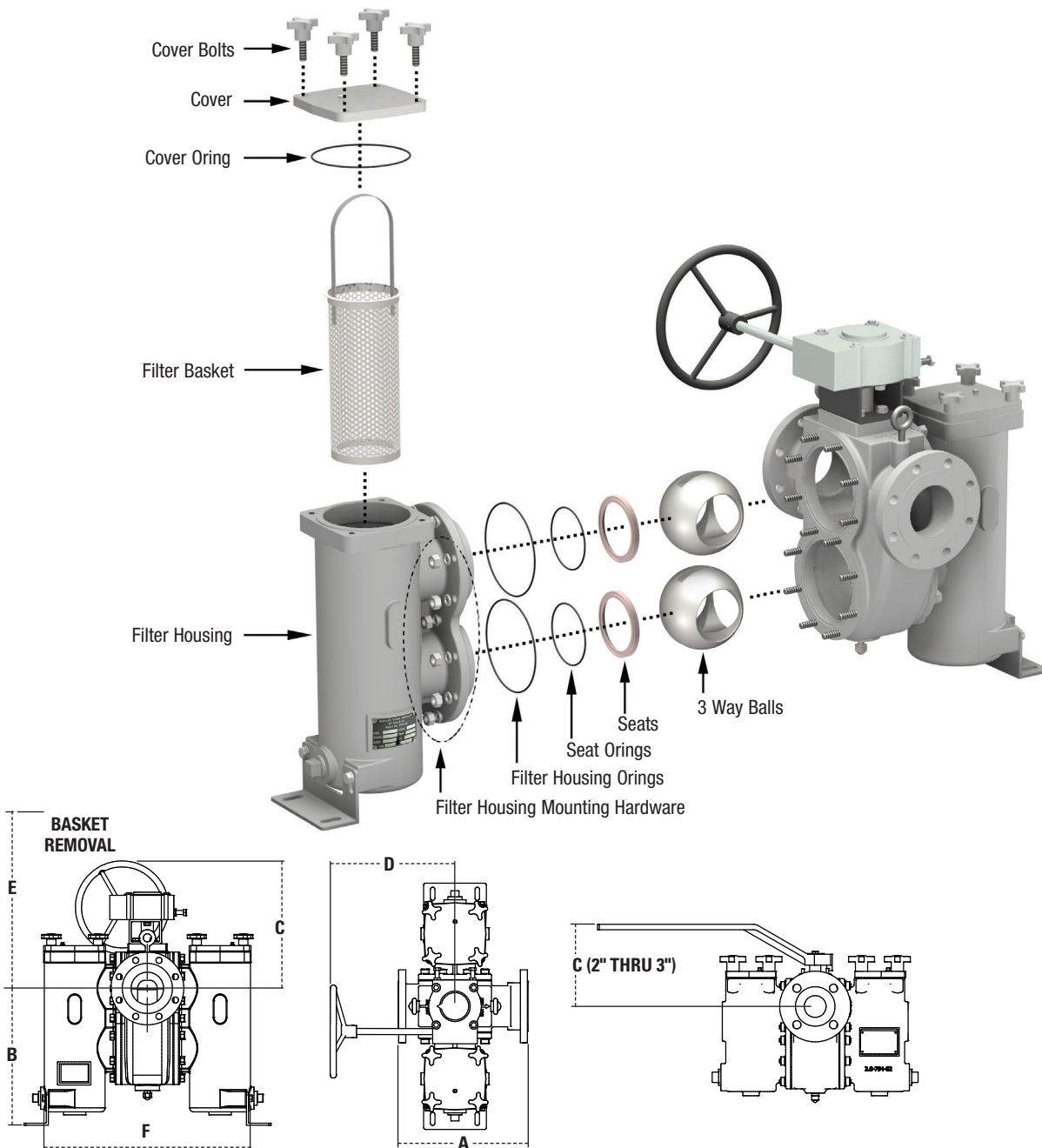

Dimensions

Models 792MF, 794MF Dimensions

SIZE		A		B		C		D		E		F		G(NPT)		WEIGHT					
		Class 150		Class 300												792		794			
in.	mm	in.	mm	in.	mm	in.	mm	in.	mm	in.	mm	in.	mm	in.	mm	lbs.	kgs.	lbs.	kgs.		
2"	51	10 ⁵ / ₁₆	270	10 ⁵ / ₁₆	270	8 ³ / ₁₆	208	7 ¹ / ₂	191	20	508	12 ³ / ₈	321	16 ⁵ / ₁₆	416	1 ¹ / ₄	32	115	52	121	55
2 ¹ / ₂ "	64	13 ¹ / ₂	343	14 ¹ / ₄	362	12	305	8 ⁵ / ₁₆	211	20	508	18	457	21	533	1 ¹ / ₂	38	223	101	233	106
3"	76	13 ¹ / ₂	343	14 ¹ / ₄	362	12	305	8 ⁵ / ₁₆	211	20	508	18	457	21	533	1 ¹ / ₂	38	223	101	233	106
4"	102	16	406	16 ¹ / ₂	419	16 ⁷ / ₈	429	15 ³ / ₄	400	15 ³ / ₈	403	23 ³ / ₈	594	25 ¹ / ₂	648	1 ¹ / ₂	38	443	201	466	211
5"	127	22	559	22 ⁷ / ₈	581	18 ¹ / ₂	470	17 ¹ / ₂	445	15 ³ / ₈	403	23 ³ / ₈	606	26 ⁵ / ₈	276	1 ¹ / ₂	38	820	372	850	385
6"	152	22	559	22 ⁷ / ₈	581	18 ¹ / ₂	470	17 ¹ / ₂	445	15 ³ / ₈	403	23 ³ / ₈	606	26 ⁵ / ₈	276	1 ¹ / ₂	38	820	372	850	385

Exploded View

Model 792MFLCDH

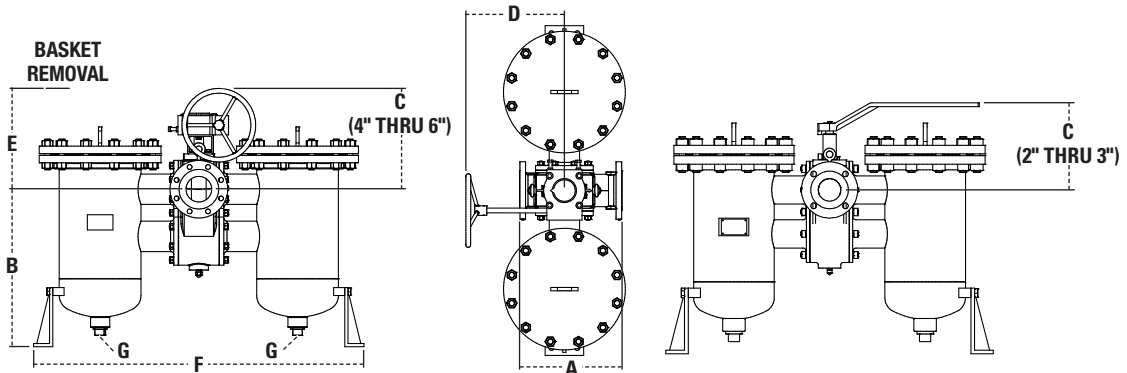
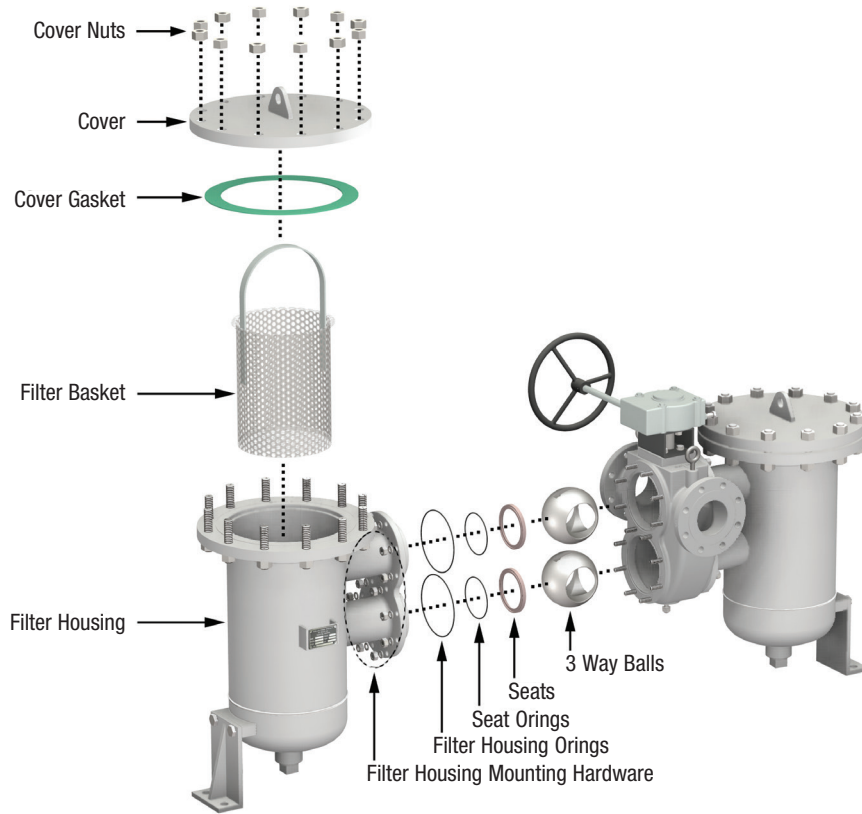

Dimensions

792MFHC, 794MFHC High-Capacity Dimensions

SIZE	A		B		C		D		E		F		G(NPT)		WEIGHT	
	Class 150 <i>in.</i>	Class 300 <i>mm</i>	Class 150 <i>in.</i>	Class 300 <i>mm</i>	Class 150 <i>in.</i>	Class 300 <i>mm</i>	Class 150 <i>in.</i>	Class 300 <i>mm</i>	Class 150 <i>in.</i>	Class 300 <i>mm</i>	Class 150 <i>in.</i>	Class 300 <i>mm</i>	Class 150 <i>lbs.</i>	Class 300 <i>kgs.</i>	Class 150 <i>lbs.</i>	Class 300 <i>kgs.</i>
2"	51	10 ⁵ / ₁₆ 270	10 ⁵ / ₁₆ 270	17 ¹⁵ / ₁₆ 456	10 ¹¹ / ₁₆ 271	—	—	21 ¹ / ₈ 537	22 ¹ / ₈ 537	37 ¹ / ₈ 943	1 ¹ / ₂ 38	361	164	504	229	
2½"	64	13 ¹ / ₂ 343	14 ¹ / ₄ 362	21 ⁷ / ₈ 556	11 ⁵ / ₈ 295	—	—	24 ¹ / ₈ 613	25 ¹ / ₂ 648	43 ⁷ / ₈ 1114	2 51	579	263	820	372	
3"	76	13 ¹ / ₂ 343	14 ¹ / ₄ 362	21 ⁷ / ₈ 556	11 ⁵ / ₈ 295	—	—	24 ¹ / ₈ 613	25 ¹ / ₂ 648	43 ⁷ / ₈ 1114	2 51	580	263	822	373	
4"	102	16 406	16 ¹ / ₂ 419	24 ³ / ₈ 625	15 ³ / ₄ 400	15 ³ / ₈ 391	27 ¹¹ / ₁₆ 703	30 ¹ / ₂ 775	51 ¹³ / ₁₆ 1316	2 51	925	420	1269	576		
5"	127	22 559	22 ⁷ / ₈ 581	31 787	17 ¹ / ₂ 445	15 ³ / ₈ 391	36 ⁷ / ₈ 937	40 ⁷ / ₈ 1038	66 ¹⁹ / ₁₆ 1700	2 51	1823	827	2452	1112		
6"	152	22 559	22 ⁷ / ₈ 581	31 787	17 ¹ / ₂ 445	15 ³ / ₈ 391	36 ⁷ / ₈ 937	40 ⁷ / ₈ 1038	66 ¹⁹ / ₁₆ 1700	2 51	1823	827	2452	1112		

Dimensions shown are for standard 792/794MFLC (792 is Class 150) (794 is Class 300). Custom ratios can be fabricated to order.

More on

Ball-Plex™ Duplex Strainers

For years the patented Mueller Ball-Plex™ Duplex Strainer have set the standard for all duplex strainer designs.

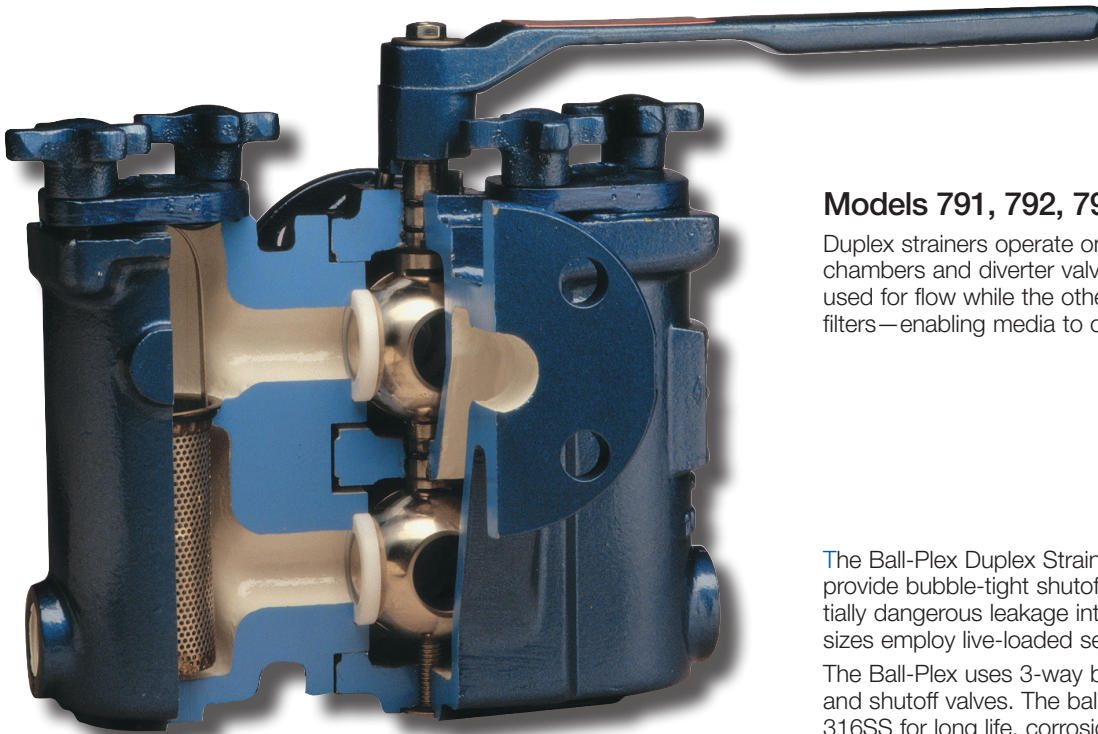

Models 791, 792, 794

Duplex strainers operate on a simple principle: Using dual chambers and diverter valves means one chamber can be used for flow while the other is isolated for cleaning basket filters—enabling media to continue flowing, uninterrupted.

The Ball-Plex Duplex Strainer design utilizes PTFE seats to provide bubble-tight shutoff, eliminating costly and potentially dangerous leakage into the unused chamber. Larger sizes employ live-loaded seat design.

The Ball-Plex uses 3-way balls as dual-purpose diverter and shutoff valves. The balls are precision-machined 316SS for long life, corrosion resistance, strength, and resistance to build up of surface solids.

Sizes 4" to 6" have a standard gear operator for easy operation.

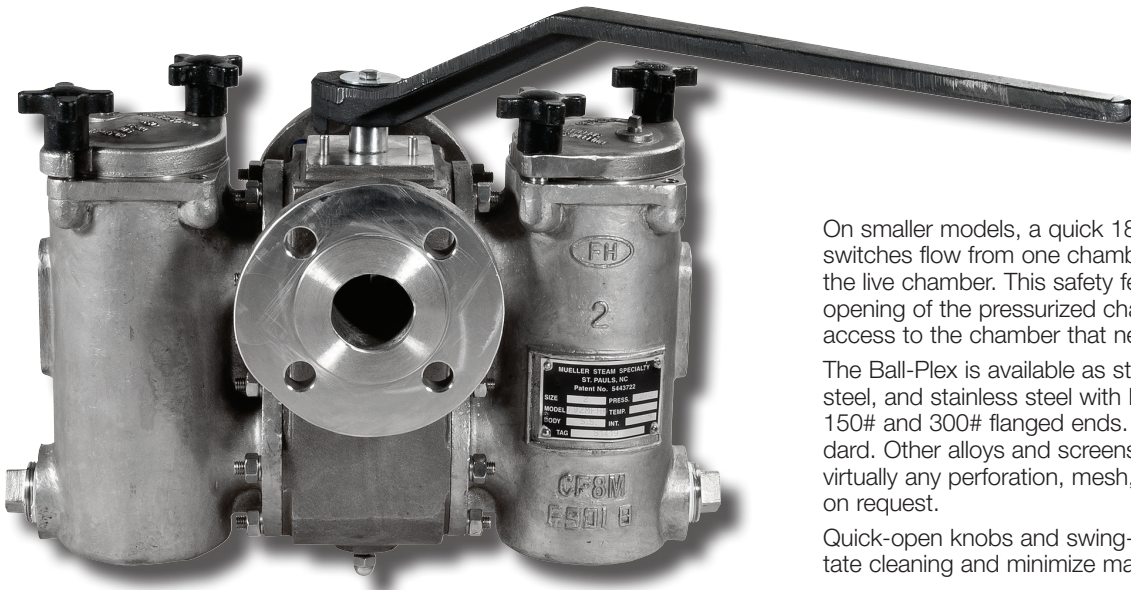

792MFHH-STAINLESS STEEL

On smaller models, a quick 180-degree turn of the handle switches flow from one chamber to the other and covers the live chamber. This safety feature eliminates accidental opening of the pressurized chamber and enables easy access to the chamber that needs servicing.

The Ball-Plex is available as standard in cast iron, carbon steel, and stainless steel with NPT threaded ends and 150# and 300# flanged ends. 304SS screens are standard. Other alloys and screens in different materials and virtually any perforation, mesh, or combination are available on request.

Quick-open knobs and swing-away chamber covers facilitate cleaning and minimize maintenance time.

With Mueller Steam Specialty, the emphasis is on specialty—it has both defined Mueller and helped us grow into one of the largest suppliers of specialty products for the valve industry. For Mueller, supplying standard products is no problem—but our ability to offer different materials and variations distinguishes us from most of our competition.

Key capabilities include fabrication, materials and overlays, products, inspection & testing, approvals & certifications, quotations, engineering, and new equipment.



For more information visit
www.muellersteam.com

Mueller Steam Specialty product specifications in U.S. customary units and metric are approximate and are provided for reference only. For precise measurements, please contact Mueller Steam Specialty Technical Service. Mueller Steam Specialty reserves the right to change or modify product design, construction, specifications, or materials without prior notice and without incurring any obligation to make such changes and modifications on Mueller Steam Specialty products previously or subsequently sold.



A **WATTS** Brand