

JACKSONVILLE, IL. GENEAL JOURNAL

VOLUME No. VII

ISSUE # 4

DECEMBER 1979

AN INDEX TO
CEMETERIES IN
MORGAN COUNTY, ILLINOIS
County Seat---JACKSONVILLE

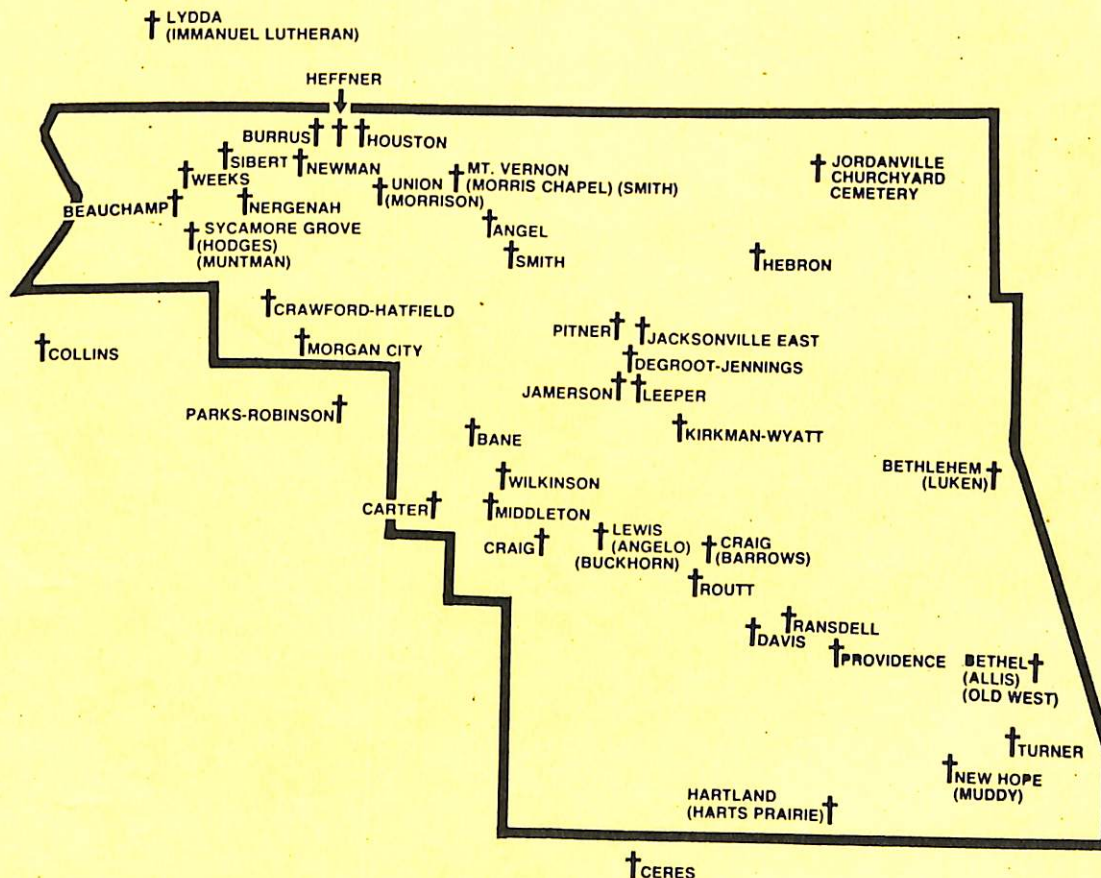

Quarterly of the

JACKSONVILLE AREA GENEALOGICAL AND HISTORICAL SOCIETY
P.O. Box 21 Jacksonville, Illinois 62651

THAT'S GOOD THINKING (?)

...To attain the highest good of true man and womanhood, simply do your honest best.
God will do the rest. James Whitcome Riley

...Advice to future parents: As a favor to genealogists, will you please name your children something outstanding and different, like Hezekiah, Shadrach, even Abednego, not John, Mary, James, Elizabeth, or William, says Christine Oppenheimer who has been in Jacksonville recently trying to sort out all of the John Crawfords, William Thompsons and Nancy Wilsons.

...Did you know that Elizabeth is the most-used feminine name? That is why your Editor shortened it to Eliz. in all of the indexes. Just think how many more characters there would be to type!

...Florence found, this week, some old albums of recipes and poems donated by the Duncan Family. Julia L. Duncan's mother gave her a blank book on May 28, 1853, with occasional pictures. She had her friends write their heart's desire in it from 1853 to 1862. The following lovely poem was written by Jas. Gallaher:

*May never care nor sorrow cloud
That sunny brow of thine;
But may contentment ever make,
Thine own pure heart its shrine.*

*And when thy days of youth are past,
And joys that thou hast known;
In the bright time of girlhood's hours,
Have like a meteor flown,*

*Still be thy pathway ever bright,
As yonder star that throws
Its rays of twinkling light expose,
The earth at twilights close.*

*And at the closing scene of life,
May a Redeemer's love
Call thee to dwell with Him in
worlds*

Of endless bliss above.

...One of the books belonged to Elizabeth Smith Duncan, a Recipe Book 1828-1884. It had some for Mince Meat, Fried Apples, and recipes from many of her friends. Among them was "Mrs. Rockwell's receipt for Curing Bacon and Pickle Pork, copied Dec. 6, 1844." Another copybook, ca 1827 in this Manuscript Divisions collection #72-47, belonging to Elizabeth has a beautiful poem from Joseph Duncan to his wife in 1829 as they came to make their new home in Jacksonville. The library was closing, and there was no time to copy this treasure. [Ill. St. Hist. Library.]

...Did you know that all of the original papers of Gov. Duncan were placed in the archives in Des Moines, Iowa? Only xerox copies are in the Illinois Historical Library, manuscript division.

...How to Make Ten Gallons of Ink -- Recipe of John "Bluffdale" Russell.

One of Greene County's earliest schoolmasters, John Russell, a prolific writer about early Illinois life, and life-long educator, used the pseudonym of "Bluffdale". This was also the name of his 1828 rock home. This house, with a few additions, still stands today and is called Hobson's Bluffdale, north of Eldred several miles. Bill and Linda Hobson and three sons, descendants, live there and operate a farm motel.

This ink recipe was found in his old dictionary by his great-grand-daughter, Mary Keller Hobson, who lives in Greenfield:

To make ten gallons of ink start with 10 gal. soft water. Add 1 pound extract of Logwood. Put the extract into the water at blood heat and stir till it is all dissolved. Then add 6 oz Gum Arabic (better leave Gum Arabic out), 1 oz bi-chromate of Potash, 1 oz prussiate of Potash. Stir until all's dissolved. Make the ink in a tin boiler.

...Our Society will be happy to hear from the first person who tries this recipe.

PLEASE: Send us any changes in your address as soon as possible. We have to pay to get YOUR QUARTERLY back to us, and then mail it you the second time. In the meantime you are doing without a valuable research tool. Right?

JACKSONVILLE, IL. GENEAL JOURNAL

of the

JACKSONVILLE AREA GENEALOGICAL AND HISTORICAL SOCIETY

P. O. Box 21

Jacksonville, Illinois 62651

Volume No. VII

December 1979

Issue # 4

CONTENTS

| | |
|--|-------|
| MAP of Morgan County, Illinois with Dalton-Long's Vol.III Cemeteries . . | Cover |
| That's Good Thinking (?) | ii |
| Table of Contents | iii |
| Dear Friends and Geneal People | iv |
| Map of Jacksnville (Original Plat by Johnston Shelton) | 1 |
| Interesting Facts Pertaining to Original Plat Map of Jacksonville | 2 |
| A Sketch of Jacksonville (from Nixon's 1868-69 <i>Jacksonville Directory</i>) . . | 3-6 |
| Morgan County Cemeteries | 7 |
| Plat Map Index of Congressional Townships in Morgan County, Illinois . . | 8 |
| Index of Cemeteries in Dalton-Long's Vol.III of <i>A Guide to Cemeteries</i> ... | 9,10 |
| Index of Burials " " " " " " <i>A Guide to Cemeteries of Morgan County, Illinois</i> . | 11-31 |
| Hilltop Churchyard Revisited (Poem by George Moore.) | 31 |
| Index of Burials in Asbury Cemetery | 32-34 |
| A Happy Sequel | 34 |
| John Swinden, Formerly of Greene County, Illinois, 1823-1898 | 35,36 |
| A Brief Sketch of Samuel D. Lockwood | 36 |
| Thanks Giving | 36 |

==:==:==:==: The mistakes of yesterday are the lessons of today. ==:==:==:==:

| | |
|---|---------|
| Regular dues for Individuals, Institutions, or Libraries | \$ 5.00 |
| Charter Renewals (for persons joining prior to April 1973). | 4.00 |
| Spouse of Regular or Charter Members | 1.00 |
| Junior Members (in High School or College enrollment) | 1.00 |
| Life Members | 100.00 |

(If you have no application blank, send 3x5 index card with complete name and address, and amount of dues sent. List family surnames you are working on. Make checks payable to Jacksonville Area G. & H. Society.

If you can't write your own history book, purchase one of ours.
The 1878 Donnelley-Loyd Morgan County History reprint, with index, is available.
\$25.00 plus \$1.00 for mailing and handling, please. Send your order in today!

Dear Friends and Geneal People:

23 November 1979

The Big Day is over, and I must get back to finishing the December Quarterly. In the first place, let me relate that your Editor was doubly grateful this year, and why. Our daughter, husband and two sons arrived home permanently from Iran this August, and while they were not with us, they had a turkey dinner (smothered in 24 inches of snow out in Boulder) and had their own family together for the first time in 5 years. All the rest of our children, (one son and 3 daughters), with 6 grandchildren, and Joan's mother, had dinner at our daughter's home in Rochester. Instead of the old-fashioned "to grandmother's house we go", it is "to our children's home we travel at no more than 55 m.p.h."

It was the pleasure of the Jacksonville Area G. & H. Society to present the name of Life Charter Member George E. "Ernie" Caldwell as a nominee for a Local Service Award by the Illinois State Genealogical Society at the annual fall conference, October 5-6, 1979, in Decatur. Among other of his services to genealogists, he and his late wife and Mary Lou Whitlaw transcribed the Census records of Scott County for 1850, 1860 and 1880, and presented them to our Society. For this we are "eternally grateful for the donation of these marvelous 'labors of love'. Until that time there was a dearth of Scott County research material, and very little published history available. Because Scott was once a part of Morgan County until 1839, our Society gets many queries from persons whose relatives can thus, by the use of these 3 census records, be placed in the correct county for further research. This gives a personal record of families for a critical 30-year period." The State Society awarded a lovely framed certificate of award which was recently presented to Ernie in Williamsville. He is very pleased to have this long overdue recognition of his efforts. He is currently bringing the history and records of the Williamsville Methodist Church up to date, and trying to establish a library there. We extend congratulations to him, and wish him much success in his venture. Perhaps some of our genealogists "out yonder" would write to him and encourage him in these efforts. Perhaps they may find some way to help with his worthwhile project. His address is Box 23, Williamsville ILL 62693.

Do Not Go Into Old Cemeteries Unprepared For Poisonous Results!

"Leaves three, Let it be." Roots too, Are taboo. Oils on your shoe, May also get through - someday, to you. Heed well this warning! Please do.

"Poison Ivy" Florence.

"Even smoke, from burning trees, May you choke, put you in deep freeze, As bills a-mount, you'll take account, Of cemetery fun, and from it run, To get some shots, to protect from ivy, And getting 'hivey', in cemetery plots."

"Poison Oak" Myra.

Myra got in smoke from burning trees in clearing a cemetery and suffered dire results a year ago. Florence was delighted to find a buried stone on November 4th, and has been battling a bad case of poison ivy from the roots under ground. There was no surface evidence of poison ivy. While there are numerous genealogists who have gone into cemeteries with^{out} contacting poison ivy, some people are more allergic to it than others. So, don't trust YOUR luck! An experienced cemetaryian will wear old boots, protect legs with a second set of old pants, and arms with long sleeves of a washable shirt, heavy duty gloves, and use a spade for ground removal, and brushing dirt away from stones. Wash all articles worn in a cemetery with some clorox in the water. Some people find that diluted product helps to keep ivy from spreading on their hands. No one medicine will work the same way for all persons with the affliction. Ivy-Dry, Caladryl lotion, and ice packs help some people. For me, the best itch-reducer was to wash the parts with Dove and water, then sprinkle on Epsom Salts crystals, let them dry and brush off. But it is a long slow process, folks. Please do not repeat my mistake of not being prepared for what happened. A last reminder:

HAVE YOUR 1980 DUES BEEN PAID? We need to get our mailing lists prepared early. And we need any address changes as soon as you know what they are.

Genealogically yours, and adieu for 1979.

Florence Hutchison

MAP OF JACKSONVILLE.

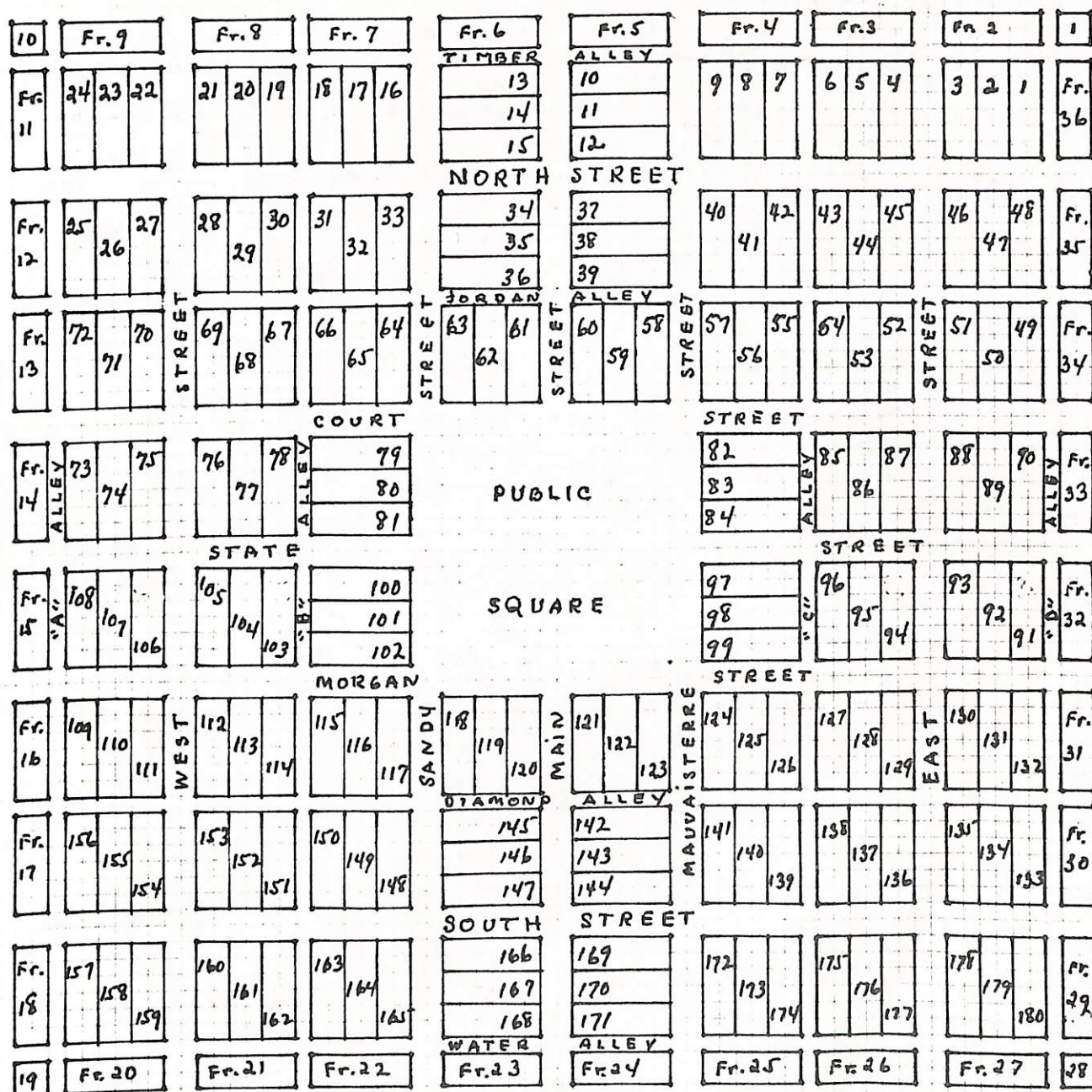

[This reduced map was drafted November 1979 by Florence Hutchison, from the Original Plat Map of Jacksonville which is to be found in DEED BOOK A, on page 19. Underneath the map are the following words by the Surveyor:]

The Lots in the foregoing plat are 180 feet 9 inches, by 60 feet 3 inches.
Morgan County, Illinois, April 6th 1825.

By me, Johnston Shelton.

- A. Sale of original lots -- the north half of the City was subject to sale by the Morgan County Commissioners.
- B. The south west quarter of the City was subject to sale by Thomas Arnett.
- C. The south east quarter of the City was subject to sale by Isaac Dial.

Lots 1-90 were sold by the County Commissioners.

Lots 91-99, 121-144, 169-180 were sold by Isaac Dial.

Lots 100-120, 145-168 were sold by Thomas Arnett.

Each lot was 60' x 180', streets 60', and alleys 20' or 30', more or less.

Around the outside edge of the City was a perimeter of odd-sized lots laid off as "Fractional (Fr.) lots":

Fr. Lots 1-14, 33-36 were sold by the Morgan County Commissioners.

Fr. Lots 15-23 were sold by Arnett.

Fr. Lots 24-32 were sold by Dial.

D. Changes in Street and Alley names on 1825 plat map, to 1872 plat map, and later, are noted here:

| | |
|-------------------------|--|
| Timber Alley | Madison street |
| North Street | still North 1872, later Douglas |
| Jordan Alley | 1872, Railroad street, later Jordan |
| Court Street | never changed |
| State Street | " " |
| Morgan Street | " " |
| Diamond Alley | " " |
| South Street | College Avenue |
| Water Alley | Vacated. See Misc.Rec.Bk. C-1 at page 195. |
| "A" Alley | part of it now Dunlap Court |
| West Street | never changed |
| "B" Alley | between new Postoffice and parking lot, it is closed in front of Municipal Building on Lots 16-21. |
| Sandy Street | never changed |
| Main Street | never changed; closed at Public Square |
| Mauvaisterre | never changed |
| "C" Alley | all way through. |
| East Street | never changed |
| "D" Alley | all way through. |

E. Present building sites:

1868 Courthouse, lots 73-75

Parking lot to succumb to new 1980 Jail, lots 70-71

Present jail, 1864-1979, lot 144

Public Library, fractional parts of lots 166-168

Municipal building, lots 16-21

New postoffice 1979, lots 64-66

Old postoffice building, lots 91-93

Pierson log cabin, popularly called "Fort Sumpter because so many battles have been fought over it", a quote credited to Dr. Chas. Frank, former Alderman on the City Council, north 1/3 of Lot 27, and north 1/3 of E $\frac{1}{2}$ Lot 26.

The John Carter log cabin exposed recently at 314 north East street is on the south half of the north third of lots 1, 2 and 3. (John Carter owned these lots as of the 1853 City tax list.)

Page 1: A SKETCH OF JACKSONVILLE. [Pages 7-11 of Nixon's "Jacksonville Directory" For 1868-69, Containing A Complete List of all Residents in the City, also a Classified Business Directory, with the Names and Address of the Merchants, Manufacturers, and Professional Men in the City. ---:---:---:--- Jacksonville, Ill. "City Job Office" Print, South-East Corner Square. 1868.]

We are indebted to the Hon. MURRAY McCONNELL for the following brief and excellent Sketch of the City of Jacksonville:

Jacksonville, Ill., Sept. 25, 1868.

To W. A. Nixon, Esq.,

Dear Sir: You request me to jot down for you a short history of Jacksonville, to be published in your Directory for the City, now being prepared by you, and I proceed to do so in as few words as I can, to give your readers the information they will expect in a work of the kind you propose to publish.

The Legislature of Illinois, in January, 1823, established by law the county of Morgan, and appointed three persons to locate a county seat.¹ The country then included in the county now composes the counties of Morgan, Scott and Cass. Owing to the fact that at that time but a few inhabitants resided within those boundaries, the Legislature thought proper to provide that the county seat to be located under said law should be temporary only, leaving it to some future Legislature to provide for the permanent location of the county seat. This temporary county seat was located at a place called "Olmstead's Mounds," some eight or nine miles nearly west of the present City of Jacksonville.

The session of the Legislature of 1824-5, passed another law touching the county seat of said county, in which three persons were appointed to permanently locate the county seat of said county,² and in said law it was provided that if said county seat should be located upon land belonging to any private citizen, the owner or owners of the same should donate to the county twenty acres, to be laid out in lots and sold, the proceeds of which should be applied to the building of a court house and jail for said county.

In obedience to this law the three persons appointed located the county seat in the center of a quarter section of land composed of the east half of the north-east quarter of section twenty-one, in township fifteen north of the base line, and in range ten west of the third principal meridian.

The day this county seat was located the land belonged to the Government of the United States, but the next day, at nine o'clock in the morning, the Government sold it at private sale at one dollar and a quarter per acre, to Thomas Arnitt and Isaac Dial, two citizens residing near the place. Arnitt purchasing the tract in section twenty, and Dial the tract in section twenty-one. Arnitt and Dial resolved in connection with the county, to lay out a town upon said land, and by an agreement between these owners and the county commissioner's court, a line was drawn from east to west through the center of the quarter section, and Arnitt and Dial conveyed by deeds to the county, each twenty acres immediately on the north side of that line. This donation by those proprietors contained forty acres, being double the quantity required by said law to be given to the county. On the tenth of March 1825, those proprietors, for themselves, and the county court for the county court for the county³ laid out a town on eighty acres of land, in a square form, in the center of said one hundred and sixty acre tract, the county owning the north half and the proprietors the south half, and after much research and deliberation in selecting a name, they called the town Jacksonville, after General Andrew Jackson, he being the great man of that day.

Previous to that time there had been a public road laid out from Springfield, the then recently located county seat of Sangamon county, to the town of Naples, on the Illinois river, in Morgan county. This road, by way of eminence and distinction, was called the State road. This State road passed east and west on the top

of the ridge of land directly over the spot selected for said county seat. The surveyor who laid out the town, (Mr. Johnston Shelton,) began the survey by laying out a central square of land, containing something more than five acres, directly in the center of the said one hundred and sixty acre tract, the State road running through the center of the square. Upon this State road he located a street sixty feet wide, intending it to run due east and west across said one hundred and sixty acres, and on the north line of the land belonging to the proprietors. Thus locating one-half of said square and one-half of the width of the street on the land of said private owners, and the other half on the land of the county. This street was called State street.

A street was then laid out running north and south through the center of said land and said central square, of the same width, and it was called Main street. Taking those two streets as base lines, the town was laid out into square blocks, of one hundred and eighty feet nine inches on each side, which blocks were divided into three lots, each of equal size. All other streets, except those two, were made forty feet wide, and the alleys twenty feet wide, all running at right angles with each other. [See Original Plat Map of Jacksonville, Illinois, Deed Book A, page .]

The county offices and all county business were removed from the temporary county seat at Olmstead's Mound to Jacksonville, in the summer of 1825, and the first circuit court was held at Jacksonville in September of that year.

In 1826 the first court house was built in Jacksonville. It was located on the land on the north side of State street, and west of Main street, and on that part of the center square that had been conveyed to the county. It was a two story frame building, thirty by forty feet square, set upon round blocks, and cost about four hundred and fifty dollars. There was but one term of the circuit court held in this house, the same being burned in December [6], 1827, together with the records of the courts of the county. The loss, however, in those records was not great, as the county had not been long organized, and but a few records had been made.⁴ The original plat, however, of the town, and the deeds from Arnitt and Dial to the county for the land whereon the north half of the town was laid out, were burned, but the record-book containing copies of said plat and of those deeds was secured, the recorder, Dennis Rockwell, having, accidentally, said book at his house on the night of the fire.

To supply the place of the court house burned, the present court house (now called the old court house) was built in 1829 and 1830, and was the first brick house in the county. This house was located on the same center square of land, on the south side of State street [italics mine for emphasis of difference in location], and west of Main street, and cost about four thousand dollars. This old court house is shortly to give place to a new and elegant structure now being built on the second block west of the square on the north side of State street, on that part of said eighty acres of land conveyed by Arnitt to the county, and this old edifice will soon be removed and forgotten. [Yes, gone, Mr. McConnell, but not forgotten yet in 1979!].

Much might be said in praise of the enterprise of the inhabitants of the city in years past, of the eleemosynary institutions, and institutions of learning that have clustered around the city. I could tell you of the first preachers and the first churches, and the first schools, but I am not sure you would deem that exactly appropriate in a work like the one you propose to publish. I could go into the personal history of the first and earliest settlers of the town; tell when they arrived and where they were from, how they lived, and when they died, but all this would be biography and not local history. Therefore I respectfully submit to you what I have written to be by you published or not, or used as you may think will best promote the objects intended by your book.

With great respect I am yours,

M. M'CONNELL.

Bibliographical references cited in body of M. McConnell's historical sketch pertaining to early history of Jacksonville:

1. 1878 History of Morgan County, Illinois, Donnelley, Loyd & Co., Pubs., Chicago. Reprint, with index, 1975 by Unigraphic, Inc., Evansville, Ind.
p. 255: *It will be noticed in reading the act creating the county that Samuel Bristow, John Clark, and Henry Fahnestock were appointed a committee to fix upon a temporary seat of justice for Morgan County. They selected a place called "Olmstead's Mounds," . . .*
2. Ibid. p. 255.
By an act passed January 6, 1825, John Howard, Abraham Pickett, and John T. Lusk, of Madison County, were appointed . . . They were required to meet at the house of James Deaton on the first Monday of March, . . .
3. Ibid. p. 254.
Daniel Lieb, Peter Conover, and Samuel Bristow, were chosen county commissioners, and William B. Green, sheriff. Dennis Rockwell was appointed clerk of this court.
4. Note of personal observation pertaining to loss of records by Florence Hutchison, Morgan County Records Preservation Chairman: *The fact that Marriage License #181 was issued as of December 7, 1827 indicates that the first 180 records of marriage were lost in this fire. No death or birth records were being kept in that early period, except for Coroner's Records. All court records were destroyed from 1823 to date of fire.*

* -- * -- * -- * -- * -- * -- * -- * -- * -- * -- * -- * -- * -- * -- *

How happy your Editor is that she copied this early "Sketch of Jacksonville" from Nixon's 1868-69 Directory for this historical article because it explains why deeds to the sale of lots could not be found under "Morgan County", or "City of Jacksonville". But this needed a map of the Original Plat in order to clarify the lot locations for our Quarterly's genealogists. So she spent a pleasurable evening drafting one that fits 8½ x 11 paper, as per the accomplished plat map in this December 1979 *Geneal Journal*, page 1.

How unfortunate it is that Murray McConnell did not live long enough to write a book of all of those historical events and people he was so well acquainted with. He was assassinated less than six months after the date of his sketch, on February 9, 1869. He had been a Brigadier General in the Civil War. A merchant by the name of William A. Robinson was indicted for the murder. There is much interesting history to be related on this matter, but suffice it to say in this limited space that he was acquitted. March 2, 1877 there was a self-confessed murderer making his statements which were not believed, and he was returned to "his home in Joliet [prison] after being convicted of larceny, for nine months." He was John Pearson[also Pierson].

And now to return to the sale of lots as listed in the Deed Books. One finds that the North half of the City was subject to sale by the Commissioners, the South west quarter of it by Arnett, and the South east quarter by Dial. Lots 1 - 90 were sold by the County Commissioners. Lots 91-99, 121-144, 169-180 were sold by Isaac Dial. Lots 100-120, 145-168 were sold by Thomas Arnett. Each lot was 60' x 180', streets 60', alleys 20' or 30', more or less. Around the outside edge of the City was a perimeter of odd-shaped and probably small-sized lots laid off as "Fractional (Fr.) lots."

Fr. Lots 1-14, 33-36 were sold by the Morgan County Commissioners.

Fr. Lots 15-23 were sold by Arnett

Fr. Lots 24-32 were sold by Dial.

Courthouse #1, 1823-1825 was out on Olmstead's Mounds.

Courthouse #2, 1825-1827 was a frame building on the northwest quarter of the Public Square in the Original Plat of Jacksonville.

Courthouse #3, 1827?-1868 was the first brick structure in the county, and placed on the southwest quarter of the Square.

Courthouse #4, 1868-in current use, was built on Lots 73, 74 & 75.

From an 1853 City Tax List was found the owners of all of the lots in the Original Plat. (List not given here, except for public and religious buildings listed as Free of taxes.)

Lot 35, Morgan County Jail. Lots 43,44,45 contained the "Locust Grove District".

The Christian Church had parts of lots 11 and 12. The Second Presbyterian Church occupied Lot 77, the First Presbyterians Lots 103,104,105. The Methodists were on Lot 95, and the Congregationalists on Lots 98 & 99. The Baptist Church was Lot 108. The School House was on 175.

Pages 255 & 256 of our 1878 Morgan County History sheds a little light on the jail situation: *The jail was constructed of square timbers, firmly fastened together, and was a rather unsafe depository for prisoners. It stood on a lot of ground north of the square, and was used until the completion of the second jail in 1833.*

Page 320 of the Jacksonville City Directory to be found in the 1866 John C. W. Bailey compilation of the Sangamon County Gazeteer with City Directories of Springfield and Jacksonville, with List of Postoffices in Illinois, sheds further light on court and jail history:

The first court was held in the open air, in the spring of 1825, and in the open prairie. The jurors sat on logs, which had been hauled into position; "the court" on the end of a log, and a short log, set on end, was the "clerk's desk;" said clerk carried his papers in his pocket and his docket in his hand, while the sheriff's runners were seen galloping in every direction. "Uncle Jacky" Smith was one of the jurors; Judge Sawyer presided, Dennis Rockwell was clerk, and L.D. Lockwood (afterwards judge) was the only attorney present. In April the original plat of Jacksonville was made by Morgan county. The Public Square was the center, and the plat included about seventy acres. In the fall a court-house was built, also a small log school-house. In December, 1827, the court-house was burned, with all the records of the county, and in the spring of 1828 the court-house now standing was built. It was the first brick building erected in Jacksonville. Thomas Carson kept the first tavern, and was first jailer. The first jail was built by Sprague, Dougherty & Gorham of hewn timber throughout. Three men were confined for stealing horses, and when the bolts of this new jail--so carefully, and, was thought, so securely built--were turned, it was thought that the men were safe; and "Uncle Tommy" Carson slept soundly. The prisoners, in the meantime, were examining their situation, and soon found that the great heavy door had been hung with common wrought hinges. They quietly lifted it out of its place, and Sampson-like, carried it two miles away from the sleeping jailor, and impudently wrote upon it, in chalk letters, "STOP THIEF." It is useless to say they never were caught.

Our Society has indexed this 1866 Bailey Directory of Jacksonville, and would send a copy of this list of over 2400 names for \$2.50 for use of our genealogists, if they would so desire to order a copy xeroxed. Names only, are listed, with page number in original Gazeteer.

* * * * *

The following pages contains the name of hundreds of burials in Morgan County. This is a burial index of Robert Dalton's Volume III of A Guide to Cemeteries in Morgan County, Illinois. Several of our society members, and avid "cemetarians" have read and turned in cemetery lists to us. These have been xeroxed and passed on to Bob. Then he proceeds to visit the given cemetery, to research further details of interest, and then spends many hours typing them in his unique fashion. First, we wish to thank all of those wonderful people who have given us readings. Next, let us review some notes on the subject from Bob:

The task of compiling the burials in the cemeteries was begun in 1967 as a public service project. At first only tombstone readings were recorded, but this soon evolved into searching out unmarked graves as well, and probing with a metal rod for buried stones. I retrieved many stones that had washed down the hills, and laid them with stones of related names.

Additional information is sometimes included, such as obituaries, items of interest about the deceased, military service, [some of which we take from the Illinois Veterans' Commission publication of 1956, Honor Roll of Morgan County], etc. Some of the cemeteries I searched no longer exist, but are now trailer courts, housing developments, pastures and plowed fields, regrettably.

Sources of information I used to obtain the burial listings have included tombstone readings, cemetery records, coroner reports, death certificates, court records, land deeds, family records, interviews with relatives, land-owners, sportsmen and mushroom hunters, lists of readings from others, and newspaper microfilms. In using microfilms of old newspapers a researcher should pay special attention to the "country correspondence" columns from outlying areas of interest. Usually printed once a week, the correspondents often mentioned births, marriages and deaths occurring in the neighborhood, and sometimes named the place of burial.

These three volumes have not been published in quantity. Bob has permitted us to xerox copies and place in the Illinois State Historical Library, Lincoln Library, Jacksonville Public Library, and the County Clerk's office.

Preceding the Burial Directory is an index of the Cemeteries involved in Volume III, along with the page number, Map number on the Morgan County congressional Township plat (next page). Listed also is section, township and range in which the cemetery is located. An additional map showing the location of the cemeteries is given on the cover of this December 1979 Quarterly of the Jacksonville Area Genealogical and Historical Society. Genealogists desiring tombstone data may write to our Society, requesting pages wanted. A donation to cover costs of xeroxing and postage will be appreciated, because it is a tedious process to select the right pages out of our loose-leaf notebook, take it to a machine, get it in the mail, and try to get all pages back in their proper place ready for the next request. We would appreciate it very much if persons who have access to the library copies in Springfield, or here in Jacksonville, would please ask those libraries for xerox copies of pages they desire, as our mail for other requests is becoming heavier all of the time.

Again, we wish to urge those persons with extra data on cemetery readings, or corrections, to send them to us to file with the particular reading it concerns. So please use 8½ x 11 paper, one cemetery per page, even if the data is not very much. Then we will not have to copy off and separate one cemetery reading from another. We wish many of you much success in finding where YOUR PEOPLE are buried. It is a joy when this occurs, as it often does.

PLAT MAP INDEX
MORGAN COUNTY, ILLINOIS

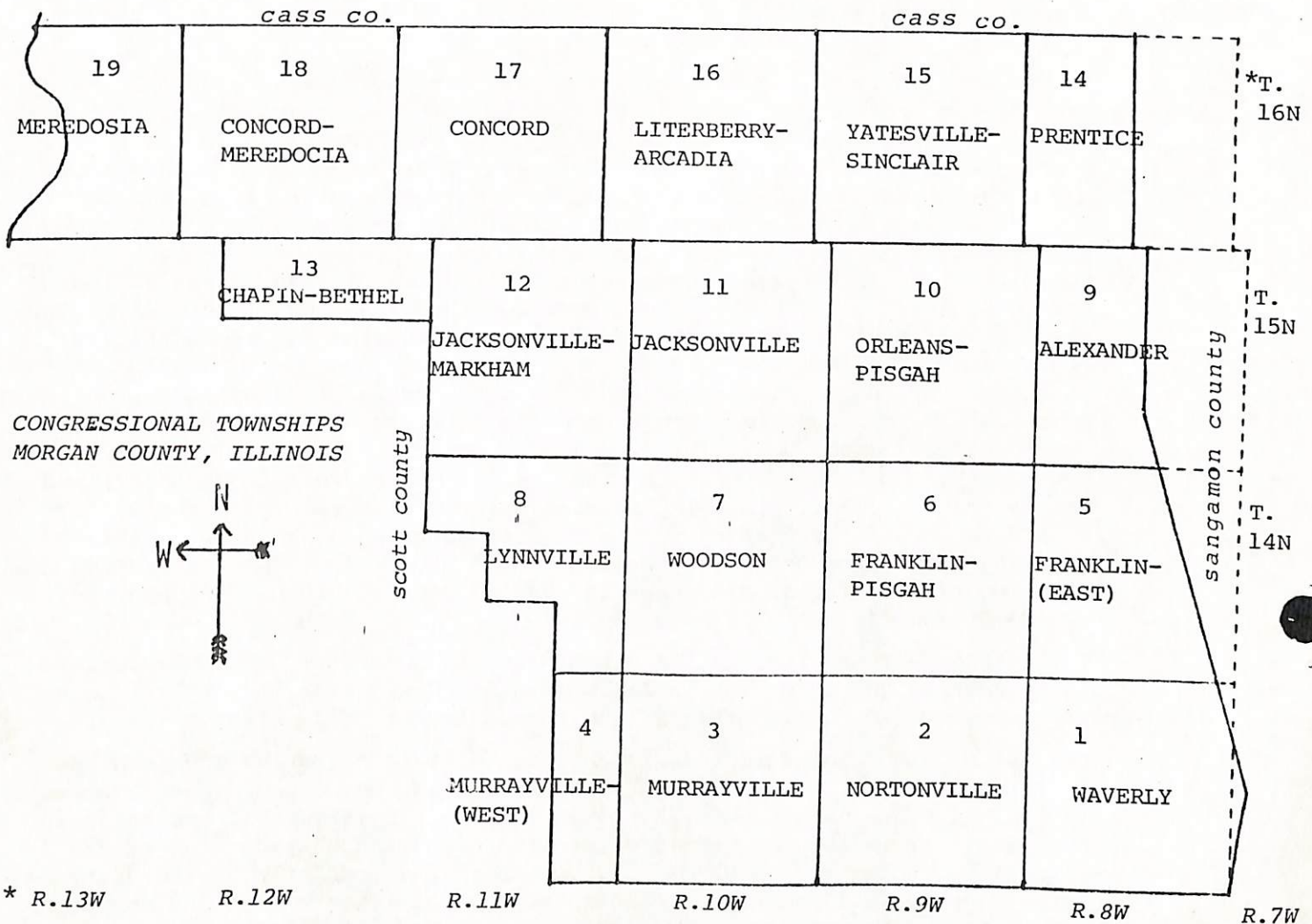

PLAT MAP# INDEX OF CONGRESSIONAL TOWNSHIPS IN MORGAN COUNTY, ILLINOIS
with Town(s) in area, or adjacent to

| Plat # | TOWNSHIP NAME | *T. | N | R. | W | PM | Plat# | TOWNSHIP NAME | *T. | N | R. | W | PM |
|--------|---------------------------|-----|---|----|---|----|-------|-------------------------------|-----|---|----|---|----|
| 1. | WAVERLY | 13 | | 8 | 3 | | 11. | JACKSONVILLE | 15 | | 10 | 3 | |
| 2. | NORTONVILLE | 13 | | 9 | 3 | | 12. | " -MARKHAM | 15 | | 11 | 3 | |
| 3. | MURRAYVILLE | 13 | | 10 | 3 | | 13. | CHAPIN-BETHEL | 15 | | 12 | 3 | |
| 4. | " (WEST). | 13 | | 11 | 3 | | 14. | PRENTICE | 16 | | 8 | 3 | |
| 5. | FRANKLIN-(EAST) | 14 | | 8 | 3 | | 15. | YATESVILLE-SINCLAIR | 16 | | 9 | 3 | |
| 6. | " -PISGAH | 14 | | 9 | 3 | | 16. | LITERBERRY-ARCADIA | 16 | | 10 | 3 | |
| 7. | WOODSON | 14 | | 10 | 3 | | 17. | CONCORD | 16 | | 11 | 3 | |
| 8. | LYNNVILLE | 14 | | 11 | 3 | | 18. | " -MEREDOSIA | 16 | | 12 | 3 | |
| 9. | ALEXANDER | 15 | | 8 | 3 | | 19. | MEREDOSIA | 16 | | 13 | 3 | |
| 10. | ORLEANS-ARNOLD | 15 | | 9 | 3 | | | | | | | | |

*Townships are NORTH of Base Line *Ranges are WEST of Third Principal Meridian

Also, Section, Township & Range, & Plat Map Numbers
as to cemetery locations in Morgan County, Illinois.

| CEMETERIES & ALTERNATE NAMES | Vol. III Pages | Map# | Sec-TN-RW* |
|--|----------------|------|------------|
| ALLIS, Bethel, Old West, or Watson | 4,5 | 1 | 11-13--8 |
| ANGEL | 1 | 17 | 23-16-11 |
| ANGELO, Buckhorn, or Lewis | 95-110 | 7 | 18-14-10 |
| BANE | 2 | 12 | 28-15-11 |
| BARROWS, Or Craig | 12 | 7 | 13-14-10 |
| BEAUCHAMP | 3 | 18 | 19-16-12 |
| BETHEL M.E., Allis, Old West, or Watson | 4,5 | 1 | 11-13--8 |
| BUCKHORN, Angelo or Lewis | 95-110 | 7 | 18-14-10 |
| BURRUS | 7,8 | 18 | 2-16-12 |
| CARTER | 8A | 8 | 8-14-11 |
| CERES, (in Greene County) | 9 | -- | 4-12-10 |
| COLLINS, (in Scott County) | 10 | -- | — — — |
| CRAIG, (no trace) | 11 | 8 | 13-14-11 |
| CRAIG, or Barrows (near Oak Ridge School) | 12 | 7 | 13-14-10 |
| CRAWFORD-HATFIELD | 13 | 13 | 15-15-12 |
| DAVIS | 14-20 | 6 | 31-14--9 |
| DeGROOT-JENNINGS (stones in a Jacksonville alley) | 21 | | |
| HARTLAND, Or Hart's Prairie | 22-27 | 2 | 34-13--9 |
| HEBRON (Methodist) | 28-48 | 15 | 28-16--9 |
| HEFFNER | 49,50 | 18 | 2-16-12 |
| HODGES, or Muntman, or Sycamore Grove | 150 | 18 | 30-16-12 |
| HOUSTON | 51 | 18 | 1-16-12 |
| IMMANUEL LUTHERAN CHURCH CEMETERY, or Lydda (in Cass County) | 111 | -- | 25-17-13 |
| JACKSONVILLE, Or Jacksonville East | 52-89 | | |
| JAMERSON (544 Brooklyn Avenue, Jacksonville) | 90 | | |
| JORDANVILLE CHURCHYARD | 91 | 15 | 10-16--9 |
| KIRKMAN-WYATT | 92 | 11 | 35-15-10 |
| LEEPER | 93,94 | 11 | 28-15-10 |
| LEWIS, Angelo, or Buckhorn | 95,110 | 7 | 18-14-10 |
| LUKEN, or Bethlehem | 6 | 5 | 9-14--8 |
| LYDDA, or Immanuel Lutheran Church (in Cass County) | 111 | -- | 25-17-13 |
| MORGAN CITY | 112,113 | 13 | 9-15-12 |

Also, Section, Township & Range, & Plat Map Numbers
 as to cemetery locations in Morgan County, Illinois

| CEMETERIES & ALTERNATE NAMES | Pages | Map# | Sec-TN-RW* |
|---|---------|------|------------|
| MORRIS CHAPEL, also called Mt. Vernon or Smith | 114-119 | 17 | 16-16-11 |
| MORRISON, or Union Grave Yard | 159 | 18 | 13-16-12 |
| Mt. VERNON, also Morris Chapel, or Smith | 114-119 | 17 | 16-16-11 |
| MUDDY, New Hope, or Old Muddy | 121-130 | 1 | 19-13--8 |
| MUNTMAN, Hodges, or Sycamore Grove | 150 | 18 | 30-16-12 |
| NERGENAH | 120 | 18 | 20-16-12 |
| NEW HOPE, also Muddy, or Old Muddy | 121-130 | 1 | 19-13--8 |
| NEWMAN | 131-137 | 18 | 3-16-12 |
| OLD WEST, also Allis, Bethel M.E., Watson, Waverly West | 4,5 | 1 | 11-13--8 |
| PARKS-ROBINSON (in Scott County) | 138 | -- | 23-15-12 |
| PITNER (not a cemetery, a stone found in Jacksonville) | 139 | | |
| PROVIDENCE | 140-146 | 2 | 4-13--9 |
| RANDELL | 147 | 6 | 32-14--9 |
| ROUTT | 148 | 7 | 24-14-10 |
| SIBERT | 149,150 | 18 | 17-16-12 |
| SMITH | 114-119 | 17 | 16-16-11 |
| SMITH, William Smith | 151,152 | 17 | 23-16-11 |
| SYCAMORE GROVE, also Hodges, or Muntman | 150 | 18 | 30-16-12 |
| TURNER | 153-158 | 1 | 21-13--8 |
| UNION, also Morrison, or Union Grave Yard | 159 | 18 | 13-16-12 |
| WATSON, also Allis, Bethel M.E., Old West, Waverly West | 4,5 | 1 | 11-13--8 |
| WEEKS, or Bryant (Hannah) | 160 | 18 | 19-16-12 |
| WILKINSON | 161 | 8 | 13-14-11 |

[The plat map of Morgan County has 19 congressional townships, which do not coincide with the political precincts, nor administrative road districts.]

* Pages are in Vol. III, Dalton-Long Guide to Cemeteries of Morgan County, Illinois.
 Sec = Section, Township __ North of Base Line, Range __ West of the 3rd Principal Meridian

Compiled and Edited by Robert Wayne Dalton and Dorothy Jean Dalton Long, 1978.

Index compiled by Edna McMahan Secrest, typed by Florence Hutchison, November 1979. * indicates a soldier.

This index, unlike Volume II, covers ONLY burials.

| Name of Deceased | Page | Name of Deceased | Page | Name of Deceased | Page |
|-------------------|------|------------------------|------|------------------------|------|
| ACRE, Calvin | 28 | ANGELO, Ellen | 106 | *AYERS, Wm. C. | 53 |
| Eldon | " | Girtam | " | BAILEY, Abraham R. | 49 |
| Sarah | " | Henry | " | Eliz. | " |
| ADAMS, Frank | 53 | ANGELO, Eliz. | 105 | Phebe E. | 50 |
| Lawrence W. | 28 | James | " | BAKER, James, Sr. | 53 |
| Marie | " | Lucy | " | Laura A. | " |
| Mary E. | " | ANGELO, Hiram T. | 107 | Sally | " |
| AGEE, William | 121 | Isom | " | BAKER, John S. | 28 |
| AINSWORTH, Mat | 53 | Laura I. | " | L. Clair | " |
| AKERS, Eliz. | " | Lavinia | " | Laura | " |
| ALFORD, Mary E.S. | 140 | Mary J. | " | BANE, George | 2 |
| Sarah E. | " | Rebecca | " | Mary | " |
| Wm. D. | " | Sidney & 2 | " | BANTA, Lula Maud | 53 |
| ALLEN, Harvey B. | 53 | little sisters | " | Wm. W. | " |
| Rhoda Ann | " | Thomas B. | " | BARBER, Ann | " |
| Washington | " | Troy | " | Geo. | " |
| Jesse | 93 | * William H. | 96 | BARKER, Sarah A. | 4 |
| Sophia | " | ANGELLO, Andrew J. | 107 | *BARNETT, W. J. | 53 |
| ALLIS, Ann C. | 4 | ANGELOW, Benj. | " | BARNHART, Susannah | 156 |
| Anne | " | Harriot S. | " | BARRETT, Martha A. | 140 |
| Caroline | " | Lenard | " | BARROWS, Emma C. | 53 |
| Fredric W. | " | Martha E. | " | BARSNES, Irma E. | 28 |
| Louisa | " | Nancy Lullah | " | BARTON, Martha A. | 53 |
| * Richard Tonges | " | ARMSTRONG, Ella A. | 53 | Ruth | " |
| S.G.M. | " | ASHBAUGH, Christopher | 121 | Ruth A. | " |
| Wm. F. | " | Elizabeth | " | BATEMAN, — | 54 |
| ALLISON, Eliz. H. | 28 | Eliza Jane | 125 | Josephus | " |
| ANDERSON, Carl S. | 140 | ATER, Lula L. | 114 | Matilda | " |
| Eve E. | " | ATKINSON, — | 53 | Wm. C. | " |
| * Edwin H. | 53 | John W. | " | Edith | 140 |
| Lucy J. | " | Phineous W. | " | Inf/Chas. & Nora | 121 |
| Mary | " | Sarah | " | Myrtle May | " |
| ANGEL, Eliz. | 1 | Inf/W.S. & S. | " | Pearl Fay | " |
| George | " | AUSTIF, Bertha A. | 121 | Wanda | " |
| Inf/J. & S. | " | Fred | " | BEACH, Jane Waterhouse | 28 |
| Thomas | " | Kathlene | " | John | " |
| ANGELO, Alice W. | 95 | Lily Mae | " | Robert | " |
| Benjamin | " | AUSTIFF, Inf/E. & L.M. | 129 | BEAL, Lee Alton | " |
| Eliz. | " | AUSTIN, Alva | 22 | Mary Anna | " |
| Inf/J.W. & S.L.J | " | Bertie | " | BEALMEAR, Sarah F. | " |
| John | " | Effie M. | " | W. E. | " |
| Mary J. | " | John M. | " | BEAUCHAMP, (male) | 3 |
| ANGELO, Albert B. | 106 | Martha | " | Ada Nora | " |
| Benjamin M. | " | Atwell A. | 53 | Albert | " |
| Christene | " | Daniel | " | BEDWELL, Metta W. | 54 |
| Daniel F. | " | Mrs. Joanna | 121 | BENNETT, Ann | " |
| * David J. | " | Agnes | 140 | Betsy C. | 131 |
| Elizabeth | " | John H. | " | | |

| Name of Deceased | Page | Name of deceased | Page | Name of deceased | Page |
|-----------------------|------------|--------------------|--------|-----------------------|--------|
| *BENNETT, James | 132 | BLODGETT, Joseph | 54 | BRECKON, Wm.Jordan | 55 |
| BERGFIELD, Maria | 28 | Lucy Maria | " | BREIDENSTEIN, Susanna | 3 |
| BERRY, Benj. | 54 | *BLUE, Thomas | 54 | BRIDGEMAN, Hannah | 114 |
| Eliz. | " | BOEN, Wm. A. | " | Hezekiah | " |
| Garrison W. | " | Wm. H. | " | Isaac | " |
| Benj. Harrison | 121 | *BOET, Sylvester | " | Jane | " |
| Hubert Marion | " | BOLES, Josephine | 131 | Jane B. | " |
| BERRY, Brookie | 28 | Lione | " | Nancy | " |
| Carrie | " | Wm. | " | BRIDGMAN, Franklin | 114 |
| Chloe | " | BOOKING, Eliz. | 40 | Rhoda | " |
| Della | " | *BORING, W.L. | 29 | Hezekiah | " |
| Jane | " | BOURN, Ann | 54 | John C. | " |
| M.S. | " | Mary | " | Lucy | " |
| Stella Marie | " | Sarah J. | " | Wm. M. | " |
| Wm. M. | " | Inf son & dau T.&M | " | BRISTON, Jane | 55 |
| Cyrus | " | Thomas | 54 | BROADWAY, John A. | " |
| BERRYMAN, Charley G. | 23 | Thomas J. | " | BROMLEY, John | 14 |
| Clara Lee | " | BOSTON, Mary D. | 29 | BROOKS, Josie M. | 29 |
| Hannah Peters | " | BOYCE, Catherine | 54 | Spencer | " |
| Henry A. | " | Henry W. | " | son & dau T.&C.E. | 29 |
| 2 Infs/L.O.& A. | " | Margaret | " | BROWN, Sarah | 14 |
| Mary J. | " | Wm. | " | Abbey | 29 |
| Tiltha A. | " | BOYCE, Eliza W. | 45 | Andrew | " |
| Inf/W.A.& H. | " | Jas. Harvey | 29 | Chas. L. | 29, 30 |
| Wm. Anderson | 22 | Noah W. | " | Elizabeth | 29, 55 |
| Inf/H.W.& O. | 27 | Thos. T. | " | Eliz. J. | " |
| BERTRAM, Josia | 14 | Mary S. | 41 | Eliz. Margaret | " |
| BINGHAM, Rachel | 29 | BOYER, Eliza Ann | 130 | Hazel L. | " |
| Samuel | " | Martha E. | 54 | Jesse P. | " |
| BINGMAN, Addie | 34 | Wm. H. | " | John L. | 29, 30 |
| Alabama | 29 | BOYCE, Wm. T. | " | Liza Ann | " |
| Alice G. | " | BRADBURY, Edwin | " | Logan | " |
| E.C. | " | Henry | " | Lucretia | " |
| James | " | Theodosia | " | Margaret | " |
| John W. | " | BRADSHAW, Fanny | " | * Noah T. | " |
| Mary Eliz. | 29, 47, 48 | John | " | Payton | " |
| Mollie P. | 29 | BRANER, Geo. W. | 114 | Tyre | " |
| Stephen E. | " | BRANSON, Kate | 55 | BROWN, Andrew J. | 30 |
| Effie | 46 | BRECKEN, Emma L. | 29 | Annie | " |
| Mary Ellen | 47 | James W. | " | B.F. | " |
| BIRCH, Francis M. | 121 | BRECKON, Catharine | 29 | Inf dau/C.L.&G.L. | " |
| BIRDSELL, Pearl E. | 140 | Effie Lee P. | " | Chas. | " |
| Wm. W. | " | Elizabeth S. | " | Charley L. | " |
| BLAND, 2 Inf daus/ | " | Family | " | Daniel D. | " |
| Wesley E.& V.M. | " | Helen Louise | " | Della | " |
| Sarah | 54 | Jos. Vickerman | " | Ellen | " |
| BLANDFORD, Ann | 131 | Vickerman | " | Geo. F. | " |
| BLANEY, — | 153 | Wm. | " | * Jas. R. | " |
| Mary C. | " | BRECKON, Charlotte | 31, 75 | Latitia | " |
| BLODGETT, Rev. Harvey | 54 | | | Logan J. | " |

| Name of Deceased | Page | Name of Deceased | Page | Name of Deceased | Page |
|---------------------|--------|----------------------|------|---------------------|------|
| BROWN, Lurain | 30 | BURRUS, Eliz. M. | 3 | CARTER, John | 8A |
| Lyla | " | Alice Ann | 7 | Mary A. | " |
| Mary Ann | " | Thos. | " | Nancy | " |
| Minnie E. | " | Benj. Martin | 8 | CARTER, Alfred | 56 |
| Roseline | " | Eliza | " | Anna | " |
| Zerelda | " | Ellen J. | " | John | " |
| BROWN, Abbie | 39 | Elmer | " | John W. | " |
| Catherine | 55 | Emma L. | " | Julia | " |
| Clarissa | " | Harry Andrew | " | Martha | " |
| Eliza J. | " | Nancy | " | * Robert | " |
| Mary Mounts | " | Nancy J. | " | Sarah | " |
| BROWN, Jane B. | 114 | Paul C. | " | CARTWRIGHT, Maria | 87 |
| Dora C. | 121 | Thos. J. | " | CARVER, Jos.Chapman | 56 |
| Frederica | " | Wm. | " | CASSEL, Ann M. | " |
| Theodore | " | Wm. H. | " | Benj. | " |
| Viola May | " | BURRUS, Eliz. E. | 131 | Geo. M. | " |
| Polly | 141 | Leonard | " | * Harrison | " |
| BROWN, Mary | 35,153 | M. Agolda | " | John T. | " |
| J. B. | 153 | Mary Alex | " | Maria E. | " |
| Julia | " | Wm. D. | " | Mary E. | " |
| Louella F. | " | Lovina (2) | 132 | Samuel | " |
| Mary A. | " | Martha M. | " | CATHERWOOD, Kate | 56 |
| Nancy O. | " | Nancy Rebecca | " | Susan L. | " |
| Samuel | " | Susan Cath. | " | CAULKINS, Samuel | " |
| BRUMBACK, Mattie A. | 30 | BUSHNELL, Clide | 23 | CAVANAUGH, Bridget | " |
| * Rollin | " | BUSHNEL, Hannah | 160 | CAVENDER, Lem R. | " |
| BRYAN, Walter | 121 | BUT ER, John W.MD | 55 | Priscilla | " |
| BRYANT, Alpheus | 160 | BUTCHER, Jas. | " | CHADWICK, Charlotte | 31 |
| Hannah | " | Sarah | 132 | Emma Cath. | " |
| Minnie | 121 | BUTLER, Martha F. | 23 | John | " |
| Walter | " | Susan | " | Frances | " |
| Sarah M. | 122 | CABNES, Wm. B. | 55 | Mary | " |
| BUCK, Marion | " | CADY, Dewit C. | " | Wm. | " |
| BUCKINGHAM, Eliza | 55 | CAIN, Elisha E. | " | CHALLANS, Eliz. | 97 |
| Eliza Ann | " | CALLAWAY, Sue A. | " | Rebecca | " |
| Margaret | " | CANNON, Mahalah A. | " | CHANEY, Rosela | 122 |
| Mary E. | " | CARNES, Wm. B. | " | CHAPIN, Horace | 4 |
| Nathan | " | CARPENTER, Amanda | 30 | * John Orr | " |
| * J. W. | " | Emma W. | " | Mrs. Sarah | 5 |
| John W. | " | Herbert B. | " | CHAPPELL, Chas. M. | 56 |
| BUCKLEY, Ann | 107 | * Nathan J. | " | Eliza | " |
| BULL, Buell L. | 140 | Spencer | " | Frank | " |
| Ruby L. | " | CARPENTER, Cyrus C. | 31 | CHAUDOIN, Clara V. | 140 |
| BURMEISTER, Carline | 30 | Inf/Albert | " | Earl Dewey | " |
| Frank F.C. | " | Montezuma | " | CHERRY, Caroline | 56 |
| Mary A. | " | Venetta | 34 | CHESTNEY, A. | " |
| Minnie | " | CARSON, Catharine C. | 55 | CHINN, Lucy Jane | " |
| Wm. | " | T.M. | " | Mary Mildred | " |
| BURRES, Martha C. | 131 | * Thomas | " | *CHURCH, Thos. | 56 |
| BURRIS, Albert | 7 | Wm. M. | " | CLARK, Alberta | 31 |

| Name of Deceased | Page | Name of Deceased | Page | Name of Deceased | Page |
|---------------------|-------|-------------------|------|----------------------|------|
| CLARK, Everett | 31 | CRAIG, Ann | 12 | CROUSE, Leslie | 32 |
| CLARK, Cath. Jane | 56 | Ann E. | " | Lilly L. | " |
| Mary Olive | " | Anna E. | " | Louisa C. | " |
| Mary | 57 | Mrs. E.A. | " | Nellie E. | " |
| CLARK, Chriscilda | 132 | Edward | " | Newton | " |
| Elizabeth | 151 | Eliza J. | " | Nancy J. | 34 |
| CLAY, Eliz. | 57,67 | Hugh | " | *CRUTCHFIELD, Sam'l. | 57 |
| COBB, Eliza | 57 | James | " | CURTAIN, Jas. | " |
| Harriet | " | James G. | " | CURTIS, Inf/H.& O. | 9 |
| Marie | " | Laura | " | CUTTLE, Jane | 78 |
| COCKRAN, Mary Alex | 131 | Lena | " | DaCAMERA, Ann | 57 |
| COE, Lovet | 57 | Mable | " | John | " |
| COFFIN, Chas. | 8 | Maria S. | " | DAGAMA, Elvira | " |
| COFFMAN, Gabrielle | 57 | Mary A. | " | John C. | 58 |
| COKER, Dennis | 31 | Olive Anna Bell | " | John V. | " |
| John | " | CRAIG, Geo. | 32 | DaGAMEGA, Anna | " |
| Marguerite | " | Rebecca | " | John | " |
| Sally | " | CRAIG, Eliz. | 57 | DAGGETT, Anne | 36 |
| COKER, Nancy E. | 32 | Henrietta | " | DAHLHOUSEN, WillieA. | 58 |
| Wm. W. | " | Larkin H. | " | DALE, Polly | 93 |
| COLE, Geo. W. | 140 | Martha Ann | " | DALTON, Martha | 58 |
| John | " | Mary S. | " | Wm. (2) | " |
| COLLEY, John H. | 32 | Morvie | " | DALY, Ellen | " |
| COLLINS, Almyra | 10 | Olive | " | *DAMON, Alfred A. | " |
| Anson | " | CRAIN, Hiram | " | J.B. | " |
| CONN, Amelia Sophia | 57 | James B. | " | Maria K. | " |
| Eunice | " | Jehu | " | DANIELS, Buker, Sr. | " |
| Samuel Wylie | " | John S. | " | Chas. H. (2) | " |
| COOK, Gerald Dean | 32 | Josie | " | Edward | " |
| COONS, Martha | " | Martha | " | Ellen Ethel | " |
| COOPER, Mary Eliz. | 47 | Silas | " | Ellen R. | " |
| Walker | 32 | Tirzah | " | Maggie | " |
| CORCORAN, P.H. | 132 | Wm. M. | " | Margaret | " |
| *CORE, Asbury B. | 57 | CRANE, Ella | 32 | Nancy W. | " |
| CORNELL, Fanny | " | Roxanna C. | " | Pearl N. | 132 |
| COULTER, Eugenia | " | CRAVEN, Eleanor | " | Veerin (2) | 58 |
| COWART, J.J. | " | Robt. L. | " | Virginia E. | " |
| COX, Eliz. T. | 57 | Virginia H. | " | DARLEY, Dawson | 14 |
| Inf/J.G.& R.J. | " | Wm. L. | " | Eliz. | " |
| Rebecca J. | " | Louisa | 34 | Sarah | " |
| COX, Emma C. (2) | 140 | CRAWFORD, David | 13 | Dawsie | 141 |
| Er. | " | Nancy J. | 149 | Geo. | " |
| Howard | " | olin | 122 | Laura | " |
| J. Wendell | " | CREAMER, David G. | 57 | Mildred F. | " |
| Leslie | " | G. C. | " | DaSILVA, Francisco | 58 |
| Lloyd R. | " | CRISWELL, Bradley | 23 | DAUB, Conrad | 115 |
| Minnie A. | " | Hannah | " | DAUP, John W. | " |
| Robert | " | Wm. Nichols | 140 | DAVENPORT, Ira | 58 |
| Russell | " | CROOKS, Robt. | 57 | Nancy | " |
| COY, Mary E. | 132 | CROUSE, Jas. | 32 | Patsey | " |

| Name of Deceased | Page | Name of Deceased | Page | Name of Deceased | Page |
|----------------------|------|----------------------|------|----------------------|------|
| DAVENPORT, Anzaletta | 59 | DAWSON, Edward L. | 60 | DODSWORTH, Ann | 35 |
| Braxton | " | Nancy J. | " | Jane | 38 |
| David S. | " | Olive L. | " | Alice | 47 |
| Henry Clay | " | DEALY, (male) | " | DONALD, Wm. | 97 |
| Ira | " | DEATHERAGE, Lee | 122 | DOOLIN, Inf/W.& M. | 107 |
| Ira W. | " | Josephus | 60 | DOUEGHY, Amelia A. | 60 |
| Katherine | " | Mary | " | DOYLE, Cath. Murray | " |
| Mariah | " | DEATON, Alice E. | 32 | Jas. | " |
| Mary | " | DECKER, John | 115 | Jos. | " |
| Mary Ruark | " | DEETER, Eliza | 153 | DRESSOR, Mary | " |
| Minerva | " | DeFRATES, Antonia | 60 | DRINKWATER, Addie M. | 132 |
| Nancy Ann | " | * Jos. | " | Cath. | " |
| DAVIDSON, Alfred | " | DeFRATTES, Joseph | " | Chas. | " |
| Chas. E. | 141 | *DeFRATUS, Antone | " | Isaac | " |
| Edward E. | " | DeGROOT, Louisa | 21 | Rev. Jacob | 133 |
| Inf son/W.F. | " | DENNIS, Gabriel H. | 4 | Rebecca | " |
| DAVIES, Edith H.S. | 32 | Lucinda | " | Sarah | " |
| DAVIS, Daniel B. | 14 | Malinda J. | " | DUCKWORTH, Dorcas | 15 |
| Joseph | " | Beatrice Belle | 122 | Harriet Ann | 107 |
| Martha A. | " | James S. | " | Mary L. | " |
| Thos. J. | " | Levi W. | " | DUFFER, Ada Jane | 33 |
| Wm. R. | 15 | Nancy A. | " | Minerva J. | " |
| DAVIS, Eliz. | 32 | *DeONELLUS, Jno | 60 | Sarah J. | " |
| Flora B. | 43 | DIENER, Chas. | " | DUFNER, Clinton | " |
| Nancy | 47 | DILLON, Eleander B. | " | DUGGER, A. | 23 |
| DAVIS, A.G. | 59 | DIMMITT, Emma | 44 | Dred | " |
| Alice | " | Rev. Jas. P. | 32 | DUNAVAN, Jane D. | 60 |
| Chas. C. | " | Sarah L. | " | Jessie | " |
| Fanny | " | DIXON, Josia | 15 | Jesse M. | 33 |
| Frank M. | " | * Theodore | " | Julia Ann | " |
| Geo. P. | " | DOBSON, Geo. | 60 | DUNBACK, Caselia | 60 |
| * Jacob | " | Larkin H. | " | Chas. H. | " |
| James E. | " | Susan | " | DUNLOP, Jas. | " |
| John (2) | " | Daniel M. | 97 | DUNN, Mahala J. | 133 |
| John Wm. | " | Martha J. | " | Nancy | 60 |
| Lydia | " | Richard | " | DUNSTON, Esther | 15 |
| Martin | " | Thomas | " | Geo. | " |
| Mary Eliz. | " | DODGE, Inf/J.V.&A.A. | 60 | Wm. | " |
| Mary Jane | " | Mary Alice | " | DUPUY, Frank | 60 |
| Sarah Ann | " | DODSWORTH, Sarah | 14 | DUSTIN, Lucretia | 61 |
| Wm. | " | L.D. | 15 | Sarah | " |
| DAVIS, Lucinda | 74 | Ellen | 30 | Stephen | 60 |
| Eliz. | 149 | DODSWORTH, Alice F. | 32 | DWYER, Mary A. | 122 |
| W. | " | Catharine | " | DYER, Harry | 115 |
| DAWSON, Louisa | 32 | Edward A. | " | Williametta | 33 |
| Bernard | 59 | Hannah | " | | |
| Eliz. (2) | " | Richard (2) | " | | |
| * Jno. | " | DODSWORTH, Frances | 33 | | |
| * John (Rev. War) | " | John | " | | |
| * Josiah | " | Margaret Lucile | " | | |
| *DAWSON, Alfred A. | 60 | Stephen | " | | |
| Bailey L. | " | Thos. | " | | |

To determine a cemetery
name for a given burial,
see "List of Cemeteries,
With Page Numbers . . ."
For location in County,
see accompanying map.

| Name of Deceased | Page | Name of Deceased | Page | Name of Deceased | Page |
|----------------------|------|------------------------|------|--------------------|------|
| EADES, Nancy | 33 | EVENS, Elijah | 61 | FLINN, Frank, Jr. | 34 |
| *EADS, John T. | " | Inf dau/Elijah | " | Josiah | 33 |
| Sara C. | " | Nancy | " | FOLEY, Catherine | 62 |
| EBBEY, Geo. | 141 | EWING, Belle | " | FORD, Hettie | " |
| Helen | " | Father & Mother | " | Malinda | " |
| Nettie | " | Hester | " | Mary E. | " |
| ECHOLS, Fannie | 61 | John M. | " | Thos. (2) | " |
| EDGERTON, Harriet | " | Willie | " | Tommie | " |
| Henry Clay | " | FANNING, And. J. (2) | 15 | FORDYCE, M. Dorson | " |
| Urbane | " | Clara M. | " | FOREMAN, Anderson | " |
| EDMONDSON, Willie H. | " | Geo., Sr. | " | Polly | " |
| EDWARDS, Oma Lyons | 122 | Jacob | " | FORTNEY, Geo. S. | " |
| ELDRIDGE, Martha M. | 129 | * Lafayette | 16 | FOSTER, Ella | 32 |
| Ruth Aleen | 122 | M.M. | " | James M. | 33 |
| ELGIN, Mary | 33 | Mary | " | Mary A. | " |
| Sallie | " | Mary C. | " | Lillie | 34 |
| ELLINGTON, Becca J. | 15 | Sarah B. | " | Richard | " |
| John J. | " | FANNING, Barbara A. | 18 | FOSTER, Ollie | 40 |
| ELLIOTT, Olive Ann | 61 | Eliz. Ellen | 23 | Melissa | 43 |
| Sarah J. | 118 | Robt. D. | " | Pleasant A. | 47 |
| ELLSON, Margaret H. | 61 | FANNING, Edgar | 24 | FOSTER, John | 62 |
| ELMORE, Marion R. | 97 | Johney | " | Lorendia | " |
| ELSOME, Ann | 33 | Ollie | " | Sarah Frances | " |
| Chas. M. | " | Ralph P. | " | FOSTER, Frank R. | 122 |
| Geo. | " | G. Raymond | " | Freddie C. | " |
| EMERICK, Martha | 61 | Sallie F. | " | Willie R. | " |
| EMERY, Helen Merle | 122 | FANNING, Cora Lee | 27 | Inf/J. & E. | 141 |
| Susan E. | " | Chas. | 141 | FOUNTAIN, Amy | 126 |
| EMMERSON, Irvin T. | 33 | Eliz. | " | FOX, Louisa C. | 32 |
| Margaret A. | " | Frank F. | " | Addie | 34 |
| Mary | " | James L. | " | Alexander T. | " |
| Richard W. | " | Joab M. | " | Cynthia Ellen | " |
| Thomas | " | Lucinda Ormsley | " | Daisy Dean | " |
| EMMIS, Hiram | 61 | Mildred | " | Eleanore E. | " |
| Sopha E. | " | Polly | " | Elisha | " |
| EMORY, Clark (Carl) | 136 | FARRELL, Inf/J.A. | 122 | Elisha E. | " |
| ENGLAND, Mary E. | 16 | FAY, Jas. A. | 61 | * Elisha T. | " |
| ENGLISH, John J. | 61 | Sarah C. | " | Enna | " |
| ERIXON, John | " | FEASTER, Alice | 32 | Eulalie E. | " |
| Rachel | " | FERNANDES, Mrs. Bertie | 33 | Jas. E. | " |
| ERVIN, Alexander | " | Mrs. Effie | " | Jos. A. | " |
| Ange | 133 | Mercianna | 61 | Laura E. | " |
| Libbie | 61 | Sebastiana | " | Louisa | " |
| EVANS, Chas. E. | 23 | FERREIRA, Joaquina | " | Martha J. | " |
| Margaret | " | FIELD, Louisa J. | 62 | Mary | " |
| Wm. M. | " | FILSON, Margaret H. | " | Mary Ann | " |
| EVANS, John W. | 61 | FINCH, John T. | 97 | Nancy J. | " |
| * W. C. | " | Sallie | " | Inf/Noah & Mary | " |
| EVANS, Amy | 141 | FISHER, Cornelius S. | 62 | Noah B. | " |
| Julia E. | 153 | FISK, Eveline | " | Noah Thos. | " |
| EVENS, Arden (2) | 61 | FLATFORD, Louise | 12 | Orpha | " |

| Page 7: INDEX: | | A Guide to Cemeteries of Morgan County, Illinois. Vol. III. Dalton & Long, 1978. Index covers only burials. *=soldier. | | | |
|---------------------|------|---|----------|----------------------------|------|
| Name of Deceased | Page | Name of Deceased | Page | Name of Deceased | Page |
| FOX, Sarah E. | 34 | GIBSON, Della | 141 | GRADY, Joseph Milton | 64 |
| Thos. | " | John M. | " | Laura | " |
| Thos. U. | " | Mary M. | " | Nellie F. | " |
| Wm. Leonard | " | Inf/R. & H. | " | Susan Eliz. | " |
| FOX, Emily Jane | 36 | GIBSON, Eliz. | 145 | GRANT, Jas. C. | 98 |
| Frances A. | 38 | GIDEON, E.S. | 133 | Mary E. | " |
| Daisy Jean | 40 | GIEKESON, Hugh | 63 | GRAVES, Amelia A.B. | 64 |
| FOX, Eva | 62 | GIGER, Chas. Wesley | 133 | Emily M. | " |
| Frederick A. | " | David | " | Henry M. Calla | " |
| Geo. W. | " | Eliz. | " | Wm. | " |
| Maria | " | Tillie McLain | " | GRAY, Dora E. | 24 |
| Sarah | " | * Wm. H. | " | James N. | " |
| FRENCH, ____ (male) | " | Willie | " | Samuel R. | " |
| Eliz. | " | GILKERSON, Hugh | 63 | GRAY, Emmer A. | 65 |
| Mary W. | " | GILLILAND, Emma | 133 | Geo. S. | " |
| Harriet | 68 | John E. | 137 | Sarah Jane | 64 |
| FRICKE, John Henry | 111 | GILMORE, Geo. F. | 63 | GREEN, Geo. C. | 35 |
| FRUIDE, Eliz. | 62 | Robt. A. | " | Jos. | " |
| FRY, Ann E. | " | Susannah M. | " | Lucretia E. | " |
| Edith | " | GISH, ____ | 1 | Mary Eliza | " |
| Leonard | " | James | 151 | GRIERSON, Albert | 65 |
| FRY, Chas. | 133 | GLEDHILL, Frances C. | 65 | Alice K. | " |
| Matilda | " | *GLENN, J. I. | 63 | Benj. H., Jr. | " |
| FULLER, Harvey C. | 62 | GOBLE, Jos. | 137 | Gen. Benj. Henry | " |
| Susannah Marg. | " | GOODALL, Blanchie | 34 | Ettie | " |
| Martha | 141 | Jane | 35 | Geo. M. | " |
| FUNK, Lettie May | 62 | Wm. | " | Louisa | " |
| Venetta | 34 | GOODELL, Jas. L. | 153 | Mary (2) | " |
| GABLE, Joseph | 133 | Walter | " | Robt. | " |
| GAILY, Ernest C. | 62 | GOODPASTURE, Abraham (2), | 115 | Robt. K. | " |
| Luella C. | " | Hannah | 115 | Steel | " |
| Lovie W. | 63 | Eliz. | 116, 151 | GRIFFIN, Miss Agnes | 35 |
| GALBRAITH, Jesse W. | " | Zannah H. | 151 | *GRIMSLEY, Abraham | 16 |
| Lucian B. | " | Susan M. | 152 | Fielding | " |
| Wm. | " | GOODRICK, Ailsie Jane | 63 | Mary C. | " |
| GALBRATH, Samuel | " | * J.M. | " | Susan | " |
| GALE, Dewit | " | Joel H. | " | GRIMSLEY, Jas. | 98 |
| *GARY, Jno E. | " | Julia B. | " | Jane | " |
| GASS, Lucy D. | " | Wm. R. | " | Louisa | " |
| GATLIN, Catherine | " | GOODRICK, Bert C. | 64 | Elija | 108 |
| GAULKINS, Samuel | " | Joel | " | Pheba J. | " |
| GEERS, Mary | " | Josie | " | *GROVES, Jacob | 122 |
| Wm. | " | Lizzie | " | * Joseph | 130 |
| GENRY, Amanda | 108 | Mary E. | " | GUNNELS, Mrs. Eliz. | 122 |
| James M. | 97 | Rachel Ann | " | GUY, Clara E. | 73 |
| Jane | 107 | Susan | " | Edwin H. | 65 |
| Mary Jane | " | GOFF, Mariah | 63 | Minerva Ruark | " |
| Wm. D. | 98 | GOTLIEB, Carl | 122 | Wm. C. | " |
| GERARD, Hattie A. | 153 | GRADY, Chas. E. | 64 | Willie L. | " |
| GEST, Catherine | 63 | Jas. Thaddeus | " | GUYNANE, Ellen | " |
| Isaiah | " | Jas. Theodore | " | "Nothing ventured, nothing | |
| Nathan | " | Jos. Henry | 34 | gained." | |
| Sarah (2) | " | | | | |

| Page 8: INDEX: | | A Guide to Cemeteries of Morgan County, Illinois. Vol. III. Dalton & Long, 1978. Index covers only burials. *=soldier. | | | |
|-------------------|------|---|-------|---------------------|-----------|
| Name of Deceased | Page | Name of Deceased | Page | Name of Deceased | Page |
| HACKETT, Geo. | 65 | HAMMOND, Minerva | 66 | HARRISON, Sarah D. | 35 |
| Sarah | " | Sarah H. | " | Wm. H. | " |
| HAHN, John | 16 | HANELINE, Cora Eliz. | 35 | HART, Anderson | 24 |
| HAIRGROVE, Pearl | 98 | Crit | " | Bessie May | " |
| Mary Jane Pitner | 65 | Elmer | " | Charles Wilborn | " |
| HALL, Geo. J. | 108 | Mary | " | Cora E. | " |
| Harriet | " | Nellie | " | David | 24,36,123 |
| Harris M. | 65 | *HANEY, Alden | 99 | Edgar A. | 24 |
| Lucille | " | HANN, John | 16 | James | " |
| Susannah | " | HANNING, Harriet | 35 | Jefferson | " |
| Mary Ann | 98 | Henry | " | John S. | " |
| HAM, Attas | 122 | John | " | Lucyan | " |
| Geo. A. | " | HANSHAW, Lewis B. | 24 | Mary O. | " |
| Martha Ellen | " | Wm. P. | " | Milley E. | " |
| Golmer | 123 | HAPPY, Charlie E. | 66 | Nettie Mansfield | " |
| Harriet | " | * J.E. | " | Sarah F. | " |
| Mamie Louie | " | Lou | " | T.J. | " |
| Maude | " | Louesa | " | Inf/T.J. & M.E. | " |
| Ora | " | Nancy | " | W. A. | " |
| Otis Earl | " | Sallie | " | HART, Eliz. | 25 |
| Stella L. | " | Wm. W. (2) | " | Malicy E. | " |
| *HAM, Geo | 130 | HARBER, Harvey Newton | 35 | Mary F. | " |
| Reba | 128 | Matilda E. | " | Sarah M. | " |
| HAMILTON, Agness | 65 | HARDIN, Chas. | 66 | * Wallace | " |
| Chas. V. | " | Charlie | " | Luiza Jane | 26 |
| Henry H. | " | Katy | " | HART, Aaron | 36 |
| David | 66 | Eliz. | 57,67 | Alice Hunter | " |
| Eliz. | " | Eliz. Clay | 67 | Ann | " |
| Geo. | " | * Col. John J. | " | Anne D. | " |
| Henry | " | HARKIN, Michael | " | Caroline M. | 36 |
| Isham A. | " | HARLEY, H. C. | 141 | Edwin T. | " |
| John | " | Louisa Newman | " | Emily Jane K. | " |
| John F. | " | HARPER, Francis | 67 | Francis | " |
| Lurinda | " | HARRIS, Ann C. | 35 | Matthew T. | " |
| Mary L. | " | Cynthia | " | HART | 123 |
| Owen | " | Dr. D. N. | " | G. Walsh | " |
| HAMM, Alexander | 128 | Geo. | " | Geo. W. | " |
| Chas | 24 | Dr. Geo. F. | " | Nancy Caroline | " |
| HAMMEL, Isaac R. | 98 | Henry H. | " | Sarah J. | " |
| Sarah | " | * Jesse | 67 | HART, Ellen Eliz. | 130 |
| Peter E. | 108 | Rebecca | " | Matthew | 35 |
| HAMMOND, Aaron | 66 | HARRISON, Alexander | " | Sarah Jane Rebecca | 155 |
| Inf/Aaron & Laura | " | Edith | 32 | HARTLEY, Martin | 67 |
| Ella | " | Ann | 35 | HARVEY, Elvis Lewis | 99 |
| Georgia E. | " | Martin | " | HASLER, Wm. | 16 |
| Homer A. | " | Daisy | " | HATCHER, Eliz. | 99 |
| Hulda H. | " | Geo. | " | * Richard | " |
| Lathrop | " | Herbert | " | Richard | 108 |
| Laura | " | John L. | " | HATFIELD, Emma | 67 |
| Mary S. | " | M.E. | " | Hannah | " |

SUCCESS? In one woman's opinion, "if you have tried to DO SOMETHING, and failed, you are vastly better off than if you had tried to do nothing and succeeded?" RIGHT?

| Name of Deceased | Page | Name of Deceased | Page | Name of Deceased | Page |
|------------------------|------|-------------------------|------|-------------------------|------|
| HATFIELD, Howell | 67 | HENRY, Harriet | 68 | HODGSON, Cora E. | 37 |
| Lewis | " | John W. | 108 | Eugene | " |
| Louis | " | Lucilla M. | " | Harry | " |
| Lydia | " | Gussie | 142 | Ida E. | " |
| Mathias | " | Lydia | " | Inf/J. & J.A. | " |
| Inf/R. & E.F. | 13 | Mary Eliz. | 48 | J. Raymond | " |
| HAUGH, Jas. | 67 | Richard | 100 | James C. | " |
| Patrick | " | HENSON, Inf/J.C. & R.M. | 16 | Lucinda | " |
| HAYDEN, Chas., Sr. | " | * M.C. | 130 | Jane Ann | " |
| Lizzie | 133 | HERIFORD, Cora | 36 | John | " |
| Wm. R. | 67 | HERRIN, Ethel Albert | 123 | Martha | " |
| HAYNES, Ada H. | 141 | HERRON, Sarah | 9 | Mark | " |
| Margaret Rees | " | HESLEP, Lucinda | 68 | Matthew | " |
| Wm. | " | Milton B. | " | Maycie A. | " |
| Wm. A. | " | Thos. | " | Rebecca | " |
| Mrs. Bessie L. | 146 | Wm. L. | " | Reecie M. | " |
| HEDENBERG, Edwin | 67 | HESS, Mrs. Melvina | 133 | Samuel W. | " |
| Emily J. | " | HESSER, Geo. | 68 | Wm. | " |
| James | " | HESTER, Eliza Ann | 100 | HOFFMAN, Robt. P. | 69 |
| Julia B. | " | HETTICK, Sarah M. | 25 | HOFFMEIER, Henry Ludwig | 111 |
| Sarah | " | HICKMAN, Ethel | 36 | HOFFMEYER, " " " | " |
| Peter | 68 | *HICKMAN, J. T. | 37 | HOGAN, Wm. | 133 |
| Susan M. | " | Susannah | " | HOLDING, Enna | 34 |
| Wm. B. | 67 | *HICKS, Isaac W. | 68 | HOLLAND, Martha N. | 69 |
| HEDGER, Joseph B. | 108 | HIGGINS, John | " | HOLLE, Hermann | " |
| HEFFNER, Joseph F. | 50 | HILLIGASS, Benj. | " | HOLLEY, Albert | " |
| Merrus A. | " | James M. | " | Chas. | " |
| Phebe F. | " | John | " | Edward | " |
| Phebe Inez | " | Rachel Ann | " | Eliz. | " |
| Wm. F. | " | HILLS, Annie | 123 | Emily | " |
| HEFLIN, Addie | 36 | HILTON, Eliz. T. | 153 | John H. | " |
| James | " | Wm. W. | " | HOLMES, Inf/Chas. | 25 |
| HEINEY, Eliz. | 99 | HINES, John | 68 | Ida | 156 |
| HEITZENREDER, Daisy E. | 151 | Mary | 126 | Hersel | 25 |
| HEMSTOCK, Wm. | 68 | Michael | 68 | Isaac | 37 |
| HENDERSON, Ben L. | " | HITCHCOCK, Lucius MD | 5 | Margret | " |
| * Chas. | " | HITT, Samuel | 68 | HOMES, Claborn | " |
| Chas. F. | " | Sarah | " | Jacob W. | " |
| Geo. A. | " | HOBBS, Bessie | 142 | John H. | 38 |
| Isaac | " | Chas. | 16 | Samuel | " |
| * J.P. | " | * L.W.B. | " | HOUDYSHELL, Eliz. | 133 |
| Martha Ann | " | Mrs. Lincoln | " | HOON, Amy B. | 142 |
| Mary E. | " | Mary E. | " | HOPE, Philadelphia | 69 |
| Nettie E. | " | Mary Ann | 20 | HOPPER, Albert T. | 38 |
| Samuel H. | " | Wm. | 17 | Ann | 33 |
| Smiley H. | " | HOBSON, Nancie E. | 123 | Dimmitt | 38 |
| * Thomas | " | HODGE, Jas. Wm. | 37 | Frances A. | " |
| Wm. H. | " | Susan | 44 | Geo. Taylor | " |
| Wesley | 108 | Susan S. | 37 | Gladys | " |
| Wm. | 133 | HODGSON, Ann | " | Hannah | " |
| HENRIQUES, Antonio | 68 | Annie | " | Jane P. | " |
| Maria | " | Christopher (2) | " | Jennie D. | " |

| Name of Deceased | Page | Name of Deceased | Page | Name of Deceased | Page |
|-----------------------|------|--------------------------|------|--------------------------|------|
| HOPPER, Julia Ann | 33 | JACKSON, Mary Louise | 69 | JONES, Hannah A. | 17 |
| Mrs. Martha | 38 | Thomas | " | * J.G. | " |
| Thomas | " | Wm. Fry | " | Jesse J. | " |
| HOUSTON, S.B. | 51 | JACOBUS, Eliz. | 142 | Margaret | " |
| *HOWARD, Alex | 69 | Wesley R. | " | Susan S. | " |
| Walter H. | 38 | JAMERSON, Inf/G.& A.M.90 | | Sarah J. | 19 |
| HOWE, Eliza | 69 | JAMES, Collon D. | 70 | Mary Ann | 20 |
| HOWERTON, Andrew, Sr. | " | Adam | 133 | Susan | 41 |
| Ebenezer | " | Chas. | " | Emily W. | 70 |
| HUBBS, Joseph | 38 | Mary | " | JONES, ____ (3) | 123 |
| HUCKSTEP, Sarah M. | 122 | Nancy | 134 | Ady A. | " |
| HUDLESON, John | 160 | Tenna | " | Albert R. | " |
| HUMPHREY, Benj. N. | 69 | John | " | Harriet M. | " |
| Wm. D. | " | JEFFRIES, Elvira | 5 | Thos. F. | " |
| *HUNT, W. E. | " | Elvira V. | " | JONES, Abigail | 142 |
| HUNTER, ____ | " | JENKINS, Arthur | 70 | Curtis J. | " |
| Colladon(?) | " | Emeline L. | " | Ella Susan | " |
| Eliz. | 38 | Laura C. | " | Mary | " |
| Emma D. | " | JENNEY, Lauretta H. | 5 | Jesse | " |
| Francis | " | JENNINGS, ____ | 70 | JORDAN, Lora A. | 70 |
| J. | 69 | Emily | 21 | Mary | 2 |
| Jane (2) | 38 | * Robt. | 70 | Wm. P. | 70 |
| Robt. | " | JENTRY, Jane | 107 | JORDEN, Jane | " |
| Sarah E. | 40 | JOHN, Edith M. | 27 | John R. | " |
| HURST, John | 69 | Mary A. | " | *JORDON, Richard | " |
| * Thomas | " | JOHNSON, Eliz. | 38 | JUMPER, Wm. | 39 |
| *HUTCHI(N)SON, Jas. | 17 | John Q. | 39 | KAISER, Erwin | 143 |
| HUTCHISON, Eletha | 5 | *JOHNSON, Chas. | 70 | *KAPPIAS, Louis | 70 |
| James | " | Eliz. Pyatt | " | KEEMER, Ira | " |
| James B. | " | Jeremiah | " | KEENER, Evaline | " |
| John | 153 | Myra C. | " | KELLEY, Daniel | 108 |
| Paulina | 5 | Richard | " | * J.G. | 70 |
| Susan | " | Wallace | " | KELLY, Martha J. | 97 |
| HYMES, Frank E. | 38 | Wm. G. | " | * Silas | 108 |
| Inf/F.E.& L.G. | " | JOHNSON, Amanda | 100 | KELTNER, Albert Eugene | 39 |
| Harold Eugene | " | Laura L. | " | KEMPF, Wilhelm Heinrich | 70 |
| Lucretia G.L. | " | Benj. F. | 101 | KENNEDY, Alice | 70 |
| INGALLS, Aghson | 69 | Jas. K. P. | " | Augustus W. | " |
| * Darius | " | Mary | " | Susie | " |
| J. | " | Nancy | " | KENNEY, James | 93 |
| Patsey | " | Zacarry T. | " | KENNIEBREW, Alonzo H. MD | 71 |
| INGRAM, Clara Mae | " | JOHNSON, Amanda | 108 | *KERR, James | 71 |
| Ed | " | Benj. F. | " | Jennett | " |
| Nellie | " | Benj. J. | " | Rebecca | " |
| IRONMONGER, Walter | " | Inf/3 D.& S. | " | Sarah Isabel | " |
| JACINTO, John | " | Jasper E. | " | Zerelda | " |
| Mary | " | Josephine Z. | " | *KERSHAW, Albert | " |
| JACKSON, Chas. E. | " | Geo. H. | 137 | Ellen | " |
| Daisy | 151 | Minnie | 142 | KETTLE, Ella L. | 142 |
| Eliz. | 106 | Oscar | " | John Wykes | " |
| Joseph | 69 | JOLLY, Mrs. Frank | 129 | KING, Cora | 5 |

| Page 11: INDEX: | | A Guide to Cemeteries of Morgan County, Illinois. Vol. III. Dalton & Long, 1978. Index covers only burials. *=soldier. | | | |
|------------------------|------|---|------|-------------------------|------|
| Name of Deceased | Page | Name of Deceased | Page | Name of Deceased | Page |
| KING, Eddie | 71 | LAZENBY, John | 101 | LONG, Sarah A. | 149 |
| Lizzie D. | " | LEAK, Chas. V. | 39 | Wm. A. | " |
| KIRBY, Ada O. | 142 | LEAKE, Inf/W.& J.B. | 142 | LONG, Lenora | 151 |
| Annie M. | " | LEEPER, ____ (2) | 93 | LONGWORTH, Eliz. | 39 |
| Emma J. | " | LEMM, Mary Ann | 116 | LOOMIS, Amy Alice | 72 |
| Fanny | " | LETTON, Matilda E. | 71 | Sarah E. | " |
| John | " | LEWIS, Annie M. | 39 | LOUGHARY, Easter | 8 |
| Wm. W. | " | Emberson | " | Inf/no par. | 117 |
| KISSINGER, Anna | 71 | Frank | " | LOVEKAMP, Inf/A& A.R. | 111 |
| KITTINGER, Bettie | 123 | Josephus | " | LUCE, Nellie Maude | 106 |
| KNELTE, Jas. | 48 | Linda Belle | " | LUDLUM, Andrew Todd | 72 |
| KNIFFLEY, Inf/V.& B.A. | 146 | Sara E. | " | Cornelius | " |
| KNOX, Louisa | 71 | Oda "Odie" | 47 | LYNN, James | 102 |
| Martha | " | LEWIS, Catherine | 101 | Lucinda | 108 |
| Wm. C. | " | Eleanor | " | LYONS, Albert Roscoe | 124 |
| KUNSCH, Rebecca T. | " | Eliza J. | " | Alva Raymon | " |
| LAIR, Anna | 130 | Laura C. | 102 | Lulu | " |
| Geo. | " | Milton N. | " | Ollie | " |
| Thos. Henry | " | Minnie | " | Roy | " |
| LAKE, Lindsay | 3 | Thos. Milton | 106 | LYONS, John W. | 128 |
| Liney | " | LEWIS, David | 108 | Wm. | 129 |
| Margaret A. | " | John Cyros | " | MacDOWELL, Lucy | 105 |
| Susan | " | Minnie | " | McAFEE, E.A. | 12 |
| LAMBERT, Rhoda L. | 153 | LINDLY, Mary | 1 | McALISTER, Bartlet | 102 |
| Richard Chris. | 71 | LINDSEY, Lucretia | 38 | Lucy J. | " |
| Thos. | " | Cassius M. | 39 | McALLISTER, David | " |
| LAMKULAR, Anna | 39 | Eliz. | " | Mattie E. | 134 |
| Thos. Henry | " | Laura E. | " | McCAFFERTY, Martha A. | 72 |
| Wm. Henry | " | Martha Lanham | " | McCALLISTER, Lucy M. | 103 |
| LAMKULER, Henry | " | N. W. | " | Sarah A. | " |
| Wilhelmina | " | Robt. L. | " | McCARTHY, Myrtle M. | 39 |
| LANDIS, Juliet Squieb | 71 | Sarah A. | " | McCLAIN, Mary (2) | 153 |
| LANDIS, Philip K. | 71 | Susan F. | " | McCORMICK, Amanda R. | 72 |
| LANHAM, Martha | 47 | LINDSEY, Martha | 47 | Luramah | " |
| Pleasant | 39 | LIONS, John W. | 124 | Maggie | " |
| LARGE, Bertie | 123 | LIPSCOMB, Dr. S.J. | 72 | Valentine S. | " |
| Charley Thos. | 153 | LITTON, Jas. | " | McCOY, Ada Jane | " |
| Geo. W. | 124 | Johnney | " | Ada Woodson | " |
| LAUGHARY, Charlotte | 116 | Mary | " | Rev. Asa Shinn | " |
| Laura D. | " | LOAR, Alex | " | Chas. Asa | " |
| LAWRENCE, Americus V. | 71 | Rev. C. (G?) | " | John Woodson | " |
| Lydia | " | Polly | " | Lydia C. | " |
| LAWS, Edgar S. | 124 | LONERGAN, T. | " | Nelley | 103 |
| Sallie L. | " | LONG, Archie Truman | 17 | McCRACKEN, Mary B. | 72 |
| LAWSON, Catharine | 71 | Edna Louise | " | McCULLOUGH, Mrs. | 93 |
| Emily J. | " | LONG, Comfort | 117 | McCURDY, Inf/R.L.& M.M. | 125 |
| Evelina | " | Hezekiah | " | McDONAL, Emma J. | 72 |
| Henrietta | " | * Jacob | " | McDOWD, Abbie | 39 |
| John | " | Mary | " | McGINNIS, Child | 93 |
| John L. | " | Melvina | " | McGOWAN, Eliz. Margaret | 29 |
| Julia A. | " | LONG, Anna | 149 | McHENRY, Ida | 39 |
| Wm. R. | " | Lewis B. | " | McINTIRE, Nancy J. | " |

| Name of Deceased | Page | Name of Deceased | Page | Name of Deceased | Page |
|-------------------------|------|-------------------------|------|----------------------|------|
| McKAY, Fielding | 72 | MANSFIELD, R. | 5 | MATTHEWS, Annie | 134 |
| Timiora | 93 | Nettie | 24 | Eliz. Jane | " |
| McKINLEY, Mary Jane | 39 | Albert | 25 | MAY, Rhoda | 115 |
| McLAIN, Inf/J.D. & M.A. | 134 | Everett E. | " | MAYES, Catherine | 134 |
| Maudie | 134 | Mary Emma | " | James C.T. | " |
| Ruth | " | Susan I. | " | James H. | " |
| Wilmer E. | " | MANSFIELD, Clara E. Guy | 73 | James R. | " |
| Eliz. | 154 | Geo. L. | 73 | Mary L. | " |
| Wm. | 153 | Edith | 124 | Susannah | " |
| McLEAN, Alice | 73 | Eliz. | 149 | MAYES, Bertha Lee | 153 |
| McLIN, Charity | 117 | Edward | 160 | John W. | " |
| McMAHON, Alice | 47 | Hannah | " | Lizzie Almira | " |
| Almira C. | 153 | MANSON, Ruth S. | 73 | Maude | " |
| Clement Loyd | 154 | MAPES, Susanna | " | Jessie Catherine | 156 |
| Ivan T. | " | MARCH, John R. | 40 | MEANS, Eliz. | 40 |
| John D. | " | MARIAN, Bertha May | 47 | John W. | " |
| Nancy M. | " | MARONEY, Margaret Ryan | 73 | Marion C. | " |
| McMURPHY, Wm. Howard | 47 | MARSHALL, Mary Caroline | 102 | Ollie | " |
| McNALL, Ella L. | 73 | Michael | 102 | Wm. Henry | " |
| McNAMARA, Mary | " | MARTIN, Callis M. | 36 | MEANS, Margaret | 74 |
| McNAY, Eliza | 127 | Chas. H. | 40 | MEDGER, Joseph B. | 103 |
| McNEAL, Archibald | 47 | Daisy Jean | " | MEDLOCK, Ella | 40 |
| Augustus A. | 39 | 2 Infs/J.L. & S.A.P. | 40 | MELICK, Abraham | 74 |
| Myrtle M. | " | James L. | 40 | Sarah | " |
| John A. | 40 | S. Louisa | " | MELTON, Ellen | 125 |
| Martha E. | " | Sarah A. | " | Wm. G. | " |
| Mary C. | " | Sarah E. | " | MENEZES, Charlotte | 74 |
| W.A. | " | Sarah L. | " | MENGEL, Peter | " |
| McNUTT, Jas. A. | 39 | Washington J.F. | " | Sarah Stephens | " |
| McWILLIAMS, Wm. | 73 | Wm. H. | " | * J. H. | " |
| MABERY, Mary Eliz. | " | Willie M. | " | MEREDITH, Hannah A. | 17 |
| MADDOX, Abby Ann | 40 | MARTIN, Nancy | 73 | John | 18 |
| Eliza | " | Folka | 124 | Lon | " |
| Ida M. | " | M.H. | " | MICHAELS, Theodore | 74 |
| J.R. | " | Mary | " | MICHENER, Eliza Jane | 125 |
| Jas. Oscar | 40 | Minnie | " | Wilson | " |
| Mary | " | Vena | " | MIDDLETON, Emeline | 74 |
| Samuel Edward | " | MARTIN, Child | 125 | Grayon F. | " |
| Sarah | " | Bertha | " | MILES, Lillie | 34 |
| Sarah M. | " | * Henry | " | MILLER, Hester M. | 40 |
| Inf/T.H. & A.A. | " | Lena | " | Ada | 74 |
| Thos. H. | " | MASNELL, Sarah Jane | 73 | Daniel | " |
| MAHLER, Antony | 73 | MASON, Lee | " | E.T. | " |
| MAHON, Francis | 36 | Miner | " | Emma F. | " |
| MAHONEY, Margaret Ryan | 73 | MATHERS, Anna | " | Henry | " |
| MALLICOAT, Addie | 117 | John | " | Lucinda Davis | " |
| Eliza O. | " | Juliett | " | Mary L. | " |
| J. | " | Eliza | 74 | Myrtle A. | " |
| Martha Jane | 119 | Wesley, Sr. | " | Sallie | " |
| MALONE, Bridget | 73 | MATHEW, Eliz. | 134 | Susan | " |
| MANN, Daniel | " | MATHEWS, Isaac | 149 | Willie F. | " |
| David | " | Susanah S. | " | | |

| Page 13: INDEX: | | A Guide to Cemeteries of Morgan County, Illinois. Vol. III. Dalton & Long, 1978. Index covers only burials. *=soldier. | | | |
|-----------------------|------|---|------|----------------------|------|
| Name of Deceased | Page | Name of Deceased | Page | Name of Deceased | Page |
| MILLER, Benjamin | 103 | MURPHY, Margaret | 75 | NORTHCUT, John | 108 |
| Dau/Daniel & C. | " | Nancy N. | 120 | NORTON, Ada | 74 |
| Deborah | " | MURRAY, Catharine | 60 | Myrtle A. | " |
| Edward | " | MUSH, Emma | 134 | NUNES, Justina V. | 5 |
| Harriet | " | MYERS, Bessie M. | 45 | Margaret | " |
| J. | " | Mildred Adele | 75 | Christian | 75 |
| Jacob | " | NALL, Eliz. Ellen | 23 | Manuel | " |
| Martha A. | " | Eliza E. | 25 | Mary | " |
| Mary J. | " | Hannah M. | " | NUNN, Catharine M. | " |
| MILLER, Emily | 108 | Herman F. | " | Wm. E. | " |
| Inf/Wm.J.& Emily | " | Hiram F. | " | OFFICER, Sarah | 108 |
| Glena | 134 | John | " | Wm. (2) | 103 |
| James Allen | " | Russel | " | ORE, Calvin | 117 |
| Martha Ellen | " | Son/R.& H. | " | Rody A. | " |
| Randol C. | " | Russell B. | " | Wm. R. | " |
| MILLS, Anna L. | 142 | * Wm. T. | " | ORE, Robt. Earl | 118 |
| Edward | 74 | NAULTY, Sarah E. | 34 | Sarah J. | " |
| Jennie | " | Martha E. | 40 | ORESSER, Mary | 60 |
| Susannah | " | Eliz. | 41 | ORR, Sarah | 5 |
| MINER, Geo. L. | 125 | Frank | " | OSBORN, Geo. | 75 |
| Ida B. | " | James | " | OSGOOD, Eddie | 112 |
| Robt. M. | " | * Peter E. | " | Henry D. | " |
| Wm. Lee | " | Sarah A. | " | Rusia | 113 |
| Hardin W. | 154 | Wm. D. | " | Sarah | " |
| Martha | " | NAYLOR, _____ | 134 | OSTEN, John | 75 |
| MINTER, Margaret | 75 | Mary C. | " | OWSLEY, Kate | " |
| MITCHELL, J.E. | " | Mary R. | " | Mary F. | " |
| Mary | " | Philip H. | " | OXLEY, James | 18 |
| MOFFETT, James | 125 | Sarah E. | " | Mary | " |
| MOHN, Sarah | 40 | Thomas | " | OXLEY, Geo. W. | 19 |
| MONROE, John Rinman | 75 | Wm. H. | " | Inf/G.W.& S.A. | " |
| MONT, H. E. | " | NEIL, Ann | 75 | Robt. E. | " |
| MOODY, Ida May | 40 | Rev. James | " | Sarah A. | " |
| Lucinda | " | NELSON, Sarah | 41 | OXLEY, Anna L. | 142 |
| MOON, Lyman C. | 3 | NERGENAH, Henry T. | 120 | Edgar S. | " |
| MOORE, Georgie | 40 | Nancy | " | Florence | " |
| Joseph | " | Susan F. | " | Maggie M. | " |
| MORISON, Wm. | 103 | NESBITT, Martha L. | 41 | Raymond | " |
| MORRIS, John Austin | 25 | NEVINS, Inf/Lee & O. | 130 | Wm. A. | " |
| Wm. T. | " | NEWCOMB, A. W. | 75 | PADGET, Effie Lee | 29 |
| MORRIS, Allen | 27 | NEWLAND, Edward E. | " | *PAIGE, A.S. | 75 |
| Cora Lee | " | Geo. | " | *PANKEY, Wm. | 134 |
| Charlotte | 75 | * Samuel | " | PARKER, Prudence B. | 41 |
| Mary E. | 142 | NEWMAN, Hiram N. | 9 | Susan D. | " |
| MORRISON, Margaret J. | 149 | Margaret | " | T. | " |
| MOSS, Martha J. | 75 | Nelson B. | 75 | PARKS, Hardin | 138 |
| *MULLIGAN, Samuel | 40 | NICHOLAS, Barbara | 18 | Lydia | " |
| MURPHY, Ellen | " | NIEHAUS, Lydia | 111 | Pleasant | " |
| Franklin J. | " | NORFLEET, Harold E. | 41 | PARROTT, Amanda | 30 |
| Chatharine M. | 41 | Henry | " | Mollie | 29 |
| John J. | " | Minnie | " | PATTERSON, Forest M. | 75 |
| Mary S. | " | Vernon | " | * J.S. | " |

| Name of Deceased | Page | Name of Deceased | Page | Name of Deceased | Page |
|--------------------------|------|----------------------|------|----------------------|------|
| PATTERSON, Jean Z. | 75 | POST, Nancy R. | 135 | RAWLINGS, Albert E. | 142 |
| *PAXTON, Cheaster L. | " | Phebe | " | Chas. H. | " |
| * David | " | Stephen | 134 | Eliza E. | " |
| PAYNE, Violet M. | 41 | POTTER, Ernest E. | 118 | Elva J. | " |
| PEARSON, Baby son | 142 | Ida Amelia | 77 | Geo. W. | " |
| Viola | " | Mary E. | " | James E. | " |
| PEARY, Eliz. | 109 | *PRICE, Albert | " | Meade Ambrose | 143 |
| PEMBERTON, Rhoda | 76 | * Wm. | " | Rowena | " |
| PENCE, Roy | 26 | PROSSER, Margaret K. | " | Wm. E. | " |
| PETERS, Emanuel | 76 | PUSEY, Ann | " | Minnie B. | 145 |
| Hannah | 23 | PYATT, Eliz. | 70 | Leora | 146 |
| PETERSON, John A. | 154 | Benjamin | 77 | RAWSON, Anna G. | 5 |
| PETREE, Inf/Wm. & L.B. | 125 | Caroline | " | Edward | " |
| PHELPS, Anna | 5 | Eliza Ellen | " | RAY, Abram | 109 |
| S.S. | 76 | Ida Belle | " | REA, Benjamin | 77 |
| PHILEY, Dolly | 5 | * John | " | Eliza J. | 78 |
| Elisha | " | Josephine | " | Jane | " |
| PHILLIPS, Edna Christena | 9 | Margaret | " | John W. | " |
| Richard, Jr. | 76 | Oliver J. | " | Mary J. | " |
| PICKETT, Hester Jane | " | QUACKENBUSH, Eliz. | " | REARICK, Emma F. | " |
| PILCHER, Anderson | 41 | Mary L. | " | Emma J. | " |
| Cora Lee | " | QUIN, Eliz. | " | * Geo. | " |
| Hannah | " | RADFORD, Lillie R. | 144 | Geo. C. | " |
| Inf twins/J.D. & H. | 41 | RANDELL, Eliza | 77 | Henrietta H. | " |
| Jeptha Dudley | 41 | Charlton P. | 147 | Lydia C. | " |
| Sarah | " | Mary | " | Sarah | " |
| Sarah J. | " | Presley | " | Wm. Alex | " |
| * Shadrach | " | Thomas | 77 | Wm. G. | " |
| PITNER, Mary Jane | 65 | RANSON, Edith Aileen | 103 | REAUGH, Maria | 103 |
| Alexander | 76 | RAPP, Chas. E. | 77 | REDFERN, John Wesley | 26 |
| Eliz. | " | Eliza | " | REDMAN, John | 9 |
| Geo. M. | " | Michael | " | Samuel | 103 |
| James T. | " | Susan H. | " | REED, Henry | 78 |
| Jane W. | " | Susie | " | Wm. F. | " |
| Kate L. | " | RATKIN, Matilda | " | Juda Seymour | 143 |
| Michael F. | " | RATLIFF, Eliz. | 1 | Martha M. | " |
| Montgomery | " | Inf/R. & E. | " | Wm. R. | " |
| Michael | 139 | Inf/W.G. & M. | " | REES, Annie E. | 78 |
| PITTA, Mary | 76 | Nancy | " | Edwin | " |
| POAD, Jane | 38 | Nancy J. | " | REEVE, Elmer E. | 41 |
| POE, John W. | 12 | RAWLINGS, Catherine | 19 | Hattie | " |
| POINTS, Artemicia | 103 | Chas. | " | Isaac B. | " |
| *POISAL, Henry K. | 41 | Chas. H. | " | Mariah | " |
| PORTER, Marion A. | 76 | Edward | " | Sarah | " |
| Sarah | " | Henry | " | REID, Caleb C. | 78 |
| Sinclair | " | R. | " | Eliz. R. Akers | " |
| Wm. | " | Robt. E. | " | Enoch S. | " |
| POSAL, Henry K. | 41 | Sarah H. | " | Geo. W. (2) | " |
| POSEY, Sarah | 76 | Sarah J. | " | Jessie | " |
| * Wm. Churchill | " | Wm. | " | John W. | " |
| POST, Mary E. | 135 | Emma C. | 140 | Lydia C. | " |
| | | Adeline R. Smith | 142 | Martha Capps | " |

| Name of Deceased | Page | Name of Deceased | Page | Name of Deceased | Page |
|----------------------|------|-----------------------|------|-------------------------|------|
| REID, Martha Garrett | 78 | *ROBERTS, F.T. | 79 | ROWLAND, Oscar | 79 |
| Mary Prather | " | * Richard | 125 | RUARK, J. A. | " |
| Richard W. | " | Chas. E. | 143 | Mary | 59 |
| Sarah E. | " | Clara L. Woods | " | Minerva | 65 |
| Stephen H. (2) | " | Jane | " | RUBART, Nancy | 152 |
| REILY, J. W. | 135 | Susan | " | RUBISON, Clara L. | 143 |
| REMINGTON, Harvey | 118 | Susan E. | " | RUCKER, John W. | 79 |
| REUTER, Frederick | 78 | ROBERTSON, Hannah | 41 | Wm. | " |
| REYNOLD, Elizah | 109 | Robert | " | RULE, Anna S. | " |
| REYNOLDS, Elijah | 104 | Susan | " | * Wm. H. | " |
| Eliz. | 154 | ROBERTSON, John J. | 79 | RUMMEL, Inf/G.& M. | 135 |
| Ida | " | ROBINSON, Eliz. | 141 | Mary E. | " |
| Joel H. | " | John | 41 | Peter | " |
| Joseph | " | Susan | 79 | RUNKLE, Mary Louise | 42 |
| RHEA, _____ | 125 | Wm. H. | 138 | RUSSEL, Martha | 113 |
| John A. | " | ROBSON, John W. | 19 | William | " |
| John Lendelle | " | Anna E. | 42 | RUSSELL, Richford | 1 |
| Vera La Veta | " | Geo. | " | Inf/W.G.& M. | " |
| RHEA, Ellen | 135 | Jane | " | Wm. G. | " |
| Howard | " | Mary Eliz. | " | *RUSSELL, James | 79 |
| Linda | " | Willie | " | Hezekiah | 154 |
| Margaret Jane | " | ROCKWELL, Hattie Hine | 79 | Margaret | " |
| Mary | " | Olive E. | " | RUTHERFORD, Ezekiel | 42 |
| Mary E. | " | ROEDERSHEIMER, Jacob | " | RUTLEDGE, Charlie | 80 |
| S. Esteline | " | Mary Ellen | " | Eliza A. | " |
| Samuel | " | ROEGGE, Lydia | 111 | Geo. | " |
| RHEA, James | 154 | Ralph Leland | " | Ida Craig | " |
| Mary Eliz. | 155 | ROGERS, Chas. L. | 109 | John E. | " |
| Lewis | 154 | Isaac | " | Mary Ann | " |
| Thomas | " | Lucinda | " | * Wm. J. | " |
| Wm. J. | " | Elia A. | 143 | RYAN, Margaret | 73 |
| RHOADS, H. Mattie | 78 | Mary E. | " | RYNDERS, Amos Theodore | 126 |
| Walter | " | ROLAND, _____(3) | 79 | Isiah | 126 |
| RICHARDS, Daniel W. | 79 | Christopher | 125 | RYNEARSON, B.F. | 80 |
| * Frank | " | Nancy Caroline | " | Susan | " |
| Geo. | " | *ROSS, Lt. F. Marion | 79 | SACKET, Geo. | " |
| Geo. M. | 78 | ROTH, Amelia | 45 | Sarah | " |
| Geo. W. | " | ROULAND, Martha Ellen | 122 | SALTER, Jane VanVechten | 5 |
| Margaret E. | 20 | Alexander | 125 | SAMPLE, Bennie | 80 |
| RICHARDSON, Mary E. | 19 | Sarah A. | " | Chas. | " |
| Chas. | 118 | Clark | 126 | SANDERS, Irby H. | 26 |
| Nancy M. | 119 | Elijah | " | Sarah H. | " |
| Nancy M. | 118 | Elma A. | " | SANDERSON, Robt. | 19 |
| Margaret M. | 151 | Jane R. | " | SANDS, Ann Eliza | 154 |
| Thomas | " | Mary H. | " | SANFORD, Etta | 80 |
| Zannah S. | " | Maude | " | Inf/R.L.& M.C. (2) | " |
| RICKEY, Inf/male | 113 | Sarah Jane | " | R. L. | " |
| RICKS, Mary | 79 | Susan | " | SANSAM, Amy | 126 |
| John | " | Wm. | " | Henry | " |
| RIESEBIETER, Herbert | 41 | ROUT, Margaret J. | 79 | Horace L. | " |
| RIGG, Eliz. | 154 | Catharine M. | 148 | Rosa M. | " |
| James L. | " | ROWLAND, Abner C. | 79 | SAUNDERSON, Eliz. | 80 |
| ROBERTS, And.Stewart | 79 | Love | " | SARGENT, Fred W. | 143 |

| Name of Deceased | Page | Name of Deceased | Page | Name of Deceased | Page |
|---------------------|------|-----------------------|------|--------------------------|------|
| SARGENT, John H. | 143 | SEYMOUR, Eliz. Dalton | 143 | SEYMOUR, Ted L. | 144 |
| SAVAGE, Ella O. | 80 | Fanny | 143 | * Wm. Richard | " |
| SAWYER, Bennie | " | Geo. W. | " | SEYMOUR, Clara L. | 146 |
| SCANLAN, Ellen Hall | " | * Geo. W. | " | Chester Arthur | 145 |
| *SCHARLTES, Jacob | " | Geraldine Kaiser | " | Harriet E. Story | " |
| SCHOFIELD, David | 81 | Jackson | " | Mae Malinda | " |
| Hubert | " | James P. | " | Nettie | " |
| Joseph | " | James Pulliam | " | SHAFFER, Annie G. | 42 |
| Richard | " | James R. | " | Harvey S. | " |
| Susan | " | James W. | " | Robert E.L. | " |
| SCHOLFIELD, Eliz. | 104 | John Willie | " | SHARP, Catharine | 81 |
| Eliz. A. | 109 | 2 sons/Julius | " | Charlotte | " |
| James | 104 | Laura | " | Elbert | " |
| James H. | 109 | Lavina | " | Martin | 82 |
| Maria | 104 | Mary E. (2) | " | Mary | " |
| SCHOONOVER, David | 81 | Robt. | " | Nancy M. | " |
| David, Jr. | " | Rose E. | " | Rispa | " |
| Phebe J. | " | Sally A. Burch | " | SHEEHAN, John | " |
| SCHUREMAN, Caroline | " | SEYMOUR, Aderson | 144 | SHEPHERD, Clara B. | 127 |
| David L. | " | Agness A. | " | SHEPPARD, Marg. Ann | 82 |
| John V. | " | Amanda J. | " | Robt. W. | " |
| Sarah | " | Anna W. Spires | " | Sarah M. | " |
| SCOTT, Malinda | 26 | Augustus | " | SHIRLEY, Eliz. G. | " |
| W.P. | 42 | Austin R. | " | Emily B. | " |
| Eliz. | 81 | Catharine | " | Evaline G. | " |
| James (2) | " | E. | " | Geo. Yates | " |
| Margaret | " | Earl H. | " | Geo. Y., Jr. | " |
| SCOTT, Bennie | 135 | Edward D. | " | Howard | " |
| SCUDERS, Ann | 81 | Eliz. | " | 6 infs/J.H.& L.M.W.19,20 | |
| John | " | Fanny | " | John G. | 82 |
| Sarah | " | Hannah | " | Mary | 20 |
| SELBY, Alice | " | Hannah V. Story | " | Thos. H. | 82 |
| Hannah | " | J. | " | Wilbur F. | " |
| John (2) | " | James E. | " | SHULTZ, Elisabeth | 42 |
| Silas | " | John | " | SHUMWAY, Nancy | 26 |
| SELF, Julia Ann | 33 | John H. | " | SIBERT, Geo. E. | 149 |
| Mary J. (2) | 109 | John, Sr. | " | Isaac | " |
| Mary J. | 104 | John W. | " | Jeremiah | " |
| SESSIONS, Sarah | 113 | Lewis A. | " | Susannah | 150 |
| SEVIER, Eliza | 127 | Lillie R. | " | SIEBERT, Geo. | 149 |
| * Guy Sanders | " | Maggie | " | Nancy J. | " |
| Nathan | " | Marion S. | " | Susanah | " |
| Ruth Beatrice | " | Martha (2) | " | SIERER, Mary E. | 82 |
| Wm. Annanias | " | Mary E. | " | SIGLER, Mary E. | " |
| SEWALTS, Charity E. | 118 | Maude | " | SILCOX, David H. | 1 |
| Godfrey | " | Melinda Grimsley | " | SIMMONS, Martha | 82 |
| SEYMOUR, Jack | 127 | Nancy H. | " | Sarah (2) | " |
| Mary | " | Oliver Thompson | " | Solomon | " |
| SEYMOUR, Addie L. | 143 | Richard | " | SIMMS, Emmy | " |
| Albert | " | Robt., Sr. | " | SIMS, Stella | " |
| Barton | " | Inf/Robt.& Mary | " | Susan J. | " |
| Effie L. | " | Sarah (2) | " | SINCLAIR, Annie G. | 42 |

| Page 17: INDEX: | | A Guide to Cemeteries in Morgan County, Illinois. Vol. III. Dalton & Long, 1978. Index covers only burials. *=soldier. | | | |
|----------------------|------|---|------|---------------------|------|
| Name of Deceased | Page | Name of Deceased | Page | Name of Deceased | Page |
| SINCLAIR, Sallie | 33 | SMITH, Nancy F. | 26 | SMITH, Martha (2) | 119 |
| Amanda Crawford | 42 | Virgie | " | Mary | " |
| Eliza | " | Marguerite | 31 | Nancy M. | " |
| Euphemia H. | " | Ollie | 40 | * Richard P. | " |
| Geo. | " | SMITH, Eliz. | 42 | Wm. B. | " |
| Ida Lee | " | John J. M. | " | SMITH, Eliz. | 121 |
| John | " | Richard | " | Susannah | 150 |
| Rev. John | " | SMITH, Ann | 43 | Cathrine | 151 |
| Juliett | " | Inf/C.W. & M. | " | Nancy | " |
| Lyle | " | John | " | SMITH, Dewella | 152 |
| Malinda | " | Melissa F. | " | Nancy | " |
| Mary J. | " | Nancy (2) | " | Susan M. | " |
| Morrison | " | Orpha J. | " | Inf/W. & M. | " |
| * Peter A. | " | Samuel W. | " | Wm. A. | " |
| Rachel | " | Wm. | " | SNAPE, Eliz. | 83 |
| * Robt. W. | " | Wm. H. | " | Emma | " |
| Samuel | " | *SMITH, Archimedes | 82 | John | " |
| Samuel James | " | * Elijah (Rev. War) | " | Mary | " |
| Susannah | " | * G.C. | " | Robt. | " |
| Watson | " | James S. | " | SNAPE, Nanny | 82 |
| SINNOTT, _____ | 82 | Martha | " | Samuel F. | " |
| SKEEN, Isaiah | " | Rachel | " | SNELLEN, Aquilla | 105 |
| *SKIDMORE, R. | " | Ralph | " | Eliz. | 109 |
| SKINNER, Ann Savilla | 135 | * Riley | " | SNYDER, Gilbert | 83 |
| Harriett | " | Thos. H. | " | SORRELL, Henry | 43 |
| Hazen | " | Sallie | 97 | Mary | " |
| SLATER, Inf/C. & L. | 118 | SMITH, Amanda M. | 104 | SORRELLS, Marg. | 9 |
| Lulu L. | " | Eliz. | " | * Wm. | " |
| SLATTEN, Anna | 42 | Geo. W. (2) | " | SORRELS, Hiram | 105 |
| * James | " | James P. | " | Mahala | " |
| SLEETER, David H. | 135 | John | " | Milton F. | " |
| Josephine E. | " | Samuel B. | " | * Peter | " |
| Lillie May | " | Sarah | " | Sarah A. | " |
| Mary Marg. | " | Sarah A. | " | Sissie Belle | " |
| Wm. (2) | " | Seli E. | " | Thos. | " |
| SMITH, Sarah A. | 1 | SMITH, Dulcenda | 109 | Maudie E. | 109 |
| * Edward | 3 | James W. | " | Wm. A. | " |
| Emily N. | " | John | " | SORRILL, Catherine | 43 |
| SMITH, Amelia F. | 20 | Thos. B. | " | Henry | " |
| * Benjamin | " | SMITH, Desdemona | 113 | SPALDING, Elvira M. | 83 |
| John M. | " | Aaron | 118 | Horace | " |
| Mary King | " | Benj. F. | " | Wm. W. | " |
| 2 Infs/R. & Mary | " | Charity E. | " | SPARKS, John | " |
| Robt. | " | SMITH, Ashford | 119 | SPENCER, Marg. | 9 |
| Sarah E. | " | B.F. | " | Abbie | 83 |
| SMITH, Alva T. | 26 | Celia | " | Ada May | " |
| Harrison | " | Elvina | " | Bertha A. | " |
| Jasper E. | " | Francis (2) | " | Ellen E. | " |
| Lulu E. | " | Infant | " | Louise | " |
| Minnie | " | John | " | Richard B. | " |
| Myrtle | " | Larkin B. | " | * Richard B. | " |

| Name of Deceased | Page | Name of Deceased | Page | Name of Deceased | Page |
|---------------------------|------|-------------------------|------|----------------------|------|
| SPENCER, Stephen | 83 | STICE, Catherine | 156 | SWAIN, Catherine | 43 |
| Thomas C. | " | STIGALL, Edith | 32 | Thomas | " |
| * Wm. S. | " | John H. | 43 | Inf/A.R. & E. | 44 |
| SPILMAN, Lizzie | " | STILLWELL, Frances | 109 | Adelaide | " |
| SPIRES, Addie | 145 | James S. | 127 | Amanda C. | " |
| Betty June | " | John L. | " | Arthur | " |
| Eliz. | " | Lucy Jane | " | Bessie May | " |
| Francis | " | Ralph T. | " | Chas. M. | " |
| Fred M. | " | Sarah M. | " | Edwin Howard | " |
| son/Francis & M.E. | " | STILTZ, Fanny A. | 43 | Emma W. | " |
| son/Fred | " | STILWELL, Henry F. | 105 | Fannie C. | " |
| James | " | John A. | " | G. R. | " |
| Leatha | 146 | STIMPSON, — | 43 | Hedley, V. | " |
| Mary Ann | 145 | Bertie | " | Infant daus (2) | " |
| Mary E. | " | Eliz. | 29 | J. Ellen | " |
| Minnie B. Rawlings | " | John H. | 43 | Mrs. J.C. | " |
| Willie B. | " | Willie | " | James Coughy | " |
| SPRINGER, Geo. | 83 | STOCKTON, Alma Fay | " | Jane Ann | " |
| STACEY, Minnie | 41 | Jacob H. | " | John | " |
| * James D. | 83 | Margaret | " | Lovella B. | " |
| Martha A. | " | Mary Ellen | 47 | Margaret Adeline | " |
| Mary Lila | " | STONE, James T. | 146 | Marietta | " |
| * T.P. | " | STOOPS, Ellen Eliz. | 130 | Sarah | " |
| STAGG, Achsah Lena | 89 | STORY, Hannah U. | 144 | Sarah J. | " |
| Isabella A. | 83 | Harriet E. | 145 | Susan S. H. | " |
| * James M. | " | (2 Seymour women) | " | Thomas H. | " |
| Lawrence Eldin | " | STOUT, H. (N?) | 84 | Walter H. | " |
| Louise Furgeson | " | Johnney | " | Wm. | " |
| STANBERY, John R. | 129 | Rachel | " | SWAIN, Rebecca | 85 |
| STANDAGE, John | 154 | STRAWN, Isiah (2) | " | Thomas, Sr. | " |
| Joseph | " | James G. | " | SWAN, Robt. | 44 |
| *STARR, Matthew H. | 84 | Nancy | " | SWEET, Anna | 85 |
| STEINLEY, C. | " | STREET, Eliza Ann | " | Olive Maria | " |
| STEPHEN, Sarah | 74 | STREUTER, Infant | 111 | Wm. (2) | " |
| STERIGAR, John | 43 | STRICKLIN, Caroline H. | 135 | SWITZER, Troy | 109 |
| STEVENS, Rebecca M. | 84 | Wm. R. | " | TABB, Phebe McCready | |
| STEVENSON, Eliza | " | STRICKLINN, Ophelia (2) | " | Buckles | 154 |
| Emily Virginia | " | STRINGHAM, Ann | 84 | TANDY, Chas. B. | 85 |
| John Wm. | " | STROWMATT, Ann E. | 9 | Martha H. | " |
| STEWART, 2 sons/J. & M.A. | 8 | Barbara Jean | " | * Willis | " |
| Manerva A. | 8 | John | " | TANNER, Cyrus | 5 |
| STICE, Eliz. | 43 | STURGES, Martha A. | 140 | Lucy Sturtevant | " |
| Flora B. | " | STURGISS, Geo. | 127 | TAYLOR, Josiah | 44 |
| Geo. L. | " | STURTEVANT, Lucy | 5 | Margaret | " |
| Infant | " | SUDGER, Ann | 84 | Samuel | " |
| Lennie L. | " | SUDGERS, J— | 85 | Wm. T. | " |
| Marcella | " | John | " | TAYLOR, John W. | 45 |
| * Van A. | " | SUMPTER, Eva May | 135 | * Arthur | 85 |
| Wm. Martin | " | SUTER, Martin | 105 | Eliz. | " |
| STICE, Sarah E. | 105 | SWAIN, Margaret A. | 33 | Ernest | " |
| Inf/S.F. & L.L. | 109 | Susan | 37 | * James | " |

| Name of Deceased | Page | Name of Deceased | Page | Name of Deceased | Page |
|-----------------------|-------|----------------------|------|-----------------------|------|
| TAYLOR, John W. | 85 | TRAVIS, Eliz. | 145 | TURNER, Catherine | 156 |
| Mary Eliz. | " | Frederick | " | Ellen | " |
| Samuel | " | TREMBLE, Henry | 87 | Geo. N. | " |
| Spencer | " | TROTTER, Williametta | 33 | Isaac J. | " |
| TAYLOR, Mary Belle | 145 | * Addison | 45 | James M. | " |
| TENDICK, Jane | 85,86 | Amelia | " | Jessie | " |
| John | " | Bella A. | " | Rev. Joel | " |
| Peter | 86 | Bessie M. | " | * John | " |
| TERRY, Philip | " | Eliza W. | " | John M. | " |
| *THOMAS, Henry H. | " | Ella May | " | Lemuel A. | " |
| Wm. | " | Frank M. | " | Margaret | " |
| THOMASON, Carl | 119 | Fritz Canby | " | Mahala | " |
| THOMPSON, Virginia H. | 32 | Hattie J. | " | Martha | " |
| Frank | 45 | Jane | " | Mary | " |
| Inf/Geo.W.& M.S. | " | John | " | Rachel(2) | " |
| Geo. W. | " | John M. | " | Ruth | " |
| Harry | " | Joseph A. | " | Samuel A. | " |
| Louise B. | " | Lavina J. | " | Sarah J. | " |
| Margaret | " | Letha | " | Susannah | " |
| Myra S. | " | Milton E. | " | Thos. R.G. | " |
| Van B. | " | Nellie | " | Wm. | " |
| THOMPSON, Alfred T. | 86 | Rebekah | " | UBBERS, Folka | 124 |
| Eleanor | " | Sophie E. | " | UPCHURCH, Effie | 46 |
| Wm. | " | Marie | 87 | Inf/H.& Mabel M. | 47 |
| Wm. Prentice | " | Wm. David Rice | " | James A. | 46 |
| THOMPSON, Nancie | 120 | TRUE, Sarah Ann | 45 | Mildred | " |
| Nelly | 127 | * Thos. J. | " | *UPHAM, Abner A. | 87 |
| Wm. E. | " | Willis J. | 91 | *VAGTS, Arthur | " |
| Samuel | 129 | TRUITT, Archel | 136 | John | " |
| THOMPSON, Surrwin | 136 | Clinton | " | * John | " |
| THORNBORROW, Hannah | 86 | TUCKER, Casander | 87 | *VANCIL, Jacob | 156 |
| John | " | John M. | 20 | Lizzie Almira | 153 |
| Mary Ann | " | TURNER, _____ | 77 | VANITER, Samuel | 130 |
| Stephen | " | Wm. T. | 26 | VANVECHTEN, Jane | 5 |
| THORNTON, Louisa A. | " | * L.T. | " | VANCLEAVE, Lucretia | 87 |
| Sarah V. | " | Almira Collins | 153 | VANWINKLE, Eliz. | " |
| THROWER, Catherine | " | Eliz. | " | Jason | " |
| TIEMEYER, Fried | " | Lovella F. | " | T.S. | " |
| Friedline | " | Mary | " | *VAN WINKLE, Bert A. | 145 |
| Henry | " | Eliz | 154 | Eliz. Gibson | " |
| Minnie | " | Martha | " | Geo. Ezra | " |
| *TIFF, James R. | 87 | Nancy M. | " | Helen E. | " |
| * Wm. J. | " | TURNER, Andrew J. | 155 | John | " |
| TILTON, Robt. | " | David F. | " | Melissa A. | " |
| W. I. | " | Eliza M. | " | VANZANT, Cynthia M. | 88 |
| TIMBERMAN, Leora | 146 | Kenneth F. | " | Isaiah | " |
| TINDALL, Lizzie | 110 | Loyd | " | VASCONCELLOS, Emanuel | " |
| TODD, Eliz. | 87 | Martin Luther | " | Ida | " |
| TOWNLEY, America | 150 | Mary Eliz. | " | VAUGHN, Mary E. | " |
| *TRALL, Jno | " | Moses O. | " | Polly | " |
| TRAMEL, Sampson E. | 127 | Sarah Jane Rebecca | " | Rufus M. | " |

| Name of Deceased | Page | Name of Deceased | Page | Name of Deceased | Page |
|----------------------|------|----------------------|------|------------------------|----------|
| VIEIRA, Joseph | 88 | WEEKS, Hannah | 160 | WILDAY, Tilitha Drink- | |
| * Joseph | " | Lena M. | " | water | 136 |
| VIERRA, Mary | " | Marg. E. | " | WILHITE, Geo. Lanham | 46 |
| VORHEES, Albert | " | Raymond T. | " | WILKINSON, Hannah | 86 |
| Sarah | " | Washington | " | WILLERTON, Margaret | 145 |
| VOORHEES, Stephen G. | " | WELLS, Wyman Wayne | 145 | William | " |
| Wm. | " | WERNER, Jessie Cath. | 156 | WILLETT, Eliza J. | 46 |
| WAGGENER, Mary M. | 46 | Wm. | 88 | Geo. H. | " |
| Thos. Tilford | 47 | WEST, Ruth | " | Georgie | " |
| WAGGNER, Matilda | 46 | Timothy H. | 89 | * Henry C. | " |
| WAGGONER, Addie | 36 | WESTROPE, Wm. P. | 109 | Jennie | " |
| WAGNER, Aaron Smith | 136 | WET___, Pau_ina | 89 | Maria R. | " |
| Mary | " | WETHERBEE, Chas. A. | " | Samuel C. | " |
| WAKELY, Anne Marsden | 88 | Mary | " | Samuel E. | " |
| Dr. Thos. A. | " | Truman F. | " | WILLIAMS, Sarah E. | 89 |
| WALKER, Margaret R. | 3 | WHEELER, Henry | 26 | Inf/T.B.& S.J. | 46 |
| Phillip | 88 | Levi | " | Willie | " |
| WALSH, Frank | " | Mae Malinda | 145 | WILLIAMSON, James | 89 |
| Peter | " | Marshall | 26 | * Samuel | " |
| WALTER, Lena | 46 | Minerva | " | Sarah | " |
| WANN, Mrs. Chas. | 127 | Sarah E. | " | WILSON, John E. | 1 |
| Inf/Chas. | " | WHITAKER, Luiza Jane | " | Anna E. | 12 |
| WARD, Edward | 46 | WHITE, Emma | 30 | Annie | 46 |
| Emma H. | " | Caroline | 129 | Eliz. H. | " |
| Geo. H. | " | Hiram | " | * Geo. | " |
| Thos. | " | John | 145 | Harriet | " |
| Wilhelmina | " | Laura | " | * Henry | " |
| Wm. H. | " | *WHITEMAN, Jack | 46 | WILSON, Eliz. B. | 47 |
| WARFIELD, Lot Lance | " | Jackson | " | Eliza M. | 89 |
| WARNER, Nancy | 88 | Martha | " | Louisa | " |
| Sarah | " | WHITLOCK, Eliza Ann | 130 | M.J. | " |
| WARREN, Ann D. | " | James R. | 127 | Martha | " |
| Margaret | " | WIGGS, Flossie | 26 | * Robert | " |
| * Col. Wm. B. | " | WIGHT, David | 89 | Susannah F. | 119 |
| WARTERS, James | 20 | Mary | " | WINDSOR, Emeline | 89 |
| Grace R. | 46 | WILDAY, Abraham | 136 | * J. | " |
| Mathou | " | Alexander | " | WINGLER, Robt. Lee | 146 |
| *WASHINGTON, Geo | 88 | Arthusa J. | " | WISEMAN, Achsah Lena | 89 |
| WATERFIELD, Mary E. | 46 | Benj. | " | WITHERBEE, Georgia A. | 26 |
| WATKINS, John A. | 88 | C.A. | " | Jessee H. | " |
| Sarah E. | " | Chas. | " | WITHERBEE, Alma Irene | 127 |
| WATSON, Eliza M. | " | Diana | " | Anna E. | " |
| WATTS, Wm. J. | 105 | Eleanor | " | Eliz. L. | " |
| WEAVER, Mary A. | 88 | Eliz. | " | Lena A. | " |
| Samuel | " | Inf/A. & T. | " | Mary A. Owyer | " |
| WEBB, ___ | " | Jerial E. | " | Wm. H. | " |
| Eleanor | 86 | John | " | Wm. Wood | 127, 128 |
| Eleanor T. | 88 | Katharine | " | WITHERBEE, Eliz. L. | 129 |
| John | " | Luella M. | " | WITT, Eloise Bull | 145 |
| WEBSTER, Alice Ann | 8 | Sarah | " | WOOD, Ella A. | 26 |
| Jos. E. | " | Sedonia | " | Hattie | " |
| Sarah Olive | " | Thos. J. (2) | " | * John W. | " |

| Page 21: INDEX: | A Guide to Cemeteries in Morgan County, Illinois. Vol. III. Dalton & Long, 1978. Index covers only burials. *=soldier. | | | | |
|-------------------|---|--------------------------|------|----------------------|------|
| Name of Deceased | Page | Name of Deceased | Page | Name of Deceased | Page |
| WOOD, Mary Jane | 26 | WOODMAN, Amanda M. | 89 | *WORRALLS, Jacob | 9 |
| Eliz. | 27 | Edward | " | *WRIGHT, Isaac | 89 |
| Gracie Irene | " | Harry | " | * A. Thurman | 146 |
| Inf/J.W. & M.J. | " | Mary E. | " | Julia K. | " |
| Inf/E. & M. | " | WOODMANSEE, Daisy Alma | 145 | Marie E. | " |
| Wheatley | " | Fletcher Givens | 145 | Ward S. | " |
| WOOD, Inf/J. & M. | 47 | * John F. | " | Wm. E. | " |
| James | " | Mary A. | 146 | WRIGHTSMAN, Mahala | 156 |
| Jane | " | Mildred E. | " | WYATT, Della Lynch | 89 |
| Martha | " | WOODROW, Mary E. | 89 | WYCKOFF, Orpha Celia | " |
| * McLean F. | 89 | WOODS, Clara L. | 146 | WYLDER, Margaret | 128 |
| Sarah Mariah | 128 | WOODSON, Josie | 89 | YANCY, Claude Harris | 47 |
| WOOD, Ben Onia | 129 | WOOLLEN, Matthew Simpson | 89 | YATES, Gov. Richard | 89 |
| Eliz. L. | " | WORRALL, David | 9 | YOUNG, Mary A. | " |
| Joel Blinn | " | Sarah | " | ZACHARIAS, A. F. | " |
| John Eli | " | WORRALLS, Eliz. | " | | |

-----*

The index to Volume II A Guide to Cemeteries in Morgan County, Illinois, by Dalton and Long was published in our Society's Quarterly, Jacksonville (IL) Geneal Journal June 1979, Vol. No. VII, Issue # 3. (We inadvertantly wrote it Issue # 2. Will our genealogists please make this simple correction on their own copies?)

The index to Volume I A Guide to Cemeteries in Morgan County, Illinois, by Dalton and Long has not been published. Our Society will, however, xerox a copy of it for interested genealogists. A donation of \$3.50 to the Society would be appreciated to defray costs of xeroxing and postage.

We feel sure that Bob Dalton is well under way on Volume IV of his guide to cemeteries in Morgan County. In fact, he has completed Yatesville Cemetery. There are 26 pages for this one. We could send a genealogist the 4 pages of index to determine if their people are there. It seems appropriate to close this index with a poem by Beatrice Branch of Miami, Florida, found in the Sunshine Magazine February, 1976.

HILLTOP CHURCHYARD REVISITED

*A man travels the world over in search of what he
needs and returns home to find it. George Moore.*

Here beneath the melting snow
Are all my loves of long ago:
Gentle people--now but names
That memory alone reclaims.

When youthful days were intertwined
With hilltop paths that dip and wind,
Ambition spurned this country town,
Seeking fortune and renown.

How blind was I, to be obsessed
With all that proved but second-best
To birthright joys that now are lost,
Except for marble stones, embossed.

This Cemetery is at the eastern end of Lake Jacksonville in Section 11 Township 14 North, Range 10 West of the Third Principal Meridian, in Morgan County. It is beside the Asbury Methodist Church. Elizabeth Hardy made a reading of tombstones, and then Pauline Hembrough Goheen compiled a more complete listing from the cemetery records, in 1976. Here we are just publishing the listing of names because this is a large cemetery.

| | | |
|------------------------|----------------------------|-----------------------|
| BACHMAN, Mabel | DEVORE, John B. | HEMBROUGH, William |
| BARR, A. Y. | James H. | Hannah Fermer |
| Clara E. | Catherine J. | Uriah |
| Effie M. | James H. | Lula May |
| Mary R. | Edna J. | Martha J. |
| Wm. W. | Harvey | William H. |
| BARROWS, Paul | ELSONE, Faye | Jane M. |
| Jennie R. | FITZSIMMONS, LetaMegginson | Inf/son |
| Ralph | Wilbert | Carl Leslie |
| Aileen M. | FLATFORD, Nathaniel | Olive Eliz.Megginson |
| Wm. E. | Rachel | John Wesley |
| BARTZ, Rebecca Lynn | GOHEEN, Thos. Robt. | Harriet Taylor |
| BROGDON, Blanch | GORDON, Linda Lou | Geo. W. |
| Geo. H. | GREEN, Austin B. | Agnes A. Megginson |
| CLARK, Harry J. | Mary J. | Robert |
| Lilliam M.H. | Minnie R. | Hannah |
| Joseph A. | Charlie S. | Joseph |
| COE, Dora | Minnie M. | Hannah L. Vasey |
| COFFMAN, Adam B. | Marella | Dean M. |
| COX, Chas. | Clark L. | Pauline V. Goodall |
| Harriett A. | Eva L. Pence | Dean Thomas |
| CRAIG, Wm. Thos. | Elmer Austin | Thomas S. |
| Lelia M. | Laura B. Henry | Annie PhyllisHamilton |
| Harry G., Jr. | GRUNDER, Henry | Glenn W. |
| CRAIN, Howard H. | Luch B. | Earl R. |
| E.E. | GUNTERMAN, Ada Belle | Emma S. Henry |
| E.L. | HARNEY, Chas. T. | James R. |
| WILLIAMS, Mabel | Fannie Megginson | Laura M. Simpkins |
| Crain | Leroy | Harry Wayne |
| CRAIN, Betty Hembrough | Floyd M. | Thomas Lee |
| Mildred McGinnis | Ruth Iglehart Smith | Ellsworth |
| CRAWFORD, John H. | HAYES, Melva | Caroline Thomas |
| Susan F. | HAYHURST, Lillian Young | Floyd Elmer |
| Ross | Harold, Jr. | Larry E. |
| CROUSE, Jerry Lee | HELLIWELL, Thomas | John D. |
| CRAIN, Dallas | Edith Swain | Anna D. Reed |
| Sarah | Ralph | Lillie May |
| DEVORE, Fannie J. | Wm. | Minnie E. |
| Clara Bell | Eliza | Douglas Anderson |
| Della Mae | Harry | Hildegarde |
| Wm. | Eliza | Edwin R. |
| Emma | Joseph | Margaret A. Scott |
| Uriah | Mary | Ruth A. |
| Marion A. | Eugene B. | Frank E. |
| John M. | HEMBROUGH, Thomas | Lena L. Taylor |
| Uriah J. | Eliza Jane Devore | Frank |
| Sarah J. | John | Annie M. |

Page 2: Index of Burials in Asbury Cemetery.

| | | |
|-------------------------------|-----------------------|---------------------------|
| HEMBROUGH, Chas. Richard | MAY, Catherine | MORRIS, Geo. W. |
| Rose L. | MAYES, Viola Reynolds | Vestia B. |
| Clarence F. | & inf/dau | MORTIMER, Wm. H. |
| Wm. | McCORMICK, Wm. D. | Sarah A. Rawlings |
| Emma Ann | Annie I. Darley | Earl & Eva (twins) |
| Ethel Sorrell | Laura | Wm. D. |
| Neal Malone | Walter A. & | Minnie E. |
| Wilbur Reed | inf/son | MORROW, Geo. T. |
| Carl Trabue | McCURLEY, Pauline | Eva J. |
| HITCH, James F. | Wm. E. | Hary Helen |
| Alice | Linnie T. | MYERS, Geo. W. |
| HOGG, John T. | Frank E. | Sarah A. |
| Eliz. Jane Megginson | Sarah Mae Gallagher | NEWMAN, Inf/son Geo. & L. |
| HOPPER, Alex | McKEAN, James A. | James |
| Anna | Eliza Frances | Elizabeth |
| Fredrick A. | George H. | George A. |
| Maggie A. | Bessie B. Reed | Hattie B. |
| Margie? | MEGGINSON, John R. | RANSON, James Wm. |
| Ernest A. | Fannie Hodgkinson | Beatrice E. |
| HOWE, Aaron B. (2) | Joseph P.D. 1858-1884 | Chas. L. |
| Mary B. | George A. | John E. |
| IGLEHART, Pearl Rufus | Emma J. | Ann E. |
| Zella DeCastro | Nettie V. Kitner | RAWLINGS, James |
| JEFFERSON, Margaret | Richardson Dale | Frances Hembrough |
| JENKINS, Luther L. | Minnie Dore | REED, Wm. Andrew |
| Mabel G. | John L. | Mary A. Clark |
| Forrest Lee | Earl | Edith Mae |
| JENNINGS, Robert R. | Ralph W. | Inf/son W.A. & M.A. |
| Emma Scott | Annie L. | Victoria Kyle |
| JOHNSON, Eva F. | Emma | Andrew Jackson |
| Nellie E. | John Ernest | Susan Frances Williams |
| Margaret T. | Joseph P.D. 1886-1949 | Lizzie S. |
| Eliza M. | Robert V. | Franklin E. |
| John W. | Jessie M.R. | Elizabeth |
| U.J. | Rueben C. | RETZER, Sylvia Ruby |
| Charity | Ida | REYNOLDS, Chas. E. |
| Francis M. | Maud | Nellie G. |
| John D. | Claude Dewey | Russell M. & |
| Lucy H. | R.D. | Roland W. |
| Edith E. | Simpson Shirley | Mary J. |
| Sarah E. | Geo. T. | Edwin J. |
| Mary A. | Mrs. Eva | Mary Ellen Hembrough |
| LANE, Edward Lee | Jesse Eugene | Raymond T. |
| LASHMET, Jonas | Phyllis Steinmetz | RICHARDSON, Annie P. |
| Mary | Ralph A. | James E. son/W.R. & A. |
| LECKBEE, Clark Clinton | Ruth Hembrough | Nettie |
| Mary Ahern | Jackie | RUBY, Willis |
| LONGSTAFF, Frederick "Pat" | Agnes Taylor | Grace |
| Lila Lee Garret | John Louis | RUYLE, Peter |
| LULL, Albert B. | MIERS, John | Albert W. |
| 2 children | Esther | Frances D. |
| LINDSAY, children/D.L. & S.C. | Frederick T. | Mabel M. |
| MATTES, James M. | Ross H. | SCOTT, Eliz. A. |

SCOTT, Ezra C.
 Mary
 Jonas T.
 Jeanette
 SANDERS, Chas. D.
 Mattie Haley
 Gladys V.
 SANDERSON, Jane
 SCOTT, Chas. E.
 Annetta Blackburn
 Mabel
 SHELTON, Allie A.
 T. A.
 Stephen Gabriel
 Lt. John Wesley
 SHEPPARD, Clifford C.
 Lucille E.
 Hardin D.
 Zella Crain
 SIMPKIN, Geo.
 Sarah E.
 SMITH, Frank Marion
 Margaret
 Clyde
 John Richard
 Belle
 Harry F.
 Harriette J.
 Robt. Hamlin
 Mary M.
 Bradley
 Mattie J.
 David
 Sarah E.
 James R.
 Annie B. Hembrough
 Lena Ruth
 SOOY, Myron Watson
 SPREEN, Wm. F.
 Maria A.
 Carrie A.
 STAPLES, Geo. E.
 Julia A.
 STEELMAN, H. Leslie
 James Clarke
 SWIGERT, John F.
 Maximilia T.
 Eliza A.
 Inf/son J.F. & M.
 Rebecca E.
 Florence C.
 Rebecca
 Colleen M.

SWIGERT, Adelia C.
 Bamael
 SLUDER, Chas. Henry
 Bertha Louise
 TARZWELL, Iva M. Green
 TAYLOR, Oliver Scott
 Jennie O'Brien
 Chas. Edgar
 Emma G.
 George D.
 Polly E.
 Cornelius C.
 Eliz. E.
 Edward A.
 Susan
 Wilbur
 Emma J.
 Chas. A.
 Martha E.
 Geo. Z.
 Geo. D.
 O. Glenn
 TAYMAN, John Lavan
 Sarah Eliz. Watson
 VANSTONE, Thomas
 VASEY, Wm.
 Lulu Nelson Hembrough
 Esther Reid
 Geo.
 Wm.
 Louisa
 John R.
 Geneva
 WATSON, Isaac
 Sarah J.
 Chas.
 Aileen
 WEST, Porter G.
 WHITE, Wm. G.
 Luella
 Geo. Earl.
 Dale Arthur
 Anah B. Hembrough
 Thomas
 Laura L.
 WILLEN, James
 Wm. H.
 WILLIAMS, Mabel Crain
 WINTER, Geo. W.
 Eva. A.
 WYCKOFF, Samuel
 Margaret
 YEAGER, Sarah F.

YEAGER, Sarah H. J.
 YOUNG, Thomas
 Louise A.
 Roy Thomas
 Nellie

* * * * *
 * A HAPPY SEQUEL
 * A happy sequel to having
 * such an excellent reading
 * on Asbury cemetery occurred
 * on November 13 & 14.
 * One of our Society mem-
 * bers, Christine Crawford
 * Oppenheimer, of New York,
 * came to our fair city in
 * search of a Nancy Wilson,
 * whom we found buried at Nor-
 * tonville, and a John Craw-
 * ford, her grandfather. He
 * was said to have been "bur-
 * ied in Jacksonville."
 * We searched Diamond Grove
 * and Jv'l East cemetery re-
 * cords with no success. She
 * found the obituary in the
 * newspaper films at our Pub-
 * lic Library, which indicated
 * that he was buried at Asbury.
 * From the reading, she also
 * found many of her other
 * relatives of the Andrew
 * Jackson Reed and Lashmet
 * families.

* The cemetery, once neg-
 * lected, is now well-kept by
 * the Asbury Cemetery Associ-
 * ation. Donations would be
 * welcomed in order to contin-
 * ue the good work now being
 * done, and trying to better
 * the roads in and around
 * the cemetery.

* Please be helpful to
 * those persons concerned
 * with its upkeep, and send
 * your donations and thanks
 * to the Treasurer, Mrs.
 * Frank Hembrough, 411 West-
 * gate, Jacksonville ILL
 * 62650.
 *

Page 1: JOHN SWINDEN, FORMERLY OF GREENE COUNTY, ILLINOIS, 1823 - 1898.
Copied from: Portrait and Biographical Record of Western Oregon.
Copied by Mrs. Zora Swinden Phillips, grand-daughter of Charles Lee Swinden. Her address: 12545 Quito Rd., Saratoga CALIF 95070.

This biography gives us a good example of tracing people who travelled to the West. If a genealogist can determine the area of their residence, he should read those county histories available in that state. This may be a way of back-tracking on families who came through West Central Illinois, stopping for a time, and then moving on as the advertisements glamorized new lands available.

In John Swinden, Oregon found one of those large hearted and earnest pioneers who was not only willing, but glad to ally his fortunes with its wonderful promise, and suffer want and deprivation ere he had accomplished his goal of success. Under his guidance many acres of virgin soil were upturned to the sky and made to give of their richness for the latter day uses of man, furnishing a home for himself and family, and sustenance for those near him as well as for the wayfarer who chances his way and was less fortunate than himself. The farm now occupied by the widow and children, who survived his death, December 1, 1898, at the age of 75, is 162 acres in extent, and is located in the vicinity of Applegate, Josephine County. Its many improvements bespeak his generous nature and progressive spirit, and here he conducted general farming and stock-raising, also made a specialty of fruit, and shipped the first carload of apples out of Josephine County.

All through life Mr. Swinden betrayed his sterling English ancestry in his devotion to duty and his strict regard for truth and reliability. He was born in Yorkshire, England, March 20, 1823, and in 1840 accompanied his parents to America, locating in Green[e] County, Ill. He was the oldest of 6 children, all of whom worked hard on the Illinois farm, yet his devotion to his adopted country stood the test of the war of 1847, when he enlisted in Company C, First Illinois Volunteer Infantry, under the command of Captain Fry, and participated in the battle of Buena Vista, as well as others of that memorable period. After being mustered out of the service he returned to Green County and continued to farm, and May 1, 1849, married Mrs. Elizabeth Jackson, a native of Scarborough, Yorkshire, England, and born May 10, 1829. Mrs. Swinden's father, Robert Woodall, was born in Yorkshire, May 13, 1805, and died in Winchester, Ill., whither he removed at an early day, about 1833, and where he engaged in farming and stockraising. His wife, Anne (Coltus) Woodall, was born in England May 10, 1805, and died in Winchester, Ill., in 1890.

Soon after his marriage, Mr. Swinden located in Scott County, Ill., and remained there until crossing the plains, September 27, 1851, being the date of his arrival in Oregon City. They met with considerable opposition from the Indians, and Mrs. Swinden lay sick for 9 weeks, her oldest daughter Mary A. having been born on the plains. The first winter the family spent at Butteville, Marion County, and in January, 1852, moved to Clackamas, where Mr. Swinden managed the mill of Cranfield & Matlock for a time.

Subsequently starting for southern Oregon, the Swinden's arrived in Jackson County the last of September, spending the winter in the mines in Jacksonville, where he endured many hardships through the limited supply of provisions. In July 1853, he bought 320 acres of land on Canes Creek, nine and a half miles north of Jacksonville, in Jackson County, where he farmed and engaged in mining until locating on the farm now owned by his widow in 1887.

Mr. Swinden participated in the Indian wars of 1853, and 1855-56. For a time he was in command of the fort at Dardanell, as a member of Captain Lambrick's company, and in the estimation of the men who fought with him in those troublesome times he was a remarkably brave and fearless man. His success in later life enabled him to give his children practical advantages, for he believed in education

and advancement, and took great pride in his interesting daughters and strong rugged sons. His oldest daughter, Sarah A., is deceased; the second daughter, Mary A., is the wife of J. W. Johnson, of Grants Pass; Georga A. is the wife of James M. Mansfield of Grants Pass; William H. lives on the home farm; Robert F. lives in Jackson County; John E. is a farmer in Josephine County; Olive E. is the wife of J. R. Stanley, of Washington; George W. is living at home; Charles L. is a farmer of Josephine County; Kate is a resident of Redding, Calif." Rhoda J. is the wife of F. W. Bedell, of Los Angeles, Calif.; and Agnes J. lives in Calif. Mr. Swinden was liked and respected for his noble traits of character, for his success in the face of difficulty, and for his example of a strong and honest English-American farmer.

* * * * *

A BRIEF SKETCH OF SAMUEL D. LOCKWOOD

Copied from p. 408, History of Adams County, Illinois, 1879.

This is another example of locating biogs or sketches of people from our area in histories of other counties further west.

John Yorcke Sawyer, the first circuit judge, ... appears enrolled as a lawyer December 7, 1820 . . . He was succeeded by one of the supreme judges whose name stands recorded as the first licensed lawyer in Illinois, May 14, 1819.

Samuel D. Lockwood, who was born in central New York, came to Illinois in 1818; stopped first at Kaskaskia, and finally settled in Jacksonville Illinois, made that place his residence until after being retired from the bench in 1848, he removed to Batavia, in Kane county, where he died about six years since.

He had an excellent education, a very refined mind, studious habits, and proverbial purity of character. Lifted early in life to the supreme bench, he honored the ermine as few others have. His appearance was appropriate and imposing--white-haired while yet young, of graceful form, dignified and courteous in demeanor, he was a model jurist, and if not possessing the higher native intellect of some who graced the supreme bench in the aggregate of qualification he was unexcelled. No public man of Illinois has passed under a longer period of constant observation and been clothed with as much of general confidence and respect. It might be said of him, as Daniel Webster said of Chief Justice Jay, that when the spotless ermine of the judicial robe fell on him it touched nothing less spotless than itself. Judge Lockwood's political connections were with the Whig and subsequently Republican party. . . .

Our own Morgan County 1879 History gives some references to Samuel, but does not mention where he died. And so, this again is given as an example to our far-flung family historians -- examine the history books of any county that your people may have wandered to - or any of their relatives. The history of our area may be found in books far to the West of us, just as we find the history of our forefathers in the eastern 13 colonies that eventually became the founding states of our nation.

* * * * *

THANKSGIVING. (From the front of a Thanksgiving card, November 1979)

THANKSGIVING is a day that is celebrated mainly in the heart...

It is a time when families seem closer and friendships dearer...

A time when troubles are forgotten and blessings are remembered...

Thanksgiving is that time of year when we gratefully say,

"This is a wonderful world we live in, after all."

And may your Editor add:

THANKS GIVING should not be confined to one specified Calendar day.

Let it become our habit to gratefully say

"Thank you Lord, this is a wonderful world we live in," every day!

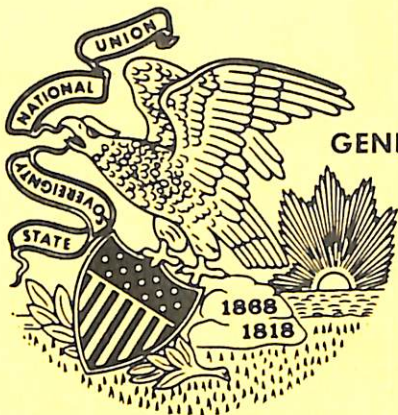

ANNUAL REPORT
GENERAL NOT FOR PROFIT CORPORATION ACT
(FILING FEE \$5.00)

SECRETARY OF STATE OF ILLINOIS

Annual Report 1979

N 5085-257-1
FILE NO.

SS 23-7430032

CORPORATE NAME JACKSONVILLE AREA GENEALOGICAL AND HISTORICAL SOCIETY
REGISTERED AGENT % FLORENCE HUTCHISON
REGISTERED OFFICE 629 S DIAMOND
CITY, STATE, ZIP CODE JACKSONVILLE, ILLINOIS 62650

USE A TYPEWRITER IN COMPLETING THIS REPORT

DO NOT WRITE IN THIS SPACE

FILING FEE . . . \$ _____

PENALTY . . . \$ _____

CLERK _____

1.) THE PRINTED INFORMATION ABOVE IS THE EXACT FORMAT MAINTAINED ON FILE BY THE SECRETARY OF STATE. IF ANY PORTION DOES NOT AGREE WITH YOUR RECORDS, YOU MUST ACQUIRE AND FILE PROPER FORMS FOR CORRECTION.

2.) THE ABOVE CORPORATION ORGANIZED UNDER THE LAWS OF THE STATE OF ILLINOIS, PURSUANT TO THE PROVISIONS OF "THE GENERAL NOT FOR PROFIT CORPORATION ACT" OF THE STATE OF ILLINOIS, HEREBY MAKES THE FOLLOWING REPORT

3.) THE NAMES AND RESPECTIVE ADDRESSES OF ITS OFFICERS AND DIRECTORS ARE:

| NAME | OFFICE | NUMBER AND STREET | CITY | STATE |
|--------------------------|-----------|-----------------------|---------------|----------------|
| Mrs. Florence Hutchison | PRESIDENT | 629 South Diamond, | Jacksonville, | Illinois 62650 |
| Mrs. Emily Sievers | SECRETARY | 211 Westgate Ave., | " | " |
| Mr. Marshall Robinson | TREASURER | 423 Southville, | " | " |
| Miss Lucille V. Crawford | DIRECTOR | 353 East State, | " | " |
| Mrs. Jane Coble | DIRECTOR | 1124 West Walnut, 42E | " | " |
| Mrs. Myra N. Martin | DIRECTOR | 359 East Tremont, | Waverly | 62692 |
| Mrs. Clara Wiese | DIRECTOR | 1836 Mound Avenue, | Jacksonville | 62650 |
| Mrs. Mabel Sheffer | DIRECTOR | Rte. 1, Box 246 | Carrollton | 62016 |
| Mr. Lester Penick | DIRECTOR | Rte. 2, | Franklin | 62638 |
| | DIRECTOR | | | |
| | DIRECTOR | | | |

NOTE: LIST ALL DIRECTORS ABOVE: ILLINOIS CORPORATIONS MUST HAVE AT LEAST **THREE** DIRECTORS.

4.) THE FOLLOWING IS A BRIEF STATEMENT OF THE CHARACTER OF THE AFFAIRS WHICH THE CORPORATION IS ACTUALLY CONDUCTING:

To preserve and perpetuate ancestral records of members and to assist each other in genealogical research for educational, patriotic and historical purposes; to discover, collect and preserve any materials which may help to establish or illustrate the history of west central Illinois counties; to encourage preservation and safeguarding of municipal, township, county and state public records, and promote publication of related materials for public use.