

I-235

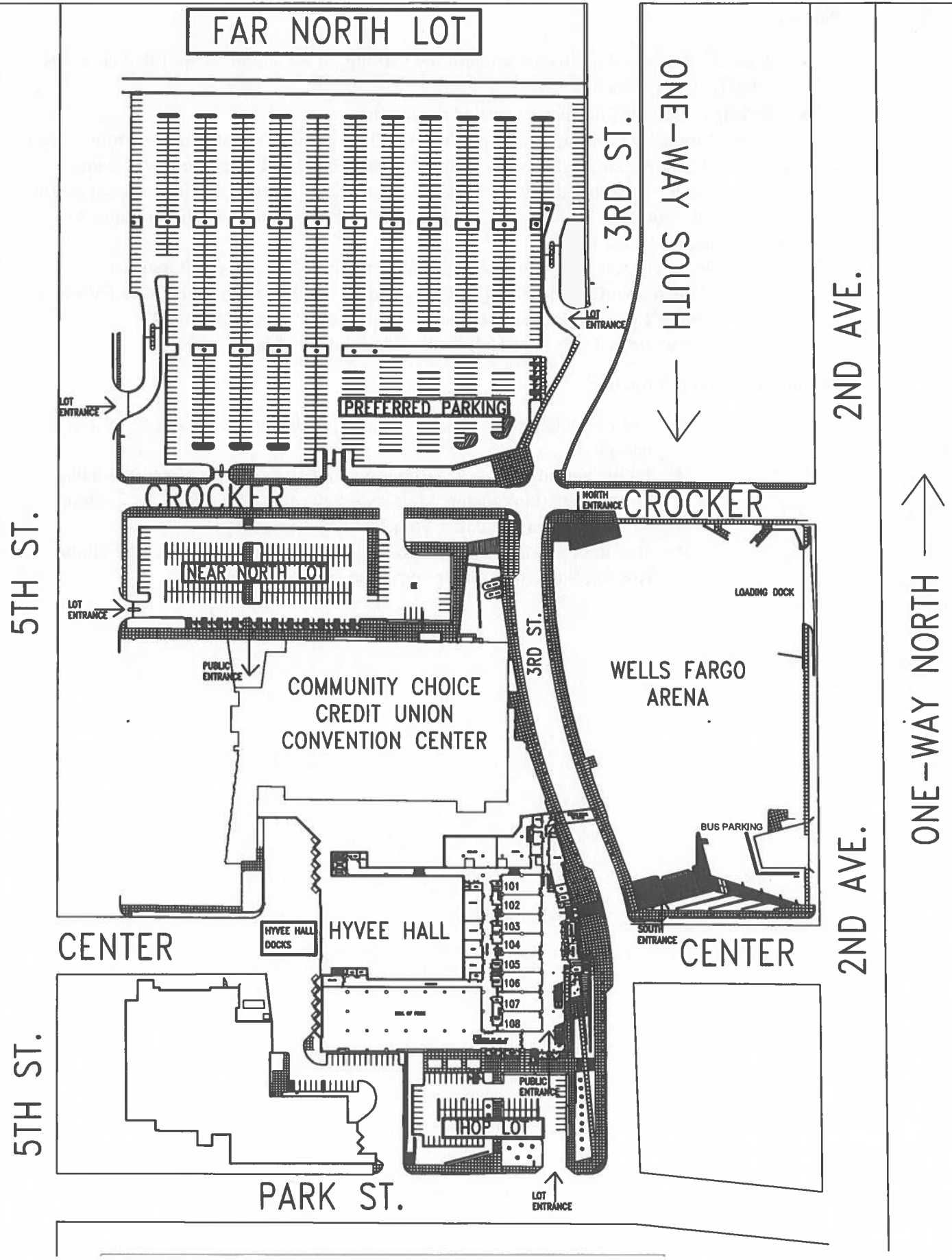

HY-VEE HALL & COMMUNITY CHOICE CREDIT UNION CONVENTION CENTER PARKING

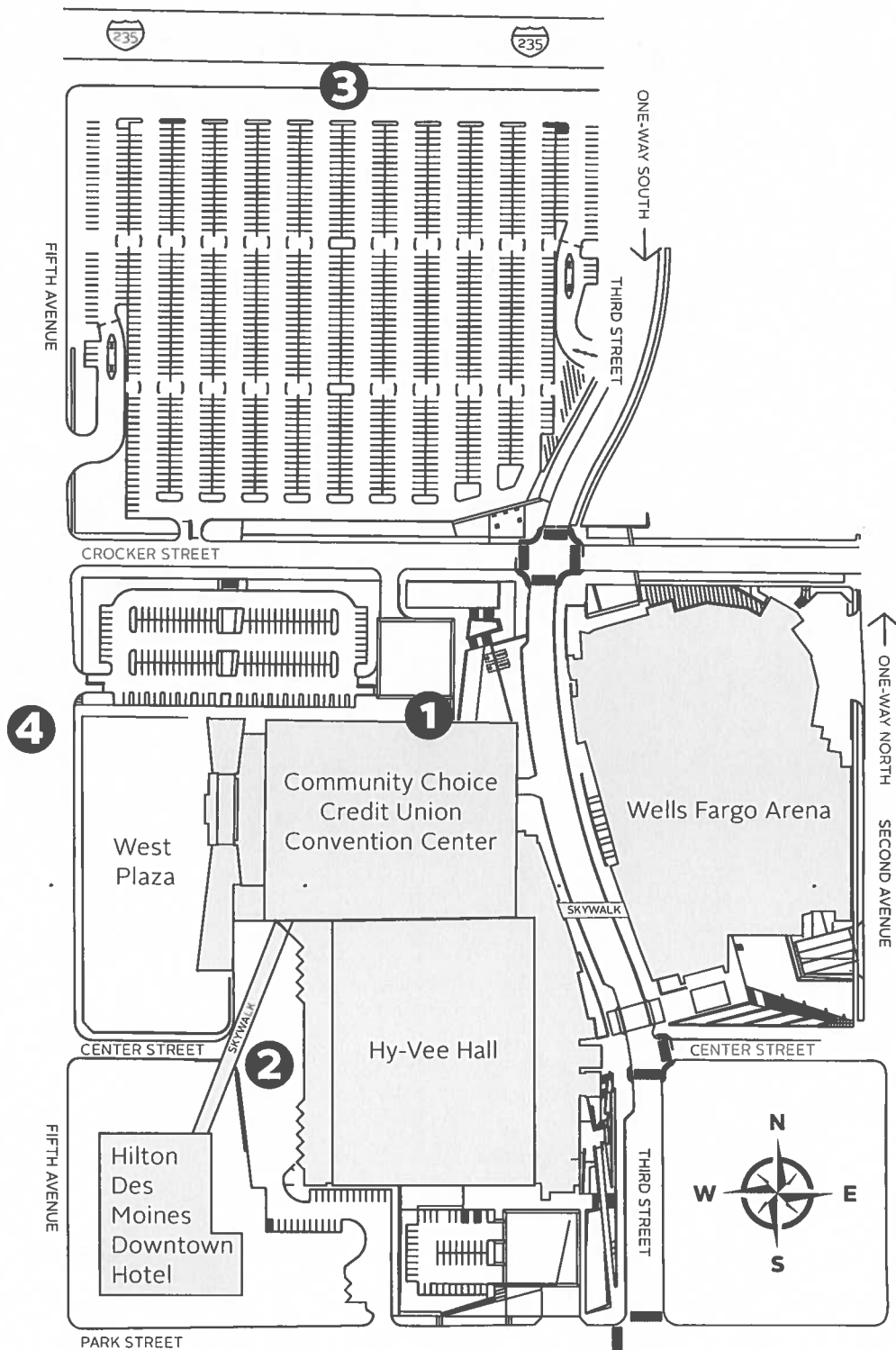

1) NORTH-SIDE ROLL-UP DOOR

- Accessed through Near North Parking Lot with entrance off of 5th St.
- Ground Level dock access for 300 & Ballroom level

2) HY-VEE HALL DOCKS

- Accessed via 5th and Center St. - West side of Hy-Vee Hall
- (10) total docks to be assigned based on availability

3) NORTH CURB OF IOWA EVENTS CENTER NORTH LOT

- Lot has 650 ft. of curb to park.
- Enter off 5th Ave North of Crocker. Exit 3rd Ave.

4) 5TH AVE. EAST SIDE NORTHBOUND

- 400 ft. of curb to park



CAMPUS MAP

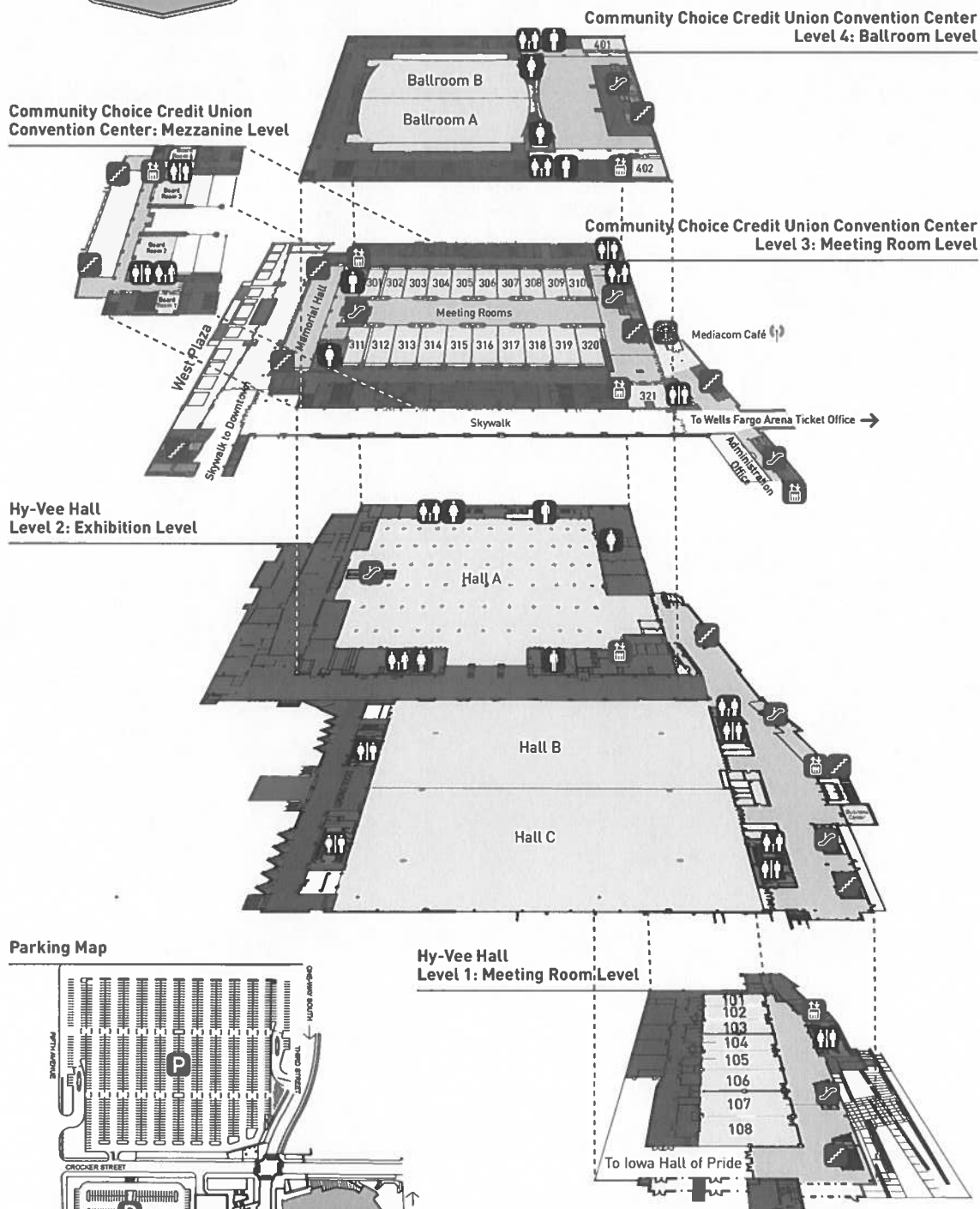

You Are Here

- Restroom
- Family Restroom
- Elevator
- Stairs
- Escalator
- Mediacom Café

Principal River's Edge Restaurant.....	515.564.8787
Iowa Events Center Administration Office.....	515.564.8000
Wells Fargo Arena Ticket Office.....	515.564.8300
Iowa Events Center Security Office (CSC).....	515.564.8100
Iowa Barnstormers Main Line.....	515.564.8450
Iowa Energy Main Line.....	515.564.8550
Iowa Wild Main Line.....	515.564.8700
Iowa Hall of Pride.....	515.564.8507

Proudly Managed By:
GLOBAL SPECTRUM
A Division of Spectrum Management

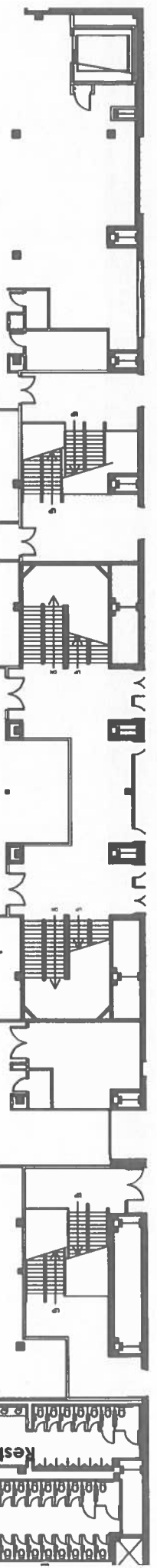

- 301 302 303 304 305 306 307 308 309 310

- 10 11 12 13 14 15 16 17 18 19 20 21 22 23

34	33	32	31
35	36	37	38

30	29	28	27	26	25	24
39	40	41	42	43	44	45

Raffle Area

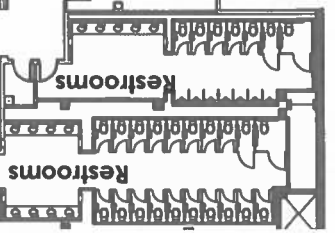

MON/TUES

- 25 1 2 3 4
24 123 122 121 120

59	58	57	56	55	54	53
60	61	62	63	64	65	

52	51	50	49	48	47	46
66	67	68	69	70	71	72

Food

FEB 10-11TH

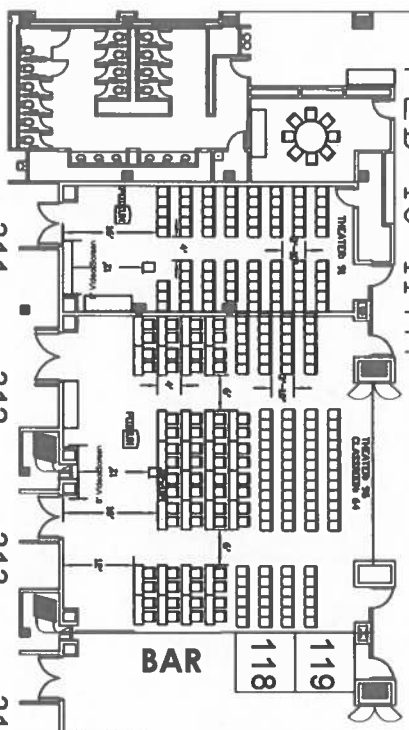

- 311 312 313 314 315 316 317 318 319 320

- 117 116 115 114 113 112 111 110 109 108 107 106 105 104 103

85	84	83	82	81
86	87	88	89	90

80	79	78	77	76	75	74	73
91	92	93	94	95	96	97	98

- 99 100 101 102



Sportsman Raffle Storage

