

# IsoPod CANbus PT

## Pressure Transmitter

- ✓ CAN Open CiA443
- ✓ Range 0-1500 bar
- ✓ ISO 13628-6:2006 Compliant
- ✓ Redundant
- ✓ Designed for 4500 m water depth
- ✓ Total Accuracy < 0.5 % FS
- ✓ Fast response time (3 ms)
- ✓ Sputtered Thin-film technology
- ✓ EB welded diaphragm
- ✓ For harsh environments



The IsoPod CANbus pressure transmitter represents the next generation pressure sensors. Based on our thin-film strain gauge measuring technology sputtered on our unique semi-flush diaphragm well proven in our 4-20Ma sensor for over 25 years.

Our thin-film strain gauge measuring technology sputtered on the Hastelloy diaphragm is superior at both dynamic and static measurements for long life-time and high-pressure applications. Mechanical parts made in Inconel 625 ensure superior strength and excellent material properties.

Highly skilled personnel manufacture, Calibrate and perform extensive ESS-tests according to established procedures.

The IsoPod PT is digitally calibrated and temperature compensated. Extensive pressure & temperature cycling tests guarantee this pressure transmitter to be the right choice for subsea installations.

#### Typical Applications are:

- ✓ Subsea Control Modules
- ✓ Subsea Processing
- ✓ Subsea Pumps
- ✓ Subsea Measurements



*"The Scan Sense IsoPod PT borrows its name from the Giant isopod. These creatures live on the seabed in the abyss of the open sea down to 2,150 meters, where pressure is high. Their bodies are dorso-ventrally compressed, protected by a rigid, calcareous exoskeleton. The large eyes are compound with nearly 4,000 facets, for perfect sensing in the dark, cold and deep waters."*

[www.scansense.no](http://www.scansense.no)

Manufactured by: **ScanSense AS**, Åsgårdstrandsveien 359, 3179 Åsgårdstrand, Norway

Phone: +47 33 36 30 00, Fax: +47 33 36 30 01, E-mail: [post@scansense.no](mailto:post@scansense.no)

## Technical information

<b>Pressure Range/ Full Scale</b>	0-1500 bar
<b>Total Accuracy</b>	± 0,5 % of Full Scale
<b>Long Term Drift</b>	< ± 0,1 % of Full Scale / Year
<b>Output Signal</b>	CANopen, fault tolerant and high speed
<b>Supply Voltage</b>	12-30 Vdc
<b>Typical Response Time</b>	< 3 ms
<b>Stabilization after power up</b>	< 2 s
<b>Safe Overpressure</b>	1.5 x Full Scale
<b>Burst Pressure</b>	> 3 x Full Scale
<b>Operation Temperature</b>	-5 °C to +45 °C
<b>Design and Test Temperature</b>	-18 °C to +70 °C
<b>Calibrated temperature range</b>	-5 °C to +70 °C
<b>Storage Temperature</b>	-40 °C to +80 °C
<b>Protections</b>	Inverted Polarity Transient Protection according to CiA443
<b>Materials</b>	Pressure port and housing: Inconel 625 Diaphragm: Hastelloy C-22 Boot seal: HNBR
<b>Pressure Fitting</b>	Flange spigot
<b>Connection</b>	Subsea connector, 1m flying leads
<b>Weight</b>	125 g (sensor without booted plug and wires)
<b>Documentation</b>	SMDR, GA drawing and FAT report in MRB

Note: Due to continuous product improvements, published specifications may change without notice.

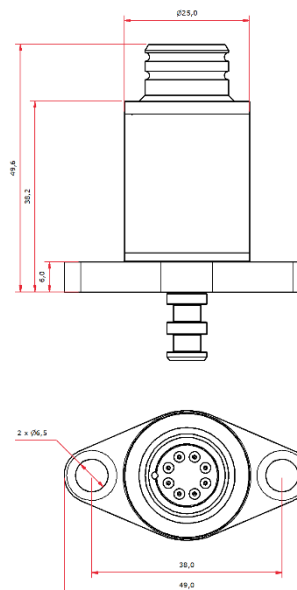

ScanSense AS is a Norwegian company specializing in design and manufacturing of high-quality sensor solutions for pressure, load and force. The company has more than 30 years of experience of making tailor-made solutions for the oil and gas industry.