

PROJECT:
BAYSIDE DEVELOPMENT - MULTI-FAMILY BUILDING C

LOCATION:

CLIENT:

RELEASE:
SCHEMATIC DESIGN

REVISIONS:

#	DATE	DESCRIPTION

NORTH ARROW:

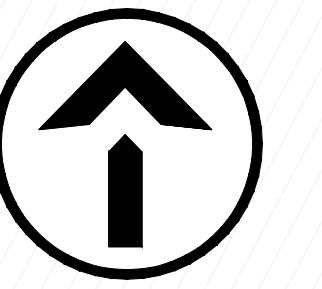

SEAL:

all in

SHEET:
OVERALL STORM WATER PLAN

PROJECT MANAGER: DMJ
PROJECT NUMBER: 210709.01
DATE: 10.10.2022

SHEET NUMBER:
SWMP

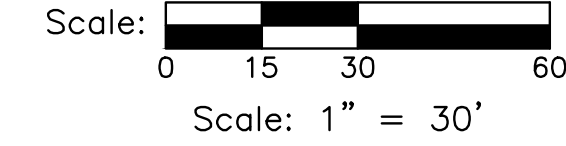
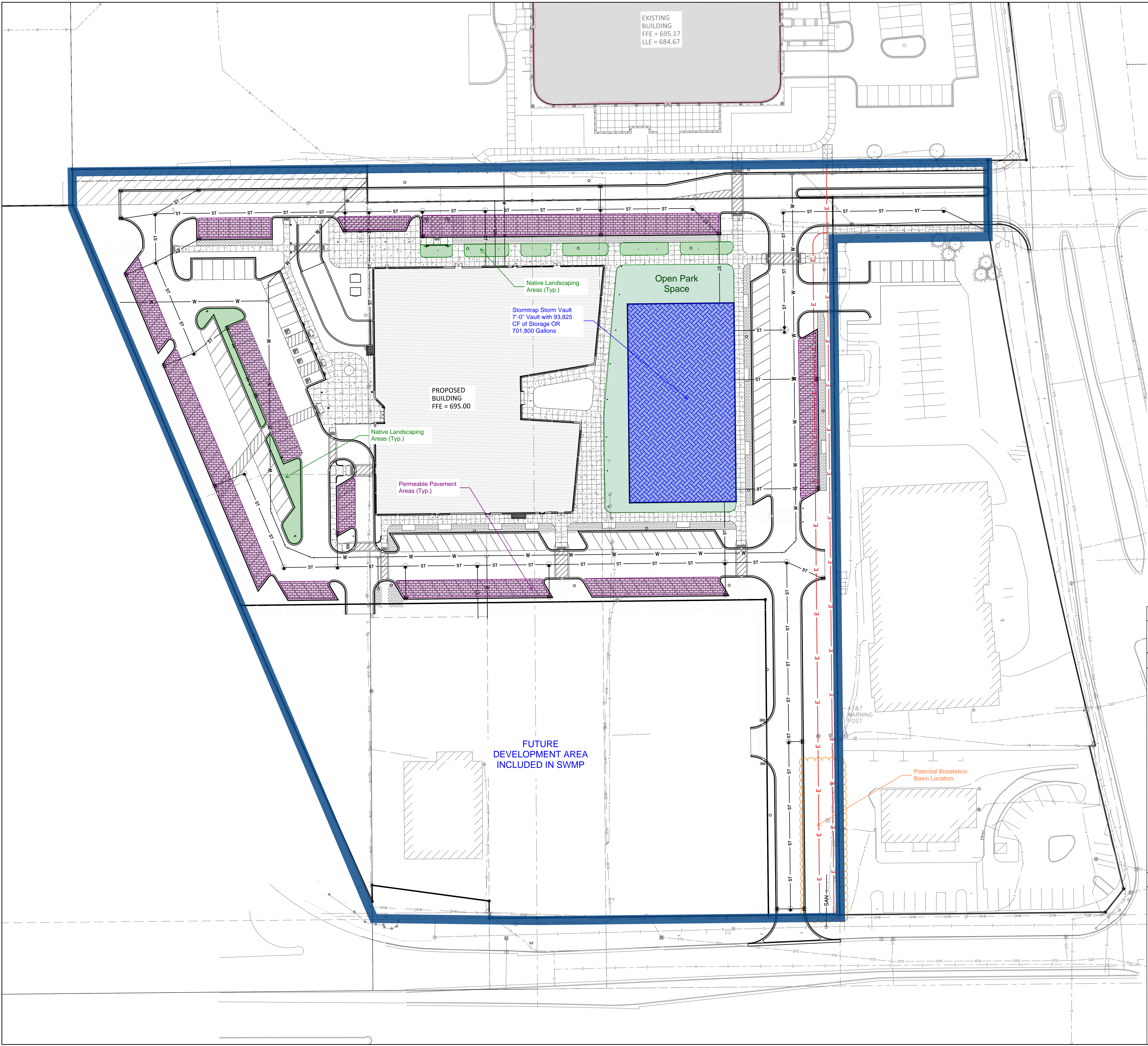

Dial 811 or (800)242-8511

www.DiggersHotline.com

UTILITY NOTES

- PROJECT LIMITS**
- KNOWN UTILITY AND POTENTIAL CONFLICT EXIST WITH EXISTING UNDERGROUND UTILITIES. PRIOR TO UTILITY INSTALLATION, CONTRACTOR TO EXCAVATE AND EXPOSE EXISTING UTILITIES, VERIFY LOCATIONS AND ELEVATIONS, AND CONTACT ENGINEER IF CONFLICTS EXIST WITH PROPOSED CONSTRUCTION AND EXISTING UNDERGROUND UTILITIES.
- CAUTION**
- PER PROJECT SPECIFICATIONS AND THE STANDARD SPECIFICATIONS FOR SEWER AND WATER CONSTRUCTION IN WISCONSIN, THE POINT OF COMMENCEMENT FOR THE LAYING OF SEWER PIPE SHALL BE AT THE LOWEST POINT IN THE PROPOSED SEWER LINE. THE PIPE SHALL BE LAD WITH THE BELL END OF THE BELL AND SPIGOT PIPE, OR WITH THE RECEIVING GROOVE END OF THE TONGUE AND GROOVE PIPE. FRONTING UPGRADE: WHEN A NEW SEWER IS TO BE CONNECTED TO AN EXISTING SEWER NOT TERMINATING IN A MANHOLE, THE CONTRACTOR SHALL UNCOVER THE EXISTING SEWER TO ALLOW ANY ADJUSTMENTS IN LINE AND GRADE TO BE MADE BEFORE PIPE IS LAID.
 - THE UNDERGROUND AND OVERHEAD UTILITY INFORMATION AS SHOWN HEREON IS BASED, IN PART, UPON INFORMATION FURNISHED BY UTILITY COMPANIES, LOCAL MUNICIPALITY, PROPERTY OWNER, AND DIGGERS HOTLINE. WHILE THIS INFORMATION IS BELIEVED TO BE RELIABLE, ITS ACCURACY AND COMPLETENESS CANNOT BE GUARANTEED NOR CERTIFIED TO.
 - GENERAL CONTRACTOR OR THEIR SUB CONTRACTORS SHALL APPLY FOR AND OBTAIN ALL THEIR REQUIRED PERMITS AND APPROVALS PRIOR TO THE START OF THEIR WORK. CONSULT WITH AND OBTAIN FROM ENGINEER COPIES OF ENGINEERING DESIGN APPROVAL PERMITS, INCLUDING BUT NOT LIMITED TO WORK, STATE OR LOCAL PLUMBING, WDOT, COUNTY, AND STORM WATER MANAGEMENT.
 - GENERAL CONTRACTOR OR THEIR SUB CONTRACTORS SHALL CONTACT DIGGERS' HOTLINE TO ALLOW THEM SUFFICIENT TIME TO LOCATE EXISTING UTILITIES PRIOR TO COMMENCEMENT OF WORK.
 - GENERAL CONTRACTOR OR THEIR SUB CONTRACTORS ARE RESPONSIBLE FOR COORDINATING THEIR WORK WITH ALL OTHER CONTRACTORS.
 - GENERAL CONTRACTOR OR THEIR SUB CONTRACTORS ARE RESPONSIBLE FOR VERIFYING OWNERSHIP OF AND COORDINATING THE DEMOLITION AND/OR RELOCATION OF ALL EXISTING UTILITIES FROM EXISTING BUILDINGS AND WITHIN THE PROJECT LIMITS, INCLUDING BUT NOT LIMITED TO ELECTRICAL/FIBER OPTIC/TELEPHONE/CABLE/GAS/WATER/SANITARY/STORM. DEMOLITION OF THIS UTILITY WORK MUST BE IN ACCORDANCE WITH ALL STATE, FEDERAL, & LOCAL REGULATIONS.
 - FOR ALL WORK, GENERAL CONTRACTOR OR THEIR SUB CONTRACTORS ARE RESPONSIBLE FOR REVIEWING BID DOCUMENTS, VERIFYING THE VERTICAL AND HORIZONTAL LOCATION OF ALL EXISTING UTILITIES WITHIN THE PROJECT LIMITS, AND INCLUDE IN THEIR CONTRACT THE RELOCATION OF SAID UTILITIES (NOTED OR NOT ON THE BID DOCUMENTS) AS NECESSARY TO PROVIDE PROPER DEPTH/CLEARANCE PER UTILITY OWNER'S REQUIREMENTS.

KEY INDEX

—	PROJECT LIMITS	
●	STORM MANHOLE	21 (2204)
■	STORM CATCH BASIN WITH CURB BOX FRAME & GRATE	24 (2204)
□	RCP APRON ENDWALL	27 (2205) 28 (2205)
▭	RIP RAP	27 (2205)
⊥	WATER MAIN TEE	
⊗	WATER MAIN VALVE	
—	STORM SEWER	
—	SANITARY SEWER	
—	WATER MAIN	