

**BAYSIDE  
MIDDLE  
SCHOOL  
OVERVIEW**

# Traffic Management Factors and Concepts Examined Current and Proposed

- Pedestrian Safety
- Vehicle Safety
- Separation of Bus and Parent Pickup
- Neighboring property impacts
- On site traffic flow
- Off site traffic flow and impacts
- Infrastructure and ROW impacts
- Current/future bus count
- Current volume of parent pickup vehicles
  - 6 observation dates,
    - all over 60 vehicles
    - Four over 70 vehicles
    - Two over 80 vehicles
- Impervious surface
- Stormwater management
- Other mitigating/limiting factors

# Current Conditions

## (Prior to Safety Fencing Installation)

- Significant concern for Pedestrian and Vehicular Safety
- Multiple building exit points/ pickup points
  - Maitland
  - King
  - Ellsworth
  - Standish
  - School Protocol: Parking Lot
- Current volume of parent pickup vehicles
  - 6 pick up observations
    - all over 60 vehicles
    - Four over 70 vehicles
    - Two over 80 vehicles
- Current conditions are extremely unsafe

# School Pickup Observation

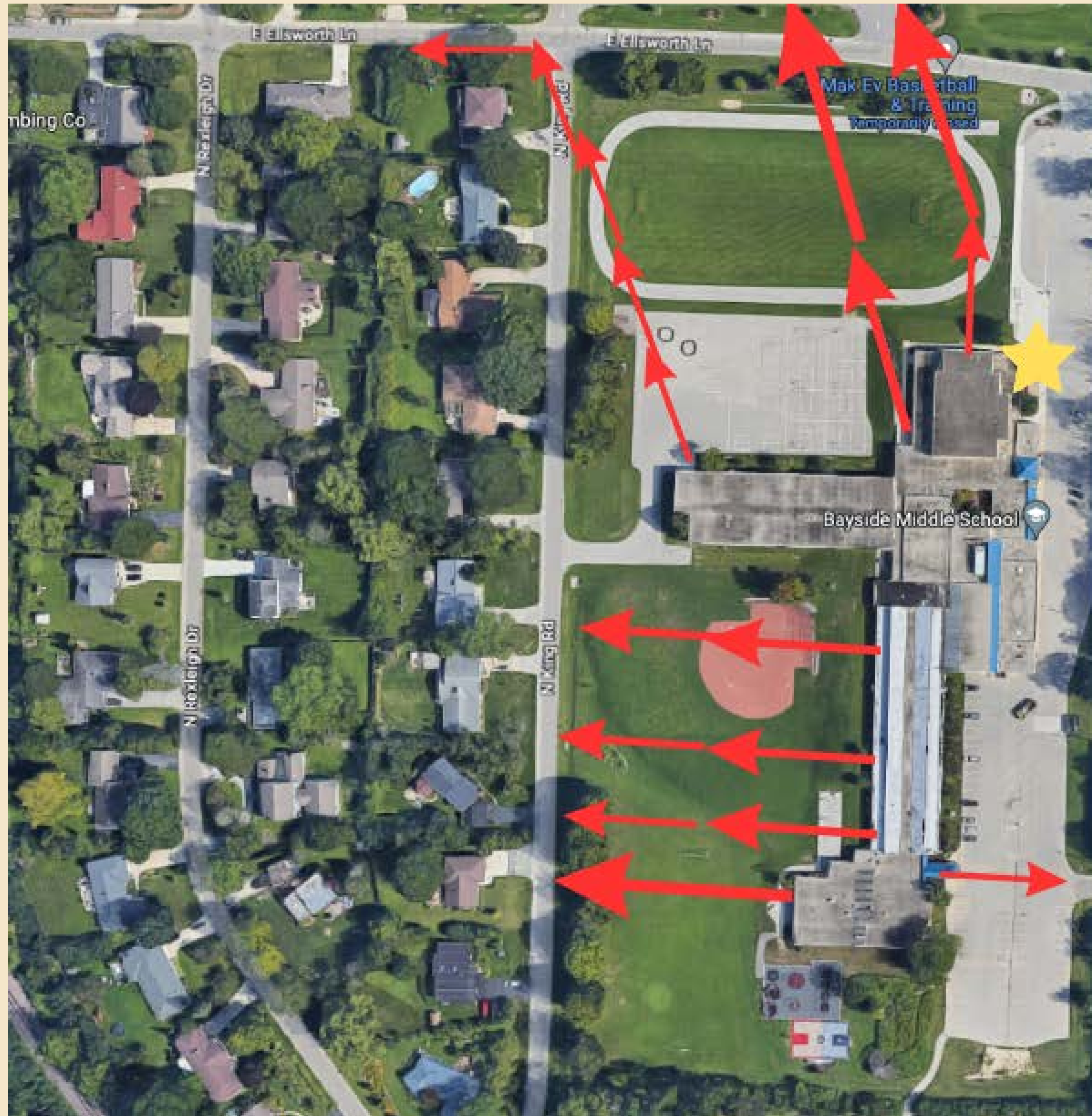

**Observations on  
Wednesday, April 19, 2023  
Conditions: Rain**

- Roughly 80 cars present for pick up
- Cars lined on Ellsworth Lane, King Road, and Ellsworth Park parking lot. Unable to observe Maitland.
- Ellsworth Park parking lot used as a pick-up site.
- Children walking between cars to cross streets.
- Cars driving on the wrong side of the street due to cars parking on the road.
- Cars driving at each other in wrong lanes of traffic.
- Cars driving in the shoulder/ditch.
- Numerous students exiting side doors/not the main exit.
- Cars making U-turns in the middle of streets and obstructing traffic.
- Children walk to cars rather than cars driving to children.



Cars lined up along  
Ellsworth Ln, past King Rd,  
almost to Rexleigh Dr.

3:31pm

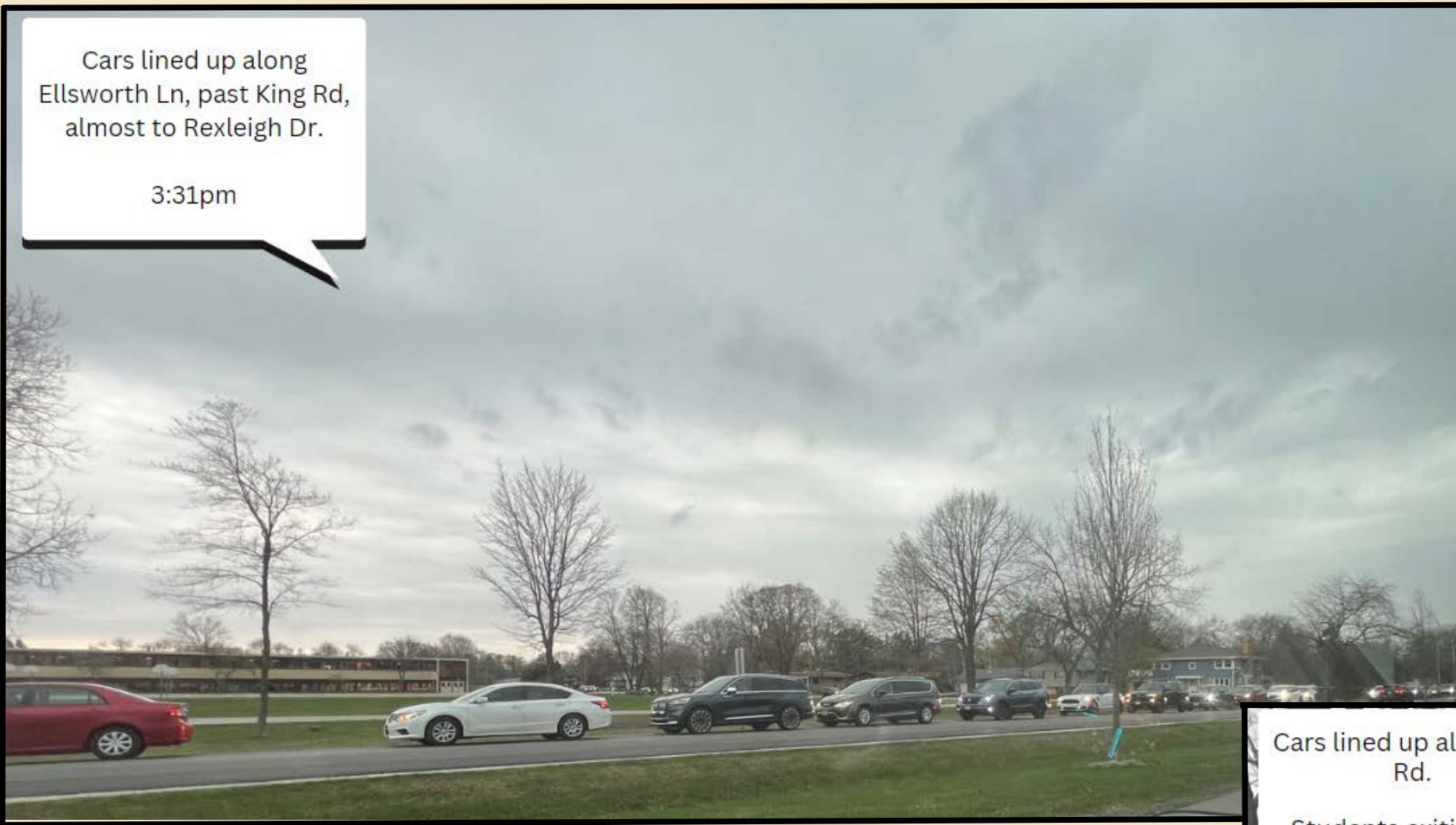

## Present conditions of school pickup

Cars lined up along King  
Rd.

Students exiting side  
doors to reach these  
cars.





Cars lined up to  
Rexleigh Dr.



## Present conditions of school pickup

Cars utilizing Ellsworth  
Park as a pick up  
location (kids crossing  
the the street between  
cars).





Cars utilizing Ellsworth Park as a pick up location (kids crossing the the street between cars).



## Present conditions of school pickup

Cars utilizing King Rd for pick up, parking in the shoulder.

Cars driving on the wrong side of the road to get around them.





Cars driving directly at each other (the wrong direction) down Ellsworth Lane.



## Present conditions of school pickup

Cars driving directly at each other down Ellsworth Lane.  
Car driving in the shoulder and grass to avoid collision.





Cars driving the wrong direction due to cars parking at the intersection of Ellsworth and King.



## Present conditions of school pickup

Cars making U-turns in the middle of Ellsworth due to students walking to cars rather than cars driving to the pick up location.





Cars attempting to leave the pick up line, driving on the wrong side of the street, because children walk to cars.



## Present conditions of school pickup

Cars driving the wrong direction down the street to move around pick up line.

(Blue car)





# Traffic Management Concepts Examined

- Eight drawn concepts have been examined
- Countless undrawn/brainstorming concepts have been discussed.

# School District Recommended Concept

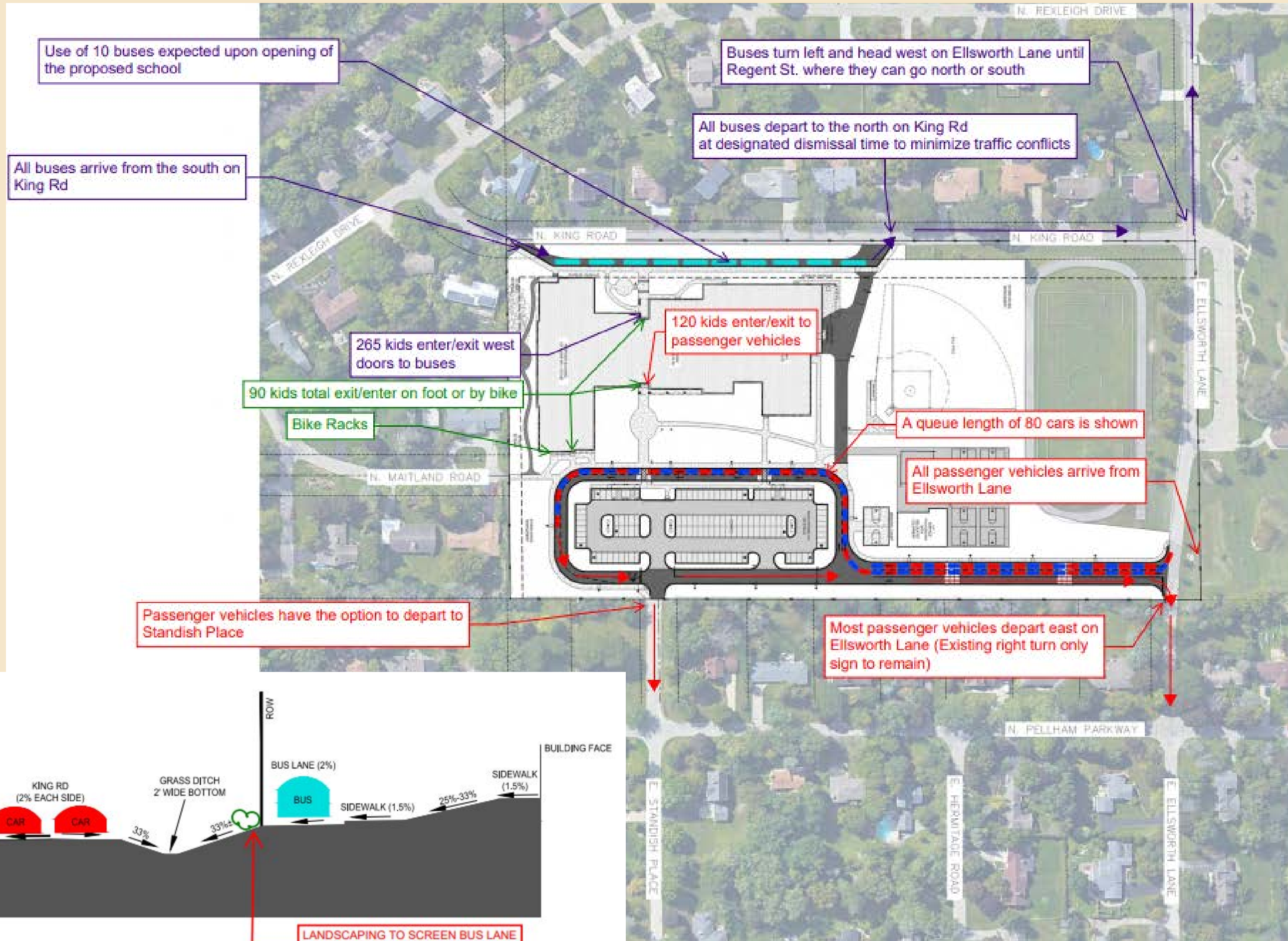

**eua**

PROJECT INFORMATION:  
**BAYSIDE MIDDLE SCHOOL**

601 E ELLSWORTH LN, BAYSIDE, WI 53217

DATE	DESCRIPTION

**kapur**

7112 N. Hart Washington Road  
 Menasha, Wisconsin 53217  
 kapurinc.com

SHEET INFORMATION:  
**PROGRESS DOCUMENTS NOT FOR CONSTRUCTION**

PROJECT MANAGER: TS  
 PROJECT NUMBER: 1814402  
**WEST BUS LANE**  
**FIGURE 1**

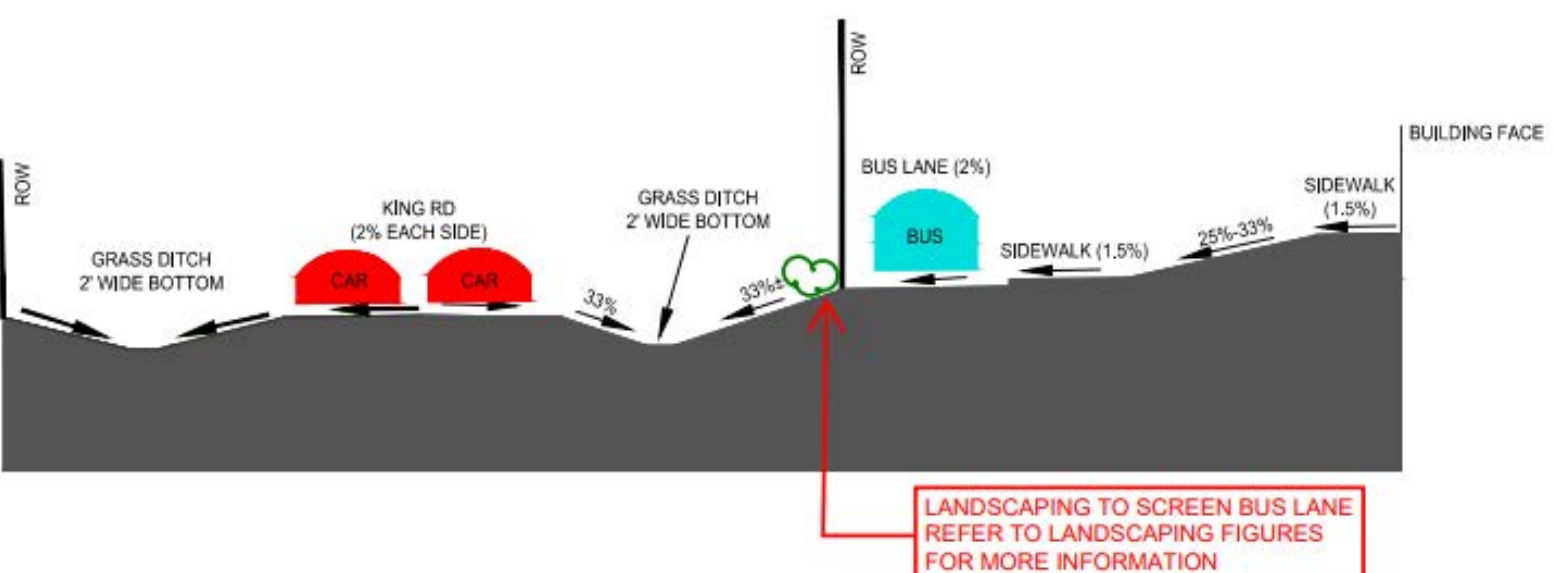



# Option 'A'

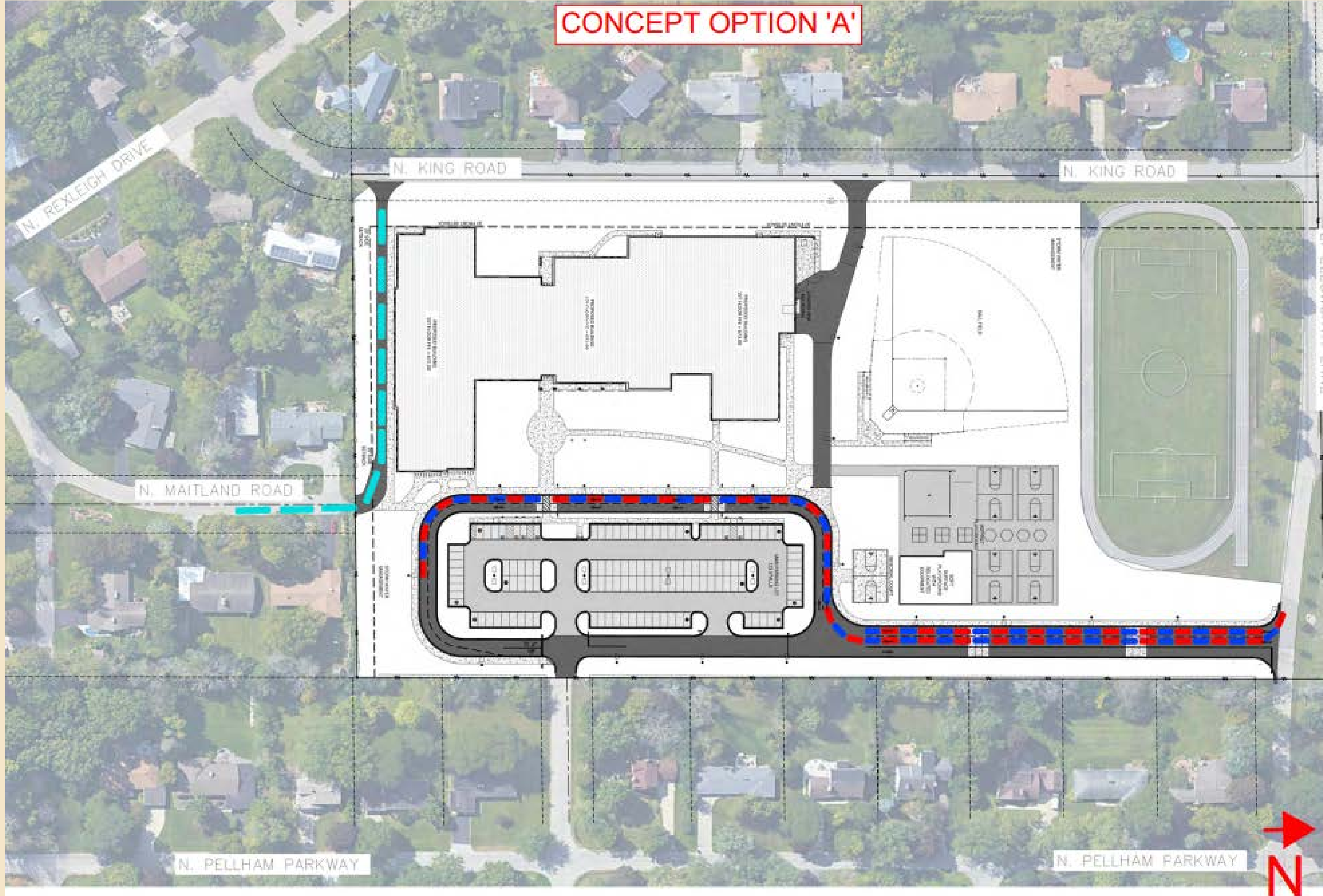

**eua**

**PROJECT INFORMATION**  
**BAYSIDE MIDDLE SCHOOL**  
 601 E ELLSWORTH LN, BAYSIDE, WI 53217

**DATE AND REVISIONS**

DATE	DESCRIPTION
08/14/2018	ISSUE FOR PERMITTING
08/14/2018	ISSUE FOR PERMITTING
08/14/2018	ISSUE FOR PERMITTING
08/14/2018	ISSUE FOR PERMITTING
08/14/2018	ISSUE FOR PERMITTING
08/14/2018	ISSUE FOR PERMITTING
08/14/2018	ISSUE FOR PERMITTING
08/14/2018	ISSUE FOR PERMITTING
08/14/2018	ISSUE FOR PERMITTING
08/14/2018	ISSUE FOR PERMITTING

**KEY PLAN**

**kapur**

1741 N. Park Washington Road  
 Milwaukee, Wisconsin 53217  
 kapur.com

**PROGRESS DOCUMENTS NOT FOR CONSTRUCTION**

PROJECT MANAGER: [Name]  
 PROJECT NUMBER: 181442

**SOUTH BUS LANE**

**FIGURE 4**









# Option 'C'

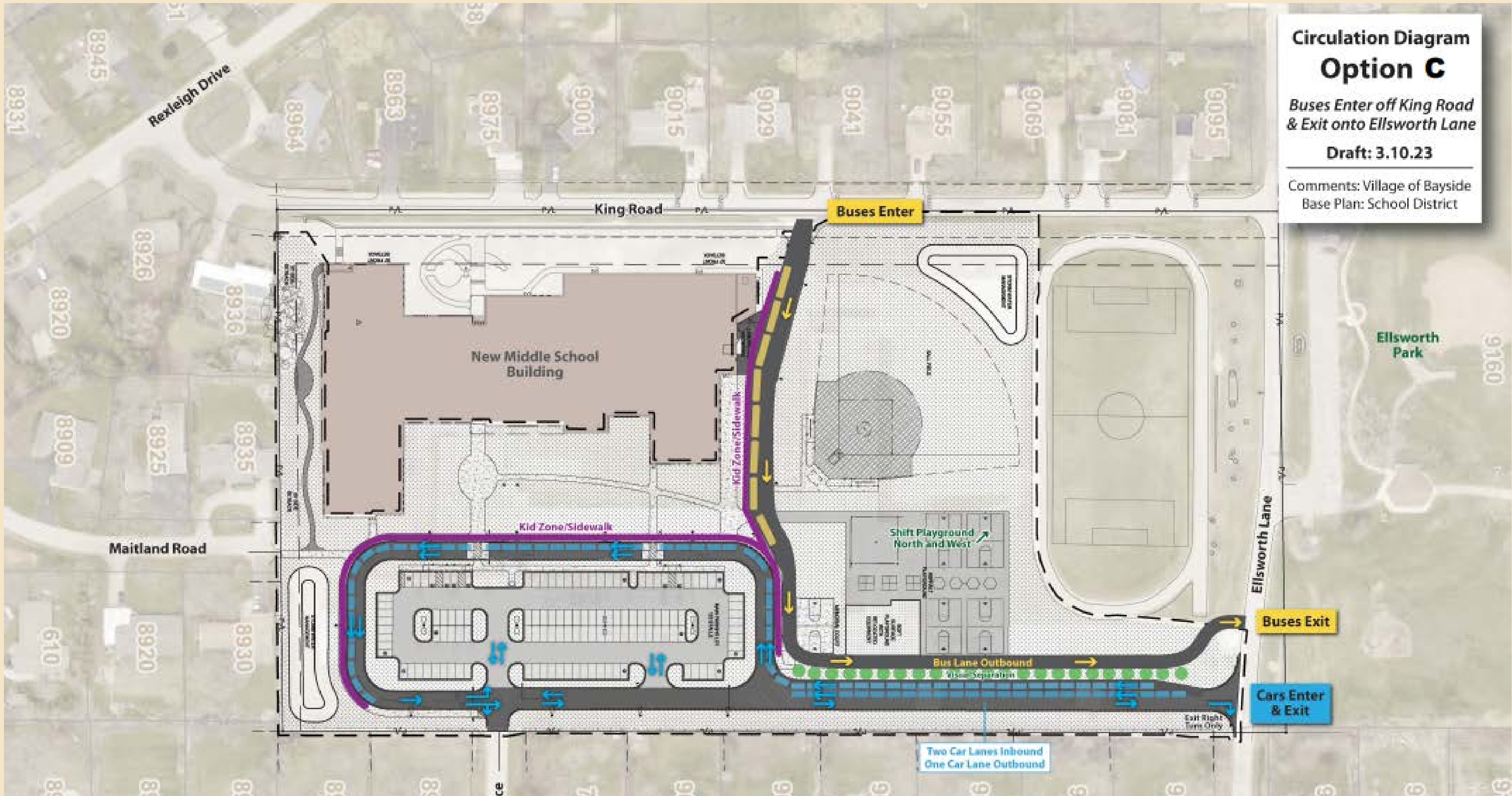

**Circulation Diagram**  
**Option C**  
*Buses Enter off King Road & Exit onto Ellsworth Lane*  
**Draft: 3.10.23**  
Comments: Village of Bayside  
Base Plan: School District



# Option 'D'

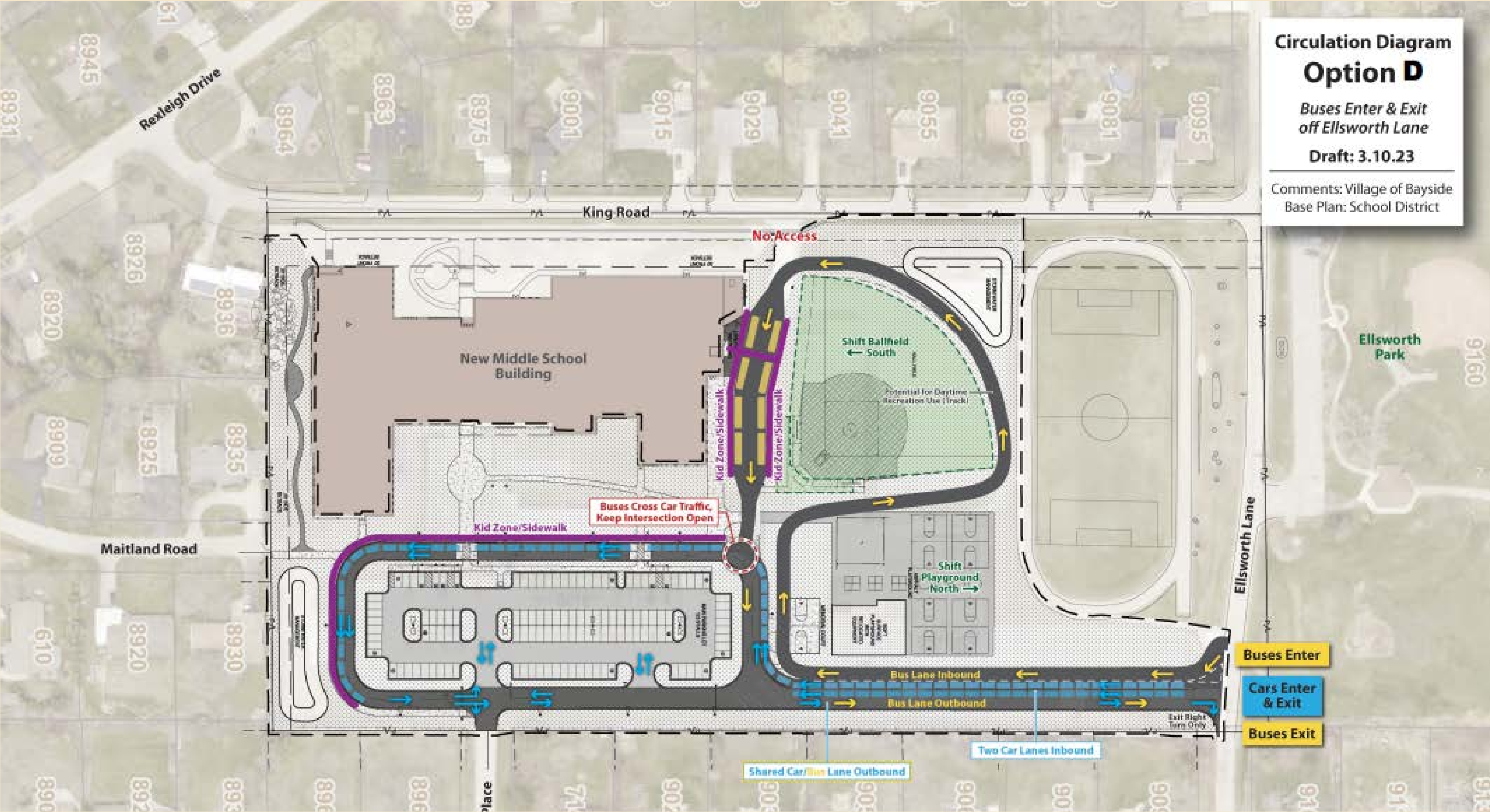



# Option 'E'

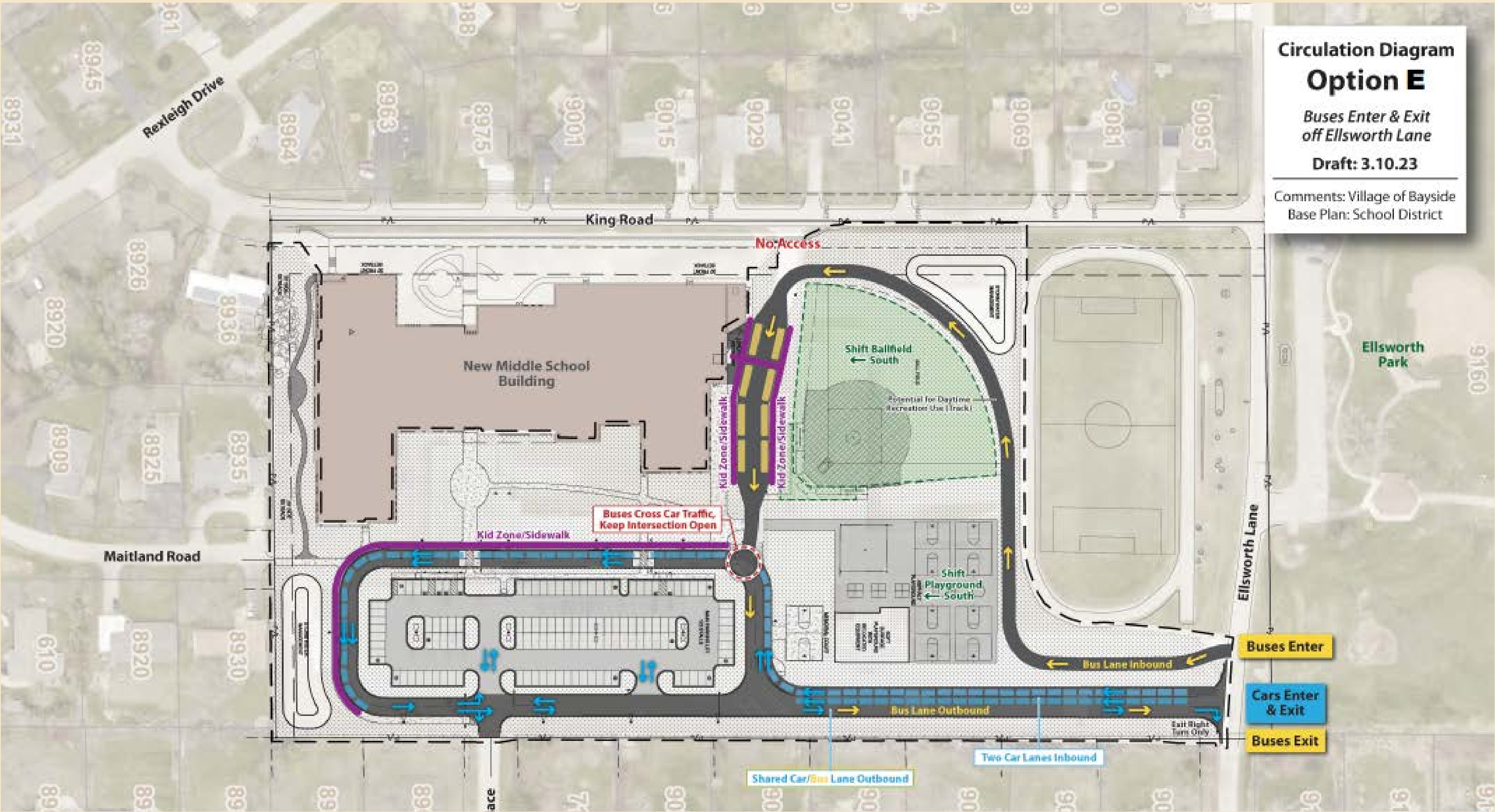



# Option F

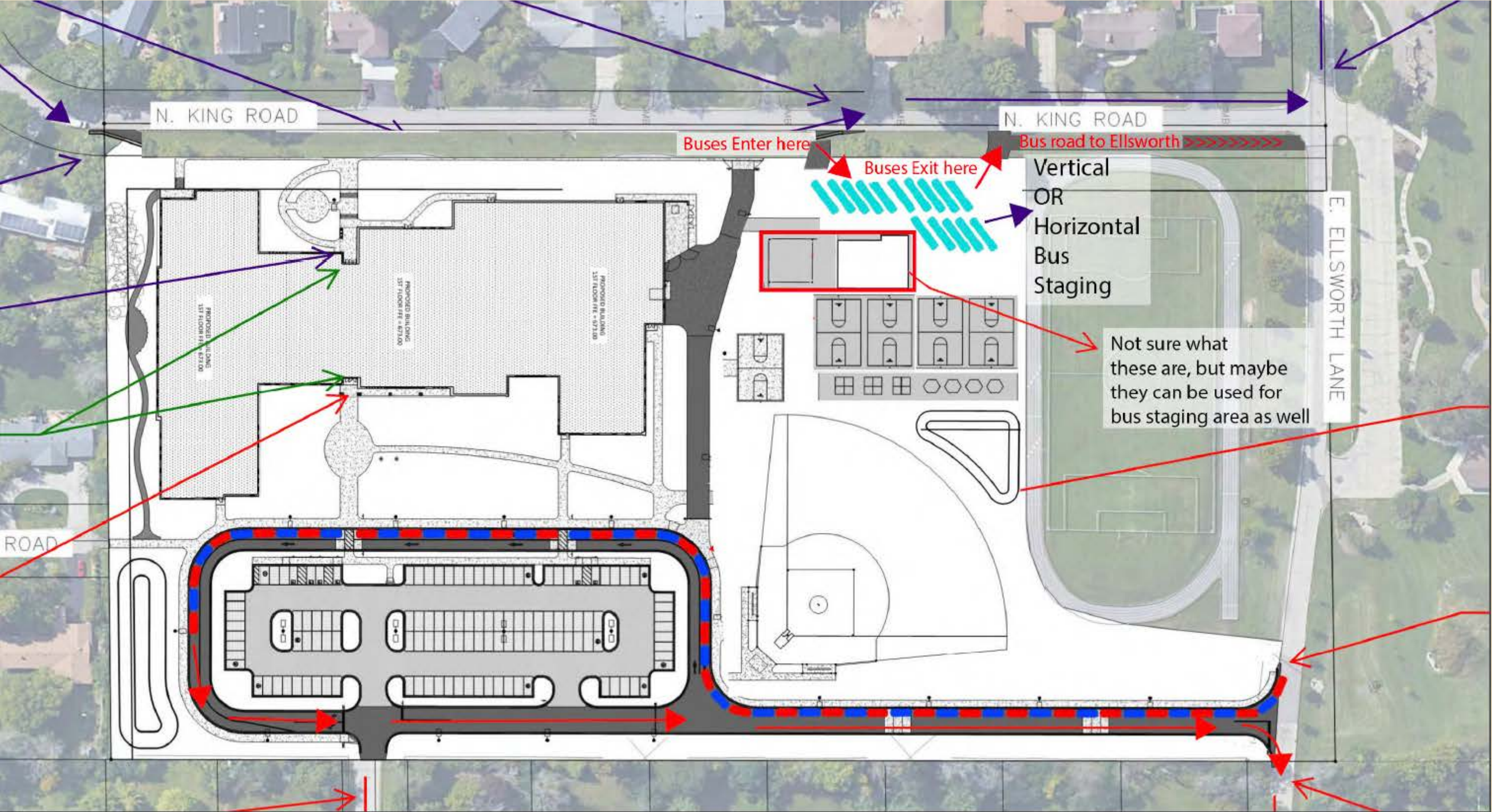



# Option G

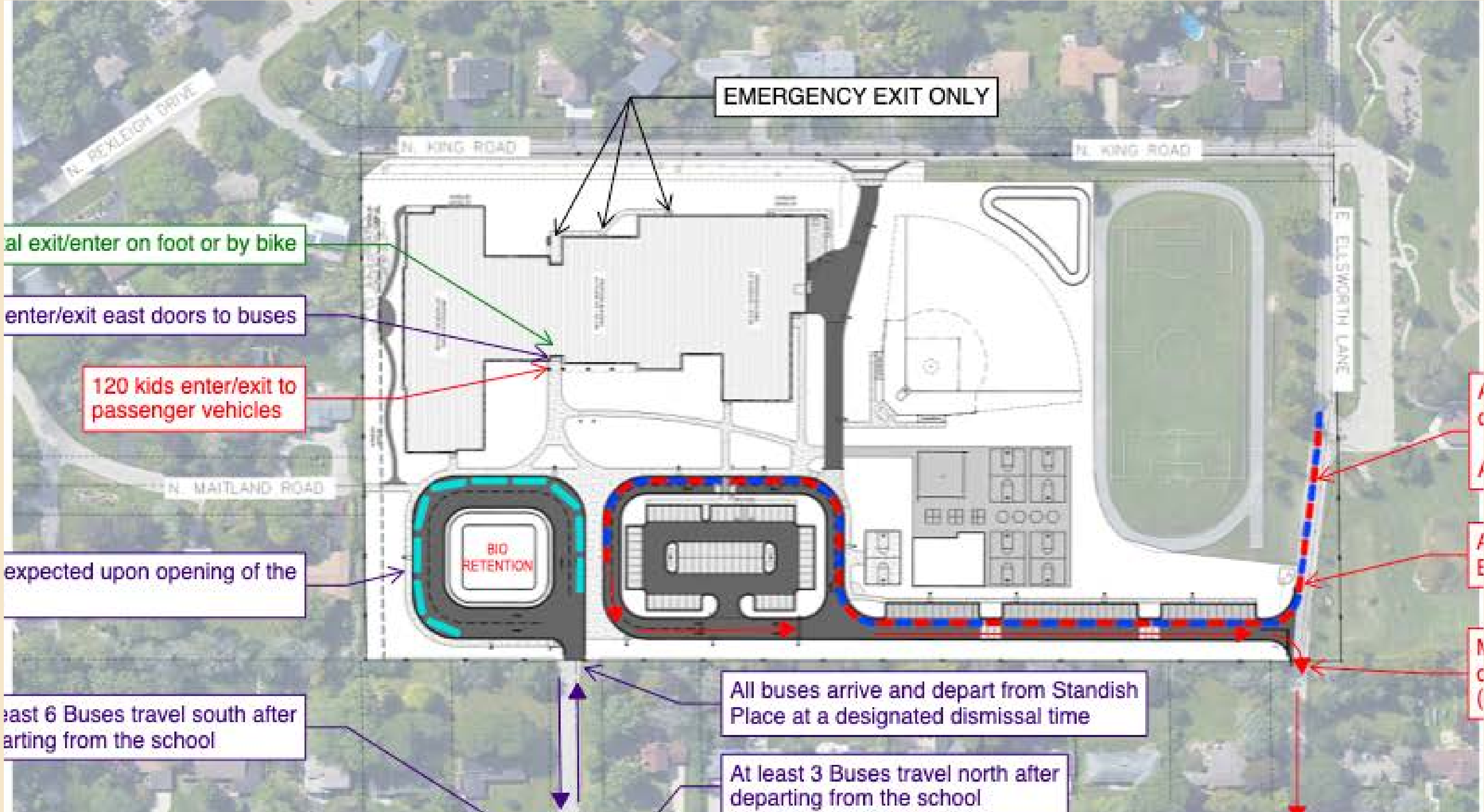

al exit/enter on foot or by bike

enter/exit east doors to buses

120 kids enter/exit to passenger vehicles

expected upon opening of the

At least 6 Buses travel south after departing from the school

EMERGENCY EXIT ONLY

All buses arrive and depart from Standish Place at a designated dismissal time

At least 3 Buses travel north after departing from the school

A C  
A E  
M C



# Landscape/ Aesthetics

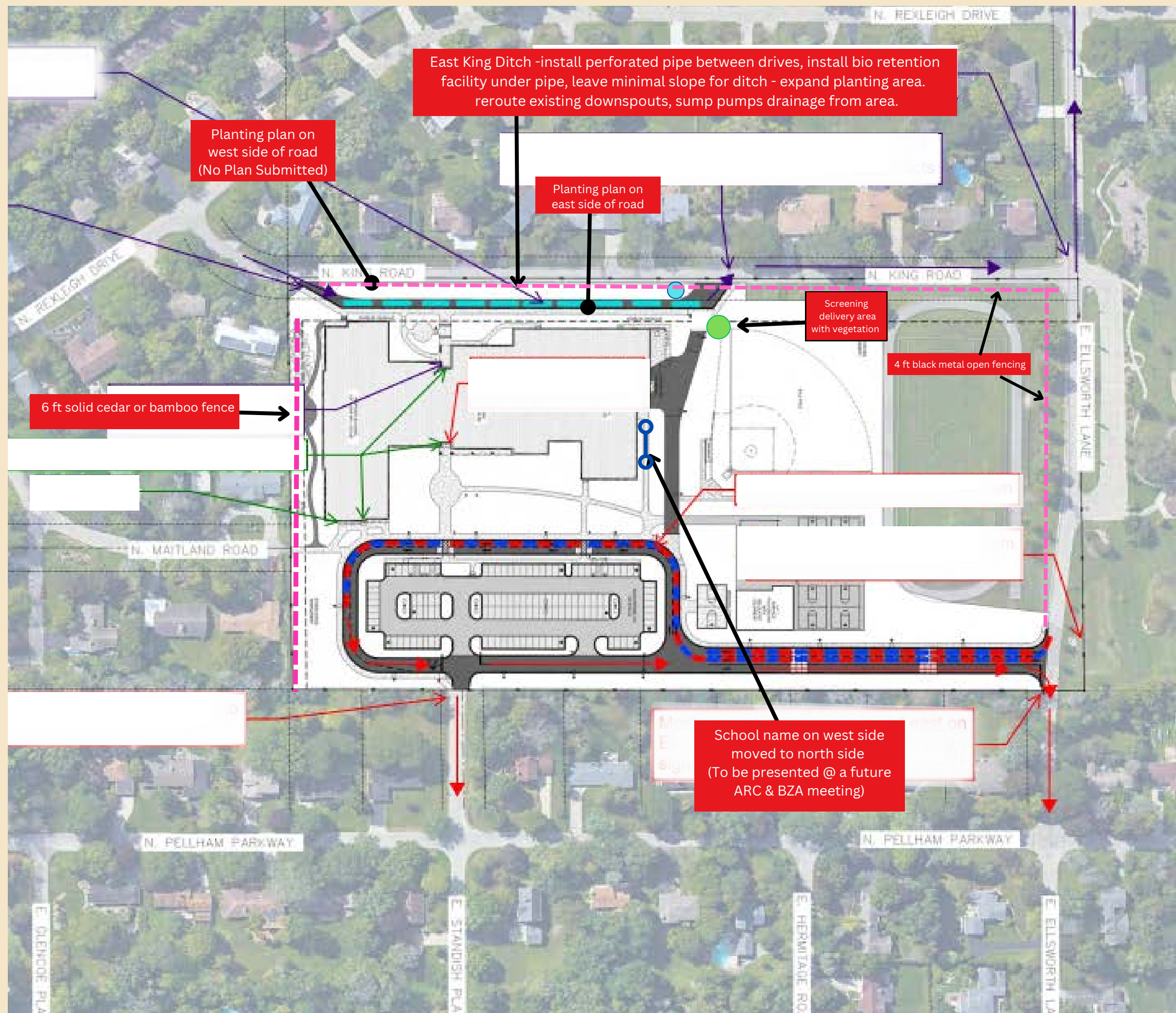

# Signage

Northbound King Sign-  
Bus traffic only. Buses  
permitted Monday through  
Friday  
8am-8:30am  
3pm-3:45pm

Planting plan on  
west side of road  
(No Plan Submitted)

Sign- No stopping, standing, or  
parking

East King Ditch -install perforated pipe between drives, install bio retention  
facility under pipe, leave minimal slope for ditch - expand planting area.  
reroute existing downspouts, sump pumps drainage from area.

Planting plan on  
east side of road

Sign-  
Delivery  
vehicle  
entrance  
only 9am -  
2pm

Sign-  
Exit  
only. No  
left turn

Sign- No stopping, standing, or  
parking

Sign- Bus traffic:  
No right turn.  
Left turn only

Sign- Form a  
Single Line

6 ft solid cedar or bamboo fence

Screening  
delivery area  
with vegetation

4 ft black metal open fencing

Sign- No stopping, standing, or  
parking

Sign- "No Thru Traffic.  
Ellsworth Park Parking  
Only".

Sign-  
Exit →  
Exit ↑

Sign-  
1) No stopping, standing, or parking  
2) No entrance - one way street  
(SD Proposal to be modified)

School name on west side  
moved to north side  
(To be presented @ a future  
ARC & BZA meeting)

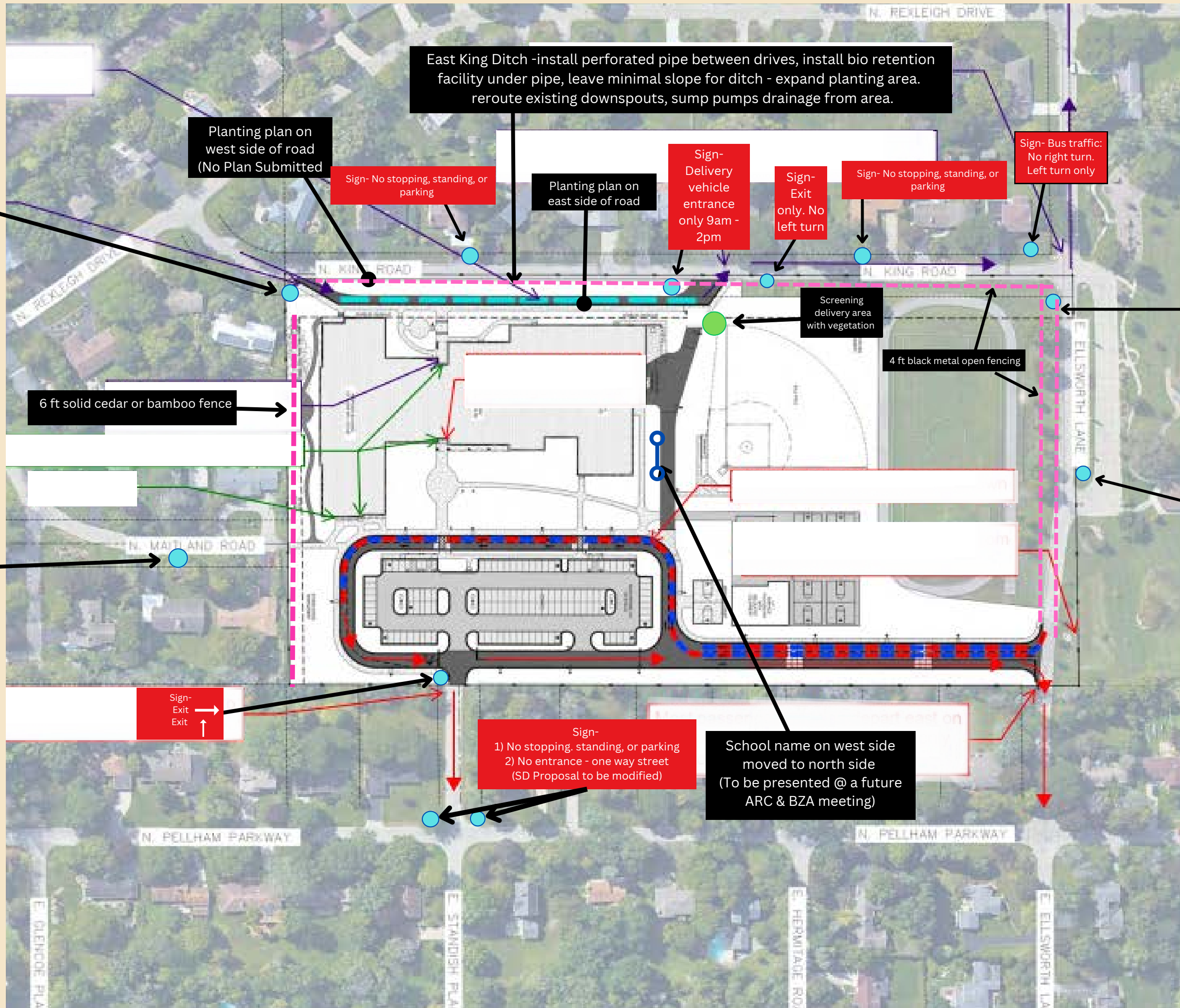



# Safety/ Site Needs

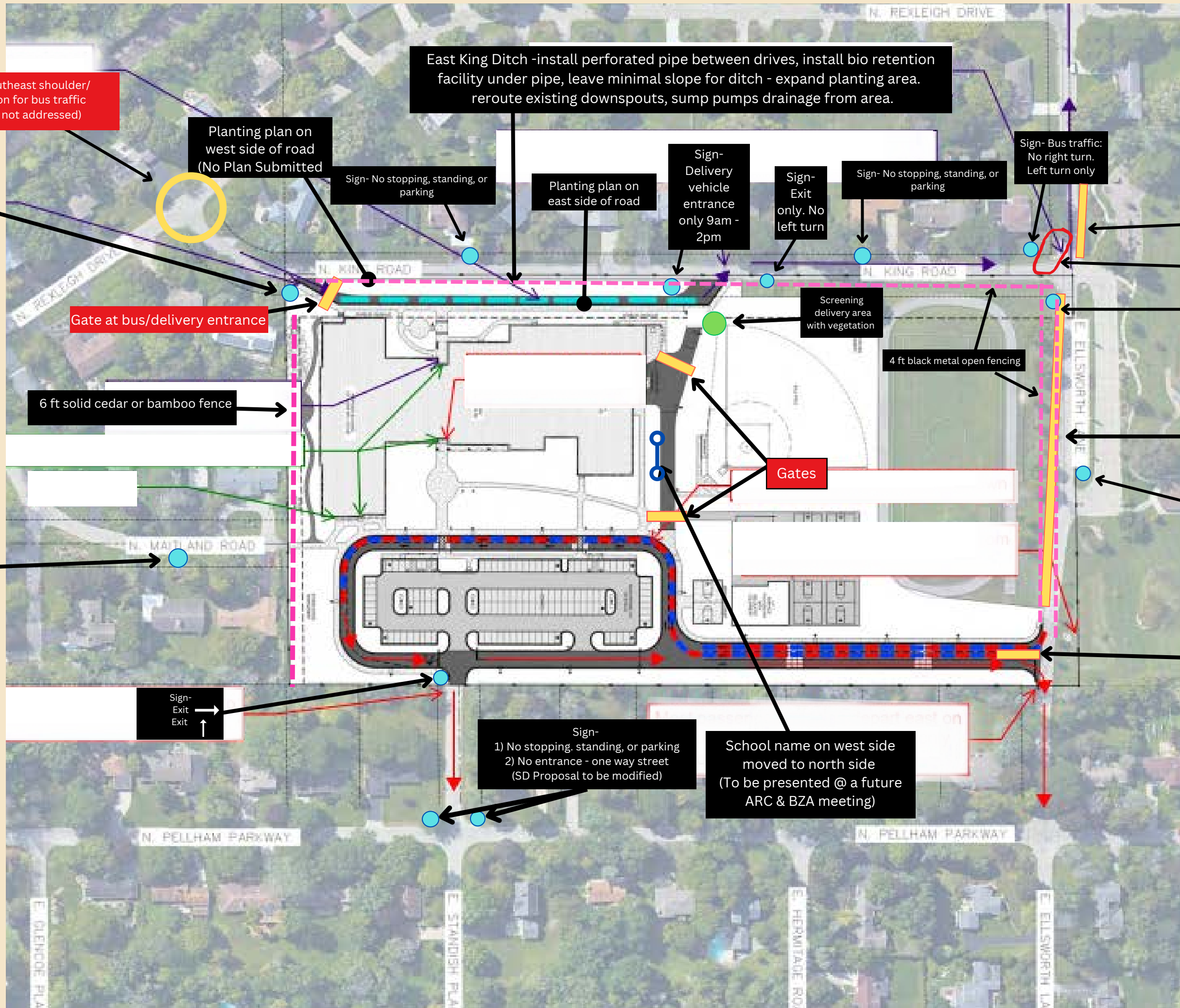

Northbound King Sign- Bus traffic only. Buses permitted Monday through Friday 8am-8:30am 3pm-3:45pm

Expand southeast shoulder/ intersection for bus traffic (Concern not addressed)

Planting plan on west side of road (No Plan Submitted)

Sign- No stopping, standing, or parking

Planting plan on east side of road

Sign- Delivery vehicle entrance only 9am - 2pm

Sign- Exit only. No left turn

Sign- No stopping, standing, or parking

Sign- Bus traffic: No right turn. Left turn only

1 foot shoulder widening 30-40 ft

Expand shoulder

Sign- Form a Single Line

Gate at bus/delivery entrance

6 ft solid cedar or bamboo fence

Screening delivery area with vegetation

4 ft black metal open fencing

Gates

New curb lane. Stripe indicating school pickup lane from King to school entrance.

Sign- "No Thru Traffic. Ellsworth Park Parking Only".

Sign- No stopping, standing, or parking

Intersection alterations for Buses -SW corner of King & Ellsworth -NE corner BDR & Rexleigh -NE corner of Ellsworth & Regent -King & Rexleigh (Partial Plan Submitted)

Maintenance agreement for queuing lane Ellsworth and King (No Plan Submitted)

Sign- Exit Exit

Sign- 1) No stopping, standing, or parking 2) No entrance - one way street (SD Proposal to be modified)

School name on west side moved to north side (To be presented @ a future ARC & BZA meeting)

Install concrete pork chop to require right turn only and add signage \*\*\*OPTIONAL\*\*\*

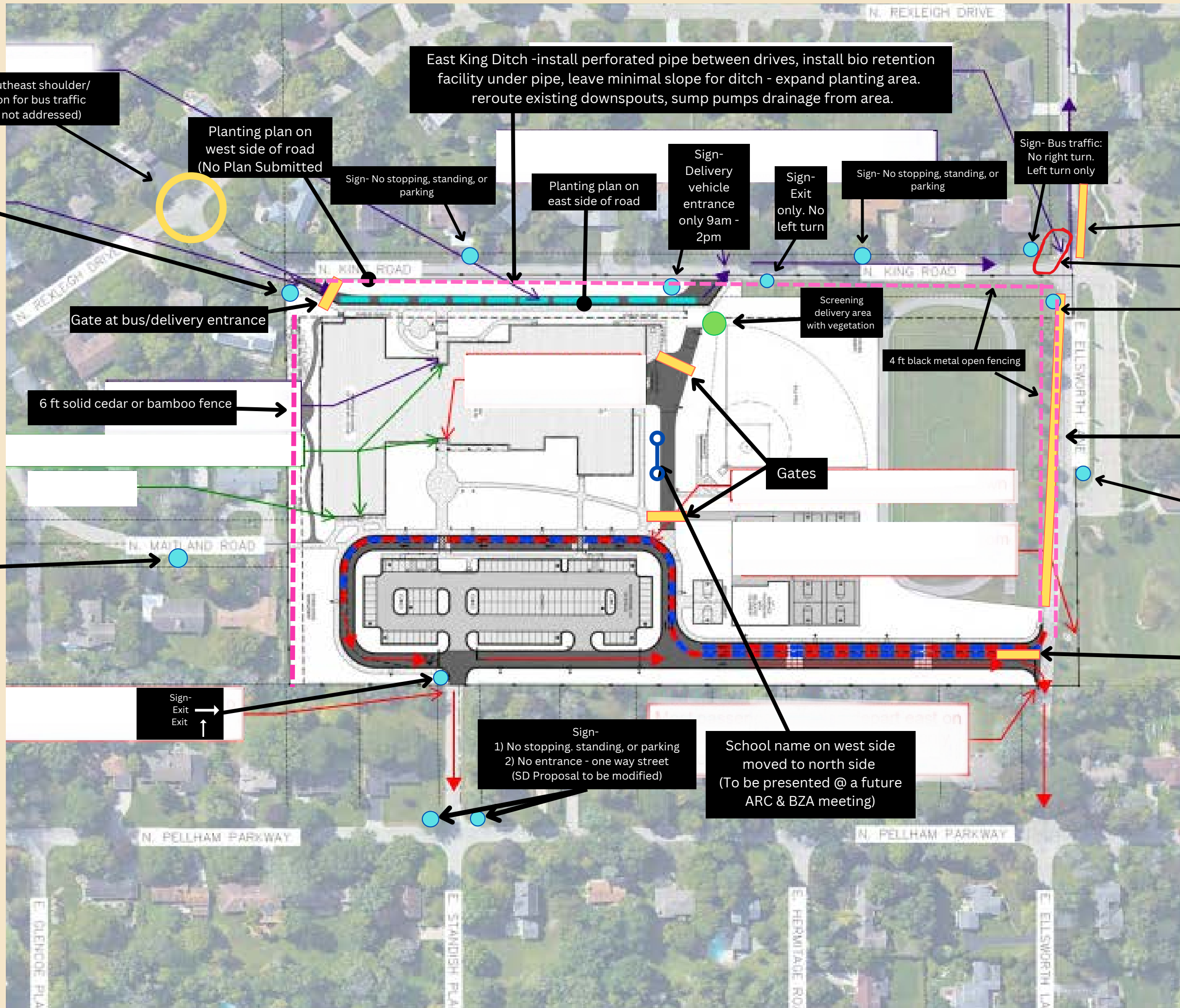

Northbound King Sign- Bus traffic only. Buses permitted Monday through Friday 8am-8:30am 3pm-3:45pm

Expand southeast shoulder/ intersection for bus traffic (Concern not addressed)

Planting plan on west side of road (No Plan Submitted)

East King Ditch -install perforated pipe between drives, install bio retention facility under pipe, leave minimal slope for ditch - expand planting area. reroute existing downspouts, sump pumps drainage from area.

Sign- No stopping, standing, or parking

Planting plan on east side of road

Sign- Delivery vehicle entrance only 9am - 2pm

Sign- Exit only. No left turn

Sign- No stopping, standing, or parking

Sign- Bus traffic: No right turn. Left turn only

1 foot shoulder widening 30-40 ft

Expand shoulder

Sign- Form a Single Line

Gate at bus/delivery entrance

6 ft solid cedar or bamboo fence

Screening delivery area with vegetation

4 ft black metal open fencing

Gates

New curb lane. Stripe indicating school pickup lane from King to school entrance. Sign- "No Thru Traffic. Ellsworth Park Parking Only".

Sign- No stopping, standing, or parking

Install concrete pork chop to require right turn only and add signage \*\*\*OPTIONAL\*\*\*

Intersection alterations for Buses -SW corner of King & Ellsworth -NE corner BDR & Rexleigh -NE corner of Ellsworth & Regent -King & Rexleigh (Partial Plan Submitted)

Maintenance agreement for queuing lane Ellsworth and King (No Plan Submitted)

Sign- Exit Exit

Sign- 1) No stopping, standing, or parking 2) No entrance - one way street (SD Proposal to be modified)

School name on west side moved to north side (To be presented @ a future ARC & BZA meeting)