

# The Conservancy at McLean Phase 1

Belmont, North Carolina

Prepared For:  
NW Lake Wylie, LLC

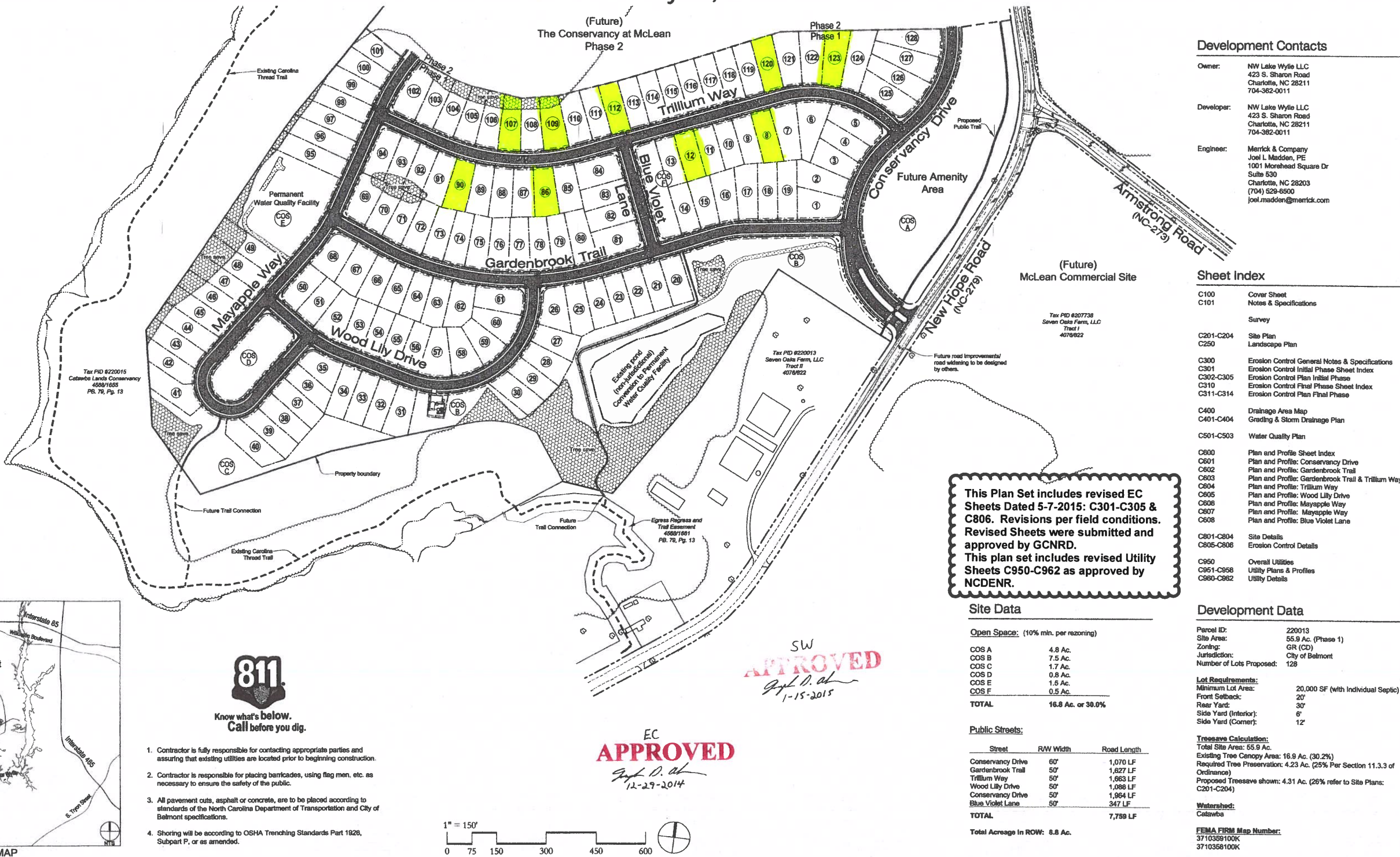

**MERRICK & COMPANY**  
1001 MOREHEAD SQUARE DRIVE, SUITE 530  
CHARLOTTE, NC 28203  
PHONE: 704.529.6500  
FAX: 704.529.6501  
WWW.MERRICK-AND-COMPANY.COM  
Merrick & Company is a full-service engineering and architectural firm. We provide a wide range of services to our clients, including site planning, civil engineering, architectural design, and construction management. Our team is experienced and knowledgeable, and we are committed to providing the highest quality of service to our clients.

**McLean**  
NW Lake Wylie LLC  
423 S. Sharon Road  
Charlotte, NC 28211

REVISIONS	DATE	BY	DESCRIPTION
1	11/10/14	JLM	Address City Comments
2	11/10/14	JLM	Address City Comments
3	11/10/14	JLM	Address City Comments
4	11/10/14	JLM	Address City Comments
5	11/10/14	JLM	Address City Comments
6	11/10/14	JLM	Address City Comments
7	11/10/14	JLM	Address City Comments
8	11/10/14	JLM	Address City Comments
9	11/10/14	JLM	Address City Comments
10	11/10/14	JLM	Address City Comments

DATE	BY	DESCRIPTION
11/10/14	JLM	Address City Comments
11/10/14	JLM	Address City Comments
11/10/14	JLM	Address City Comments
11/10/14	JLM	Address City Comments
11/10/14	JLM	Address City Comments
11/10/14	JLM	Address City Comments
11/10/14	JLM	Address City Comments
11/10/14	JLM	Address City Comments
11/10/14	JLM	Address City Comments
11/10/14	JLM	Address City Comments

**The Conservancy at McLean Phase 1**  
Belmont, North Carolina  
**Cover Sheet**

**JOEL L. MADDEN**  
No. 28807  
12-9-2014

JOB NO: 7825-03  
DATE: 11/10/2014  
SHEET: C100