

-  REMOVE (3) OAKS AND (4) CREPE MYRTLES; GRIND STUMPS AND STOCK PILE CHIPS PER CLIENT
-  PLANT DEMO (TRANSPLANTS TO BE DETERMINED BY CLIENT)

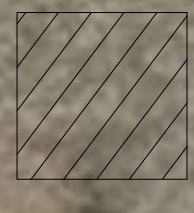
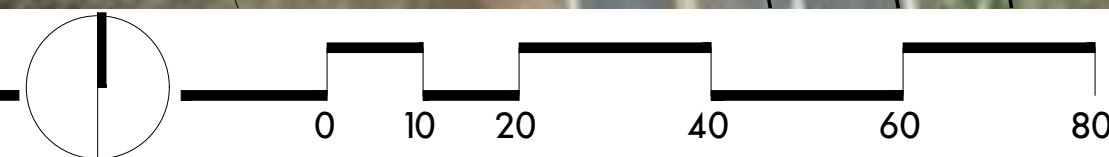

CONSULTANT

ENTRANCE GARDEN

PREPARED FOR:
DANIEL STOWE BOTANICAL GARDEN

6500 SOUTH NEW HOPE ROAD BELMONT, NC 28012

REVISIONS		
NO.	REMARKS	DATE

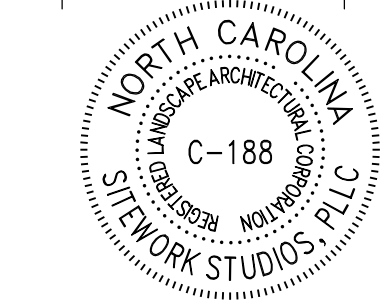

DATE:
1.6.21
SHEET TITLE:

DEMOLITION PLAN

SHEET NO.
L-100



NOTE:
THERE ARE NO ENDANGERED
SPECIES WITHIN THE PROJECT
AREA

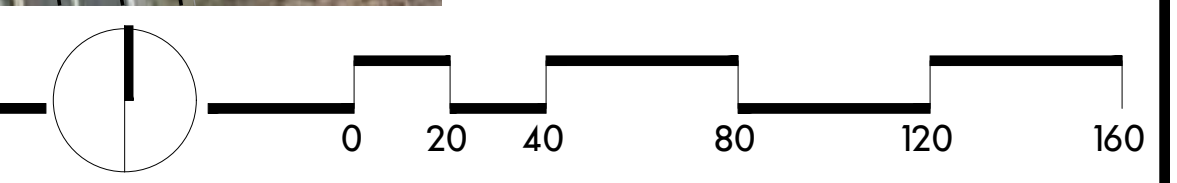

CONSULTANT

ENTRANCE GARDEN
 PREPARED FOR:
DANIEL STOWE BOTANICAL GARDEN
 6500 SOUTH NEW HOPE ROAD BELMONT, NC 28012

REVISIONS		
NO.	REMARKS	DATE



DATE:
1.5.21
SHEET TITLE:

**ENVIRONMENTAL
 SURVEY**

SHEET NO.
L-101

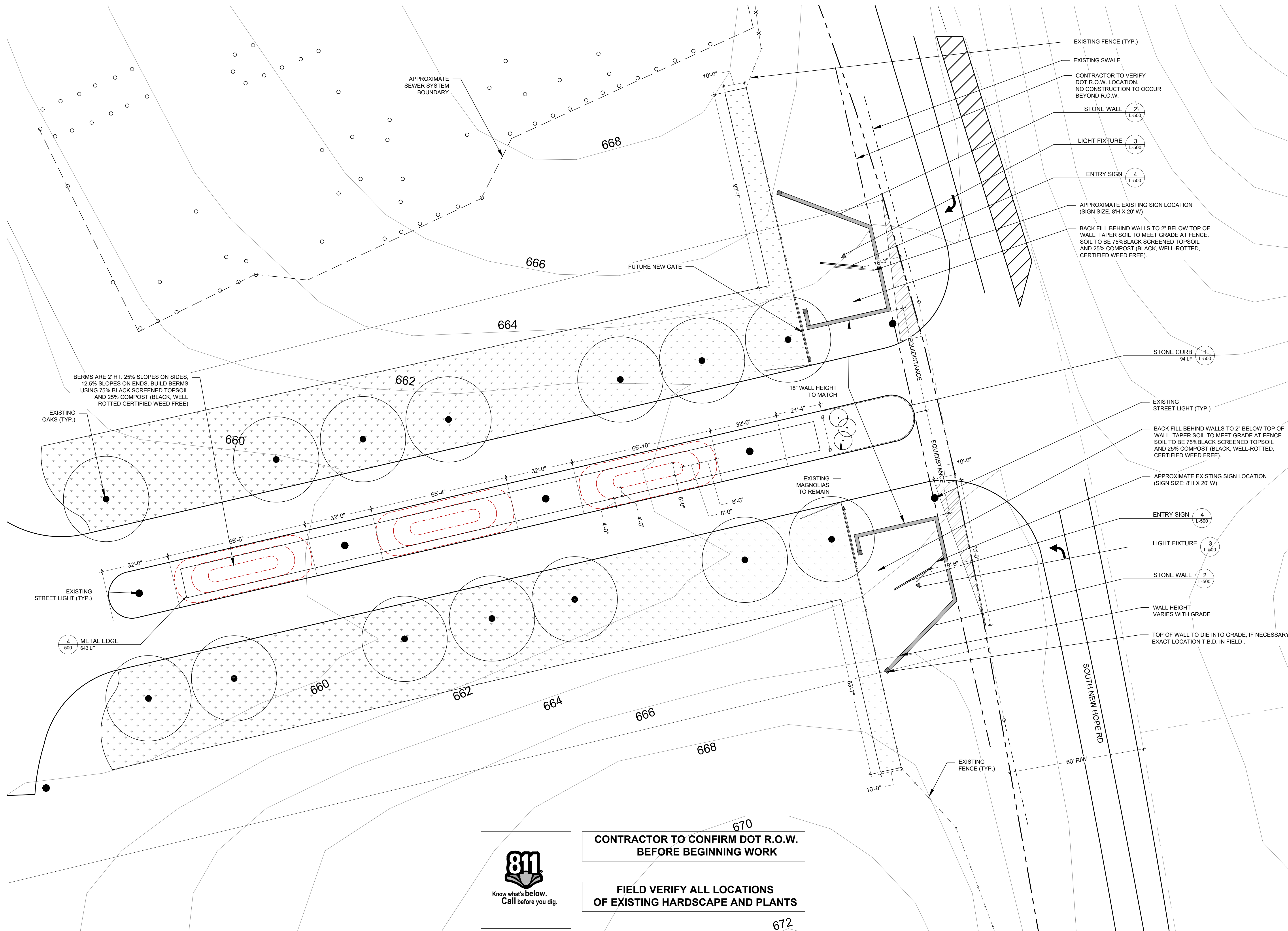

- EXISTING FENCE (TYP.)
- EXISTING SWALE
- CONTRACTOR TO VERIFY DOT R.O.W. LOCATION. NO CONSTRUCTION TO OCCUR BEYOND R.O.W.
- STONE WALL 2 L-500
- LIGHT FIXTURE 3 L-500
- ENTRY SIGN 4 L-500
- APPROXIMATE EXISTING SIGN LOCATION (SIGN SIZE: 8'H X 20' W)
- BACK FILL BEHIND WALLS TO 2" BELOW TOP OF WALL. TAPER SOIL TO MEET GRADE AT FENCE. SOIL TO BE 75%BLACK SCREENED TOPSOIL AND 25% COMPOST (BLACK, WELL-ROTTED, CERTIFIED WEED FREE).

- STONE CURB 1 94 LF L-500
- EXISTING STREET LIGHT (TYP.)
- BACK FILL BEHIND WALLS TO 2" BELOW TOP OF WALL. TAPER SOIL TO MEET GRADE AT FENCE. SOIL TO BE 75%BLACK SCREENED TOPSOIL AND 25% COMPOST (BLACK, WELL-ROTTED, CERTIFIED WEED FREE).
- APPROXIMATE EXISTING SIGN LOCATION (SIGN SIZE: 8'H X 20' W)
- ENTRY SIGN 4 L-500
- LIGHT FIXTURE 3 L-500
- STONE WALL 2 L-500
- WALL HEIGHT VARIES WITH GRADE
- TOP OF WALL TO DIE INTO GRADE, IF NECESSARY. EXACT LOCATION T.B.D. IN FIELD.

BERMS ARE 2' HT. 25% SLOPES ON SIDES, 12.5% SLOPES ON ENDS. BUILD BERMS USING 75% BLACK SCREENED TOPSOIL AND 25% COMPOST (BLACK, WELL ROTTED CERTIFIED WEED FREE)

4 METAL EDGE 500 / 643 LF



CONTRACTOR TO CONFIRM DOT R.O.W. BEFORE BEGINNING WORK

FIELD VERIFY ALL LOCATIONS OF EXISTING HARDSCAPE AND PLANTS

CONSULTANT

ENTRANCE GARDEN
 PREPARED FOR:
DANIEL STOWE BOTANICAL GARDEN
 6500 SOUTH NEW HOPE ROAD BELMONT, NC 28012

REVISIONS		
NO.	REMARKS	DATE



DATE: 1.6.21
 SHEET TITLE:

SITE DEVELOPMENT PLAN

SHEET NO.
L-200

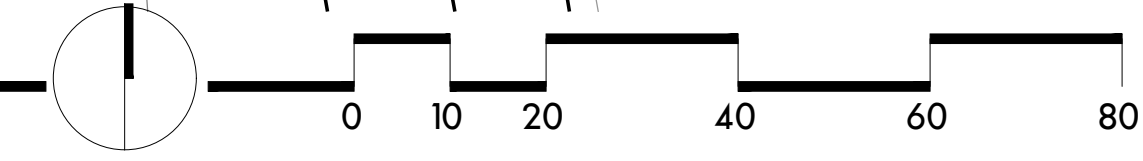

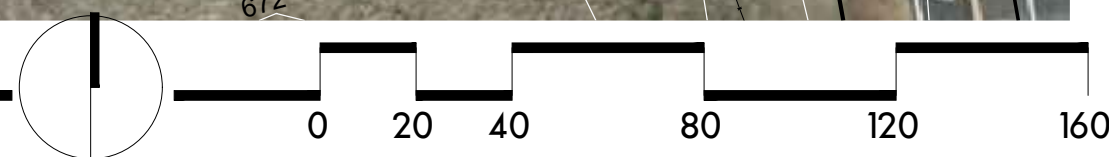
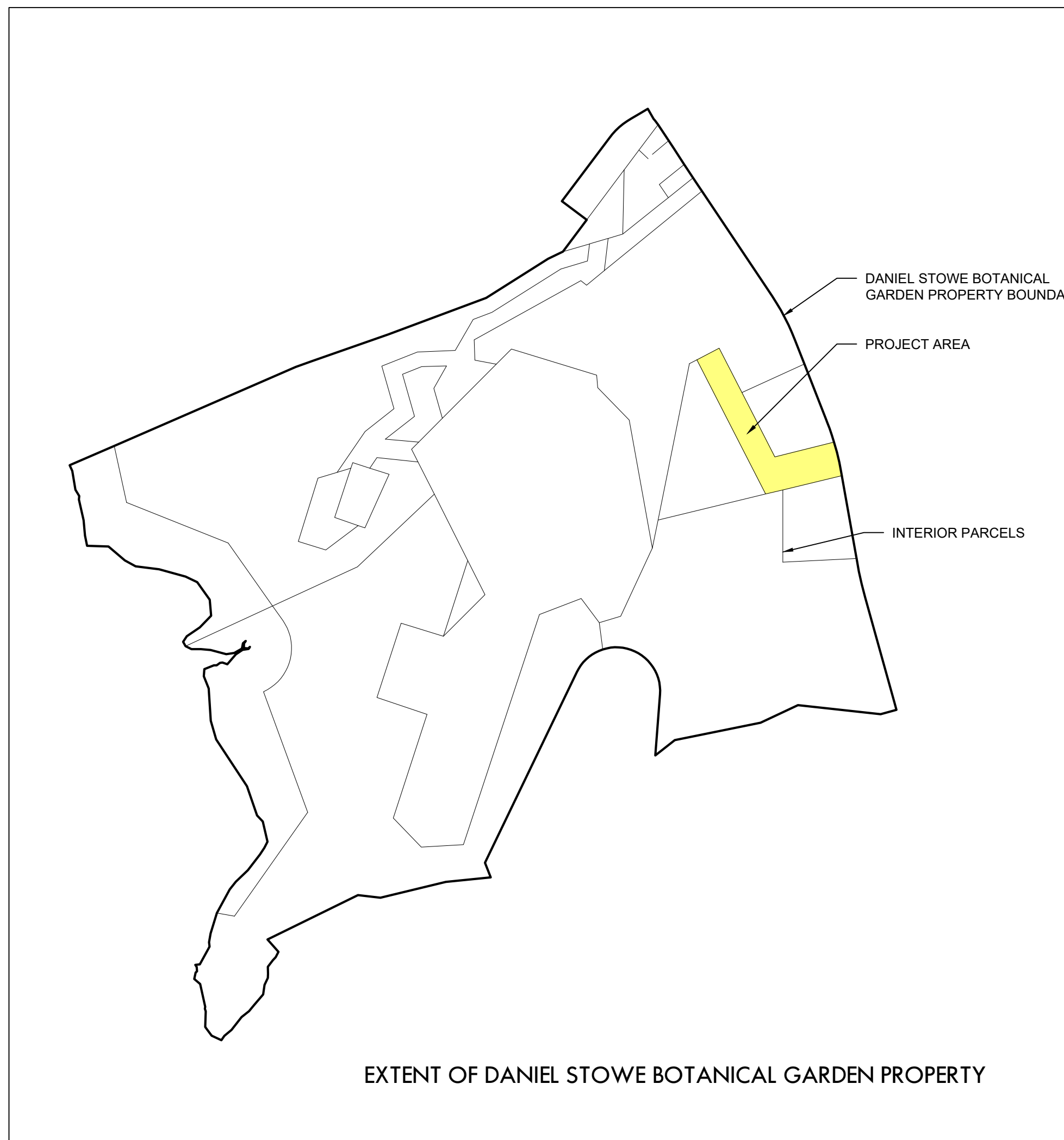

CONSULTANT

ENTRANCE GARDEN

PREPARED FOR:
DANIEL STOWE BOTANICAL GARDEN

6500 SOUTH NEW HOPE ROAD BELMONT, NC 28012

REVISIONS		
NO.	REMARKS	DATE

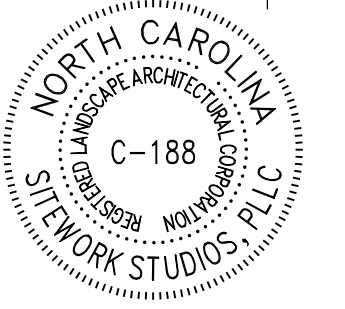

DATE:
 1.6.21

SHEET TITLE:

CONTEXT
 MAP

SHEET NO.
L-201

sitework
 STUDIOS

LANDSCAPE ARCHITECTURE
 352 Depot Street | Suite 120 | Asheville, NC 28801 | 828.225.4945

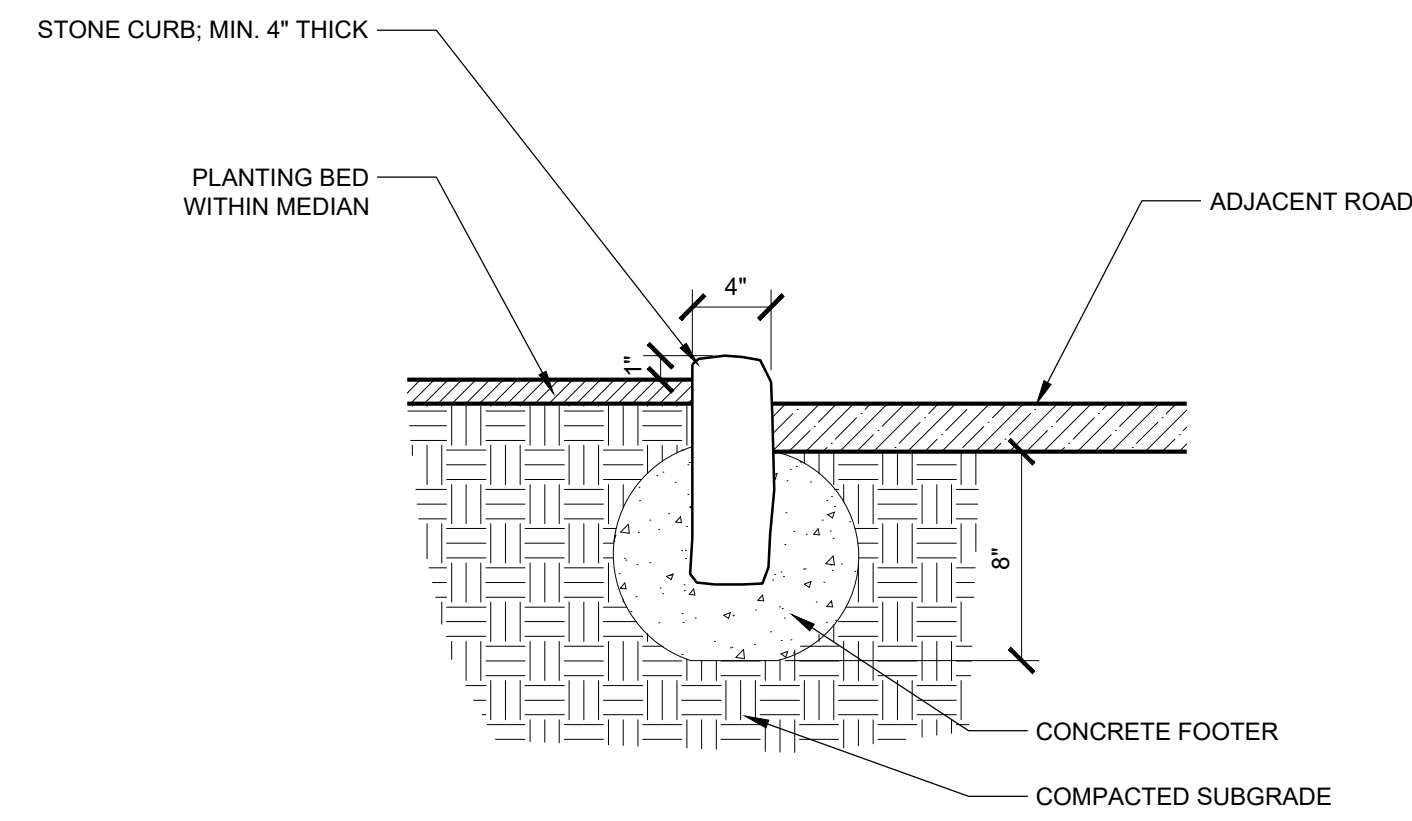

1 STONE CURB
NTS

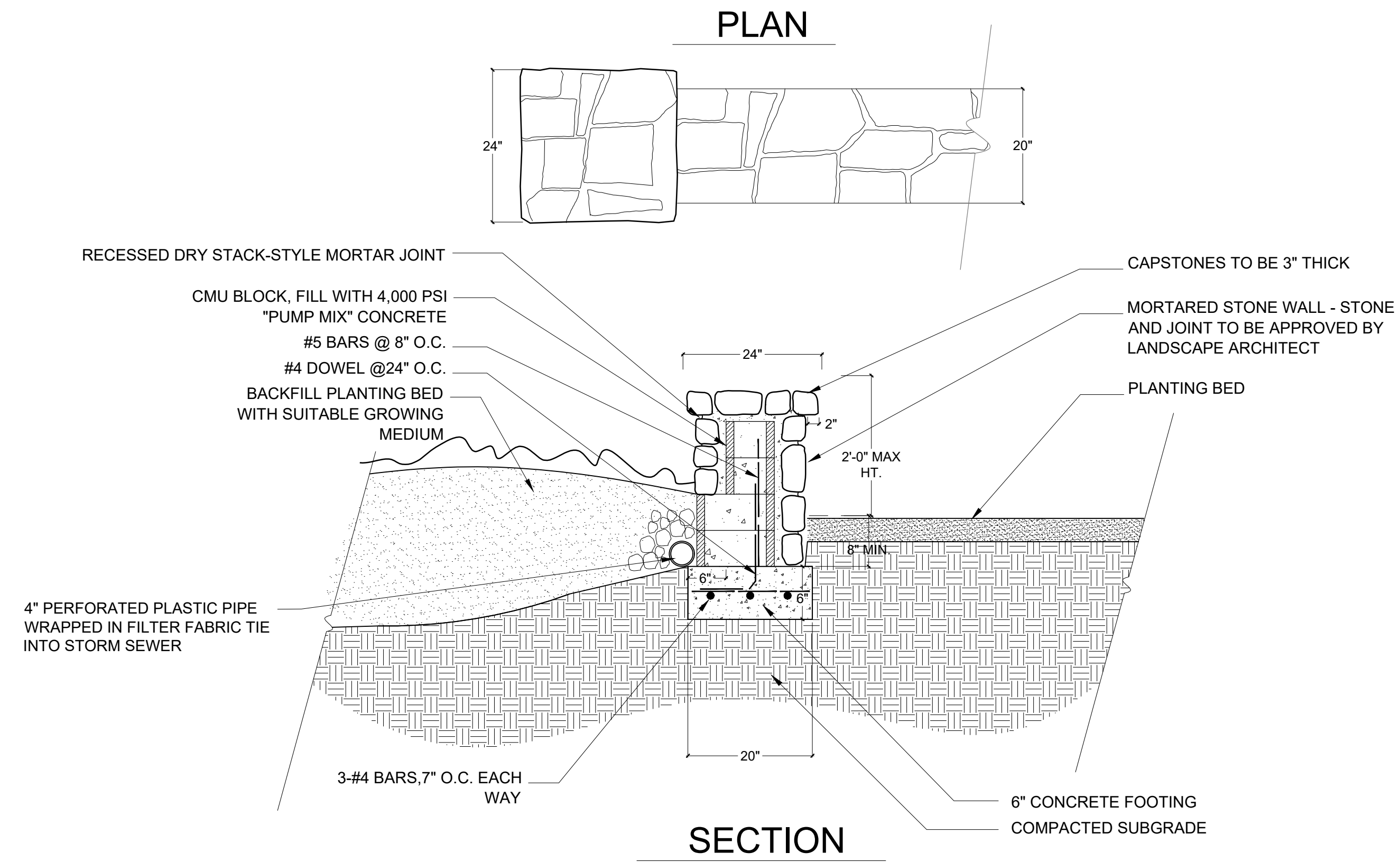

2 STONE WALL
NTS

AFL Series

LED Flood Light Specifications

Model AFL-	50K15-110-x	50K30-110-x	50K50-110-x	50K70-110-x	50K100-110-x
Intensity	1,800 lm	3,600 lm	6,000 lm	9,100 lm	13,000 lm
Operating Voltage	120-277 VAC				
Power Consumption	15 W	30 W	50 W	70 W	100 W
Current Draw	0.13 A @120 VAC	0.25 A @120 VAC	0.42 A @120 VAC	0.58 A @120 VAC	0.83 A @120 VAC
Efficacy	120 lm/W		130 lm/W		
Color Temperature	5000K				
Beam Angle	80° x 110° (NEMA 5 x NEMA 6)				
CRI	70+				
Dimming	none				
IP Rating	IP65				
Ambient Operating Temperature	-40°-113° F (-40°-45° C)				
Product Weight	≤ 1.15 lb (0.52 kg)	≤ 1.65 lb (0.75 kg)	≤ 2.75 lb (1.25 kg)	≤ 7.65 lb (3.47 kg)	
Rated Life (L70)	50,000 hours				

Dimensional Drawings
Slip-fitter Mount Versions
AFL-50K70-110-S and AFL-50K100-110-S

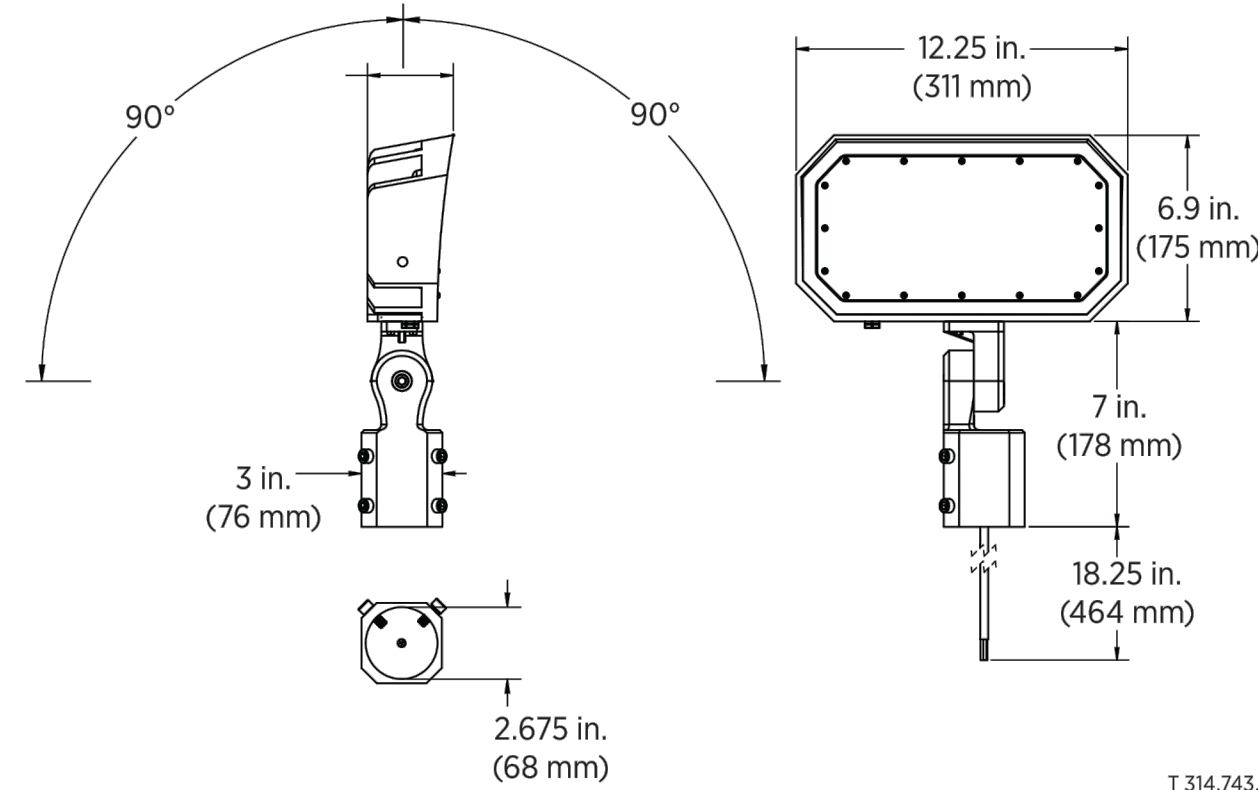

3 LIGHT FIXTURE



4 ENTRY SIGN

CONSULTANT

ENTRANCE GARDEN

PREPARED FOR:
DANIEL STOWE BOTANICAL GARDEN

6500 SOUTH NEW HOPE ROAD BELMONT, NC 28012

REVISIONS		
NO.	REMARKS	DATE

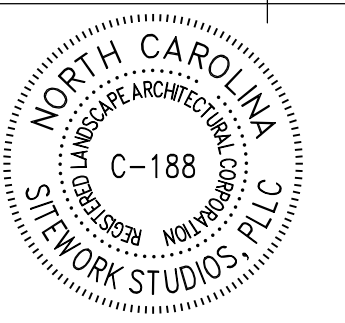

DATE:
1.6.21
SHEET TITLE:

DETAILS

SHEET NO.
L-500