

CROW HOLDINGS

INDUSTRIAL

August 29, 2022

Re: Crow Holdings Industrial Community Meeting for The Oaks Commerce Center

Crow Holdings Industrial along with Orsborn Engineering Group will be hosting an open community forum to discuss the development of an approximately 470,000 square foot distribution warehouse facility at Hickory Grove Road in Belmont, North Carolina at **Centerview Baptist Church, 2300 Acme Road, Belmont, NC 28012** on **September 12, 2022, at 6:30 PM EST.**

The development will encompass the following three parcels:

- Parcel One
 - Size: +/- 44 acres
 - Jurisdiction: Belmont
 - Zoning: BC-D
 - Parcel Number: 306477
- Parcel Two
 - Size: +/- 0.3 acres
 - Jurisdiction: Gaston County
 - Zoning: C-1
 - Parcel Number: 183195
- Parcel Three
 - Size: +/- 0.3 acres
 - Jurisdiction: Gaston County
 - Zoning: R-1
 - Parcel Number: 183196

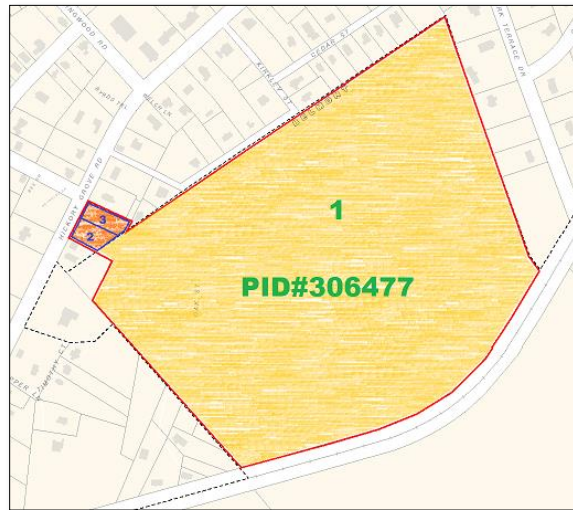

The intended use of the current Belmont zoning district, Business Campus Development (BC-D), is to allow for the development of light industrial and heavy industrial uses, which aligns with the proposed distribution warehouse facility. As an additional part of the project, Crow Holdings Industrial plans to annex the remaining two parcels into the City of Belmont and rezone them to BC-D.

Below, you will find a conceptual plan that better depicts the project along with sample renderings of the building and additional information can be found at Belmont Planning Department's website: <https://www.cityofbelmont.org/oaks-commerce>.

If you would like to inquire further about the project, please contact either Matt or Nick at Crow Holdings. We look forward to hearing from you!

Matt Cochrane
Managing Director, Carolinas
Crow Holdings Industrial
704.258.9147
mcochrane@chindustrial.com

Nick Thornton
Development Associate, Carolinas
Crow Holdings Industrial
704.754.2792
nthornton@chindustrial.com

CROW HOLDINGS

INDUSTRIAL

OVERALL SITE PLAN

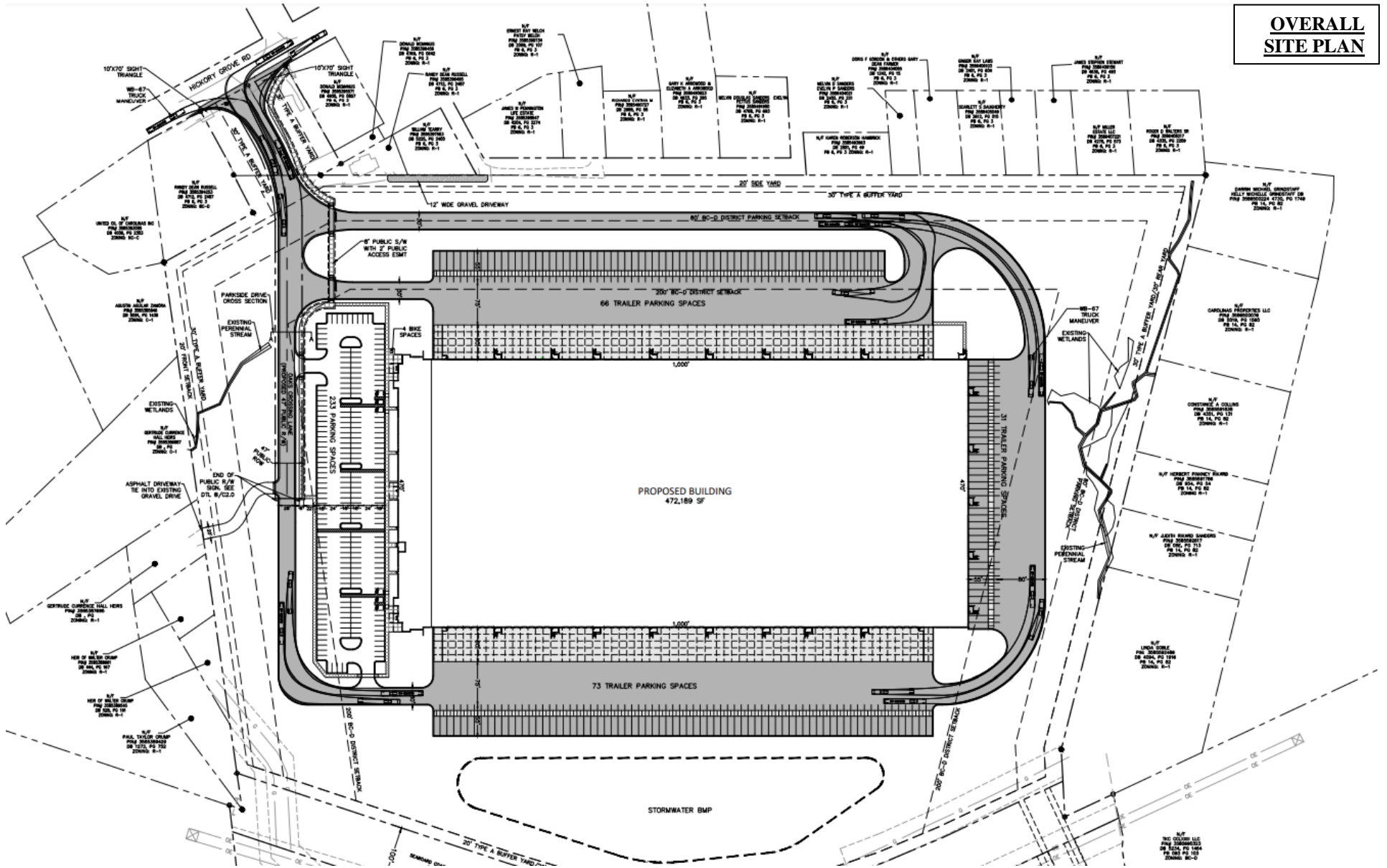

CROW HOLDINGS

INDUSTRIAL

TREE SAVE PLAN (SHADED)

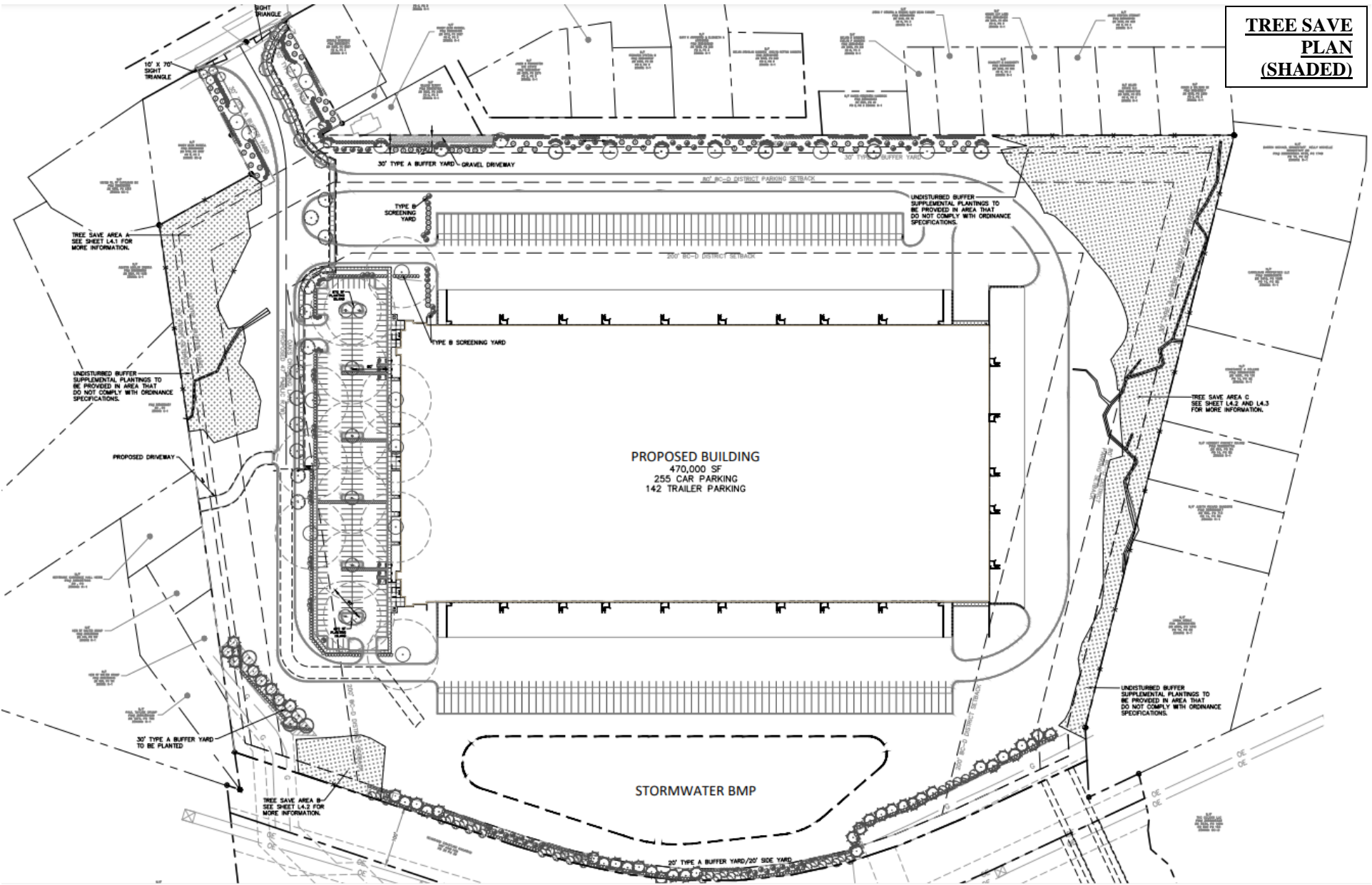

CROW HOLDINGS

INDUSTRIAL



ARCHITECTURE BY [unreadable]