

**SITE PLAN**  
SCALE: 1" = 50'

**TRANSFORMER INSTALLATION**

Installed at site: **V01**  
 Grid Number: **223868-173388**  
 kVA Rating: **500 kVA**  
 Material ID#: **6258250**

Foreman to reline the following information

Company ID#: \_\_\_\_\_  
 Primary phase connected to: **ABC**  
 Tested Secondary Voltage: \_\_\_\_\_

**FAULT CURRENT TABLE**

3Ø PM TRANSFORMERS (208Y/120V)					
		208V Windings			
Location	Size	R/X	Min. %Z	Fault Current	
V01	500kVA	0.2	2.30	60,300 Amps	

**3Ø PRIMARY CABLE REMOVAL TABLE**

Location	From	To	Cable Size	Quantity	Length (per conductor)	Remarks
J01	V02		1/0	3	~290'	AØEHS523 BØEHS524 CØEHS525

Total: ~290 Feet of 3Ø 1/0 PRI Cable Removed

**Vault & Equipment Table**

Work Location	Grid Number	Vault Size & Cover	Type & Size Equipment In Vault	Primary Bushings		Transformer ID Numbers (Company ID)	ASBUILT INFORMATION Foreman-Complete
				LB	DC		
J02	223857-173386	JBOX35AS (1'x1'x1')	JBOX				
V01	223868-173388	PM3P15M (7'x7'x4')	PAD-3P-12-120/208-500 (500 kVA)				

**Primary Cable & Conduit Table (Foreman to Complete)**

LOCATION		CONDUIT											PRIMARY CABLE											QTY OF LUBE (gal.)		AS BUILT INFORMATION			
From	To	Size (in)	Qty	Design Length (ft)	Actual Length (ft)	TYPE				BENDS			PULL (lbs)	PULL Rev (lbs)	Cable Size	Design Length (ft)	Actual Length (ft)	CABLE NUMBERS			MANUFACTURING INFORMATION			FOR FEEDER CABLE ONLY			Design	As Built	Actual Amount Installed (Conduit & Cable)
						DB120	HDPE	SCH 40	90°	45°	22°	11°						A	B	C	Manufacturer	Compound	Year	Tape	CN	#4/0 NEU			
IP1	J02	4"	2	50'																									
J01	J02																												
J02	V01	4"	1	150'																									
J02	V02																												

**SITE SPECIFIC NOTES**

- J01: GRID #223857-173410**
    - EXISTING J-BOX TO REMAIN
    - REMOVE CABLE # AØEHS523, BØEHS524, CØEHS525 (J01 TO V02)
    - INSTALL CABLE # AØEJR177, BØEJR178, CØEJR179 (J01 TO J02)
  - J02: GRID #223857-173386**
    - INSTALL 5x7x5 3Ø J-BOX [JBOX3AS] W/ ANTI-SKID PER STD 6055.1030
    - INSTALL (9) 15KV 1/0 PRIMARY CABLE ELBOWS [ELB10J] PER STD 6041.1000
    - INSTALL (3) NEW DUST CUP
    - INSTALL CABLE # AØEJR177, BØEJR178, CØEJR179 (J01 TO J02)
    - INSTALL CABLE # AØEJR180, BØEJR181, CØEJR182 (J02 TO V01)
    - INSTALL CABLE # AØEJR183, BØEJR184, CØEJR185 (J02 TO V02)
    - INSTALL GRID #223857-173386
  - V01: GRID #223868-173388**
    - INSTALL 774 VAULT W/8" SQ. COVER [PM3P15M] PER STD 6045.5000
    - INSTALL NEW 500kVA 120/208V PM XFMR [MID 6258250]
    - INSTALL (3) 15KV 1/0 PRIMARY CABLE ELBOWS [ELB10J] PER STD 6041.1000
    - INSTALL (8) 4-POS 2-500 KCMIL SECONDARY CONNECTOR BARS [MID 7651002]
    - INSTALL (12) MOUNTING BOLTS KITS [MID 7651008]
    - INSTALL CABLE # AØEJR180, BØEJR181, CØEJR182 (J02 TO V01)
    - CONNECT (4) RUNS OF CUSTOMER OWNED 500 KCMIL
    - INSTALL GRID #223868-173388
  - V02: GRID #223851-173386**
    - EXISTING TWT TO REMAIN
    - REMOVE CABLE # AØEHS523, BØEHS524, CØEHS525 (J01 TO V02)
    - INSTALL CABLE # AØEJR183, BØEJR184, CØEJR185 (J02 TO V02)
  - IP1:**
    - POTELCO TO TRENCH (3') OF EXISTING 1/0 UG PRI PER SPLICE PIT DIAGRAM
  - IP1 - J02**
    - INSTALL (2) 4" SCH40 CONDUIT L = 150' (L=\_\_\_\_\_)
  - J01 - J02**
    - INSTALL (1) RUN OF 3Ø 1/0 UG PRI, L = 280' (L=\_\_\_\_\_)
  - J02 - V01**
    - INSTALL (1) 4" SCH40 CONDUIT L = 150' (L=\_\_\_\_\_)
    - INSTALL (1) RUN OF 3Ø 1/0 UG PRI, L = 170' (L=\_\_\_\_\_)
  - J02 - V02**
    - INSTALL (1) RUN OF 3Ø 1/0 UG PRI, L = 135' (L=\_\_\_\_\_)
  - J01 - V02**
    - REMOVE EXISTING 3Ø 1/0 UG PRIMARY, L = 290' (L=\_\_\_\_\_)
- \*\*CUSTOMER TO PROVIDE ALL TRENCHING, BACKFILL, AND RESTORATION\*\***

**@XFMR (V01)**  
 Load: 500 kW  
 LRC: 65 AMPS  
 % V. Drop: 0.7%  
 % Flicker: 0.5%

**POWER GENERAL NOTES - COMMERCIAL PROJECT**

- All materials to be installed in accordance with Puget Sound Energy's (PSE) standards. Any deviation from this work sketch must be AUTHORIZED by PSE's Project Manager and NOTED on the Foreman's Copy.
- All switching arrangements and/or outage arrangements are to be made with the Project Manager at least three (3) working days in advance.
- Contact the Utilities Underground Location Center (1-800-424-5555) at least 48 hours prior to commencing work to get the underground facilities located.
- STAKING: The customer will provide all staking (transformer, handhole, trench, grade, lot, pole, sidewalk, etc.). See sketch and details for locations. Equipment locations must be approved by the Project Manager.
- SITE PREPARATION: The work area will be at or near finished grade, clear of trench spoils or construction materials which would restrict construction and/or equipment access, before work can begin.
- Roads shall be paved or have a compacted, crushed rock base in place.
- CLEARANCES: Transformers require a minimum of 6 feet from fire fighting equipment, 10 feet from combustible walls, overhangs, doors, and windows, and a minimum of 5 feet from the back of curb (or guard posts will be required per PSE standards). All conduits and vaults are to be at least 5 feet away from water, storm and sewer lines when paralleling them in the right of way, and at least 1 foot when crossing them.
- All work is to be done in accordance with local municipal and county permit requirements as applicable.
- Customer/Developer is responsible to provide, install and maintain all secondary service cables, conduits and crossings from the individual unit's meter base to the designated connection point.
- Inclement weather conditions may cause delays in construction times and dates.
- EXCAVATION: The customer is to provide all trenching, backfill, vault excavations, compaction and restoration per this sketch and per PSE standards. A minimum protective cover of 36" is required over PSE's primary voltage equipment and 24" is required of PSE's secondary voltage equipment. The customer will provide any and all shoring or they will side slope the trench to 1:1.

**EROSION & SEDIMENT CONTROL REQUIREMENTS**

EROSION & SEDIMENT CONTROL SHALL BE PER PSE STANDARD PRACTICE 0150.3200 TECHNIQUES FOR TEMPORARY EROSION & SEDIMENT CONTROL & ANY ADDITIONAL LOCAL JURISDICTION REQUIREMENTS (LOCAL JURISDICTIONS MAY HAVE ADDITIONAL REQUIREMENTS INCLUDING NOTES DETAILING WHERE EROSION OR SEDIMENT CONTROL STRUCTURES ARE TO BE INSTALLED, CROSS SECTION DETAILS OF THE TYPICAL EROSION STRUCTURES, & SPECIAL REQUIREMENTS FOR WORK IN SENSITIVE AREAS.)

**CIRCUIT LOADING TABLE**

CIRCUIT: TOL-16  
 AS OF 11/7/23

	A PHASE	B PHASE	C PHASE
EXIST. PEAK LOAD	121	113	129
EST. NEW LOAD	9	9	9
TOTAL	130	122	138

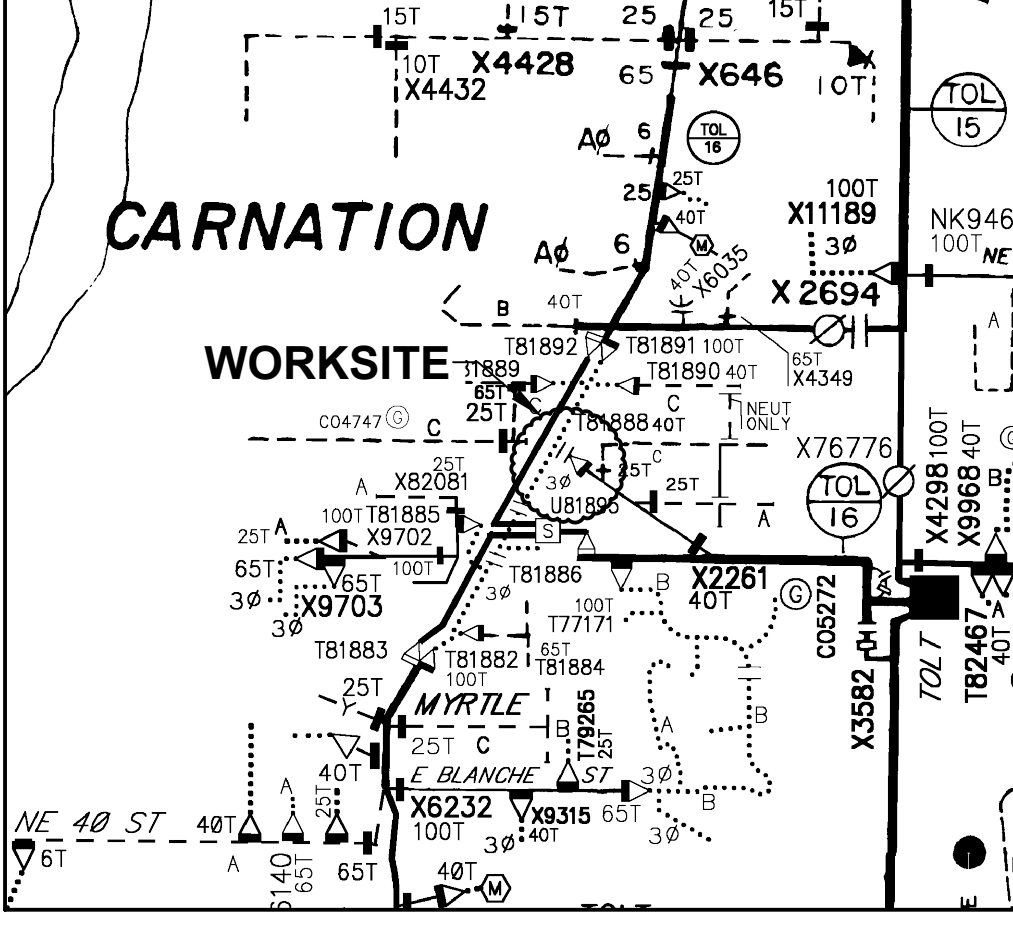

**FOREMAN (CHECK BOX WHEN COMPLETED)**

PSE Equipment LOCKED/SECURED & Work Area left in CLEAN/SAFE Condition.  
 Grid, Cable, and Switch numbers INSTALLED & VERIFIED.  
 Field Changes RED-LINED on As-built.  
 Material VERIFIED and CHANGES noted on Paperwork.  
 Total PRIMARY Cable noted on As-built.  
 Company ID#s RECORDED in correct location on As-built.  
 Indicate correct FUSE SIZE on As-built & VERIFY proper PHASE.  
 Deviations noted on the As-built and their reason.

I certify that the work performed meets PSE's standards and procedures and that all quality requirements are met.

Foreman's Signature: \_\_\_\_\_  
 Print Name: \_\_\_\_\_ Date: \_\_\_\_\_

**Vicinity Map**  
TG PG 569-D1

**Coordinate**  
47.6492, -121.9142

**Owner / Developer Contact Info**

SNO-VALLEY SENIORS  
 PO Box 96  
 CARNATION, WA 98014  
 ATTN: Ryan Arp 206-285-2966 office

For contacts below dial 1-888-CALL PSE (225-5773)

**PROJECT PHASE**

PROJECT PHASE	NOTIF#	ORDER#
PWR Superior	511176312	105104182
SVC Connect	514486430	104356963
Meter	514486525	3002407226

**Project Manager Contact Information:**

Manager: ABDUL KAMEL  
 Cell Phone: 425-748-6382  
 E-Mail: ABDUL.KAMEL@PSE.COM

Developer	Yes	No	Yes	No	PSE
"Outages Required"	Yes	No	Yes	No	
"Flagging Required"	Yes	No	Yes	No	

THIS SKETCH NOT TO BE RELIED UPON FOR EXACT LOCATION OF EXISTING FACILITIES

REAL ESTATE/EASEMENT	PERMIT
N/A	CARNATION
3	N/A
2	N/A
1	N/A

REV#	DATE	BY	DESCRIPTION	ENGR - GAS	PHONE NO	DATE
3	N/A	N/A	N/A			
2	N/A	N/A	N/A			
1	N/A	N/A	N/A			

**JOINT FACILITIES ARRANGEMENTS**

UTILITIES	N/A	N/A	N/A	N/A
CONTACT	N/A	N/A	N/A	N/A
PHONE#	N/A	N/A	N/A	N/A

**PUGET SOUND ENERGY**

**SNO VALLEY SENIOR HOUSING**

NEW 3Ø J-BOX & PM XFMR, UG PRI LE, UG PRI REMV, SVC CONNECT  
 31845 W COMMERCIAL ST, CARNATION, WA 98014

INCIDENT	MAOP
N/A	N/A
Gas Order	Elect Order
N/A	105104182
SCALE	PAGE
AS NOTED	1/2

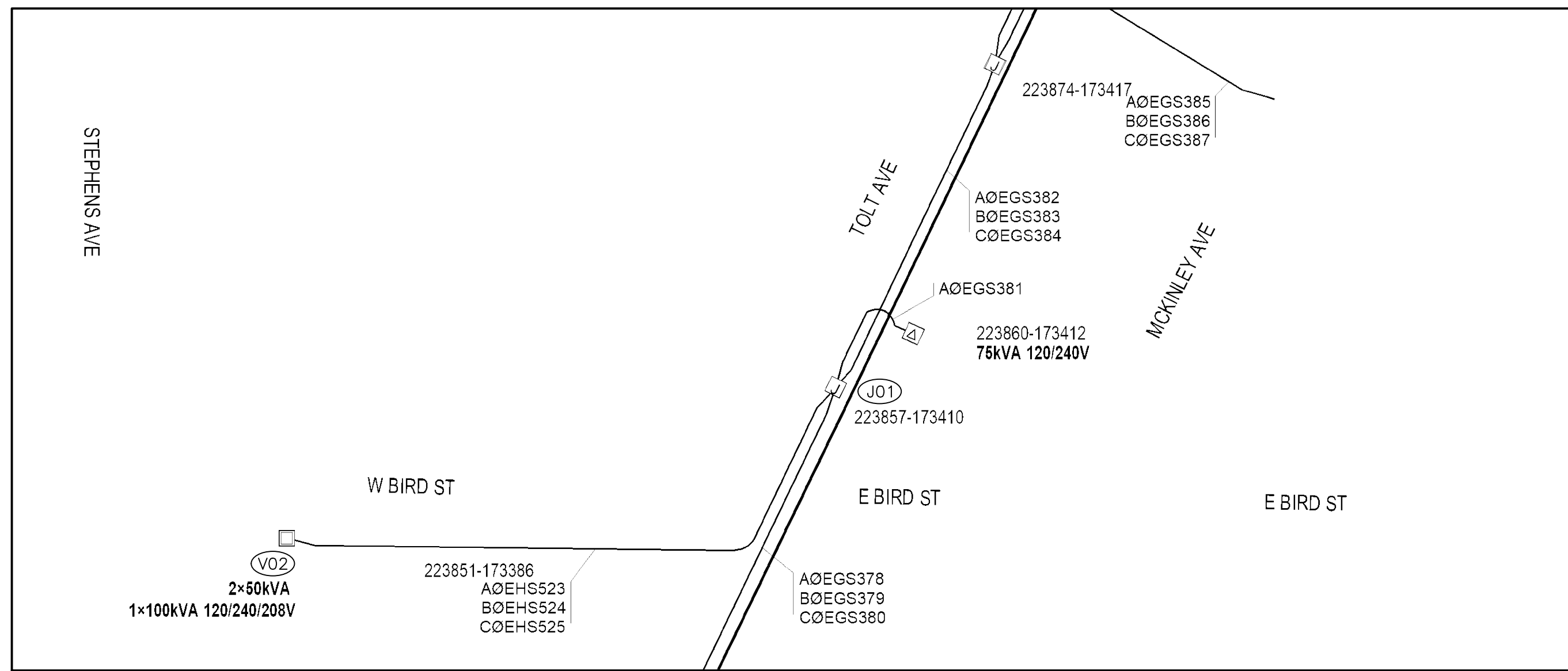

**PRIMARY UNDERGROUND CIRCUIT ONE-LINE DIAGRAM**  
**MAP #2507E064 (PRE CONSTRUCTION)**  
 SCALE: 1:50

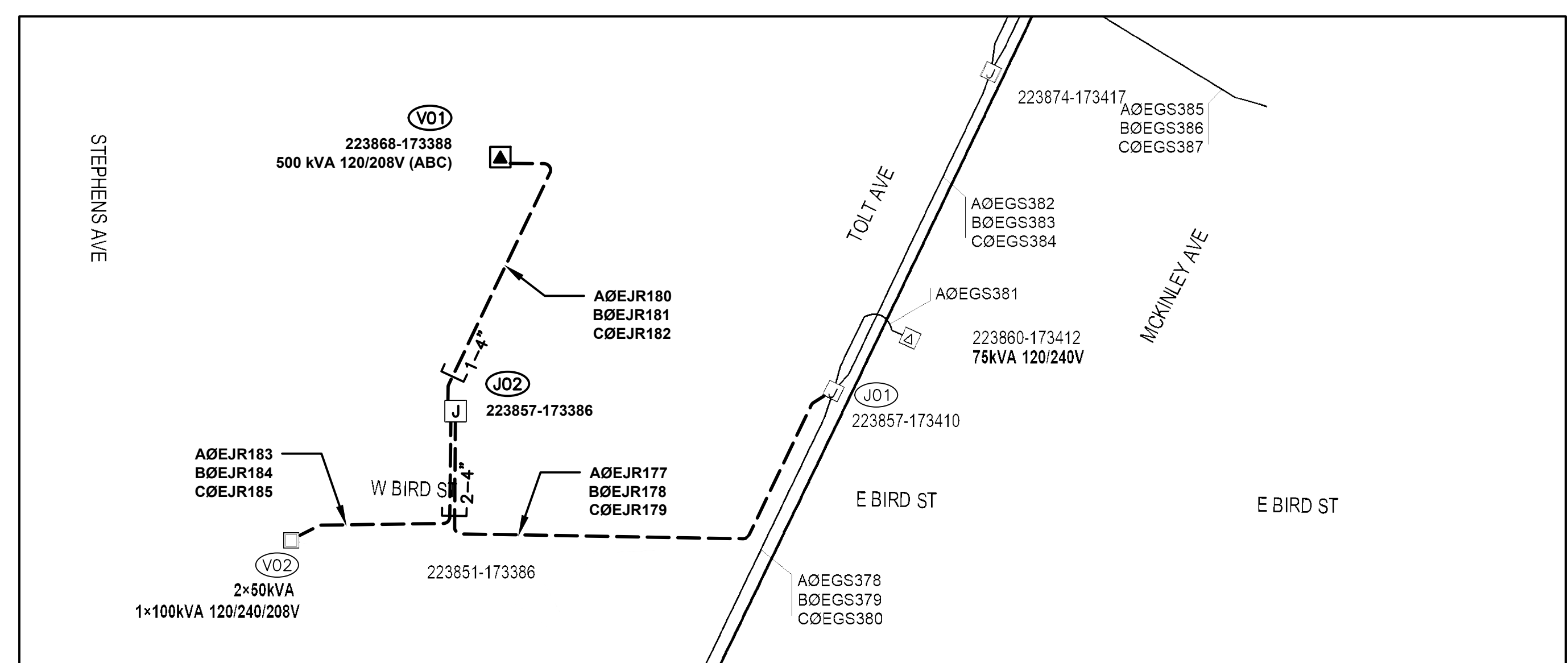

**PRIMARY UNDERGROUND CIRCUIT ONE-LINE DIAGRAM**  
**MAP #2507E064 (POST CONSTRUCTION)**  
 SCALE: 1:50

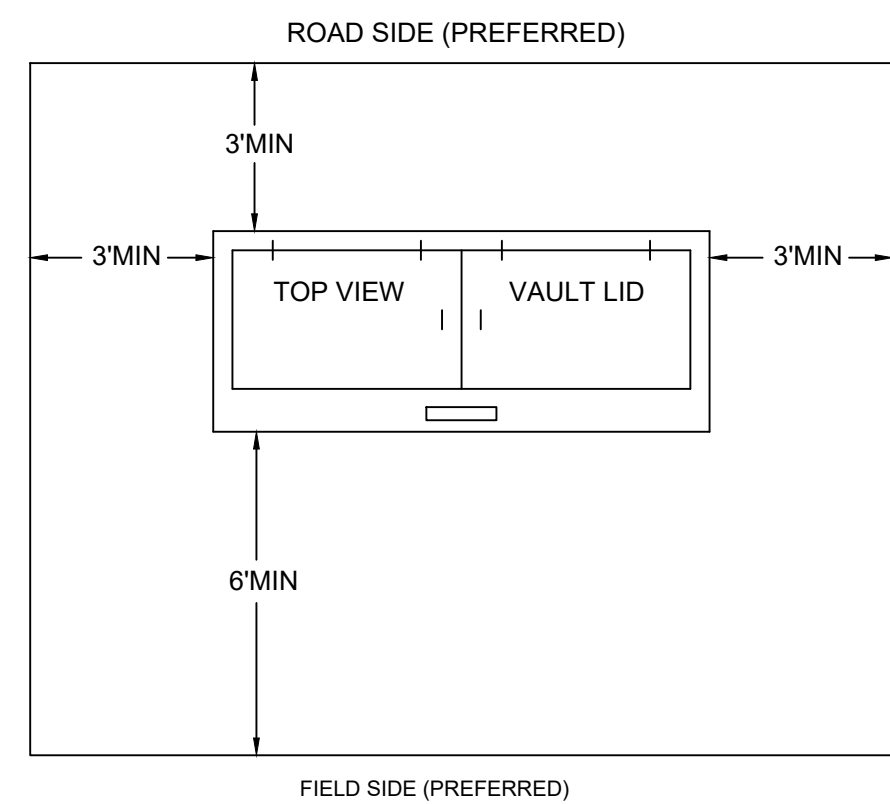

**TOP VIEW VAULT LID**  
 Not to scale 6775.0035.02

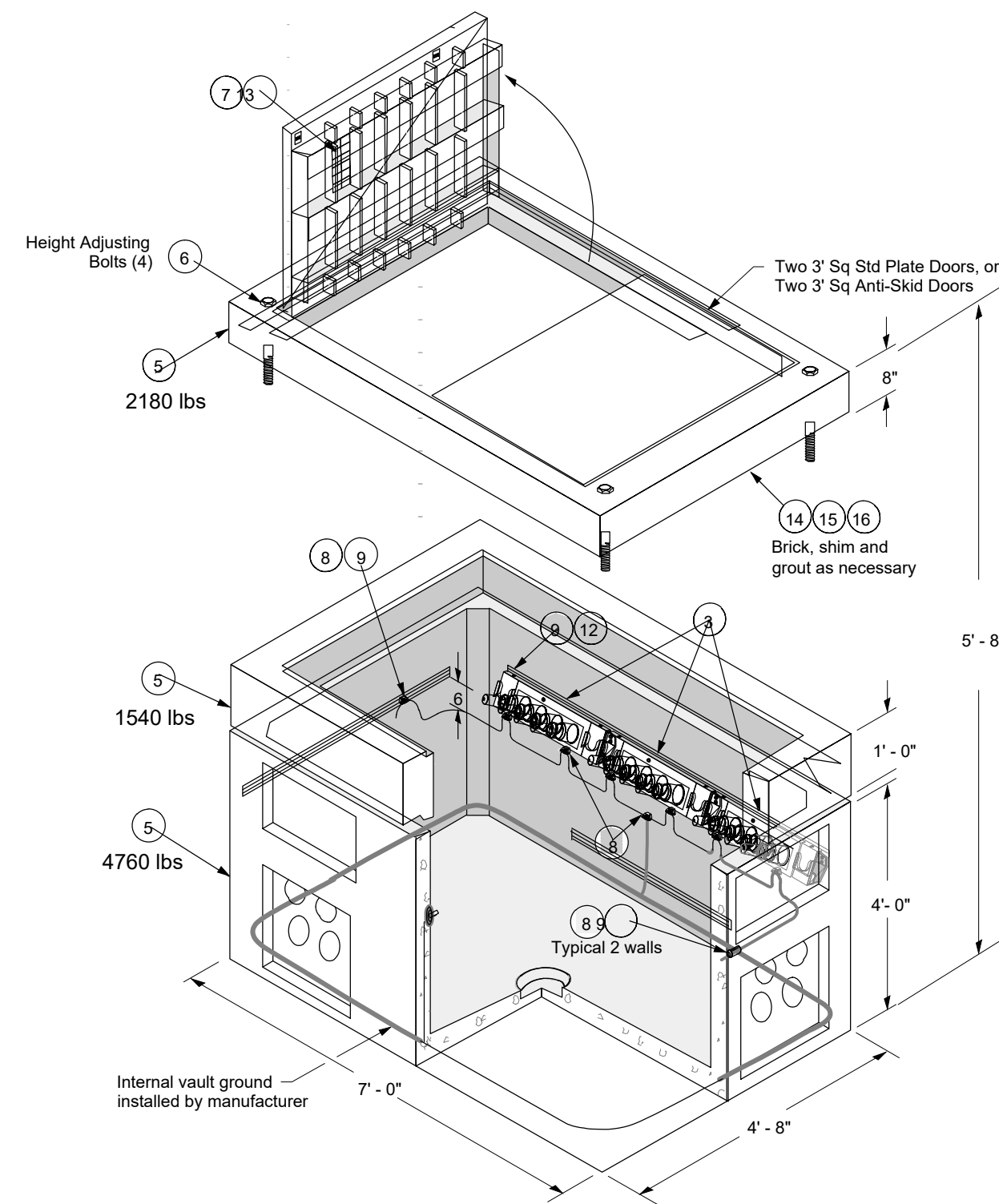

NOTE A: Customer's service wire conduits may enter at any corner other than the corner where the primary cable enters the vault.

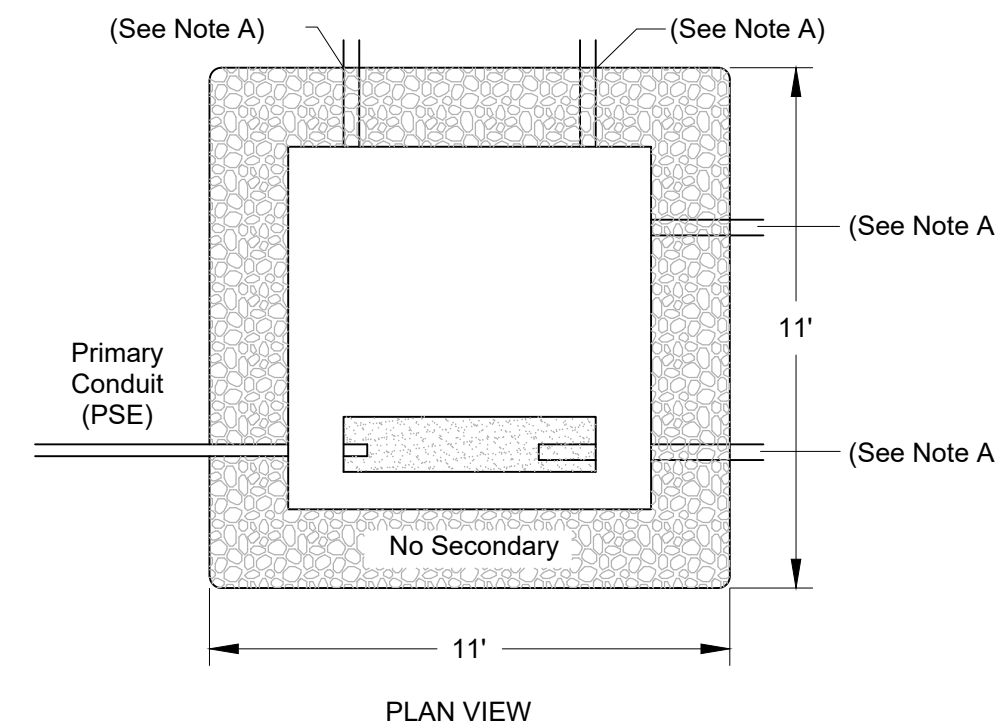

**COMMERCIAL TRANSFORMER CONDUIT PLACEMENT**  
 Not to scale

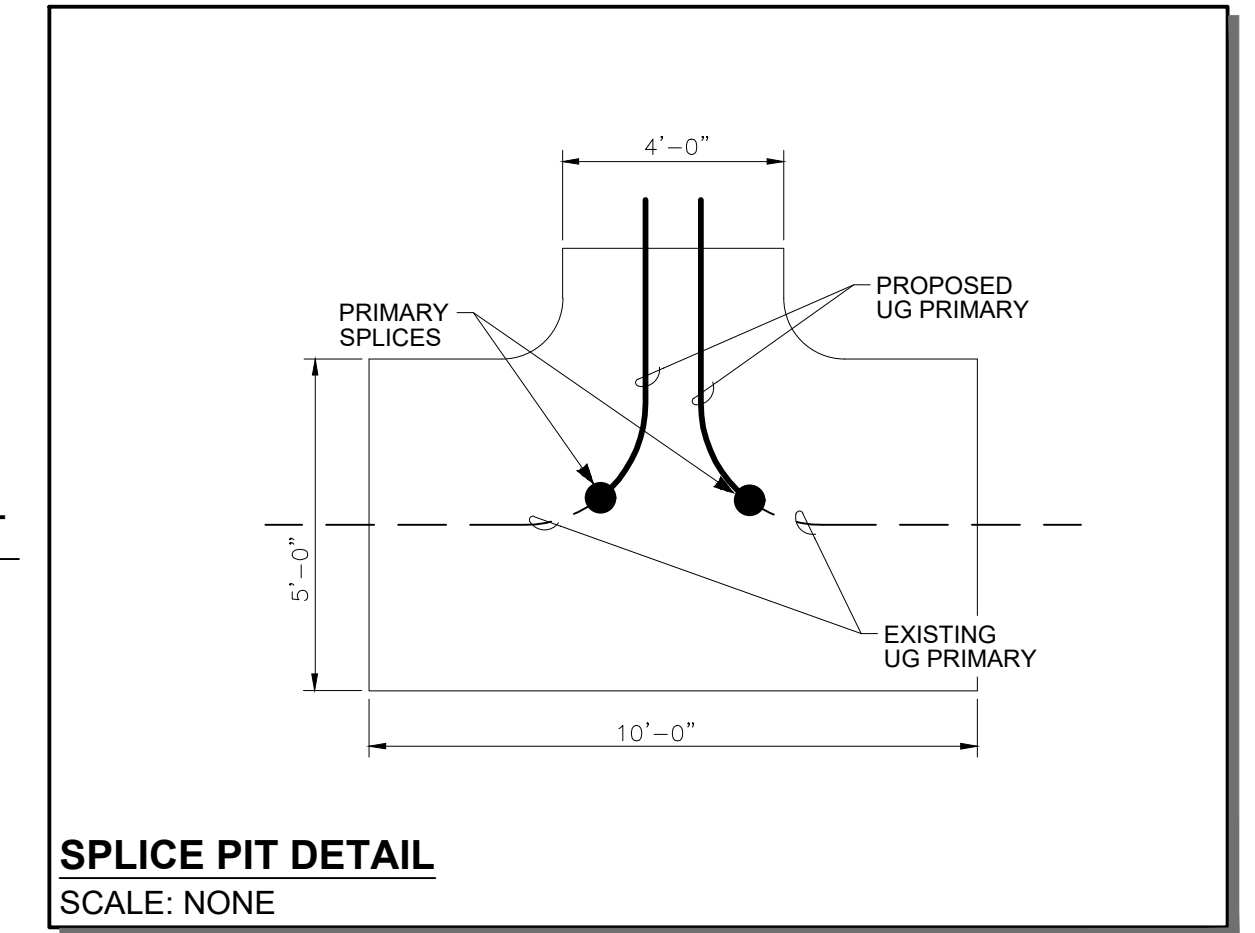

**SPLICE PIT DETAIL**  
 SCALE: NONE

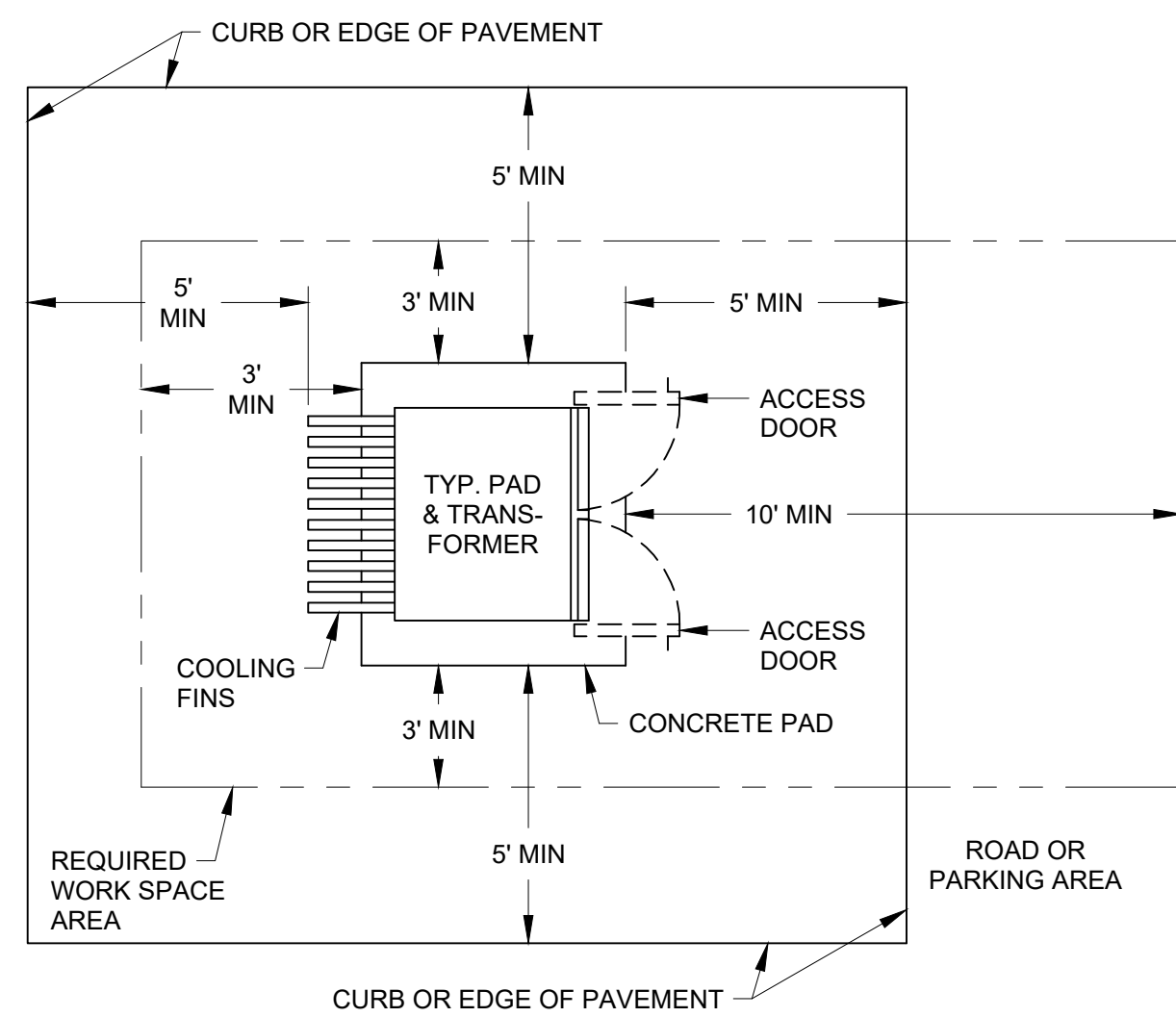

**MINIMUM CLEARANCES FOR PSE EQUIPMENT**  
 Not to scale 6775.0035

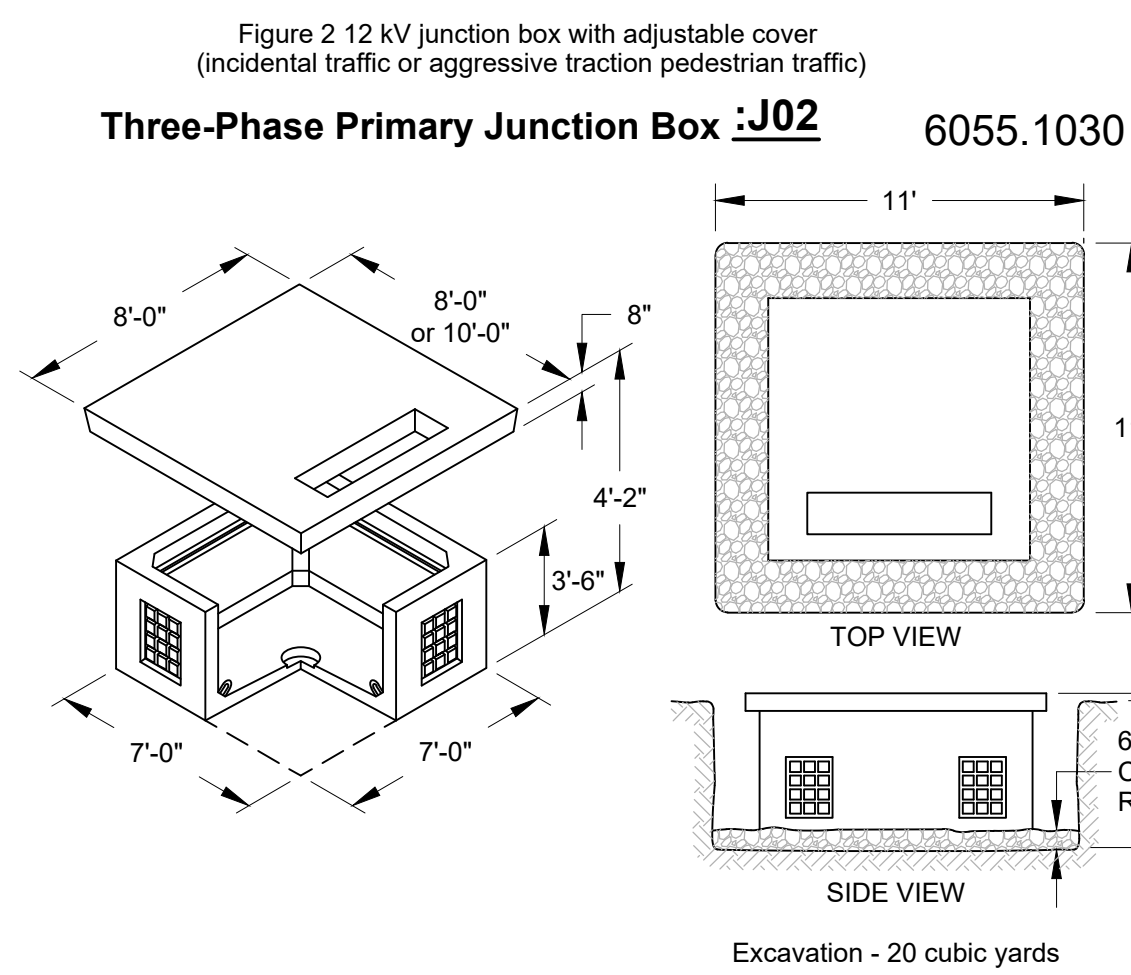

**VAULT & EXCAVATION DETAIL: VO1**  
 Not to scale 6045.5000

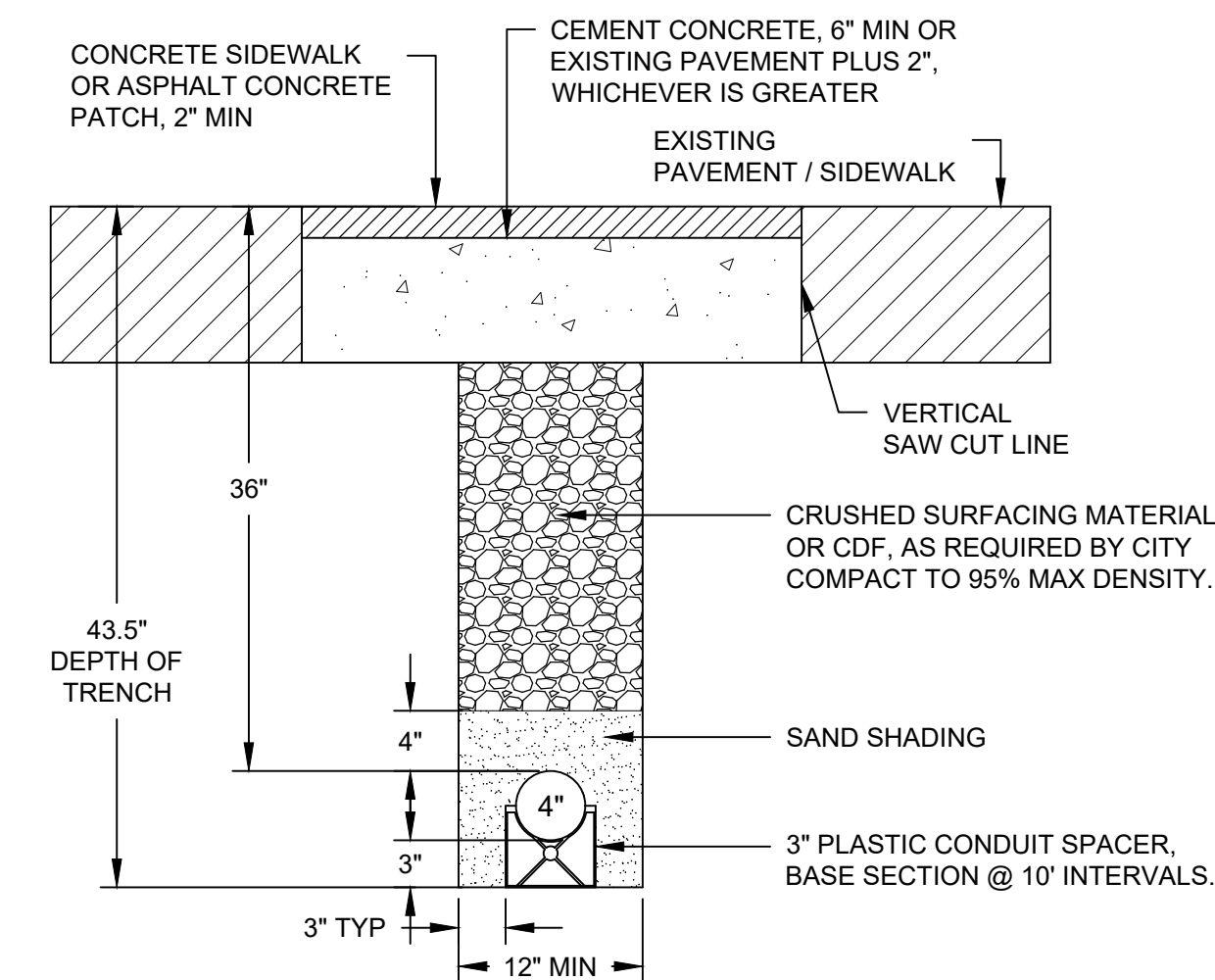

**DUCT BANK EXCAVATION AND RESTORATION DETAIL**  
 SCALE: NONE

For contacts below dial 1-888-CALL PSE (225-5773)

**CALL 811 TWO BUSINESS DAYS BEFORE YOU DIG**

THIS SKETCH NOT TO BE RELIED UPON FOR EXACT LOCATION OF EXISTING FACILITIES

REV#	DATE	BY	DESCRIPTION	ENGR - GAS	PERMIT
3	N/A	N/A	N/A		
2	N/A	N/A	N/A		
1	N/A	N/A	N/A		
3	N/A	N/A	N/A		
2	N/A	N/A	N/A		
1	N/A	N/A	N/A		
3	N/A	N/A	N/A		
2	N/A	N/A	N/A		
1	N/A	N/A	N/A		
3	N/A	N/A	N/A		
2	N/A	N/A	N/A		
1	N/A	N/A	N/A		

REAL ESTATE/EASEMENT	PERMIT
N/A	

UTILITIES	CONTACT	PHONE#
N/A	N/A	N/A
N/A	N/A	N/A
N/A	N/A	N/A

INCIDENT	MAOP
N/A	N/A
N/A	N/A
N/A	N/A

SCALE	PAGE
AS NOTED	22

105104182

Nov 09, 2023 1:45pm C:\Users\zangyu\appdata\local\temp\AcPublish\_13852\105104182\_SNO VALLEY SENIOR HOUSING.dwg