



TOWN OF COLMA

STERLING PARK RESIDENTIAL ADDRESS LOCATIONS

 CITY LIMIT LINE
 STREET ADDRESS
 PUBLIC FACILITY

Note: Only street addresses for residential properties are shown.

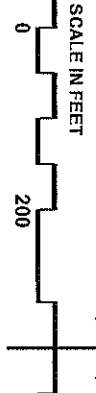

Plan Prepared By:
 LSA Associates, Inc., 395 Oyster Point Boulevard, Suite 307
 South San Francisco, CA 94080, (650) 236-0015
 southsanfrancisco@lsa-assoc.com 04/2010

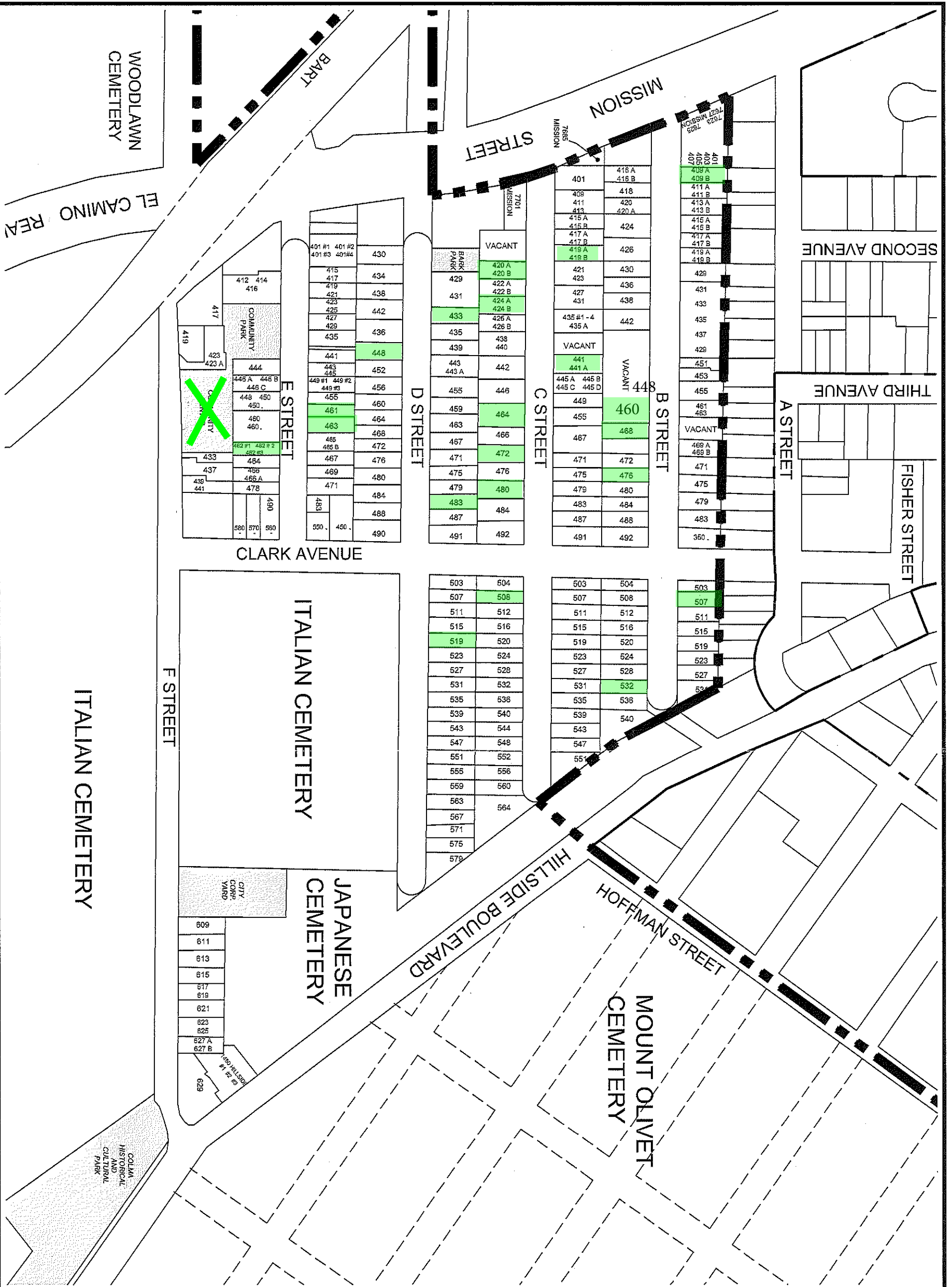

 = Sterling Park
 = Garage Sale Locations

Town of Colma Town Wide Garage Sale

June 1, 2024 - 9am-5pm

Sterling Park Locations & Information

*Map of locations on other side

- 1. 409 B Street**
 - a. Clothes and shoes
 - b. Household items
 - c. Jewelry sets
- 2. 460 B Street**
 - a. Toys
 - b. Video games
 - c. Clothes
- 3. 468 B Street**
 - a. Clothes
 - b. TV
 - c. Tools
- 4. 476 B Street**
 - a. Loft Bed (Full)
 - b. Boys Bike
 - c. Twin Beds (2)
- 5. 507 B Street**
 - a. Baby items
 - b. Clothes and accessories
 - c. Electronics and furniture
- 6. 532 B Street**
 - a. Vinyl records
 - b. Vintage holiday household items
 - c. Costume jewelry
- 7. 419 #A C Street**
 - a. Clothes and toys
 - b. Candles
 - c. Collection coins
- 8. 419 #B C Street**
 - a. Clothes
 - b. House Decor
- 9. 420 C Street**
 - a. Clothes
 - b. Toys
 - c. Misc. household items
- 10. 424 #B C Street**
 - a. Kids clothes
 - b. Toys
 - c. Women's and men's shoes
- 11. 441 C Street**
 - a. Shoes
 - b. Women's clothes
- 12. 464 C Street**
 - a. Misc. Items
- 13. 472 C Street**
 - a. Clothes
 - b. Houseware
 - c. Furniture
- 14. 480 C Street**
 - a. Office furniture/supplies
 - b. Automotive tools
 - c. Clothing
- 15. 508 C Street**
 - a. Guitar
 - b. Music items- records, box
 - c. Misc. household items
- 16. 433 D Street**
 - a. Jewelry
 - b. Holiday items
 - c. Charms
- 17. 448 D Street**
 - a. Motorcycle
 - b. Luggage
- 18. 483 D Street**
 - a. Misc. Items
- 19. 519 D Street**
 - a. Cash register
 - b. Kitchen table and 4 chairs
 - c. Video projector
 - d. Bike and vacuum
- 20. 461 E Street**
 - a. Clothing and shoes
 - b. Toys
 - c. Accessories
- 21. 463 E Street**
 - a. Dining Table and 4 chairs
 - b. Clothes and shoes
- 22. 462 E Street**
 - a. Bakeware
 - b. Kitchen gadgets