



Town of Colma Drought Garden Location:

- North side of the Colma Historical Museum, 1500 Hillside Boulevard, Colma, CA 94014
- Close to intersection of F Street and Hillside Boulevard
- Street parking available on F Street or Hillside Boulevard

← HILLSIDE BLVD →

← MUSEUM →

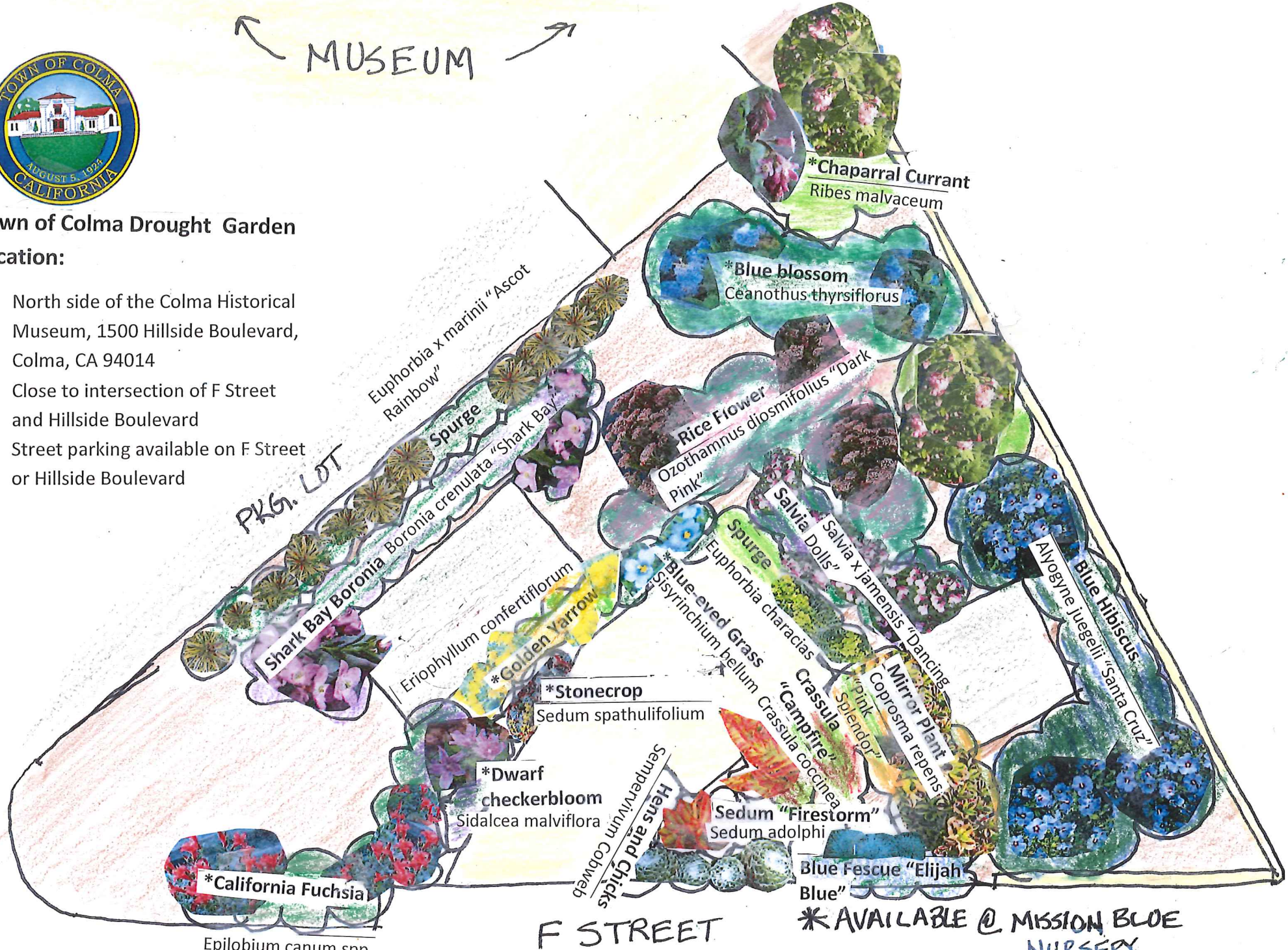

F STREET



Mission Blue Nursery:

- Supports San Bruno Mountain conservation
- For information, go to the San Bruno Mountain Watch Website: mountainwatch.org
- Plant sales to the public on plant sale dates or by appointment with an order of \$100 or more
- Nursery is located at 3401 Bayshore Boulevard, Brisbane

Town of Colma—Drought Tolerant Sample Garden

In response to the worst drought on record in California, the Town of Colma's City Council complied with Governor Jerry Brown's April 1, 2015 Executive order to reduce water use throughout the State. The City Council directed a reduction in irrigation to its landscaped areas by twenty-five percent.

In an effort to show the local community how beautiful a garden can be using a minimal amount of water, the City Council directed the installation of a drought tolerant sample garden. The garden includes a few plants native to San Bruno Mountain and California, and can be purchased and found locally at the Home Depot and Mission Blue Nursery. The Town would like to thank their good friends and partners at the Home Depot in Colma for its generous donation of drought tolerant plants to the Garden.

