

THIS DRAWING IS THE PROPERTY OF DESIGN GROUP FACILITY SOLUTIONS, INC. AND SHALL NOT BE REPRODUCED, COPIED, LENT OR ALTERED DIRECTLY OR INDIRECTLY NOR USED FOR ANY PURPOSE OTHER THAN THAT FOR WHICH IT IS SPECIFICALLY FURNISHED AND MUST BE RETURNED TO DESIGN GROUP FACILITY SOLUTIONS, INC. ON COMPLETION OF WORK, IF REQUESTED.

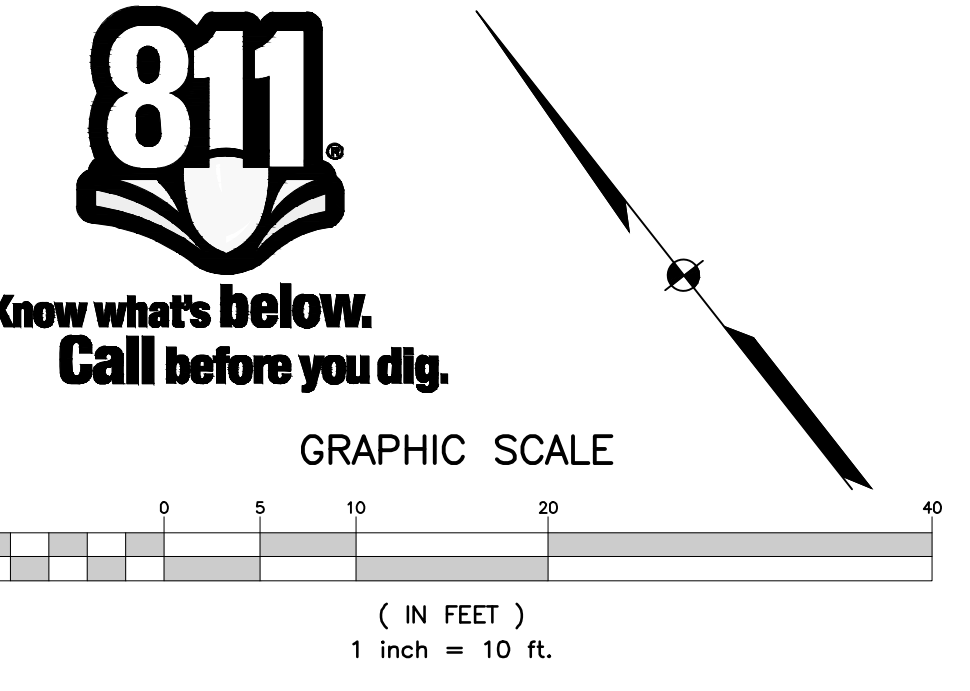
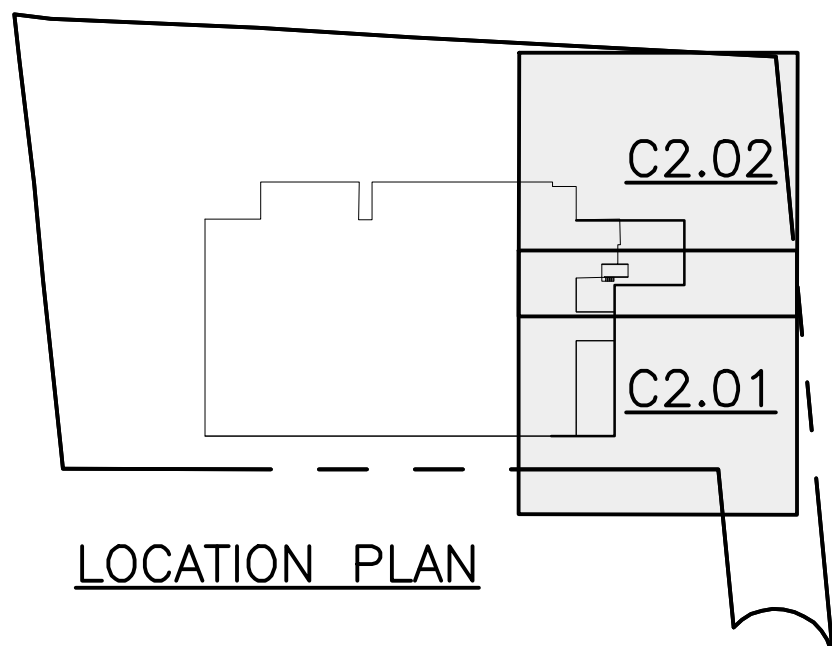
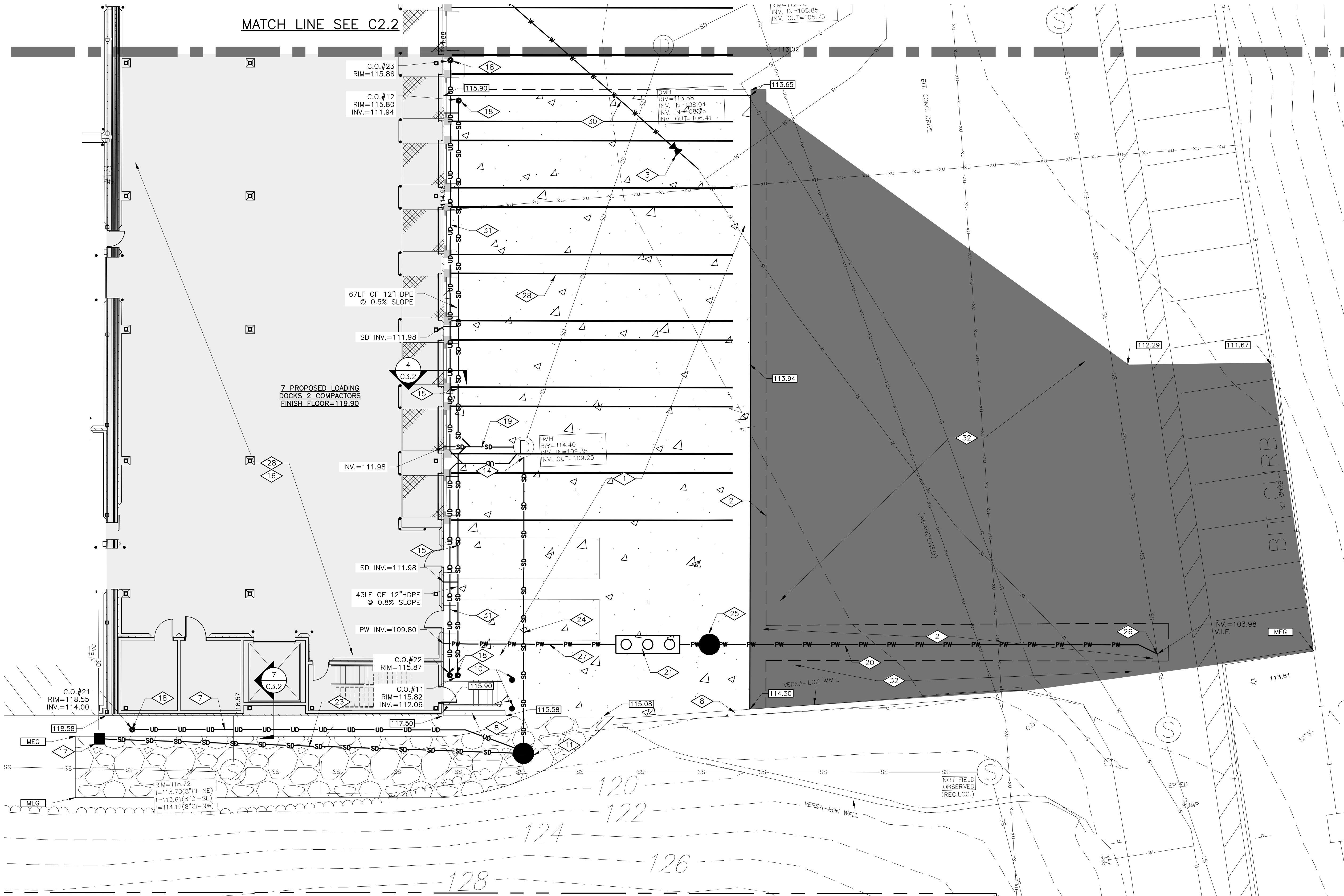

KEY NOTES

- 1. CONSTRUCT CONCRETE TRUCK DOCK CONCRETE PAVEMENT PER DETAIL 2/C3.2.
- 2. CONSTRUCT ASPHALT PAVEMENT AS SHOWN AND PER DETAIL 1,3/C3.2. SEE DEMOLITION PLAN CD1.01 KEYNOTES 2 AND 22 FOR LIMITS OF FULL DEPTH PAVEMENT RECONSTRUCTION.
- 3. FURNISH AND INSTALL 8" GATE VALVE PER DETAIL 1/C3.1.
- 4. COORDINATE DOMESTIC WATER CONNECTION WITH PLUMBING CONTRACTOR.
- 5. SANITARY MAN HOLE #79 WITH FLOW METER AND PH METER PER DETAIL 8/C3.2.
- 6. FURNISH AND INSTALL WYE CONNECTION INTO EXISTING SANITARY AS SHOWN AT INVERT 104.67.
- 7. FURNISH AND INSTALL ±80LF OF 8" HDPE PERFORATED UNDERDRAIN PIPE WITH SOCK PER DETAIL 7, 7B/C3.2.
- 8. CONSTRUCT CONCRETE RETAINING WALL FROM PROPOSED BUILDING, INTEGRAL WITH STRUCTURAL CONCRETE FOUNDATION, AND TIE INTO GRAVEL FIRE ACCESS ROAD RAMP.
- 9. CONSTRUCT PARKING STRIPING, 9' x 18' STALLS, AFTER ASPHALT REPAIR IS COMPLETE. MAINTAIN 12' DRIVE LANE FOR ACCESS TO RAMP ON NORTH SIDE OF BUILDING ADDITION.
- 10. FURNISH AND INSTALL BOLLARDS PER DETAIL 4/C3.1.
- 11. FURNISH AND INSTALL NYLOPLAST STORM DRAIN MANHOLE. RIM=116.00, (WEST) INV. IN=111.33, (NORTH) INV. IN=111.00, (EAST) INV. OUT=109.63. BED IN MATERIALS IN ACCORDANCE WITH THE MANUFACTURERS SPECIFICATIONS.
- 12. PASSIVE GREASE INTERCEPTOR WITH BAFFLE BY HIGHLAND TANK, MODEL PGI-1250-3. VERIFY CONNECTION ELEVATIONS TO EXISTING UTILITIES AND PROVIDE SHOP DRAWINGS FOR APPROVAL PRIOR TO ORDERING STRUCTURES. SEE 2/C3.03 FOR STRUCTURE DETAILS.
- 13. APPROXIMATE PHASE 2 BUILDING ADDITION, SEE ARCHITECTURAL PLANS FOR MORE INFORMATION.
- 14. CORE DRILL INTO EXISTING STRUCTURE FOR PROPOSED 15" HDPE STORM LINE. FURNISH AND INSTALL RUBBER BOOT. PROPOSED INV. IN = 109.35.
- 15. FURNISH AND INSTALL 12" HDPE DOWN SPOUT MANIFOLD PER 3/C3.1.
- 16. APPROXIMATE PHASE 1 BUILDING ADDITION, SEE ARCHITECTURAL PLANS FOR MORE INFORMATION.
- 17. SITE CONTRACTOR SHALL FIELD VERIFY EXISTING PIPE INVERTS AND FURNISH AND INSTALL NYLOPLAST CATCH BASIN WITH DUCTILE IRON GRATE PER DETAIL. RIM=118.62, INV.=112.77 PROVIDE SHOP DRAWING FOR APPROVAL PRIOR TO ORDERING.
- 18. FURNISH AND INSTALL CLEAN OUT PER DETAIL 2/C3.1.
- 19. FURNISH AND INSTALL 13LF OF STORM DRAIN LINE PER DETAIL 3/C3.1 FROM PROPOSED BUILDING ADDITION TO EXISTING MANHOLE AT EXISTING INVERT 109.35. MATCH EXISTING PIPE SIZE AND MATERIAL.
- 20. 8" SDR 35 PVC SANITARY SEWER AT 0.006 FT/FT. CONNECT TO 8" SANITARY MAIN. VERIFY CONNECTION ELEVATIONS TO EXISTING UTILITIES AND CONNECTIONS TO BUILDING AS WELL AS UTILITY TIE IN POINTS.
- 21. PASSIVE GREASE INTERCEPTOR WITH BAFFLE BY HIGHLAND TANK, MODEL PGI-750-3. VERIFY CONNECTION ELEVATIONS TO EXISTING UTILITIES AND PROVIDE SHOP DRAWINGS FOR APPROVAL PRIOR TO ORDERING STRUCTURES. SEE 1/C3.03 FOR STRUCTURE DETAIL.
- 22. CONTRACTOR SHALL REMOVE AND REPLACE EMPTY 4" PVC CONDUITS AS NECESSARY FOR PROPOSED STORM PIPE INSTALLATION.
- 23. FURNISH AND INSTALL 80LF OF 10"HDPE @ 1.8% SLOPE PER DETAIL 3/C3.1.
- 24. FURNISH AND INSTALL 56LF OF 15"HDPE @ 0.5% SLOPE PER DETAIL 3/C3.1.
- 25. SANITARY SEWER MANHOLE #86 WITH FLOW METER AND PH METER PER DETAIL 8/C3.2.
- 26. FURNISH AND INSTALL WYE CONNECTION INTO EXISTING SANITARY AS SHOWN AT INVERT 104.31.
- 27. 6" SDR 35 PVC SANITARY SEWER AT 1% SLOPE. CONNECT TO 8" SANITARY MAIN. VERIFY INVERTS WITH PLUMBING CONTRACTOR AND CONNECTIONS TO BUILDING AS WELL AS UTILITY TIE IN POINTS.
- 28. CONSTRUCT 2 COATS OF 6" WIDE WHITE TRUCK PARKING STRIPES (9'x55') AS SHOWN ON PLAN CENTERED ON TRUCK DOCK DOORS.
- 29. FURNISH AND INSTALL STORM DRAIN MAN HOLE PER DETAIL 9/C3.2.
- 30. PROPOSED WATERLINE, REROUTE TO THE PROPOSED BUILDING ADDITION. MATCH EXISTING PIPE MATERIAL AND SIZE. CAP PROPOSED WATER LINE AT BOUNDARY OF PHASE 1 AND 2. PREPARE WATERLINE FOR CONTINUATION IN PHASE 2 AS SHOWN ON C2.2. INSTALL PER DETAIL 3/C3.1. SITE CONTRACTOR SHALL FIELD VERIFY WATER/FIRE SERVICE LINE LOCATION, MATERIAL AND SIZE, AND EXCAVATE, INSTALL, TEST, DISINFECT, BACKFILL AND COMPACT FOR PROPOSED WATER AND FIRE SERVICE LINES AS SHOWN AND PER DETAILS 1,3,6/C3.1. MAINTAIN 10' MINIMUM HORIZONTAL AND 18" VERTICAL SEPARATION FROM SANITARY SEWER LINES. ALL WORK SHALL MEET THE APPLICABLE REQUIREMENTS OF THE TOWN OF DANVERS WATER DEPARTMENT.
- 31. FURNISH AND INSTALL 8" HDPE PERFORATED UNDERDRAIN PIPE WITH SOCK PER DETAIL 7, 7B/C3.2.
- 32. MILL AND FILL HATCHED AREA OUTSIDE OF PAVEMENT PATCH WORK, SEE KEYNOTE #2. MILL AND FILL SHALL BE COMPLETED ALL AT ONE TIME AT THE END OF THE IMPROVEMENTS. RESTRIPE EXISTING PARKING STALLS AND PEDESTRIAN AISLE.

PROPOSED UTILITY PIPE SIZE, INVERTS, MANHOLES, OIL SEPARATOR INFORMATION IS FOUND ON PROFILE SHEETS C4.01 AND C4.02 UNLESS OTHERWISE PROVIDED.

NO.	DATE	BY	REVISION
0	06/09/20	BR/AM	SUBMITTED FOR PERMITTING



OLD NEIGHBORHOOD FOODS, INC.
 LYNN, MA
 PROJECT: LOADING DOCK EXPANSION
 DANVERS, MA
 DRAWING TITLE: ENLARGED GRADING AND UTILITIES PLAN

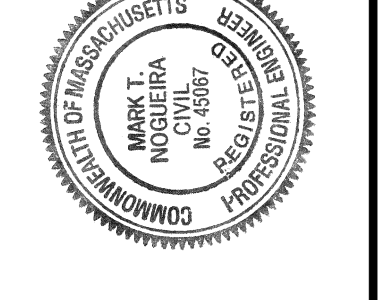

PROJECT NO. 2001673
 ISSUED 06/09/2020
 SCALE 1"=10'
 DRAWN BY GAR
 DRAWING NO.

C2.01