

# AUSTIN AVE. & PARK ST. STORM AND SANITARY SEWER IMPROVEMENTS EFFINGHAM, IL



**J.U.L.I.E.**  
JOINT UTILITY LOCATION INFORMATION FOR EXCAVATION  
1-800-892-0123 OR 811

**UTILITY NOTE:**  
THE LOCATIONS OF THOSE BURIED AND ABOVEGROUND UTILITIES SHOWN ARE APPROXIMATE, ARE SHOWN FOR CONTRACTOR INFORMATIONAL USE ONLY, AND ARE NOT TO BE REFERENCED FOR CONSTRUCTION PURPOSES. THE IMPLIED PRESENCE OR ABSENCE OF UTILITIES IS NOT TO BE CONSTRUED BY THE OWNER, ENGINEER, CONTRACTOR, OR SUBCONTRACTORS TO BE AN ACCURATE AND COMPLETE REPRESENTATION OF UTILITIES THAT MAY OR MAY NOT EXIST ON THE CONSTRUCTION SITE. BURIED AND ABOVEGROUND UTILITY LOCATION, IDENTIFICATION, AND MARKING ARE THE SOLE RESPONSIBILITY OF THE CONTRACTOR. REROUTING, DISCONNECTION, PROTECTION, ETC. OF ANY UTILITIES MUST BE COORDINATED BETWEEN THE CONTRACTOR, UTILITY COMPANY, AND OWNER. SITE SAFETY, INCLUDING THE AVOIDANCE OF HAZARDS ASSOCIATED WITH BURIED AND ABOVEGROUND UTILITIES, REMAIN THE SOLE RESPONSIBILITY OF THE CONTRACTOR.

UTILITY CONTACTS			
CONTACT TYPE:	COMPANY NAME:	CONTACT PHONE:	STREET ADDRESS:
ELECTRIC & GAS:	AMEREN ILLINOIS	(618) 236-6281	1800 FORD AVENUE EFFINGHAM, IL 62401
WATER & SEWER:	CITY OF EFFINGHAM	(217) 342-5303	201 EAST JEFFERSON AVENUE EFFINGHAM, IL 62401
CABLE/PHONE:	ILLINOIS CONSOLIDATED COMMUNICATIONS	(217) 235-3355	P.O. BOX 523 EFFINGHAM, IL 62401
	MEDIACOM	(217) 348-5533 EXT. 7808	710 WEST JEFFERSON AVENUE EFFINGHAM, IL 62401



## VICINITY MAP

DRAWINGS RELEASED FOR:	
<input type="checkbox"/>	PLAN REVIEW
<input type="checkbox"/>	PERMITTING
<input checked="" type="checkbox"/>	BIDDING
<input type="checkbox"/>	CONSTRUCTION
02/05/2025 DATE	

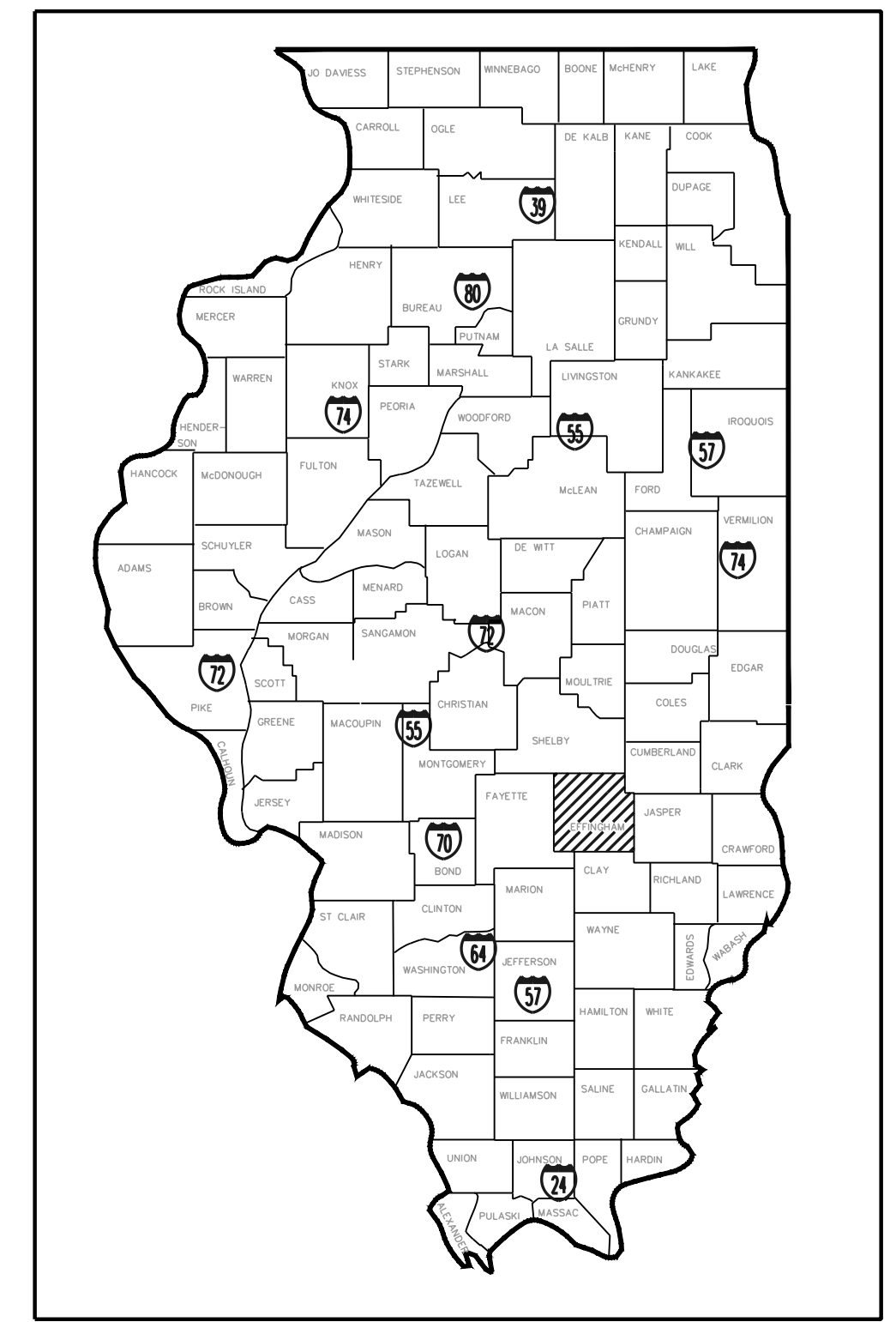

STATE LOCATION MAP

DRAWING INDEX	
C000	COVER SHEET
C100	DEMOLITION PLAN
C200	OVERALL SITE PLAN
C300-301	SANITARY PLAN AND PROFILE
C400	STORM SEWER PLAN AND PROFILE
C500	CIVIL DETAILS

APPROVED: CITY OF EFFINGHAM

*[Signature]* 2/5/25  
CITY ENGINEER DATE

*[Signature]* 2/5/25  
DIRECTOR OF PUBLIC WORKS DATE

*[Signature]* 2/5/2025  
CITY ADMINISTRATOR DATE

WES M. KISTLER  
062-068499  
STATE OF ILLINOIS  
CIVIL ENGINEER  
SIGNED: 02/05/2025  
EXPIRES: 11/30/2025

DATE: 02/05/2025  
CDI #: 5592  
DESIGNED BY: WMK  
DRAWN BY: LJB  
CHECKED BY: WMK

REV. NO.	DATE	REMARKS
1	02/17/24	ADDENDUM #1

**CDI**  
CIVIL DESIGN, INC.  
104 N. SECOND STREET, SUITE A  
EFFINGHAM, IL 62401  
217.342.2025  
ILLINOIS PROFESSIONAL DESIGN FIRM  
LICENSE # 184.003222

AUSTIN AVE. & PARK ST.  
STORM AND SANITARY  
SEWER IMPROVEMENTS  
EFFINGHAM, ILLINOIS

SHEET TITLE  
**COVER SHEET**

SHEET NO.  
**C000**

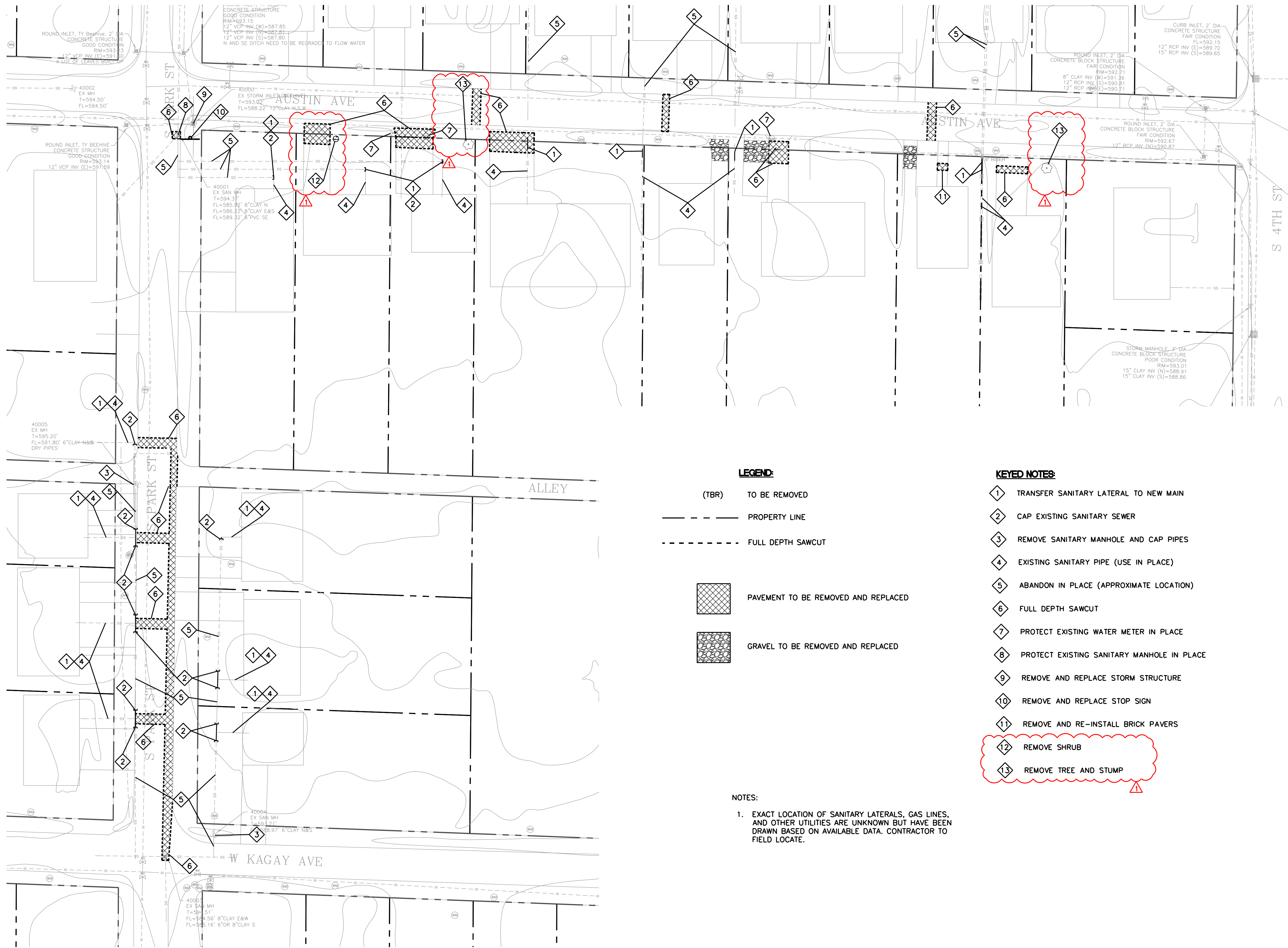

- LEGEND:**
- (TBR) TO BE REMOVED
  - PROPERTY LINE
  - FULL DEPTH SAWCUT
  - [Cross-hatch pattern] PAVEMENT TO BE REMOVED AND REPLACED
  - [Stippled pattern] GRAVEL TO BE REMOVED AND REPLACED

- KEYED NOTES:**
- 1 TRANSFER SANITARY LATERAL TO NEW MAIN
  - 2 CAP EXISTING SANITARY SEWER
  - 3 REMOVE SANITARY MANHOLE AND CAP PIPES
  - 4 EXISTING SANITARY PIPE (USE IN PLACE)
  - 5 ABANDON IN PLACE (APPROXIMATE LOCATION)
  - 6 FULL DEPTH SAWCUT
  - 7 PROTECT EXISTING WATER METER IN PLACE
  - 8 PROTECT EXISTING SANITARY MANHOLE IN PLACE
  - 9 REMOVE AND REPLACE STORM STRUCTURE
  - 10 REMOVE AND REPLACE STOP SIGN
  - 11 REMOVE AND RE-INSTALL BRICK PAVERS
  - 12 REMOVE SHRUB
  - 13 REMOVE TREE AND STUMP

**NOTES:**

- EXACT LOCATION OF SANITARY LATERALS, GAS LINES, AND OTHER UTILITIES ARE UNKNOWN BUT HAVE BEEN DRAWN BASED ON AVAILABLE DATA. CONTRACTOR TO FIELD LOCATE.

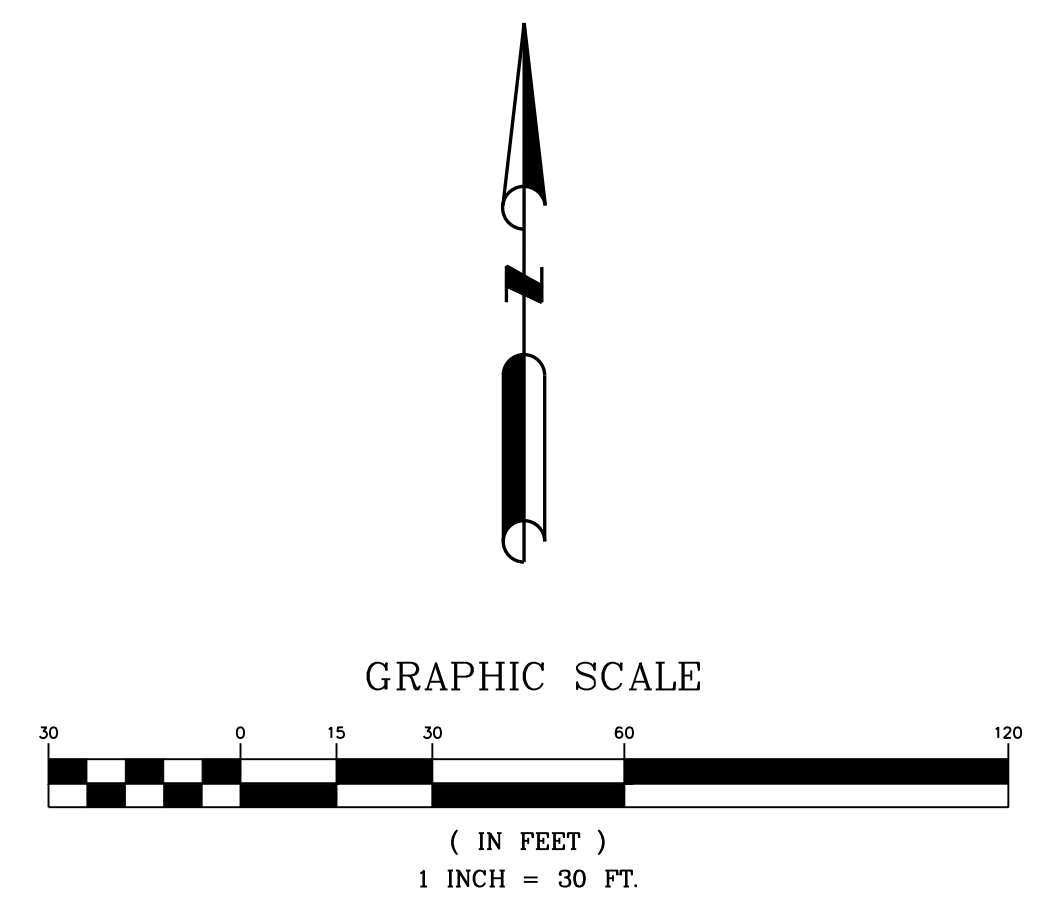

*Wes Kistler*  
 CIVIL ENGINEER  
 SIGNED: 02/05/2025  
 EXPIRES: 11/30/2025

DATE: 02/05/2025  
 CDI #: 5592  
 DESIGNED BY: WMK  
 DRAWN BY: LJB  
 CHECKED BY: WMK

REV. NO.	DATE	REMARKS
1	02/17/24	ADDENDUM #1



CIVIL DESIGN, INC.  
 WBLDDBE  
 104 N. SECOND STREET, SUITE A  
 EFFINGHAM, IL 62401  
 217.342.2025  
 ILLINOIS PROFESSIONAL  
 DESIGN FIRM  
 LICENSE # 184.003222

**AUSTIN AVE. & PARK ST.  
 STORM AND SANITARY  
 SEWER IMPROVEMENTS**  
 EFFINGHAM, ILLINOIS

**DEMOLITION PLAN**

SHEET TITLE  
 SHEET NO. **C100**

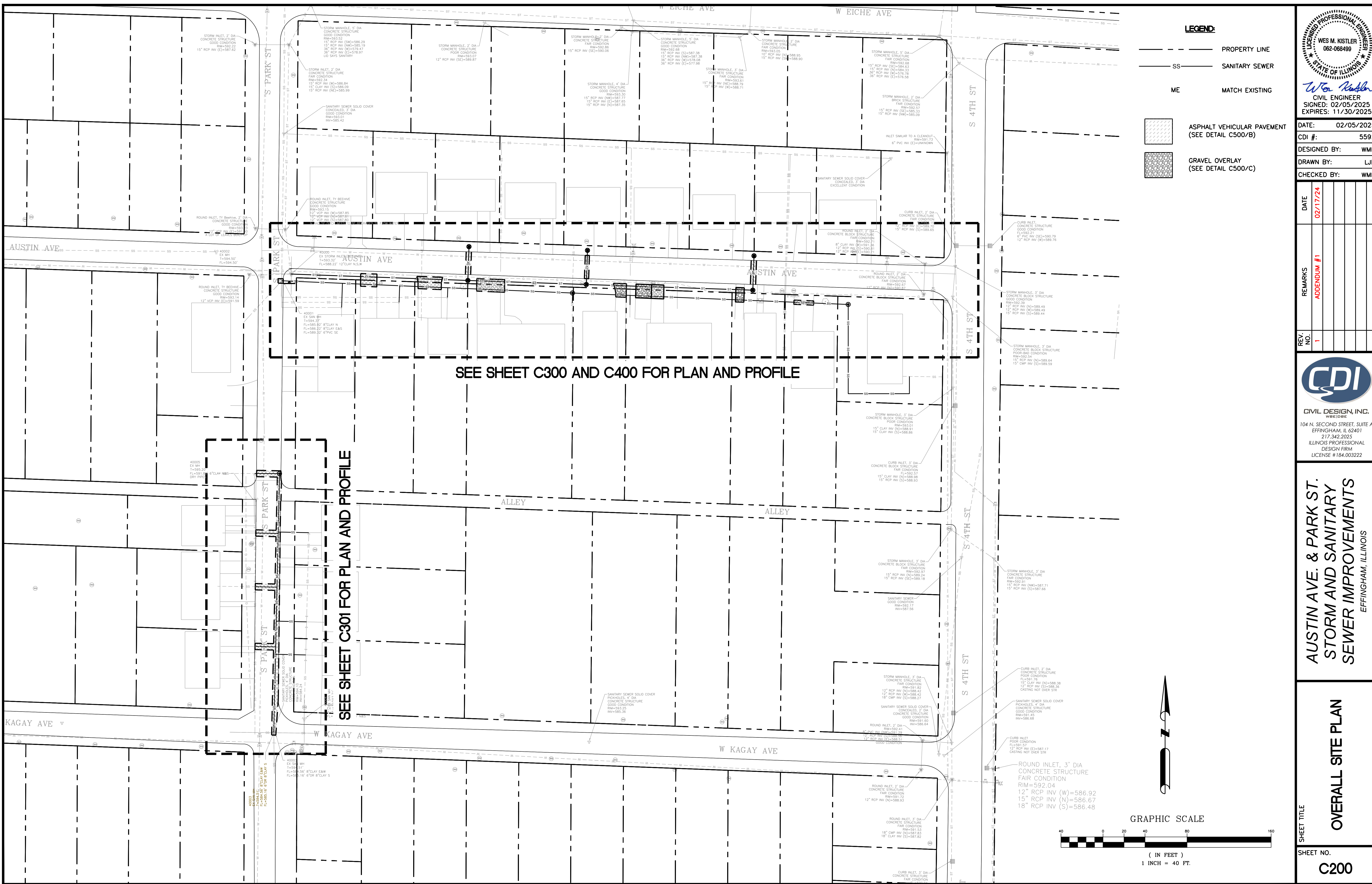

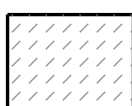
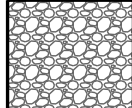
- LEGEND:**
- — — — — PROPERTY LINE
  - SS — — — — — SANITARY SEWER
  - ME — — — — — MATCH EXISTING
  -  ASPHALT VEHICULAR PAVEMENT (SEE DETAIL C500/B)
  -  GRAVEL OVERLAY (SEE DETAIL C500/C)

SEE SHEET C300 AND C400 FOR PLAN AND PROFILE

SEE SHEET C301 FOR PLAN AND PROFILE

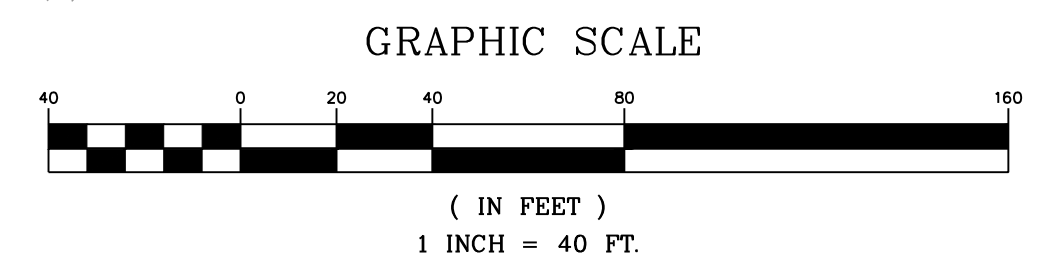
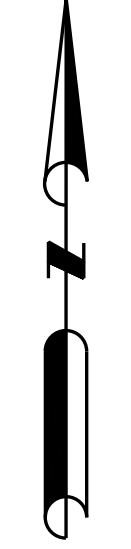

**WES M. KISTLER**  
 062-068499  
 LICENSED PROFESSIONAL ENGINEER  
 STATE OF ILLINOIS  
*Wes Kistler*  
 CIVIL ENGINEER  
 SIGNED: 02/05/2025  
 EXPIRES: 11/30/2025

DATE:	02/05/2025
CDI #:	5592
DESIGNED BY:	WMK
DRAWN BY:	LJB
CHECKED BY:	WMK

REV. NO.	DATE	REMARKS
1	02/17/24	ADDENDUM #1

**CDI**  
 CIVIL DESIGN, INC.  
 WBLDGE  
 104 N. SECOND STREET, SUITE A  
 EFFINGHAM, IL 62401  
 217.342.2025  
 ILLINOIS PROFESSIONAL  
 DESIGN FIRM  
 LICENSE # 184.003222

**AUSTIN AVE. & PARK ST.  
 STORM AND SANITARY  
 SEWER IMPROVEMENTS**  
 EFFINGHAM, ILLINOIS

SHEET TITLE  
**OVERALL SITE PLAN**  
 SHEET NO.  
**C200**



Wes M. Kistler  
CIVIL ENGINEER  
SIGNED: 02/05/2025  
EXPIRES: 11/30/2025

DATE: 02/05/2025  
CDI #: 5592  
DESIGNED BY: WMK  
DRAWN BY: LJB  
CHECKED BY: WMK

REV. NO.	DATE	REMARKS
1	02/17/24	ADDENDUM #1

CIVIL DESIGN, INC.  
104 N. SECOND STREET, SUITE A  
EFFINGHAM, IL 62401  
217.342.2025  
ILLINOIS PROFESSIONAL  
DESIGN FIRM  
LICENSE # 184.003222

**AUSTIN AVE. & PARK ST.  
STORM AND SANITARY  
SEWER IMPROVEMENTS**  
EFFINGHAM, ILLINOIS

**SANITARY PLAN  
AND PROFILE**

SHEET NO.  
**C300**

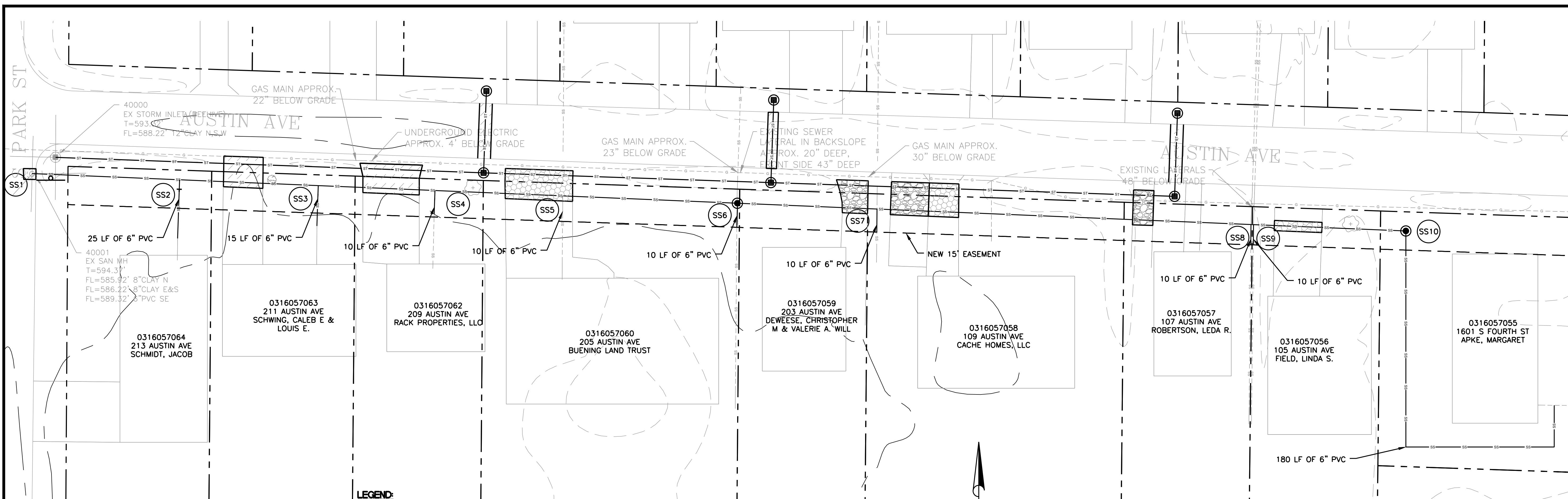

- LEGEND:**
- PAVEMENT REPLACEMENT, HOT-MIX ASPHALT (SEE DETAIL C500/B)
  - AGGREGATE SURFACE COURSE (SEE DETAIL C500/C)
  - PAVEMENT REPLACEMENT, CONCRETE (SEE DETAIL C500/G)
  - PROPERTY LINE
  - SS SANITARY SEWER
  - ST STORM SEWER

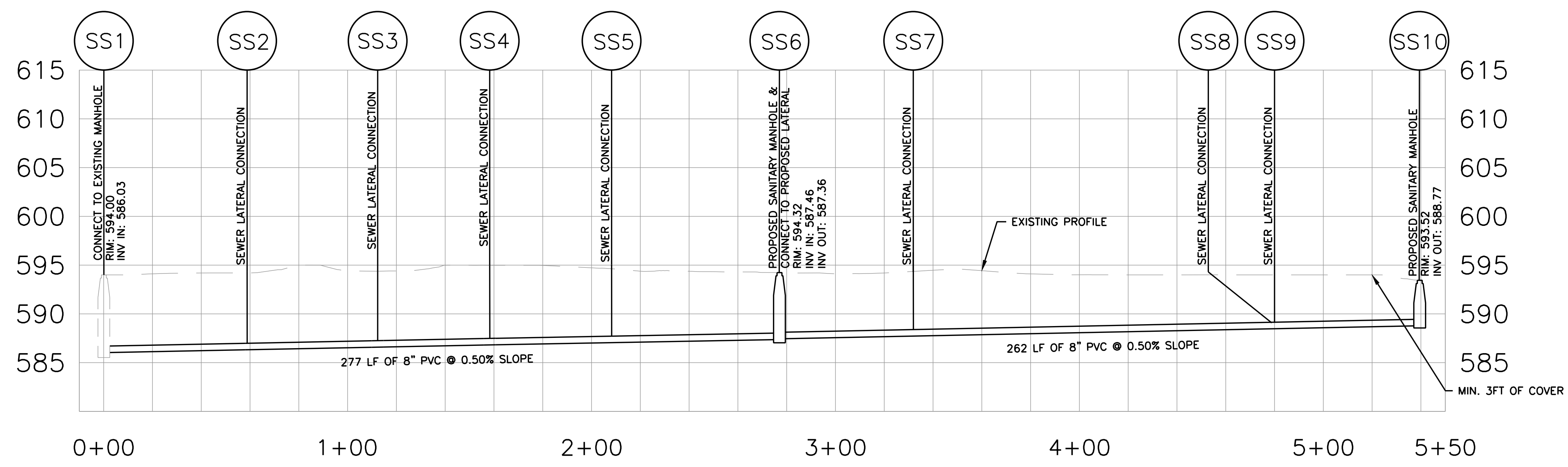
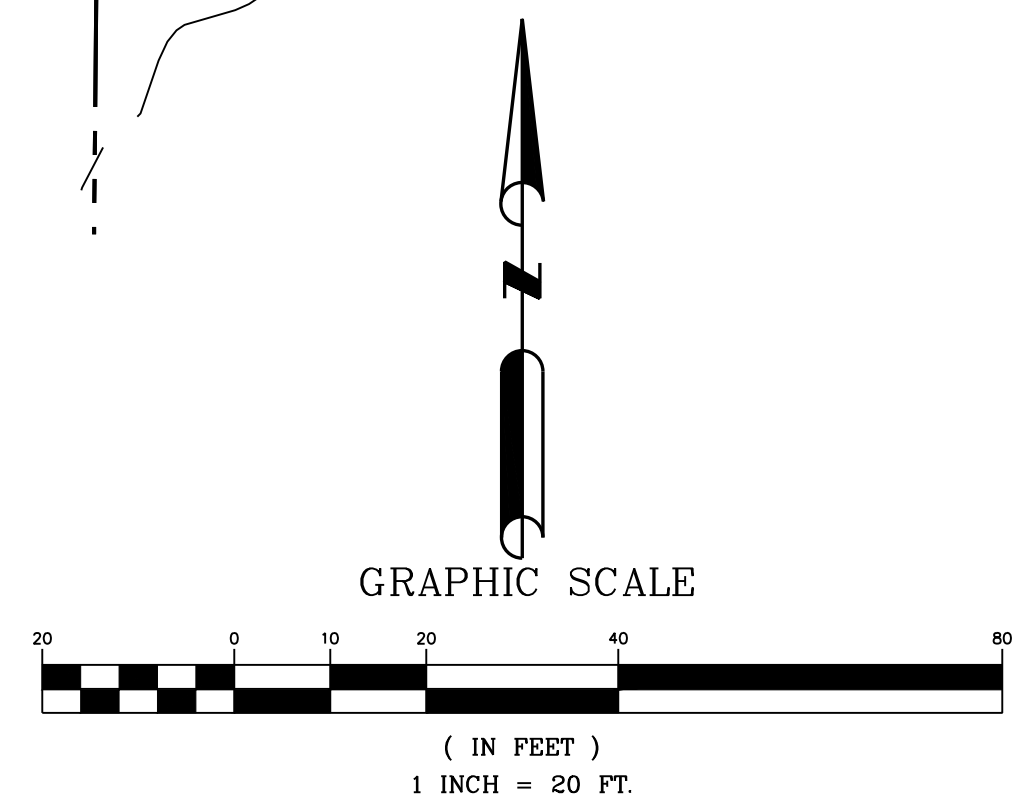

**NOTE:**  
EXISTING PROFILE BASED ON LIDAR DATA. CONTRACTOR TO VERIFY ELEVATIONS BEFORE ORDERING PRECAST CONCRETE STRUCTURES.

**SCALE**  
HORIZONTAL: 1"=20'  
VERTICAL: 1"=5'

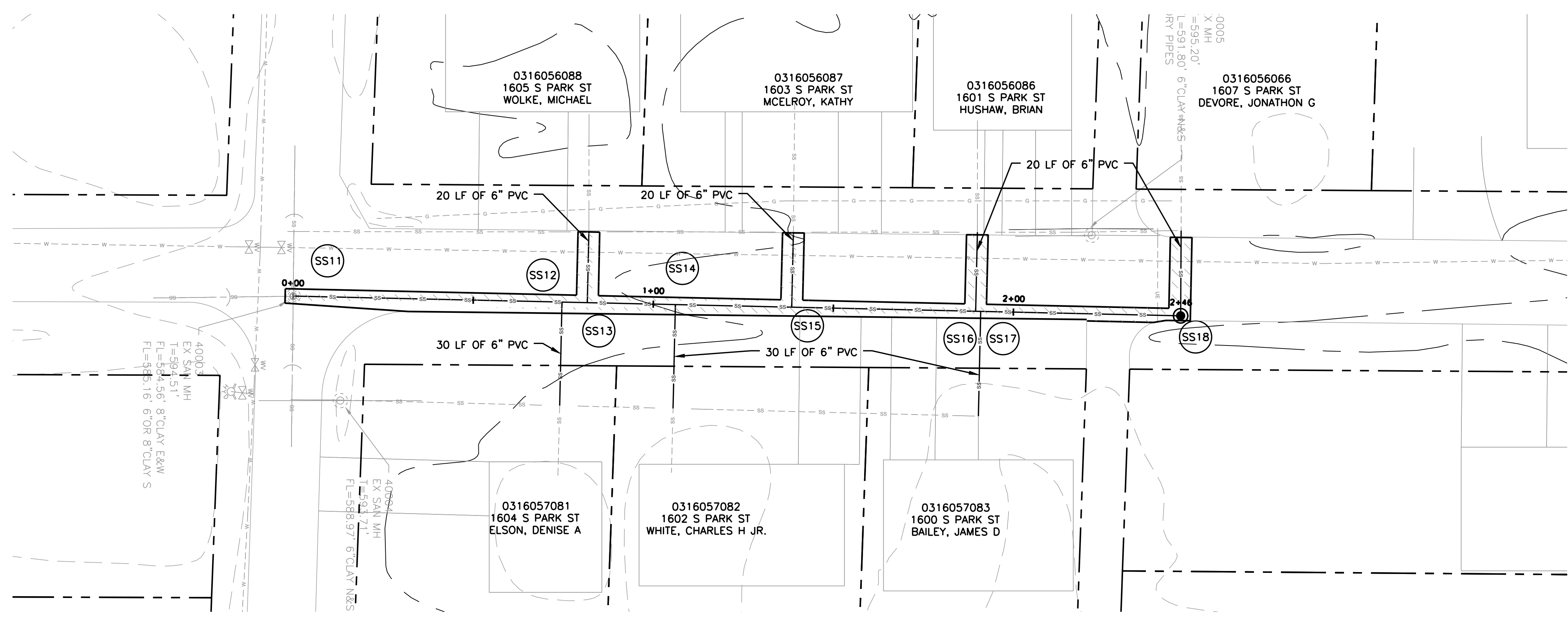

**LEGEND:**  
 - - - - - PROPERTY LINE  
 SS - - - - - SANITARY SEWER  
 ST - - - - - STORM SEWER

PAVEMENT REPLACEMENT, HOT-MIX ASPHALT (SEE DETAIL C500/B)  
 AGGREGATE SURFACE COURSE (SEE DETAIL C500/C)  
 PAVEMENT REPLACEMENT, CONCRETE (SEE DETAIL C500/G)

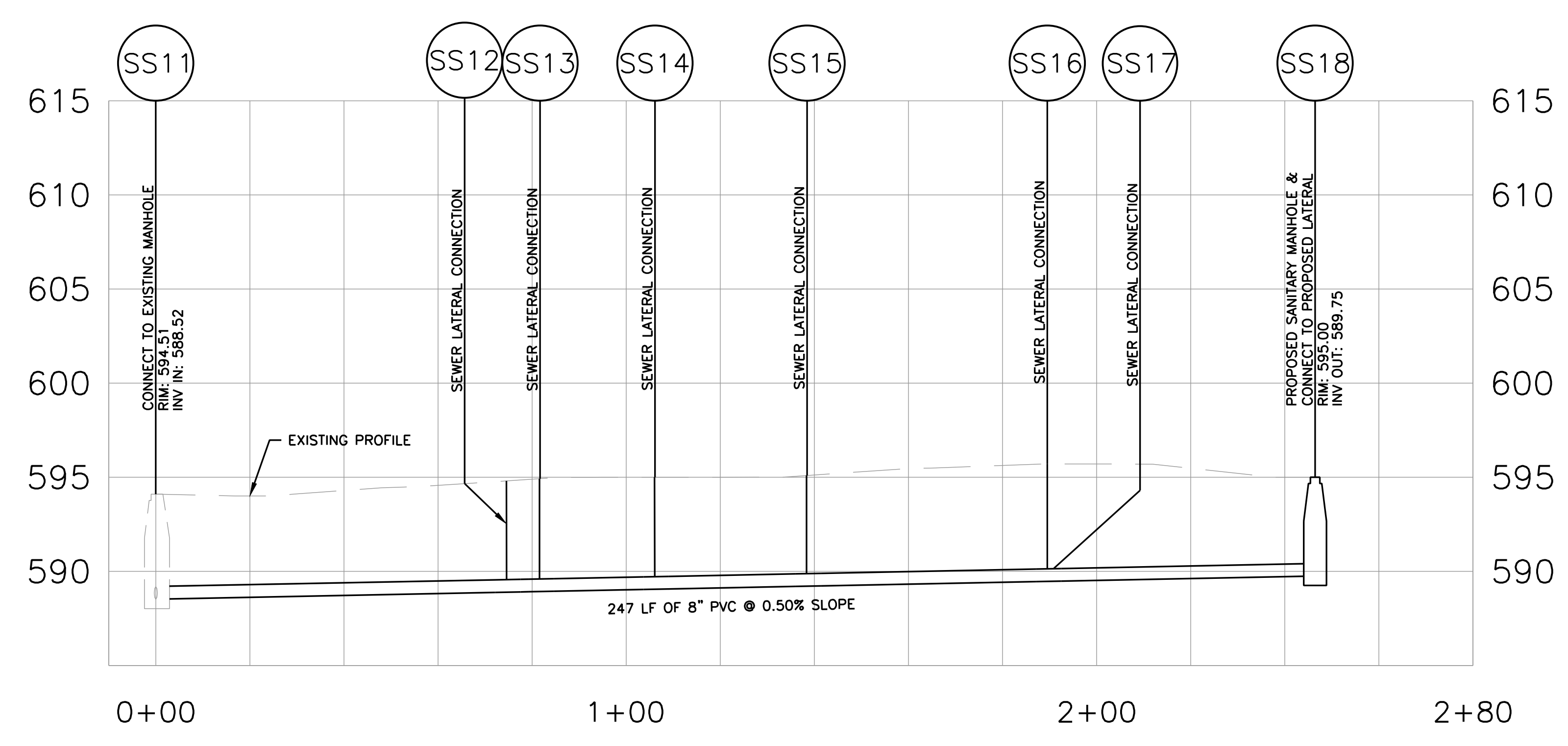
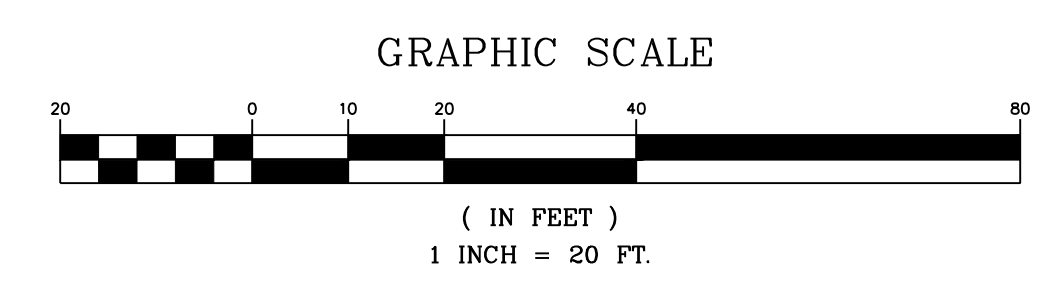
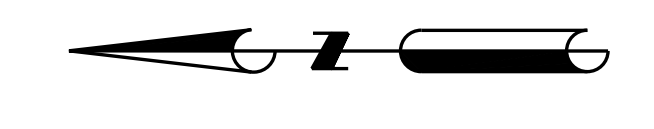

**NOTE:**  
 EXISTING PROFILE BASED ON LIDAR DATA. CONTRACTOR TO VERIFY ELEVATIONS BEFORE ORDERING PRECAST CONCRETE STRUCTURES.

**SCALE**  
 HORIZONTAL: 1"=20'  
 VERTICAL: 1"=5'

PROFESSIONAL ENGINEER  
 WES M. KISTLER  
 062-068499  
 STATE OF ILLINOIS  
 W. M. Kistler  
 CIVIL ENGINEER  
 SIGNED: 02/05/2025  
 EXPIRES: 11/30/2025

DATE: 02/05/2025  
 CDI #: 5592  
 DESIGNED BY: WMK  
 DRAWN BY: LJB  
 CHECKED BY: WMK

REV. NO.	DATE	REMARKS
1	02/17/24	ADDENDUM #1

**CDI**  
 CIVIL DESIGN, INC.  
 WBLDDBE  
 104 N. SECOND STREET, SUITE A  
 EFFINGHAM, IL 62401  
 217.342.2025  
 ILLINOIS PROFESSIONAL  
 DESIGN FIRM  
 LICENSE # 184.003222

**AUSTIN AVE. & PARK ST.  
 STORM AND SANITARY  
 SEWER IMPROVEMENTS**  
 EFFINGHAM, ILLINOIS

SHEET TITLE  
**SANITARY PLAN  
 AND PROFILE**  
 SHEET NO.  
**C301**

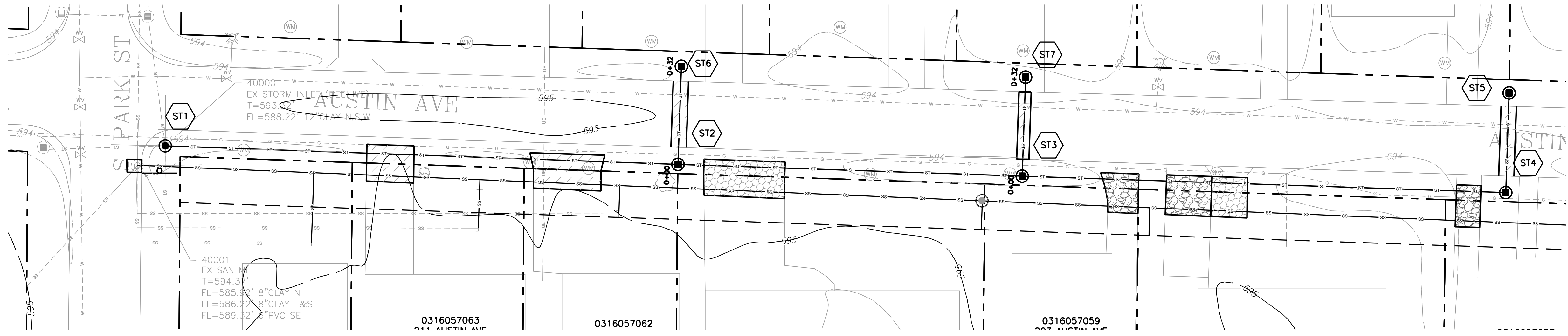

**LEGEND:**

- PROPERTY LINE
- ST --- ST --- STORM SEWER
- SS --- SS --- SANITARY SEWER
- [Pattern] PAVEMENT REPLACEMENT, HOT-MIX ASPHALT (SEE DETAIL C500/B)
- [Pattern] AGGREGATE SURFACE COURSE (SEE DETAIL C500/C)
- [Pattern] PAVEMENT REPLACEMENT, CONCRETE (SEE DETAIL C500/G)



Wes M. Kistler  
CIVIL ENGINEER  
SIGNED: 02/05/2025  
EXPIRES: 11/30/2025

DATE: 02/05/2025  
CDI #: 5592  
DESIGNED BY: WMK  
DRAWN BY: LJB  
CHECKED BY: WMK

REV. NO.	DATE	REMARKS
1	02/17/24	ADDENDUM #1

CIVIL DESIGN, INC.  
104 N. SECOND STREET, SUITE A  
EFFINGHAM, IL 62401  
217.342.2025  
ILLINOIS PROFESSIONAL DESIGN FIRM  
LICENSE # 184.003222

**AUSTIN AVE. & PARK ST.  
STORM AND SANITARY  
SEWER IMPROVEMENTS**  
EFFINGHAM, ILLINOIS

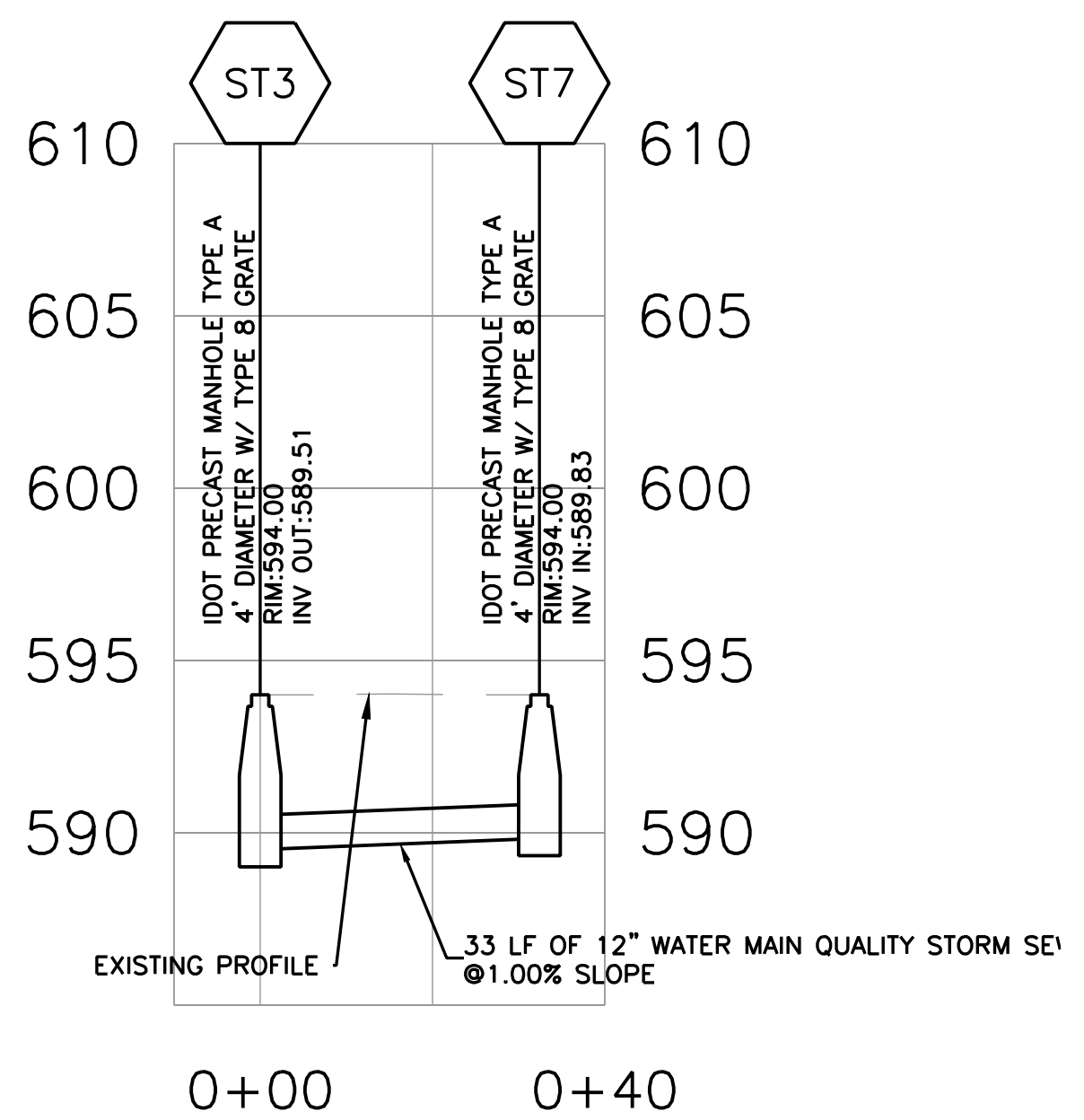
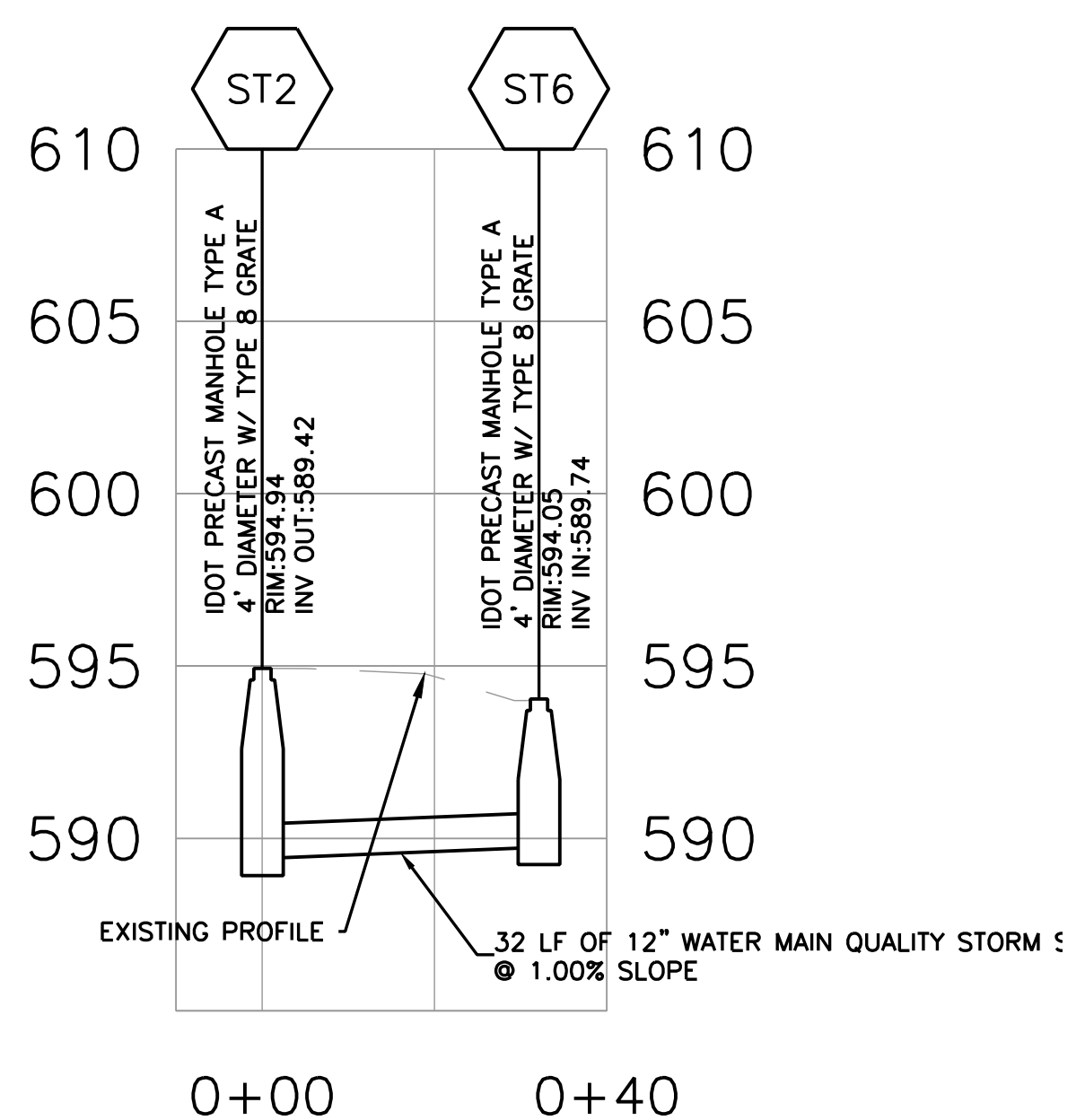
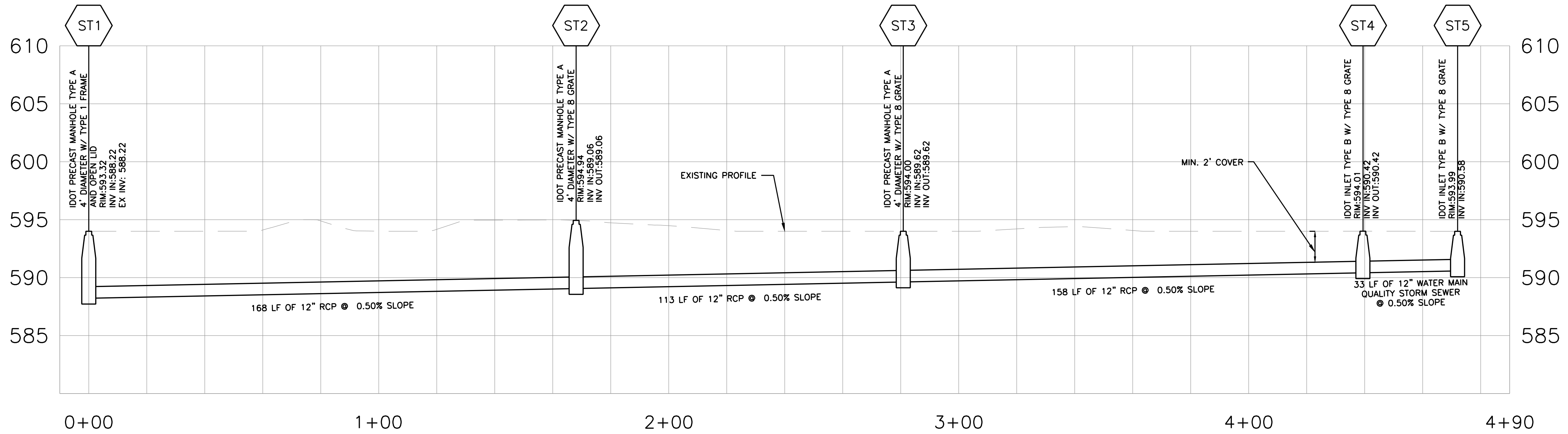

**NOTE:**  
EXISTING PROFILE BASED ON LIDAR DATA. CONTRACTOR TO VERIFY ELEVATIONS BEFORE ORDERING PRECAST CONCRETE STRUCTURES.

GRAPHIC SCALE  
( IN FEET )  
1 INCH = 20 FT.

**SCALE**  
HORIZONTAL: 1"=20'  
VERTICAL: 1"=5'

SHEET TITLE  
**STORM SEWER  
PLAN AND PROFILE**

SHEET NO.  
**C400**

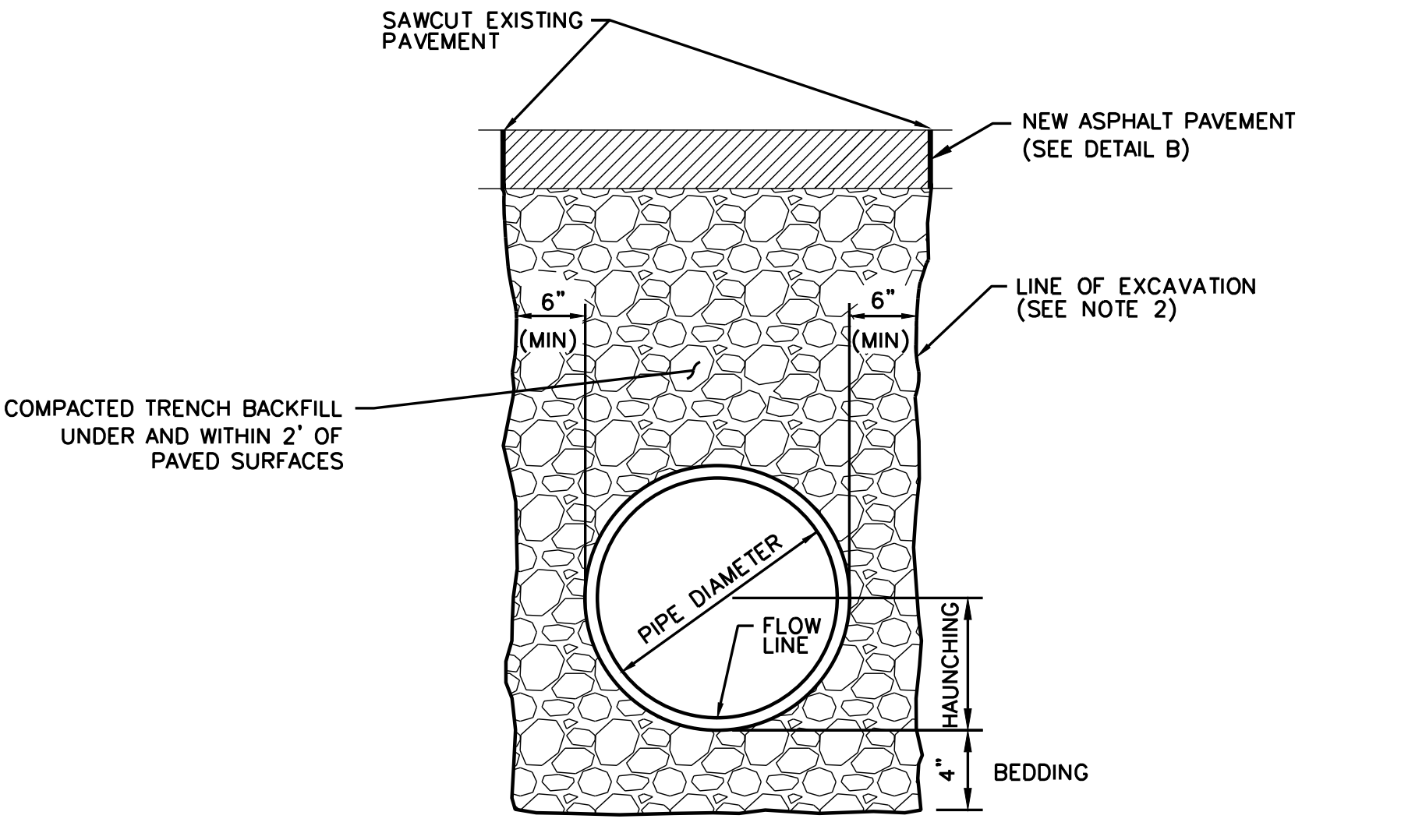
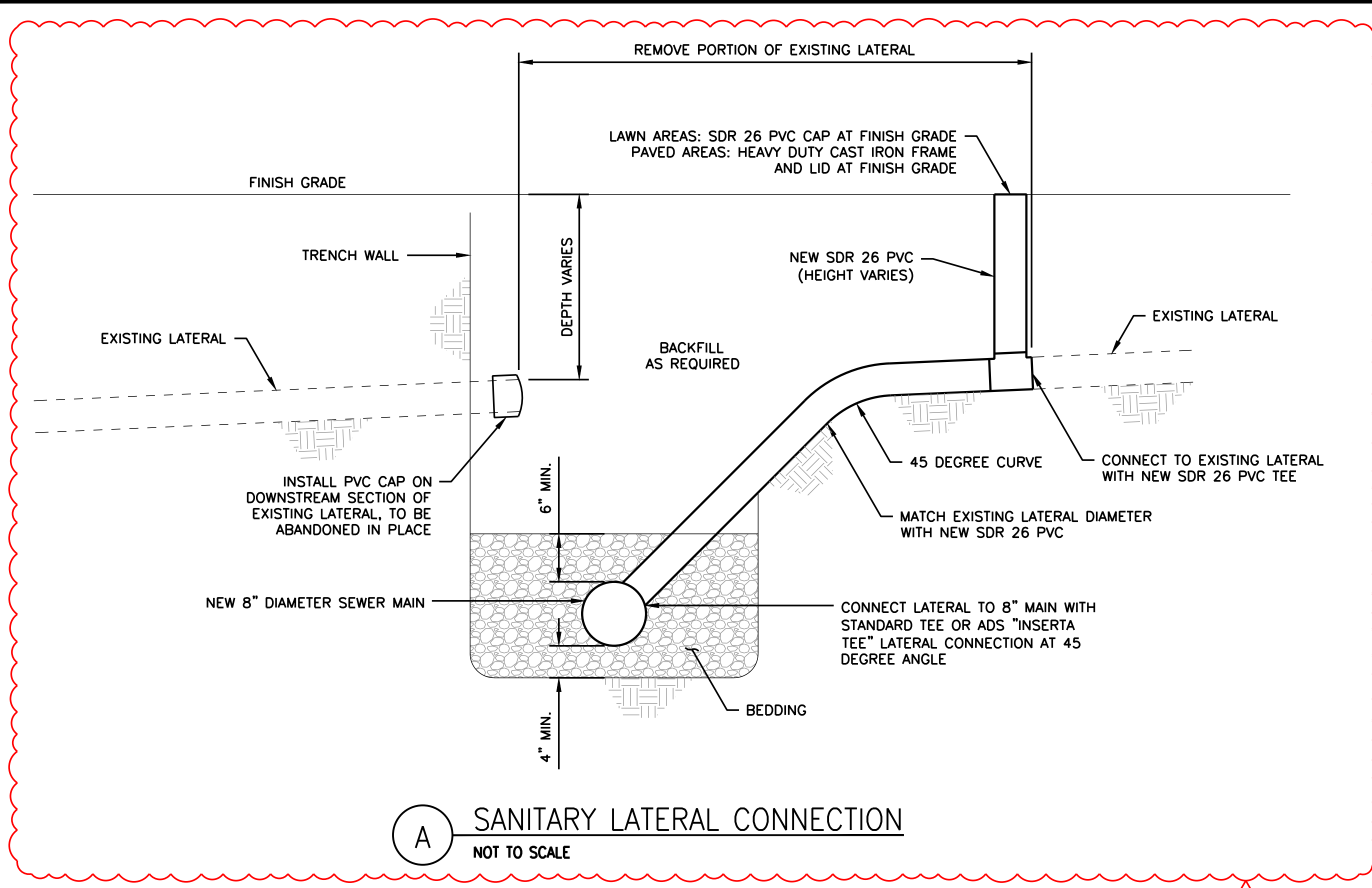

- NOTES:**
- BEDDING, HAUNCHING, INITIAL BACKFILL, AND TRENCH BACKFILL MATERIAL SHALL BE IDOT AGGREGATE GRADATION FA-1, FA-2, FA-6, FA-21, CA-6, CA-10, OR CA-18.
  - CONTRACTOR SHALL BE RESPONSIBLE FOR SHORING AND BENCHING TRENCH EXCAVATION IN ACCORDANCE WITH LOCAL, STATE, FEDERAL, AND OSHA REQUIREMENTS.
  - ALL COMPACTION SHALL BE TO 95% MAXIMUM DENSITY AS DETERMINED FROM STANDARD PROCTOR COMPACTION TEST.

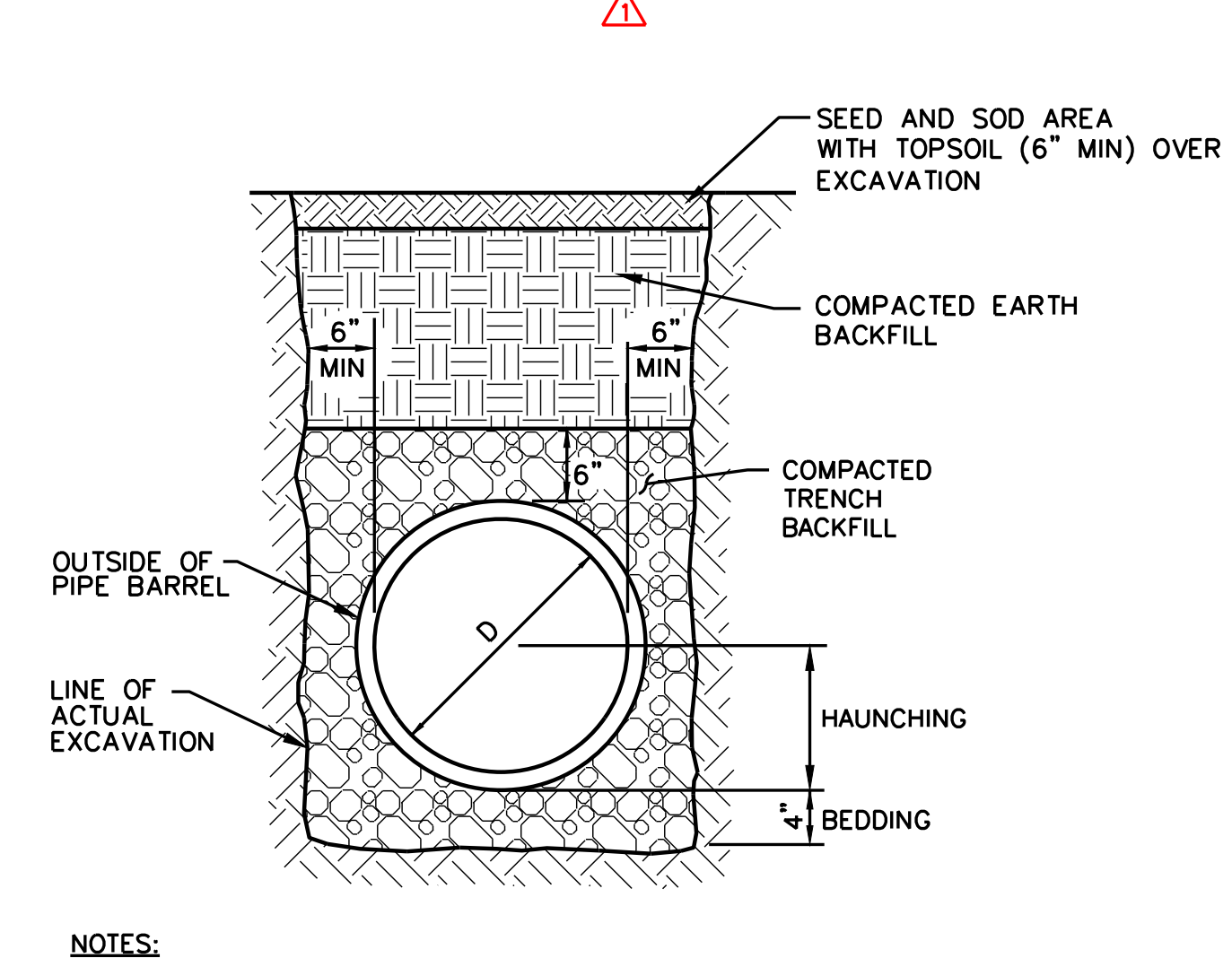

- NOTES:**
- DO NOT USE THIS DETAIL FOR EXCAVATIONS BELOW PAVEMENTS
  - BEDDING, HAUNCHING, INITIAL BACKFILL, AND TRENCH BACKFILL MATERIAL SHALL BE IDOT AGGREGATE GRADATION FA-1, FA-2, FA-6, FA-21, CA-6, CA-10, OR CA-18.
  - CONTRACTOR SHALL BE RESPONSIBLE FOR SHORING AND BENCHING TRENCH EXCAVATION IN ACCORDANCE WITH LOCAL, STATE, FEDERAL, AND OSHA REQUIREMENTS.
  - ALL COMPACTION SHALL BE TO 85% MAXIMUM DENSITY AS DETERMINED FROM STANDARD PROCTOR COMPACTION TEST.

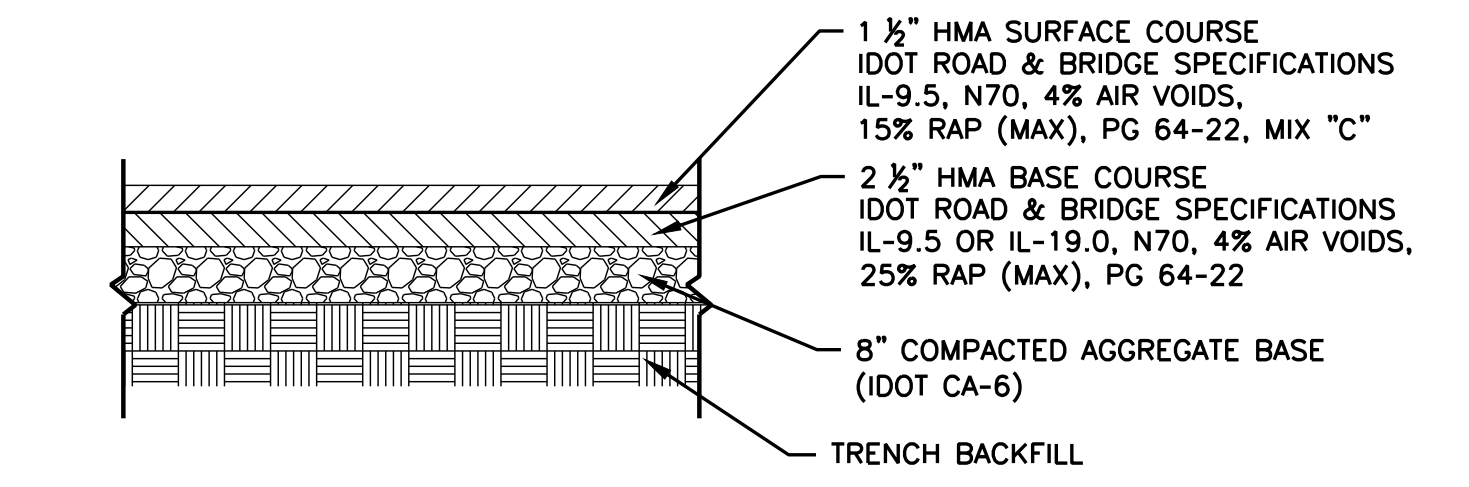

**B PAVEMENT REPLACEMENT, HOT-MIX ASPHALT**  
NOT TO SCALE

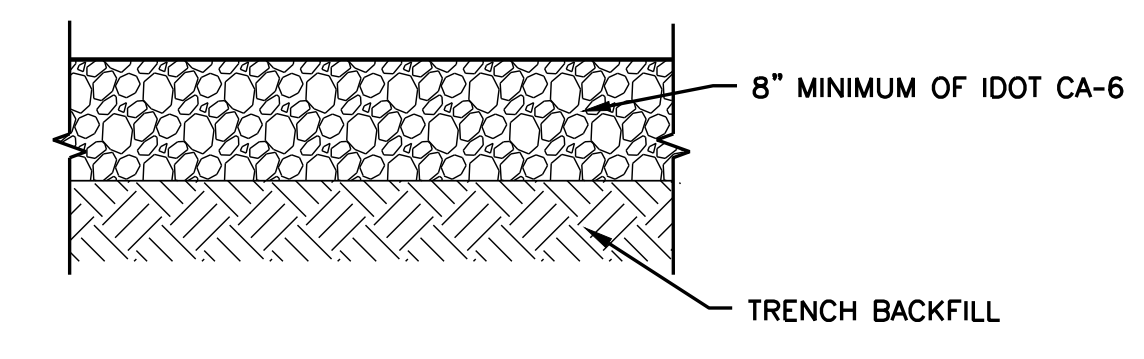

**C AGGREGATE SURFACE COURSE**  
NOT TO SCALE

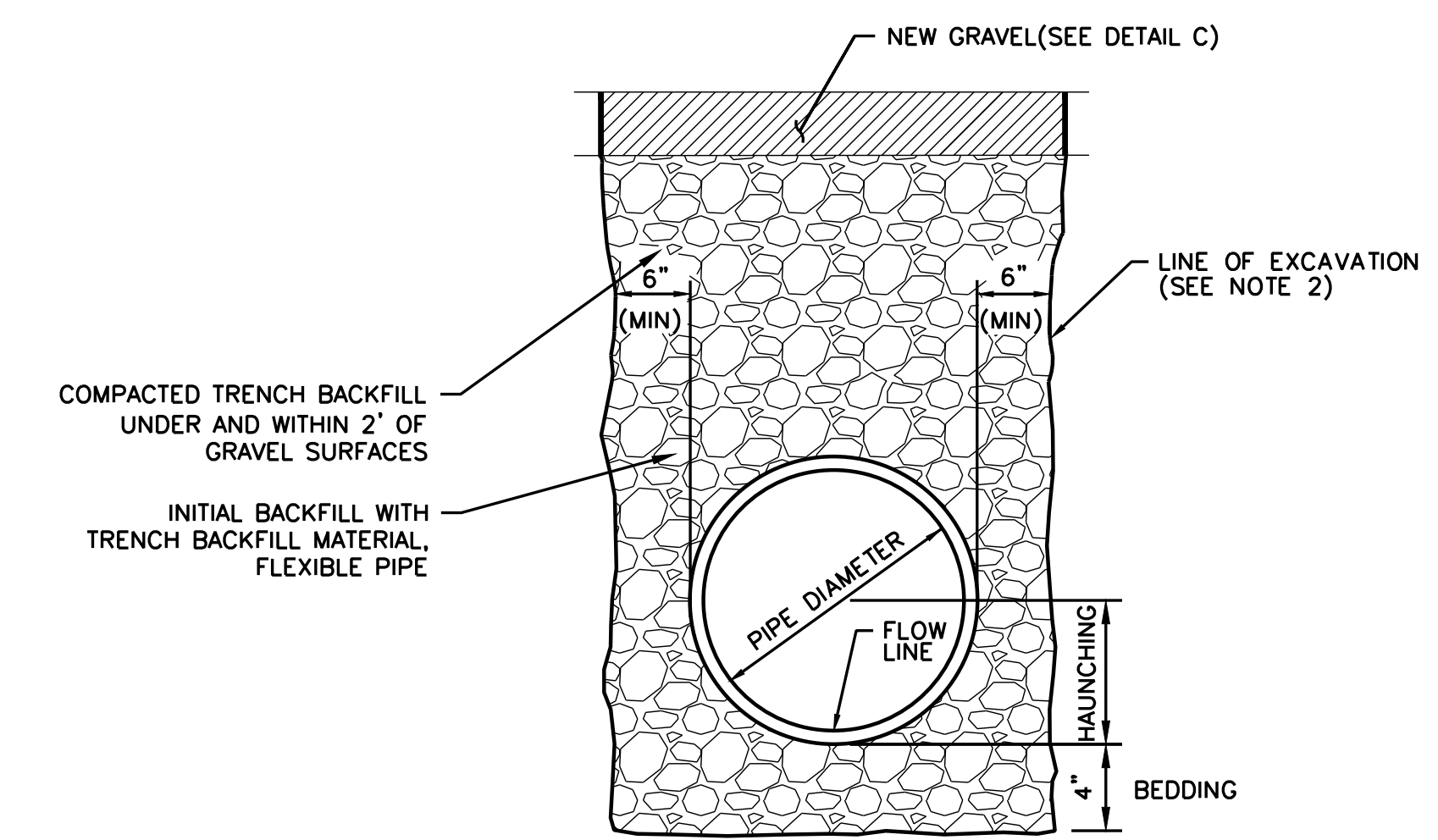

- NOTES:**
- BEDDING, HAUNCHING, INITIAL BACKFILL, AND TRENCH BACKFILL MATERIAL SHALL BE IDOT AGGREGATE GRADATION FA-1, FA-2, FA-6, FA-21, CA-6, CA-10, OR CA-18.
  - CONTRACTOR SHALL BE RESPONSIBLE FOR SHORING AND BENCHING TRENCH EXCAVATION IN ACCORDANCE WITH LOCAL, STATE, FEDERAL, AND OSHA REQUIREMENTS.

**F UTILITY TRENCH - UNDER GRAVEL**  
NOT TO SCALE

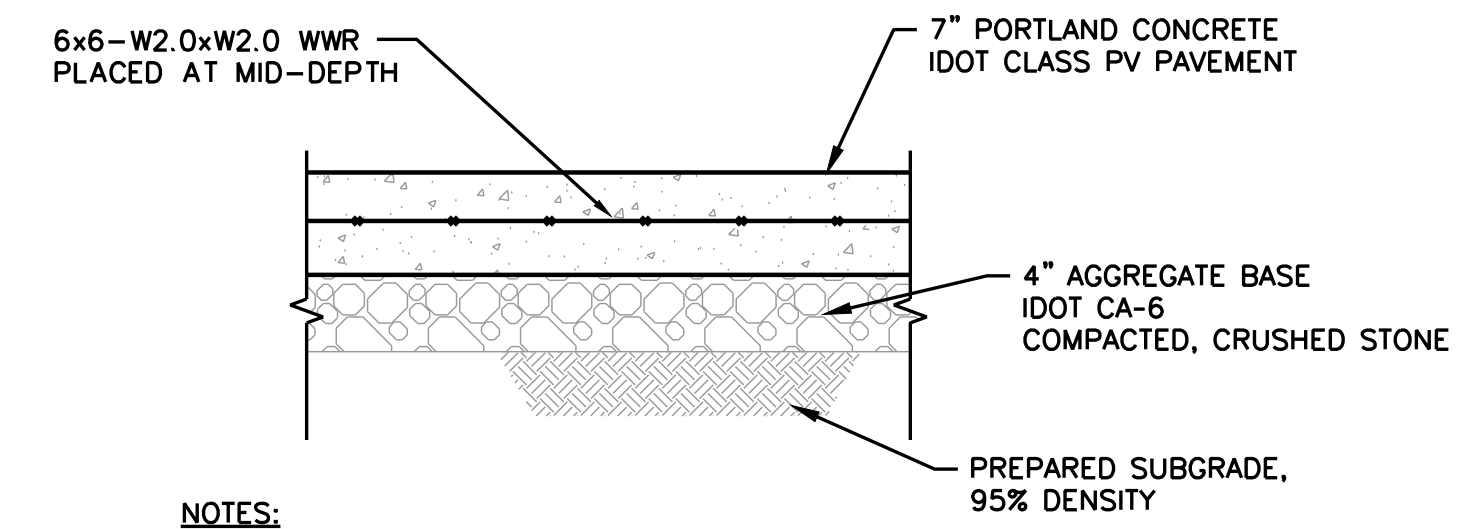

- NOTES:**
- CONTRACTOR TO USE TIED CONTRACTION JOINTS AND DOWELED EXPANSION JOINTS FOR THIS TYPE OF PAVEMENT.
  - NO. 6X24 TIE BARS AT 36" CENTERS SHALL BE USED BETWEEN NEW AND EXISTING CONCRETE PAVEMENTS.

**G PAVEMENT REPLACEMENT, CONCRETE**  
NOT TO SCALE



Wes M. Kistler  
CIVIL ENGINEER  
SIGNED: 02/05/2025  
EXPIRES: 11/30/2025

DATE: 02/05/2025  
CDI #: 5592  
DESIGNED BY: WMK  
DRAWN BY: LJB  
CHECKED BY: WMK

REV. NO.	DATE	REMARKS
1	02/17/24	ADDENDUM #1



**AUSTIN AVE. & PARK ST. STORM AND SANITARY SEWER IMPROVEMENTS**  
EFFINGHAM, ILLINOIS

**CIVIL DETAILS**

SHEET TITLE  
SHEET NO. **C500**