

MEMORANDUM

DATE: February 19, 2019

FILE: 4.1226.00

TO: John Moser, Maggiora Ghilotti Inc.
Cc: Garret Toy, Town of Fairfax (MGP)

FROM: Wayne Leach

RE: Fairfax Parkade, Fairfax – Field Change Directive (FCD 001)

Description:

As requested by Town of Fairfax we are providing FCD 001 that addresses the concern about the tree condition and proposed construction.

1. In addition to the 4 trees identified (#10, #22, #23, #27) in the bid documents to be removed the contractor shall include in the removal trees identified and tagged as #1, #16, #20, and #29.
2. In addition, the demolition and excavation area around trees #12, #14, and #17 shall be reduced in order to increase the chance of survival. The proposed curbed tree well is under consideration to be increased. Further direction with respect to any reconfigured tree well will follow.

Reason for Change:

Arborist review and assessment of current conditions of trees and impacts to construction including methods of construction.

Cost Impact: Contractor to provide cost impact to Town of Fairfax as appropriate.

Schedule Impact: Contractor to provide schedule impact to Town of Fairfax as appropriate.

Attachments/ Affects:

Exhibit Attached

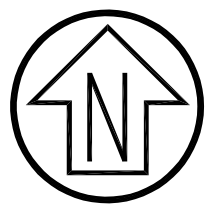

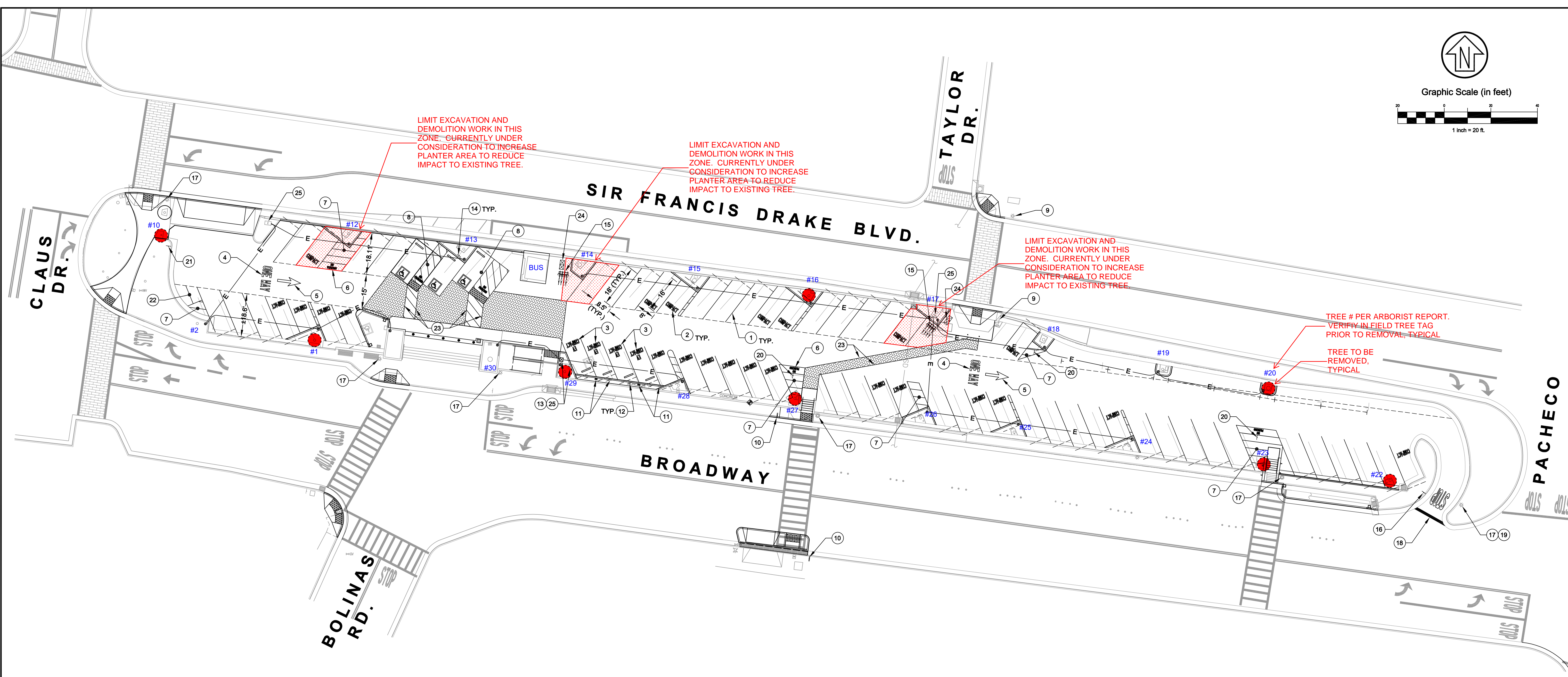
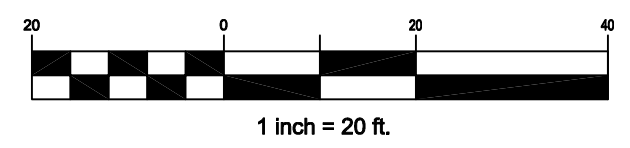

Graphic Scale (in feet)



STRIPING NOTES

- ALL PARKING LOT STRIPING SHALL BE WHITE LATEX PAINT (2 COATS), UNLESS NOTED OTHERWISE.
- ALL SIGNING AND STRIPING SHALL CONFORM TO CURRENT CALTRANS STANDARD SPECIFICATIONS.
- ALL SIGNS & PAVEMENT MARKINGS TO BE INSTALLED IN ACCORDANCE WITH CALTRANS SPECS.
- ADDITIONAL SIGNS SHALL BE POSTED IN A CONSPICUOUS PLACE AT EACH ENTRANCE TO OFF-STREET PARKING. THE SIGN SHALL NOT BE LESS THAN 17"x22" IN SIZE AND LETTERING NOT LESS THAN 1" HEIGHT WHICH STATES "UNAUTHORIZED VEHICLES PARKED IN DESIGNATED ACCESSIBLE SPACES NOT DISPLAYING DISTINGUISHING PLACARDS OR LICENSE PLATES ISSUED FOR PERSONS WITH DISABILITIES MAY BE TOWED AT OWNER'S EXPENSE. TOWED VEHICLES MAY BE RECLAIMED BY TELEPHONING THE TOWN OF FAIRFAX POLICE DEPARTMENT AT (415) 453-5330.
- HANDICAP STALLS SHALL BE PER TITLE 24 REQUIREMENTS AND LOCAL ORDINANCES.

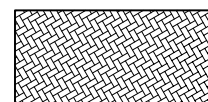
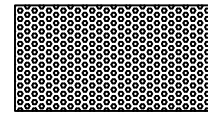
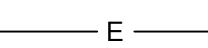
LEGEND

-  STAMPED ASPHALT, HERRINGBONE PATTERN PAINTED BRICK RED
-  DETECTABLE WARNING DOMES, SEE DETAIL 9 ON SHEET C6.0
-  UNDERGROUND ELECTRICAL
-  110 VOLT DUPLEX ELECTRICAL OUTLET WITHIN WEATHERPROOF IN GROUND BOX FOR TREE LIGHTS (18 EA.)

KEYNOTES

- 4" WHITE PAINTED PARKING STALL STRIPING
- "COMPACT" 12" HIGH LETTERING PAINTED WHITE PER CALTRANS STD. PLAN A24D LOCATED CENTERED AT REAR OF PARKING STALL
- "EV COMPACT" 12" HIGH LETTERING PAINTED WHITE PER CALTRANS STD. PLAN A24D LOCATED CENTERED AT REAR OF PARKING STALL
- "ONE WAY" LETTERING PER CALTRANS STD. PLANS
- TYPE I (10'-0") ARROW PAINTED WHITE PER CALTRANS STD. PLAN A24A
- "NO PARKING" 12" HIGH LETTERING PAINTED WHITE PER CALTRANS STD. PLAN A24E LOCATED CENTERED AT REAR OF NO PARKING AREA
- 4" WHITE STRIPING AT 36" O.C. 45° TO ONE WAY TRAVEL LANE
- ACCESSIBLE PARKING STALLS, SEE DETAIL 4 ON SHEET C6.0 FOR DIMENSIONS, SIGNING AND STRIPING
- PEDESTRIAN FLASHER. PROTECT IN PLACE.
- INSTALL SOLAR POWERED BACK TO BACK RAPID FLASH BEACON AND WII-2 SIGN AT CROSSING. PROVIDE LED/AUDIBLE PUSH BUTTON.
- RELOCATE (2) EV CHARGING STATIONS. ELECTRICAL CONDUIT TO BE UNDERGROUNDED
- "EV PARKING ONLY WHILE CHARGING" AND "FOUR HOUR PARKING" SIGNS & POST (4 TOTAL)
- ELECTRICAL CABINET TO BE RELOCATED, SEE PLAN FOR NEW LOCATION
- ACCESSIBLE SIGN, SEE DETAIL 7 ON SHEET C6.0
- 5 LOOP WAVE BIKE RACK
- REMOVE EXISTING SIGN AND INSTALL STOP SIGN (R1-1) & DO NOT ENTER SIGN (R5-1) ON BACK
- PROTECT IN PLACE STREET LIGHT
- STOP BAR LIMIT LINE AND PAINTED "STOP" WORD PER CALTRANS STD. PLAN A24D AND A24G
- REMOVE EXISTING SIGN & INSTALL R3-2 NO LEFT TURN SIGN
- INSTALL 4 HOUR PARKING 9 A.M. TO 6 P.M. EXCEPT SUNDAY SIGN R32(CA)
- NEW ACCESSIBLE PARKING SIGN, SEE STRIPING NOTE 4 THIS SHEET
- TWO MOTORCYCLE PARKING STALLS
- 4" WHITE PAINTED WALKWAY STRIPING
- RELOCATED TRASH CANS (2 EA.)
- CONNECT UNDERGROUND ELECTRICAL TO EXISTING JUNCTION BOX/CABINET

PARKING COUNT

TYPE	SIZE	COUNT
STANDARD	8.5' x 18'	35
PARALLEL	8' x 20'	6
ELECTRIC VEHICLE	8.5' x 16'(MIN.)	4
COMPACT	8.5' x 16'(MIN.)	23
ADA	9' x 18'	3
MOTORCYCLE	3'(MIN.) x 6'(MIN.)	2
TOTAL		73

**TREE REMOVAL EXHIBIT
PER TOWN OF FAIRFAX AND URBAN
FORESTRY ASSOCIATES, INC
UPDATE OF 2013 TREE
INSPECTION.**

Rev	Date	Description	Designed	Drawn	Checked
12/17/18	ISSUED FOR BID				
12/04/18	ISSUED FOR TOWN OF FAIRFAX REVIEW				

CSW ST2
CSW/Stuber-Stroeh Engineering Group, Inc.
 Civil & Structural Engineers | Surveying & Mapping | Environmental Planning
 Land Planning | Construction Management
 45 Leveroni Court Novato, CA 94949
 tel: 415.883.9850 fax: 415.883.9835
<http://www.cswst2.com> © 2018

Town	Fairfax
County	Marin
State	California

**FAIRFAX PARKADE IMPROVEMENT PROJECT
SIGNING, STRIPING, AND ELECTRICAL PLAN**

TOWN OF FAIRFAX

Prepared Under the Direction of:

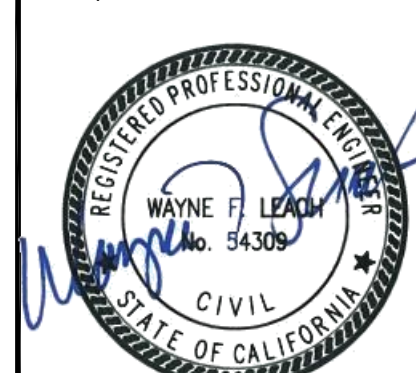

Sheet	C5.0
Scale:	1" = 20'
Date:	12/17/2018
Project Number:	4.1226.00
Plan File:	D-5522-07

P:\044122600\Drawings\C5.0 - SIGNING AND STRIPING PLAN.dwg 12/17/2018 - 10:08 AM jbar 13.5492