



Staff Report

September 10, 2019

TO: Honorable Mayor and Members of the Town Council
FROM: Brit Snipes, Town Engineer
DATE: September 10, 2019
RE: Sierra de Montserrat

Recommendation

Accept presentation and provide direction for future steps

Issue Statement and Discussion

Rutherford Canyon is a public road that runs through the middle of Sierra de Montserrat connecting Laird Road to Barton Road. It was built to access the properties within the Sierra de Montserrat subdivision. Because it is parallel to Well Ave, it is heavily used by drivers trying to go between Laird and Barton. A maintenance district funded by the property owners within Sierra de Montserrat for the maintenance of the paving, drainage and trail.

The Home Owners Association would like the Town to consider participating in a traffic calming project. Half of the traffic on Rutherford Canyon is pass through traffic. Many of these pass-through drivers speed through the neighborhood.

The plan is to restripe the road with thermoplastic striping and dots with 10 foot wide lanes. These narrower lanes will provide a wider shoulder for bikes and a calming effect on drivers.

CEQA Requirements

None at this time.

Financial and/or Policy Implications

A combination of funds from the Sierra de Montserrat maintenance district and Transportation Reserves.

Attachments

- A. Exhibit of Sierra de Montserrat.

MONTSERAT

LAND USE DIAGRAM

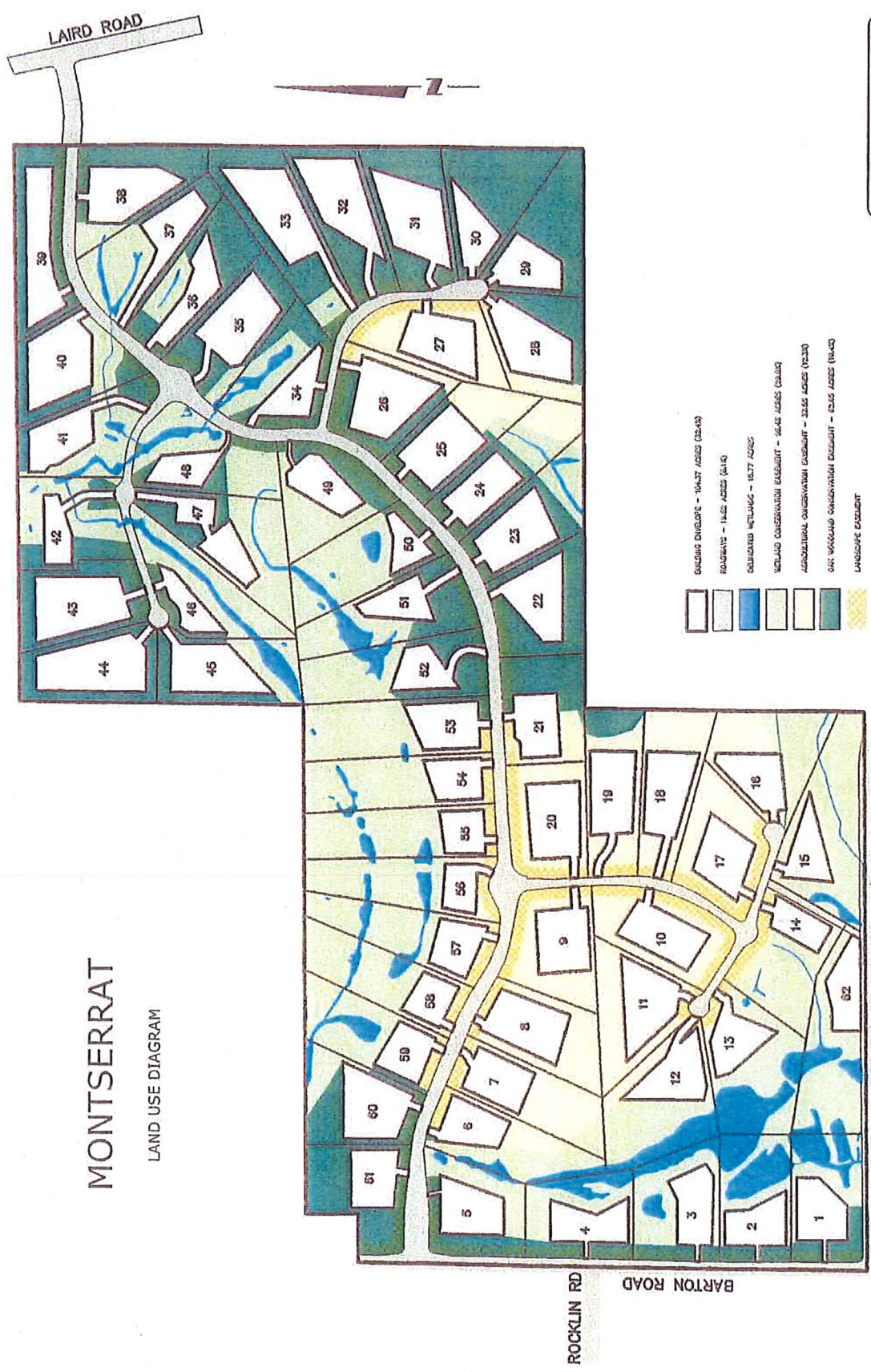

- GOLFING COURSE - 16437 ACRES (25.14)
- ROADS - 1942 ACRES (3.11)
- DEDICATED WELLS - 1877 ACRES
- WELLS CONSERVATION EASEMENT - 1643 ACRES (2.64)
- AGRICULTURAL CONSERVATION EASEMENT - 3325 ACRES (5.30)
- GOLF WILDLAND CONSERVATION EASEMENT - 8215 ACRES (13.40)
- LANDSCAPE EASEMENT

MSA
 ENGINEERING
12/28/04
1000 W. 10th Street, Suite 100, Fort Collins, CO 80526
970.226.1111