

## STAFF REPORT

TOWN COUNCIL MEETING OF MAY 11, 2010

## CONSENT AGENDA

TO: HONORABLE MAYOR AND MEMBERS OF THE TOWN COUNCIL

FROM: BRIAN FRAGIAO, DIRECTOR OF PUBLIC WORKS 

DATE: APRIL 30, 2010

SUBJECT: MAGNOLIA STREET DRAINAGE PROJECT – ADVERTISE FOR BIDS **RECOMMENDATION:**

Approve the Plans and Specifications for the project with the findings that the project is exempt under CEQA categories 15301 & 15303 and authorize staff to advertise for bids.

**ISSUE STATEMENT AND DISCUSSION:**

At the December 8, 2009 Town Council meeting, Council awarded the engineer services to RSC Engineering to design a drainage facilities in the area of Magnolia Street and Oak Street. The improvements will alleviate street flooding in the area and re-direct drainage flows away from existing homes. The existing pipe system that runs between two houses has lost its original carrying capacity due to pipe collapse, debris and root damage. The flooding at the Oak Street and Magnolia Street intersection has increased through the years and Public Works attempts to clear the pipe has become a never ending battle. The new improvements would consist of plugging the existing pipe entrance on Magnolia Street, installing a new drainage pipe that follows the existing street alignments, install drop inlets, manholes and a detention system that will replenish the groundwater table. The cost is estimated at \$250,000.

The following schedule will be followed:

Advertise for bids - May 14<sup>th</sup> – June 4<sup>th</sup>

Award Contract – June 8<sup>th</sup>

Process Agreements – June 9<sup>th</sup> – June 25<sup>th</sup>

Pre-Construction Meeting - June 28<sup>th</sup>

Start Construction – July 12<sup>th</sup>

Complete Project – Early September

**CEQA REQUIREMENTS:**

This project is exempt under the California Environmental Quality Act (CEQA) Section 15301(a, b, c & d)(Class 1), "Existing Facilities" and Section 15303(d) (Class 3), "New Construction" of the guidelines.

**FINANCIAL AND/OR POLICY IMPLICATIONS:**

Construction cost is estimated at \$250,000. Funding will be provided by the Town's Drainage Development Impact Fees (\$135,000) and general fund reserve.

# IMPROVEMENT PLANS FOR MAGNOLIA STORM DRAIN PLANS

## MAGNOLIA STREET, OAK STREET AND SOUTH HOLLY STREET LOOMIS, CA 95650

TOWN OF LOOMIS

PROJECT NO. 077-051  
DRAWN BY: K. SHAFFER  
CHECKED BY: J. HANCOCK  
REVIEWED BY: J. HANCOCK

RSC ENGINEERING  
2500 Central Express Blvd. #100  
Folsom, CA 95630  
TEL: 916.763.2252 FAX: 916.763.4528

MAGNOLIA STORM DRAIN PLANS  
SOUTH HOLLY STREET AND  
LOOMIS, CA 95650

SHEET TITLE  
**COVER SHEET**  
SHEET NO. \_\_\_\_\_  
DATE: APRIL 29, 2016

REVISED	DATE	TOWN APPROVAL	AGENCY APPROVALS

<b>SHEET INDEX</b>	<b>AGENCY APPROVALS</b>
CIVIL IMPROVEMENT PLANS C1.0 COVER SHEET C1.1 NOTES SHEET C2.0 EXISTING CONDITIONS C3.0 MAGNOLIA STREET PLAN AND PROFILE C4.0 OAK STREET PLAN AND PROFILE C5.0 S. HOLLY STREET PLAN AND PROFILE C6.0 GUTFALL PLAN AND PROFILE C7.0 DETAIL SHEET C7.1 SLURRY & STRIPING PLAN C8.0	          

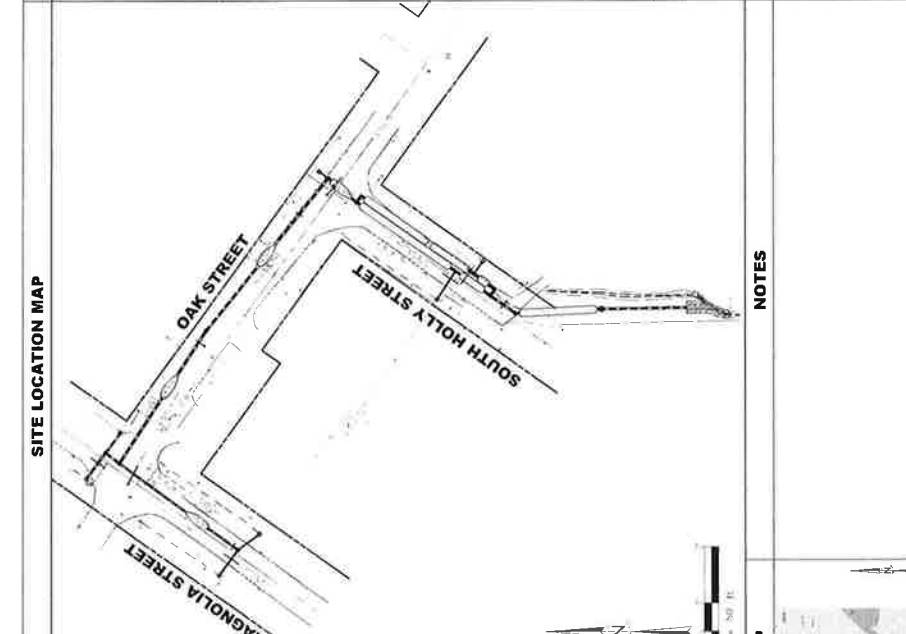

#### SYMBOL LEGEND

○	PROPOSED SANITARY MANHOLE
○	EXISTING SANITARY MANHOLE
○	PROPOSED STORM DRAIN
○	EXISTING STORM DRAIN
○	PROPOSED INTERSECTION
○	EXISTING INTERSECTION
○	PROPOSED DRIVE
○	EXISTING DRIVE
○	PROPOSED SIDEWALK
○	EXISTING SIDEWALK

#### ABBREVIATIONS

A= AERIAL PHOTOGRAPHY  
 B= BENCH MARK  
 C= CENTERLINE  
 D= DRAINAGE  
 E= ELEVATION  
 F= FUTURE  
 G= GUTTER  
 H= HYDROLOGIC  
 I= IMPROVEMENT  
 J= JUNCTION  
 K= KURVE  
 L= LINE  
 M= MARK  
 N= NORTH  
 O= OPEN  
 P= POINT  
 Q= QUANTIFICATION  
 R= ROAD  
 S= SURFACE  
 T= TYPICAL  
 U= UTILITY  
 V= VERIFICATION  
 W= WALL  
 X= EXISTING  
 Y= YIELD  
 Z= ZONE

#### VICINITY MAP

**SITE**

UTILITY REPRESENTATIVES		BENCH MARK	
USA	500-277-7610	BM SPT 8941	ELEV. 374.67
GAS	PACIFIC GAS & ELECTRIC	BM SPT 8942	ELEV. 374.67
ELECTRICITY	PAGE	INTERSECTION BETWEEN OAK STREET & CALLOUN STREET	
TELEPHONE	AT&T		
WATER	PCWA		
SEWER	SUNBELT		
DRAINAGE	TOWN OF LOOMIS		
FIRE	LOOMIS FIRE DEPARTMENT		
CABLE TV	WAVE BROADBAND		

**C1.0**  
OF 10

DATE: APRIL 29, 2016

**TOWN OF LOOMIS**

**DEPARTMENT OF PUBLIC WORKS APPROVAL**

PLANS ARE ACCEPTED FOR USE AS WORKING DOCUMENTS. UNDISCOVERED ERRORS ARE THE RESPONSIBILITY OF THE DESIGNER. THIS APPROVAL EXPIRES ONE (1) YEAR FROM THE APPROVAL DATE. UNLESS AN EXTENSION IS APPROVED IN WRITING BY THE DEPARTMENT OF PUBLIC WORKS OR CONSTRUCTION HAS BEEN INITIATED. EXPIRATION WILL RESULT IN A RE-APPROVAL FEE. THESE PLANS SHALL BE SUBMITTED FOR REVIEW AND APPROVAL.

TOWN ENGINEER \_\_\_\_\_ DATE \_\_\_\_\_



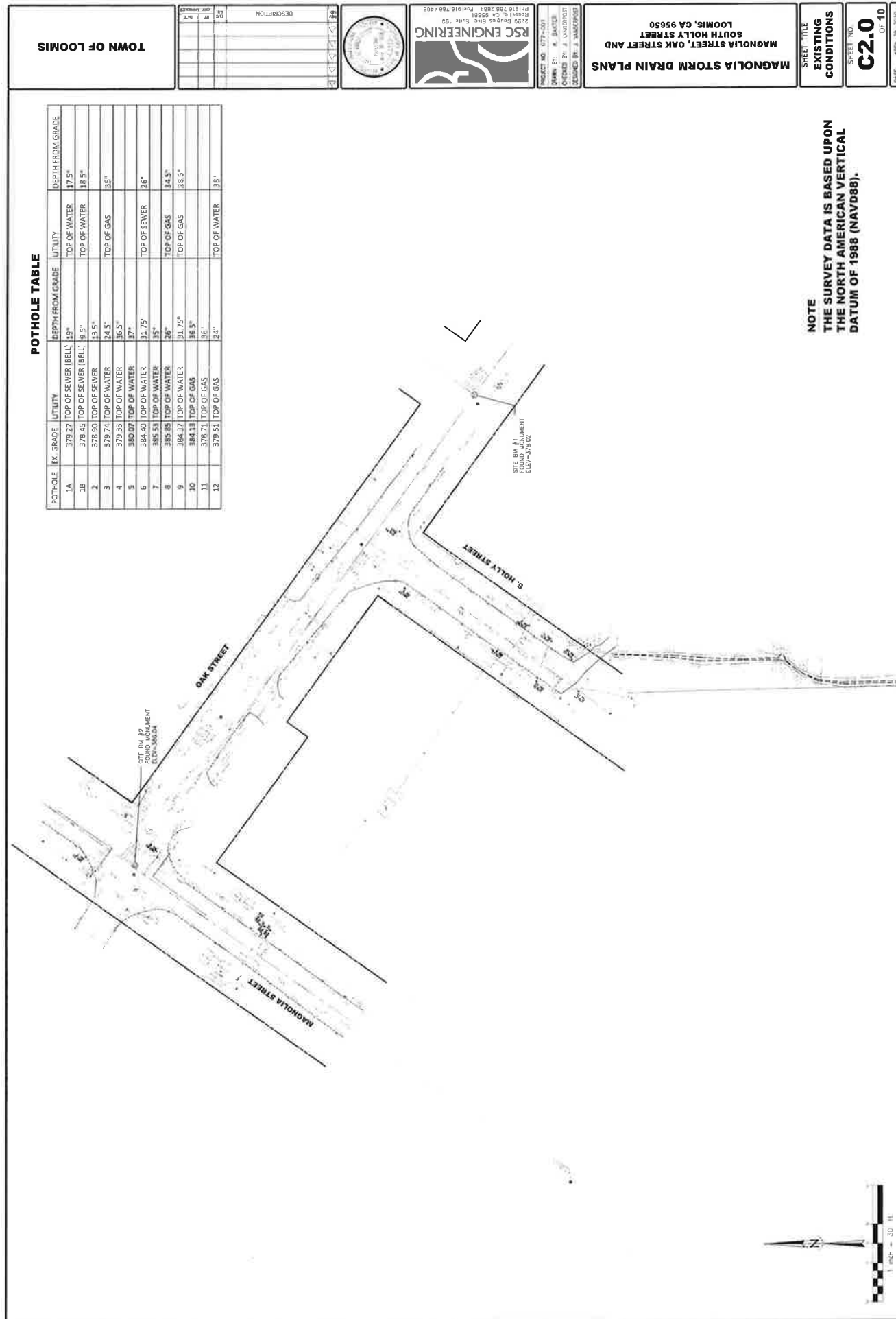

**POTHOLE TABLE**

POT HOLE	EX. GRADE	UTILITY	DEPTH FROM GRADE	UTILITY	DEPTH FROM GRADE
1A	379.27	TOP OF SEWER (BELL)	19"	TOP OF WATER	17.5"
1B	378.45	TOP OF SEWER (BELL)	19.5"	TOP OF WATER	18.5"
2	378.90	TOP OF SEWER	13.5"	TOP OF GAS	35"
3	379.74	TOP OF WATER	14.5"	TOP OF GAS	35"
4	379.33	TOP OF WATER	16.5"	TOP OF SEWER	26"
5	380.07	TOP OF WATER	17"	TOP OF GAS	34.5"
6	384.40	TOP OF WATER	31.75"	TOP OF GAS	38.5"
7	382.51	TOP OF WATER	35"	TOP OF GAS	38.5"
8	386.88	TOP OF WATER	26"	TOP OF GAS	28.5"
9	384.37	TOP OF WATER	31.75"	TOP OF GAS	38.5"
10	384.13	TOP OF GAS	36.5"	TOP OF WATER	38"
11	378.71	TOP OF GAS	36"	TOP OF WATER	38"
12	379.51	TOP OF GAS	24"	TOP OF WATER	38"

TOWN OF LOOMIS





**RSC ENGINEERING**

2202 De Soto Ave. Suite 100  
Loomis, CA 95661  
Phone: 916.786.4408 Fax: 916.786.4408

PROJECT NO. 077-001  
DRAWN BY: K. BARTER  
CHECKED BY: J. VANDERST  
DESIGNED BY: J. VANDERST

**MAGNOLIA STREET, OAK STREET AND SOUTH HOLLY STREET, LOOMIS, CA 95650**

SHEET TITLE  
**EXISTING CONDITIONS**

SHEET NO.  
**C2.0**  
OF 10

**NOTE**  
THE SURVEY DATA IS BASED UPON  
EXISTING CONDITIONS  
THE NORTH AMERICAN VERTICAL  
DATUM OF 1988 (NAVD88).



SYMBOL AND NAME	DESCRIPTION



PROJECT NO. 1877-0031  
 DRAWN BY: K. BAKER  
 CHECKED BY: J. WAGNER  
 DESIGNED BY: J. WAGNER

MAGNOLIA STORM DRAIN PLANS  
 MAGNOLIA SOUTH HOLLY STREET AND LOOMIS, CA 95650

SHEET TITLE  
**MAGNOLIA STREET PLAN AND PROFILE**

SHEET NO.  
**C3.0**  
 OF 10

DATE: APRIL 28, 2010

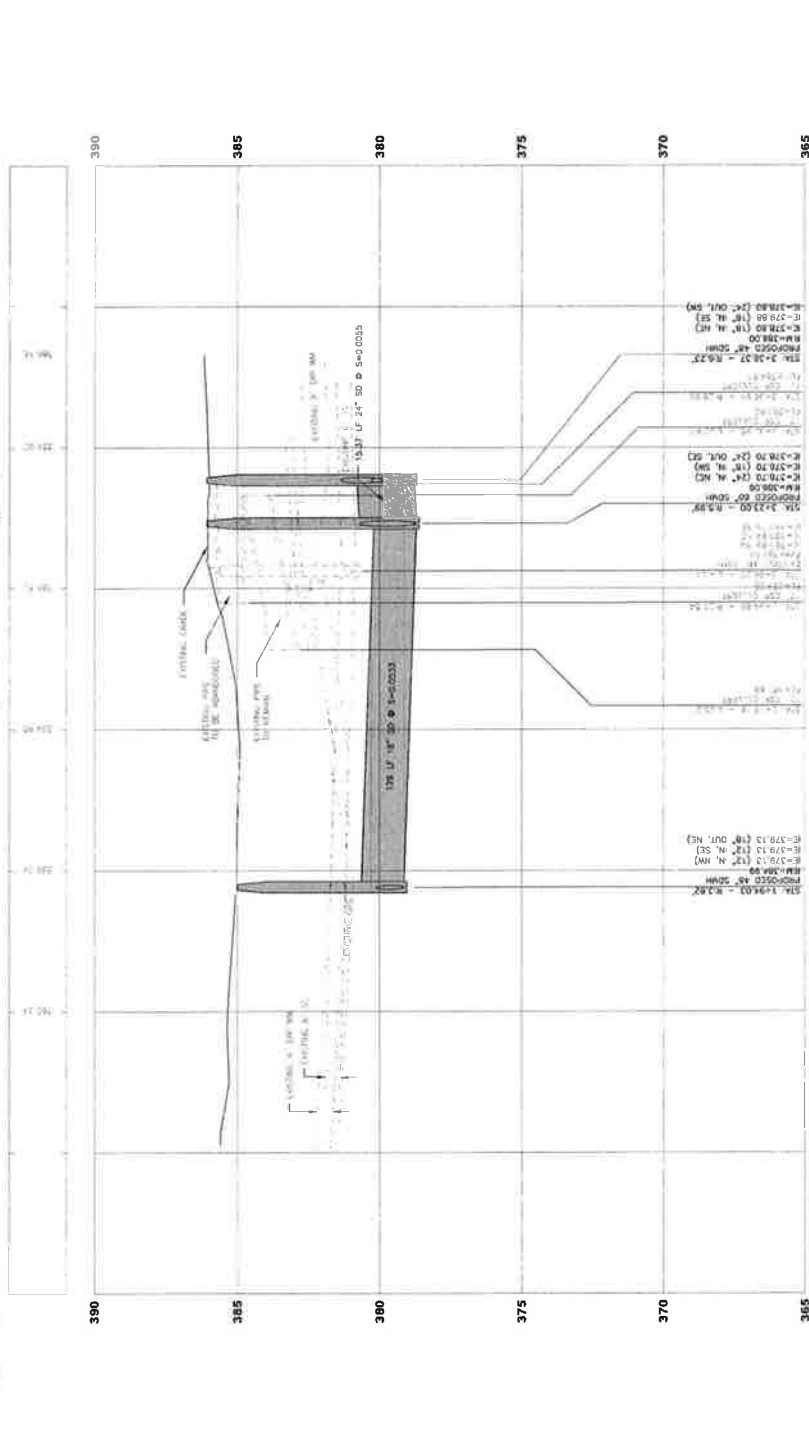
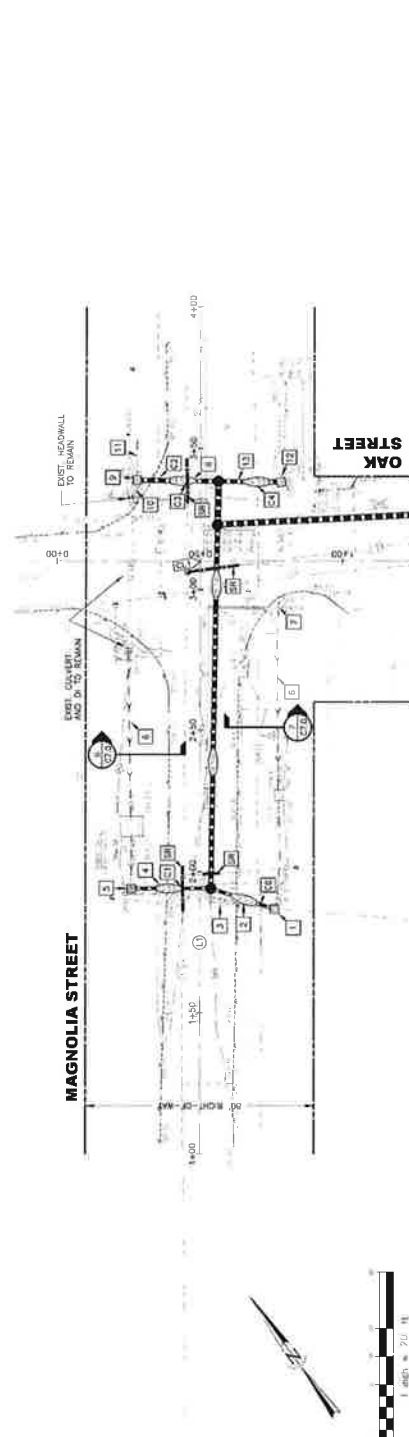

**GENERAL NOTES**

1. ALL PROPOSED INLETS SHALL BE DROP INLET TYPE. PROPOSED DRAIN INLET SHALL BE 18" DIA. AND 18" HIGH. ALL EXISTING AND PROPOSED DRAINAGE SHALL BE IN ACCORDANCE WITH THE LATEST EDITION OF THE STANDARD SPECIFICATIONS FOR HIGHWAY CONSTRUCTION, 2009 EDITION, SECTION 707.01, UNLESS NOTED OTHERWISE.
2. ALL MANHOLES SHALL BE 48" DIAMETER PRECAST MANHOLES PER TOWN OF LOOMIS STANDARD DRAWING H-42. MANHOLES SHALL BE 5'-0" HIGH AND 5'-0" DIA. UNLESS NOTED OTHERWISE.
3. ALL PROPOSED AND EXISTING UTILITY LINES SHALL BE IN ACCORDANCE WITH TOWN OF LOOMIS STANDARD DRAWING H-42. MODIFIED, SEE SHEET C7.0.
4. CONTRACTOR SHALL REPAIR AND REPLACE ANY CURBS AND SIDEWALKS DAMAGED BY CONSTRUCTION. NEW CURB INLET CURB AND GUTTER SHALL BE TYPE 2 PER TOWN OF LOOMIS STANDARD DRAWING H-2.
5. CONTRACTOR SHALL MAKE AREA ADJACENT TO DRAIN INLET TO CRACK/MANHOLE POSITIVE DRAINAGE.

**CENTERLINE KEY NOTES**

MAGNOLIA STREET EXTENSION 3+0 TO 3+00  
 OAK STREET STATION 0+00 TO 0+50  
 CENTERLINE SEGMENT - NORTH 354.114.8" EAST

**KEY NOTES**

1. STA. 1+88.71 - 1+26.26 PROPOSED DRAIN INLET PER STD DWG SD-3 SIDE OPENING FL=382.20 E=279.20 (17" OUT. NW)
2. 23.6 L' 12" SD @ 5-0.0030
3. BRANCKE EXISTING 12" CSP DRAINAGE
4. 27.3 L' 12" SD @ 5-0.0035
5. STA. 1+84.03 - 1+84.07 PROPOSED DRAIN INLET AND REPLACE WITH 18" DIA. PRECAST MANHOLE WITH GRATE TYPE COVER PER STD DWG SD-3 SIDE OPENING FL=384.57 TOP CORNER=385.27 SIDE OPENING FL=384.57 E=350.12 (17" OUT. SE)
6. REPAIR EXISTING SINGLE TO CRACK/MANHOLE LINE WITH 18" DIA. COBBLE FLAGGED ON GEOTEXTILE FABRIC. SEE CROSS SECTION SHEET C7.0
7. PLACE & COMPACT CURB 2' AB TO PROVIDE A 2" DRAINAGE SLOPE TO DRAINAGE INLET WITH 1-3" COBBLE (MIN. 3" WOOD)
8. 28.4 L' 12" SD @ 5-0.005
9. STA. 3+38.00 - 3+51.15 PROPOSED DRAIN INLET WITH GRATE TYPE COVER PER STD DWG SD-3 SIDE OPENING FL=384.70 E=278.84 (18" OUT. SE)
10. CONTRACTOR SHALL EXISTING SINGLE BETWEEN EXISTING DRAINAGE INLET WITH 1-3" COBBLE (MIN. 3" WOOD)
11. SEE NOTE #5. CONTRACTOR SHALL EXISTING SINGLE WITH 1-3" COBBLE ON GEOTEXTILE FABRIC TO E5' NORTHWEST OF PROPOSED INLET (MIN. 3" WOOD)
12. BRANCKE EXISTING DRAIN INLET AND REPLACE WITH PROPOSED TYPE B DRAIN INLET PER STD DWG SD-4 QUANT.=385.59 E=380.10 (18" OUT. NW)
13. 22 L' 18" SD @ 5-0.01
14. UTILITY CROSSING GAS E=332.40 SLOPE E=330.21 CLEAR= 40.6'
15. UTILITY CROSSING WATER E=338.98 SLOPE E=336.20 CLEAR= 24.18'
16. UTILITY CROSSING WATER E=338.98 SLOPE E=336.20 CLEAR= 40.9'
17. UTILITY CROSSING WATER E=338.98 SLOPE E=336.20 CLEAR= 40.9'
18. UTILITY CROSSING WATER E=338.98 SLOPE E=336.20 CLEAR= 40.9'
19. UTILITY CROSSING WATER E=338.98 SLOPE E=336.20 CLEAR= 40.9'
20. UTILITY CROSSING WATER E=338.98 SLOPE E=336.20 CLEAR= 40.9'
21. UTILITY CROSSING WATER E=338.98 SLOPE E=336.20 CLEAR= 40.9'
22. UTILITY CROSSING WATER E=338.98 SLOPE E=336.20 CLEAR= 40.9'
23. UTILITY CROSSING WATER E=338.98 SLOPE E=336.20 CLEAR= 40.9'
24. UTILITY CROSSING WATER E=338.98 SLOPE E=336.20 CLEAR= 40.9'
25. UTILITY CROSSING WATER E=338.98 SLOPE E=336.20 CLEAR= 40.9'
26. UTILITY CROSSING WATER E=338.98 SLOPE E=336.20 CLEAR= 40.9'
27. UTILITY CROSSING WATER E=338.98 SLOPE E=336.20 CLEAR= 40.9'
28. UTILITY CROSSING WATER E=338.98 SLOPE E=336.20 CLEAR= 40.9'
29. UTILITY CROSSING WATER E=338.98 SLOPE E=336.20 CLEAR= 40.9'
30. UTILITY CROSSING WATER E=338.98 SLOPE E=336.20 CLEAR= 40.9'
31. UTILITY CROSSING WATER E=338.98 SLOPE E=336.20 CLEAR= 40.9'
32. UTILITY CROSSING WATER E=338.98 SLOPE E=336.20 CLEAR= 40.9'
33. UTILITY CROSSING WATER E=338.98 SLOPE E=336.20 CLEAR= 40.9'
34. UTILITY CROSSING WATER E=338.98 SLOPE E=336.20 CLEAR= 40.9'
35. UTILITY CROSSING WATER E=338.98 SLOPE E=336.20 CLEAR= 40.9'
36. UTILITY CROSSING WATER E=338.98 SLOPE E=336.20 CLEAR= 40.9'
37. UTILITY CROSSING WATER E=338.98 SLOPE E=336.20 CLEAR= 40.9'
38. UTILITY CROSSING WATER E=338.98 SLOPE E=336.20 CLEAR= 40.9'
39. UTILITY CROSSING WATER E=338.98 SLOPE E=336.20 CLEAR= 40.9'
40. UTILITY CROSSING WATER E=338.98 SLOPE E=336.20 CLEAR= 40.9'
41. UTILITY CROSSING WATER E=338.98 SLOPE E=336.20 CLEAR= 40.9'
42. UTILITY CROSSING WATER E=338.98 SLOPE E=336.20 CLEAR= 40.9'
43. UTILITY CROSSING WATER E=338.98 SLOPE E=336.20 CLEAR= 40.9'
44. UTILITY CROSSING WATER E=338.98 SLOPE E=336.20 CLEAR= 40.9'
45. UTILITY CROSSING WATER E=338.98 SLOPE E=336.20 CLEAR= 40.9'
46. UTILITY CROSSING WATER E=338.98 SLOPE E=336.20 CLEAR= 40.9'
47. UTILITY CROSSING WATER E=338.98 SLOPE E=336.20 CLEAR= 40.9'
48. UTILITY CROSSING WATER E=338.98 SLOPE E=336.20 CLEAR= 40.9'
49. UTILITY CROSSING WATER E=338.98 SLOPE E=336.20 CLEAR= 40.9'
50. UTILITY CROSSING WATER E=338.98 SLOPE E=336.20 CLEAR= 40.9'
51. UTILITY CROSSING WATER E=338.98 SLOPE E=336.20 CLEAR= 40.9'
52. UTILITY CROSSING WATER E=338.98 SLOPE E=336.20 CLEAR= 40.9'
53. UTILITY CROSSING WATER E=338.98 SLOPE E=336.20 CLEAR= 40.9'
54. UTILITY CROSSING WATER E=338.98 SLOPE E=336.20 CLEAR= 40.9'
55. UTILITY CROSSING WATER E=338.98 SLOPE E=336.20 CLEAR= 40.9'
56. UTILITY CROSSING WATER E=338.98 SLOPE E=336.20 CLEAR= 40.9'
57. UTILITY CROSSING WATER E=338.98 SLOPE E=336.20 CLEAR= 40.9'
58. UTILITY CROSSING WATER E=338.98 SLOPE E=336.20 CLEAR= 40.9'
59. UTILITY CROSSING WATER E=338.98 SLOPE E=336.20 CLEAR= 40.9'
60. UTILITY CROSSING WATER E=338.98 SLOPE E=336.20 CLEAR= 40.9'
61. UTILITY CROSSING WATER E=338.98 SLOPE E=336.20 CLEAR= 40.9'
62. UTILITY CROSSING WATER E=338.98 SLOPE E=336.20 CLEAR= 40.9'
63. UTILITY CROSSING WATER E=338.98 SLOPE E=336.20 CLEAR= 40.9'
64. UTILITY CROSSING WATER E=338.98 SLOPE E=336.20 CLEAR= 40.9'
65. UTILITY CROSSING WATER E=338.98 SLOPE E=336.20 CLEAR= 40.9'
66. UTILITY CROSSING WATER E=338.98 SLOPE E=336.20 CLEAR= 40.9'
67. UTILITY CROSSING WATER E=338.98 SLOPE E=336.20 CLEAR= 40.9'
68. UTILITY CROSSING WATER E=338.98 SLOPE E=336.20 CLEAR= 40.9'
69. UTILITY CROSSING WATER E=338.98 SLOPE E=336.20 CLEAR= 40.9'
70. UTILITY CROSSING WATER E=338.98 SLOPE E=336.20 CLEAR= 40.9'
71. UTILITY CROSSING WATER E=338.98 SLOPE E=336.20 CLEAR= 40.9'
72. UTILITY CROSSING WATER E=338.98 SLOPE E=336.20 CLEAR= 40.9'
73. UTILITY CROSSING WATER E=338.98 SLOPE E=336.20 CLEAR= 40.9'
74. UTILITY CROSSING WATER E=338.98 SLOPE E=336.20 CLEAR= 40.9'
75. UTILITY CROSSING WATER E=338.98 SLOPE E=336.20 CLEAR= 40.9'
76. UTILITY CROSSING WATER E=338.98 SLOPE E=336.20 CLEAR= 40.9'
77. UTILITY CROSSING WATER E=338.98 SLOPE E=336.20 CLEAR= 40.9'
78. UTILITY CROSSING WATER E=338.98 SLOPE E=336.20 CLEAR= 40.9'
79. UTILITY CROSSING WATER E=338.98 SLOPE E=336.20 CLEAR= 40.9'
80. UTILITY CROSSING WATER E=338.98 SLOPE E=336.20 CLEAR= 40.9'
81. UTILITY CROSSING WATER E=338.98 SLOPE E=336.20 CLEAR= 40.9'
82. UTILITY CROSSING WATER E=338.98 SLOPE E=336.20 CLEAR= 40.9'
83. UTILITY CROSSING WATER E=338.98 SLOPE E=336.20 CLEAR= 40.9'
84. UTILITY CROSSING WATER E=338.98 SLOPE E=336.20 CLEAR= 40.9'
85. UTILITY CROSSING WATER E=338.98 SLOPE E=336.20 CLEAR= 40.9'
86. UTILITY CROSSING WATER E=338.98 SLOPE E=336.20 CLEAR= 40.9'
87. UTILITY CROSSING WATER E=338.98 SLOPE E=336.20 CLEAR= 40.9'
88. UTILITY CROSSING WATER E=338.98 SLOPE E=336.20 CLEAR= 40.9'
89. UTILITY CROSSING WATER E=338.98 SLOPE E=336.20 CLEAR= 40.9'
90. UTILITY CROSSING WATER E=338.98 SLOPE E=336.20 CLEAR= 40.9'
91. UTILITY CROSSING WATER E=338.98 SLOPE E=336.20 CLEAR= 40.9'
92. UTILITY CROSSING WATER E=338.98 SLOPE E=336.20 CLEAR= 40.9'
93. UTILITY CROSSING WATER E=338.98 SLOPE E=336.20 CLEAR= 40.9'
94. UTILITY CROSSING WATER E=338.98 SLOPE E=336.20 CLEAR= 40.9'
95. UTILITY CROSSING WATER E=338.98 SLOPE E=336.20 CLEAR= 40.9'
96. UTILITY CROSSING WATER E=338.98 SLOPE E=336.20 CLEAR= 40.9'
97. UTILITY CROSSING WATER E=338.98 SLOPE E=336.20 CLEAR= 40.9'
98. UTILITY CROSSING WATER E=338.98 SLOPE E=336.20 CLEAR= 40.9'
99. UTILITY CROSSING WATER E=338.98 SLOPE E=336.20 CLEAR= 40.9'
100. UTILITY CROSSING WATER E=338.98 SLOPE E=336.20 CLEAR= 40.9'

**MAGNOLIA STREET PROFILE**  
 HORIZ. 1"-20" VERT. 1"-2"

TOWN OF LOOMIS

NO.	DATE	DESCRIPTION



**RSC ENGINEERING**  
 2500 Douglas Blvd. Suite 100  
 Roseville, CA 95678  
 PROJECT NO. 0377-001  
 DRAWN BY: K. BAUTER  
 CHECKED BY: J. WANGENKAMP  
 DESIGNED BY: J. WANGENKAMP

**MAGNOLIA STREET, OAK STREET AND SOUTH HOLLY STREET, LOOMIS, CA 95650**

**SHEET TITLE**  
 OAK STREET  
 PLAN AND  
 PROFILE

**SHEET NO.**  
**C4.0**  
 OF 10

DATE: APRIL 28, 2010

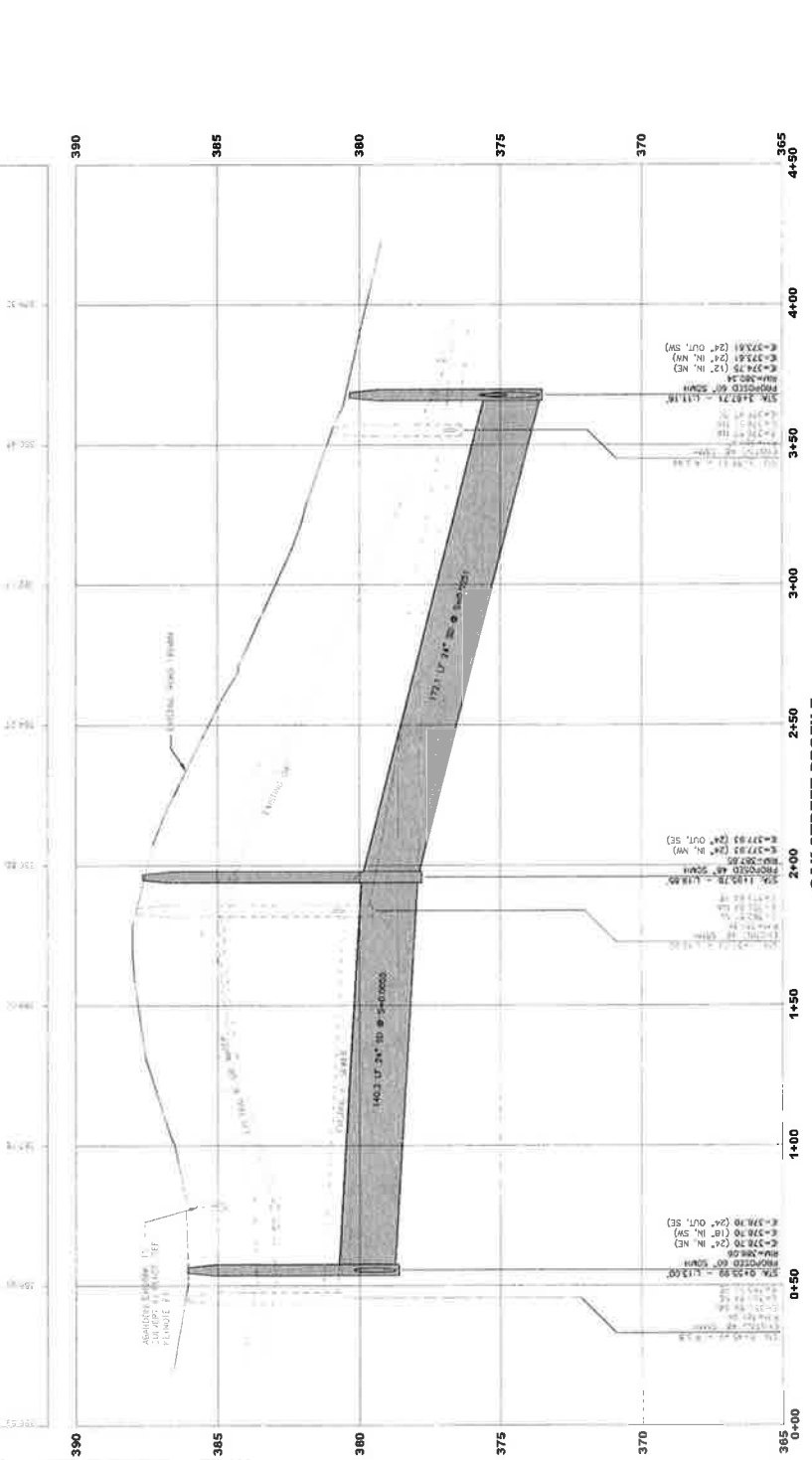
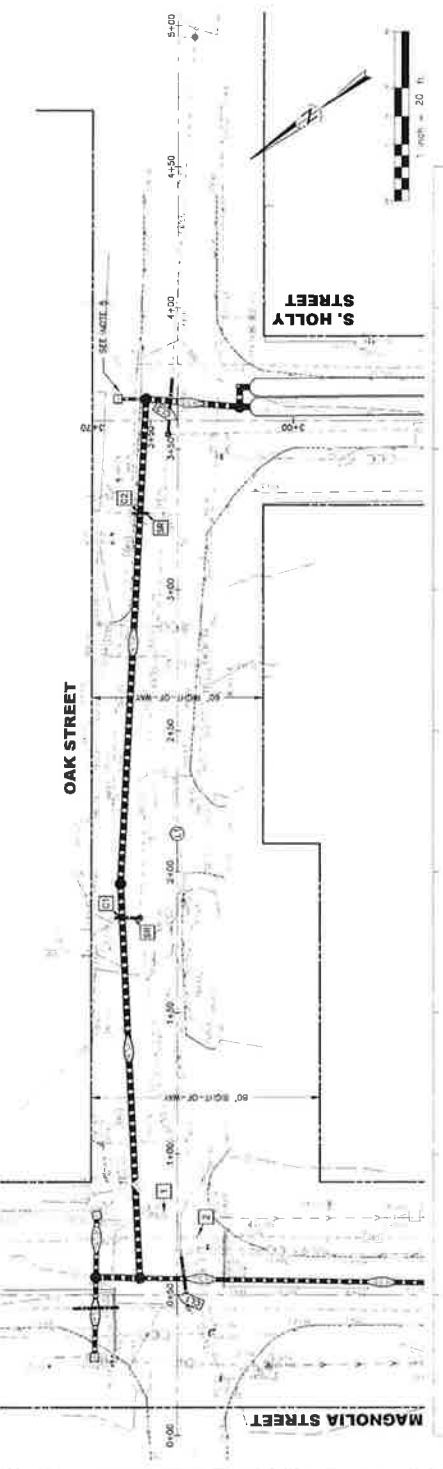

**OAK STREET PROFILE**  
 SCALE: 1"=20' VERT., 1"=2'

**GENERAL NOTES**

1. ALL PROPOSED INLETS SHALL BE DROP INLET TYPE "1" PER TOWN OF LOOMIS STANDARD DRAWING SD-3. ALL PER TOWN OF LOOMIS STANDARD DRAWING SD-3. ALL UNLESS NOTED OTHERWISE SHALL HAVE A HEIGHT OF 6".
2. ALL MANHOLES SHALL BE 48" DIAMETER PRECAST MANHOLES PER TOWN OF LOOMIS STANDARD DRAWING SD-3. UNLESS NOTED OTHERWISE.
3. ALL CONSTRUCTION SHALL BE ACCORDANCE WITH TOWN OF LOOMIS STANDARD DRAWING H-42 MODIFIED. SEE SHEET C7.0
4. CONTRACTOR SHALL REPAIR AND REPLACE ANY CURB AND GUTTER DAMAGE TO EXISTING CURB AND GUTTER SHALL BE TYPE 2 PER TOWN OF LOOMIS STANDARD DRAWING H-2
5. CONTRACTOR SHALL REGRADE ADJACENT TO DRAIN MANHOLES TO MAINTAIN STREET DRAINAGE FINISH GRADE SHALL BE A SMOOTH STREET SURFACE.

**CENTERLINE KEY NOTES**

- 1. OAK STREET STATION 0+50.00
- 2. MAGNOLIA STREET STATION 3+15.00
- 3. S. HOLLY STREET STATION 3+40.48
- 4. CENTERLINE SEGMENT - NORTH 54°18'05.4" WEST

**KEY NOTES**

1. CONTRACTOR SHALL ABANDON EXISTING 12" CSP BY OPEN EXPOSURE PORTION OF CSP WITHIN THE MANHOLES AND CATCH BASINS SHALL BE REMOVED AND DISPOSED OF
2. CONTRACTOR SHALL REMOVE EXISTING COLORATCH AC AND AC PER SPECIFICATIONS
3. UTILITY CROSSING STORM (E-375.07) CLEAR = 50.5'
4. UTILITY CROSSING STORM (E-374.63) CLEAR = 50.5'
5. BR DENOTES SS CROSSING REPAIR PER SP4UD STANDARD DWG 17 (SEE SHEET C7.0)

NO.	DATE	DESCRIPTION



**RSC ENGINEERING**  
 2350 Center Blvd, Suite 100  
 P.O. Box 1234, Loomis, CA 95650  
 PH: 530.754.8228  
 FAX: 530.754.8228

PROJECT NO. 0712-031  
 DRAWN BY: J. HANCOCK  
 CHECKED BY: J. HANCOCK  
 DESIGNED BY: J. HANCOCK

**MAGNOLIA STORM DRAIN PLANS**  
 MAGNOLIA STREET, OAK STREET AND HOLLY LOOMIS, CA 95650

**SHEET TITLE**  
**S. HOLLY STREET PLAN AND PROFILE**

**SHEET NO.**  
**C50**  
**OF 10**

DATE: APR. 29, 2010

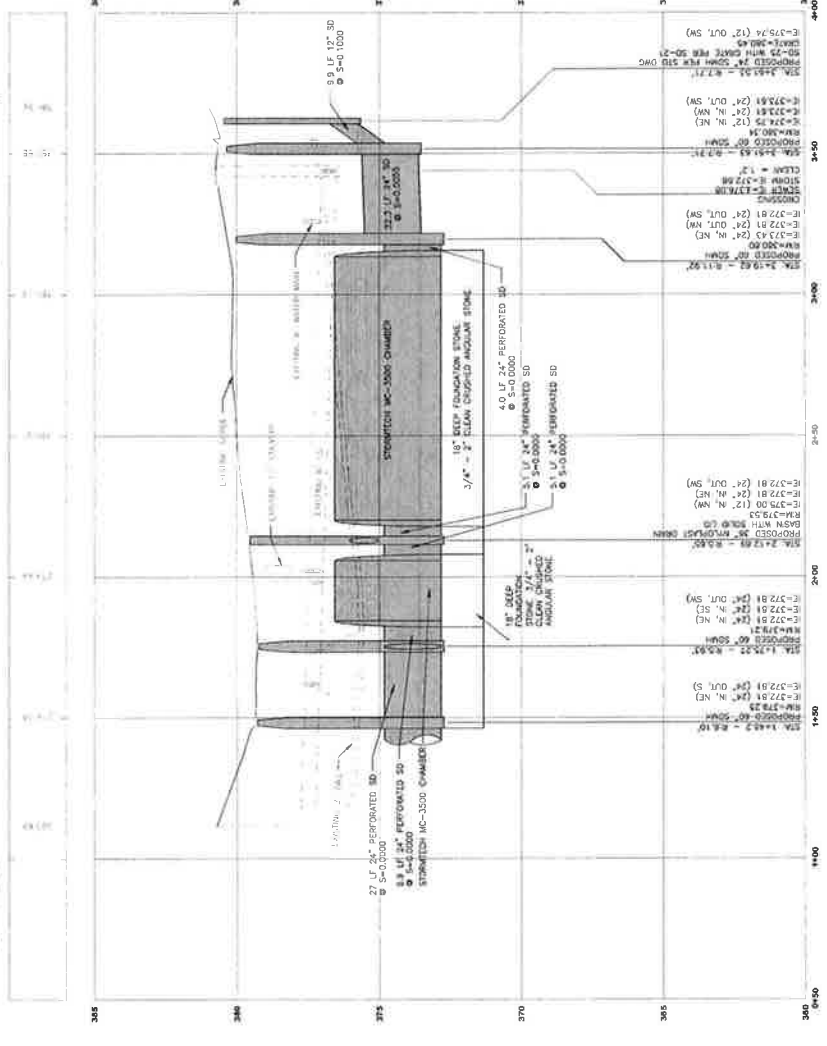
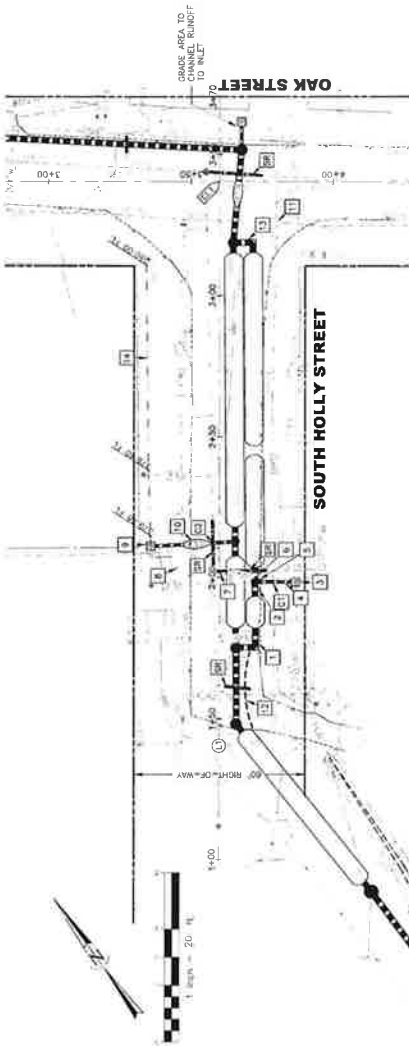
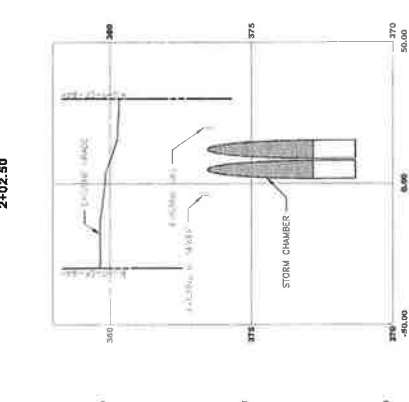
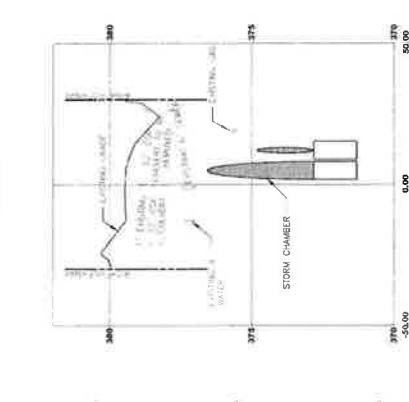
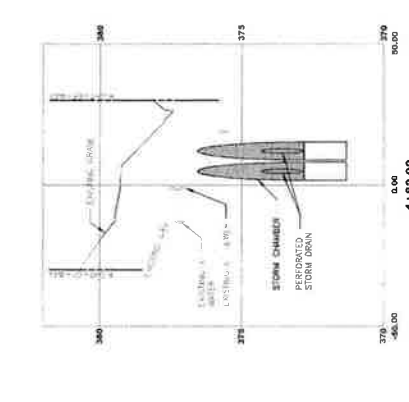

**GENERAL NOTES**

- ALL PROPOSED INLETS SHALL BE DROP INLET TYPE PER TOWN OF LOOMIS STANDARD DRAWING SD-5, UNLESS NOTED OTHERWISE.
- ALL MANHOLES SHALL BE 48" DIAMETER PRECAST MANHOLES PER TOWN OF LOOMIS STANDARD DRAWING SD-23, UNLESS NOTED OTHERWISE.
- ALL REVISIONS, BACKFILL AND RESTORATION SHALL BE SHOWN ON SEPARATE SHEETS.
- CONTRACTOR SHALL REGRADE AREA ADJACENT TO DRAIN INLET TO CREATE/MAINTAIN POSITIVE DRAINAGE. FINISH GRADE SHALL BE A SMOOTH SURE SURFACE. FINISH SHALL BE AS SHOWN ON SEPARATE SHEETS UPON COMPLETION OF PROPOSED IMPROVEMENTS.

**CENTERLINE KEY NOTES**

1. S. HOLLY STREET STATION 34+0.48  
 CURB STREET STATION 34+50.00

2. CENTERLINE SEGMENT - NORTH 35°41'46" EAST

**KEY NOTES**

1. 1.8 LF 24" PERFORATED SD @ S+0.0000
2. 5.1 LF 24" PERFORATED SD @ S+0.0000
3. 3.0 LF 24" PERFORATED SD @ S+0.0000
4. 1.4 LF 12" SD @ S+0.0050
5. 36" NYTOPAST DRAIN BASIN WITH P20 SOLID I.D. RING 375.0713' (N, NE)  
 E=372.81 (24" N, NE)  
 E=372.81 (24" OUT, SW)
6. 5.1 LF 24" PERFORATED SD @ S+0.0000
7. 2.0 LF 24" PERFORATED SD @ S+0.0000 TO 1.1 LF 24" PERFORATED SD @ S+0.0000
8. ALL REMAINING PORTION OF EXISTING 12" SDP DRAINAGE TO BE MAINTAINED AS SHOWN ON PROPOSED STORM DRAIN TRENCH
9. 24" SDH PER TOWN OF LOOMIS STD DWG SD-25 (SEE SHEET C7.0)  
 CLEAR = 25.5'  
 E=376.00 (12" OUT, SW)
10. 29.8 LF 12" SD @ S+0.0033
11. CONTRACTOR SHALL REMOVE EXISTING DRAINAGE ACROSS CROSSING AND RESTORE POT-HOLE USING ASI AND ASI PER SPECIFICATIONS
12. 30' LF 6" UNDERDRAIN (PER STONE FOUNDATION - PER STANDARD SPECIFICATIONS)
13. 10.4 LF 24" PERFORATED SD @ S+0.0000
14. CONSTRUCT SHALE TO CREATE/MAINTAIN POSITIVE DRAINAGE TO EXISTING STORM DRAIN USING 1" COBBLE ON GEOTEXTILE FABRIC (SEE CROSS SECTION SHEET C7.0)
15. UTILITY CROSSING  
 CLEAR = 25.5'  
 STORM E=372.25  
 CLEAR = 25.7'
16. STANDARD DWG C7.17 (SEE SHEET C7.0)

**SOUTH HOLLY STREET PROFILE**  
 NOTE: 1"=20' VERT. 1"=2'

**GENERAL NOTES**

1. ALL PROPOSED INLETS SHALL BE DROP INLET TYPE PER TOWN OF LOOMIS STANDARD DRAWING SD-2, UNLESS NOTED OTHERWISE.
2. ALL MANHOLES SHALL BE 48" DIAMETER PRECAST MANHOLES PER TOWN OF LOOMIS STANDARD DRAWING SD-23, UNLESS NOTED OTHERWISE.
3. CONTRACTOR SHALL CLEAR AND GRADE AREA AS SHOWN AND PROVIDE ALL NECESSARY FACILITIES AND OUTFALL UNITS OF CLEANING AND FILTERING TO BE INSTALLED AND OPERATIONAL PRIOR TO COMPLETION OF CONSTRUCTION. THE AREA SHALL BE GRADED TO MATCH EXISTING CONDITIONS AND ALLOW FOR FUTURE CONSTRUCTION.
4. ALL PROPOSED CONSTRUCTION SHALL BE TEMPORARILY REINSTALLED WALKWAY AT A SAFE LOCATION TO AVOID DAMAGES DURING CONSTRUCTION. THIS IS ALSO A CONDITION OF CONSTRUCTION. MATERIALS SHALL BE REINSTALLED IN THE ORIGINAL LOCATION.
5. ALL EXISTING UTILITY LINES SHALL BE PROTECTED AND RECONSTRUCTED PER SHEET C7.0. ANY CHANGES TO EXISTING UTILITY LINES SHALL BE SHOWN ON SHEET C7.0.

**CENTERLINE KEY NOTES**

- 1. CENTERLINE SEGMENT - NORTH 24°23'4" WEST
- 2. CENTERLINE SEGMENT - NORTH 03°57'5" WEST

**KEY NOTES**

1. STA. 0+63.81 - 0+71.17 EXISTING FLOWLINE WIDTH AT RECORDING LIMIT.
2. REMOVE AND REINSTALL EXISTING POST & WIRE GATE.
3. 1/2" DIA. SECTION WITH 1.5" FLOWLINE WIDTH PER DETAIL 5/17.0.
4. "CHANNEL DITCH" SECTION REFERS TO SHEET C7.0 FOR STORM DRAIN OUTFALL DETAIL.
5. SEE NOTE 3.
6. SEE NOTE 4.

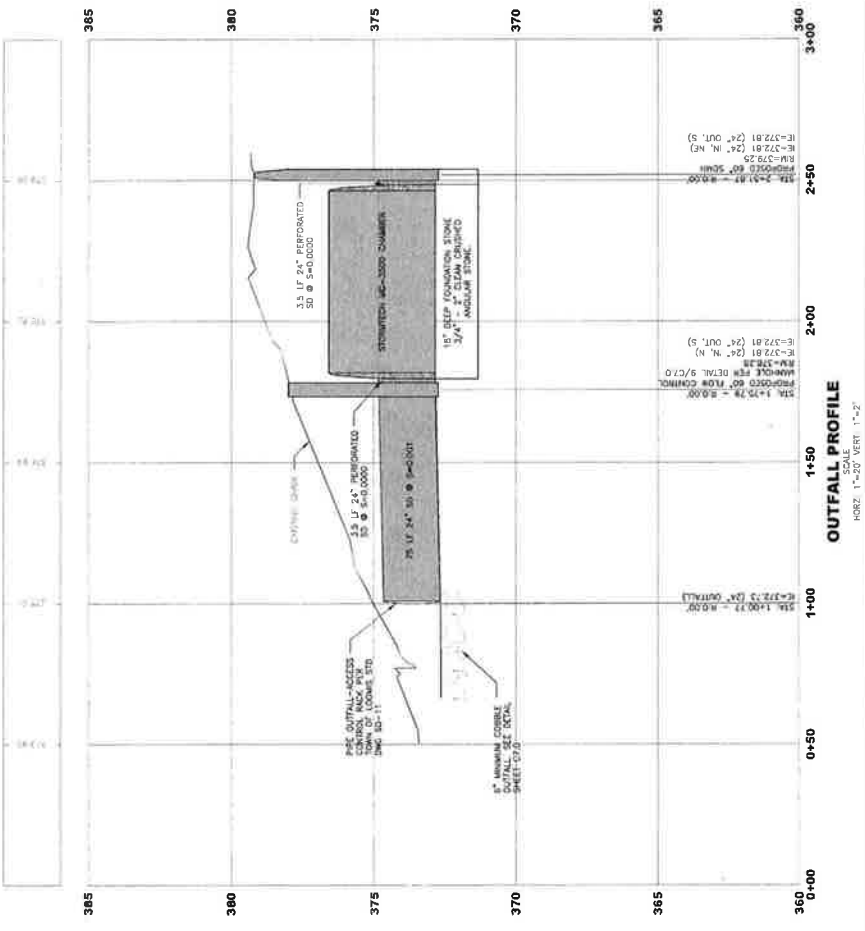
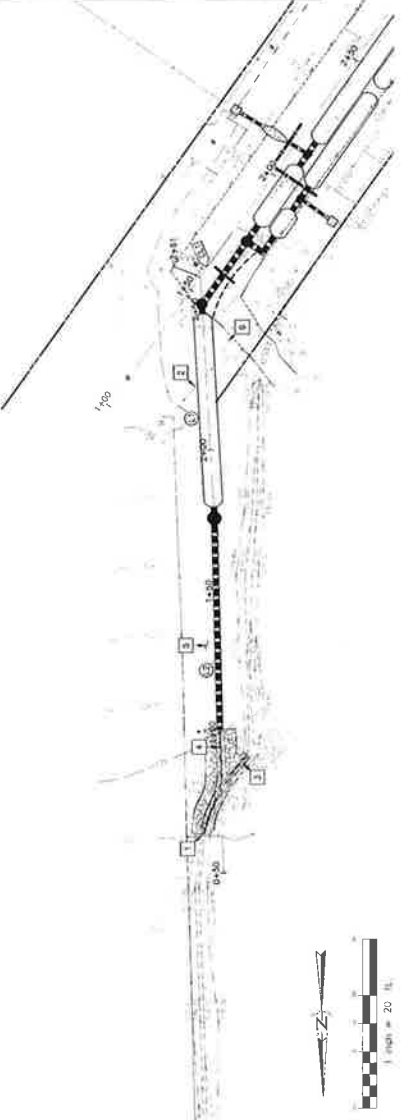
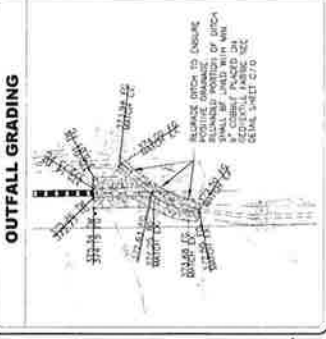

TOWN OF LOOMIS

REV.	DATE	BY	APP.	DESCRIPTION



PROJECT NO. 077-1011  
 DRAWN BY: K. BRUNO  
 CHECKED BY: J. UNDERWOOD  
 DESIGNED BY: J. UNDERWOOD

**MAGNOLIA STORM DRAIN PLANS**  
 MAGNOLIA STREET, OAK STREET AND LOOMIS, CA 95650

SHEET TITLE  
**OUTFALL PLAN AND PROFILE**

SHEET NO.  
**C6.0**  
 OF 10

DATE: APRIL 29, 2010



REVISION NO.	DATE	DESCRIPTION

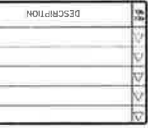

**MAGNOLIA STORM DRAIN PLANS**  
 MAGNOLIA STREET, OAK STREET AND LOOMIS, CA 95650

SHEET TITLE  
**DETAIL SHEET**  
 SHEET NO.  
**C7.0**  
 OF 10

PROJECT NO. 177-01  
 DRAWN BY: J. WANDERST  
 CHECKED BY: J. WANDERST  
 DESIGNED BY: J. WANDERST

**NOTES:**

1. BACKFILL MATERIAL SHALL BE APPROVED BY THE TOWN ENGINEER OR THEIR REPRESENTATIVE PRIOR TO INSTALLATION.
2. INITIAL PIPE BEDDING AND BACKFILL MATERIAL SHALL BE IN ACCORDANCE WITH THE TOWN ENGINEER'S RECOMMENDATIONS, INCLUDING A SOLE STATEMENT FOR MANUFACTURERS.

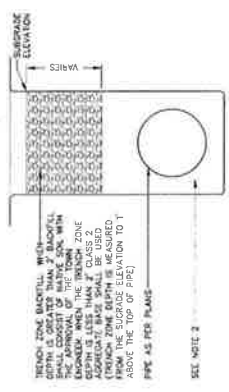

**3 BEDDING & BACKFILL DETAIL**  
 NOT TO SCALE

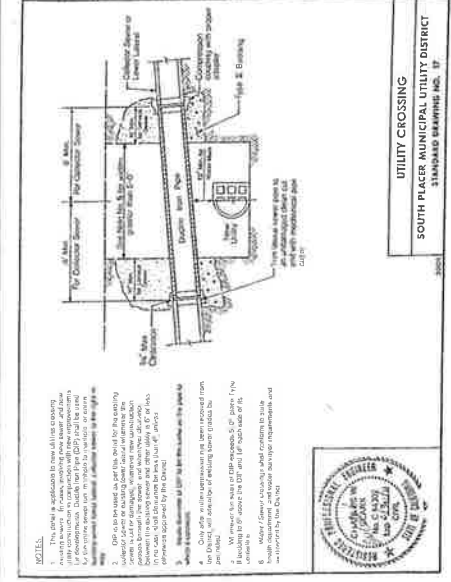

**2 SANITARY SEWER PIPE CROSSING DETAIL**  
 NOT TO SCALE

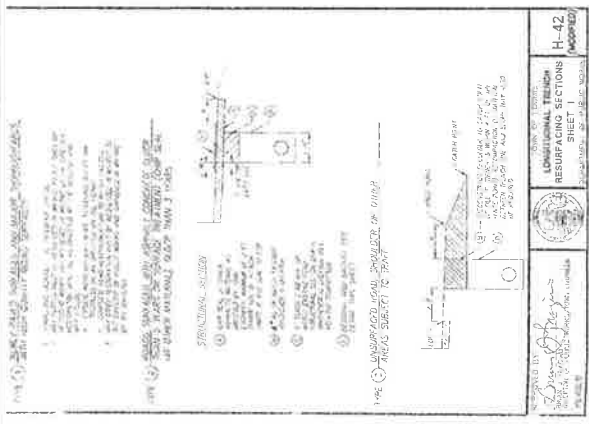

**1 MODIFIED TRENCH SECTION**  
 NOT TO SCALE



**6 LT. SHOULDER MAGNOLIA STREET SECTION**  
 NOT TO SCALE

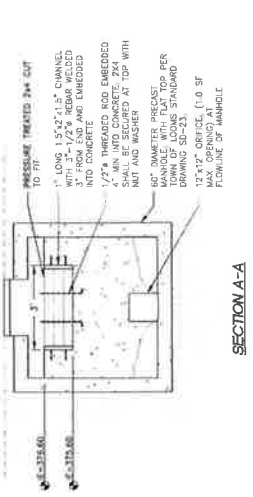

**5 FLOW CONTROL MANHOLE**  
 NOT TO SCALE

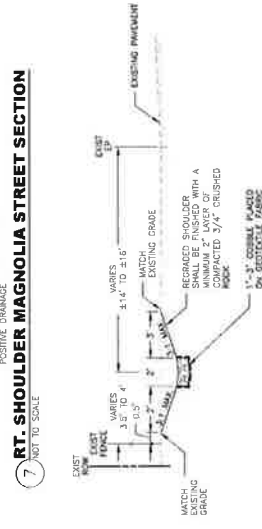

**7 RT. SHOULDER MAGNOLIA STREET SECTION**  
 NOT TO SCALE

**8 HOLLY STREET SWALE CROSS SECTION**  
 NOT TO SCALE

**4 OUTFALL DETAIL**  
 NOT TO SCALE

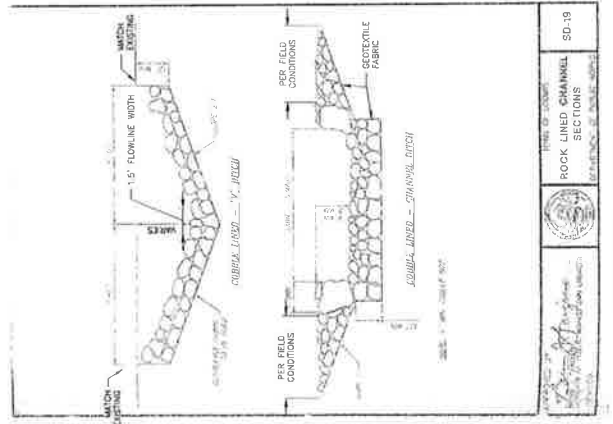

NO.	REVISION	DATE



**RSC ENGINEERING**  
 PROJECT NO. 077-001  
 DRAWN BY: K. BALTER  
 CHECKED BY: J. HANCOCK  
 DESIGNED BY: J. HANCOCK

MAGNOLIA STREET, OAK STREET AND  
 LOOMIS, CA 95650

**MAGNOLIA STORM DRAIN PLANS**

SHEET TITLE  
**DETAIL SHEET**

SHEET NO.  
**C7.1**  
 OF 10

DATE: 08/13/2010

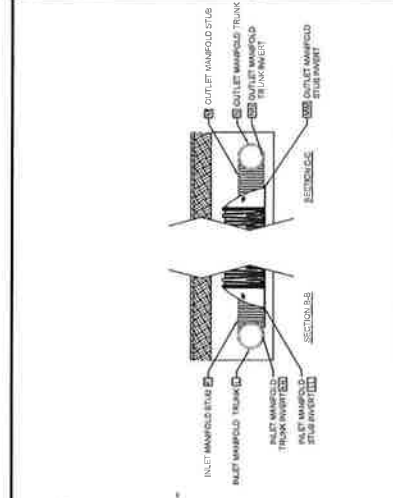

**STORMTECH MANIFOLD DETAIL**  
 NOT TO SCALE

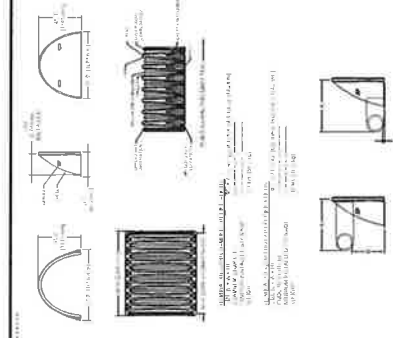

**STORMTECH CHAMBER SPECIFICATIONS**  
 NOT TO SCALE

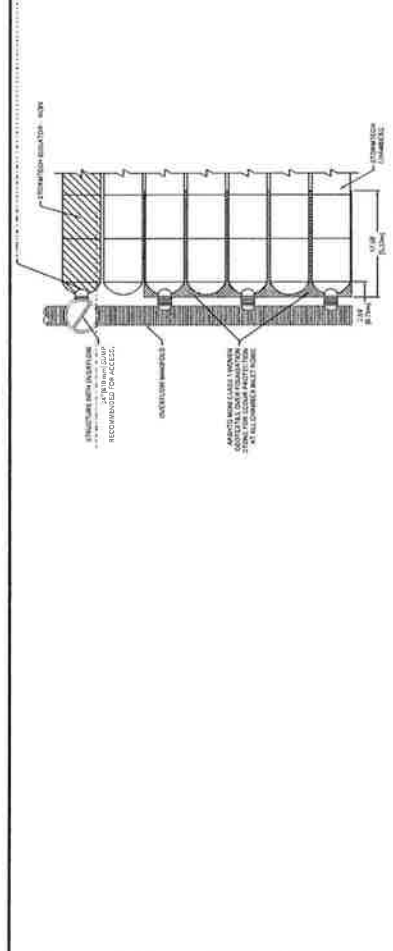

**STORMTECH TYPICAL SECTION**  
 NOT TO SCALE

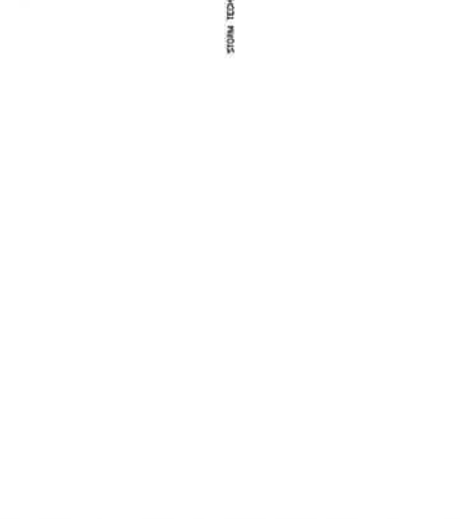

**STORMTECH TYPICAL CROSS SECTION**  
 NOT TO SCALE

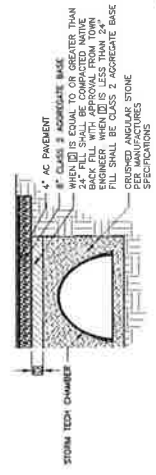

**STORMTECH BACK FILL**  
 NOT TO SCALE

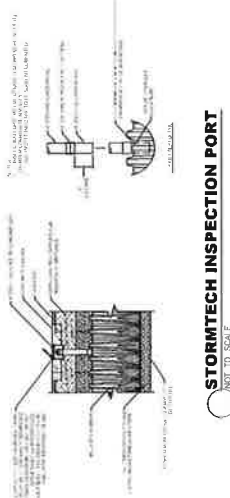

**STORMTECH INSPECTION PORT**  
 NOT TO SCALE

NOTE: STORM TECH DETAILS SHOWN ARE FOR INFORMATION ONLY. SITE SPECIFIC DETAILS FROM MANUFACTURER MUST BE SUBMITTED FOR APPROVAL PRIOR TO CONSTRUCTION

**TOWN OF LOOMIS**

NO.	DESCRIPTION



**RSC ENGINEERING**  
 PROJECT NO: 077-001  
 DRAWN BY: K. SHAFER  
 CHECKED BY: J. WARDEN  
 DESIGNED BY: J. WARDEN

**MAGNOLIA STORM DRAIN PLANS**  
 MAGNOLIA STREET, OAK STREET AND  
 SOUTH HOLLY STREET  
 LOOMIS, CA 95650

SHEET TITLE:  
**SLURRY &  
 STRIPING PLAN**

SHEET NO:  
**C8.0**  
 OF 10

DATE: APRIL 28, 2010

**GENERAL NOTES**

- LIMITS OF SLURRY SEAL SHALL BE COORDINATED WITH APPLICABLE RECORDS PRIOR TO APPLICATION.
- ALL STRIPING AND INCHWORM MARKING LIMITS OR LOCATION SHALL BE COORDINATED WITH TOWN OF LOOMIS REPRESENTATIVE PRIOR TO APPLICATION.
- STRIPING AND INCHWORM MARKINGS SHALL BE PER MUTED GUIDELINES.

**KEY NOTES**

- STOP LEGEND
- LIMIT LINE (1/2" WIDE, WHITE)
- STOP SIGN AND POLE WITH BASE
- PAVEMENT DEMARCATION DETAIL PER MUTED GUIDELINES (4" WIDE, YELLOW)
- DENOTES SLURRY SEAL LIMITS

