



STAFF REPORT

TOWN COUNCIL MEETING OF JANUARY 10, 2012

BUSINESS ITEM

To: Town Council

From: Brian Fragio, Director of Public Works/Town Engineer

Two handwritten signatures, one in blue ink and one in black ink, positioned to the right of the 'From' line.

Subject: Bench Donations for the Blue Anchor Park

Date: December 19, 2011

RECOMMENDATION:

Direct Staff.

ISSUE AND DISCUSSION:

During the bid process for the Blue Anchor Park improvements, Council directed staff to eliminate the line item in the bid proposal regarding purchase and installation of benches. It was the goal that donated benches would be installed in the park.

Councilmember Ucovich has asked that this item be discussed at Council.

Currently, there is a list of 14 people who would like to purchase a granite bench. I spoke to Scott Paris and the granite benches will be under \$300 and the plaque is roughly \$135. The original park layout included 7 benches in the park (see attachment). Additional benches can be located along the sidewalk to Walnut Street cul-de-sac.

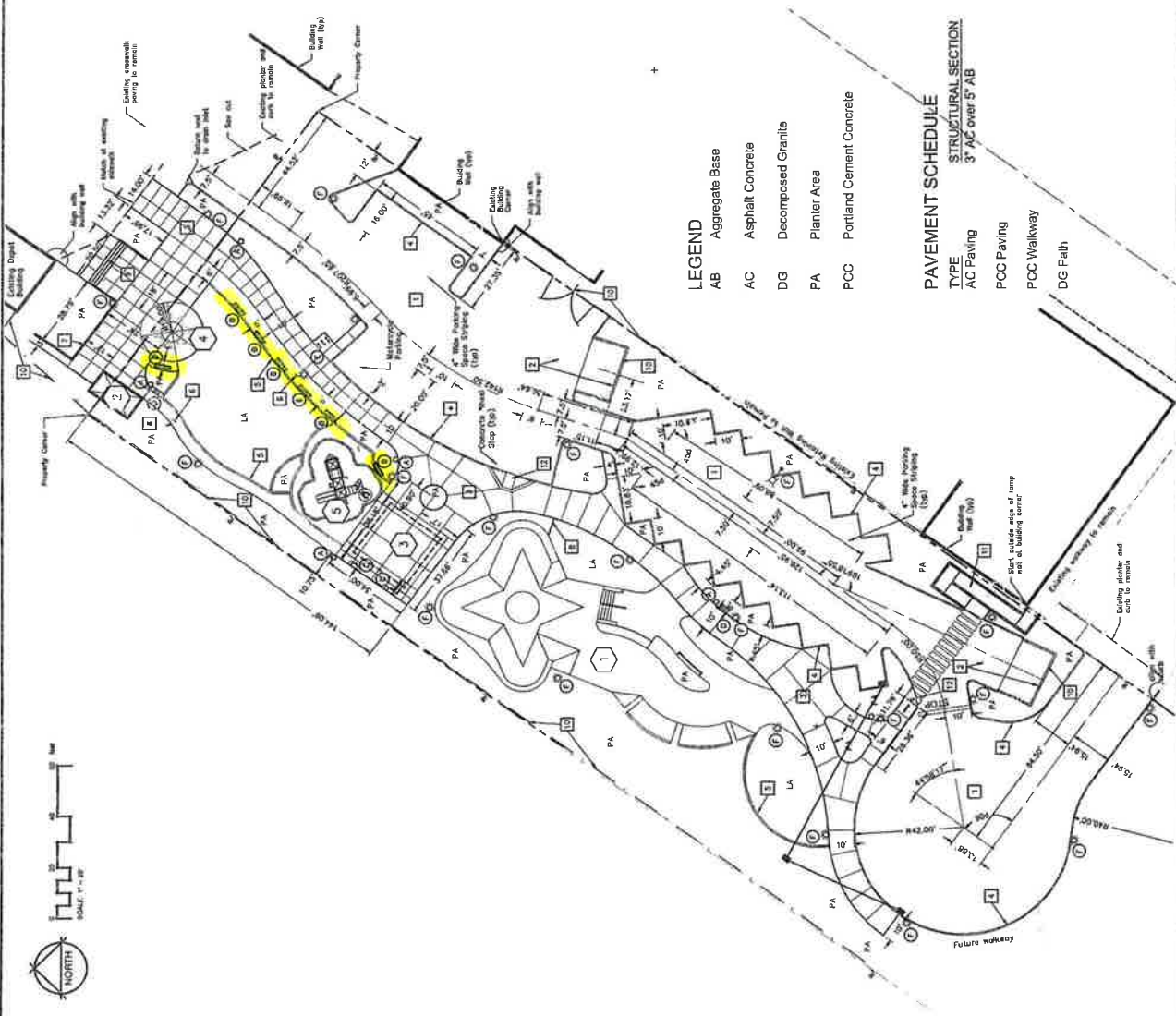

LEGEND

AB	Aggregate Base
AC	Asphalt Concrete
DG	Decomposed Granite
PA	Planter Area
PCC	Portland Cement Concrete

PAVEMENT SCHEDULE

STRUCTURAL SECTION
3" AC over 5" AB

TYPE	AC Paving
PCC Paving	
PCC Walkway	
DG Path	

SITE FURNITURE LEGEND

- 1 TRASH CONTAINER (see sheet C5 for detailed model / spec. information)
- 2 6-FT. BENCH (see sheet C5 for detailed model / spec. information)
- 3 BBQ (see sheet C5 for detailed model / spec. information)
- 4 DRINKING FOUNTAIN (see sheet C3 and C5 for detailed model / spec. information)
- 5 BIKE RACK (see sheet C5 for detailed model / spec. information)
- 6 SITE LIGHTING: See sheet xx for electrical plans, and schedules.

SITE STRUCTURE INFORMATION

- Contractor to provide ADD ALTERNATE bid prices for the following park elements (see also Sheet C5 for more information):
- 1 SKATE FACILITY: See Skate ("SK") sheets for details and layout information.
 - 2 RESTROOM FACILITY: Contractor to coordinate / build structure, prepare pad per grading plan and provide mechanical / plumbing / electrical as indicated on the utility plans and electrical plans within this set of plans
 - 3 SHADE STRUCTURE: Contractor to install per manufacturer's specification. See Electrical plans to coordinate electrical issues.
 - 4 WATER PLAY SPRAY PAD: Contractor to install spray nozzles, drainage, mechanical and electrical per other plans located in this set, and per manufacturer's specification / design build plans.
 - 5 TOT-LOT STRUCTURES / AMENITIES: Install equipment and surface per manufacturer's specifications.

---SITE FURNITURE: Contractor to install benches, trash receptacles, drinking fountains and bike racks.

KEYED NOTES

- 1 AC paving
- 2 PCC paving
- 3 PCC walkway
- 4 Type 5 barrier curb per Town of Loomis std drawing H-2.
- 5 Mow curb per detail on sheet C2
- 6 DG path per detail on sheet C2
- 7 Planter Curb Per detail on sheet C2
- 8 Plastic Header Board per detail on Sheet C2
- 9 Concrete Stairs per detail on Sheet C2
- 10 Trash enclosure per details on Sheet C3
- 11 ADA Ramp per details on Sheet C4
- 12 Curb Ramp per Caltrans Stnds.
- 13 8-ft. High Vinyl Clad Chain Link Fence per detail sheet C3

SITE CONCRETE INFORMATION

- Contractor to install site concrete per various details on Sheet C2 and the following:
- 1. Concrete walks / plaza concrete to be Wash-off Finish Colored Concrete, Davis Color: Pebble, Mix Rate of .5 lbs. of 641 per 94 lbs. (1cu/ft.) of type II Cement
 - 2. Top-Of surface to be xxxxxxxx

REVISIONS

NO.	DESCRIPTION	DATE

LAYOUT PLAN
Park Improvement Plans
DOWNTOWN PARK
Town of Loomis, California

PROJECT NO.	L1
DATE	7-20-10
SCALE	1/4"=1'-0"
DRAWN BY	TRACI HUNTER
CHECKED BY	DAVID HUNTER
DATE	7-20-10
APP. NO.	2010-04-10
APP. DATE	2010-04-10

