



**STAFF REPORT
TOWN COUNCIL MEETING OF AUGUST 12, 2014
BUSINESS ITEM**

TO: HONORABLE MAYOR AND MEMBERS OF THE TOWN COUNCIL

FROM: BRIAN FRAGIAO, DIRECTOR OF PUBLIC WORKS

DATE: AUGUST 1, 2014

RE: CALTRANS ENCROACHMENT PERMIT FOR THE HORSESHOE BAR BRIDGE METAL ARTWORK AND TREE PLANTING PROJECTS.

Recommendation:

Direct staff to: 1) continue with the Caltrans Encroachment Permit Process by having the Town Manager enter into the Freeway Maintenance and Landscape Maintenance Agreements; 2) acquire a consultant to provide Metal Artwork design plans and calculations (not to exceed \$5000); 3) acquire a fabrication company to make and install the artwork on the bridge (not to exceed \$30,000); 4) acquire a landscape architect to provide Tree planting design plans (not to exceed \$5,000); and 5) to purchase and install the Irrigation & Trees (not to exceed \$5,000).

Issue Statement and Discussion

On June 17, 2014, staff submitted an Encroachment Permit Application to Caltrans for the installation of Metal Artwork on the Horseshoe Bar Bridge and Tree Planting within the on and off ramp loops. Caltrans responded on July 17, 2014 with two letters directing the next steps (attached). The Town will be required to do the following:

1. Enter into a Freeway Maintenance Agreement with Caltrans for the maintenance of the deck of the existing bridge and the proposed Metal Artwork.
2. Provide Caltrans with detailed Metal Artwork design plans and structural calculations.
3. Enter into a Landscape Maintenance Agreement with Caltrans for the irrigation/planting and maintenance of the trees.
4. Provide Caltrans with detailed Tree Irrigation & Planting design plans.

Staff has recently found out that the Horseshoe Bar Bridge raising date has been moved from summer 2015 to January 2015. Staff has been informed that the schedule change is due to the Contractor falling behind on the schedule.

With the bridge raising schedule change, staff may not have enough time to process the encroachment permit, acquire a consultant to design the metal Artwork and install the pieces as part of the bridge raising project. Therefore, the Metal Artwork may have to take place after the bridge has been raised. Staff will make every effort to speed the process. The tree planting will take place after the bridge is raised and all of Caltrans staging material has been removed.

CEQA Requirements

This project is exempt under the California Environmental Quality Act (CEQA) Sections 15301(c&d) (Class 1), "Existing Facilities" and 15303 (c)(d)(e), "New Construction" of the guidelines. The Town may be required to follow NEPA guidelines since it is within Caltrans property.

Financial and/or Policy Implications

Metal Artwork - \$20,000 of General Fund Reserve has been set aside as part of the 2015-2016 Capital Improvement Program projects. Staff has been researching costs for the metal and Core 10 steel will be roughly \$15,000 for materials. This does not include design, cutting and installation. The total cost may be in the range of \$30-\$35k. An additional \$15,000 maybe needed for this work.

Tree Planting – The project has been included in the 2015- 2016 Capital Improvement Program Projects. No cost was established for the project. Funding will come from the Tree Mitigation Fund (\$336,684) for design and installation. \$10,000 could be set aside for this project. The Maintenance will be provided by the Public Works Staff.

TOWN OF LOOMIS

RESOLUTION NO. 14-

TOWN MANAGER TO ENTER INTO A FREEWAY MAINTENANCE AND LANDSCAPE MAINTENANCE AGREEMENTS WITH CALTRANS, ACQUIRE A CONSULTANT TO PROVIDE METAL ARTWORK DESIGN PLANS AND CALCULATIONS, (not to exceed \$5000) A FABRICATION COMPANY TO MAKE AND INSTALL THE ARTWORK ON THE BRIDGE, (not to exceed \$30,000), ACQUIRE A LANDSCAPE ARCHITECT TO PROVIDE TREE PLANTING DESIGN PLANS (not to exceed \$5,000) AND TO PURCHASE AND INSTALL THE IRRIGATION & TREES (not to exceed \$5,000) AS PART OF THE CALTRANS ENCROACHMENT PERMIT PROCESS

WHEREAS, the Town of Loomis submitted an Encroachment Permit Application to Caltrans to install Metal Artwork on the Horseshoe Bar Bridge and to plant trees within the on and off ramp of the Horseshoe Bar Interchange; and

WHEREAS, as part of the Encroachment Permit Process, The Town will be required to enter into a Freeway and Landscape Maintenance Agreement with Caltrans; and

WHEREAS, the Town will need to acquire a consultant to design the Metal Artwork, a company to fabricate and install the Metal Artwork, and a Landscape Architect to design a tree planting plan; and

WHEREAS, funding will be provide by the General Fund Reserve Account and the Tree Mitigation Fund.

NOW, THEREFORE, IT IS HEREBY RESOLVED that the Town of Loomis Town Council directs staff to continue with the Caltrans Encroachment Permit Process by having the Town Manager enter into the Freeway Maintenance and Landscape Maintenance Agreements, acquire a consultant to provide Metal Artwork design plans and calculations (not to exceed \$5000), a fabrication company to make and install the Artwork on the bridge (not to exceed \$30,000), acquire a landscape architect to provide Tree planting design plans (not to exceed \$5,000) and to purchase and install the Irrigation & Trees (not to exceed \$5,000).

PASSED AND ADOPTED by the Council of the Town of Loomis this 12th day of August, 2014 by the following vote:

AYES:
NOES:
ABSENT:

Mayor

ATTEST:

Town Clerk

DEPARTMENT OF TRANSPORTATION DISTRICT 3

703 B Street
MARYSVILLE, CA 95901
PHONE (530) 741-4403
FAX (530) 741-4236
TTY (530) 741-4509

RECEIVED

JUL 22 2014

**TOWN OF LOOMIS***Flex your power!
Be energy efficient!*

July 17, 2014

0314-NLF0423

03-PLA-80-8.64/8.81

Rick Angelocci
Town Of Loomis
3665 Taylor Road
Loomis, CA 95650

Dear Mr. Angelocci:

We received your encroachment permit application package on 06/19/2014 to do landscaping and irrigation work inside the ramp loops on Interstate 80 at Horseshoe Bar interchange in the city of Loomis. Here are the comments made after first review:

MAINTENANCE AGREEMENT:

A landscape maintenance agreement is required between the City of Loomis and State for the maintenance of the trees and irrigation system. Please contact our Maintenance Agreement Coordinator Nancy Xu at (530) 741-5396 for assistance.

LANDSCAPE ARCHITECT:

1. Do not use the Landscape Architect licensed seal for James C. Williamson on your plans. He is NOT authorized to do this work under his license.
2. On plans, list the botanical and common names of plants that are being proposed. Show a legend for plant and irrigation symbols. List what type of irrigation heads are proposed.
3. Provide individual plant basins covered with 3 inches of mulch. Mass-mulching is acceptable also.
4. Check setback requirements for plant placement.
5. How is schedule 40 irrigation pipe to be placed under Horseshoe Bar?
6. Who owns the existing water meter and who is paying for the water?

STRUCTURES:

1. Please add bridge number to plan sheet.
2. Provide duration of irrigation system in operation until trees are established.
3. Review Bridge (#19-0097) General Plan for alternative location of temporary irrigation line.

Town Of Loomis

July 17, 2014

Page 2

Please submit Six (6) sets of revised plans and include a letter listing your response to each comment above. Reference our file number **0314-NLF0423** on your letters and for inquiries made on permit status.

If we do not receive a response within six months from the date of this letter your application will be denied and your file will be closed, and you will need to reapply to continue the Encroachment Permit process.

If you have any questions you may contact Berinder Dhaliwal at (530) 741-5374.

Sincerely,

for BRUCE CAPAUL
Chief, Encroachment Permits Branch

DEPARTMENT OF TRANSPORTATION DISTRICT 3

703 B Street
MARYSVILLE, CA 95901
PHONE (530) 741-4403
FAX (530) 741-4236
TTY (530) 741-4509

RECEIVED

JUL 22 2014

TOWN OF LOOMIS



*Flex your power!
Be energy efficient!*

July 17, 2014

0314-NGM0424

03-PLA-80-8.72/8.72

Rick Angelocci
Town Of Loomis
3665 Taylor Road
Loomis, CA 95650

Dear Mr. Angelocci:

We received your encroachment permit application on 06/19/2014 for permission to attach metal art work to the pedestrian fence on the bridge overcrossing at the Horseshoe Bar interchange on Interstate-80. Following are the comments made after first review:

MAINTENANCE AGREEMENT:

Although there is a 1962 Freeway Maintenance Agreement (FMA) between Placer County and the State for the maintenance of the Horseshoe Bar Bridge, City of Loomis and State should have a FMA in place for the bridge, and the proposed metal art work pieces attaching to the bridge fence will be under the FMA. Please contact our Maintenance Agreement Coordinator Nancy Xu at (530) 741-5396 for assistance.

STRUCTURES:

1. Please add bridge number to the plan sheet.
2. Provide engineering calculations due to weight of art work and wind load increases to the structure.
3. Structural analyses of applied wind load on the art work need to be determined by the City or County. When the City or County is unable to determine design wind speed, the basic wind speed shall not be less than 100 mph.
4. Provide a plan sheet showing the details of art work connections to pedestrian fence line.
5. The plans and engineering calculations shall be stamped and signed by a California Registered Engineer.
6. Concrete anchor reinforcement must be located by nondestructive means before installing holes for anchors. Rotary drills to be used, no impact drills or coring. If reinforcement is encountered the anchor hole shall be abandoned, patched and a new hole installed. Anchor must be on Caltrans Authorized

Town Of Loomis

July 17, 2014

Page 2

Materials List for Mechanical Expansion Anchors

(http://www.dot.ca.gov/hq/esc/approved_products_list/) and installed per recommendations by manufacture.

7. All anchorage to concrete shall be detailed using Concrete Anchorage Devices from the Caltrans approved products (http://www.dot.ca.gov/hq/esc/approved_products_list/).

LANDSCAPE ARCHITECT:

You are showing an example of art work in a roundabout on Rocklin Road, What are you proposing for this project? The location, and size and materials are important to evaluate.

Please submit Six (6) sets of revised plans and include a letter listing your response to each comment above. Reference our file number **0314-NLF0424** on your letters and for inquiries made on permit status.

If we do not receive a response within six months from the date of this letter your application will be denied and your file will be closed, and you will need to reapply to continue the Encroachment Permit process.

If you have any questions you may contact Berinder Dhaliwal at (530) 741-5374.

Sincerely,

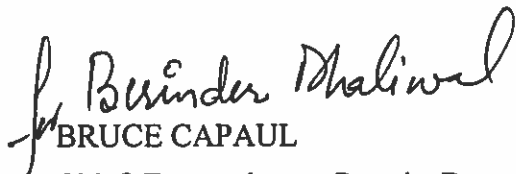
BRUCE CAPAUL

Chief, Encroachment Permits Branch

LOOMIS TREE PLANTING

DATE PLOTTED: 03-MAY-2013	DATE PLOTTED: 03-MAY-2013
TIME PLOTTED: 09:10:18	TIME PLOTTED: 09:10:18
DATE PLOTTED: 03-MAY-2013	DATE PLOTTED: 03-MAY-2013
TIME PLOTTED: 09:10:18	TIME PLOTTED: 09:10:18
DATE PLOTTED: 03-MAY-2013	DATE PLOTTED: 03-MAY-2013
TIME PLOTTED: 09:10:18	TIME PLOTTED: 09:10:18



PLANS APPROVAL DATE: _____
 THE STATE OF CALIFORNIA OR ITS OFFICERS OR AGENTS SHALL NOT BE HELD RESPONSIBLE FOR ANY ERRORS OR OMISSIONS OR FOR THE CONSEQUENCES OF THEIR USE OR REUSE.

LOOMIS LANDSCAPE ARCHITECTURE
 1000 S. GARDEN AVENUE, SUITE 100
 ANAHEIM, CALIFORNIA 92805
 TEL: 714.771.1111
 WWW.LOUMISLANDSCAPE.COM

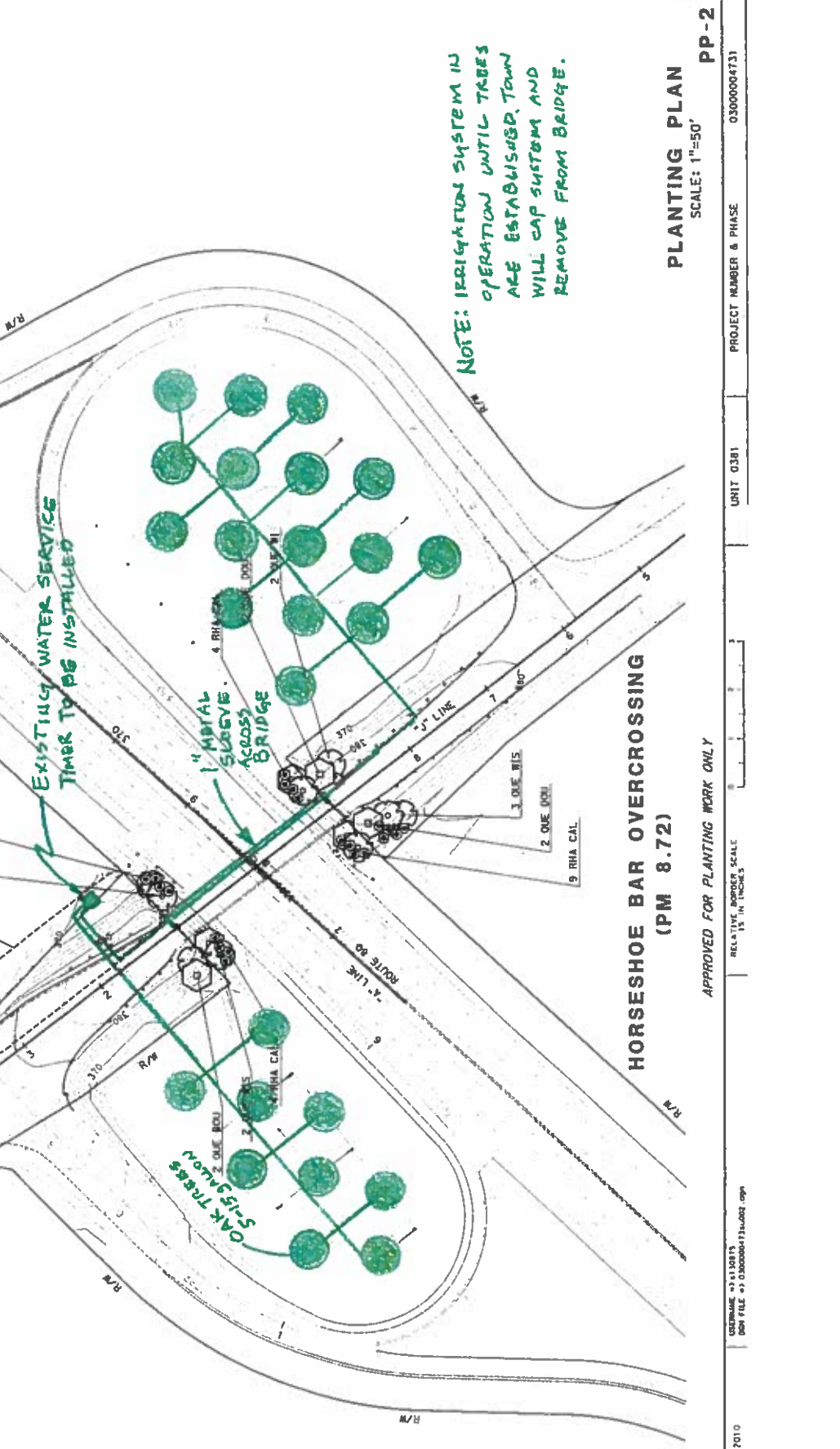

NOTE: IRRIGATION SYSTEM IN OPERATION UNTIL TREES ARE ESTABLISHED. TOWN WILL CAP SYSTEM AND REMOVE FROM BRIDGE.

HORSESHOE BAR OVERCROSSING
 (PM 8.72)

PLANTING PLAN
 SCALE: 1"=50'

PP-2

STATE OF CALIFORNIA - DEPARTMENT OF TRANSPORTATION	SENIOR LANDSCAPE ARCHITECT	T CHRIS JOHNSON	CHECKED BY	J. WILLIAMSON	REVISD BY	DATE REVISD
<p>APPROVED FOR PLANTING WORK ONLY</p> <p>RELATIVE NUMBER SCALE: 1"=15' IN INCHES</p> <p>PROJECT NUMBER & PHASE: 03000004731</p> <p>UNIT 0381</p> <p>DATE PLOTTED: 03-MAY-2013</p> <p>TIME PLOTTED: 09:10:18</p> <p>DATE PLOTTED: 03-MAY-2013</p> <p>TIME PLOTTED: 09:10:18</p>						

HORSESHOE BAR BRIDGE ART WORK

4" = 1'

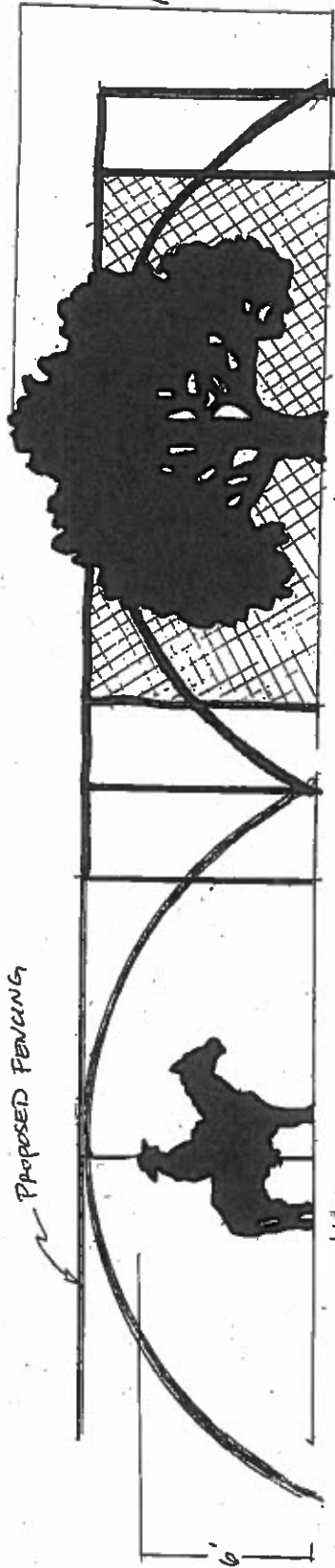

1/4" THICK METAL
± 300 lbs

LETTERS 1/4" THICK METAL
± 50 lbs. ea.

1/4" THICK METAL
± 150 lbs



1" = 20'