



**STAFF REPORT
COUNCIL MEETING OF AUGUST 14, 2012
CONSENT ITEM**

TO: HONORABLE MAYOR AND MEMBERS OF THE TOWN COUNCIL

FROM: BRIAN FRAGIAO, DIRECTOR OF PUBLIC WORKS/TOWN ENGINEER 

DATE: JULY 26, 2012

SUBJECT: NANCY BECK MULTI-USE PLAZA PROJECT – ADVERTISE FOR BIDS

RECOMMENDATION:

Direct Staff to advertise for bids for the Nancy Beck Multi-Use Plaza Project with the findings that the project is exempt under CEQA categories 15303, 15304 & 15332.

BACKGROUND:

The Town recently completed the improvements for the Blue Anchor Park and Parking facility along the railroad track from Horseshoe Bar Road to Walnut Street. Included in this segment is the Multi-Use Plaza which has been named after long time community organizer Nancy Beck. The improvements will continue the landscaping south of the park and add a plaza area that can be used for events, skating and leisure use. The project's tentative timeline would be as follows:

August 17, 2012 – Advertise Project

September 28, 2012 – Bid Opening

October 9, 2012 – Town Council Award to Low bidder

November 5, 2012 – Receive signed agreements/Notice to Proceed

February 2013 – estimated project completion (60 days)

CEQA:

This project is exempt under the California Environmental Quality Act (CEQA) Sections 15303 (c)(d)(e), "New Construction", 15304(a)(b)(c)(f)(h), "Minor Alterations to Land" and 15332, "In-fill Development Projects".

FINANCIAL AND/OR POLICY IMPLICATIONS:

\$125,000 of Park Development Funds (balance of \$195,000) has been set aside by the Town Council for this project.



Google earth



| | | | | | |
|--|--|--|--|--|--|
| | | | | | |
| | | | | | |
| | | | | | |
| | | | | | |
| | | | | | |
| | | | | | |

REVISIONS

Omni • megans
 ENGINEERS PLANNERS
 1000 S. GARDEN AVENUE
 SUITE 200
 ANAHEIM, CA 92805
 (714) 771-8888
 FAX (714) 771-8889
 WWW.OMNI-MEGANS.COM

LAYOUT PLAN
Park Improvement Plans
DOWNTOWN PARK
 Town of Loomis, California

| | |
|-------------|----------|
| DATE | 1/20/22 |
| SCALE | AS SHOWN |
| DESIGNED | SAK |
| DRAWN | SAK |
| CHECKED | 1/24/22 |
| IN CHARGE | SAK |
| PROJECT NO. | 22-0010 |
| SHEET NO. | 11 |

SITE FURNITURE LEGEND

- ① TRASH CONTAINER (see sheet C5 for detailed model / spec. information)
- ② 6-FT. BENCH (see sheet C5 for detailed model / spec. information)
- ③ BBQ (see sheet C5 for detailed model / spec. information)
- ④ DRINKING FOUNTAIN (see sheet C3 and C5 for detailed model / spec. information)
- ⑤ BIKE RACK (see sheet C5 for detailed model / spec. information)
- ⑥ SITE LIGHTING: See sheet xx for electrical plans, and schedules.

SITE STRUCTURE INFORMATION

- Contractor to provide ADD ALTERNATE bid prices for the following park elements (see also Sheet C5 for more information):
- ① SKATE FACILITY: See Skate ("SK") sheets for details and layout information.
 - ② RESTROOM FACILITY: Contractor to coordinate / build structure, prepare pad per grading plan and provide mechanical / plumbing / electrical as indicated on the utility plans and electrical plans within this set of plans
 - ③ SHADE STRUCTURE: Contractor to install per manufacturer's specification. See Electrical plans to coordinate electrical issues.
 - ④ WATER PLAY SPRAY PAD: Contractor to install spray nozzles, drainage, mechanical and electrical per other plans located in this set, and per manufacturer's specification / design build plans.
 - ⑤ TOT-LOT STRUCTURES / AMENITIES: Install equipment and surface per manufacturer's specifications.

---SITE FURNITURE: Contractor to install benches; trash receptacles, drinking fountains and bike racks.

KEYED NOTES

- ① AC paving
- ② PCC paving
- ③ PCC walkway
- ④ Type 5 barrier curb per Town of Loomis std drawing H-2.
- ⑤ Mow curb per detail on sheet C2
- ⑥ DG path per detail on sheet C2
- ⑦ Planter Curb Per detail on sheet C2
- ⑧ Plastic Header Board per detail on Sheet C2
- ⑨ Concrete Stairs per detail on Sheet C2
- ⑩ Trash enclosure per details on Sheet C3
- ⑪ ADA Ramp per details on Sheet C4
- ⑫ Curb Ramp per Calltrans Strds.
- ⑬ 8-ft. High Vinyl Clad Chain Link Fence per detail sheet C3

SITE CONCRETE INFORMATION

- Contractor to install site concrete per various details on Sheet C2 and the following:
1. Concrete walks / plaza concrete to be Wash-off Finish Colored Concrete, Davis Color: Pebble, Mix Rate of .5 lbs. of 641 per 94 lbs. (1cuft.) of type II Cement
 2. Tot-lot surface to be xxxxxxx

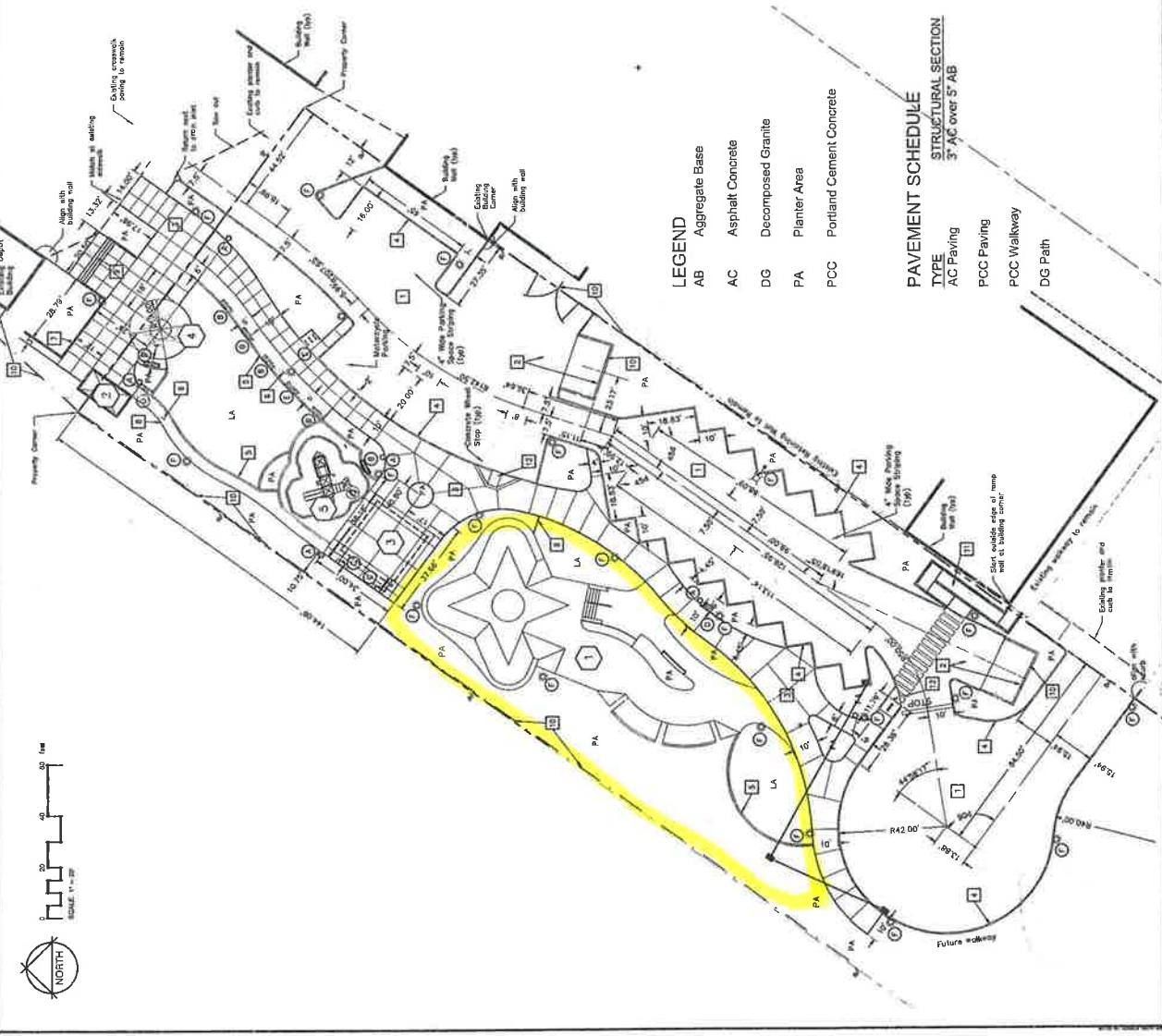

LEGEND

- AB Aggregate Base
- AC Asphalt Concrete
- DG Decomposed Granite
- PA Planter Area
- PCC Portland Cement Concrete

PAVEMENT SCHEDULE

- STRUCTURAL SECTION
 3" AC over 5" AB
- AC Paving
 - PCC Paving
 - PCC Walkway
 - DG Path