

THE VILLAGE AT LOOMIS GENERAL PLAN AMENDMENT TOWN OF LOOMIS, CALIFORNIA

JULY 2017

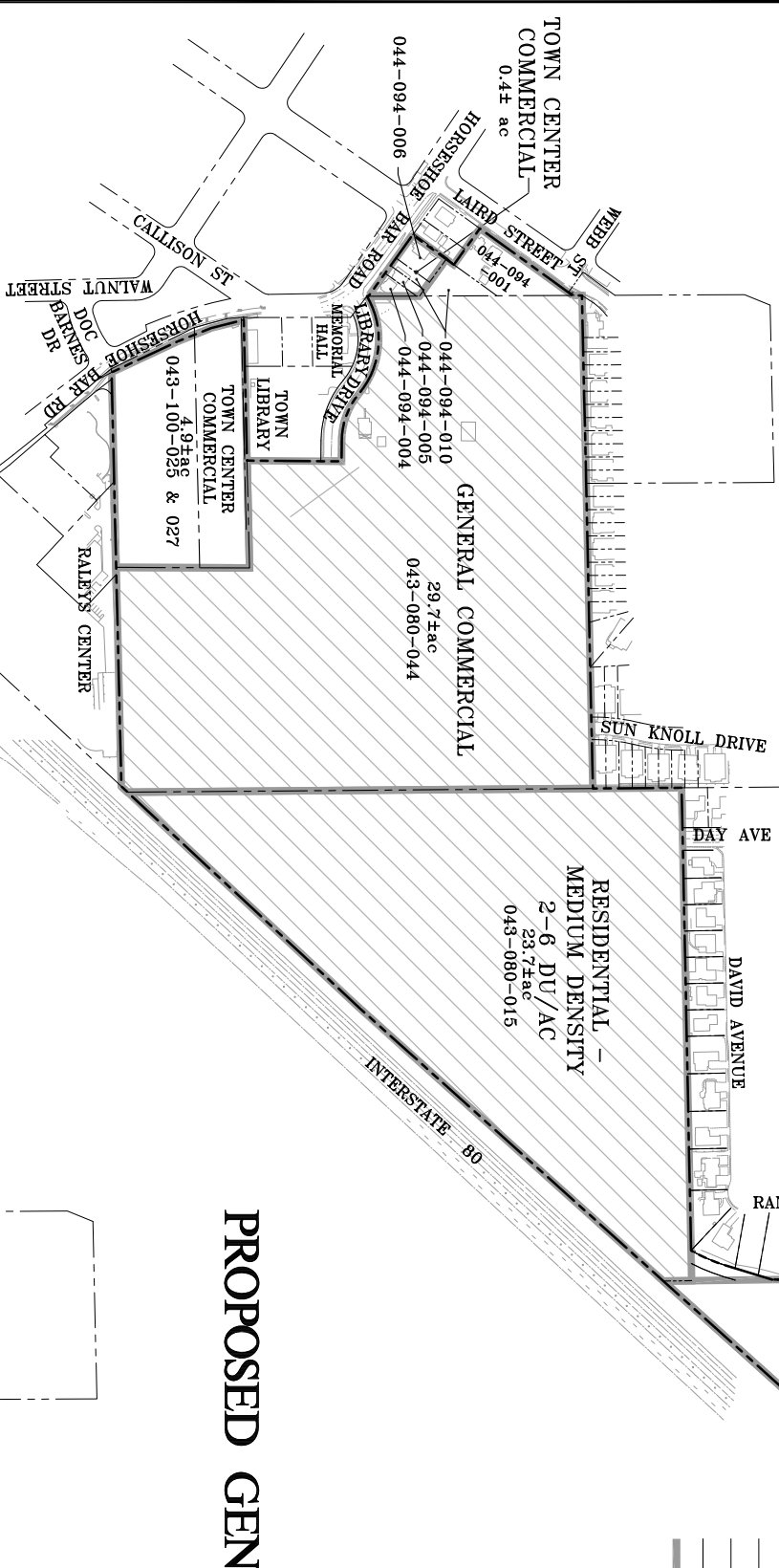

EXISTING GENERAL PLAN



EXISTING GP DESIGNATIONS

GENERAL PLAN DESIGNATION	ACREAGE
RESIDENTIAL-MEDIUM DENSITY	23.7±
GENERAL COMMERCIAL - SPECIFIC AREA 2	29.7±
TOWN CENTER COMMERCIAL	5.3±
OFFICE PROFESSIONAL	7.8±
TOTALS	66.5±

RESIDENTIAL - HIGH DENSITY OVERLAY

PROPOSED GENERAL PLAN

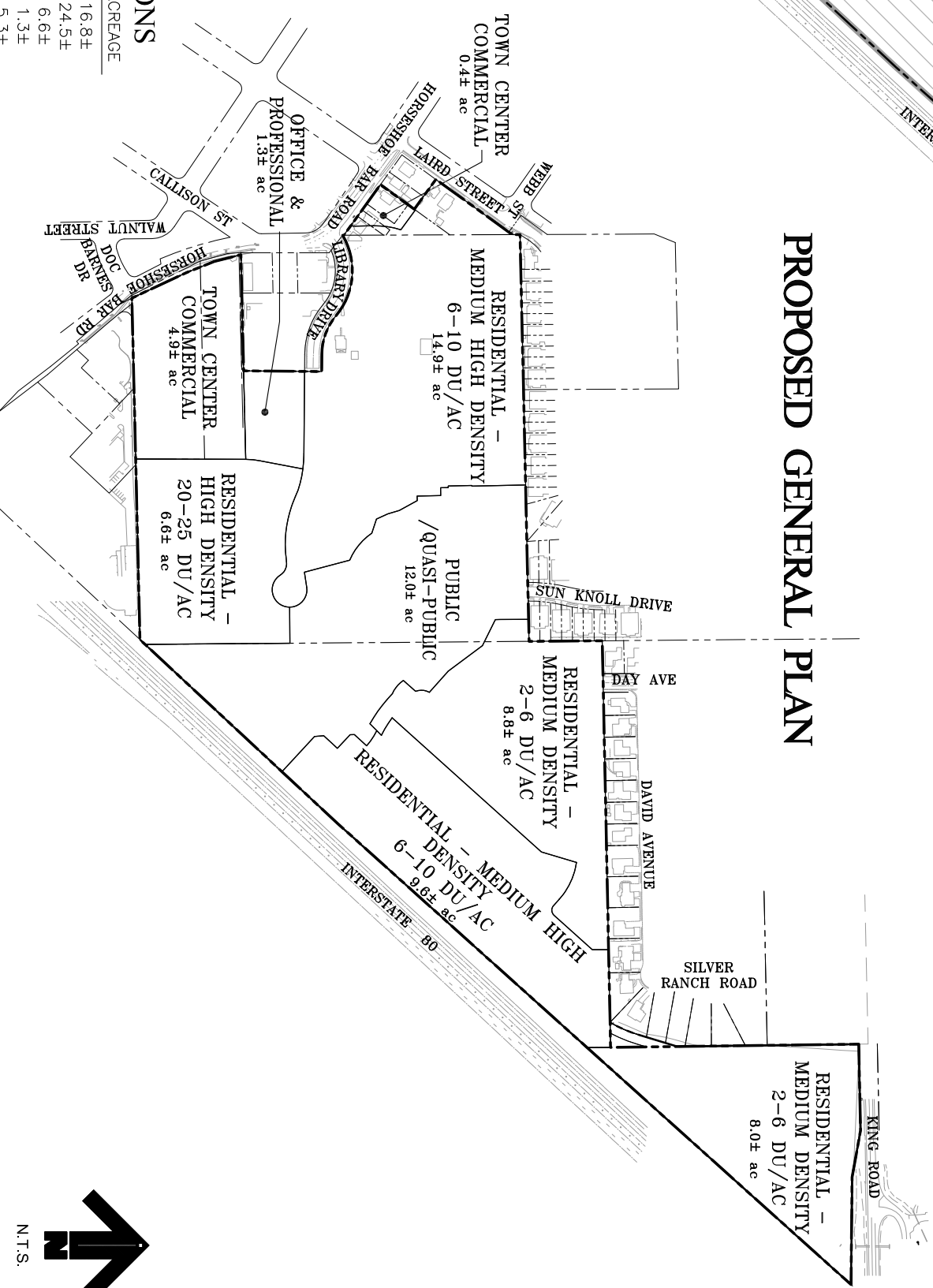

PROPOSED GP DESIGNATIONS

GENERAL PLAN DESIGNATION	ACREAGE
RESIDENTIAL-MEDIUM DENSITY	16.8±
RESIDENTIAL-MEDIUM HIGH DENSITY	24.5±
RESIDENTIAL HIGH DENSITY-20	6.6±
OFFICE AND PROFESSIONAL	1.3±
TOWN CENTER COMMERCIAL	5.3±
PUBLIC/QUASI-PUBLIC	12.0±
TOTALS	66.5±

LEGEND

- PROJECT BOUNDARY
- ADJACENT EXISTING LOT LINES
- R/W - EXISTING
- PARCEL LINES - EXISTING
- GENERAL PLAN DESIGNATION BOUNDARY

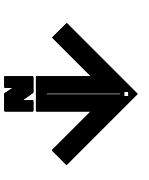

N.T.S.

