

STAFF REPORT
COUNCIL MEETING OF SEPTEMBER 14, 2010
BUSINESS ITEM

TO: HONORABLE MAYOR AND MEMBERS OF THE TOWN COUNCIL

FROM: BRIAN FRAGIAO, DIRECTOR OF PUBLIC WORKS/TOWN ENGINEER



DATE: SEPTEMBER 1, 2010

SUBJECT: LOOMIS MONUMENT PROPOSAL

RECOMMENDATION:

Discuss and direct.



BACKGROUND:

The Town has been approached by Brent Ludlow a senior at Del Oro Highschool to construct a Loomis entry monument. Attached are several concepts that Brent has drawn. Here are several locations that the monument could be constructed:

- 1. Taylor Road, south of King Road – Downtown Master Plan Location
- 2. Taylor Road, north of Sierra College – Downtown Master Plan Location
- 3. Sierra College Blvd., north of Granite Drive – In new Landscape median
- 4. Downtown Park

Monument costs are being developed at this time.

FINANCIAL AND/OR POLICY IMPLICATIONS:

None at this time.

Alt top. to prev.



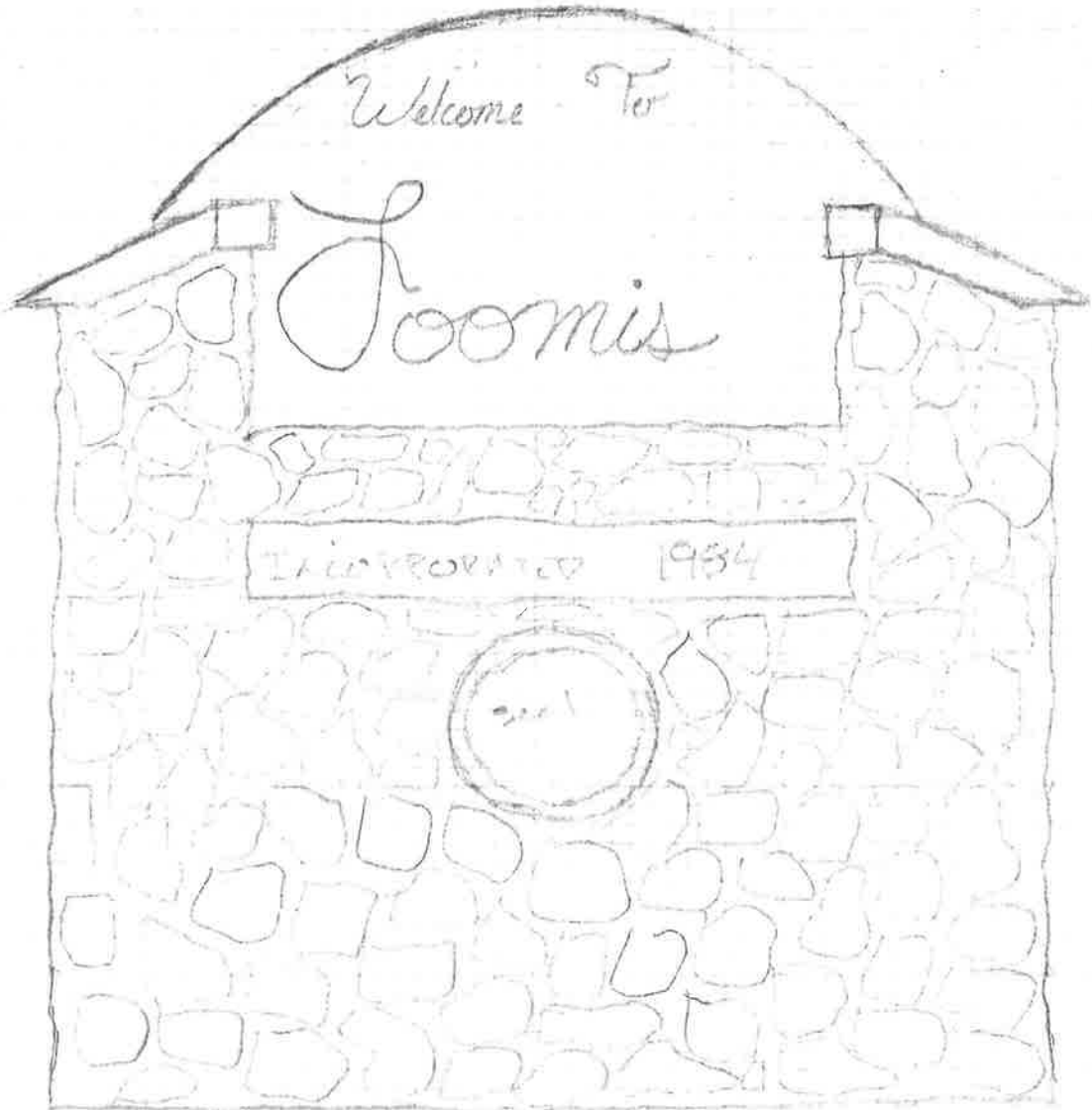

H →

W



WELCOME TO LOOMIS



A small town
is like a big family.

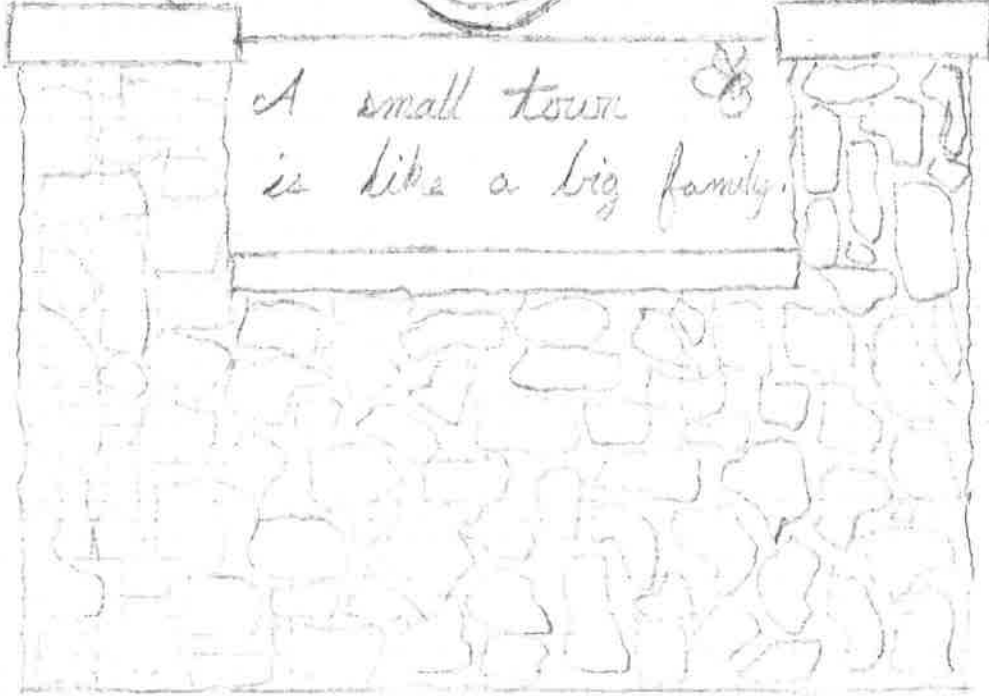

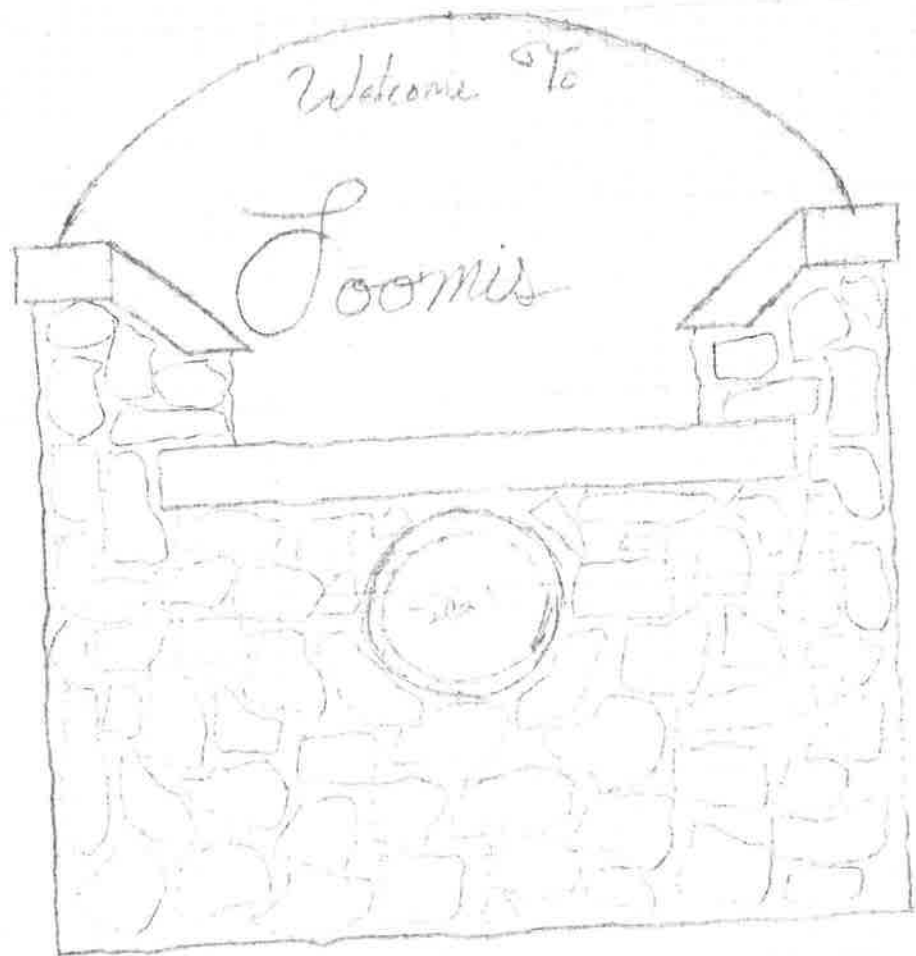



Welcome To

Loomis

Incorporated 1984



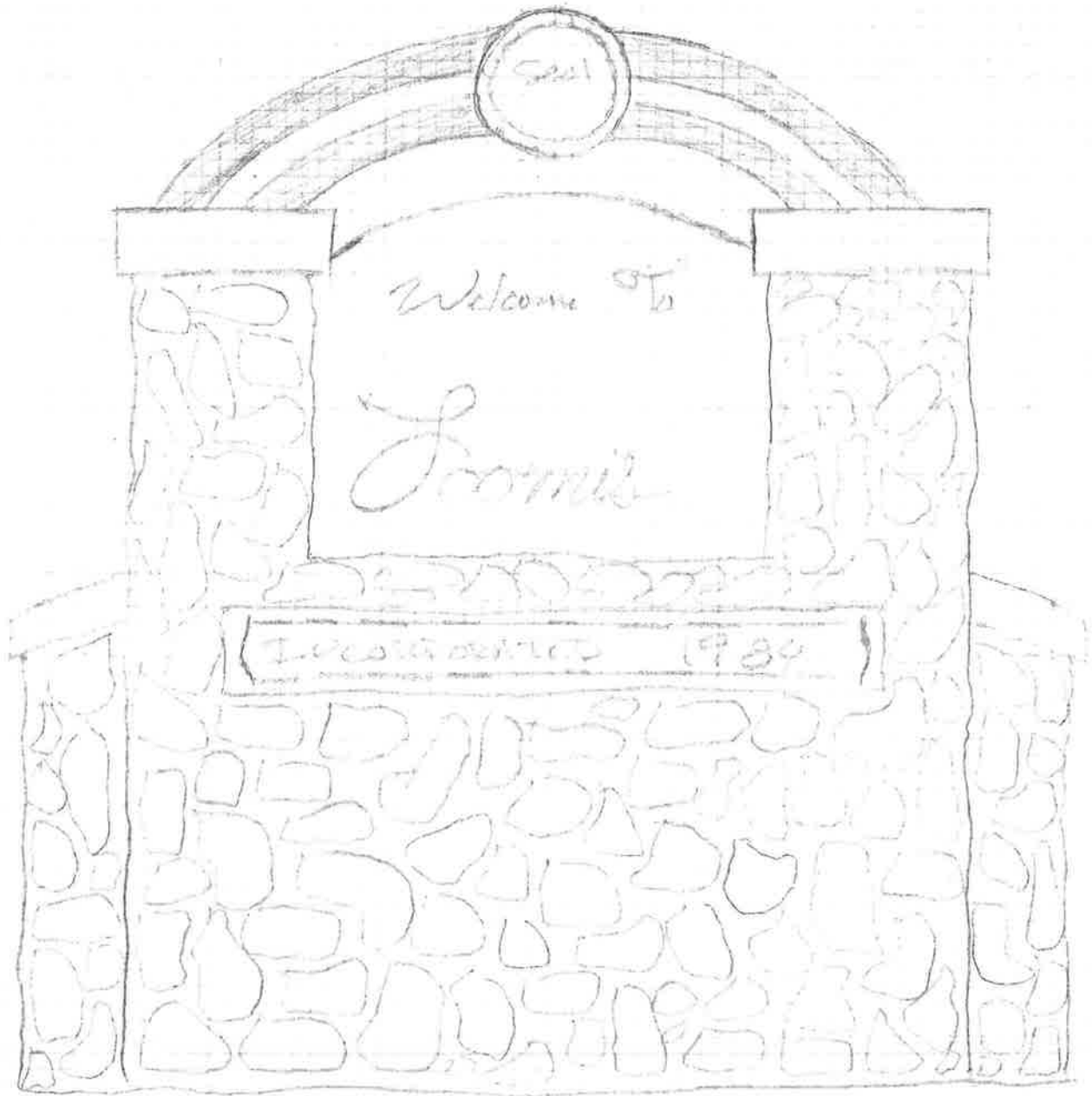

Sail

Welcome To

Loomis

ESTABLISHED 1984

FIGURE 3.5 - EAST GATEWAY CONCEPT PLAN

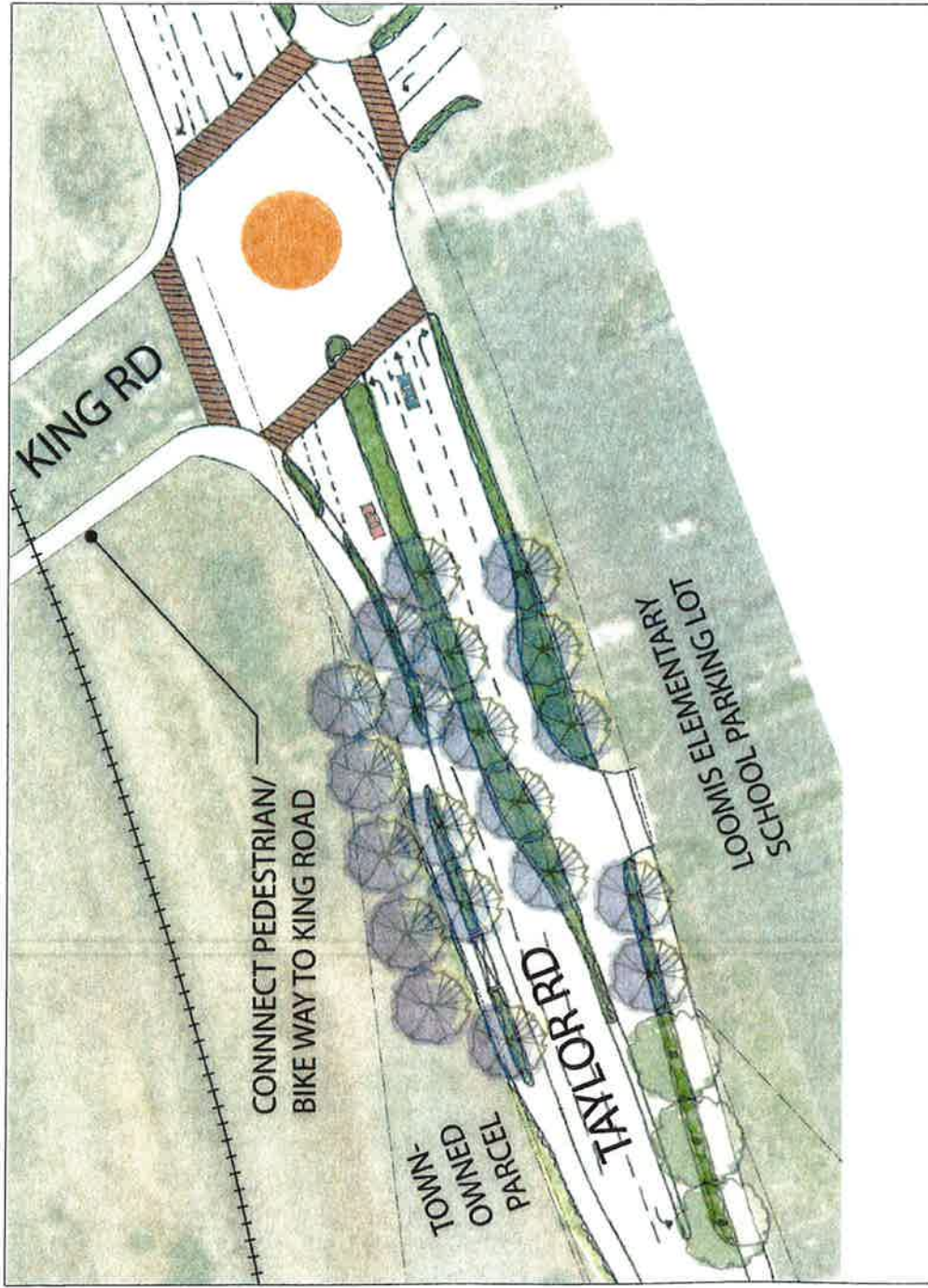

- Crosswalks
- Gateways
- Pocket Plazas
- Deciduous Tree
- Evergreen Tree
- Specimen Tree
- Gateway Flowering Orchard Tree

FIGURE 3.25 - WEST GATEWAY CONCEPT PLAN

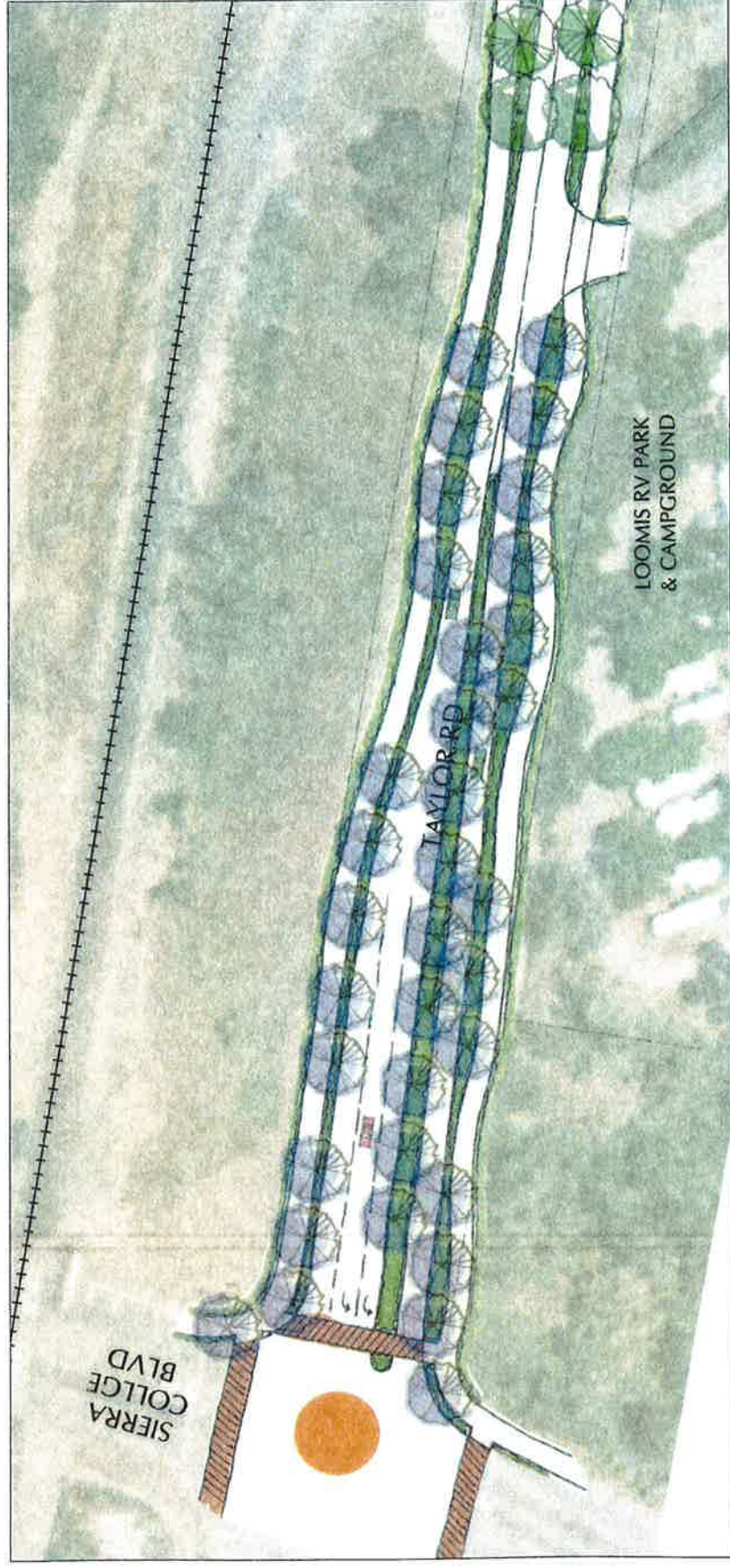
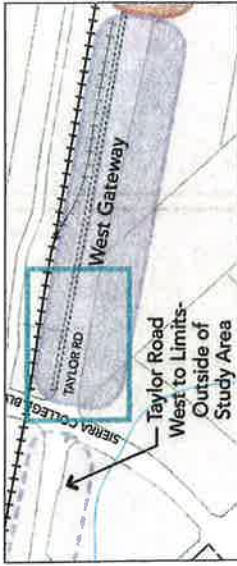

- Crosswalks
- Gateways
- Pocket Plazas
- Deciduous Tree
- Evergreen Tree
- Gateway Flowering Orchard Tree
- Specimen Tree

9] PLUGS JOINED TO REM

10] CAUTION: APPROXIMATE LOCATION TO FIELD VERIFY EXACT LOCATION

045-041-016
(Hanzlick)



F
TC
FL
CITY LIMIT

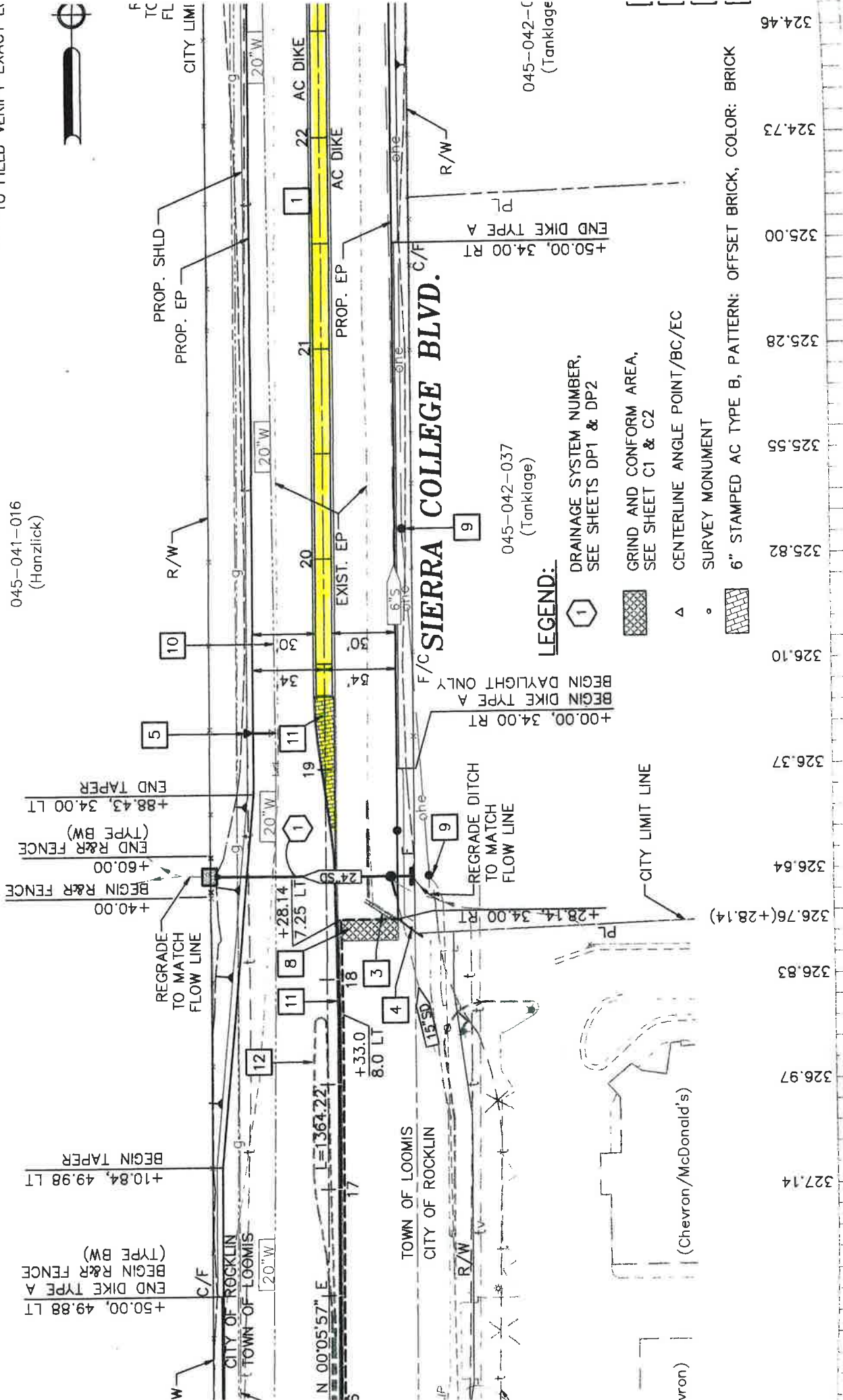

SIERRA COLLEGE BLVD.

045-042-037
(Tanklage)

045-042-C
(Tanklage)

LEGEND:

1] DRAINAGE SYSTEM NUMBER, SEE SHEETS DP1 & DP2

2] GRIND AND CONFORM AREA, SEE SHEET C1 & C2

4] CENTERLINE ANGLE POINT/BC/EC

5] SURVEY MONUMENT

6] STAMPED AC TYPE B, PATTERN: OFFSET BRICK, COLOR: BRICK

+50.00, 34.00 RT
END DIKE TYPE A
PL

+00.00, 34.00 RT
BEGIN DIKE TYPE A
BEGIN DAYLIGHT ONLY
F/C

+28.14, 34.00 RT
REGRADE DITCH
TO MATCH
FLOW LINE
PL

+88.43, 34.00 LT
END TAPER
END R&R FENCE
(TYPE BW)
+60.00
BEGIN R&R FENCE
+40.00

+50.00, 49.88 LT
END DIKE TYPE A
BEGIN R&R FENCE
(TYPE BW)
+10.84, 49.98 LT
BEGIN TAPER

326.76(+28.14)

326.83

326.97

327.14

327.28

327.42

327.56

327.70

327.84

327.98

328.12

328.26

328.40

328.54

328.68

328.82

328.96

329.10

329.24

329.38

329.52

329.66

329.80

329.94

330.08

330.22

330.36

330.50

330.64

330.78

330.92

331.06

331.20

331.34

331.48

331.62

331.76

331.90

332.04

332.18

332.32

332.46

(Chevron/McDonald's)

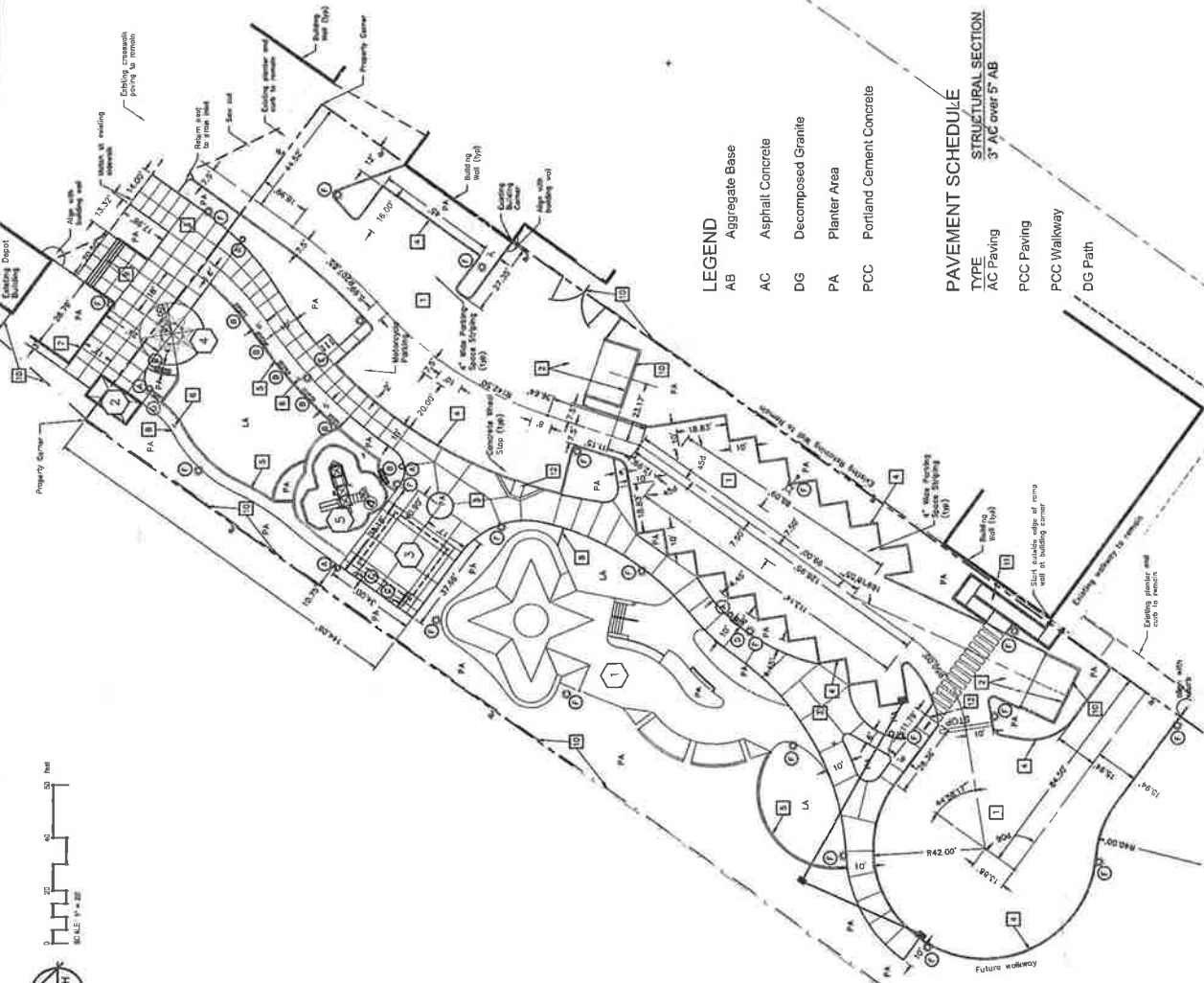

SITE FURNITURE LEGEND

- 1 TRASH CONTAINER (see sheet C5 for detailed model / spec. information)
- 2 6-FT. BENCH (see sheet C5 for detailed model / spec. information)
- 3 BBQ (see sheet C5 for detailed model / spec. information)
- 4 DRINKING FOUNTAIN (see sheet C3 and C5 for detailed model / spec. information)
- 5 BIKE RACK (see sheet C5 for detailed model / spec. information)
- 6 SITE LIGHTING: See sheet xx for electrical plans, and schedules.

SITE STRUCTURE INFORMATION

- Contractor to provide ADD ALTERNATE bid prices for the following park elements (see also Sheet C5 for more information):
- 1 SKATE FACILITY: See Skate ("SK") sheets for details and layout information.
 - 2 RESTROOM FACILITY: Contractor to coordinate / build structure, prepare pad per grading plan and provide mechanical / plumbing / electrical as indicated on the utility plans and electrical plans within this set of plans
 - 3 SHADE STRUCTURE: Contractor to install per manufacturer's specification. See Electrical plans to coordinate electrical issues.
 - 4 WATER PLAY SPRAY PAD: Contractor to install spray nozzles, drainage, mechanical and electrical per other plans located in this set, and per manufacturer's specification / design build plans.
 - 5 TOT-LOT STRUCTURES/ AMENITIES: install equipment and surface per manufacturer's specifications.

---SITE FURNITURE: Contractor to install benches, trash receptacles, drinking fountains and bike racks.

KEYED NOTES

- 1 AC paving
- 2 PCC paving
- 3 PCC walkway
- 4 Type 5 barrier curb per Town of Loomis std drawing H-2.
- 5 Mow curb per detail on sheet C2
- 6 DG path per detail on sheet C2
- 7 Planter Curb Per detail on sheet C2
- 8 Plastic Header Board per detail on Sheet C2
- 9 Concrete Stairs per detail on Sheet C2
- 10 Trash enclosure per details on Sheet C3
- 11 ADA Ramp per details on Sheet C4
- 12 Curb Ramp per Calltrans Stnds.
- 13 8-ft. High Vinyl Clad Chain Link Fence per detail sheet C3

SITE CONCRETE INFORMATION

- Contractor to install site concrete per various details on Sheet C2 and the following:
- 1. Concrete walks / plaza concrete to be Wash-off Finish Colored Concrete, Davis Color: Pebble, Mix Rate of .5 lbs. of 641 per 94 lbs. (1cuft.) of type II Cement
 - 2. Tot-lot surface to be xxxxxxx

PAVEMENT SCHEDULE
STRUCTURAL SECTION
3" AC over 5" AB

- TYPE
AC Paving
PCC Paving
PCC Walkway
DG Path

- LEGEND**
- AB Aggregate Base
 - AC Asphalt Concrete
 - DG Decomposed Granite
 - PA Planter Area
 - PCC Portland Cement Concrete

REVISIONS

NO.	DESCRIPTION	DATE

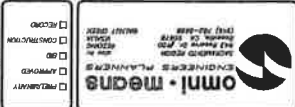

LAYOUT PLAN
Park Improvement Plans
DOWNTOWN PARK
Town of Loomis, California

L1

X of 8