

VICINITY MAP
NO SCALE

OWNER / DEVELOPER:

MORTON & PITALO, INC.
1500 TAYLOR ROAD
SACRAMENTO, CA 95815
OFFICE: (916) 452-2000
PHONE: (916) 452-2000
FAC: (916) 452-2000
ALT: DAVE BENTON

CIVIL ENGINEER:

MORTON & PITALO, INC.
1500 TAYLOR ROAD
SACRAMENTO, CA 95815
OFFICE: (916) 452-2000
PHONE: (916) 452-2000
FAC: (916) 452-2000
ALT: DAVE BENTON

LANDSCAPE ARCHITECT:

CALIFORNIA ARCHITECTS PC
250 COUNTY LANE
ALHAMBRA, CA 91801
PHONE: (626) 447-7111
ALT: JOSE DIAZ

PROJECT INFO:

LAND USE: EXISTING (CA: GENERAL COMMERCIAL)
PROJECT NAME: MORTON & PITALO
APN: 043-014-011

PARKING REQUIREMENTS: FURNITURE STORE

1 SPACE FOR EACH 200 SF OF FLOOR DISPLAY AREA FOR THE FIRST 1,000 SF. 1 SPACE FOR EACH LINE OF 50' FLOOR DISPLAY AREA OVER 1,000 SF. 1 SPACE FOR EACH 1,000 SF OF OUTDOOR DISPLAY AREA.
PARKING SPACES REQUIRED: 11 (200 SF) / 1,000 SF / 50' x 20' SPACES REQUIRED: 1000 SF / 1,000-1 SPACE REQUIRED
OUTDOOR DISPLAY AREA: 8' x 11' SPACES REQUIRED
TOTAL REQUIREMENTS: 77 SPACES
TOTAL SPACES PROVIDED: 42
THIRTY-ONE (31) VEHICLES REQUIRED
21 BICYCLES

SUMMARY TABLE

UTILITY	COMPANY	CONTACT	PHONE
CABLE TV	COMCAST		(916) 434-8000
ELECTRICITY	PG&E		(916) 434-8000
GAZ	PG&E		(916) 434-8000
TELEPHONE	ATT	JAY JOHNSON	(916) 434-1378
SEWER	TOWN OF LOOMIS	BRIAN DUNN	(916) 434-1340
PLUMBING	PLUMBING PROFESSIONAL DISTRICT	MICHAEL HICKS	(916) 434-2288
TRUCK	PLACER COUNTY EMERGENCY SERVICES	HEATHER SULLIVAN	(530) 888-4887
WATER	PLACER COUNTY WATER AGENCY	HOWARD WIRTH	(530) 827-4888
WATER	SUBSTATION SERVICE ALERT		(916) 227-2800

UTILITY REPRESENTATIVES

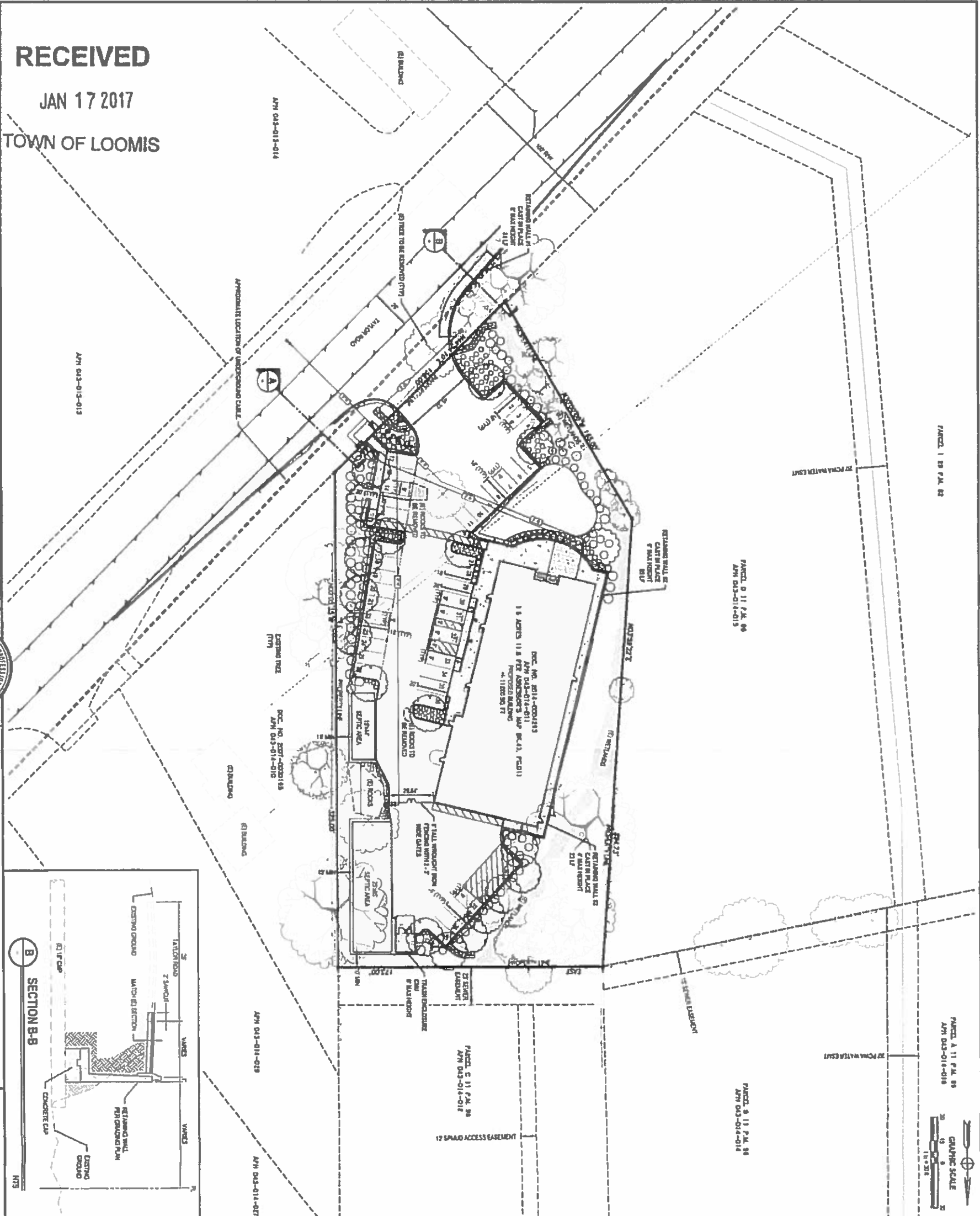
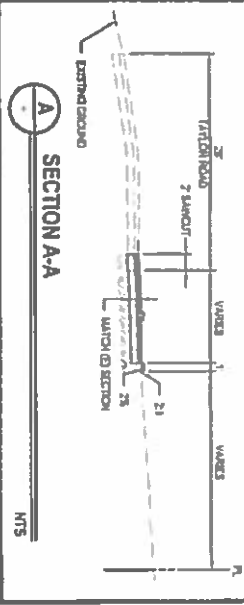
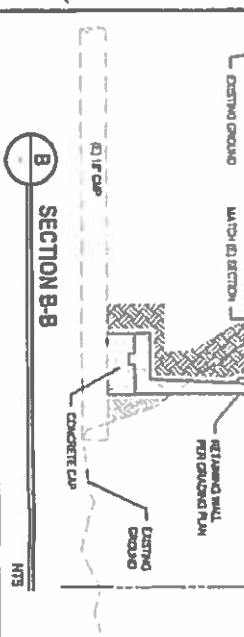

RECEIVED
JAN 17 2017
TOWN OF LOOMIS

SCALE	HORIZ. 1" = 40'	VERT. 1" = 4'
BENCH MARK	EL. = 418.88	
COMPILED	LM	
DESIGNED	LM	
DRAWN	PSJ	
PROJ. ENGR.	LM	



MORTON & PITALO, INC.
CIVIL ENGINEERING • LAND PLANNING • LAND SURVEYING
Folsom • Sacramento • Fresno
21 Fort Point Road, Suite #100
Folsom, CA 95630
Phone: (916) 984-7231
www.morton-pitalo.com

3264 TAYLOR ROAD
SITE PLAN
TOWN OF LOOMIS, CALIFORNIA

DATE	JANUARY 18, 2017
SHEET	SP1
OF	1

RECEIVED
 JAN 17 2017
 TOWN OF LOOMIS

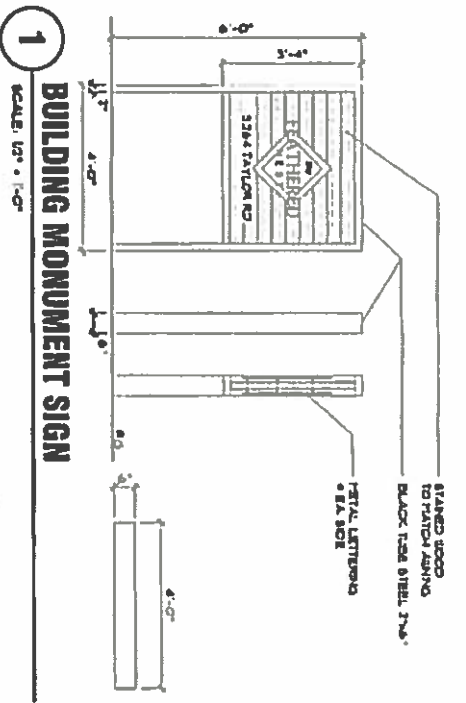

1 BUILDING MONUMENT SIGN
 SCALE: 1/2" = 1'-0"

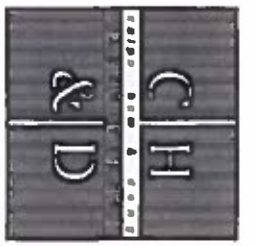

CH&D CONSULTANTS
 5150 18TH STREET, SUITE 200
 SACRAMENTO, CALIFORNIA 95833
 (916) 486-1111
 www.chand.com

PROJECT
 3264 TAYLOR ROAD
 LOOMIS, CA 95763

3284 TAYLOR ROAD
 LOOMIS, CA 95763
 SHEET 11111
SITE PLAN

The contractor shall verify and be responsible for all dimensions and conditions on the job and the utility and the location of any existing structures, lines, and other features shown on the drawings and indicated on the ground. The contractor shall verify and be responsible for all dimensions and conditions on the job and the utility and the location of any existing structures, lines, and other features shown on the drawings and indicated on the ground. The contractor shall verify and be responsible for all dimensions and conditions on the job and the utility and the location of any existing structures, lines, and other features shown on the drawings and indicated on the ground.

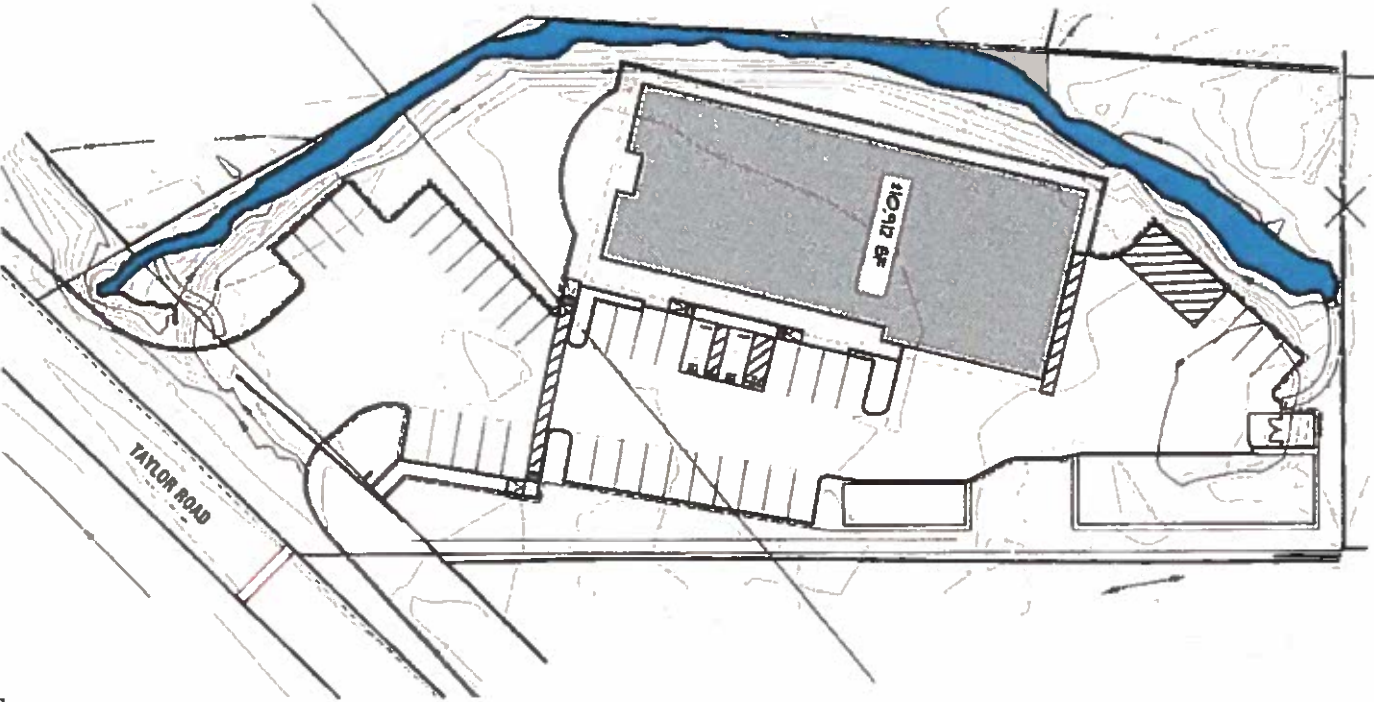

SITE PLAN - TOPOGRAPHY
 SCALE: 1/2" = 1'-0"

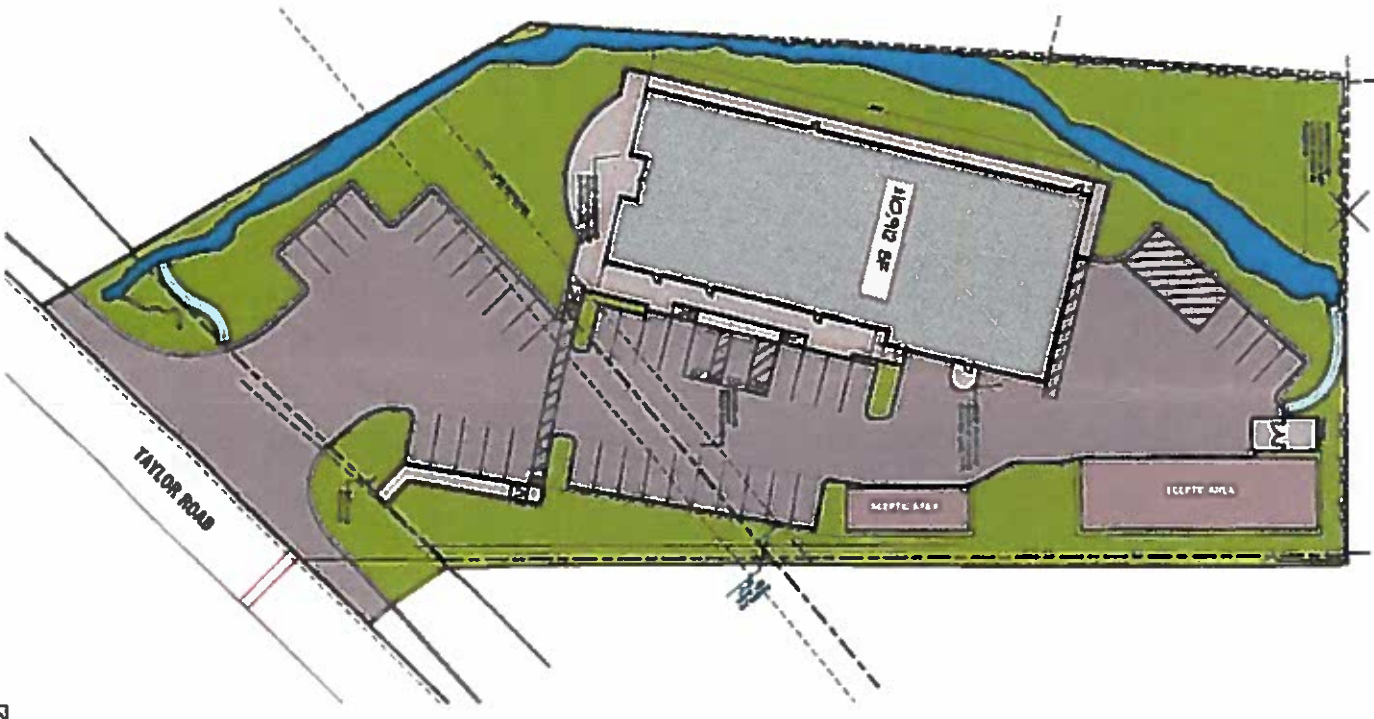

SITE PLAN
 SCALE: 1/2" = 1'-0"

NO.	DATE	DESCRIPTION
1	01/17/17	ISSUED FOR PERMITS
2	01/17/17	ISSUED FOR PERMITS
3	01/17/17	ISSUED FOR PERMITS
4	01/17/17	ISSUED FOR PERMITS
5	01/17/17	ISSUED FOR PERMITS
6	01/17/17	ISSUED FOR PERMITS
7	01/17/17	ISSUED FOR PERMITS
8	01/17/17	ISSUED FOR PERMITS
9	01/17/17	ISSUED FOR PERMITS
10	01/17/17	ISSUED FOR PERMITS

A1.1
 SHEETS

