

ORIGINAL PLOT DATE: ONE DAY

FOR REDUCED PLANS, THE ORIGINAL SCALE IS IN INCHES

3
2
1
0
1
2
3
FOR REDUCED PLANS, THE ORIGINAL SCALE IS IN INCHES

Path: I:\004 Municipal Services\Projects\Project Management - Storm Drain\Projects\Magnolia-Cowdng Layout Name: Layout Plot Date Feb 17, 2023 at 02:46 pm

PROJECT PLANS FOR : TOWN OF LOOMIS MAGNOLIA STREET STORM DRAIN REPLACEMENT

FEBRUARY 2023

FOR THE TOWN OF LOOMIS PLACER COUNTY, CALIFORNIA

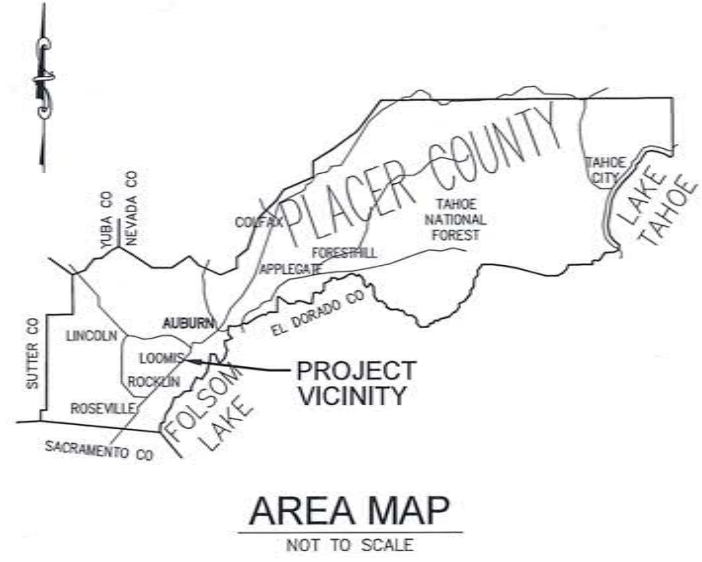

AREA MAP
NOT TO SCALE

ABBREVIATIONS

| | |
|------|---------------------------|
| CMP | CORRUGATED METAL PIPE |
| (N) | NEW |
| (E) | EXISTING |
| DR17 | DIMENSION RATION 17 |
| HDPE | HIGH DENSITY POLYETHYLENE |



LOCATION MAP
NOT TO SCALE

INDEX OF SHEETS

| No. | Sheet Title |
|-----|------------------|
| 1 | TITLE SHEET |
| 2 | STORM DRAIN PLAN |
| 3 | DETAILS |

COASTLAND | DCCM
11641 Blocker Dr, Ste 170, Auburn, CA 95603
530.888.9929 530.889.9979 Fax

Laurie M. Loiza
LAURIE M. LOAIZA, RCE 65951 02/16/2023 DATE



BID SET
DATE: FEBRUARY 16, 2023

TOWN OF LOOMIS
APPROVED DATE 2/17/23
Mark Se
TOWN ENGINEER

| | |
|----------------|---------------|
| PROJECT NUMBER | 65-4923 |
| DRAWING DATE | FEBRUARY 2023 |
| DRAWING NUMBER | 1 OF 3 |

TOWN OF LOOMIS MAGNOLIA STREET STORM DRAIN REPAIR PROJECT

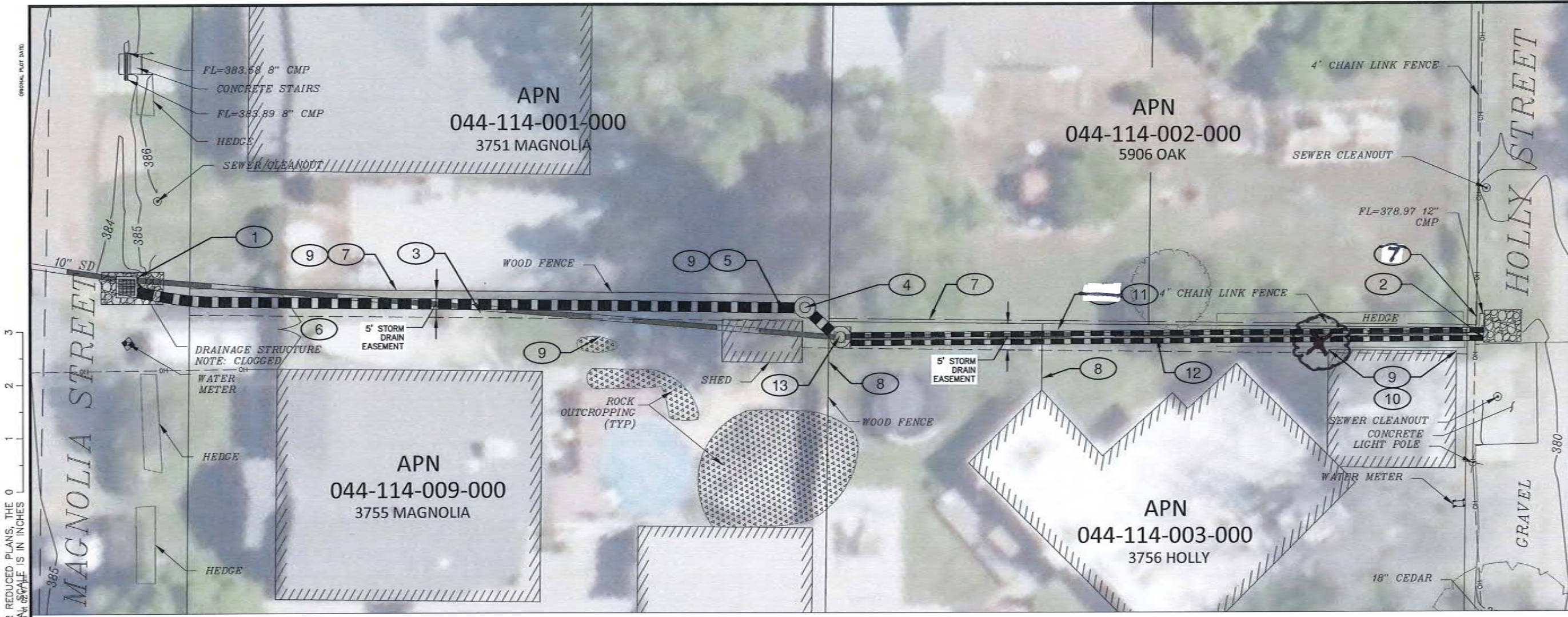

ORIGINAL PLOT DATE: 02/16/2023
 FOR REDUCED PLANS, THE 0 SCALE IS IN INCHES
 385
 386
 384
 385
 386

Xrefs: XR-TOPD.dwg; XR-Titled.dwg; CCE-ENGINEERS STAMPS-PLAN.dwg
 Images: Laurie-19.dwg
 Paths: T:\004_Municipal_Services\Loomis\Project_Management - Storm_Drain\Projects\Magnolia\Submittal\SP-DETAILS.dwg Layout Items: 2 Plot Date: Feb 16, 2023 10:57 AM

- CONSTRUCTION NOTES**
- 1 STRUCTURE #1 - REMOVE EXISTING STRUCTURE AND INSTALL NEW 36"x36" PRECAST CONCRETE CATCH BASIN WITH GRATED COVER AND RISER IF NECESSARY PER DETAIL 1 ON SHEET 3. GROUT CONNECTIONS TO (E) 10" PIPE AND (N) 18" PIPE WITH NON-SHRINK GROUT. PLACE STRUCTURE AS FAR SOUTH AS POSSIBLE. PLACE CLASS 8 GEOTEXTILE FABRIC AND 2 CUBIC YARDS OF CLASS 1 (6") RSP IN ACCORDANCE WITH SECTION 72 OF THE CALTRANS STANDARD SPECIFICATIONS.
 - 2 STRUCTURE #3 - CULVERT OUTFALL PER DETAIL 2 ON SHEET 3. FLOW LINE TO BE HIGHER THAN EXISTING TO FACILITATE DRAINAGE TO STREET.
 - 3 REMOVE (E) 12" CMP AND INSTALL APPROXIMATELY 130 LF OF (N) 18" DR17 HDPE PIPE SHALL BE LAID AT CONSISTENT SLOPE BASED ON INVERT AT STRUCTURE #1 AND INVERT AT OUTFALL. CONTRACTOR SHALL MEASURE INVERTS, CALCULATE PIPE SLOPE, AND OBTAIN ENGINEER'S APPROVAL BEFORE COMMENCEMENT OF WORK. CONTRACTOR TO VERIFY AT COMMENCEMENT OF CONSTRUCTION THAT A MINIMUM PIPE COVER OF 12" CAN BE MAINTAINED. NOTIFY ENGINEER IMMEDIATELY OF ANY DISCREPANCIES.
 - 4 STRUCTURE #2 - INSTALL NEW 48" MANHOLE PER TOWN STANDARD DETAIL SD-23 (DETAIL 3 ON SHEET 3). INVERT OF MH TO BE ESTABLISHED BASED ON APPROVED PIPE SLOPE.
 - 5 PROTECT IN PLACE (E) SHED (TO REMAIN).
 - 6 PROTECT IN PLACE (E) DOUBLE CHAIN LINK GATE (TO REMAIN). IF GATE NEEDS TO BE REMOVED TO FACILITATE CONSTRUCTION, CONTRACTOR TO PRESERVE AND REINSTALL IN SAME LOCATION. **OR CHAIN LINK**
 - 7 PROTECT IN PLACE EXISTING WOOD FENCE. BRACE AS NECESSARY.
 - 8 REMOVE (E) FENCE AS NECESSARY AND RESTORE TO ORIGINAL CONDITIONS OR BETTER.
 - 9 NOTE: LIMITED WORKING SPACE DUE TO OBSTRUCTIONS.
 - 10 REMOVE EXISTING TREE AND VEGETATION ADJACENT TO CAR PORT.
 - 11 PLACE GRASS SEED AND COVER WITH PEAT MOSS WITHIN EXISTING GRASS AREAS DISTURBED UPON COMPLETION OF TRENCH.

- 12 REMOVE (E) 12" CMP AND INSTALL APPROXIMATELY 120 LF OF (N) 2-12" DR17 HDPE PIPE SHALL BE LAID AT 6" SEPARATION OD TO OD. PIPE SHALL BE LAID AT CONSISTENT SLOPE BASED ON INVERT AT UPSTREAM STRUCTURE AND INVERT AT OUTFALL. CONTRACTOR SHALL MEASURE INVERTS, CALCULATE PIPE SLOPE, AND OBTAIN ENGINEER'S APPROVAL BEFORE COMMENCEMENT OF WORK. CONTRACTOR TO VERIFY AT COMMENCEMENT OF CONSTRUCTION THAT A MINIMUM PIPE COVER OF 12" CAN BE MAINTAINED. NOTIFY ENGINEER IMMEDIATELY OF ANY DISCREPANCY.
 - 13 STRUCTURE #4: REMOVE EXISTING STRUCTURE AND INSTALL NEW 36" X36" PRECAST CONCRETE CATCH BASIN WITH SOLID COVER PER DETAIL 1 ON SHEET 3. GROUT CONNECTION TO (N) 18" PIPE AND N 2-12" WITH NON-SHRINK GROUT. INVERT OF TO BE ESTABLISHED BASED ON APPROVED PIPE SLOPE.
- GENERAL NOTES:**
1. TRIM TREES AS NECESSARY FOR LATERAL & VERTICAL CLEARANCE WITH APPROVAL AND OBSERVATION OF ENGINEER.
 2. NO FIELD SURVEY WAS PERFORMED FOR THIS PROJECT. ALL INFORMATION IS APPROXIMATE. CONTRACTOR SHALL VERIFY ALL INFORMATION IN FIELD.
 3. NO GEOTECHNICAL INVESTIGATION WAS PERFORMED.
 4. THE EXTENT OF ROCK EXCAVATION IS UNKNOWN. UNFORESEEN ROCK EXCAVATION TO BE PAID BY CHANGE ORDER.
 5. NO UNDERGROUND UTILITY INFORMATION IS SHOWN.
 6. TEMPORARY FENCING IS REQUIRED TO SECURE REAR YARDS FROM PASSAGE OF PEOPLE AND PETS.
 7. CONTRACTOR TO COORDINATE THE RELOCATION AND REMOVAL OF PRIVATE PROPERTY WITH PROPERTY OWNER AS NEEDED FOR CONSTRUCTION ACTIVITIES.

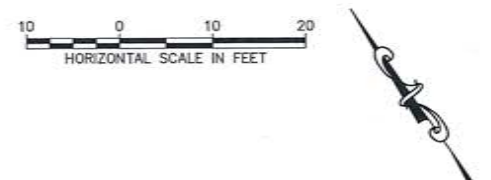

TOWN OF LOOMIS
MAGNOLIA STREET STORM DRAIN REPAIR

STORM DRAIN PLAN
MAGNOLIA STREET TO HOLLY STREET

PROJECT NUMBER
65-4923

DRAWING DATE
FEBRUARY 2023

SHEET NUMBER
2 OF **3**

CALIFORNIA

COASTLAND | DCCM

DESIGNED BY: DRG/LML
 DRAWN BY: ERG
 REVIEWED BY: LML/DHS
 PREPARED UNDER THE DIRECTION OF: ERG/LML

Laurie M. Loatza
 Laurie M. Loatza, RCE 65951 DATE: 02/16/2023
 CIVIL ENGINEER
 PROFESSIONAL ENGINEER EXPIRES 02/16/2025
 11641 Blocker Dr, Ste 170, Auburn, CA 95803
 530.868.9979 Fax
 530.868.9929

Laurie M. Loatza
 No. 65951
 CIVIL ENGINEER
 PROFESSIONAL ENGINEER EXPIRES 02/16/2025
 11641 BLOCKER DR, STE 170, AUBURN, CA 95803
 530.868.9979 FAX
 530.868.9929

Xrefs: XR-TOPD.dwg; XR-TiltBlock.dwg; CCE-ENGINEERS STAMPS-PLAN.dwg
 Image: Laird-49.jpg
 Path: T:\004 Municipal Services\Loomis\Project Management - Storm Drain\Projects\Magnolia\Detail\SP-DETAILS.dwg Layout: Name: 3 Plot Date: 02/16/2023 08:47 AM
 FOR REDUCED PLANS, THE ORIGINAL SCALE IS IN INCHES

Heavy Duty Grate :
 Weight : 380 Lbs.
 Open Area 651 Sq. Inches

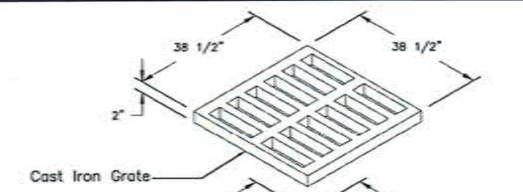

6" Riser W/ Frame
 Weight : 510 Lbs.

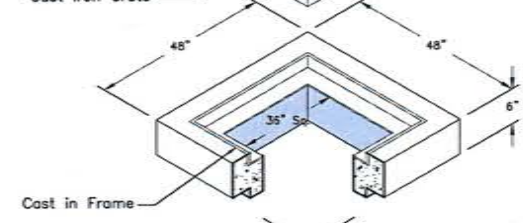

Risers

Weight : See Chart

| Extension | Weight (Lbs.) |
|-----------|---------------|
| 8" | 475 |
| 12" | 1000 |

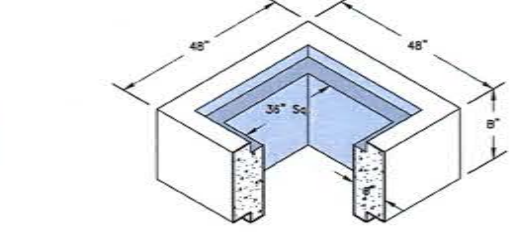

Bottom :

Weight : See Chart

| Bottom | Weight (Lbs.) |
|--------|---------------|
| 4-Way | 2,550 |

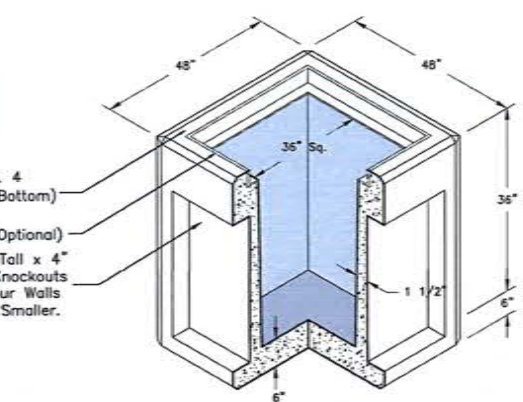

1" Chamfer (TYP. 4 Corners, Top & Bottom)
 Cast in Frame (Optional)
 36" Wide x 36" Tall x 4" Deep Thin-wall Knockouts Typical on all Four Walls For 24" RCP or Smaller.

NOTES:

- CONTRACTOR SHALL PROVIDE PRODUCT SUBMITTAL FOR CATCH BASIN AND COVER TO TOWN ENGINEER FOR APPROVAL.
- SEAL CONNECTIONS BETWEEN PIPE AND STRUCTURE WITH NON SHRINK GROUT.
- USE SOLID LID WHERE SPECIFIED ON PLANS.

36"X36" CATCH BASIN

SCALE: NTS

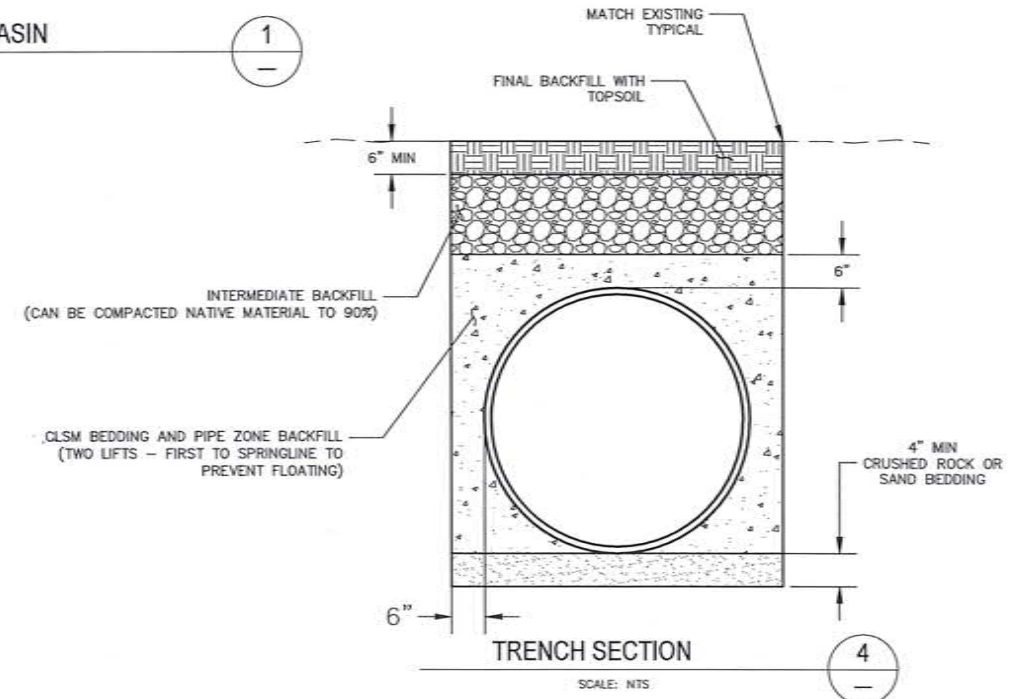

TRENCH SECTION

SCALE: NTS

PLACE 12" STAINLESS STEEL ANIMAL GUARD. SEE NOTE 2.

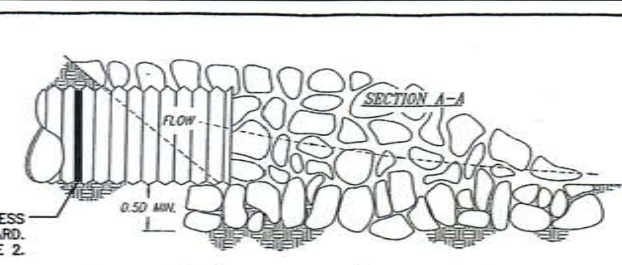

2-12" DIAMETER HDPE

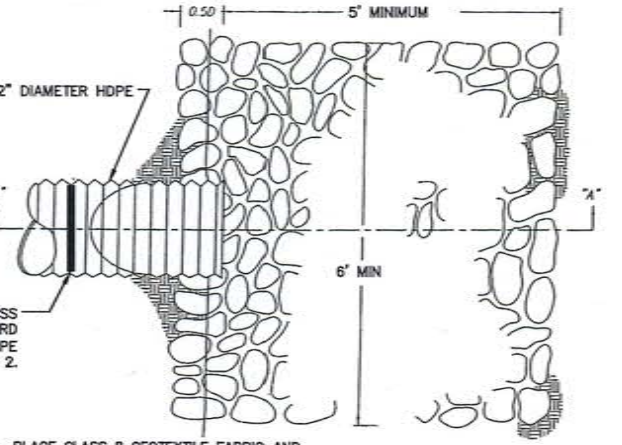

PLACE 12" STAINLESS STEEL ANIMAL GUARD ON EACH 12" HDPE PIPE SEE NOTE 2.

- PLACE CLASS 8 GEOTEXTILE FABRIC AND CLASS I (6") ROCK SLOPE PROTECTION IN ACCORDANCE WITH SECTION 72 OF THE CALTRANS STANDARD SPECIFICATIONS.
 LIMITS OF ROCK PLACEMENT TO BE FINALIZED IN FIELD.
- GUARD SHALL BE DRAINAGE SOLUTIONS OR APPROVED EQUAL. INSTALL PER MANUFACTURER RECOMMENDATIONS.
- DUAL 12" HDPE PIPES TO BE CENTERED ON ROCK SLOPE PROTECTION

APPROVED BY: *Brian J. Fragala*
 BRIAN J. FRAGALA, DIRECTOR OF PUBLIC WORKS, TOWN ENGINEER
 TOWN OF LOOMIS
 CULVERT OUTFALL
 DEPARTMENT OF PUBLIC WORKS
 SD-17

MODIFIED TOWN STANDARD DETAIL SD-17

SCALE: NTS

2

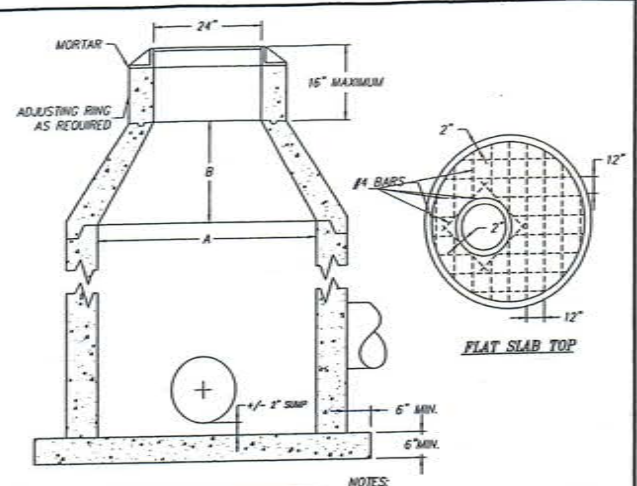

- SUMP SHALL BE 2" DEEP (TYP.) MEASURED FROM FROM INVERT OF OUTFALL PIPE. SUMP NOT REQUIRED IF DIAMETER OF OUTFALL PIPE IS 24" OR LARGER, OR IF M.H. IS NOT WITHIN PUBLIC R/W OR OTHER AREA WITH VEHICULAR ACCESS. A 12" DEEP SUMP WILL BE REQUIRED IN ALL MANHOLES DISCHARGING DIRECTLY TO WATERWAYS OR OPEN SPACES.
- NOTES:
- ECCENTRIC CONES SHALL BE USED IF SHOWN ON THE PLANS.
 - JOINTS MAY BE EITHER KEED OR TONGUE AND GROOVE.
 - A MINIMUM OF 6" OF UNDISTURBED MANHOLE WALL SHALL REMAIN BETWEEN ENTERING PIPES

TABLE OF DIMENSIONS

| M.H. | A | B | T MIN |
|------|-----|-----|-------|
| 48" | 48" | 16" | 6" |
| 60" | 60" | 30" | 8" |
| 72" | 72" | 42" | 8" |

DIMENSION "B" IS A MINIMUM DIMENSION AND MAY BE GREATER IF DEPTH PERMITS.
 RISER SECTIONS, CONES AND ADJUSTING RINGS SHALL CONFORM TO ASTM DESIGNATION C-478
 FRAME SHALL BE SECURED TO RISER OR FLAT SLAB TOP WITH CEMENT MORTAR CLASS A CONCRETE

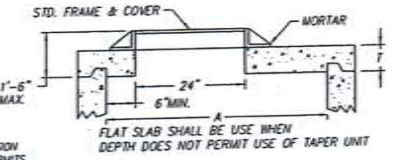

APPROVED BY: *Brian J. Fragala*
 BRIAN J. FRAGALA, DIRECTOR OF PUBLIC WORKS, TOWN ENGINEER
 TOWN OF LOOMIS
 STANDARD PRECAST STORM MANHOLE
 DEPARTMENT OF PUBLIC WORKS
 SD-23

TOWN STANDARD DETAIL SD-23

SCALE: NTS

3



PREPARED UNDER THE DIRECTION OF
Laurie M. Loatza
 LAURIE M. LOATZA, RCE 65981, DATE 02/16/2023
 DESIGNED BY: [Signature]
 DRAWN BY: [Signature]
 ERG/LML/ERG LML/DHS

COASTLAND | DCCM
 11641 Blocker Dr, Ste 170, Auburn, CA 95603
 530.886.9929

TOWN OF LOOMIS
 MAGNOLIA STREET STORM DRAIN REPAIR
 CALIFORNIA
 DETAILS
 MAGNOLIA STREET STORM DRAIN REPAIR

PROJECT NUMBER
 65-4923
 DRAWING DATE
 FEBRUARY 2023
 SHEET NUMBER
 3 OF 3