

CONSULTANTS
CONSULTANT #1 - DISCIPLINE
CONSULTANT #1 - NAME
ADDRESS
PHONE NUMBER
WEBSITE

LANDSCAPE
RIDGE LANDSCAPE ARCHITECTS
8841 RESEARCH DR., #200, Irvine
949-387-1323 EXT.30

CONSULTANT #3 - DISCIPLINE
CONSULTANT #3 - NAME
ADDRESS
PHONE NUMBER
WEBSITE

CONSULTANT #4 - DISCIPLINE
CONSULTANT #4 - NAME
ADDRESS
PHONE NUMBER
WEBSITE

CONSULTANT #5 - DISCIPLINE
CONSULTANT #5 - NAME
ADDRESS
PHONE NUMBER
WEBSITE

CONSULTANT #6 - DISCIPLINE
CONSULTANT #6 - NAME
ADDRESS
PHONE NUMBER
WEBSITE

PROJECT NAME
CREEKSTONE, LOOMIS.

PROJECT DESCRIPTION
24-HOUR RESIDENTIAL CARE FACILITY FOR THE ELDERLY (ASSISTED LIVING & INDEPENDENT LIVING) AND STAND ALONE INDEPENDENT LIVING COTTAGES.

PROJECT ADDRESS
3400 CHISOM TRAIL, LOOMIS, CA 95650

OWNER INFORMATION
BPG LOOMIS, LLC.
153 CEDROS #1267
SOLANA BEACH, CA 92075

GOREE PROJECT NUMBER
2305

STAMP / SIGNATURE

ISSUE DATE
10/31/2023

KEY PLAN

SHEET NAME
PRELIMINARY
LANDSCAPE PLAN

SHEET NUMBER

L1.1



LEGEND

- 1 ENHANCED CONCRETE PAVING AT BUILDING ENTRY AND COURTYARD
- 2 NATURAL GRAY CONCRETE PAVING
- 3 ENHANCED CONCRETE PAVING AT DRIVEWAY ENTRY
- 4 DROUGHT TOLERANT PLANTING
- 5 EXISTING TREES
- 6 ACCENT TREES
- 7 SCREENING TREES
- 8 SHADE TREES
- 9 PUTTING GREEN
- 10 PICKLE BALL
- 11 CABANA
- 12 PERIMETER FENCE & GATE
- 13 COBBLE CREEK AND POND
- 14 EXISTING LANDSCAPE
- 15 VEGETABLE GARDEN WITH DG PAVING
- 16 CORNHOLE COURT
- 17 MONUMENT SIGN
- 18 FLAG POLE
- 19 RETAINING WALL

INTERSTATE 80
BOYINGTON ROAD

CHISOM TRAIL
EASEMENT

EXISTING BUILDING

CHISOM TRAIL

APN: 043-050-032-000
N/F DECKER, JON LEE &
DECKER KRISTIE LEE TR

CONSULTANTS
CONSULTANT #1 - DISCIPLINE
CONSULTANT #1 - NAME
ADDRESS
PHONE NUMBER
WEBSITE

LANDSCAPE
RIDGE LANDSCAPE ARCHITECTS
8841 RESEARCH DR., #200, Irvine
949-887-1323 EXT.30

CONSULTANT #3 - DISCIPLINE
CONSULTANT #3 - NAME
ADDRESS
PHONE NUMBER
WEBSITE

CONSULTANT #4 - DISCIPLINE
CONSULTANT #4 - NAME
ADDRESS
PHONE NUMBER
WEBSITE

CONSULTANT #5 - DISCIPLINE
CONSULTANT #5 - NAME
ADDRESS
PHONE NUMBER
WEBSITE

CONSULTANT #6 - DISCIPLINE
CONSULTANT #6 - NAME
ADDRESS
PHONE NUMBER
WEBSITE

PROJECT NAME
CREEKSTONE, LOOMIS.

PROJECT DESCRIPTION
24-HOUR RESIDENTIAL CARE FACILITY FOR THE ELDERLY (ASSISTED LIVING & INDEPENDENT LIVING) AND STAND ALONE INDEPENDENT LIVING COTTAGES.

PROJECT ADDRESS
3400 CHISOM TRAIL, LOOMIS, CA 95650

OWNER INFORMATION
**BPG LOOMIS, LLC.
153 CEDROS #1267
SOLANA BEACH, CA 92075**

GOREE PROJECT NUMBER
2305

STAMP / SIGNATURE

ISSUE DATE
10/31/2023

ISSUE HISTORY

DATE:	MARK:	DESCRIPTION:

KEY PLAN

SHEET NAME
PRELIMINARY PLANTING PLAN

SHEET NUMBER

L2.1

PROPOSED PLANT PALETTE

TREES

SYMBOL	BOTANICAL NAME	COMMON NAME	SIZE / FORM	HT. X SPRD. X CAL. (MIN.)	WATER USE	DESCRIPTION
	ACER PALMATUM	JAPANESE MAPLE	24" BOX STD.	8'H X 5'W X 2" C	M	SMALL DECIDUOUS ACCENT
	ACER RUBRUM	RED MAPLE	24" BOX STD.	10'H X 5'W X 2" C	M	DECIDUOUS CANOPY
	CERCIS CANADENSIS 'FOREST PANSY'	FOREST PANSY REDBUD	24" BOX STD.	8'H X 3'W X 1-3/4" C	M	DECIDUOUS FLOWERING ACCENT
	LAGERSTROEMIA FAUERI 'MUSKOGEE'	MUSKOGEE CREPE MYRTLE	24" BOX STD.	8'H X 4' W X 1-3/4" C	L	DECIDUOUS FLOWERING ACCENT
	QUERCUS DOUGLASSII	BLUE OAK	24" BOX STD.	8'H X 5'W X 2" C	L	DECIDUOUS CANOPY
	QUERCUS WIZLIZENII	INTERIOR LIVE OAK	24" BOX STD.	8'H X 5'W X 2" C	L	DECIDUOUS CANOPY

BACKGROUND SHRUBS

SYMBOL	BOTANICAL NAME	COMMON NAME	SIZE	SPACING	WATER USE	DESCRIPTION
	ACCA SELLOWIANA	PINEAPPLE GUAVA	5 GAL.	6' O.C.	M	LARGE FLOWERING
	LEUCOPHYLLUM F. 'GREEN CLOUD'	TEXAS RANGER	5 GAL.	5' O.C.	L	LARGE FLOWERING INFORMAL SCREENING HEDGE
	OLEA X MONTRA 'LITTLE OLLIE'	LITTLE OLLIE	5 GAL.	4' O.C.	L	LARGE SHRUB
	RHAMNUS C. 'MOUND SAN BRUNO'	COFFEEBERRY	5 GAL.	5' O.C.	L	LARGE SHRUB
	SENNA ARTEMISIOIDES	FEATHERY CASSIA	5 GAL.	5' O.C.	L	LARGE FLOWERING

MIDGROUND SHRUBS

SYMBOL	BOTANICAL NAME	COMMON NAME	SIZE	SPACING	WATER USE	DESCRIPTION
	DIANELLA TASMANICA 'VARIEGATA'	VARIEGATED FLAX LILY	5 GAL.	36" O.C.	M	STRAPPY ACCENT
	HESPERALOE PARVIFLORA	RED YUCCA	5 GAL.	36" O.C.	L	FLOWERING ACCENT
	LANTANA 'GOLD MOUND'	YELLOW LANTANA	5 GAL.	36" O.C.	L	FLOWERING SHRUB
	MUHLENBERGIA C. 'REGAL MIST'	PINK MUHLY	5 GAL.	36" O.C.	L	ORNAMENTAL GRASS
	RHAPHIOLEPIS UMBELLATA	YEDDO HAWTHORNE	5 GAL.	36" O.C.	L	FLOWERING ACCENT
	ROSMARINUS O. 'TUSCAN BLUE'	ROSEMARY	1 GAL.	36" O.C.	L	FLOWERING ACCENT
	SALVIA CLEVELANDII 'ALLEN CHICKERING'	CLEVELAND SAGE	1 GAL.	48" O.C.	L	FLOWERING ACCENT
	SALVIA GREGGII	AUTUMN SAGE	1 GAL.	36" O.C.	L	FLOWERING ACCENT

FOREGROUND SHRUBS

SYMBOL	BOTANICAL NAME	COMMON NAME	SIZE	SPACING	WATER USE	DESCRIPTION
	ARTEMISIA 'POWIS CASTLE'	ARTEMISIA	1 GAL.	30" O.C.	L	SHRUB
	CALLISTEMON 'LITTLE JOHN'	DWARF BOTTLEBRUSH	5 GAL.	30" O.C.	L	FLOWERING SHRUB
	COPROSMA X KIRKII	CREeping COPROSMA	1 GAL.	36" O.C.	M	FLOWERING SHRUB
	COTONEASTER DAMMERI 'LOWFAST'	LOWFAST COTONEASTER	1 GAL.	36" O.C.	L	SPREADING MASS
	DIANELLA 'CASA BLUE'	CASA BLUE FLAX LILY	1 GAL.	24" O.C.	L	STRAPPY ACCENT
	ECHEVERIA 'RUFFLES'	RUFFLES ECHEVERIA	1 GAL.	18" O.C.	L	SUCCULENT ACCENT
	FESTUCA MAIREI	ATLAS FESCUE	1 GAL.	30" O.C.	M	ORNAMENTAL GRASS
	SESLARIA AUTUMNALIS	AUTUMN MOOR GRASS	1 GAL.	30" O.C.	M	ORNAMENTAL GRASS



PROPOSED PLANT PALETTE

GROUNDCOVERS

SYMBOL	BOTANICAL NAME	COMMON NAME	SIZE	SPACING	WATER USE	DESCRIPTION
	ACACIA REDOLENS 'LOW BOY'	PROSTRATE ACACIA	1 GAL.	8' O.C.	L	EVERGREEN GROUNDCOVER
	BACCHARIS P. 'PIGEON POINT'	DWARF COYOTE BRUSH	1 GAL.	48" O.C.	L	EVERGREEN GROUNDCOVER
	LANTANA 'NEW GOLD'	NEW GOLD LANTANA	1 GAL.	36" O.C.	L	FLOWERING GROUNDCOVER
	MYOPORUM PARVIFOLIUM	MYOPORUM	1 GAL.	36" O.C.	L	EVERGREEN GROUNDCOVER
	ROSA X 'FLOWER CARPET RED'	RED CARPET ROSE	1 GAL.	36" O.C.	M	FLOWERING GROUNDCOVER
	ROSMARINUS O. 'HUNTINGTON CARPET'	PROSTRATE ROSEMARY	FLATS	12" O.C.	L	EVERGREEN GROUNDCOVER
	SALVIA 'BEE'S BLISS'	BEE'S BLISS SAGE	1 GAL.	36" O.C.	L	FLOWERING GROUNDCOVER

BIOSWALE GRASSES

SYMBOL	BOTANICAL NAME	COMMON NAME	SIZE	SPACING	WATER USE	DESCRIPTION
	CAREX PANSA	CALIFORNIA MEADOW SEDGE	1 GAL.	24" O.C.	M	BIOSWALE GRASS
	CAREX TUMICOLA	FOOTHILL SEDGE	1 GAL.	24" O.C.	L	BIOSWALE GRASS
	JUNCUS PATENS	CALIFORNIA GRAY RUSH	1 GAL.	18" O.C.	L	BIOSWALE GRASS

VINES

SYMBOL	BOTANICAL NAME	COMMON NAME	SIZE	SPACING	WATER USE	DESCRIPTION
	DISTICTUS BUCCINATORIA	BLOOD-RED TRUMPET VINE	1 GAL./STAKED		M	FLOWERING VINE

MATCHLINE - SEE SHEET L2.2

APN: 043-050-037-000
N/F DECKER JOHN LEE &
DECKER KRISTIE LEE TR

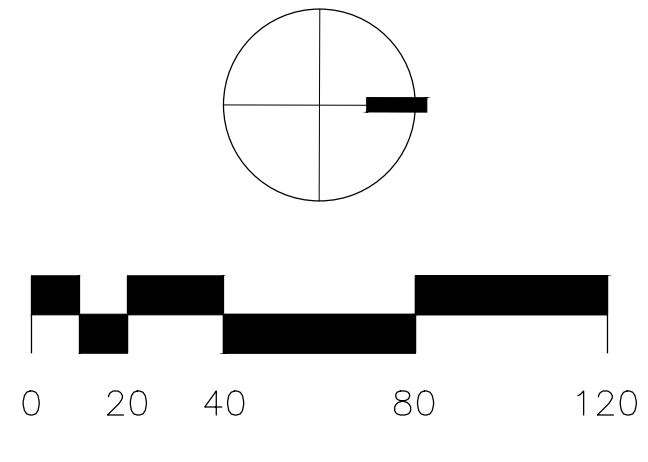

COPYRIGHTED DOCUMENT: THIS DRAWING AND THE INFORMATION CONTAINED HEREIN HAS BEEN GENERATED BY AN INSTRUMENT OF SERVICE FOR THE PROJECT. THESE DOCUMENTS ARE THE SOLE PROPERTY OF GOREE WHITFIELD, INC. ANY USE OF THESE DOCUMENTS, DATA AND DESIGNS FOR PURPOSES OTHER THAN THOSE ASSOCIATED WITH THE PROJECT WITHOUT THE EXPRESS WRITTEN PERMISSION OF GOREE WHITFIELD, INC. IS PROHIBITED.

CONSULTANTS

CONSULTANT #1 - DISCIPLINE
CONSULTANT #1 - NAME
ADDRESS
PHONE NUMBER
WEBSITE

LANDSCAPE
RIDGE LANDSCAPE ARCHITECTS
8841 RESEARCH DR., #200, Irvine
949-387-1323 EXT.30

CONSULTANT #3 - DISCIPLINE
CONSULTANT #3 - NAME
ADDRESS
PHONE NUMBER
WEBSITE

CONSULTANT #4 - DISCIPLINE
CONSULTANT #4 - NAME
ADDRESS
PHONE NUMBER
WEBSITE

CONSULTANT #5 - DISCIPLINE
CONSULTANT #5 - NAME
ADDRESS
PHONE NUMBER
WEBSITE

CONSULTANT #6 - DISCIPLINE
CONSULTANT #6 - NAME
ADDRESS
PHONE NUMBER
WEBSITE

PROJECT NAME

CREEKSTONE, LOOMIS,

PROJECT DESCRIPTION

24-HOUR RESIDENTIAL CARE FACILITY FOR THE ELDERLY (ASSISTED LIVING & INDEPENDENT LIVING) AND STAND ALONE INDEPENDENT LIVING COTTAGES.

PROJECT ADDRESS

3400 CHISOM TRAIL, LOOMIS, CA 95650

OWNER INFORMATION

**BPG LOOMIS, LLC.
153 CEDROS #1267
SOLANA BEACH, CA 92075**

GOREE PROJECT NUMBER

2305

STAMP / SIGNATURE

ISSUE DATE

10/31/2023

ISSUE HISTORY

DATE:	MARK:	DESCRIPTION:

KEY PLAN

SHEET NAME

PRELIMINARY PLANTING PLAN

SHEET NUMBER

L2.2

PROPOSED PLANT PALETTE

GROUNDCOVERS

SYMBOL	BOTANICAL NAME	COMMON NAME	SIZE	SPACING	WATER USE	DESCRIPTION
	ACACIA REDOLENS 'LOW BOY'	PROSTRATE ACACIA	1 GAL.	8" O.C.	L	EVERGREEN GROUNDCOVER
	BACCHARIS P. 'PIGEON POINT'	DWARF COYOTE BRUSH	1 GAL.	48" O.C.	L	EVERGREEN GROUNDCOVER
	LANTANA 'NEW GOLD'	NEW GOLD LANTANA	1 GAL.	36" O.C.	L	FLOWERING GROUNDCOVER
	MYOPORUM PARVIFOLIUM	MYOPORUM	1 GAL.	36" O.C.	L	EVERGREEN GROUNDCOVER
	ROSA X 'FLOWER CARPET RED'	RED CARPET ROSE	1 GAL.	36" O.C.	M	FLOWERING GROUNDCOVER
	ROSMARINUS O. 'HUNTINGTON CARPET'	PROSTRATE ROSEMARY	FLATS	12" O.C.	L	EVERGREEN GROUNDCOVER
	SALVIA 'BEE'S BLISS'	BEE'S BLISS SAGE	1 GAL.	36" O.C.	L	FLOWERING GROUNDCOVER

BIOSWALE GRASSES

SYMBOL	BOTANICAL NAME	COMMON NAME	SIZE	SPACING	WATER USE	DESCRIPTION
	CAREX PANSA	CALIFORNIA MEADOW SEDGE	1 GAL.	24" O.C.	M	BIOSWALE GRASS
	CAREX TUMICOLA	FOOTHILL SEDGE	1 GAL.	24" O.C.	L	BIOSWALE GRASS
	JUNCUS PATENS	CALIFORNIA GRAY RUSH	1 GAL.	18" O.C.	L	BIOSWALE GRASS

VINES

SYMBOL	BOTANICAL NAME	COMMON NAME	SIZE	SPACING	WATER USE	DESCRIPTION
	DISTICTUS BUCCINATORIA	BLOOD-RED TRUMPET VINE	1 GAL./STAKED		M	FLOWERING VINE

PROPOSED PLANT PALETTE

TREES

SYMBOL	BOTANICAL NAME	COMMON NAME	SIZE / FORM	HT. X SPRD. X CAL. (MIN.)	WATER USE	DESCRIPTION
	ACER PALMATUM	JAPANESE MAPLE	24" BOX STD.	8'H X 5'W X 2" C	M	SMALL DECIDUOUS ACCENT
	ACER RUBRUM	RED MAPLE	24" BOX STD.	10'H X 5'W X 2" C	M	DECIDUOUS CANOPY
	CERCIS CANADENSIS 'FOREST PANSY'	FOREST PANSY REDBUD	24" BOX STD.	8'H X 3'W X 1-3/4" C	M	DECIDUOUS FLOWERING ACCENT
	LAGERSTROEMIA FAUERI 'MUSKOGEE'	MUSKOGEE CREEP MYRTLE	24" BOX STD.	8'H X 4" W X 1-3/4" C	L	DECIDUOUS FLOWERING ACCENT
	QUERCUS DOUGLASII	BLUE OAK	24" BOX STD.	8'H X 5'W X 2" C	L	DECIDUOUS CANOPY
	QUERCUS WIZLIZENII	INTERIOR LIVE OAK	24" BOX STD.	8'H X 5'W X 2" C	L	DECIDUOUS CANOPY

BACKGROUND SHRUBS

SYMBOL	BOTANICAL NAME	COMMON NAME	SIZE	SPACING	WATER USE	DESCRIPTION
	ACCA SELLOWIANA	PINEAPPLE GUAVA	5 GAL.	6" O.C.	M	LARGE FLOWERING
	LEUCOPHYLLUM F. 'GREEN CLOUD'	TEXAS RANGER	5 GAL.	5" O.C.	L	LARGE FLOWERING INFORMAL SCREENING HEDGE
	OLEA X MONTRA 'LITTLE OLLIE'	LITTLE OLLIE	5 GAL.	4" O.C.	L	LARGE SHRUB
	RHAMNUS C. 'MOUND SAN BRUNO'	COFFEEBERRY	5 GAL.	5" O.C.	L	LARGE FLOWERING
	SENNA ARTEMISIOIDES	FEATHERY CASSIA	5 GAL.	5" O.C.	L	LARGE FLOWERING

MIDGROUND SHRUBS

SYMBOL	BOTANICAL NAME	COMMON NAME	SIZE	SPACING	WATER USE	DESCRIPTION
	DIANELLA TASMANICA 'VARIEGATA'	VARIEGATED FLAX LILY	5 GAL.	36" O.C.	M	STRAPPY ACCENT
	HESPERALOE PARVIFLORA	RED YUCCA	5 GAL.	36" O.C.	L	FLOWERING ACCENT
	LANTANA 'GOLD MOUND'	YELLOW LANTANA	5 GAL.	36" O.C.	L	FLOWERING SHRUB
	MUHLENBERGIA C. 'REGAL MIST'	PINK MUHLY	5 GAL.	36" O.C.	L	ORNAMENTAL GRASS
	RHAPHIOLEPIS UMBELLATA	YEDDO HAWTHORNE	5 GAL.	36" O.C.	L	FLOWERING ACCENT
	ROSMARINUS O. 'TUSCAN BLUE'	ROSEMARY	1 GAL.	36" O.C.	L	FLOWERING ACCENT
	SALVIA CLEVELANDII 'ALLEN CHICKERING'	CLEVELAND SAGE	1 GAL.	48" O.C.	L	FLOWERING ACCENT
	SALVIA GREGGII	AUTUMN SAGE	1 GAL.	36" O.C.	L	FLOWERING ACCENT

FOREGROUND SHRUBS

SYMBOL	BOTANICAL NAME	COMMON NAME	SIZE	SPACING	WATER USE	DESCRIPTION
	ARTEMISIA 'POWIS CASTLE'	ARTEMISIA	1 GAL.	30" O.C.	L	SHRUB
	CALLISTEMON 'LITTLE JOHN'	DWARF BOTTLEBRUSH	5 GAL.	30" O.C.	L	FLOWERING SHRUB
	COPROSMA X KIRKII	CREEPING COPROSMA	1 GAL.	36" O.C.	M	FLOWERING SHRUB
	COTONEASTER DAMMERI 'LOWFAST'	LOWFAST COTONEASTER	1 GAL.	36" O.C.	L	SPREADING MASS
	DIANELLA 'CASA BLUE'	CASA BLUE FLAX LILY	1 GAL.	24" O.C.	L	STRAPPY ACCENT
	ECHVEVERIA 'RUFFLES'	RUFFLES ECHEVERIA	1 GAL.	18" O.C.	L	SUCCULENT ACCENT
	FESTUCA MAIREI	ATLAS FESCUE	1 GAL.	30" O.C.	M	ORNAMENTAL GRASS
	SESLARIA AUTUMNALIS	AUTUMN MOOR GRASS	1 GAL.	30" O.C.	M	ORNAMENTAL GRASS

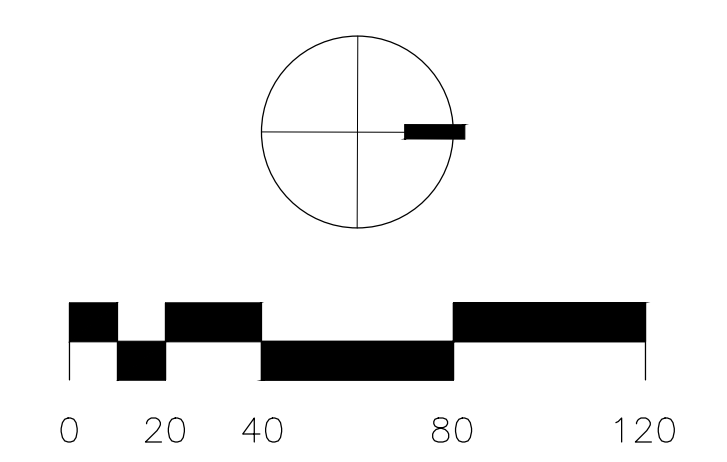
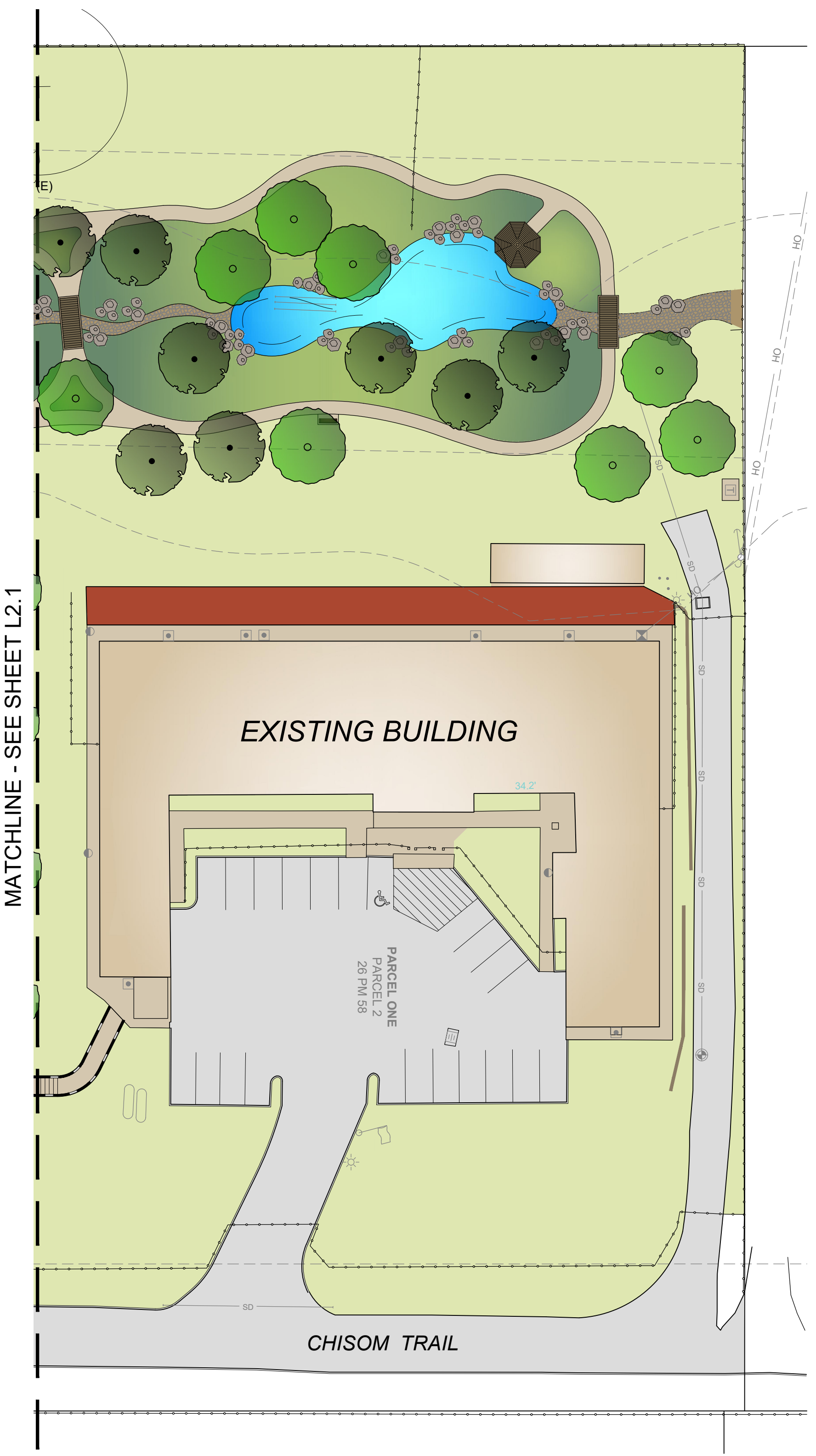

COPYRIGHTED DOCUMENT - THIS DRAWING AND THE REVISIONS FILE FROM WHICH IT HAS BEEN GENERATED, USE PROVIDED AS AN INSTRUMENT OF SERVICE FOR THE PROJECT. THESE DOCUMENTS ARE THE SOLE PROPERTY OF GOREE ARCHITECTS, INC. ANY USE OF THESE DOCUMENTS, DATA AND DESIGNS FOR PURPOSES OTHER THAN THOSE ASSOCIATED WITH THE PROJECT WITHOUT THE EXPRESS WRITTEN PERMISSION OF GOREE ARCHITECTS, INC. IS PROHIBITED.

TREES



ACER PALMATUM / JAPANESE MAPLE



ACER RUBRUM / RED MAPLE



CERCIS CANADENSIS 'FOREST PANSY' / FOREST PANSY REDBUD



LAGERSTROEMIA FAUERI 'MUSKOGEE' / MUSKOGEE CREPE MYRTLE



QUERCUS DOUGLASII / BLUE OAK



QUERCUS WIZLIZENII / INTERIOR LIVE OAK

SHRUBS



ACCA SELLOWIANA / PINEAPPLE GUAVA



LEUCOPHYLLUM F. 'GREEN CLOUD' / TEXAS RANGER



OLEA X MONTRA 'LITTLE OLLIE' / LITTLE OLLIE



RHAMNUS C. 'MOUND SAN BRUNO' / COFFEEBERRY



SENNA ARTEMISIOIDES / FEATHERY CASSIA



DIANELLA TASMANICA 'VARIEGATA' / VARIEGATED FLAX LILY



HESPERALOE PARVIFLORA / RED YUCCA



LANTANA 'GOLD MOUND' / YELLOW LANTANA



MUHLENBERGIA C. 'REGAL MIST' / PINK MUHLY



RHAMPHIOLEPIS UMBELLATA / YEDDO HAWTHORNE



ROSMARINUS O. 'TUSCAN BLUE' / ROSEMARY



SALVIA CLEVELANDII 'ALLEN CHICKERING' / CLEVELAND SAGE



SALVIA GREGGII / AUTUMN SAGE



ARTEMISIA 'POWIS CASTLE' / ARTEMISIA



CALLISTEMON 'LITTLE JOHN' / DWARF BOTTLEBRUSH

CONSULTANTS

CONSULTANT #1 - DISCIPLINE
CONSULTANT #1 - NAME
ADDRESS
PHONE NUMBER
WEBSITE

LANDSCAPE
RIDGE LANDSCAPE ARCHITECTS
8841 RESEARCH DR., #200, Irvine
949-887-1323 EXT.30

CONSULTANT #3 - DISCIPLINE
CONSULTANT #3 - NAME
ADDRESS
PHONE NUMBER
WEBSITE

CONSULTANT #4 - DISCIPLINE
CONSULTANT #4 - NAME
ADDRESS
PHONE NUMBER
WEBSITE

CONSULTANT #5 - DISCIPLINE
CONSULTANT #5 - NAME
ADDRESS
PHONE NUMBER
WEBSITE

CONSULTANT #6 - DISCIPLINE
CONSULTANT #6 - NAME
ADDRESS
PHONE NUMBER
WEBSITE

PROJECT NAME

CREEKSTONE, LOOMIS,

PROJECT DESCRIPTION

24-HOUR RESIDENTIAL CARE FACILITY FOR THE ELDERLY (ASSISTED LIVING & INDEPENDENT LIVING) AND STAND ALONE INDEPENDENT LIVING COTTAGES.

PROJECT ADDRESS

3400 CHISOM TRAIL, LOOMIS, CA 95650

OWNER INFORMATION

BPG LOOMIS, LLC.
153 CEDROS #1267
SOLANA BEACH, CA 92075

GOREE PROJECT NUMBER

2305

STAMP / SIGNATURE

ISSUE DATE

10/31/2023

ISSUE HISTORY

DATE:	MARK:	DESCRIPTION:

KEY PLAN

SHEET NAME

PLANTING IMAGERY

SHEET NUMBER

L3.1

SHRUBS



COPROSMA X KIRKII /
CREEPING COPROSMA



COTONEASTER DAMMERI 'LOWFAST' /
LOWFAST COTONEASTER



DIANELLA 'CASA BLUE' /
CASA BLUE FLAX LILY



ECHEVERIA 'RUFFLES' /
RUFFLES ECHEVERIA



FESTUCA MAIREI /
ATLAS FESCUE



SESLERIA AUTUMNALIS /
AUTUMN MOOR GRASS



ACACIA REDOLENS 'LOW BOY' /
PROSTRATE ACACIA



BACCHARIS P. 'PIGEON POINT' /
DWARF COYOTE BRUSH



LANTANA 'NEW GOLD' /
NEW GOLD LANTANA



MYOPORUM PARVIFOLIUM /
MYOPORUM



ROSA X 'FLOWER CARPET RED' /
RED CARPET ROSE



ROSMARINUS O. 'HUNTINGTON CARPET' /
PROSTRATE ROSEMARY



SALVIA 'BEE'S BLISS' /
BEE'S BLISS SAGE



CAREX PANSA /
CALIFORNIA MEADOW SEDGE



CAREX TUMICOLA /
FOOTHILL SEDGE



JUNCUS PATENS /
CALIFORNIA GRAY RUSH



DISTICTUS BUCCINATORIA /
BLOOD-RED TRUMPET VINE

CONSULTANTS

CONSULTANT #1 - DISCIPLINE
CONSULTANT #1 - NAME
ADDRESS
PHONE NUMBER
WEBSITE

LANDSCAPE
RIDGE LANDSCAPE ARCHITECTS
8841 RESEARCH DR., #200, Irvine
949-887-1323 EXT.30

CONSULTANT #3 - DISCIPLINE
CONSULTANT #3 - NAME
ADDRESS
PHONE NUMBER
WEBSITE

CONSULTANT #4 - DISCIPLINE
CONSULTANT #4 - NAME
ADDRESS
PHONE NUMBER
WEBSITE

CONSULTANT #5 - DISCIPLINE
CONSULTANT #5 - NAME
ADDRESS
PHONE NUMBER
WEBSITE

CONSULTANT #6 - DISCIPLINE
CONSULTANT #6 - NAME
ADDRESS
PHONE NUMBER
WEBSITE

PROJECT NAME

CREEKSTONE, LOOMIS,

PROJECT DESCRIPTION

24-HOUR RESIDENTIAL CARE FACILITY FOR THE ELDERLY (ASSISTED LIVING & INDEPENDENT LIVING) AND STAND ALONE INDEPENDENT LIVING COTTAGES .

PROJECT ADDRESS

3400 CHISOM TRAIL, LOOMIS, CA 95650

OWNER INFORMATION

BPG LOOMIS, LLC.
153 CEDROS #1267
SOLANA BEACH, CA 92075

GOREE PROJECT NUMBER

2305

STAMP / SIGNATURE

ISSUE DATE

10/31/2023

ISSUE HISTORY

DATE:	MARK:	DESCRIPTION:

KEY PLAN

SHEET NAME

PLANTING IMAGERY

SHEET NUMBER

L3.2