

CONSTRUCTION PLANS FOR CREEKSIDE ESTATES CITY OF LUCAS COLLIN COUNTY, TEXAS

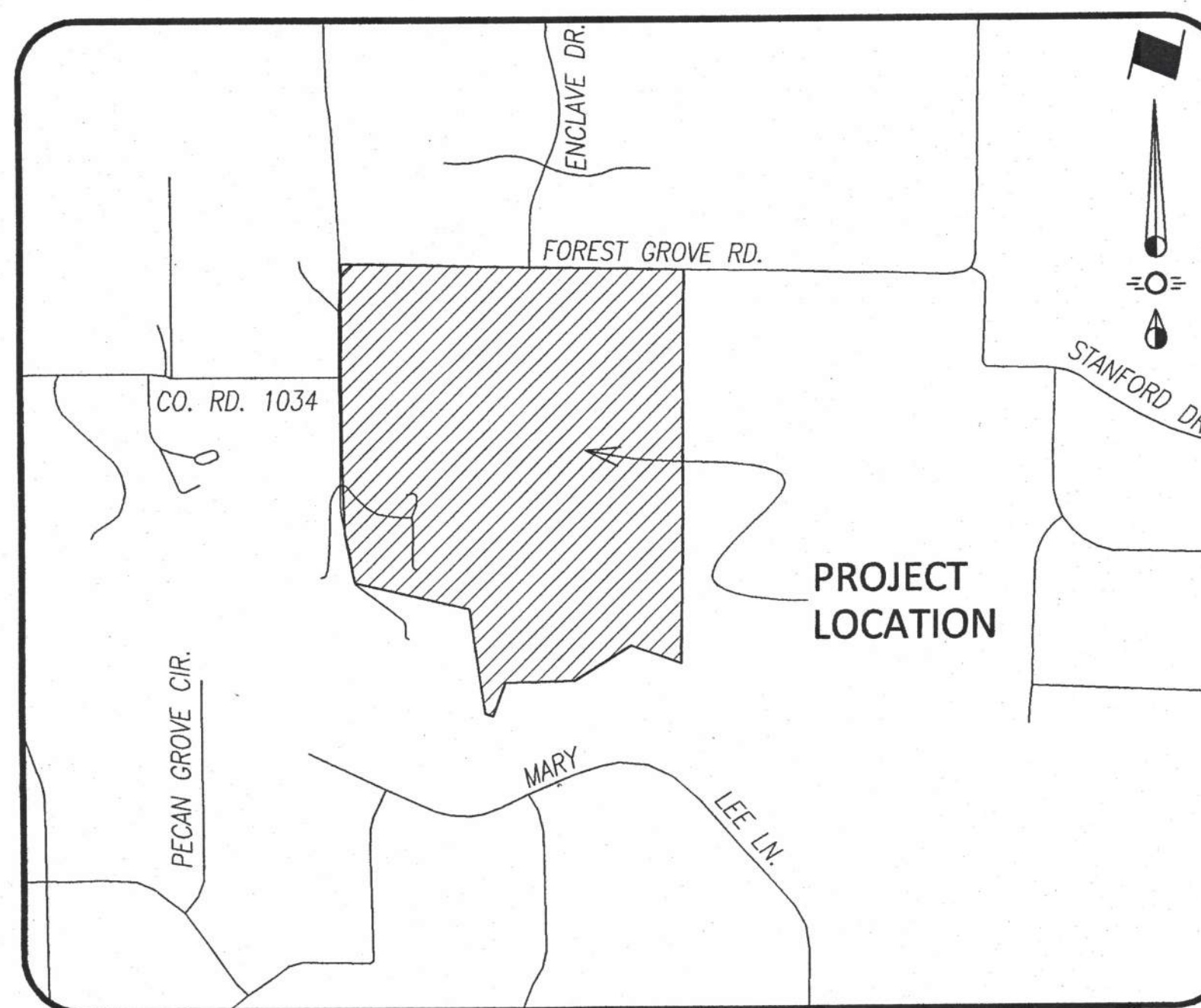

Vicinity Map
N.T.S.

INDEX OF DRAWINGS

- | | |
|----|---|
| 1 | Final Plat |
| 2 | Final Plat |
| 3 | General Notes |
| 4 | Paving Plan & Profile - Forest Grove Road |
| 5 | Paving Plan & Profile - Street A |
| 6 | Paving Plan & Profile - Street B |
| 7 | Paving Plan & Profile - Street B |
| 8 | Paving Plan & Profile - Street C |
| 9 | Paving Plan & Profile - CR321 |
| 10 | Offsite Drainage Area Map |
| 11 | Drainage Area Map |
| 12 | Detention Pond Calculations |
| 13 | Detention Pond Calculations |
| 14 | Culverts Plan & Profile |
| 15 | Water Plan |
| 16 | Erosion Control Plan & Details |
| 17 | Grading Plan |
| 18 | Grading Plan |
| 19 | Street Lights & Signage Plan |

PREPARED FOR:

CENTURION ACQUISITIONS, LP
1221 I-35 E., SUITE 200
CARROLLTON, TEXAS 75006
Contact: STEVE LENART

AS-BUILT DRAWINGS
THIS DRAWING HAS BEEN REVISED TO CONFORM TO THE
CONSTRUCTION RECORDS PROVIDED BY THE CONTRACTOR.
ALIGNMENT AND GRADES SHOWN ON THIS DRAWING WERE
NOT FIELD VERIFIED BY THE ENGINEER.
Matthew M. Dorsett
MATTHEW M. DORSETT, P.E. 90912
2/24/15
DATE

BENCHMARKS:

BM1
Being a Railroad Spike Found in the centerline of Forest Grove
Road 420 feet east of northeast corner of the subject tract.
Elevation = 581.18

BM2
Being an "X" found in concrete in the centerline of Enclave
Drive 209 feet north of the intersection of Forest Grove Road
and Enclave Drive.
Elevation = 588.43



765 Custer Road, Suite 100 • Plano, TX 75075 • (972) 422-0077 • TBPE No. F-2121

William T. Carmickle
and wife
Donna Carmickle
Vol. 4970, Pg. 1569

HWP PROPERTIES, LP
Doc. No. 20060327000389570

COELEN ADDITION
Cab. G, Pg. 180

Joseph M. Pettinger
and wife
Jennifer L. Pettinger
Vol. 4611, Pg. 490

Note:
Existing Water Line Location Based
On Field Observations & Survey Data.
Contractor To Verify Location and
Notify Engineer Of Any Discrepancies.

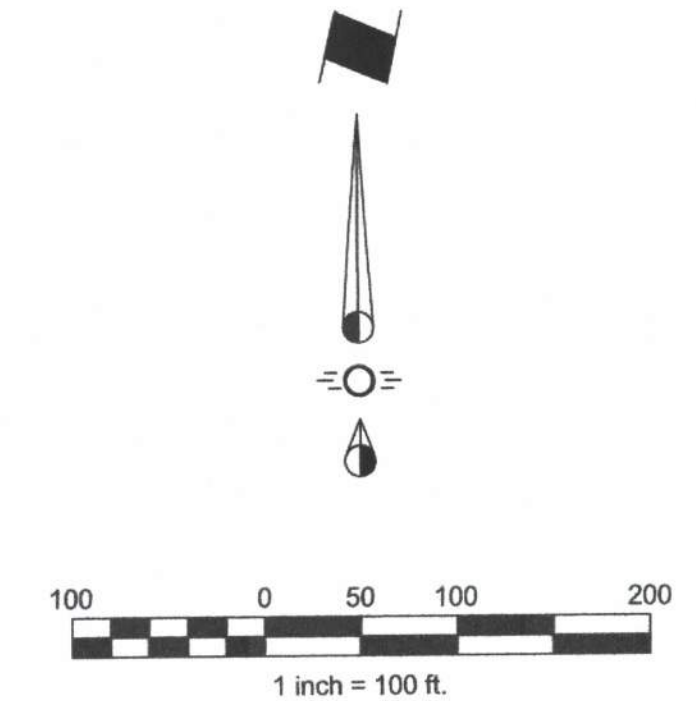

LEGEND

- Exist. Water Line
- ⊙ Exist. Fire Hydrant
- Prop. Water Line and Valve
- ⊙ Prop. Fire Hydrant

Service Schedule

| Type | Size | No. |
|------------|------|-----|
| Water | 1" | 27 |
| Irrigation | 1.5" | 1 |

CAUTION !!!
EXISTING UTILITIES

EXISTING UTILITIES AND UNDERGROUND FACILITIES INDICATED ON THESE PLANS HAVE BEEN LOCATED FROM REFERENCE INFORMATION. IT SHALL BE THE RESPONSIBILITY OF THE CONTRACTOR TO VERIFY BOTH HORIZONTALLY AND VERTICALLY THE LOCATION OF ALL EXISTING UTILITIES AND UNDERGROUND FACILITIES PRIOR TO CONSTRUCTION AND TO TAKE NECESSARY PRECAUTIONS IN ORDER TO PROTECT ALL FACILITIES ENCOUNTERED. THE CONTRACTOR SHALL PRESERVE AND PROTECT ALL EXISTING UTILITIES FROM DAMAGE DURING CONSTRUCTION.

BENCHMARKS:

BM1
Being a Railroad Spike Found in the centerline of Forest Grove Road 420 feet east of northeast corner of the subject tract. Elevation = 581.18

BM2
Being an "X" found in concrete in the centerline of Enclove Drive 209 feet north of the intersection of Forest Grove Road and Enclove Drive. Elevation = 588.43

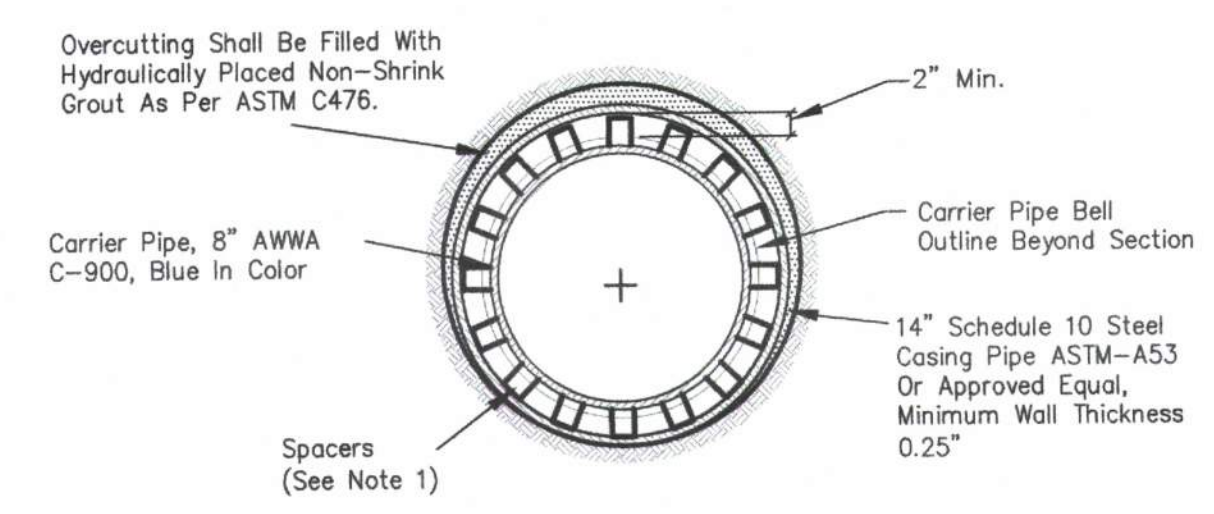

WATER MAIN ENCASEMENT & SPACER DETAIL
N.T.S.

- Note:**
- Raci spacers, or approved equal, shall be installed on carrier pipe per manufacturer's recommendations to prevent sagging and damage to pipe bells.
 - Boring shall be by the dry bore method and according to N.C.T.C.O.G. 503.3.3.3.
 - Ends of the casing pipe shall be sealed with 1/8" thick neoprene rubber & stainless steel bands.

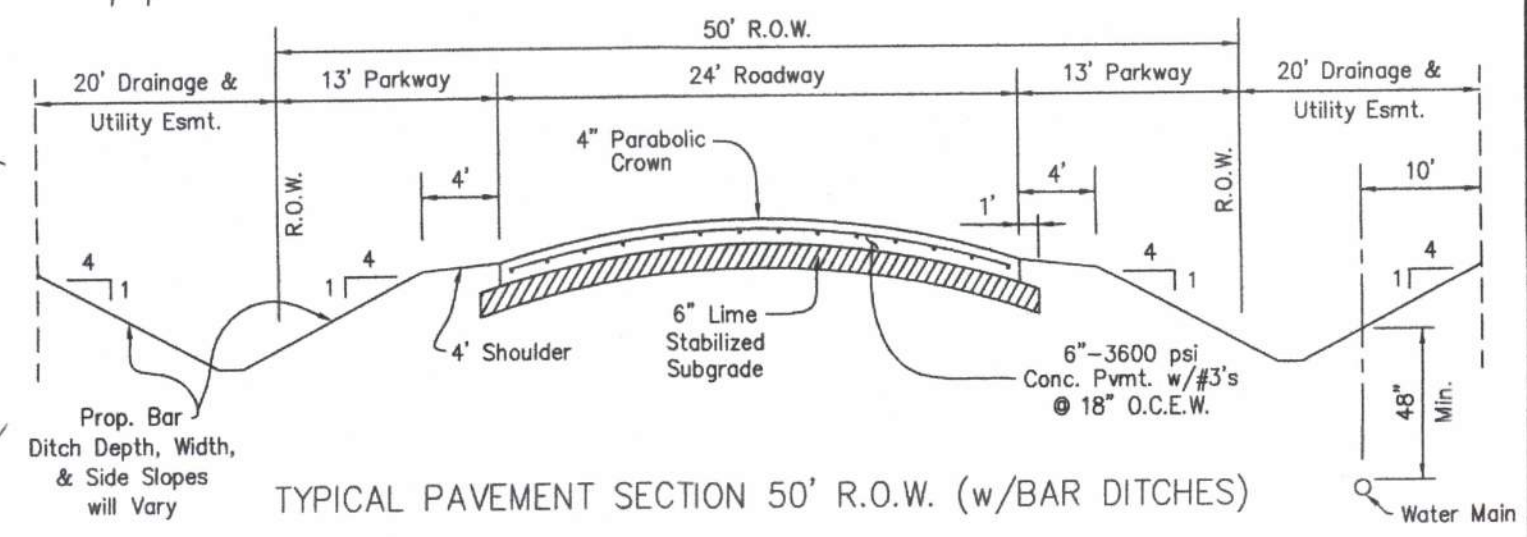

TYPICAL PAVEMENT SECTION 50' R.O.W. (w/BAR DITCHES)

AS-BUILT DRAWINGS
THIS DRAWING HAS BEEN REVISED TO CONFORM TO THE CONSTRUCTION RECORDS PROVIDED BY THE CONTRACTOR. ALIGNMENT AND GRADES SHOWN ON THIS DRAWING WERE NOT FIELD VERIFIED BY THE ENGINEER.

Matthew M. Dorsett, P.E. 90912
2/24/15
DATE

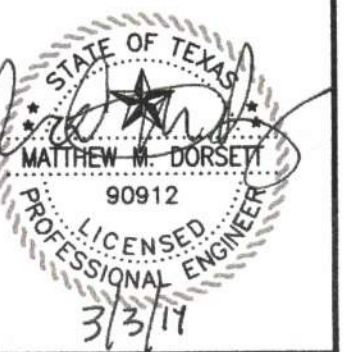

Issue Dates:

| Date | Revisions |
|---------|--|
| 3/2/14 | Remove existing 6" water line and replace with 8" water line. |
| 2/20/15 | Cap and bury existing 6" water line and install 8" water line. |

