

1. ALL CONSTRUCTION AND MATERIALS SHALL BE IN ACCORDANCE WITH THE TEXAS DEPARTMENT OF TRANSPORTATION (TXDOT) STANDARD SPECIFICATIONS FOR CONSTRUCTIONS AND MAINTENANCE OF HIGHWAYS, STREETS, AND BRIDGES, NOVEMBER 2014 EDITION, REFERRED TO AS "THE STANDARD SPECIFICATIONS".
2. IN THE EVENT AN ITEM IS NOT COVERED WITHIN THESE PLANS AND SPECIFICATIONS, THE TXDOT STANDARD SPECIFICATIONS SHALL APPLY.
3. THE CONTRACTOR SHALL SECURE ALL NECESSARY PERMITS BEFORE ANY WORK MAY BEGIN. ALL PERMIT FEES SHALL BE CONSIDERED INCIDENTAL TO PAY ITEMS PROVIDED.
4. THE CONTRACTOR SHALL PROVIDE A CONSTRUCTION SCHEDULE UPDATE TO THE ENGINEER AND THE CONSTRUCTION INSPECTOR WITH THE MONTHLY PAY ESTIMATE.
5. THE CONTRACTOR WILL BE PAID ONLY FOR THE WORK WHICH IS COMPLETED IN STRICT CONFORMANCE TO THE PLANS AND CONSTRUCTION DETAILS.
6. FINAL PAYMENT TO CONTRACTOR SHALL BE RELEASED AFTER THE ACCEPTANCE OF THE FINAL INSPECTION BY AUTHORIZED PERSONNEL OF THE PUBLIC WORKS DEPARTMENT.
7. THE CONTRACTOR SHALL CONTACT THE ENGINEER SHOULD ANY DISCREPANCIES BE FOUND IN THE CONSTRUCTION PLANS AND/OR THE SPECIAL PROVISIONS PRIOR TO CONSTRUCTION. THE CONTRACTOR WILL NOT BE COMPENSATED FOR ANY WORK NOT AUTHORIZED BY THE ENGINEER.
8. THE CONTRACTOR SHALL PROVIDE ALL NECESSARY CONSTRUCTION STAKING BY A TEXAS REGISTERED LAND PROFESSIONAL LAND SURVEYOR. WORK IS NOT PERMITTED OUTSIDE OF THE RIGHT OF WAY OR EASEMENTS WITHOUT PRIOR PERMISSION AND COORDINATION WITH THE CITY.
9. CONSTRUCTION OBSERVATION AND ADDITIONAL MATERIALS TESTING WILL BE PERFORMED BY REPRESENTATIVES OF THE OWNER, ENGINEER AND REVIEW AUTHORITIES AND AGENCIES. UNRESTRICTED ACCESS SHALL BE PROVIDED TO THESE REPRESENTATIVES AT ALL TIMES. THE CONTRACTOR IS RESPONSIBLE FOR UNDERSTANDING THE REQUIRED INSPECTIONS AND ALLOWING FOR THEM IN HIS SCHEDULE OF OPERATIONS. CONTRACTOR WILL NOT BE ALLOWED ANY ADDITIONAL CONTRACT DAYS OR COMPENSATION AS A RESULT OF HIS FAILURE TO ADEQUATELY PROVIDE FOR AUTHORIZED INSPECTIONS.
10. THE CONTRACTOR SHALL NOTIFY THE PUBLIC WORKS DEPARTMENT AND THE ENGINEER TWO WORKING DAYS BEFORE STARTING WORK.
11. THE CONTRACTOR SHALL NOTIFY THE PUBLIC WORKS DEPARTMENT AND THE ENGINEER TWO WORKING DAYS IN ADVANCE OF ANY CONCRETE PLACING OR ASPHALT LAYING OPERATION.
12. THE CONTRACTOR MUST FURNISH AT LEAST TWO PHONE NUMBERS WHERE RESPONSIBLE PERSONNEL CAN BE REACHED IN CASE OF EMERGENCY DURING WORKING AND NONWORKING HOURS. IF THERE ARE ANY CHANGES, THE INFORMATION MUST BE UPDATED IMMEDIATELY FOR THE DURATION OF THE PROJECT.
13. IF CULTURAL RESOURCES (ARCHAEOLOGICAL FINDINGS UNEARTHED) ARE LOCATED DURING CONSTRUCTION, WORK SHALL STOP IMMEDIATELY IN THAT AREA. IMMEDIATELY NOTIFY THE ENGINEER.
14. THE ENGINEER/INSPECTOR WILL NOT SUPERVISE, DIRECT OR HAVE CONTROL OVER THE CONTRACTOR'S WORK; NOR WILL THE ENGINEER/INSPECTOR HAVE AUTHORITY OVER OR BE RESPONSIBLE FOR THE MEANS, METHODS, TECHNIQUES, SEQUENCES OR PROCEDURES OF CONSTRUCTION; FOR THE SAFETY PRECAUTIONS AND PROGRAMS INCIDENT TO THE WORK OF CONTRACTOR; OR FOR ANY FAILURE OF CONTRACTOR TO COMPLY WITH LAWS, RULES, REGULATIONS, ORDINANCES, CODES OR ORDERS APPLICABLE TO CONTRACTOR FURNISHING AND PERFORMING THE WORK.
15. THE CONTRACTOR SHALL PROTECT AND BE RESPONSIBLE FOR RESETTING OR ESTABLISHING NEW BENCHMARKS AFFECTED BY THE CONSTRUCTION (NO SEPARATE PAY ITEM).
16. ALL CONCRETE SHALL BE IN COMPLIANCE WITH THE SPECIFIED CLASSES OF CONCRETE PER TXDOT SPECIFICATIONS.
17. CONTRACTOR SHALL ADHERE TO ALL REQUIREMENTS OF TXDOT ITEM 360, CONCRETE PAVEMENT.
18. THE CONTRACTOR SHALL SUBMIT TO THE ENGINEER THE COMPLETE CONCRETE MIX (BATCH) DESIGN AT THE PRE- CONSTRUCTION CONFERENCE AND/OR AT LEAST TEN WORKING DAYS PRIOR TO THE START OF ANY CONCRETE PLACING OPERATIONS. VOLUMETRIC CONCRETE IS NOT APPROVED FOR THIS PROJECT.
19. CONTRACTOR SHALL SUBMIT PAVING CONSTRUCTION PLAN AS DESCRIBED IN TXDOT ITEM 360, CONCRETE PAVEMENT.
20. CONTRACTOR SHALL EMPLOY A CERTIFIED TESTING LABORATORY TO PERFORM DENSITY TESTING IN ACCORDANCE WITH TXDOT PROCEDURE TEX-115-E. ALL TEST RESULTS SHALL BE SUBMITTED TO THE ENGINEER. TEST LOCATIONS SHALL BE MARKED IN THE PLANS AND SUBMITTED WITH THE RESULTS. COST OF DENSITY TESTING SHALL BE INCLUDED IN THE COST OF BID ITEMS 132-6001, AND 260-6079.
21. **2** CONTRACTOR SHALL EMPLOY A CERTIFIED TESTING LABORATORY FOR CONCRETE SAMPLING AND TESTING IN ACCORDANCE WITH ASTM C31-18b AND ASTM C39-18 AND TEMPERATURE. ONE SET OF FIVE (6IN X 12IN) CONCRETE CYLINDERS (TEST 1@3, 1@7, 2@28 DAYS) FOR EACH DAY'S PRODUCTION. IF THE TWO 28 DAYS TEST FAIL TO MEET REQUIRED STRENGTH, TEST THE 5TH CYLINDER AT 48 DAYS (COST OF CONCRETE TESTING SHALL BE INCLUDED IN CONCRETE POUR OPERATIONS AT NO ADDITIONAL COST. ALL TEST RESULTS SHALL BE SUBMITTED TO THE ENGINEER. TEST LOCATIONS SHALL BE MARKED IN THE PLANS AND SUBMITTED WITH THE RESULTS. CONCRETE SHALL BE SAMPLED AT POINT OF DISCHARGE AND INDICATED AS SUCH ON REPORT. CONCRETE SHALL HAVE AIR ENTRAINMENT OF 3-6%.
22. ALL INSPECTION AND TESTING LABORATORIES MUST BE APPROVED BY THE CITY PRIOR TO PERFORMING ANY WORK. SUBMIT INSPECTION AND TESTING CERTIFICATIONS A MINIMUM OF TWO WEEKS PRIOR TO BEGINNING RELATED WORK.
23. WHEN AIR TEMPERATURE IS BETWEEN 85 DEG. F (30 DEG. C) AND 90 DEG F (32 DEG. C), REDUCE MIXING AND DELIVERY TIME FROM 1 1/2 HOURS TO 75 MINUTES, AND WHEN AIR TEMPERATURE IS ABOVE 90 DEG. F (32 DEG. C), REDUCE MIXING AND DELIVERY TIME TO 60 MINUTES. NO ADMIXTURE SHALL BE PERMITTED IN THE CONCRETE MIX WITHOUT WRITTEN APPROVAL BY THE ARCHITECT/ENGINEER. NO WATER SHALL BE ADDED TO THE CONCRETE MIX AT THE JOB SITE.
24. CONCRETE WASHOUT WILL NOT BE PERMITTED ON SITE AND MUST BE CONDUCTED AT A FACILITY DESIGNATED FOR SUCH PURPOSES.
25. ALL REINFORCING STEEL AND DOWEL BARS IN PAVEMENT SHALL BE SUPPORTED AND MAINTAINED AT THE CORRECT CLEARANCES BY THE USE OF BAR CHAIRS OR OTHER APPROVED SUPPORT.
25. **2** A MINIMUM OF 6% HYDRATED LIME BY DRY SOIL WEIGHT TO THE SPECIFIED DEPTH
26. THE USE OF WOOD FORMS FOR PAVEMENT CONSTRUCTION WILL BE PERMITTED ONLY FOR LEAVE-OUTS, ALLEYS, SIDEWALKS, DRIVEWAYS, BARRIER FREE RAMPS AND INTERSECTIONS. WOOD FORMS MAY BE PERMITTED FOR OTHER USES, BUT ONLY ON A CASE-BY-CASE BASIS, AND MUST BE EXPLICITLY AUTHORIZED BY THE ENGINEER.
27. DRIVEWAY APPROACHES DAMAGED BY THE CONTRACTOR SHALL BE REMOVED AND REPLACED TO MATCH THE EXISTING CONDITIONS, AT THE CONTRACTOR'S EXPENSE AND TO THE SATISFACTION OF THE CITY OF LUCAS. DRAINAGE PIPE UNDER DRIVEWAY APPROACHES DAMAGED BY THE CONTRACTOR SHALL BE REPLACED OR REPAIRED TO EQUAL OR BETTER THAN EXISTING CONDITION, AT THE CONTRACTOR'S EXPENSE.
28. THE CONTRACTOR SHALL PROTECT ALL EXISTING FENCES (TO REMAIN). ANY DAMAGES DUE TO CONTRACTOR'S ACTION SHALL BE REPAIRED AT NO ADDITIONAL COST TO THE CITY.
29. THE CONTRACTOR SHALL RESTORE ALL AREAS DISTURBED BY THE CONSTRUCTION TO THE ORIGINAL CONDITION OR BETTER. RESTORED AREAS INCLUDE BUT NOT LIMITED TO TRENCH BACKFILL, SIDE SLOPES, FENCES, IRRIGATION SYSTEMS, DRIVEWAYS, PRIVATE YARDS, SIGNS AND ROADWAYS.
30. DISTURBED AREAS SHALL BE HYDRO MULCHED, WATERED & ESTABLISHED. DISTURBED CHANNEL SIDE SLOPES SHALL BE RESTORED WITH SOLID BLOCK SOD, WATERED, FERTILIZED & ESTABLISHED. THE ESTABLISHMENT OF GRASS IN DISTURBED AREAS SHALL BE DETERMINED BY THE CITY.
31. THE CONTRACTOR SHALL NOT PLACE FILL OR WASTE MATERIAL ON ANY PRIVATE PROPERTY WITHOUT A WRITTEN AGREEMENT WITH THE PROPERTY OWNER AND APPROVAL BY CITY. A COPY OF THIS AGREEMENT SHALL BE PROVIDED TO THE CITY. LETTERS OF FINAL APPROVAL AND RELEASE FROM THE AFFECTED PROPERTY OWNER(S) MUST BE SUBMITTED TO THE CITY BEFORE FINAL PAYMENT WILL BE AUTHORIZED ON THIS PROJECT.
32. NO EXCESS EXCAVATED MATERIAL SHALL BE DEPOSITED IN LOW AREAS OR ALONG ANY NATURAL DRAINAGE WAY, WITHOUT WRITTEN PERMISSION FROM THE ENGINEER. IF THE CONTRACTOR PLACES EXCESS MATERIAL IN AREAS WITHOUT WRITTEN PERMISSION, HE WILL BE RESPONSIBLE FOR ALL DAMAGE RESULTING FROM SUCH FILL AND HE SHALL REMOVE THE MATERIAL AT HIS OWN COST IF THE CITY SO DIRECTS.
33. THE CONTRACTOR SHALL PROTECT THE EXISTING TREES, BUSHES, LANDSCAPING PLANTS, SPRINKLERS, AND LAWNS UNLESS SHOWN OTHERWISE ON THE CONSTRUCTION DRAWINGS. ANY DAMAGE TO THE EXISTING TREES, BUSHES, LANDSCAPING PLANTS, SPRINKLERS, AND LAWNS CAUSED BY THE CONSTRUCTION SHALL BE REPLACED TO THE SATISFACTION OF THE PROPERTY OWNER AND THE CITY AT THE CONTRACTOR'S SOLE EXPENSE.
34. THE CONTRACTOR SHALL PROTECT ALL UNDERGROUND IRRIGATION SYSTEMS. ADJUSTMENT OR RELOCATION OF IRRIGATION SYSTEM SHALL BE INSTALLED BY AN IRRIGATOR LICENSED IN THE STATE OF TEXAS AND, IF REQUIRED, SHALL BE INCIDENTAL TO RIGHT OF WAY PREPARATION.
35. NO TREES SHALL BE CUT EXCEPT ON SPECIFIC AUTHORITY OF THE ENGINEER. TREES 6-INCH OR LESS IN DIAMETER ARE SUBSIDIARY TO PROJECT (NO SEPARATE PAY ITEM).
36. SHOULD ANY TREE ROOTS BE FOUND IN CONFLICT WITH PROPOSED CONSTRUCTION, THE CONTRACTOR SHALL HAVE A PROFESSIONAL ARBORIST PRUNE THE ROOTS TO PREVENT DAMAGE TO THE TREE. CONTRACTOR SHALL NOTIFY ENGINEER AT LEAST 2 DAYS PRIOR TO ANY ROOT PRUNING ACTIVITIES.
37. THE CONTRACTOR IS RESPONSIBLE FOR KEEPING STREETS, DRIVEWAYS AND SIDEWALKS ADJACENT TO THE PROJECT FREE OF MUD AND DEBRIS FROM THE CONSTRUCTION AT ALL TIMES.
38. MAIL BOXES WILL BE RESET AS DIRECTED IN THE PLANS OR BY THE ENGINEER. ALL MAIL BOXES TO BE REMOVED SHALL BE TEMPORARILY LOCATED AS TO NOT INTERRUPT MAIL SERVICE AND RESET AS SOON AS ALLOWED BY CONSTRUCTION ACTIVITIES. **2** ALL MAIL BOXES DAMAGED BY CONSTRUCTION ACTIVITIES SHALL BE REPLACED WITH MAIL BOXES OF EQUAL OR BETTER QUALITY, AND OF A **2** IDENTICAL STYLE TO THOSE BEING REPLACED.
39. ADJUSTMENT OF UNPAVED DRIVEWAYS BEHIND PROPERTY LINE AND RESTORATION OF THE SURFACE TO EQUAL OR BETTER THAN THE ORIGINAL IS INCIDENTAL WORK ON THIS PROJECT. CONTRACTOR MUST COORDINATE WITH THE ENGINEER AND PROPERTY OWNER PRIOR TO ACCESSING OR WORKING ON PRIVATE PROPERTY. HARMONIZATION IS INCIDENTAL TO THE RELATED WORK. NO ADDITIONAL PAYMENT WILL BE MADE.
40. EXISTING UTILITIES ARE SHOWN AT APPROXIMATE LOCATIONS AND DEPTHS BASED ON BEST AVAILABLE RECORDS AND LIMITED FIELD DATA. NOT ALL UTILITIES MAY BE SHOWN. THE CONTRACTOR SHALL VERIFY EXACT LOCATIONS AND DEPTHS OF ALL UTILITIES PRIOR TO BEGINNING CONSTRUCTION. ANY DAMAGES TO UTILITIES SHALL BE REPAIRED AT CONTRACTOR'S EXPENSE.
41. CALL 1-800-DIG-TESS (1-800-344-8377) AT LEAST TWO WORKING DAYS PRIOR TO BEGINNING CONSTRUCTION, SO THAT THE LOCATION OF UTILITIES CAN BE MARKED. IF NECESSARY, TEST DITCHES SHALL BE DUG TO VERIFY/DETERMINE ACTUAL FIELD LOCATIONS AND CONDITIONS. **2** LOCATION OF CITY UTILITIES TO BE PROVIDED BY THE CITY OF LUCAS
42. THE CONTRACTOR SHALL PROVIDE A TRENCH SAFETY PLAN. THIS DOCUMENT SHALL BE SUBMITTED TO THE CITY OF LUCAS AT THE PRE CONSTRUCTION CONFERENCE OR PRIOR TO THE START OF CONSTRUCTION.
43. NO STOP OR YIELD SIGN IS TO BE RELOCATED OR REMOVED WITHOUT PRIOR APPROVAL BY THE CITY. THE CONTRACTOR MUST CALL THE CITY'S PUBLIC WORKS DEPARTMENT AND OBTAIN PERMISSION FOR ANY CHANGCES IN THESE SIGNS.
44. ALL PAVEMENT MARKINGS, SIGN MATERIALS AND CONSTRUCTION SHALL CONFORM TO THE LATEST ADDITIONS OF THE STANDARD HIGHWAY DEPARTMENT SIGN DESIGN FOR TEXAS, THE TEXAS MANUAL OF UNIFORM TRAFFIC CONTROL DEVICES (TMUTCD) UNLESS NOTED OTHERWISE.
45. SIGN LOCATIONS SHOWN ON THE PLANS ARE DIAGRAMMATIC. SIGNS SHALL BE PLACED IN CONFORMANCE WITH THE LATEST EDITION OF TMUTCD.
46. PAYMENT FOR EACH SIGN SHALL INCLUDE ALL MOUNTING HARDWARE, THE SIGN POLE AND WEDGE BASE SYSTEM. (TXDOT SMD (TWT)-08).
47. REFLECTORIZED PAVEMENT MARKINGS SHALL BE THERMOPLASTIC, PER TXDOT STANDARD SPECIFICATIONS, ITEM 666. PAVEMENT MARKERS SHALL COMPLY WITH TXDOT STANDARD SPECIFICATIONS, ITEM 672.
48. ALL EXISTING SIGNS TEMPORARILY REMOVED BY THE CONTRACTOR SHALL BE PROTECTED FOR REINSTALLATION BY THE CONTRACTOR. ALL EXISTING SIGNS PERMANENTLY REMOVED SHALL BE SALVAGED.

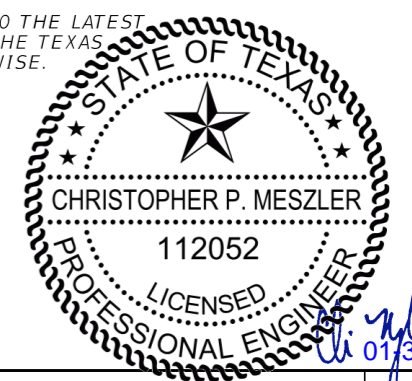

LAKES
ENGINEERING, INC.

CHRISTOPHER P. MESZLER, P.E.
LIC. No. 112052
1903 CENTRAL DRIVE, SUITE #405
BEDFORD, TX 76021
PHONE: 817.618.3640
TBPE REG. F-15243



BLONDY JHUNE RD. RECONST.
CITY OF LUCAS
PUBLIC WORKS DEPARTMENT
665 COUNTRY CLUB ROAD
LUCAS, TX. 75002

GENERAL NOTES

SHEET NO.

7

CALL BEFORE YOU DIG
TEXAS ONE CALL PARTICIPANTS REQUEST
48 HOURS NOTICE BEFORE YOU DIG, DRILL,
OR BLAST - STOP CALL

TEXAS ONE CALL SYSTEM
1-800-DIG-TESS



01/29/2019
1:46:25 PM
X:\17-113 Blondy Jhune\1800457\4 - Design\Plan_Set\3. Roadway\gmnrtd01[REV 2].DGN

JBogges
1/29/2019
1:46:25 PM
X:\17-113 Blondy Jhune\1800457\4 - Design\Plan_Set\3. Roadway\gmnrtd01[REV 2].DGN

01/29/19

SUMMARY OF QUANTITIES - BLONDY JHUNE ROAD

				BASE		ADD ALTERNATIVE 1		
ITEM-CODE			DESCRIPTION	UNIT	TOTAL		TOTAL	
ITEM NO.	DESC. CODE	SP NO			EST.	FINAL	EST.	FINAL
100	6001		PREPARING ROW	AC	3.25		0.76	
105	6011		REMOVING STAB BASE AND ASPH PAV (2"-6")	SY	12552		3265	
110	6001		EXCAVATION (ROADWAY)	CY	3609.6		2275.3	
132	6001		EMBANKMENT (FINAL)(ORDINARY COMPACTION)(TY A)	CY	2540.0		625.4	
134	6003		BACKFILL (TYPE C)	LF	94		26	
160	6003		FURNISHING AND PLACING TOPSOIL (4")	SY	4971		1242	
162	6002		BLOCK SODDING	SY	3840		1242	
162	6004		MULCH SODDING	SY	1829		0	
166	6001		FERTILIZER	AC	1.03		0.26	
169	6003		SOIL RETENTION BLANKETS (CL 1) (TY C)	SY	76		0	
260	6079		LIME TREATED (SUBGRADE)(6")	SY	13482		3758	
360	6000		CONC PVMT (CONT REINF - CRCP) (6")	SY	5378		0	
360	6002		CONC PVMT (CONT REINF - CRCP) (8")	SY	12660		3464	
432	6058		BEDDING MATERIAL (VARIABLE)	CY	26.9		0.1	
432	6060		RIPRAP (TYPE R)(24 IN)(GROUTED)	CY	247.0		86.8	
464	6003		RC PIPE (CL III)(18 IN)	LF	300		30	
464	6005		RC PIPE (CL III)(24 IN)	LF	50		93	
464	6007		RC PIPE (CL III)(30 IN)	LF	80		0	
464	6008		RC PIPE (CL III)(36 IN)	LF	120		0	
465	6187		INLET (COMPL)(DROP)(TY 1)(1 GRATE)	EA	1		0	
466	6005		HEADWALL (CH - FW - 0) (DIA = 24 IN)	EA	2		3	
466	6007		HEADWALL (CH - FW - 0) (DIA = 30 IN)	EA	4		0	
466	6009		HEADWALL (CH - FW - 0) (DIA = 36 IN)	EA	2		0	
466	6039		HEADWALL (CH - FW - 30) (DIA = 36 IN)	EA	2		0	
466	6050		HEADWALL (CH - FW - 45) (DIA = 24 IN)	EA	0		1	
467	6363		SET (TY II) (18 IN) (RCP) (6: 1) (P)	EA	20		2	
506	6001		ROCK FILTER DAMS (INSTALL) (TY 1)	LF	229		36	
506	6011		ROCK FILTER DAMS (REMOVE)	LF	229		36	
506	6022		CONSTRUCTION EXITS (INSTALL) (TY 3)	SY	356		178	
506	6024		CONSTRUCTION EXITS (REMOVE)	SY	356		178	
506	6038		TEMP SEDMT CONT FENCE (INSTALL)	LF	4604		1684	
506	6039		TEMP SEDMT CONT FENCE (REMOVE)	LF	4604		1684	
529	6005		CONC CURB (MONO) (TY II)	LF	1471		0	
530	6004		DRIVEWAYS (CONC)	SY	1095		276	
530	6017		DRIVEWAYS (CONC)(HES)(6") (4000 PSI)	CY	100		0	
533	6002		RUMBLE STRIPS (CENTERLINE)	LF	2254		1224	
533	6005		RUMBLE STRIPS (SHOULDER) CONCRETE	LF	4791		3648	
550	6003		CHAIN LINK FENCE (REMOVE)	LF	41		169	
550	6026		CHAIN LINK FENCE (INSTALL)(5')	LF	41		169	
560	6011		MAILBOX INSTALL-S (TWW-POST) TY 4	EA	6		2	
644	6060		IN SM RD SN SUP & AM TY TWT(1)WS(P)	EA	34		0	
644	6076		REMOVE SM RD SN SUP & AM	EA	18		0	
666	6011		REFL PAV MRK TY I (W) 4" (SLD)(090 MIL)	LF	10461		2235	
666	6125		REFL PAV MRK TY I (Y) 4" (SLD)(090 MIL)	LF	10520		2398	
666	6224		PAVEMENT SEALER 4 INCH	LF	20981		4633	
672	6009		REFL PAV MRKR TY II-A-A	EA	164		30	
672	6010		REFL PAV MRKR TY II-B-B	EA	6		3	
677	6001		ELIM EXT PAV MRK & MARKS (4")	LF	1556		0	
678	6001		PAV SURF PREP FOR MRK (4")	LF	20981		4633	
678	6033		PAV SURF PREP FOR MRK (RPM)	EA	164		30	
1004	6001		TREE PROTECTION	LS	1		1	
TRAFFIC CONTROL								
500	6001		MOBILIZATION	LS	1		1	
502	6001		BARRICADES, SIGNS AND TRAFFIC HANDLING	LS	1		1	
510	6001		ONE-WAY TRAF CONT (FLAGGER CONT)	LS	1		1	
512	6001		PORT CTB (FUR & INST)(SGL SLOPE)(TY 1)	LS	1		1	
512	6025		PORT CTB (MOVE)(SGL SLP)(TY 1)	LS	1		1	
512	6049		PORT CTB (REMOVE)(SGL SLP)(TY 1)	LS	1		1	
560	6011		MAILBOX INSTALL-S (TWW-POST) TY 4	LS	1		1	
662	6063		WK ZN PAV MRK REMOV (W)4"(SLD)	LS	1		1	
662	6095		WK ZN PAV MRK REMOV (Y)4"(SLD)	LS	1		1	
6001	6001		PORTABLE CHANGEABLE MESSAGE SIGN	LS	1		1	

SUMMARY OF SIDE DRAIN & MITERED END SECTIONS

LOCATION	SIDE	PIPE LENGTH - LF	SET - EA	CONSTRUCTION REMARKS
		ROUND (0464 6003)	ROUND (0467 6363)	
STA. TO STA.		18" RCP	18" (6:1)	
		P	P	
112+80.14 TO 113+10.14	RT	30.0	2	
126+57.34 TO 126+91.04	RT	30.0	2	
126+94.55 TO 127+16.42	LT	24.0	2	
146+60.63 TO 146+86.77	LT	26.0	2	
148+14.95 TO 148+41.19	LT	26.0	2	
148+85.18 TO 149+10.84	RT	26.0	2	
150+59.62 TO 150+85.87	LT	26.0	2	
157+01.97 TO 157+31.69	LT	31.0	2	
163+87.13 TO 164+13.13	LT	26.0	2	
166+39.84 TO 166+65.29	LT	26.0	2	
175+79.66 TO 176+34.01	RT	58.9	2	
SUB-TOTAL:		329.9	22	
TOTAL:		330	22	

PAY ITEM NOTES:

COST FOR ALL TESTING AND SAMPLING REQUIRED PER THE STANDARD SPECIFICATION AND GENERAL NOTES IS TO BE INCLUDED IN THE RELATED PAY ITEMS.

- 260 6079 QUANTITY PROVIDED INCLUDES AREA OF CONCRETE PAVEMENT REPLACEMENT ON DETOUR ROUTE.
- 360 6000 INCLUDES 2200'x22' CONCRETE PAVEMENT REPLACEMENT ON DETOUR ROUTE. 6" CONC., #4@18" OCEW.
- 466 6039 INCLUDES CONCRETE DISSIPATOR BLOCKS WHERE SHOWN IN PLANS.
- 506 6022 QUANTITY IS NOT A PLAN QUANTITY AND MAY BE INCREASED OR DECREASED BASED ON CONTRACTOR'S PHASING AND WORK ZONE. NO ADDITIONAL PAYMENT PROVIDED.
- 550 6003 CONTRACTOR SHALL MATCH EXISTING FENCE TYPE, MATERIAL, CONSTRUCTION, AND HEIGHT WHERE REPLACING FENCING. NO ADDITIONAL PAYMENT FOR VARYING FENCE TYPES.
- 550 6026
- 506 6038 INCLUDES REQUIRED INSPECTIONS WEEKLY AND AFTER RAIN EVENTS. NO EXTRA PAYMENT FOR REPAIRS TO EXISTING INSTALLATIONS.
- 560 6011 EXISTING MAILBOXES TO BE RELOCATED SHALL BE PRESERVED AND INSTALLED OR REPLACED IN EQUAL OR BETTER CONDITION MATCHING MATERIAL TYPE, SIZE, AND COLOR. NO ADDITIONAL PAYMENT PROVIDED FOR VARYING MAILBOX TYPES.
- 1004 6001 PROVIDE TREE PROTECTION ON ALL TREES GREATER THAN 6 IN DIAMETER WITHIN 5 FT OF PROPOSED WORK OR WORK ZONE. LUMP SUM ITEM INCLUDES ALL TREES AS DESCRIBED AND DIRECTED BY THE ENGINEER.

6001 6001 INCLUDES ALL PCMS FOR THE DURATION OF THE PROJECT.

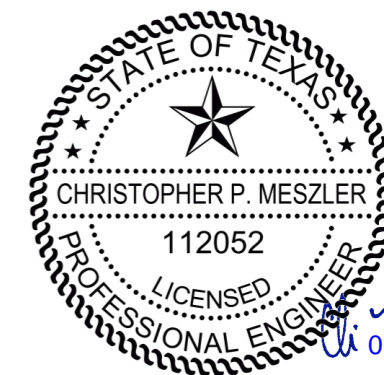

CALL BEFORE YOU DIG
TEXAS ONE CALL PARTICIPANTS REQUEST
48 HOURS NOTICE BEFORE YOU DIG, DRILL,
OR BLAST - STOP-CALL

JBogge
1/31/2019
10:19:20 AM
X:\17-113 Blondy Jhune\1800457\4 - Design\Plan Set\3. Roadway\Roadsum01(REV 2).dgn

REVISIONS	
DATE	DESCRIPTION
01/18/19	1 BID ITEMS UPDATED
01/29/19	2 ADDED PAY ITEMS AND NOTE



CHRISTOPHER P. MESZLER, P.E.
LIC. No. 112052
1903 CENTRAL DRIVE, SUITE #405
BEDFORD, TX 76021
PHONE: 817.618.3640
TBPE REG. F-15243



BLONDY JHUNE RD. RECONST.
CITY OF LUCAS
PUBLIC WORKS DEPARTMENT
665 COUNTRY CLUB ROAD
LUCAS, TX. 75002

ESTIMATES AND SUMMARY OF QUANTITIES

SHEET NO.
8

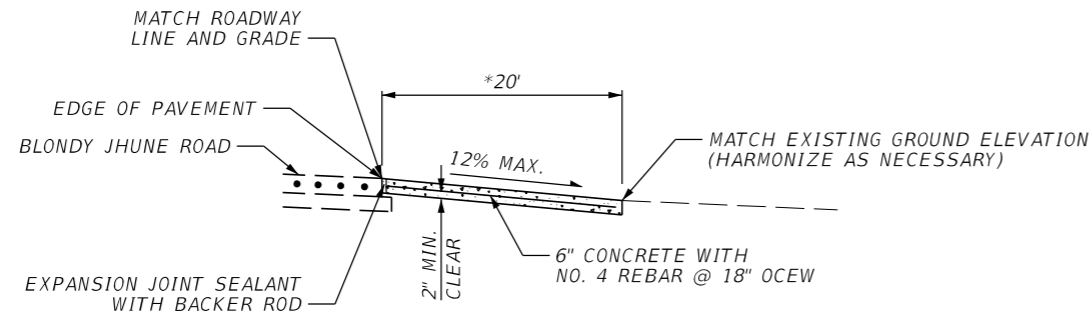

* DIMENSION MAY VARY AS SHOWN IN PLANS

DRIVEWAY TYPICAL PROFILE

(WITHOUT SIDEDRAIN)

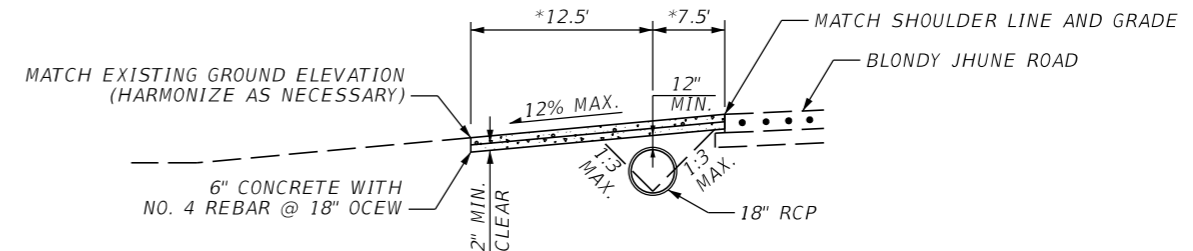

* DIMENSION MAY VARY AS SHOWN IN PLANS

DRIVEWAY TYPICAL PROFILE

(WITH SIDEDRAIN)

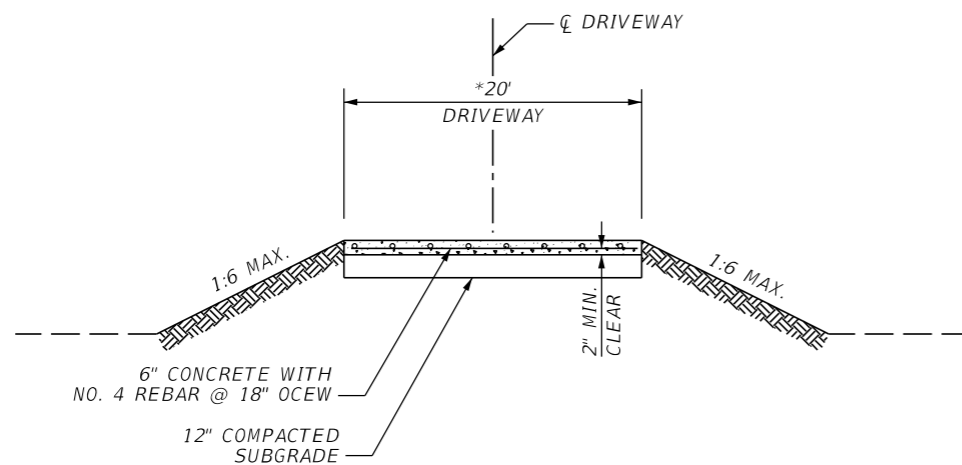

* DIMENSION MAY VARY AS SHOWN IN PLANS

DRIVEWAY TYPICAL SECTION

(WITHOUT SIDEDRAIN)

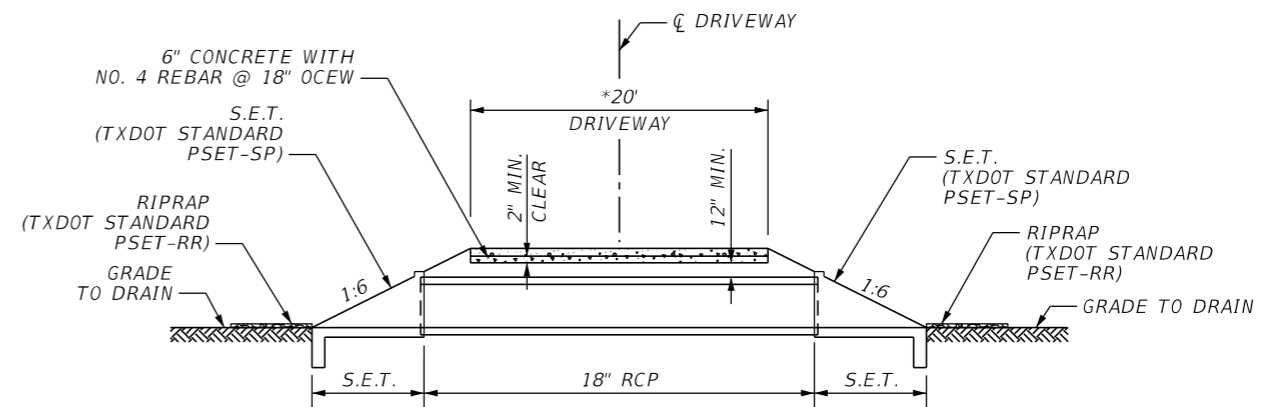

* DIMENSION MAY VARY AS SHOWN IN PLANS

DRIVEWAY TYPICAL SECTION

(WITH SIDEDRAIN)

NOTES:

- DRIVEWAY MAY BE EXTENDED BEYOND RIGHT OF WAY LINE AS REQUIRED TO MEET EXISTING GRADE. COORDINATE WITH PROPERTY OWNER AND CITY.
- EXACT LOCATIONS, DIMENSIONS, AND TYPE MAY BE FIELD MODIFIED WITH PRIOR APPROVAL FROM THE CITY.
- SIDE DRAINS TO BE INSTALLED WHERE ROADSIDE SWALE DRAINAGE IS PRESENT, AS INDICATED ON PLANS AND/OR AS DIRECTED BY THE ENGINEER.
- SIDE DRAINS TO BE INSTALLED WITH A MINIMUM OF 12" COVER, NOT INCLUDING CONCRETE DRIVEWAY THICKNESS.
- PLACE BACKFILL EQUALLY ALONG BOTH SIDES OF THE PIPE IN UNIFORM LIFTS (8 IN. MAX.). COMPACT EACH LIFT MECHANICALLY. THOROUGHLY COMPACT MATERIALS PLACED UNDER THE HAUNCHES OF THE PIPE TO PREVENT DAMAGE OR DISPLACEMENT OF THE PIPE. CONTINUE TO PLACE BACKFILL IN THIS MANNER TO THE TOP-OF-PIPE ELEVATION. PLACE AND COMPACT BACKFILL ABOVE THE TOP OF THE PIPE IN UNIFORM LIFTS (8 IN. MAX.).
- USE HIGH-EARLY STRENGTH 4,000 PSI CONCRETE AS DIRECTED BY THE ENGINEER.

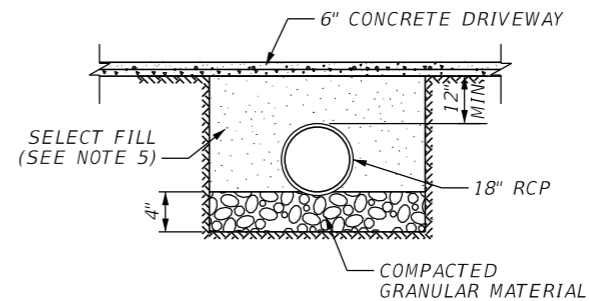

BACKFILL AND BEDDING DETAIL



CALL BEFORE YOU DIG
TEXAS ONE CALL SYSTEM
1-800-DIG-TESS
OR BEST - STOP-CALL

PLOTTED BY: JBoggs
 PLOT DATE: 1/29/2019
 LAST SAVED: 2:26:46 PM
 LOCATION: X:\17-113 Blondy Jhune\1800457\4 - Design\Plan Set\3. Roadway\spdtrd03.DGN

DATE	REVISIONS DESCRIPTION
01/29/19	2 DRIVEWAY NOTE ADDED

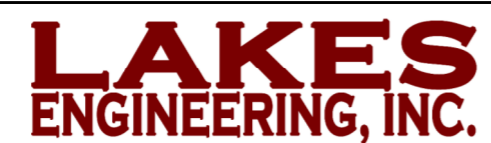

CHRISTOPHER P. MESZLER, P.E.
 LIC. No. 112052
 1903 CENTRAL DRIVE, SUITE #405
 BEDFORD, TX 76021
 PHONE: 817.618.3640
 TBPE REG. F-15243



BLONDY JHUNE RD. RECONST.
 CITY OF LUCAS
 PUBLIC WORKS DEPARTMENT
 665 COUNTRY CLUB ROAD
 LUCAS, TX. 75002

DRIVEWAY DETAILS

SHEET NO.
24