

NOTE THAT THIS DRAWING MAY HAVE BEEN ALTERED IN SCALE BY REPRODUCTION

W.O. 5686

LEGAL DESCRIPTION:

LOTS 1, 2, 71, 72, 73, AND 74, SUNNY SHORES, ACCORDING TO THE PLAT THEREOF RECORDED IN PLAT BOOK 24, PAGE 15, OF THE PUBLIC RECORDS OF PINELLAS COUNTY, FLORIDA.

AND

LOT 3, TOGETHER WITH ALL LAND LYING BETWEEN THE SAID LOT 3 AND THE WATERS OF THE GULF OF MEXICO, SUNNY SHORES, ACCORDING TO PLAT THEREOF AS RECORDED IN PLAT BOOK 24, PAGE 15, OF THE PUBLIC RECORDS OF PINELLAS COUNTY, FLORIDA.

AND

LOTS 1, 2, 3, AND 4, MADEIRA SHORES, ACCORDING TO THE MAP OR PLAT THEREOF, AS RECORDED IN PLAT BOOK 22, PAGE 87, OF THE PUBLIC RECORDS OF PINELLAS COUNTY, FLORIDA.

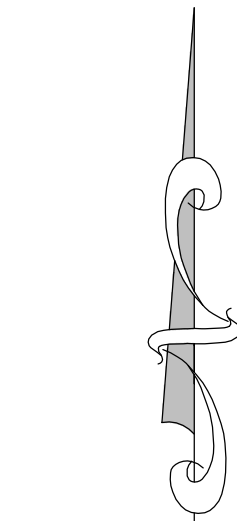

0 20' 40'

SYMBOL LEGEND

- Backflow Preventor
- Cable Box
- Centerline
- Cleanout
- Decorative Light
- Drainage Manhole
- Fire Hydrant
- Grease Trap
- Guy Anchor
- Handicap
- Lightpole
- Mailbox
- Power Box
- Sanitary Manhole
- Sign
- Spot Elevation
- Telephone Box
- Utility Pole
- Water Meter
- Water Valve
- Well

LEGEND

- (C) = Calculated Data
- (D) = Data per Description
- (F) = Field Determined
- (M) = Measured Data
- (P) = Data per Plat
- +/- = Plus or Minus
- BVIF = Air Conditioner
- BFE = Barbed Fence
- BFP = Base Flood Elevation
- CB = Backflow Preventor
- CB = Chord Bearing
- CH = Chord
- C.A.B. = Condominium Plat Book
- C/C = Covered Concrete
- C/S = Concrete Slab
- CSW = Concrete Sidewalk
- CCCL = Coastal Construction Control Line
- CL = Centerline
- CLF = Chainlink Fence
- COV. = Covered
- CLP = Concrete Light Pole
- CMP = Corrugated Metal Pipe
- CONC. = Concrete
- Δ = Delta Angle
- D.B. = Dead Book
- DW = Driveway
- DMH = Drainage Manhole
- EIP = Edge of Pavement
- EL = Elevation
- EOW = Edge of Water
- F = Found
- FCIR = Found Iron Rod & Cap
- FCM = Found Concrete Monument
- FDOT = Florida Department of Transportation
- FFE = Finished Floor Elevation
- FIR = Found Iron Pipe
- FIR = Found Iron Rod No Cap
- FMN = Found May Nail
- FND = Found Nail & Disk
- FPP = Found Pinched Pipe
- FRD = Found Rivet & Disk
- G.I. = Gate Inlet
- GV = Gate Valve
- HYD = Fire Hydrant
- I.E. = Invert Elevation
- LB = Corporate Certificate Number
- LP = Light Pole
- LFE = Lowest Floor Elevation
- M.O.L. = More or Less
- MES = Mitered End Section
- N&D = Nail & Disk
- NFNS = Not Found and Not Set
- OCS = Outfall Control Structure
- OHW = Overhead Wire
- O.R. = Official Records Book
- P.B. = Plat Book
- PCP = Permanent Control Point
- POS(s) = Page(s)
- PLS = Professional Land Surveyor
- POB = Point of Beginning
- POC = Point of Commencement
- PRC = Point of Reverse Curvature
- PRM = Permanent Reference Monument
- R = Radius
- RGE = Range
- R/W = Right-of-way
- RCP = Reinforced Concrete Pipe
- SCM = Set Concrete Monument PLS #2865
- SCIR = Set Iron Rod & Cap 5/8" PLS #2865
- SMH = Sanitary Manhole
- SMN = Set May Nail
- SND = Set Nail & Disk PLS #2865
- TBM = Temporary Benchmark
- TOS = Top of Slope
- TYP = Typical
- UB = Utility Box
- UP = Utility Pole
- VF = Vinyl Fence
- WF = Wood Fence
- WM = Water Meter
- W.O. = Work Order
- WV = Water Valve

LINE LEGEND

- Boundary Lines
- Water Line
- Telephone Line
- Gas Line
- Sanitary Sewer Line
- Storm Sewer Line
- Overhead Wire Lines
- Fence - Wire
- Fence - Chain Link
- Fence - Vinyl
- Fence - Wood
- Reclaimed Water Main

BOUNDARY AND TOPOGRAPHIC SURVEY

SECTION 9, TOWNSHIP 31 SOUTH, RANGE 15 EAST  
PINELLAS COUNTY, FLORIDA

SURVEY NOTES:

- THIS SURVEY WAS PERFORMED WITH THE BENEFIT OF:  
  
A TITLE COMMITMENT ISSUED BY FIDELITY NATIONAL TITLE INSURANCE COMPANY, COMMITMENT NO. FTPA15-16038, EFFECTIVE DATE: SEPTEMBER 1, 2015 AT 11:00 PM. PERTAINS TO LOT 4, MADEIRA SHORES ONLY.  
  
AND  
  
A TITLE COMMITMENT ISSUED BY OLD REPUBLIC NATIONAL TITLE INSURANCE COMPANY, FILE REFERENCE: 019673-000008, EFFECTIVE DATE: 03/14/14 11:00 PM. PERTAINS TO LOTS 1, 2, 71, 72, 73, AND 74, SUNNY SHORES ONLY.  
  
NO DOCUMENTS REFERENCED BY THESE COMMITMENTS WERE PROVIDED TO THIS SURVEYOR.
- PLANIMETRIC FEATURES SHOWN HEREON WERE DETERMINED BY STANDARD FIELD SURVEYING METHODS.
- BEARING BASIS IS THE SOUTHWESTERLY RIGHT-OF-WAY OF GULF BOULEVARD BEING N46°09'54"W PER PLAT.
- ALL INSTRUMENTS SHOWN HEREON ARE OF THE PUBLIC RECORDS OF PINELLAS COUNTY, FLORIDA, UNLESS OTHERWISE SPECIFIED.
- UNDERGROUND UTILITIES SHOWN HEREON ARE BASED ON SURFACE MARKINGS AND OR STRUCTURES. NO EXCAVATION WAS PERFORMED FOR THE LOCATION OF SUCH UTILITIES.
- ADDITIONS OR DELETIONS TO THIS SURVEY MAP AND/OR REPORT BY OTHER THAN THE SIGNING PARTY OR PARTIES IS PROHIBITED WITHOUT WRITTEN CONSENT OF THE SIGNING PARTY OR PARTIES.
- THIS PARCEL APPEARS TO BE IN FLOOD ZONES "AE"(EL 10 FEET), "AE"(EL 11 FEET), "VE"(EL 12 FEET) AND "VE"(EL 13 FEET) ACCORDING TO THE FLOOD INSURANCE RATE MAP, MAP NUMBER: 121030191H, MAP EFFECTIVE DATE: 08/24/2021, AS PROVIDED BY THE FEDERAL EMERGENCY MANAGEMENT AGENCY.  
  
THIS MAP'S NOTES STATE THAT THE BASE FLOOD ELEVATIONS SHOWN REPRESENT ROUNDED WHOLE-FOOT ELEVATIONS AND THEREFORE MAY NOT EXACTLY REFLECT THE FLOOD ELEVATION DATA PRESENTED IN THE FLOOD INSURANCE STUDY (FIS) REPORT. THE FIS REPORT WAS NOT CONSULTED FOR THIS SURVEY.  
  
FLOOD ZONE LINES SHOWN HEREON WERE TRANSFERRED BY GRAPHIC METHODS FROM THE FLOOD ZONE MAP, AND ARE SUBJECT TO THE INHERENT INACCURACIES OF SUCH TRANSFERS. THESE FLOOD ZONE LINES ARE PROVIDED FOR INFORMATIONAL PURPOSES ONLY, AND ANY PROPOSED FINISHED FLOOR ELEVATIONS ARE TO BE DETERMINED BY THE PERMITTING AGENCY HAVING JURISDICTION.

- AS THE FLOOD ZONE "AE" (EL 11') SHOWN HEREON IS LANDWARD OF A COASTAL HIGH HAZARD AREA (V ZONE), IT IS CONSIDERED A COASTAL A ZONE.
- LOCATIONS OF TREES SHOWN HEREON WERE LIMITED TO TREES 4" DIAMETER AT BREAST HEIGHT (DBH) OR LARGER.
- GEODATA SERVICES INC. CAN ACCEPT NO RESPONSIBILITY FOR THE IDENTIFICATION OF THE TREE SPECIES SHOWN HEREON. ALTHOUGH EVERY EFFORT HAS BEEN MADE TO PROPERLY IDENTIFY THE TREES SHOWN HEREON, TREE IDENTIFICATION IS OUTSIDE THE EXPERTISE OF A PROFESSIONAL LAND SURVEYOR. THE TREE TYPES SHOWN HEREON ARE FOR INFORMATIONAL PURPOSES ONLY AND SHOULD BE USED AFTER CONFIRMATION BY A CERTIFIED ARBORIST OR OTHER SUCH PROFESSIONAL.
- THE MEAN HIGH WATER LINE ELEVATION SHOWN HEREON IS BASED UPON TIDE INTERPOLATION POINTS ID:100112, AND ID:100113, AS PUBLISHED BY THE LAND BOUNDARY INFORMATION SYSTEM OF THE STATE OF FLORIDA.
- ELEVATION BASIS: NORTH AMERICAN VERTICAL DATUM 1988 (NAVD88). BENCHMARK UTILIZED: DNR "15-90-DA-25A", WITH AN ELEVATION OF 4.28 FEET.

SURVEYOR'S CERTIFICATION:

I, DENNIS J. EYRE, THE SURVEYOR IN RESPONSIBLE CHARGE, HEREBY CERTIFY THAT THE SURVEY REPRESENTED HEREON AND THAT SAID ABOVE GROUND SURVEY AND SKETCH ARE ACCURATE TO THE BEST OF MY KNOWLEDGE AND BELIEF. SURVEY NOT VALID WITHOUT THE SIGNATURE AND ORIGINAL RAISED SEAL OF A FLORIDA LICENSED SURVEYOR AND MAPPER, OR ELECTRONIC DIGITAL SIGNATURE IN ACCORDANCE WITH STATE OF FLORIDA ADMINISTRATIVE CODE RULE 5J-17.062.

DENNIS J. EYRE, P.L.S. FLA. REG. No. 2865  
DATE: NOVEMBER 1, 2021

THIS SURVEY CONSISTS OF 2 SHEETS, IT IS NOT FULL, OR COMPLETE, WITHOUT BOTH SHEETS.  
AN UNSIGNED SURVEY DRAWING IS FOR INFORMATIONAL PURPOSES ONLY.

W.O. # 5686	FIELD DATE: OCTOBER 3, 2018
DRAWN BY: E.J. P.T.	REVISED FLOOD ZONE DATE: NOVEMBER 1, 2021
CHECKED BY: D.J.E.	
SCALE: 1"= 20'	
FIELD BOOK / PAGE(S): 7-17/72-76	
SHEET 1 OF 2	

GEODATA SERVICES INC.  
1166 KAPP DRIVE  
CLEARWATER, FL 33765  
PHONE: (727) 447-1763



LB 7466

NOTE THAT THIS DRAWING MAY HAVE BEEN ALTERED IN SIZE BY REPRODUCTION.



W.O. 5686

# BOUNDARY AND TOPOGRAPHIC SURVEY

SECTION 9, TOWNSHIP 31 SOUTH, RANGE 15 EAST  
PINELLAS COUNTY, FLORIDA

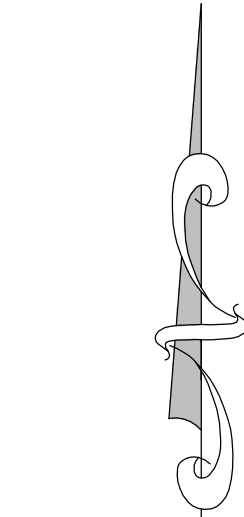

0 20' 40'

## SYMBOL LEGEND

- Backflow Preventor
- Cable Box
- Centerline
- Cleanout
- Decorative Light
- Drainage Manhole
- Fire Hydrant
- Grease Trap
- Guy Anchor
- Handicap
- Lightpole
- Mailbox
- Power Box
- Sanitary Manhole
- Sign
- Spot Elevation
- Telephone Box
- Utility Pole
- Water Meter
- Water Valve
- Well

## TREE LEGEND

- OAK
- PALM
- NORFOLK PINE
- BANYON

NOTE:  
ALL SIZES ARE IN INCHES

## LEGEND

- (C) = Calculated Data
- (D) = Data per Description
- (F) = Field Determined
- (M) = Measured Data
- (P) = Data per Plat
- +/- = Plus or Minus
- A/C = Air Conditioner
- BNF = Barbed Fence
- BFE = Base Flood Elevation
- BFP = Backflow Preventor
- CB = Chord Bearing
- CH = Chord
- C.A.B. = Condominium Plat Book
- C/C = Covered Concrete
- C/S = Concrete Slab
- CSW = Concrete Sidewalk
- CCCL = Coastal Construction Control Line
- CL = Centerline
- CLF = Chainlink Fence
- COV. = Covered
- CLP = Concrete Light Pole
- CMP = Corrugated Metal Pipe
- CONC. = Concrete
- Δ = Delta Angle
- D.B. = Deed Book
- D/W = Driveway
- DMH = Drainage Manhole
- E/P = Edge of Pavement
- EL = Elevation
- EOW = Edge of Water
- F = Found
- FCIR = Found Iron Rod & Cap
- FCM = Found Concrete Monument
- FDOT = Florida Department of Transportation
- FFE = Finished Floor Elevation
- FIP = Found Iron Pipe
- FIR = Found Iron Rod No Cap
- FMN = Found May Nail
- FND = Found Nail & Disk
- FPP = Found Pinched Pipe
- FRD = Found Rivet & Disk
- G.I. = Gate Inlet
- GV = Gate Valve
- HYD = Fire Hydrant
- I.E. = Invert Elevation
- LB = Corporate Certificate Number
- LP = Light Pole
- LFE = Lowest Floor Elevation
- M.O.L. = More or Less
- MES = Mitred End Section
- N&D = Nail & Disk
- NFNS = Not Found and Not Set
- OCS = Outfall Control Structure
- OHW = Overhead Wire
- O.R. = Official Records Book
- P.B. = Plat Book
- PCP = Permanent Control Point
- PO(s) = Page(s)
- PLS = Professional Land Surveyor
- POB = Point of Beginning
- POC = Point of Commencement
- PRC = Point of Reverse Curvature
- PRM = Permanent Reference Monument
- R = Radius
- RGE = Range
- R/W = Right-of-way
- RCP = Reinforced Concrete Pipe
- SCM = Set Concrete Monument PLS #2885
- SCIR = Set Iron Rod & Cap 5/8" PLS #2885
- SMH = Sanitary Manhole
- SMN = Set May Nail
- SND = Set Nail & Disk PLS #2885
- TBM = Temporary Benchmark
- TOB = Top of Bank
- TOS = Top of Slope
- TWP = Township
- TYP = Typical
- UB = Utility Box
- UP = Utility Pole
- VF = Vinyl Fence
- WM = Water Meter
- W.O. = Work Order
- WV = Water Valve

## LINE LEGEND

- Boundary Lines
- Water Line
- Telephone Line
- Gas Line
- Sanitary Sewer Line
- Storm Sewer Line
- Overhead Wire Lines
- Fence - Wire
- Fence - Chain Link
- Fence - Vinyl
- Fence - Wood
- Reclaimed Water Main

GULF OF MEXICO

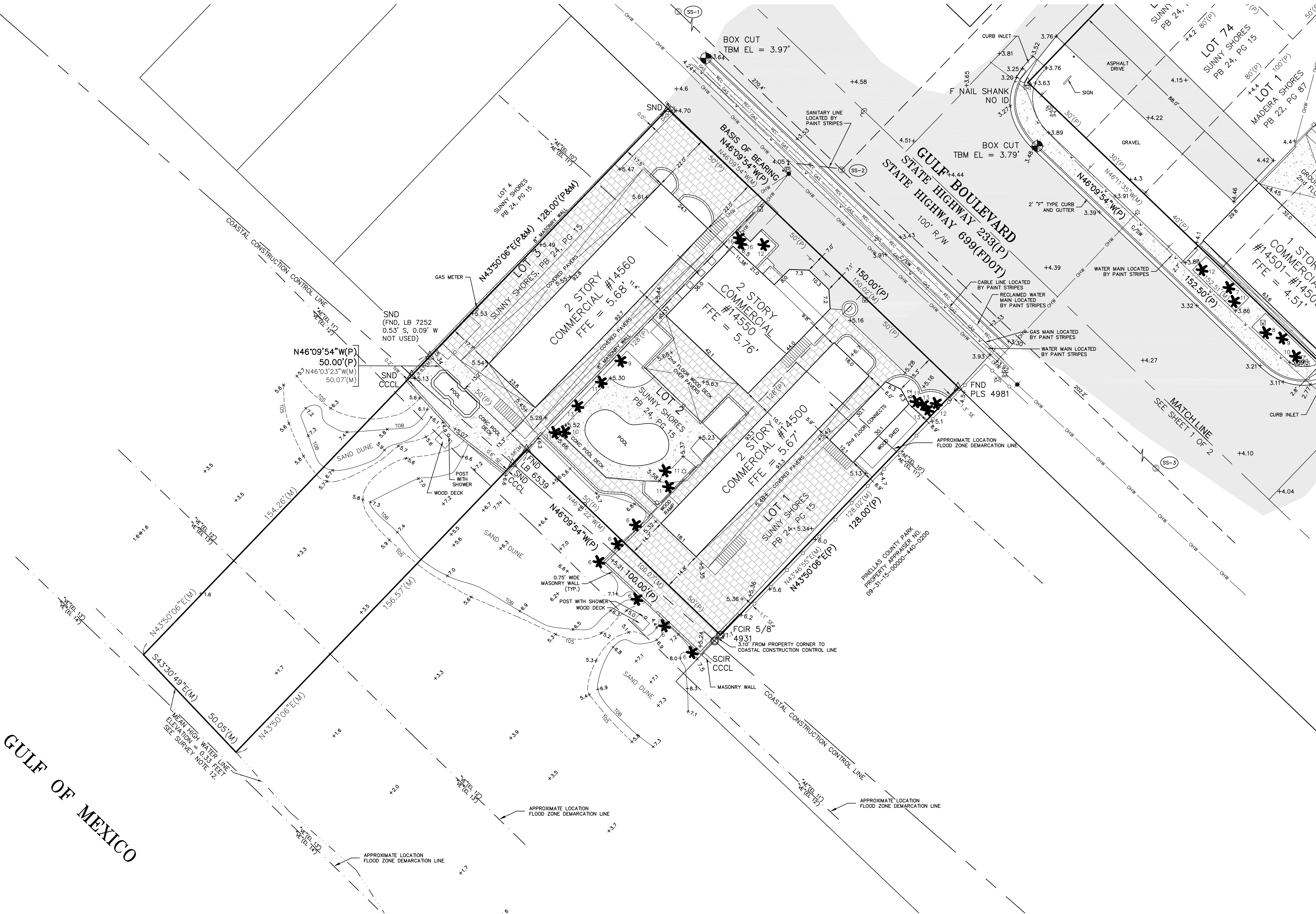

THIS SURVEY CONSISTS OF 2 SHEETS, IT IS NOT FULL, OR COMPLETE,  
WITHOUT BOTH SHEETS.  
AN UNSIGNED SURVEY DRAWING IS FOR INFORMATIONAL PURPOSES ONLY.

W.O. # 5686	FIELD DATE: OCTOBER 3, 2018
DRAWN BY: E.J. P.T.	REVISED FLOOD ZONE DATE: NOVEMBER 1, 2021
CHECKED BY: D.J.E.	
SCALE: 1" = 20'	
FIELD BOOK / PAGE(S): 7-17/72-76	
SHEET 2 OF 2	

**GEODATA SERVICES INC.**  
1166 KAPP DRIVE  
CLEARWATER, FL 33765  
PHONE: (727) 447-1763



LB 7466

NOTE THAT THIS DRAWING MAY HAVE BEEN ALTERED IN SCALE BY REPRODUCTION.