

31°20'00"N
31°19'00"N
31°18'00"N
31°17'00"N
31°16'00"N
31°15'00"N
31°14'00"N
31°13'00"N
31°12'00"N
31°11'00"N
31°10'00"N
31°09'00"N
31°08'00"N
31°07'00"N
31°06'00"N
31°05'00"N
31°04'00"N
31°03'00"N
31°02'00"N
31°01'00"N

96°56'00"W
96°55'30"W
96°55'00"W
96°54'30"W
96°54'00"W
96°53'30"W
96°53'00"W
96°52'30"W
96°52'00"W
96°51'30"W

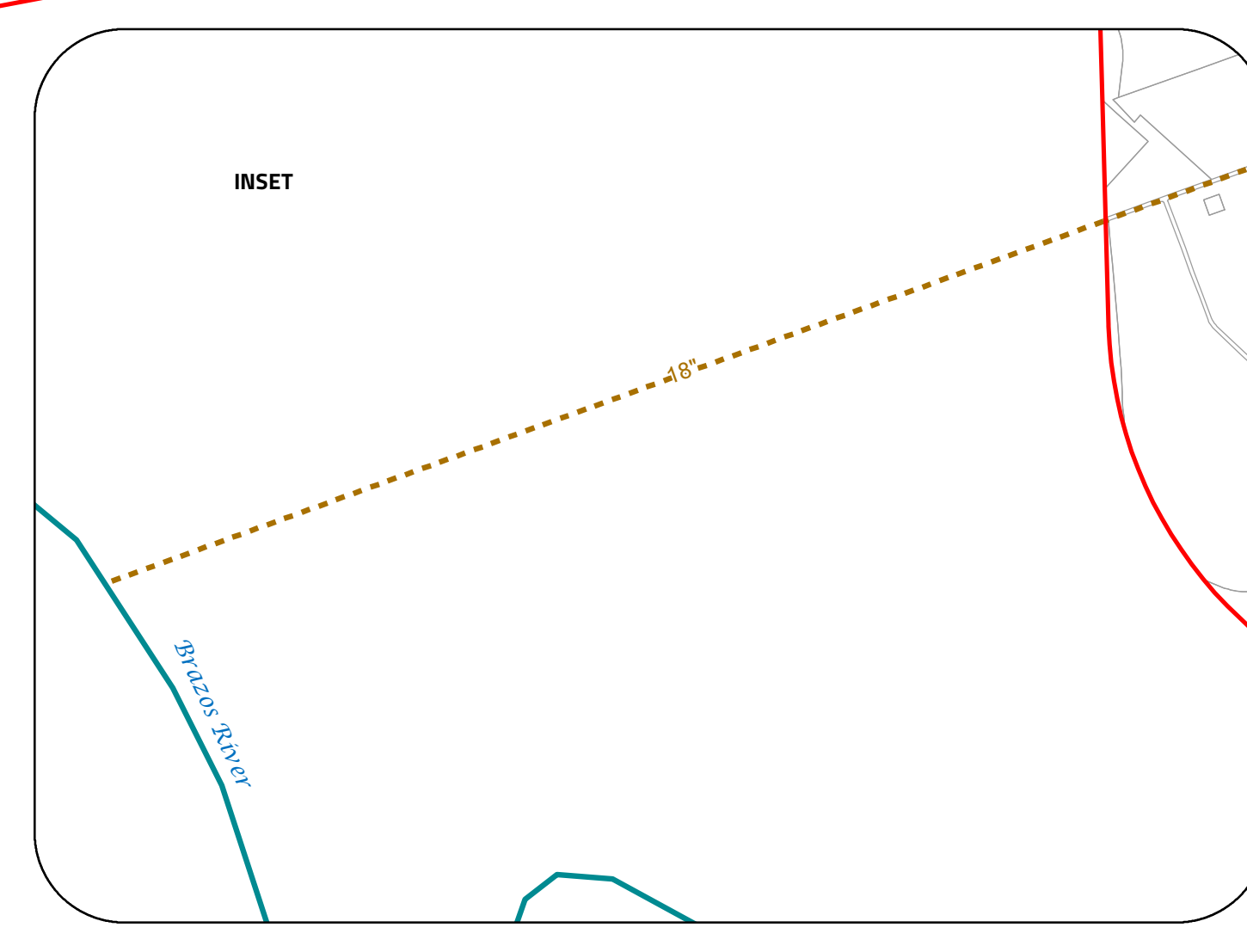

Symbol	Description
[Red outline]	City Limits
[Red outline]	Extraterritorial Jurisdiction
[Black square]	House
[Grey square]	Fiscal
[Grey line]	Unbuilt Right of Way
[Black line]	Bridge
[Black line]	Railroad
[Blue line]	Stream
[Blue area]	Lake or Pond
[Yellow area]	Multifamily Complex (Label Total Units)
[Blue line]	Water Lines* (Label Diameter)
[Red line]	DIAMETER: $\ge 12''$
[Green line]	DIAMETER: 3"
[Blue line]	DIAMETER: 4"
[Purple line]	DIAMETER: 6"
[Orange line]	DIAMETER: 8"
[Light blue line]	DIAMETER: 12"
[Dark blue line]	DIAMETER: 18"
[Black line]	FUNCTION: Distribution Line
[Dashed black line]	FUNCTION: Transmission Line
[Blue circle]	Water Line Components: Clear Wall
[Blue circle]	Water Line Components: Elevated Storage Tank
[Red cross]	Water Line Components: Fire Hydrant
[Black square]	Water Line Components: Generator
[Red square]	Water Line Components: Ground Storage Tank
[Blue circle]	Water Line Components: Pump Station
[Blue circle]	Water Line Components: Valve
[Yellow circle]	Water Line Components: Fire Protection Zone
[Green square]	Water Line Components: Water Treatment Pond

*INDIVIDUAL WATER LINE MATERIALS ARE UNKNOWN BUT THE SYSTEM IS COMPOSED OF DUCTILE IRON AND PVC.

GrantWorks, Inc.
2201 Northland Drive, Austin, TX 78756
Phone (512) 420-0303 Fax (512) 420-0302

FINANCED THROUGH THE TEXAS DEPARTMENT OF AGRICULTURE
Preparation of this document was financed through provisions of a
Texas Community Development Block Grant from the U.S. Department
of Housing and Urban Development.

This illustration was created using the best available data. Subsequent
additions, edits, & georectification performed by Grantworks, Inc.

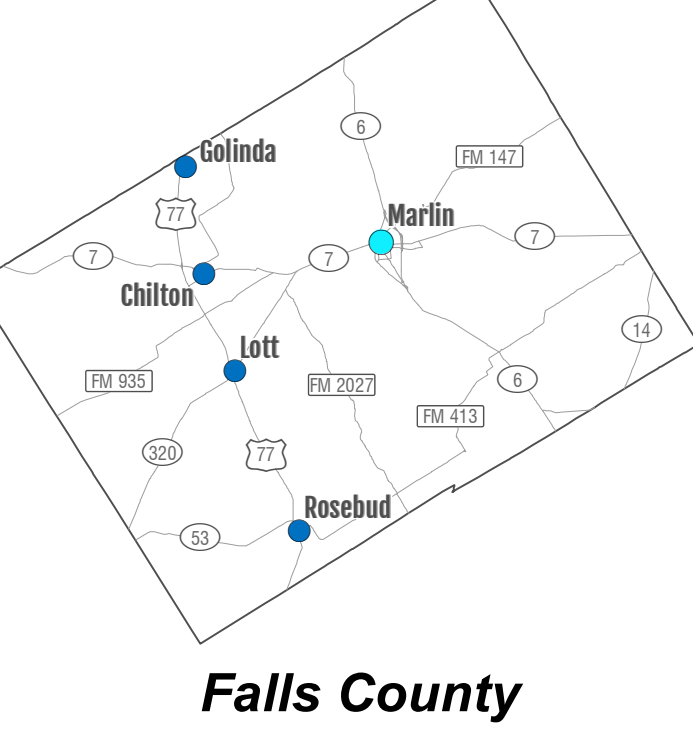
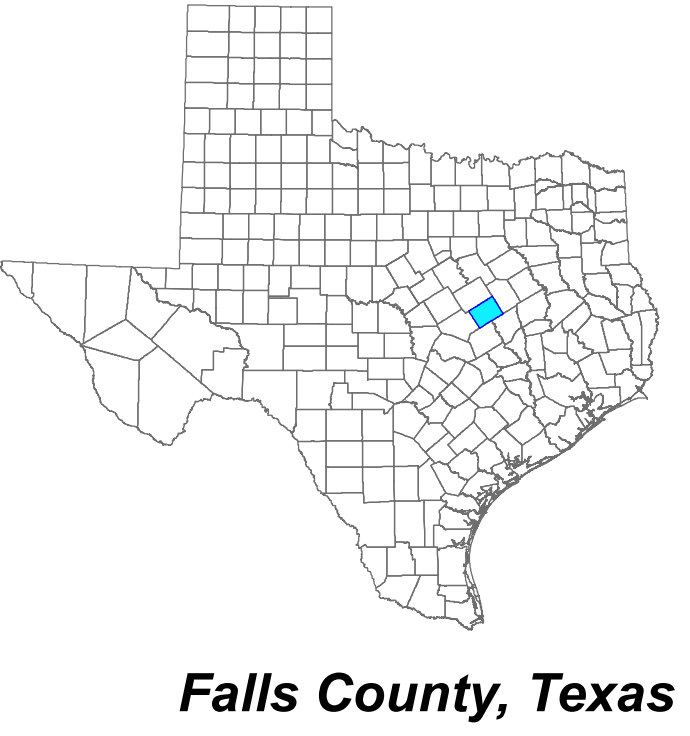

City of Marlin Falls County, Texas

Map 5A Existing Water System 2021 - Full Extent July 2022

Texas State Plane Zone 3
Texas Central
Projection: Lambert Conformal Conic
GCS North American 1983
Datum: D North American 1983

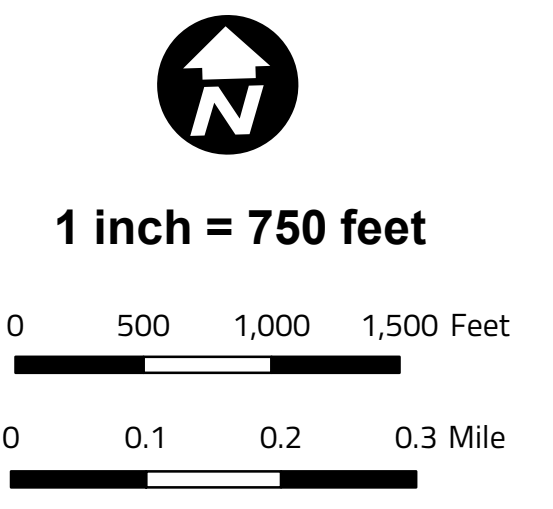

Disclaimer
The maps and documents included in this planning study are to be used for comprehensive planning purposes only as reference material provided for laypersons, whether they are public officials or members of the general public. Recommendations for infrastructure improvements in this study, which are derived from engineering studies, or project cost estimates prepared by an engineer, are cited as such. Under no circumstances should material contained within this study regarding improvements to the City's infrastructure be construed as a detailed engineering plan, specification, engineering design, or any other type of document intended for the purpose of specific public work construction. The municipality and/or governing agency is responsible for obtaining the services of a licensed professional engineer to perform engineering design services for the construction of public works projects as required by the Texas Engineering Practice Act.

The lot, right-of-way, corporate and extraterritorial jurisdiction boundaries depicted on these maps were derived from readily available information such as existing corporate maps, Census maps, or plat maps from the County Clerk or Appraisal District and are representational in nature. Locations and characterizations of infrastructure, facilities, and structures depicted on these maps are approximate. The City and GrantWorks, Inc. do not intend to establish or confirm true and legal boundaries or exact locations of physical objects with these maps and do not warrant or approve the use of these maps for any purpose other than general reference and information.