



San Antonio Creek Trail

City Council Presentation

5.2.22

Today's Agenda

- Project Overview
- What did we hear?
- Trail Corridor Conditions & Opportunities
- Preferred Alignment
- Implementation & Cost

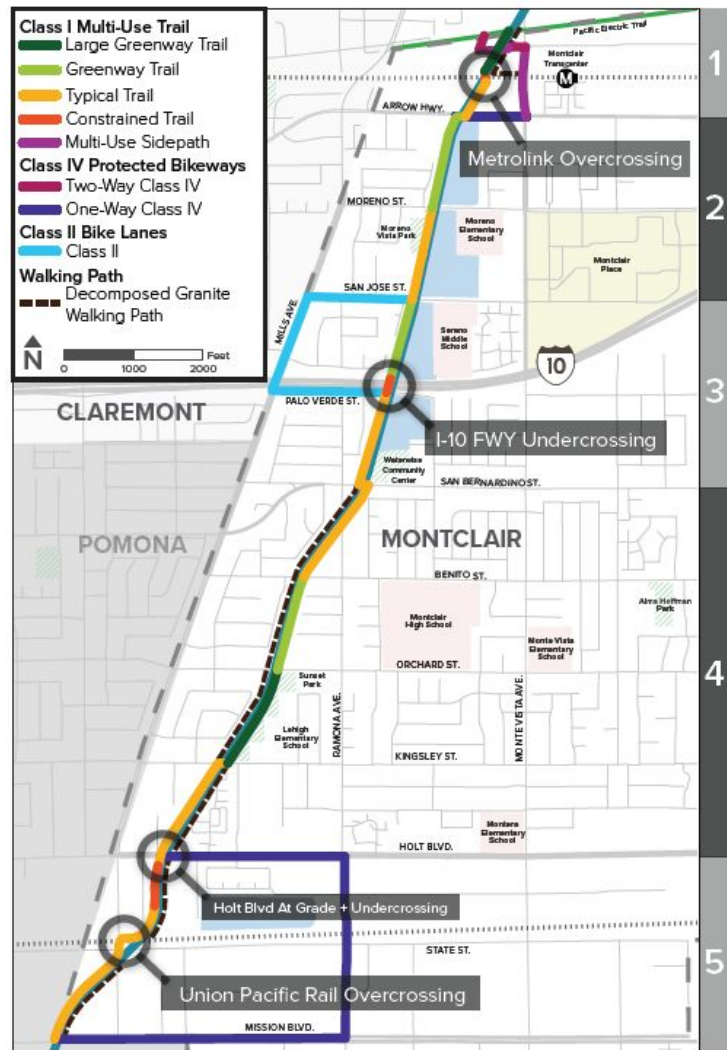

Project Overview

- Planning Study (no construction)
- Community & Stakeholder Involvement
- Where can the trail go? (Existing Conditions & Opportunities)
- What will the trail look like? (Preferred Alignment)
- How will we fund construction? (Implementation)



What did we hear?

- Pop-up Events (2) - 275 reached
- Virtual Survey events (2) - 105 reached
- Draft Plan Workshop (23 attendees)
- Stakeholder meetings: Rail agencies, developers, Chino Basin Water Conservation District, Caltrans



What did we hear?: Amenities

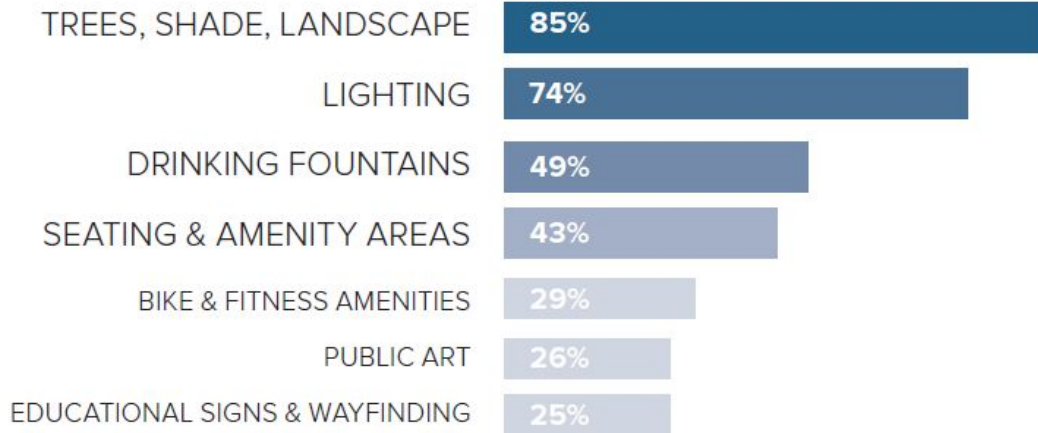

“Creek history, Santa Ana watershed information... the importance of the Chino Groundwater Basin [and] water conservation, including using native and waterwise landscaping plants, cultural history including the Tongva as the first stewards of the area.”

“Any development to improve access and use is welcome. Please consider global weather changes and provide shade & water!”
- Survey respondent

What did we hear?: Destinations

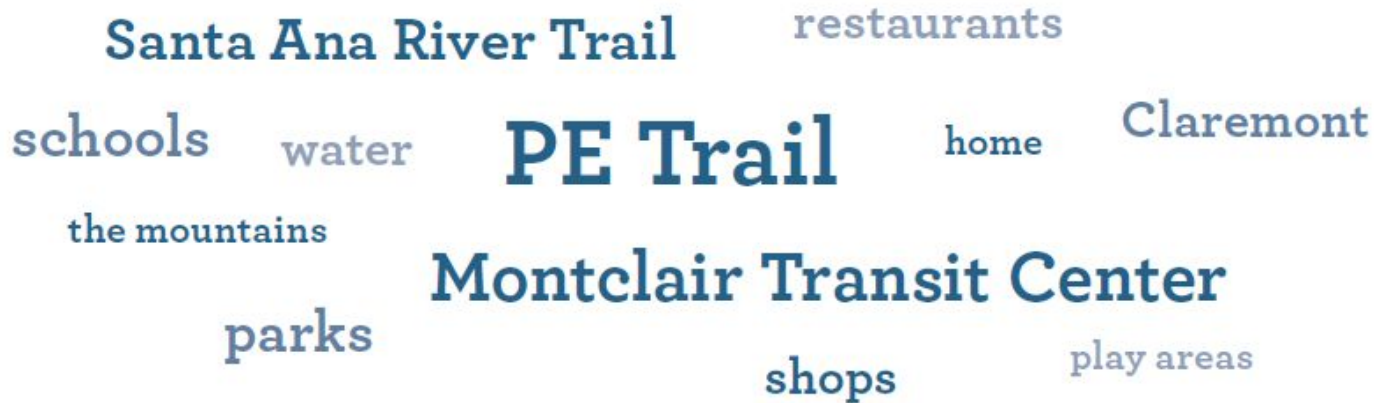

“This trail will be great connectivity to the pacific rail trail and other bike lanes!”
- Survey respondent

Existing Conditions & Opportunities

Area 1: PE Trail to San Jose Street



Existing Conditions & Opportunities

Area 2: San Jose Street to Kingsley Street

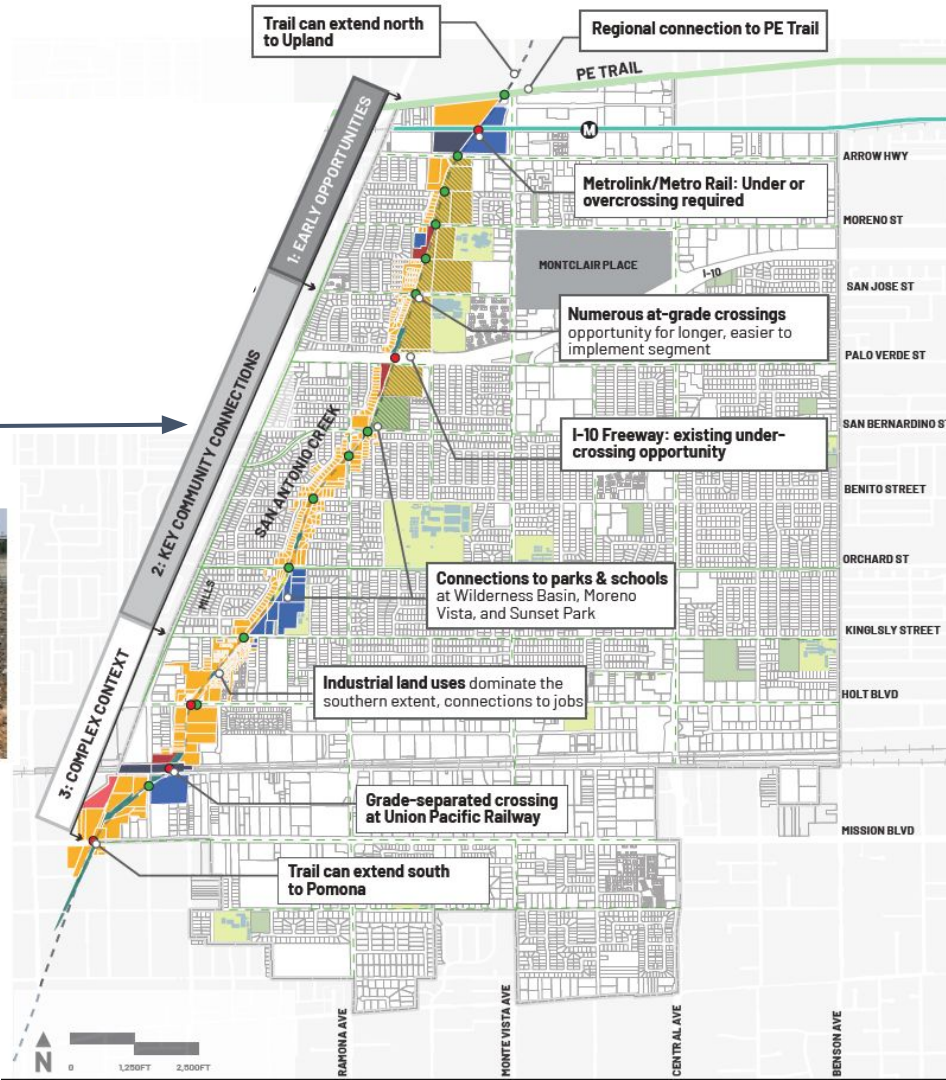

Existing Conditions & Opportunities

Area 3: Kingsley Street to Mission Boulevard

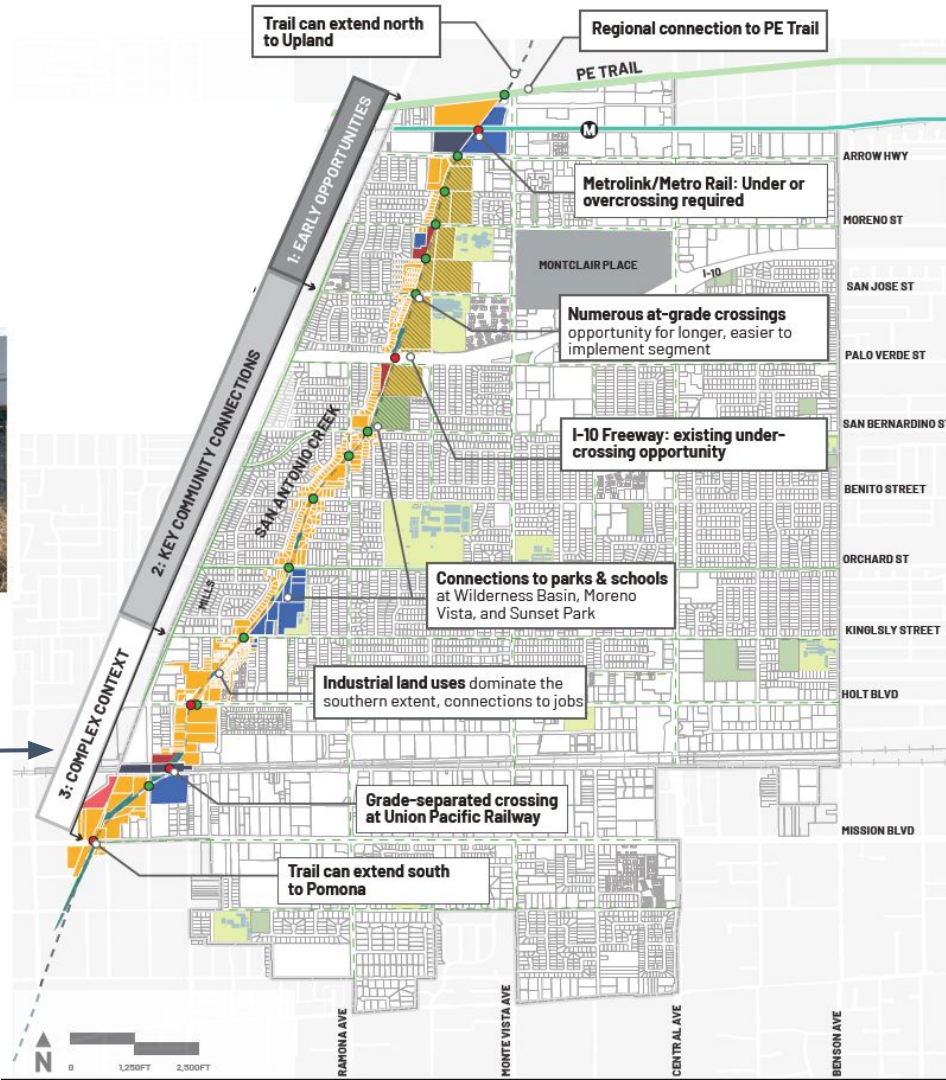

Typical Trail Alignment

Typical - Path + shade trees

Greenway - Path + linear park/amenities

Constrained - Path only

DG Walking Path

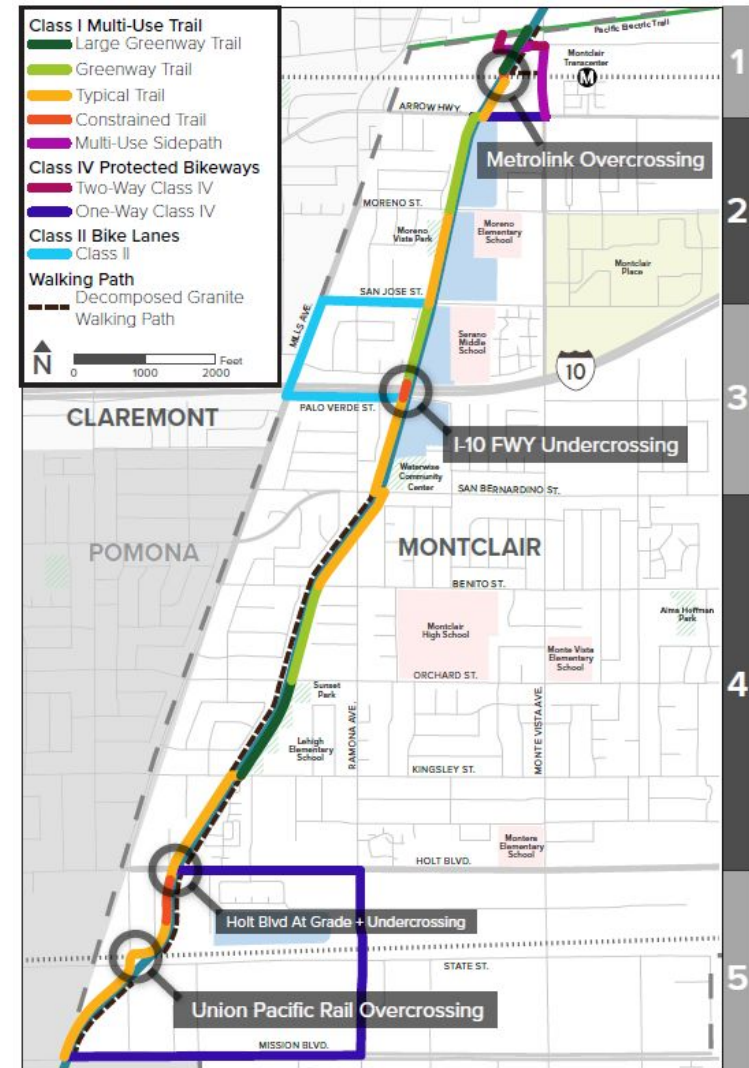
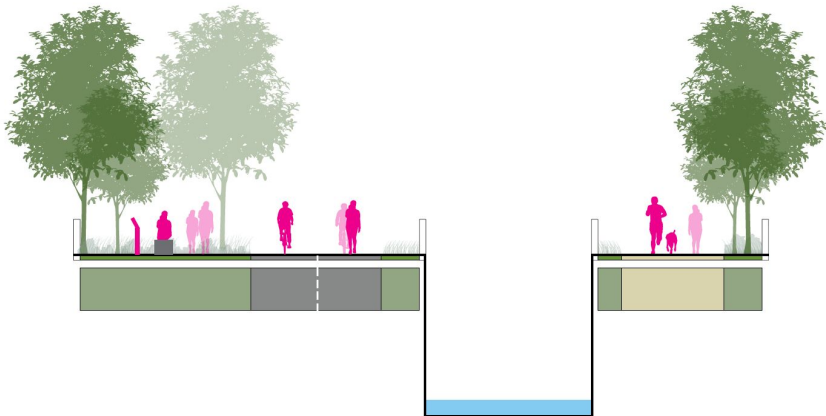

Short-Term Vision: At-Grade Alignment

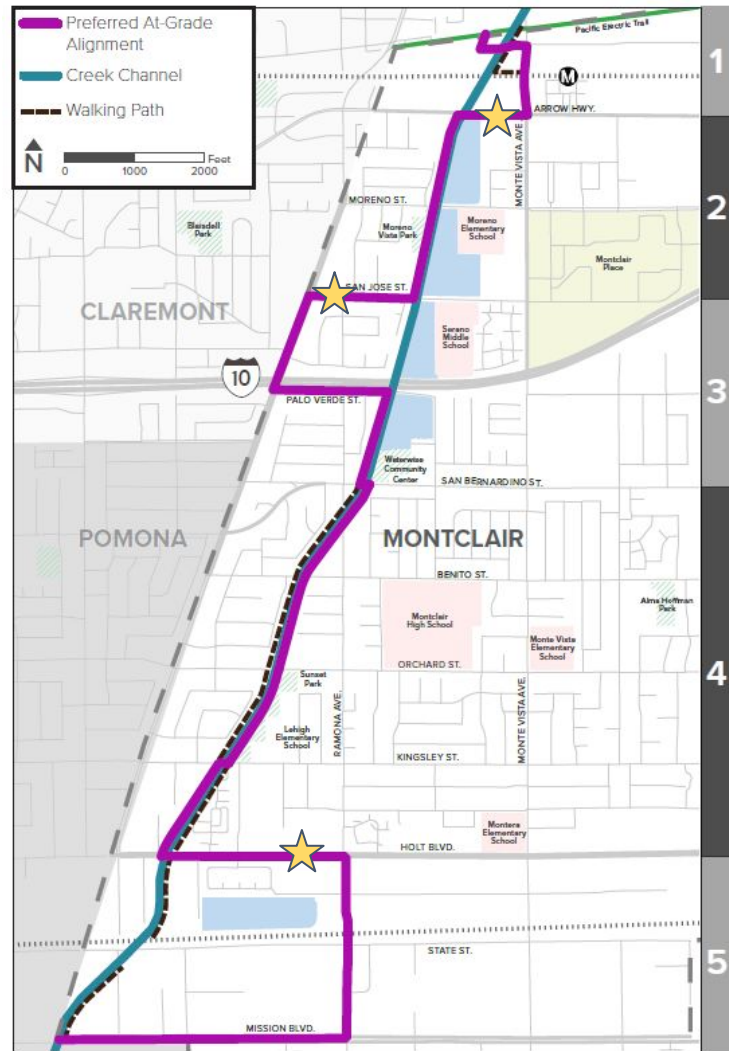

Long-Term Vision: Grade-Separated Crossings

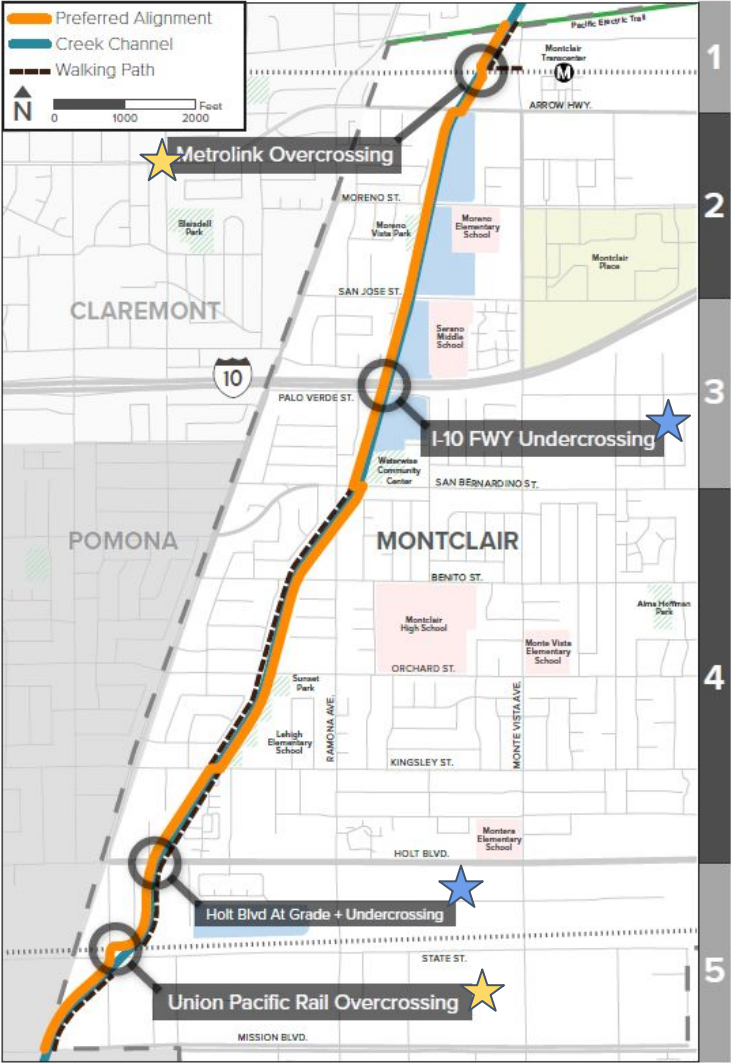

San Antonio Creek Trail: A multi-use trail and neighborhood walking path

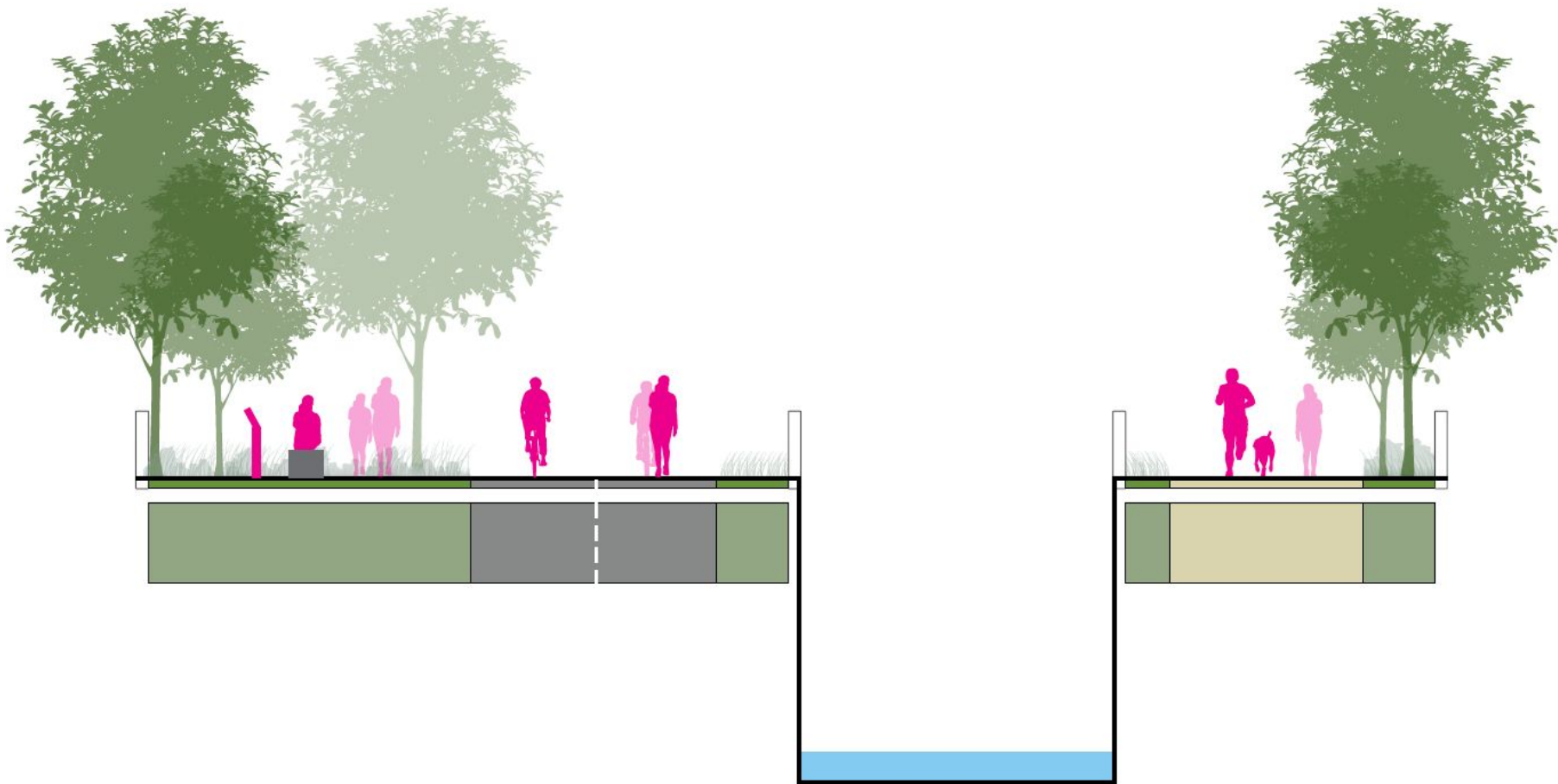

Typical Cross Sections

Typical

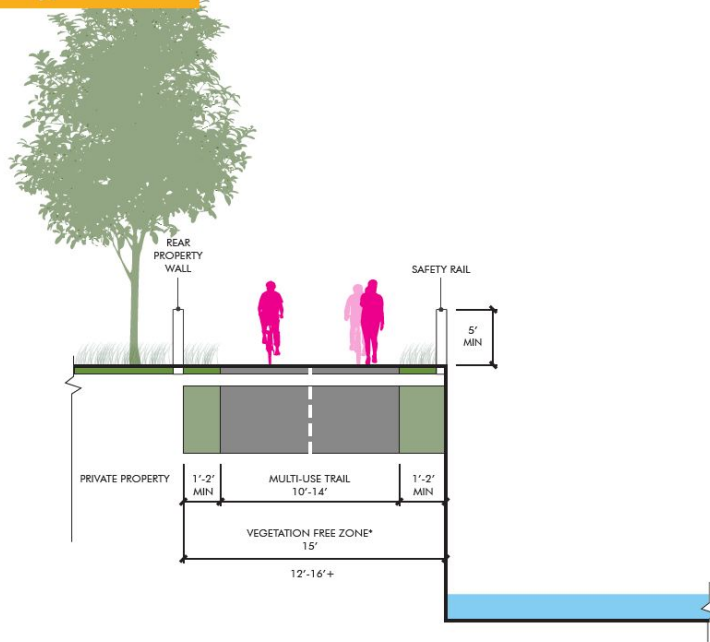

Greenway

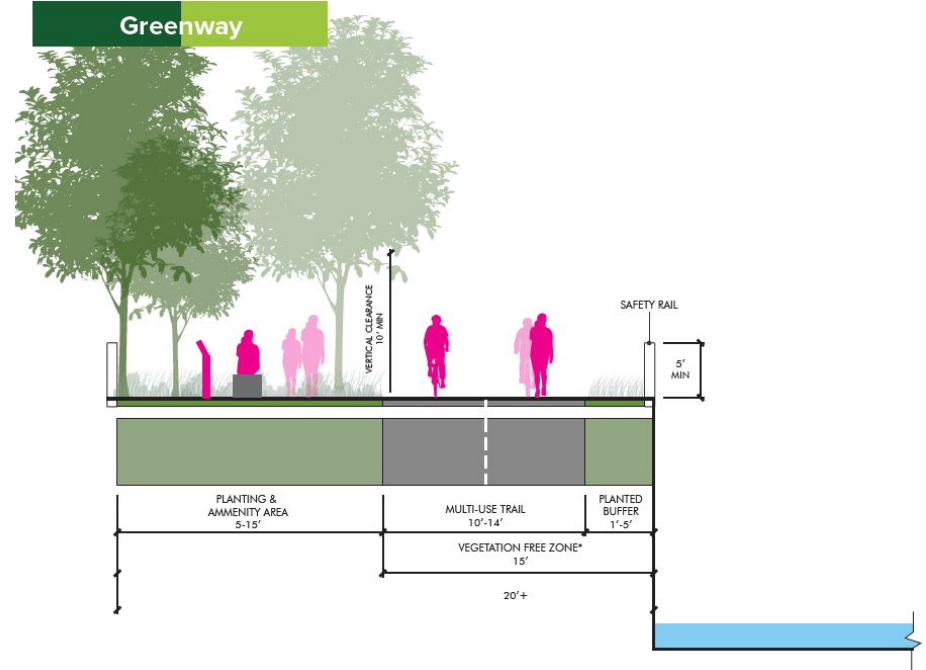

Typical Cross Sections

Constrained

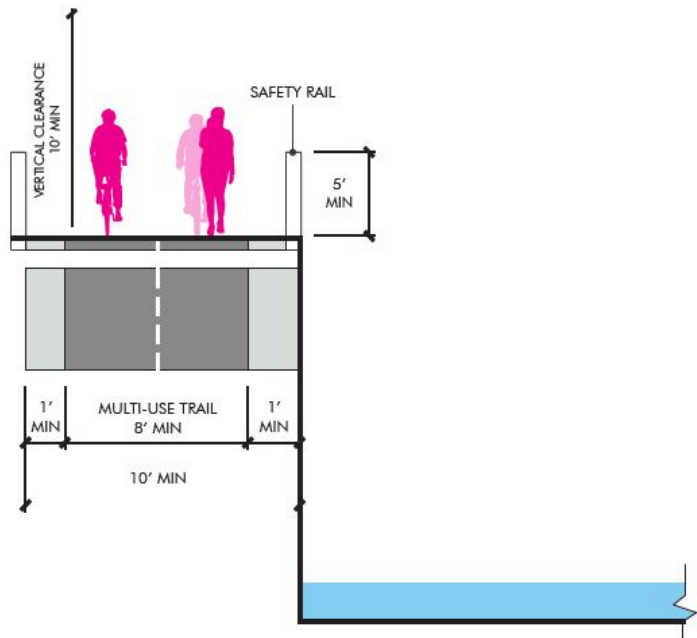

Walking Path

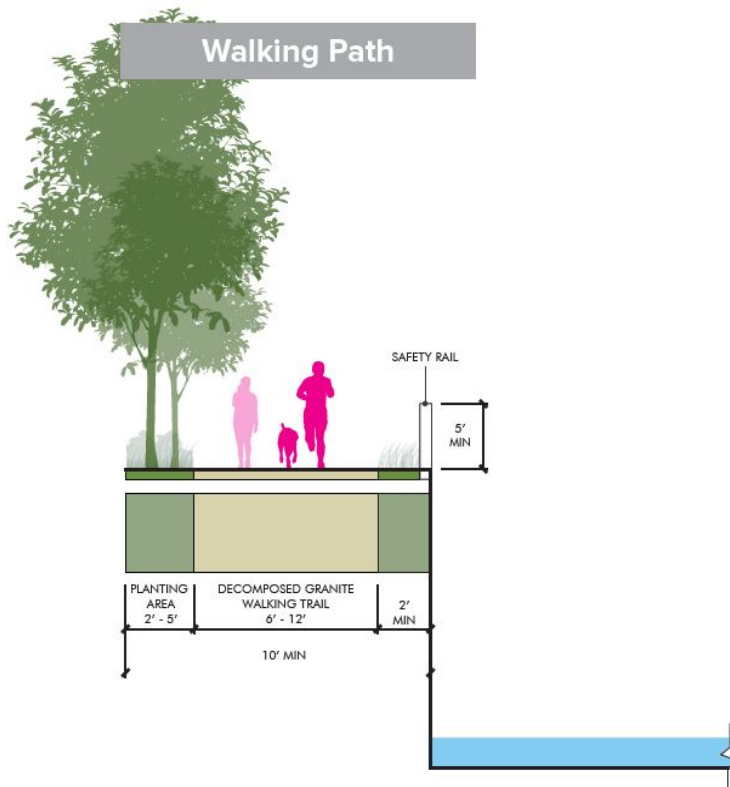

Typical Cross Sections

One-Way Class IV Bikeway

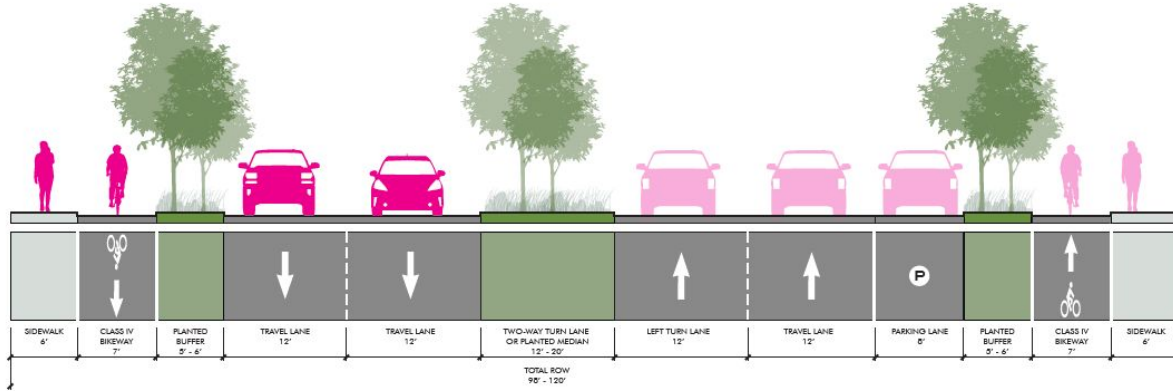

Class II

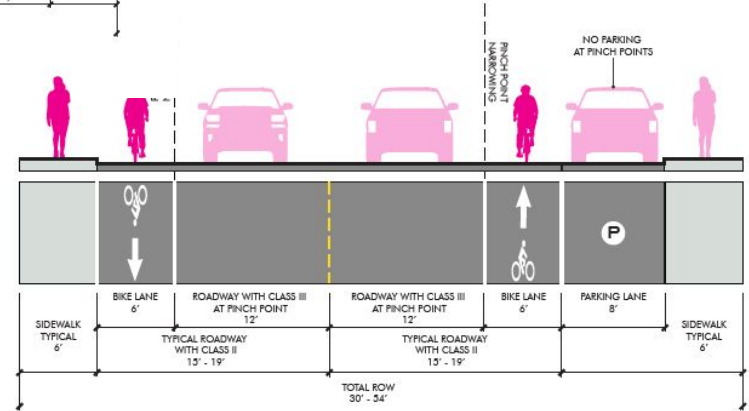

Preferred Trail Alignment: Greenway experience



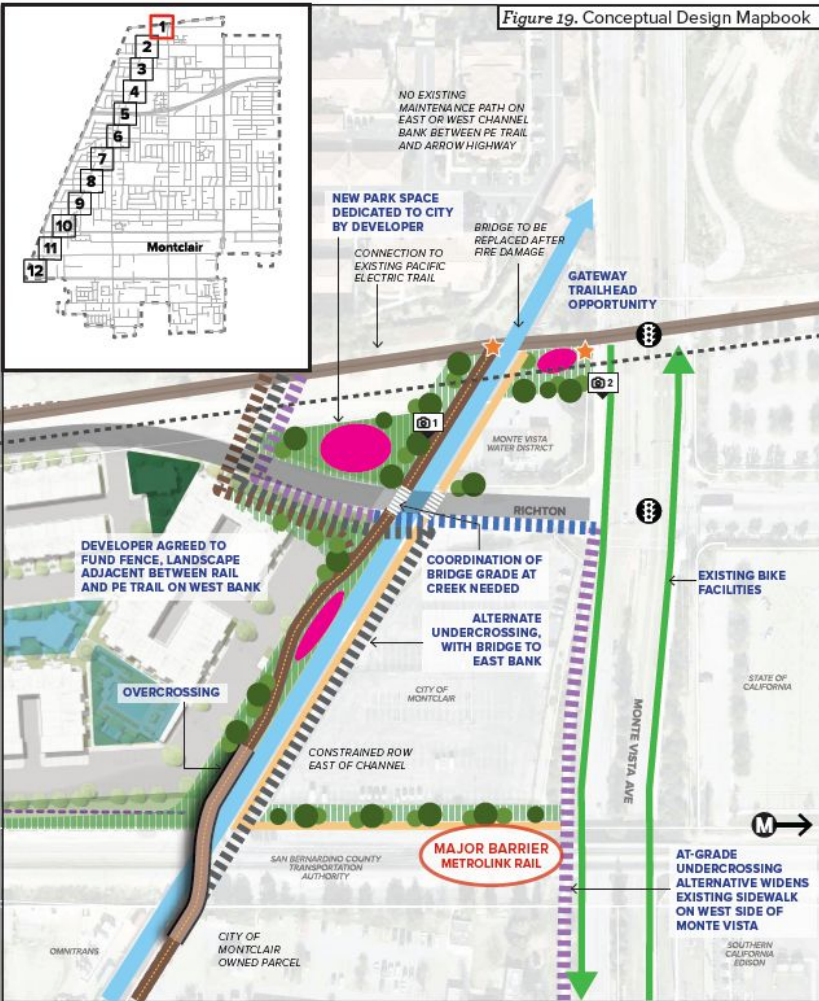

Preferred Trail Alignment: PE Trail to I-10 Freeway

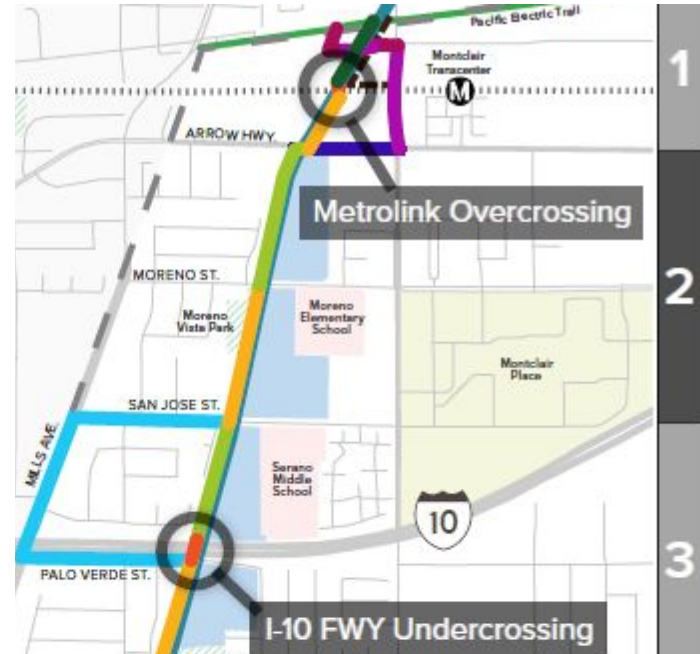

Preferred Trail Alignment: I-10 Freeway to Kingsley

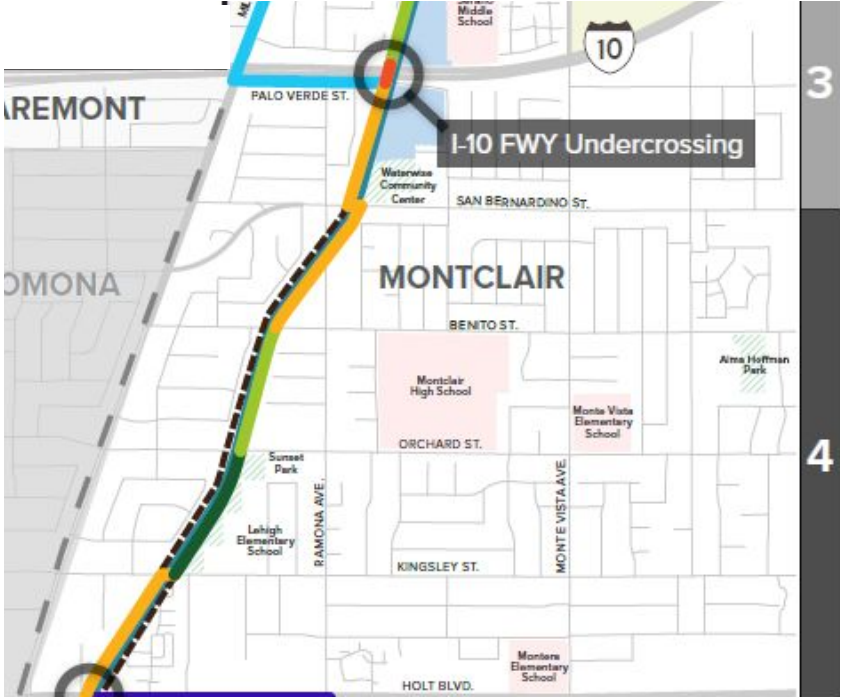
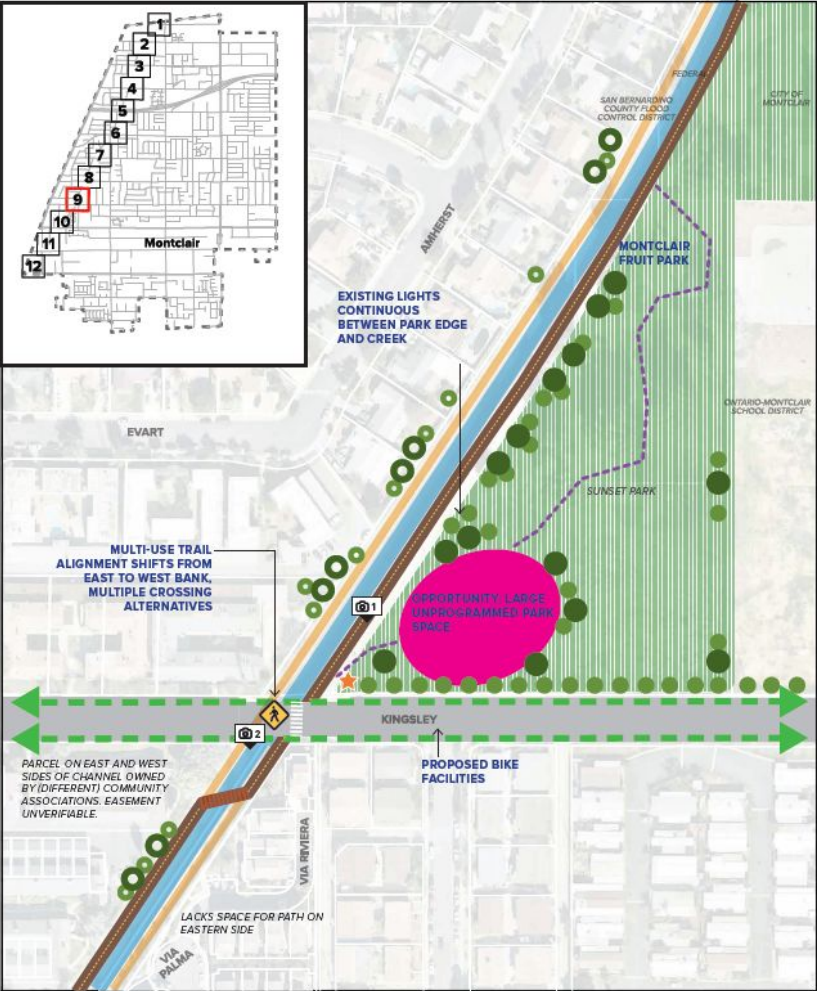

3

4

Preferred Trail Alignment: Kingsley to Mission

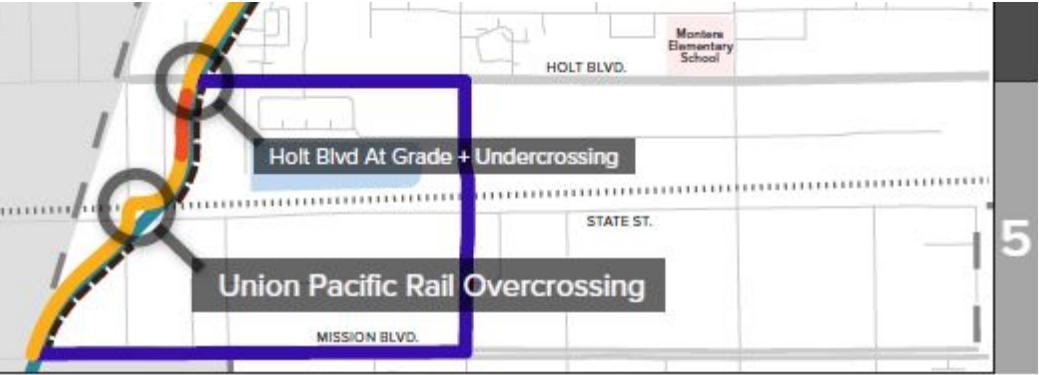
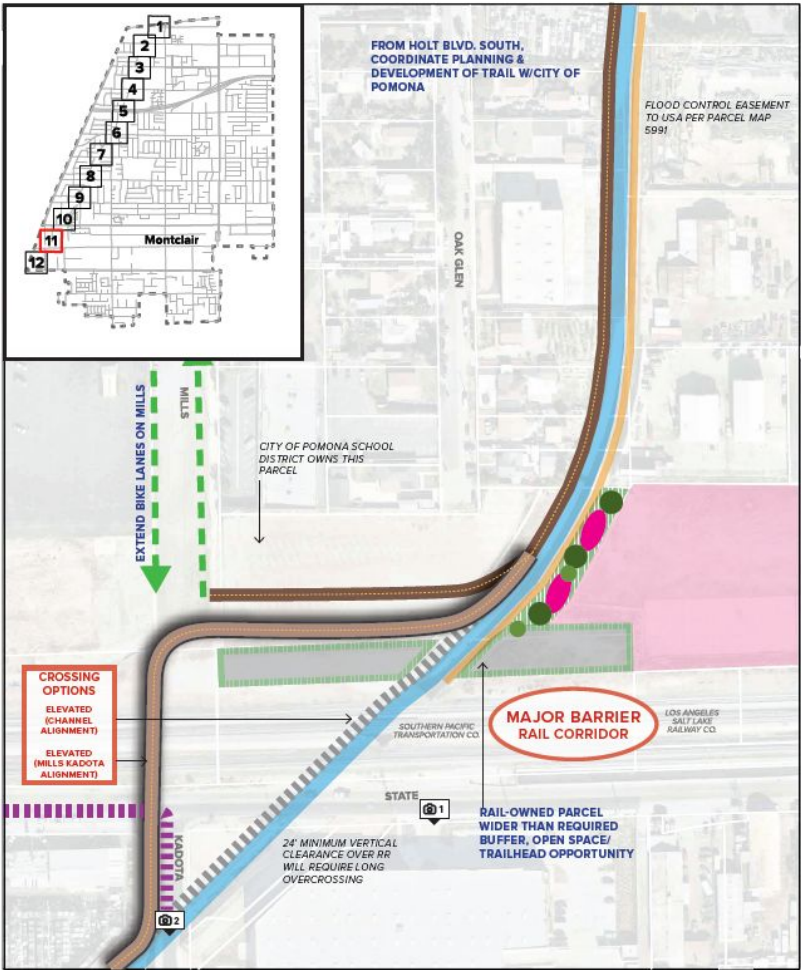

Implementation: Cost

Table 07. Segment 2 Costs

Segment 2: Arrow Highway to San Jose Street (with soft costs & contingency)				
Trail Corridor	QTY	Units	Unit cost	Segment Cost
16' Asphalt Trail (Greenway)	1,367	LF	\$262	\$358,154
14' Asphalt Trail (Typical)	1,363	LF	\$230	\$313,490
Fencing	5,460	LF	\$48	\$262,080
			Subtotal Trail Corridor	\$933,724
Trail Amenities				
Wayfinding	2,730	LF	\$4	\$11,892
Lighting	2,730	LF	\$52	\$142,188
Shade Trees	68	EA	\$610	\$41,480
Trailhead/Amenity Zone	2	EA	\$138,000	\$276,000
Native Plantings	13,670	SF	\$15	\$205,050
Irrigation	13,670	SF	\$15	\$205,050
Emergency Call Boxes	3	EA	\$15,000	\$45,000
			Subtotal Trail Amenities	\$926,660
Intersections				
Local Intersection	2.0	EA	\$115,000	\$230,000
			Subtotal Intersections	\$230,000
Access Points				
New Residential/Open Space Access	2.0	EA	\$27,600	\$55,200
			Subtotal Access Points	\$55,200
Easements				
Trail	1.00	LS	\$180,016	\$180,016
			Subtotal ROW	\$180,016
			Design Cost @ 15%	\$348,840
SEGMENT 2 DESIGN + CONSTRUCTION TOTAL				\$2,674,439

SEGMENT 2: ARROW HIGHWAY TO SAN JOSE STREET

The entirety of Segment 2 is feasible at-grade and is located on the west bank of the channel. Refer to Chapter 5 for applicable cross sections and conceptual plan drawings.

This cost estimate assumes Segment 1 has been constructed (including intersection improvements to Arrow Highway at the Creek). Segment 2's cost estimate includes 2 intersection improvements: the Creek at Moreno Street and the Creek at San Jose Street.

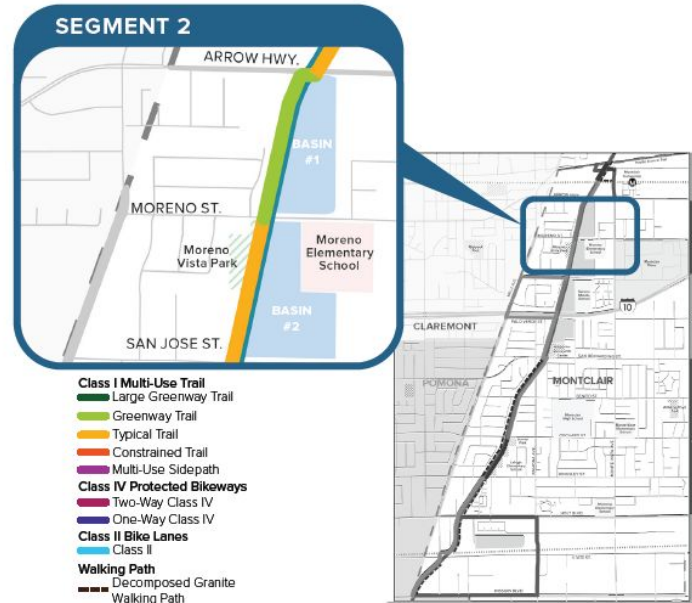

Permitting Process

Level of Government	Agency	Potential Permit or Approval
Federal	Federal Emergency Management Agency	100-year Floodplain Encroachment / 408 Permit
State	California State Water Resources Control Board	Water Quality Order 2012-0006-DWQ (General Construction Permit and SWPPP)
	Regional Water Quality Control Board	Section 401 Water Quality Certification Permit and Waste Discharge Requirement
	California Public Utilities Commission	Grade Crossing/Project Design Review
	★ Caltrans	Pre-Design Screening
Regional	Monte Vista Water District	Water Line Relocation Coordination
	San Bernardino County Flood Control District	Project Design Review
	★ Chino Basin Water Conservation District	Project Design Review
Other Agencies	San Bernardino County Transportation Authority	Project Design Review and License Agreement
	★ Southern California Regional Rail Authority	Maintenance Agreement
	★ Metro	Project Design Review
	★ Metrolink	Project Design Review

★ Involved in stakeholder engagement

Funding

	Planning & Design	Acquisition	Construction	Maintenance	Other
Federal & State					
Active Transportation Program	●		●		
BUILD Program	●		●		
Highway Safety Improvement Program	●	●	●		
Recreational Trails Program	●	●	●	●	
State Highway Operation and Protection Program (SHOPP)	●		●	●	
Affordable Housing and Sustainable Communities Program		●	●		
Urban Greening Program		●	●		
Local Partnership Program		●	●		
Road Maintenance and Rehabilitation Program				●	
Regional Surface Transportation Program			●		
Coastal Conservancy Proposition 1 Grants	●	●	●		
Wildlife Conservation Board Public Access Program	●		●		
Habitat Conservation Fund			●		
Rivers, Trails, and Conservation Assistance Program (RTCA)	●				
Environmental Enhancement and Mitigation (EEM) Grant Program	●	●	●		
Grants for Arts Projects					●

	Planning & Design	Acquisition	Construction	Maintenance	Other
Federal & state, cont.					
Our Town					●
Creative California Communities (CCC)					●
Nonprofits, Foundations, Loans & Donations					
The Trust for Public Land Acquisition Support		●			
The National Fish and Wildlife Foundation		●	●		
Doppelt Family Trail Development Fund	●		●	●	
California Infrastructure State Revolving Fund (Loan)	●	●	●	●	
Kalzer Permanente's San Bernardino County Area Grants	●	●	●	●	
Corporate Donations	●	●	●	●	
Local Measures					
Developer Impact Fees					●
Concession Fees	●	●	●	●	
Fundraising Events	●	●	●	●	
Membership Dues	●	●	●	●	
Adopt-a-Mile or Adopt-a-Trail	●	●	●	●	
On-Trail Donation Stations	●	●	●	●	
Percent-for-Art Ordinance					●

Next Steps

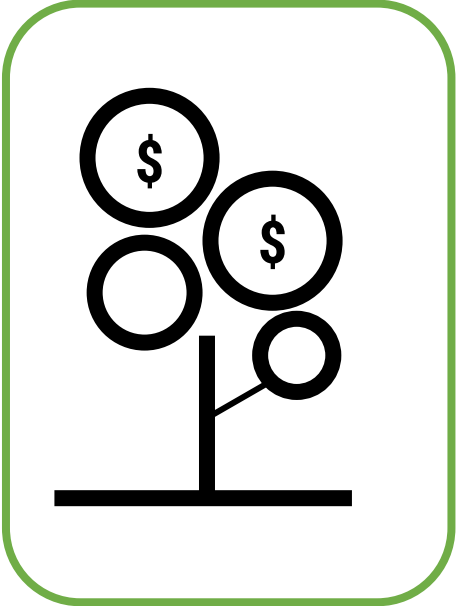

SEEK FUNDING

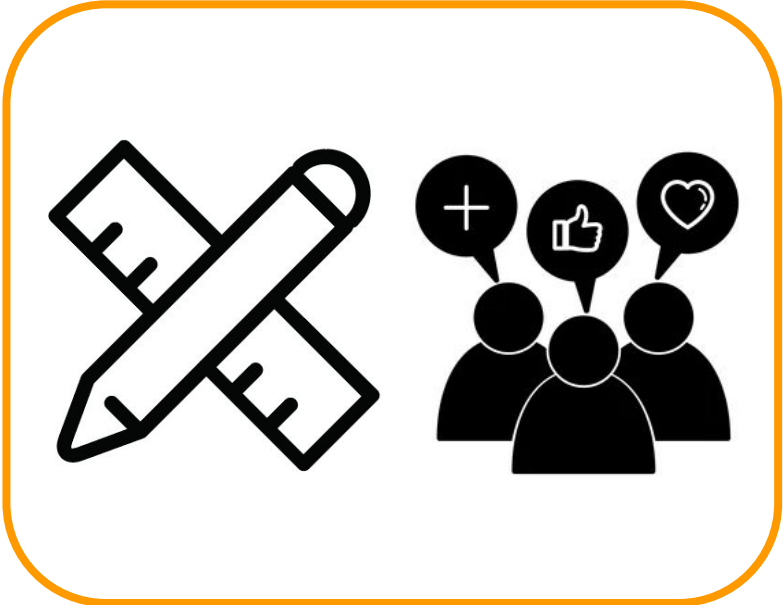

**DETAILED DESIGN +
COMMUNITY INPUT**



CONSTRUCTION

Thank you! Questions?

