

APPENDIX F

**June 22 and August 18, 1998 Portage Lakes Task Force (PLTF)
Meeting Materials**

NEFCO

NORTHEAST OHIO FOUR COUNTY REGIONAL PLANNING & DEVELOPMENT ORGANIZATION

969 Copley Road, Akron, Ohio 44320-2992

(330) 836-5731 • Fax (330) 836-7703

Gayle Jackson, Chair

Joseph Hadley, Jr., Executive Director

NEWS RELEASE

FOR IMMEDIATE RELEASE

June 10, 1998

CONTACT: Jo Ann Keiser, Environmental Planner
Northeast Ohio Four County Regional
Planning and Development
Organization (NEFCO)
969 Copley Road
Akron, OH 44320-2992
(330) 836-5731
FAX: 836-7703

The Northeast Ohio Four County Regional Planning and Development Organization (NEFCO) has received funding from the Summit Soil and Water Conservation District (SWCD) to reconvene with the Portage Lakes Task Force (PLTF) and discuss problems associated with water quality in the Upper Tuscarawas River Watershed. The funding originated from the State's Canal Lakes Watershed Management Program, which is part of the Ohio Department of Natural Resources capital improvements budget. These meetings will aid in the development of a Strategic Action Plan, which will address pollution problems in the Upper Tuscarawas Watershed.

A watershed refers to the area of land from which surface water drains into a common outlet, such as a river, lake or wetland. The Upper Tuscarawas Watershed extends from Hartville to south of Akron, and includes the Portage Lakes. When planning takes a watershed approach, it focuses on the natural flow of rivers and streams, rather than political boundaries. Each watershed is unique and strategies to protect or restore it should reflect this.

The Upper Tuscarawas Watershed is extremely important to the region for a variety of reasons. These include wildlife habitat, wetlands and open greenspace. Large tracts of land are still available for development. The watershed drains into the Portage Lakes which are a popular recreation area.

NEFCO will examine current conditions and target critical streams for protection and/or restoration and identify best management practices to reduce the impacts of runoff on water quality. A Strategic Action Plan will itemize the problems, priorities and activities the task force wants to address. If and when funding becomes available, it will act as a useful guide for implementation.

A series of meetings with the Portage Lakes Task Force and other interested parties will assist in prioritizing watershed efforts. The first set of meetings will consist of two components. The first component will introduce the watershed action plan and review the conditions of the watershed using existing NEFCO research and reports.

The second component of the meeting will give participants a chance to review a list of potential pollution sources in the watershed and their effects on water quality. This second phase will be incorporated into a priority list to address potential pollution sources.

The first meeting will be held on **Monday, June 22, 1998, 2:00 p.m. at the Ohio Division of Wildlife Conference Room.** A similar meeting will be scheduled in Lake Township sometime in August. Future meetings will discuss goals and objectives to address problems, priorities, time frames, task recommendations, funding sources and an evaluation procedure.

Because a watershed is interconnected with the quality of life of those who live and/or work there, it is important to take an active role in its future. We welcome you to attend these meetings and hope to see you there. For more information call Jo Ann Keiser or Claude Custer at NEFCO, (330) 836-5731.

NEFCO

NORTHEAST OHIO FOUR COUNTY REGIONAL PLANNING & DEVELOPMENT ORGANIZATION

969 Copley Road, Akron, Ohio 44320-2992

(330) 836-5731 • Fax (330) 836-7703

Gayle Jackson, Chair

Joseph Hadley, Jr., Executive Director

MEMORANDUM

TO: Portage Lakes Task Force (PLTF) and interested parties

FROM: Jo Ann Keiser, Environmental Planner and
Claude Custer, Jr., Water Quality Planner

DATE: June 8, 1998

SUBJECT: Portage Lakes Task Force meeting notice and request to complete
NEFCO's Pollution Potential Rating Survey for the watershed

NEFCO has received funding from the Summit Soil and Water Conservation District to re-examine the current conditions of the Upper Tuscarawas Watershed and focus on problems associated with water quality. This will aid in the development of a Strategic Action Plan to address water quality issues. This plan will guide future efforts to protect and restore the watershed.

Enclosed please find the meeting notice and agenda for the Portage Lakes Task Force meeting on **Monday, June 22, 1998, 2:00 p.m. at the Ohio Division of Wildlife**. Also included is a blank Pollution Potential Ratings chart and Upper Tuscarawas Watershed base map. Please refer to the Reduction Analysis Public Meetings Information Packet Final Report (May 1996) when reviewing the criteria for the ratings. If you do not have a report please contact us.

Assign a whole number (1-5) to each of the 120 boxes [(24 potential pollution sources) x (5 subwatersheds)]. Please do not leave any boxes blank. Don't hesitate to contact us by phone or fax if you have any questions or comments regarding this survey. If you cannot attend the meeting, please fax us your completed charts so that we may include your input in this process.

NEFCO is looking forward to hearing from you and thanks you in advance for your time.

Enclosures

NEFCO

NORTHEAST OHIO FOUR COUNTY REGIONAL PLANNING & DEVELOPMENT ORGANIZATION

369 Copley Road, Akron, Ohio 44320-2992

(330) 836-5731 • Fax (330) 836-7703

Gayle Jackson, Chair

Joseph Hadley, Jr., Executive Director

MEETING NOTICE

Upper Tuscarawas Watershed Action Plan
Portage Lakes Task Force and other interested parties

June 22, 1998

2:00 p.m.

Department of Natural Resources
Ohio Division of Wildlife Conference Room
912 Portage Lakes Drive
Akron, OH 44319

Tentative Agenda

- A. Introduction to the Upper Tuscarawas Watershed Action Plan
 - 1. Origin and Funding
 - 2. Review of Previous Meetings and Reports in the watershed
 - 3. Purpose
 - 4. Summary of Milestones and Updates
 - a. Base Map
 - b. Land Use
 - c. Critical Resources
 - d. Riparian Zone Analysis
 - e. Public Involvement
- B. Prioritization of Pollution Problems
 - 1. Basis for assigning Pollution Potential Ratings
 - a. NEFCO's ratings
 - b. Input from others
 - c. Discussion on ranking the watershed's potential pollution sources using existing rankings under the Ohio Comparative Risk Project (OCRCP)
 - 2. Additional research to locate pollution sources in the watershed
 - 3. Future Meetings

Please see reverse side for map to the Ohio Division of Wildlife

SECTION No. 37

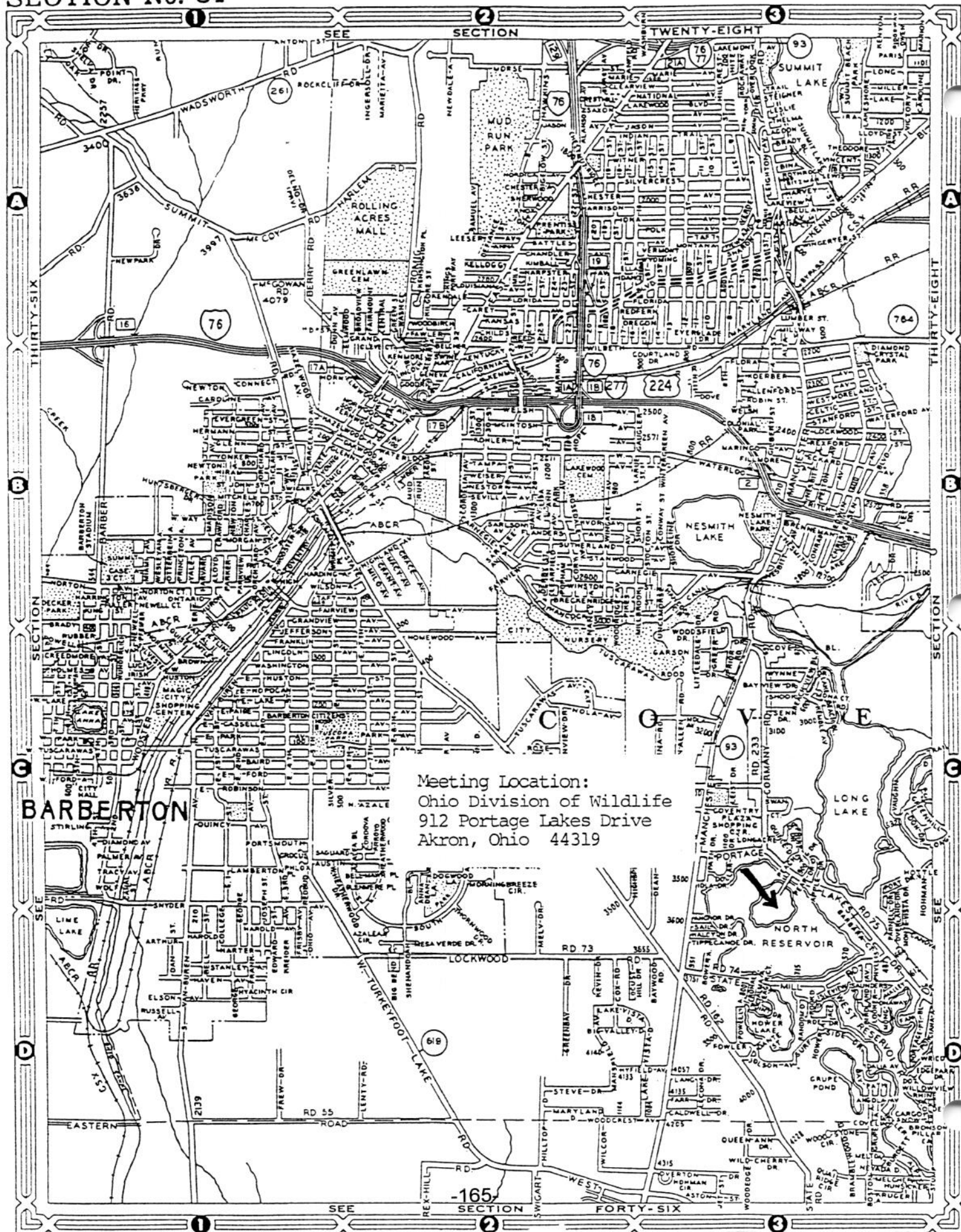

Upper Tuscarawas Watershed

Political Jurisdictions

DRAFT

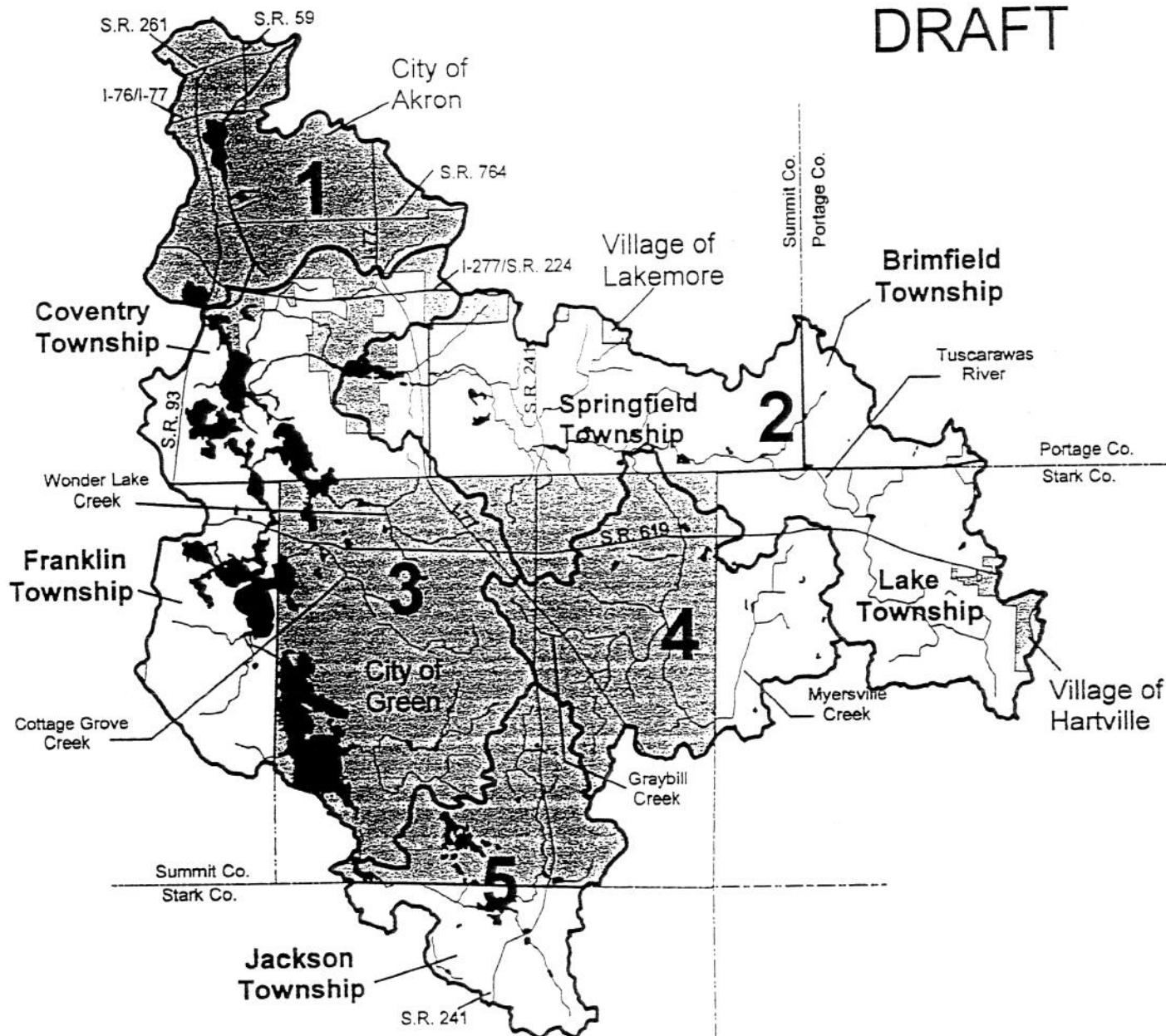

- Township
- Municipality
- County Boundary
- Portage Lakes Subwatersheds
- Rivers/Streams
- Lakes/Ponds
- State Roads and Interstate Hwys



5000 0 5000 10000 Feet

Northeast Ohio Four County Regional Planning and Development Organization
Source Material: ODNR, Division of Real Estate and Land Management; USGS.

Pollution Potential Ratings* for each Subwatershed of the Upper Tuscarawas Watershed					
Identified Potential Pollution Source	Subwatershed				
	1	2	3	4	5
a. Off-Lot (Discharging) and On-Lot (Non-Discharging) Home/Semi-Public Sewage Disposal Systems (Septic Tanks)					
b. Public and Semi-Public Sewage Treatment Plants (Package Plants)					
c. Concentrated Stormwater Flows					
d. Trucking Activity and Related Maintenance (Including Diesel Fuel Use)					
e. Oil and Gas Wells (i.e., Oil and Gas Production and Exploration/Drilling Activity)					
f. Oil and Gas Pipelines (i.e., Oil and Gas Transportation)					
g. Leaking Underground Storage Tanks					
h. Registered Underground Storage Tanks					
i. Gasoline Use (Including Storage and Transportation of Gasoline)					
j. Impervious Areas (e.g., Rooftops, Roads, Parking Lots, etc.)					
k. Agricultural Areas					
l. Construction Sites					
m. Nurseries/Greenhouses and Landscaping Operations					
n. Lawn and Garden/Household Maintenance Activity					
o. Golf Courses					
p. Fuel Oil Use (Including Storage and Transportation of Fuel Oil)					
q. Salt Storage and Seasonal Spreading of Salt					
r. Polychlorinated Biphenyls (PCBs) Use (Used in Some Electrical Transformers)					
s. Abandoned Drinking Water Wells					
t. Mining Activity (Sand and Gravel Mining)					
u. Industrial Operations					
v. Boating Activities					
w. Landfills and dumps					
x. Abandoned coal mines					

***Key to Pollution Potential Ratings:**

- 1 = Virtually no potential to impair surface water and/or ground water quality.
- 2 = Low potential to impair surface water and/or ground water quality.
- 3 = Moderate potential to impair surface water and/or ground water quality.
- 4 = High potential to impair surface water and/or ground water quality.
- 5 = Very high potential to impair surface water and/or ground water quality.

Criteria for Assigning Pollution Potential Ratings to each Subwatershed

Note: A map of the watershed has been included, which contains the locations of the five subwatersheds.

Criteria for rating each identified potential pollution source are based mostly on the Reduction Analysis Public Meetings Information Packet Final Report (May 1996). When referring to this report, focus only on the Upper Basin of the Tuscarawas Watershed when upper and lower are reported. Some of the pollution sources listed below have not been discussed in previous reports. Their distribution is unknown; however, they should be considered when looking at potential pollution sources. If you can contribute any further information than what is presented, please let us know.

a. Off-lot (Discharging) and On-Lot (Non-Discharging) Home/Semi-Public Sewage Disposal Systems (Septic Tanks)

Note: In previous NEFCO reports, the difference between off-lot and on-lot systems were not distinguished. Identification of these two may provide insight for future implementation of Best Management Practices (BMPs).

Off-lot:

- Unsewered area (Fig. 2, p. 85) of the subwatershed and significant concentrations of residences served with septic tanks (Fig. 1, p.79 and Table 5, p.78)
- Areas near the Portage Lakes, subwatersheds 1 and 3, have been identified as areas with soil characteristics conducive for septic system failure
- Number of residential roads parallel to streams/discharge point in the subwatershed
- Areas in the subwatershed with a known increasing amount of development
- The fact that there is a lack of any routine monitoring of off-lot systems

On-lot:

- Same criteria as above for rating off-lot systems, plus residential areas close to streams (about 200-300 ft.), areas of steep slopes, and the distribution of semi-public sewage disposal systems

b. Public and Semipublic Wastewater Treatment Plants (Package Plants)

- The presence of one major publicly owned treatment plant in subwatershed 2 (Summit County Wastewater Treatment Plant)
- The distribution of public and semipublic treatment plants (Fig. 2, p.85 and Table 8, p. 84)
- Combined design flow (maximum discharge) for the subwatershed
- Known lack of nutrient monitoring of small package plants

c. Concentrated Stormwater Flow

- The size and abundance of stormwater pipes in the watershed (Table 2, p. 67)
- Percentage of impervious areas in the watershed
- Probability of erosion for streams conveying flow

d. Trucking Activity and Related Maintenance (Including Diesel Fuel Use)

- Trucking related spills in the subwatershed

- Presence of primary roads, especially state and interstate highways in the subwatershed, i.e. interstate 77, State Routes 59, 224, 241, 764 and 619
- Location of trucking terminals relative to streams in the subwatershed
- Areas of steep slopes near primary roads and/or trucking terminals in the subwatershed
- The fact that some of the compounds spilled by trucking activity are long-lived (streams have difficulty assimilating them)
- e. Oil and Gas Wells (i.e., Oil and Gas Production and Exploration/Drilling Activity)
 - Distribution and density of active wells and drilling activity (p. 76 and Table 4, p. 77)
 - Relative distance to streams
 - Areas where wells and spill locations are near steep slopes
- f. Oil and Gas Pipelines (i.e., Oil and Gas Transmission)
 - Location/distribution of pipelines relative to subwatersheds and streams
 - Areas of increasing amount of development activity where excavators may accidentally dig up a pipeline
 - Agricultural areas of low slope percentages (defined by some communities as less than 12%)--because they are attractive to developers
 - The fact that pipelines eventually corrode and may develop leaks
 - Reported pipeline spills
- g. Leaking Underground Storage Tanks
 - Distribution and location of reported releases relative to streams and ground water
 - Known releases of specific compounds e.g., gasoline
- h. Registered Underground Storage Tanks
 - Distribution and location relative to streams and ground water
 - Registration requires some sort of protective mechanism in place to lessen the potential for leaks to occur
- i. Gasoline Use (Including Storage and Transportation of Gasoline)
 - Distribution and location of reported releases relative to streams and ground water
 - Presence of roads/highways and the relative closeness of these roads/highways to surface water and ground water
 - Areas with slopes greater than 6%
- j. Impervious Areas (e.g., Rooftops, Roads, Parking Lots, etc.)
 - All of above criteria for rating Gasoline Use, plus the location/distribution of all reported spills and soil loss potential downstream from impervious areas, since the increase in runoff (overland flow) from impervious areas can exacerbate natural erosion processes.
- k. Agricultural Areas
 - Agricultural land use areas
 - Slope percentages
 - Soil Loss potential
 - Distribution/location of agricultural areas relative to lakes and streams. Two smaller lakes in subwatershed 2 have shown significant volume loss due to

sedimentation. It is likely that similar small lakes in subwatershed 3 are experiencing the same loss (p. 78).

l. Construction Sites

- All of above criteria for rating Agricultural Areas, plus development on prime agricultural land that has occurred (presence of residential roads in agricultural areas)
- Known developing areas (observations made through windshield surveys, land use maps, aerial photos, tax maps etc.)

m. Nurseries/Greenhouses and Landscaping Operations

- Distribution of nurseries/greenhouses/landscaping operations
- Relative closeness to streams
- Slope percentage

n. Lawn and Garden/Household Maintenance Activity

- Distribution of residential areas and more recent residential roads
- Relative closeness to streams
- Slope percentages
- Number of landowners with direct access to the watershed

o. Golf Courses

- Seven golf courses have been located in the watershed. All of these are located in Summit County and are listed by subwatershed below:

Subwatershed 2:

1. Firestone Raymond C.
2. Chenoweth
3. Firestone Country Club

Subwatershed 3:

1. Turkeyfoot

Subwatershed 4:

1. Mayfair
2. Ohio Prestwick
3. Raintree

- Relative closeness to streams
- Slope percentages

p. Fuel Oil Use (Including Storage and Transportation of Fuel Oil)

- Distribution/location of reported spills and relative closeness to surface water and ground water
- Presence and quantity of roads (fuel oil is trucked)
- Slope percentages
- Known areas lacking natural gas service

q. Salt Storage and Seasonal Spreading of Salt

- Five sites for salt storage in the watershed; three of these are in subwatershed 3, one in subwatershed 2, and one in subwatershed 5
- Presence of roads and surface area of road/parking lot surface (impervious area)
- High-traffic roads and parking lots (state routes, interstate highways) I-77 rest stop in subwatershed 4

r. Polychlorinated Biphenyls (PCBs) Use (Used in Some Electrical Transformers)

- Distribution/location of reported spills relative to streams and ground water
- PCBs are used in electrical transformers (mounted on poles) throughout the watershed
- Slope percentages

s. Abandoned Drinking Water Wells

- The number of private wells in the watershed
 - The potential for abandoned well contamination--the number and types of reported spills and failing sewage disposal systems
 - Distribution/location of reported spills
 - Slope percentages
- t. Mining Activity (Sand and Gravel Mining)
- Distribution of active or abandoned sand and gravel pits (abandoned pits could now be ponds/lakes) (Figure for right half of Upper Basin on p.9 and text on p.76)
 - The potential for pit contamination--the number and types of report spills, failing sewage disposal systems nearby, etc.
 - Distribution/location of reported spills relative to streams and ground water (many pits are abandoned when ground water is encountered)
 - Slope percentages
- u. Industrial Operations
- Chemical use and disposal
 - Location in the subwatershed; i.e., Akron-Canton Airport in subwatershed #5 and Akron Municipal airport, which is located just to the north of subwatersheds 2 and 3
- v. Boating Activities
- Suspected level of activity resulting in shoreline erosion and sediment resuspension
 - Gasoline, oil and other chemical use and potential for leaks/spills directly into waterways
- w. Landfills and Dumps
- Number of Landfills and Dumps and proximity to surface and ground water
 - No Active Solid Waste Landfills; however, subwatershed 4 contains an inactive landfill in Uniontown
- x. Abandoned Coal Mines
- Distribution of abandoned coal mines and proximity to watershed (Figure for right half of Upper Basin, p. 9)

A:\CRITERIA.WPD

NEFCO reviving Portage Lakes Task Force

AKRON — The Northeast Ohio Four County Regional Planning and Development Organization (NEFCO) has received funding from the Summit Soil and Water Conservation District (SWCD) to reconvene with the Portage Lakes Task Force (PLTF) and discuss problems associated with water quality in the Upper Tuscarawas River Watershed.

The funding originated from the State's Canal Lakes Watershed Management Program, which is part of the Ohio Department of Natural Resources capital improvements budget. These meetings will aid in the development of a Strategic Action Plan, which will address pollution

problems in the Upper Tuscarawas Watershed.

The first meeting will be held on Monday, June 22, at 2 p.m. in the Ohio Division of Wildlife Conference Room, 912 Portage Lakes Dr. in

Boyd recognized

BETHANY, WV — Stephanie Dawn Boyd, a junior at Bethany College, has been designated "distinguished in scholarship" and named to the Dean's List for the spring semester of the College's 1997-1998 academic year.

To be named to the Dean's List, a Bethany student must have a grade-point average of 3.65 or better for at least 12 graded hours of course work.

Boyd, majoring in Biology and in English, is the daughter of Deborah Bolen of Akron and Craig Boyd of Green. She is a graduate of Green High School.

Coveignty Township. A similar meeting will be scheduled in Lake Township sometime in August.

Future meetings will discuss goals and objectives to address problems, priorities, time frames, task recommendations, funding sources and an evaluation procedure.

A watershed refers to the area of land from which surface water drains into a common outlet, such as a river, lake or wetland. The Upper Tuscarawas Watershed extends from Hartsville to south of Akron, and includes the Portage Lakes.

When planning takes a watershed approach, it focuses on the natural flow of rivers and streams, rather than political boundaries. Each watershed is unique and strategies to protect or restore it should reflect this.

The Upper Tuscarawas Watershed is extremely important to the region for a variety of reasons. These include wildlife habitat, wetlands and open greenspace. Large tracts of land are

still available for development. The watershed drains into the Portage Lakes which are a popular recreation area.

NEFCO will examine current conditions and target critical streams for protection and/or restoration and identify best management practices to reduce the impacts of runoff on water quality. A Strategic Action Plan will itemize the problems, priorities and activities the task force wants to address. If and when funding becomes available, it will act as a useful guide for implementation.

A series of meetings with the Portage Lakes Task Force and other interested parties will assist in priori-

tizing watershed efforts. The first set of meetings will consist of two components. The first component will introduce the watershed action plan and review the conditions of the watershed using existing NEFCO research and reports.

The second component of the meeting will give participants a chance to review a list of potential pollution sources in the watershed and their effects on water quality. This second phase will be incorporated into a priority list to address potential pollution sources.

For more information call Jo Ann Keiser or Claude Custer at NEFCO, (330) 836-5731.

ATTENDANCE SHEET
Upper Tuscarawas River Watershed
Potential Pollution Sources Assessment
Ohio Division of Wildlife
2:00 p.m. to 4:00 p.m.
June 22, 1998

	NAME	REPRESENTING	ADDRESS (PLEASE PRINT)
1	Cindy Junk	Summit SWCD	2787 Front St #B Cuy Falls 44221
2	Bob Saffian	SELF	3823 Bay Poth Dr. Akron, OH 44319
3	Claude Custer	NEFCO	969 Copley Rd Akron, OH 44372
4	John V Gabele	Summit Co Health	1100 GRAHAM CIR. STOW OH 44224 923 4891 ex 262
5	Tom Roth	CITIZEN (P.L.A.C.)	266 HEDGEWOOD DR. AKRON 44319
6	Paul Moser	Ohio Div. of Wildlife	912 Portage Lakes Dr. Akron, Ohio 44319 (330) 644-2293
7	Andrew Chatterton	City of Green Planning Dept.	5383 Massillon Rd. Green OH 44232
8	Georg Beckham	COURTNEY TOWNSHIP	68 Portage Lakes Dr. AKRON, OH. 44319
9	Ken Frase	OHIO EPA	270 2110 E. Aurora R. Twinsburg, Ohio
10	Ken Walker	PORTAGE LAKES J.P.	5031 MANCHESTER RD AKRON OH. 44319
11	Sp Ann Keiser	NEFCO	969 Copley Rd. AKRON, OH 44320
12			
13			

NEFCO

NORTHEAST OHIO FOUR COUNTY REGIONAL PLANNING & DEVELOPMENT ORGANIZATION

969 Copley Road, Akron, Ohio 44320-2992

(330) 836-5731 • Fax (330) 836-7703

Gayle Jackson, Chair

Joseph Hadley, Jr., Executive Director

NEWS RELEASE

FOR IMMEDIATE RELEASE

August 4, 1998

CONTACT: Jo Ann Keiser, Environmental Planner
Northeast Ohio Four County Regional
Planning and Development
Organization (NEFCO)
969 Copley Road
Akron, OH 44320-2992
(330) 836-5731
FAX: 836-7703

The Northeast Ohio Four County Regional Planning and Development Organization (NEFCO) has received funding from the Summit Soil and Water Conservation District (SWCD) to reconvene with the Portage Lakes Task Force (PLTF) and discuss problems associated with water quality in the Upper Tuscarawas River Watershed. The funding originated from the State's Canal Lakes Watershed Management Program, which is part of the Ohio Department of Natural Resources' capital improvements budget. These meetings will aid in the development of a Strategic Action Plan, which will address pollution problems in the Upper Tuscarawas River Watershed.

A watershed refers to the area of land from which surface water drains into a common outlet, such as a river, lake or wetland. The Upper Tuscarawas Watershed extends from Hartville to south of Akron, and includes the Portage Lakes. When planning takes a watershed approach, it focuses on the natural flow of rivers and streams, rather than political boundaries. Each watershed is unique and strategies to protect or restore it should reflect this.

The Upper Tuscarawas Watershed is extremely important to the region for a variety of reasons. These include wildlife habitat, wetlands and open greenspace. Large tracts of land are still available for development. The watershed drains into the Portage Lakes which are a popular recreation area.

NEFCO will examine current conditions and target critical streams for protection and/or restoration and identify best management practices to reduce the impacts of runoff on water quality. A Strategic Action Plan will itemize the problems, priorities and activities the task force wants to address. If and when funding becomes available, it will act as a useful guide for implementation.

A series of meetings with the Portage Lakes Task Force and other interested parties will assist in prioritizing watershed efforts. The first set of meetings consists of two components. The first component is to introduce the watershed action plan and review the conditions of the watershed using existing NEFCO research and reports.

The second component of the meeting is to give participants a chance to review a list of potential pollution sources in the watershed and their effects on water quality. This second phase will be incorporated into a priority list to address potential pollution sources.

The upcoming meeting will be held during the evening and will discuss similar topics as the first meeting, which was held during an afternoon in June. This meeting will be held on **Tuesday, August 18, 1998, 7:00 p.m. at the Uniontown Fire Department, on the corner of Oakwood and Edison (S.R. 619) in Lake Township.** Future meetings will discuss goals and objectives to address problems, priorities, time frames, task recommendations, funding sources and an evaluation procedure.

Because a watershed is interconnected with the quality of life of those who live and/or work there, it is important to take an active role in its future. We welcome you to attend these meetings and hope to see you there. For more information call Jo Ann Keiser or Claude Custer at NEFCO, (330) 836-5731.

NEFCO

NORTHEAST OHIO FOUR COUNTY REGIONAL PLANNING & DEVELOPMENT ORGANIZATION

969 Copley Road, Akron, Ohio 44320-2992

(330) 836-5731 • Fax (330) 836-7703

Gayle Jackson, Chair

Joseph Hadley, Jr., Executive Director

MEMORANDUM

TO: Portage Lakes Task Force (PLTF) and interested parties

FROM: Jo Ann Keiser, Environmental Planner and
Claude Custer, Water Quality Planner

DATE: August 3, 1998

SUBJECT: Portage Lakes Task Force meeting notice and request to complete
NEFCO's Pollution Potential Rating Survey for the watershed

NEFCO has received funding from the Summit Soil and Water Conservation District to re-examine the current conditions of the Upper Tuscarawas River Watershed and focus on problems associated with water quality. This will aid in the development of a Strategic Action Plan to address water quality issues. This plan will guide future efforts to protect and restore the watershed.

Enclosed please find the meeting notice and agenda for the Portage Lakes Task Force meeting on **Tuesday, August 18, 1998, 7:00 p.m. at the Uniontown Fire Department**. Also included is a blank Pollution Potential Ratings chart, Upper Tuscarawas River Watershed base map, and a draft copy of Pollution Potential Ratings assigned by NEFCO. If you have already completed a Pollution Potential Ratings chart, it is not necessary to fill in the enclosed copy. Please refer to the Reduction Analysis Public Meetings Information Packet Final Report (May 1996) when reviewing the criteria for the ratings. If you do not have a report please contact us.

Assign a whole number (1-5) to each of the 120 boxes [(24 potential pollution sources) x (5 subwatersheds)] on the blank Pollution Potential Ratings chart. **Please fill in as many boxes as possible.** Don't hesitate to contact us by phone or fax if you have any questions or comments regarding this survey. Bring your surveys, in addition to the May 1996 report, to the meeting. If you cannot attend the meeting, please fax us your completed charts so that we may include your input in this process.

NEFCO is looking forward to hearing from you and thanks you in advance for your time.

Enclosures

NEFCO

NORTHEAST OHIO FOUR COUNTY REGIONAL PLANNING & DEVELOPMENT ORGANIZATION

969 Copley Road, Akron, Ohio 44320-2992

(330) 836-5731 • Fax (330) 836-7703

Gayle Jackson, Chair

Joseph Hadley, Jr., Executive Director

MEETING NOTICE

Upper Tuscarawas River Watershed Action Plan
Portage Lakes Task Force and other interested parties

August 18, 1998

7:00 p.m.

Uniontown Fire Department

13055 Oakwood Ave.

Uniontown, OH 44685

Lake Township

Tentative Agenda

- A. Introduction to the Upper Tuscarawas River Watershed Action Plan
 - 1. Review of Previous Meetings and Reports in the Watershed
 - 2. Summary of Milestones and Updates
- B. Prioritization of Pollution Problems
 - 1. Basis for assigning Pollution Potential Ratings
 - a. NEFCO's ratings
 - b. Input from others
 - c. Discussion on ranking the watershed's potential pollution sources using existing rankings under the Ohio Comparative Risk Project (OCRCP)
 - 2. Additional research to locate pollution sources in the watershed
 - 3. Future Meetings

**See reverse side for map to the Uniontown Fire Department
(Located at the corner of Oakwood Ave. & S.R.619)**

***Please do not park in the front of the building. Parking is available in the side lot.

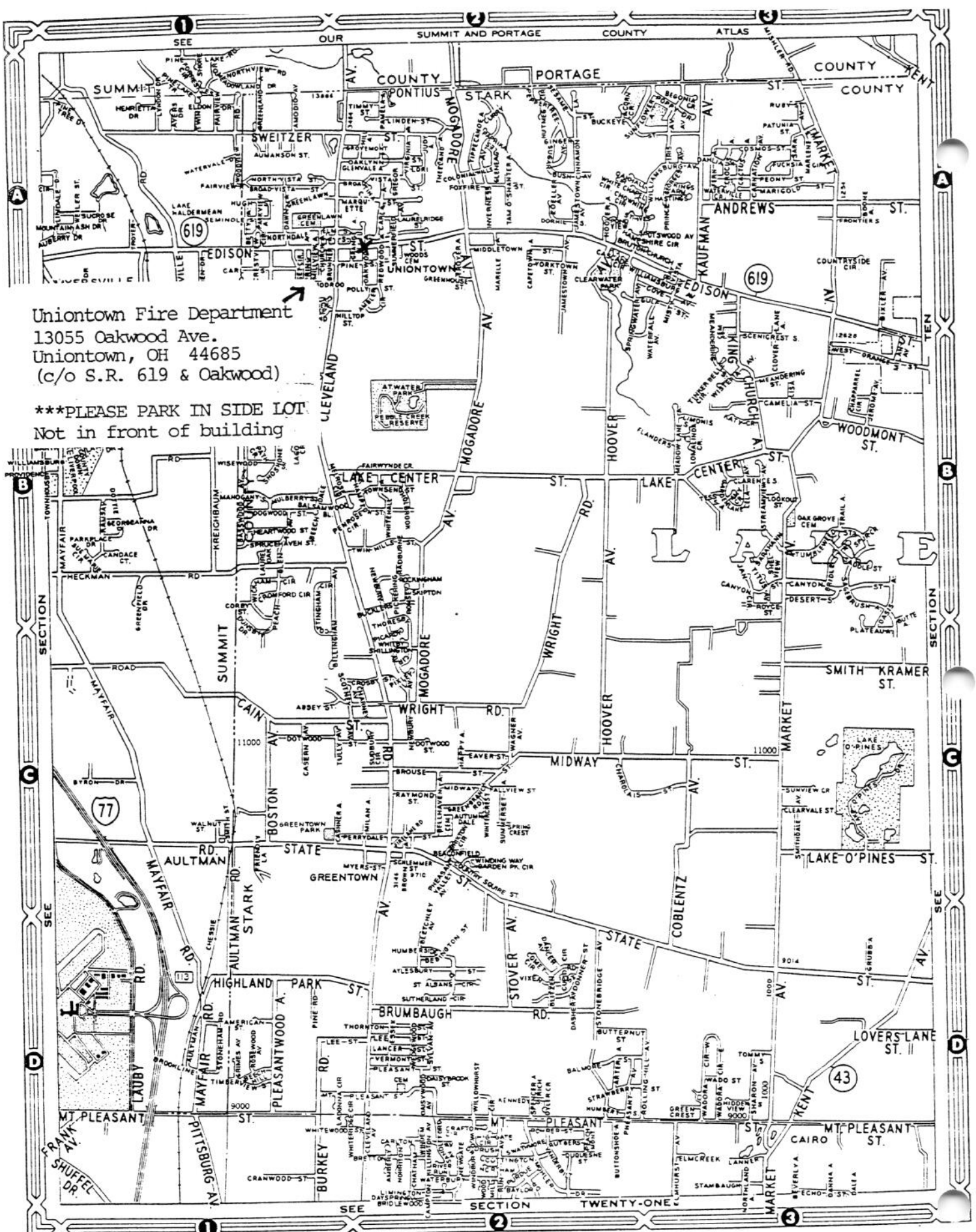

Political Jurisdictions

Upper Tuscarawas River Watershed

DRAFT

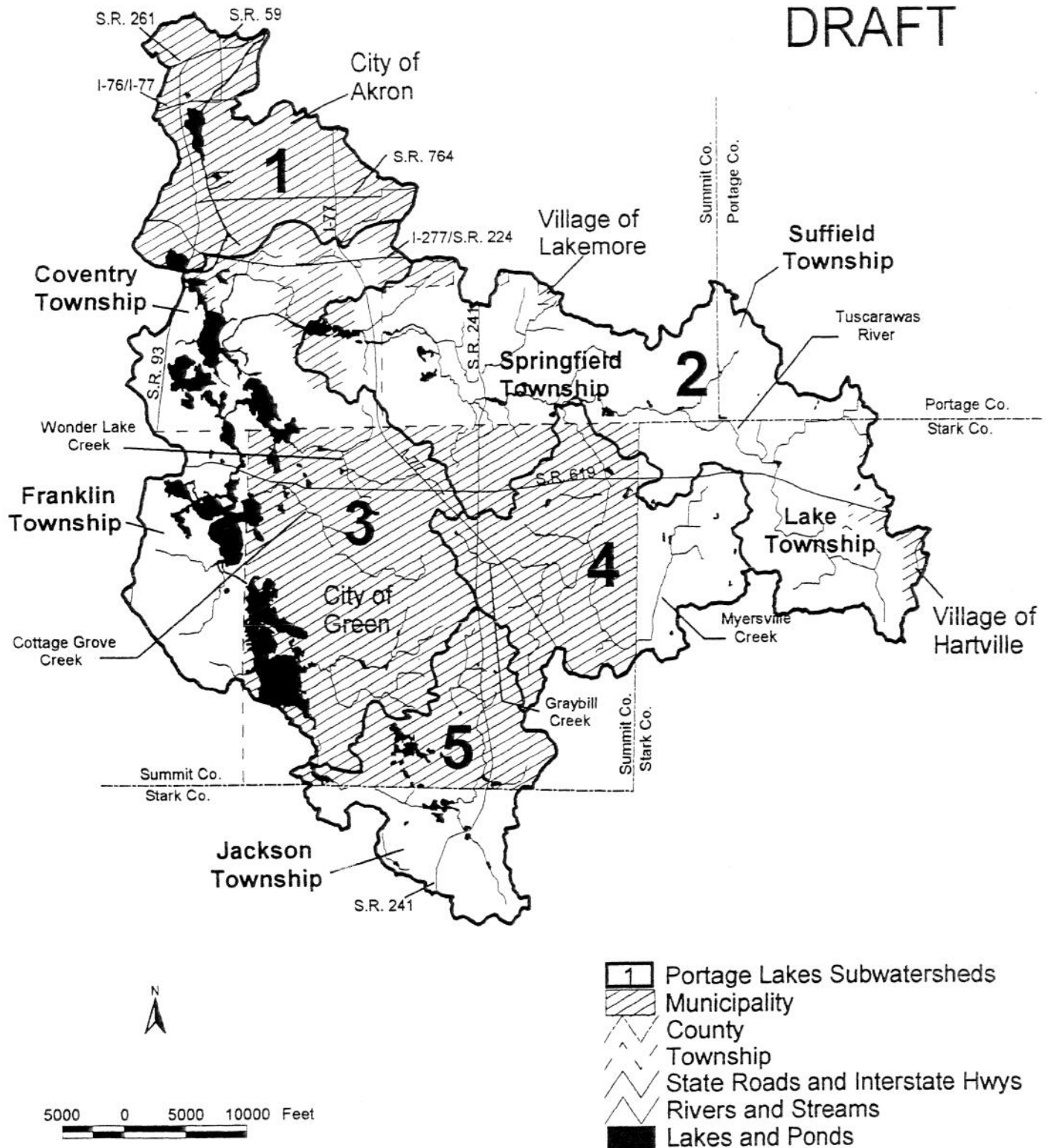

NEFCO STAFF RATINGS (DRAFT)

Pollution Potential Ratings* for each Subwatershed of the Upper Tuscarawas Watershed					
Identified Potential Pollution Source	Subwatershed				
	1	2	3	4	5
a. Off-Lot (Discharging) Home/Semi-Public Sewage Disposal Systems (Septic Tanks)	1	4	5	3	4
b. Failing On-Lot Home/Semi-Public Sewage Disposal Systems (Septic Tanks)	1	4	5	3	3
c. Public and Semi-Public Sewage Treatment Plants (Package Plants)	5	3	5	3	2
d. Trucking Activity and Related Maintenance (Including Diesel Fuel Use)	5	3	4	3	3
e. Oil and Gas Wells (i.e., Oil and Gas Production and Exploration/Drilling Activity)	2	2	5	3	3
f. Oil and Gas Pipelines (i.e., Oil and Gas Transportation)	2	3	4	2	3
g. Leaking Underground Storage Tanks	4	3	5	3	4
h. Registered Underground Storage Tanks (Awaiting information to evaluate this category)					
i. Gasoline Use (Including Storage and Transportation of Gasoline)	4	3	5	3	3
j. Impervious Areas (e.g., Rooftops, Roads, Parking Lots, etc.)	5	3	4	3	3
k. Agricultural Areas	1	3	2	4	3
l. Construction Sites	1	4	5	5	5
m. Nurseries/Greenhouses and Landscaping Operations	2	3	3	2	2
n. Lawn and Garden/Household Maintenance Activity	3	3	4	3	3
o. Golf Courses	1	3	3	4	1
p. Fuel Oil Use (Including Storage and Transportation of Fuel Oil)	2	2	3	2	2
q. Salt Storage and Seasonal Spreading of Salt	2	2	3	2	3
r. Polychlorinated Biphenyls (PCBs) Use (Used in Some Electrical Transformers)	2	2	2	2	2
s. Abandoned Drinking Water Wells	1	2	3	3	2
t. Mining Activity	2	3	3	3	2
u. Industrial Land Use Areas	5	3	2	2	2
v. Boating Activities	1	1	3	1	1
w. Landfills and dumps	2	2	2	4	2
x. Nutrients From Natural Sources (e.g., Geese)	1	2	3	1	2

*Key to Pollution Potential Ratings:

- 1 = Virtually no potential to impair surface water and/or ground water quality.
- 2 = Low potential to impair surface water and/or ground water quality.
- 3 = Moderate potential to impair surface water and/or ground water quality.
- 4 = High potential to impair surface water and/or ground water quality.
- 5 = Very high potential to impair surface water and/or ground water quality.

Pollution Potential Ratings* for each Subwatershed of the Upper Tuscarawas Watershed					
Identified Potential Pollution Source	Subwatershed				
	1	2	3	4	5
a. Off-Lot (Discharging) Home/Semi-Public Sewage Disposal Systems (Septic Tanks)					
b. Failing On-Lot Home/Semi-Public Sewage Disposal Systems (Septic Tanks)					
c. Public and Semi-Public Sewage Treatment Plants (Package Plants)					
d. Trucking Activity and Related Maintenance (Including Diesel Fuel Use)					
e. Oil and Gas Wells (i.e., Oil and Gas Production and Exploration/Drilling Activity)					
f. Oil and Gas Pipelines (i.e., Oil and Gas Transportation)					
g. Leaking Underground Storage Tanks					
h. Registered Underground Storage Tanks					
i. Gasoline Use (Including Storage and Transportation of Gasoline)					
j. Impervious Areas (e.g., Rooftops, Roads, Parking Lots, etc.)					
k. Agricultural Areas					
l. Construction Sites					
m. Nurseries/Greenhouses and Landscaping Operations					
n. Lawn and Garden/Household Maintenance Activity					
o. Golf Courses					
p. Fuel Oil Use (Including Storage and Transportation of Fuel Oil)					
q. Salt Storage and Seasonal Spreading of Salt					
r. Polychlorinated Biphenyls (PCBs) Use (Used in Some Electrical Transformers)					
s. Abandoned Drinking Water Wells					
t. Mining Activity					
u. Industrial Land Use Areas					
v. Boating Activities					
w. Landfills and dumps					
x. Nutrients From Natural Sources (e.g., Geese)					

***Key to Pollution Potential Ratings:**

- 1 = Virtually no potential to impair surface water and/or ground water quality.
- 2 = Low potential to impair surface water and/or ground water quality.
- 3 = Moderate potential to impair surface water and/or ground water quality.
- 4 = High potential to impair surface water and/or ground water quality.
- 5 = Very high potential to impair surface water and/or ground water quality.

Criteria for Assigning Pollution Potential Ratings to each Subwatershed

Note: A map of the watershed has been included, which contains the locations of the five subwatersheds.

Criteria for rating each identified potential pollution source are based mostly on the Reduction Analysis Public Meetings Information Packet Final Report (May 1996). When referring to this report, focus only on the Upper Basin of the Tuscarawas Watershed when upper and lower are reported. Some of the pollution sources listed below have not been discussed in previous reports. Their presence and distribution should be considered when looking at potential pollution sources. Additional information currently unavailable in a report format, will be presented at the meeting. If you can contribute any further information, please let us know.

- a. Off-lot (Discharging) Home/Semi-Public Sewage Disposal Systems (HSDS's), commonly referred to as Septic Tanks.
 - ▶ Unsewered area (Fig. 2, p. 85) of the subwatershed and significant concentrations of residences served with septic tanks (Fig. 1, p.79 and Table 5, p.78)
 - ▶ Residential areas over than twenty years old, since the average life expectancy of a properly functioning HSDS is about twenty years
 - ▶ Areas near the Portage Lakes, subwatersheds 1 and 3, have been identified as areas with soil characteristics conducive for septic system failure
 - ▶ Number of residential roads parallel to streams/discharge point in the subwatershed
 - ▶ Areas in the subwatershed with a known increasing amount of development
 - ▶ The fact that there is a lack of any routine monitoring of off-lot systems
- b. Failing On-Lot Home/Semi-Public Sewage Disposal Systems (Septic Tanks)
 - ▶ Same criteria as above for rating off-lot systems, plus residential areas close to streams (about 200-300 ft.), and the distribution of semi-public sewage disposal systems
- c. Public and Semi-public Wastewater Treatment Plants (Package Plants)
 - ▶ The distribution of public and semi-public treatment plants (Fig. 2, p.85 and Table 8, p. 84)
 - ▶ Combined design flow (maximum discharge) for the subwatershed
 - ▶ Known lack of nutrient monitoring of small package plants
 - ▶ The presence of one major publicly owned treatment plant in subwatershed 2 (Summit County Wastewater Treatment Plant)
- d. Trucking Activity and Related Maintenance (Including Diesel Fuel Use)
 - ▶ Trucking related spills in the subwatershed
 - ▶ Presence of primary roads, especially state and interstate highways in the subwatershed, i.e. interstate 77, State Routes 59, 224, 241, 764 and 619
 - ▶ Location of trucking terminals relative to streams in the subwatershed
 - ▶ The fact that some of the compounds spilled by trucking activity are long-lived (streams have difficulty assimilating them)
- e. Oil and Gas Wells (i.e., Oil and Gas Production and Exploration/Drilling Activity)
 - ▶ Distribution and density of active wells and drilling activity (p. 76 and Table 4, p. 77)
 - ▶ Relative distance to streams

- f. Oil and Gas Pipelines (i.e., Oil and Gas Transmission)
 - Location/distribution of pipelines relative to subwatersheds and streams
 - Areas of increasing amount of development activity where excavators may accidentally dig up a pipeline
 - The fact that pipelines eventually corrode and may develop leaks
 - Reported pipeline spills
- g. Leaking Underground Storage Tanks
 - Distribution and location of reported releases relative to streams and ground water
 - Known releases of specific compounds e.g., gasoline
- h. Registered Underground Storage Tanks
 - Distribution and location relative to streams and ground water
 - Registration requires some sort of protective mechanism in place to lessen the potential for leaks to occur
- i. Gasoline Use (Including Storage and Transportation of Gasoline)
 - Distribution and location of reported releases relative to streams and ground water
 - Presence of roads/highways and the relative closeness of these roads/highways to surface water and ground water
- j. Impervious Areas (e.g., Rooftops, Roads, Parking Lots, etc.)
 - All of above criteria for rating Gasoline Use, plus the location/distribution of all reported spills and possible soil loss downstream from impervious areas, since the increase in runoff (overland flow) from impervious areas can exacerbate natural erosion processes
- k. Agricultural Areas
 - Agricultural land use areas
 - Distribution/location of agricultural areas relative to lakes and streams
- l. Construction Sites
 - All of above criteria for rating Agricultural Areas, plus development on prime agricultural land that has occurred (presence of residential roads in agricultural areas)
 - Active construction sites
 - Areas of increasing development
- m. Nurseries/Greenhouses and Landscaping Operations
 - Distribution of nurseries/greenhouses/landscaping operations
 - Relative closeness to streams
- n. Lawn and Garden/Household Maintenance Activity
 - Distribution of residential areas and more recent residential roads
 - Relative closeness to streams
 - Number of landowners with direct access to the watershed
- o. Golf Courses
 - Seven golf courses have been located in the watershed. All of these are located in Summit County and are listed by subwatershed below:

Subwatershed 2:	Subwatershed 3:	Subwatershed 4:
1. Firestone Raymond C.	1. Turkeyfoot	1. Mayfair
2. Chenoweth		2. Ohio Prestwick
3. Firestone Country Club		3. Raintree
 - Frequency of application for pesticides and fertilizers
 - Relative closeness to streams

- p. Fuel Oil Use (Including Storage and Transportation of Fuel Oil)
 - ▶ Distribution/location of reported spills and relative closeness to surface water and ground water
 - ▶ Presence and quantity of roads (fuel oil is trucked)
 - ▶ Known areas lacking natural gas service
- q. Salt Storage and Seasonal Spreading of Salt
 - ▶ Five sites for salt storage in the watershed; three of these are in subwatershed 3, one in subwatershed 2, and one in subwatershed 5. All five of these sites are covered.
 - ▶ Presence of roads and surface area of road/parking lot surface (impervious area)
 - ▶ High-traffic roads and parking lots (state routes, interstate highways)
- r. Polychlorinated Biphenyls (PCBs) Use (Used in Some Electrical Transformers)
 - ▶ Distribution/location of reported spills relative to streams and ground water
 - ▶ PCBs are used in electrical transformers (mounted on poles) throughout the watershed, and would be present on residential roads developed prior to 1989
- s. Abandoned Drinking Water Wells
 - ▶ The number of private wells in the watershed
 - ▶ The potential for abandoned well contamination--the number and types of reported spills and failing sewage disposal systems
 - ▶ Distribution/location of reported spills
- t. Mining Activity (Sand and Gravel or Coal Mines)
 - ▶ Distribution of active or abandoned sand and gravel pits or coal mines (abandoned pits could now be ponds/lakes) (Figure for right half of Upper Basin on p.9 and text on p.76)
 - ▶ The potential for pit contamination--the number and types of report spills, failing sewage disposal systems nearby, etc.
 - ▶ Distribution/location of reported spills relative to streams and ground water (many pits are abandoned when ground water is encountered)
 - ▶ Acid mine drainage
- u. Industrial Land Use Areas (Active or Abandoned)
 - ▶ Chemical use and disposal
 - ▶ Location in the subwatershed; e.g., Akron-Canton Airport in subwatershed 5 and the Firestone Plant in subwatershed 1
- v. Boating Activities
 - ▶ Suspected level of activity resulting in shoreline erosion and sediment resuspension
 - ▶ Gasoline, oil and other chemical use and potential for leaks/spills directly into waterways
- w. Landfills and Dumps
 - ▶ Number of Landfills and Dumps and proximity to surface and ground water
 - ▶ No Active Solid Waste Landfills; however; subwatershed 4 contains an inactive landfill in Uniontown
- x. Nutrients from Natural Sources
 - ▶ Fecal contamination from water fowl, e.g., high populations of Giant Canada Geese are found in subwatershed 3, near the Portage Lakes

UNIONTOWN

Meeting to launch study of river quality

AKRON
BEACON
JOURNAL

Water quality on the Upper Tuscarawas River will be re-examined by an Akron-based planning agency, starting with a public meeting Aug. 18.

The meeting, arranged by the Northeast Ohio Four County Regional Planning and Development Agency, will be at 7 p.m. at the Uniontown Fire Department, 13055 Oakwood Ave. N.W.

The agency got funding to look at the Tuscarawas River east of the Portage Lakes in Summit, Stark and Portage counties and its impact on the Portage Lakes.

Call 330-836-5731 for information.

August 13, 1998 West Side Leader

COMMUNITY NEWS

**SEE MOTHER NATURE AT HER
BEST — A CONSTRUCTED WETLAND
PORTAGE COUNTY —**
Talk about a combination of back to the future and Mother Nature!

More than two years ago, a constructed wetland was built to demonstrate the potential effectiveness of constructed wetlands as an alternative wastewater-treatment system. The purpose of the project was to introduce an alternative method of treating residential wastewater in unsewered areas when conventional treatment systems fail or when the soils severely limit a system's effectiveness.

Now, Northeast Ohio Four

County Regional Planning and Development Organization (NEFCO) is providing the opportunity for the public to view the constructed wetland, a project conducted in cooperation with the City of Akron, Portage County Health Department, Portage Soil and Water Conservation District, the Upper Cuyahoga River Watershed Task Force and NEFCO.

The constructed wetland is located at 7509 state Route 14, southeast of Lake Rockwell Road. The two-hour tour will take place Aug. 20 at 10 a.m.

For details, call Amy Reichlin or Claude Custer at 836-5731.

In a related water matter, NEFCO has received funding from the Summit Soil and Water Conservation District to reconvene the Portage Lakes Task Force to discuss water quality and pollution

problems in the Upper Tuscarawas River Watershed.

A watershed is the area of land from which surface water drains into a common outlet, such as a lake, river or wetland. The Upper Tuscarawas River Watershed extends from Hartville to south of Akron and includes the Portage Lakes.

NEFCO will examine current conditions and target critical streams for protection and/or restoration. In addition, the organization will identify the best management practices to reduce the impact of runoff on water quality.

A series of meetings will assist in prioritizing watershed efforts. The next meeting will take place Aug. 18 at 7 p.m. at the Uniontown Fire Department, located at the corner of Oakwood and Edison roads in Lake Township.

For details, call 836-5731.

ATTENTION ONLY
Portage Lakes Task Force
August 18, 1998
7:00 p.m.

	NAME	REPRESENTING	ADDRESS	PHONE / FAX
1	Judy Heasley		3011 Northview Rd Uniontown 44685	699-3297
2	Jesse Dittz		2975 Northview Rd Uniontown 44685	699-2654
3	Tammy Proctor	Hartsville News	P.O. Box 428	877-9345 FAX 877-1364
4	Don Myers	Lake Township Trustee	2314 State St NE North Canton OH 44721	877 2546
5	John Bradshaw	Kent Health Dept.	930 Overholt Rd Kent 44240	678-8109
6	Vince Mealy	Homeowner - Springfield Twp.	3089 Northview Rd. Uniontown Oh 44685	699-0475
7	Andrew Chatterton	City of Green	5383 Resillon Rd. Green, OH	896-6614
8	James Titmas	self	3577 Yellow Creek Rd	650 6644 650 2624 Fax
9	Lori Monsewicz	Repository		454-5611 ext. 309 699-1085 (w)

	Name	Representing	Address	Phone
10	NORM and Linda Gerstenslager	Selfs	3035 Northview Rd	699-1196
11	Judi Brightwell	CCLT	11897 Basswood Ave	
12	Chris Borello	CCLT	2816 Bridlewood St NW	499-5207
13	Bill Nye	Portage Lakes Advisory Council Franklin Twp	4538 Lahm Dr, Akron 44319	644-0325
14	Jo Ann Keiser	NEFCO	969 Copley Rd. Akron, OH 44320	836-5731
15	Jeff Pritchard	Self	1343 Homoda Ave Akron, Ohio 44305	784-7162
16	Charles Carter	NEFCO		