

- LEGEND**
- BIORETENTION AREA
 - SELF-TREATING AREA
 - NOT TREATED AREA
 - IMPERVIOUS AREA (PAVEMENT / HARDSCAPE)
 - IMPERVIOUS AREA (ROOF)
 - PERVIOUS AREA (LANDSCAPE)
 - DRAINAGE MANAGEMENT AREA
 - BMP IDENTIFICATION
 - WATER SHED IDENTIFICATION
 - BEST MANAGEMENT PRACTICES

IMPERVIOUS AREA TABULATION:
 TOTAL SITE AREA: 42.32 ACRES (PARCEL 1)
 EXISTING IMPERVIOUS AREA: 0 SF (SITE IS CURRENTLY VACANT AND UNDEVELOPED)
 PROPOSED IMPERVIOUS AREA:
 ROOFS: 293,799 SF = 6.7 AC. (BUILDINGS AND ENCLOSURES)
 PAVEMENT: 475,826 SF = 10.9 AC. (DRIVES, PARKING, WALKS/HARDSCAPE)
 TOTAL IMPERVIOUS AREA: 769,625 SF (17.7 ACRES)

Rev	Date	Description	Designed	Drawn	Checked
03/22/2024		SPAR SUBMITTAL			

CSW ST 2
CSW/Stuber-Stroeh Engineering Group, Inc.
 Civil Engineering · Planning · Land Surveying & Mapping
 504 Redwood Blvd., Ste 310 Novato, CA 94947
 tel.: 415.883.9850 fax: 415.883.9835
 http://www.cswst.com © 2023

City	Petaluma
County	Sonoma
State	California

DEER CREEK APARTMENTS
 PRELIMINARY STORMWATER CONTROL PLAN - OVERALL
 ACCLAIM COMPANIES

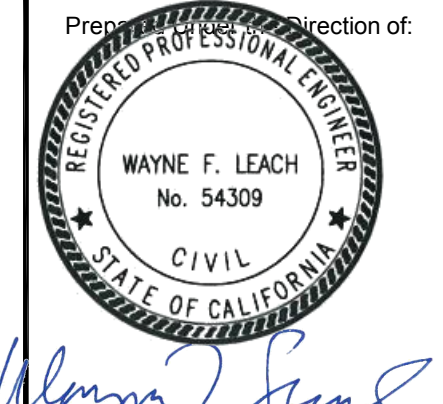

Sheet	C4.0
Scale:	1" = 80'
Date:	12/11/2023
Project Number:	23.00.128
Plan File:	

US HIGHWAY 101

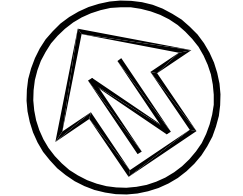

Graphic Scale (in feet)

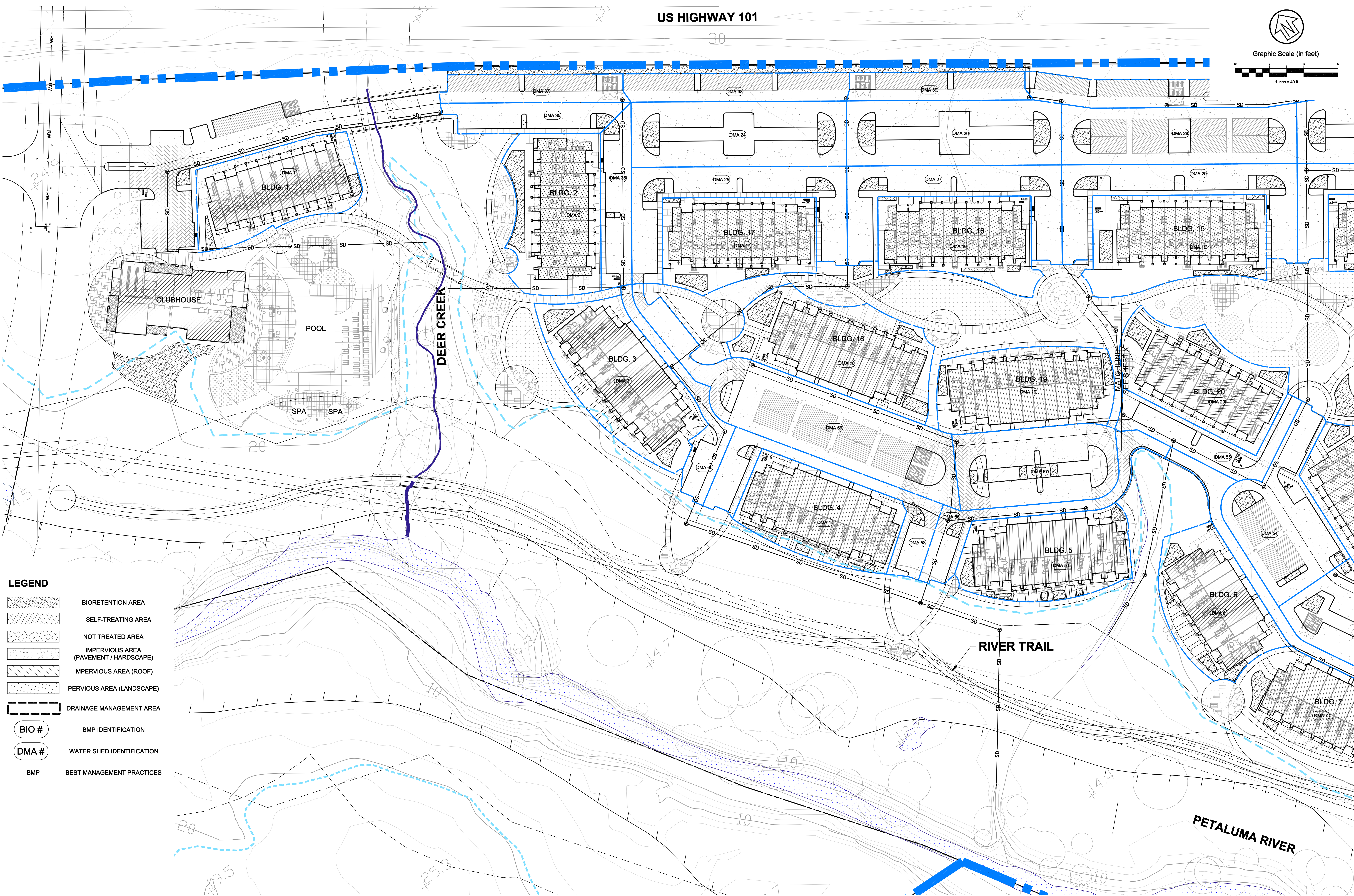
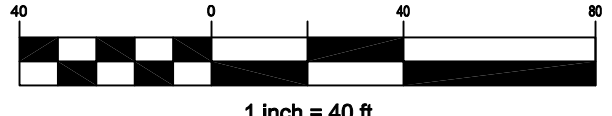

- LEGEND**
- BIORETENTION AREA
 - SELF-TREATING AREA
 - NOT TREATED AREA
 - IMPERVIOUS AREA (PAVEMENT / HARDSCAPE)
 - IMPERVIOUS AREA (ROOF)
 - PERVIOUS AREA (LANDSCAPE)
 - DRAINAGE MANAGEMENT AREA
 - BMP IDENTIFICATION
 - WATER SHED IDENTIFICATION
 - BEST MANAGEMENT PRACTICES

Rev	Date	Description	Designed	Drawn	Checked
03/22/2024		SPAR SUBMITTAL			

CSW ST2
 CSW/Stuber-Stroeh Engineering Group, Inc.
 Civil Engineering - Planning - Land Surveying & Mapping
 504 Redwood Blvd., Ste 310 Novato, CA 94947
 tel.: 415.883.9850 fax: 415.883.9835
<http://www.cswst.com>
 © 2023

City	Petaluma
County	Sonoma
State	California

DEER CREEK APARTMENTS
 PRELIMINARY STORMWATER CONTROL PLAN - WEST
 ACCLAIM COMPANIES

Professional Seal:
 Wayne F. Leach, No. 54309, Civil Engineer, State of California.
 Signature: *Wayne F. Leach*

Sheet	C4.1
Scale:	1" = 40'
Date:	12/11/2023
Project Number:	23.00.128
Plan File:	

Small vertical text on the right edge: E:\shared\proj\2300128\2300128_03B_Separate\DWG\Sheet-C4.1-Stormwater-Control-Plan-Final.rvt 03/22/2024 08:28 AM Rev 13.032

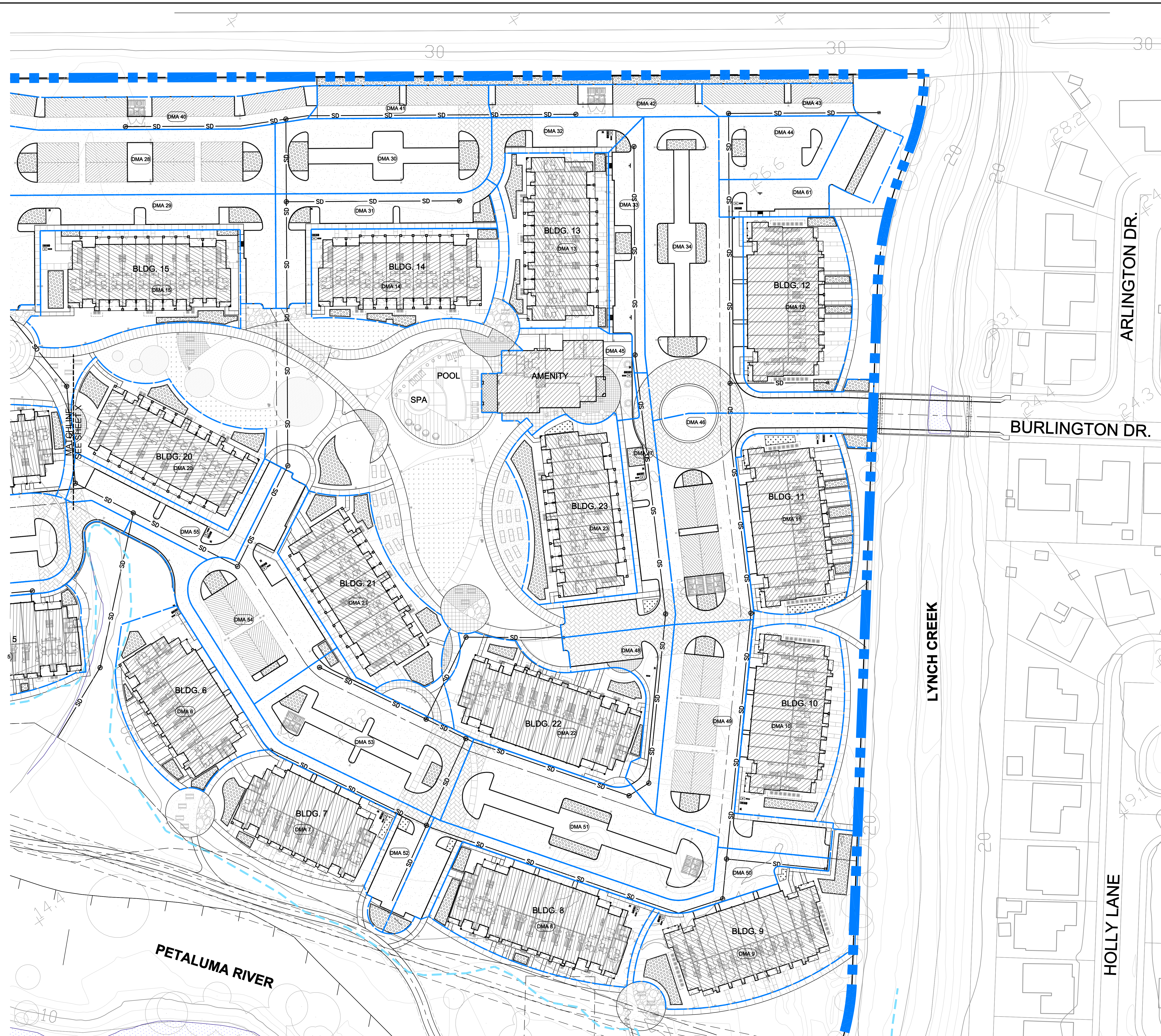
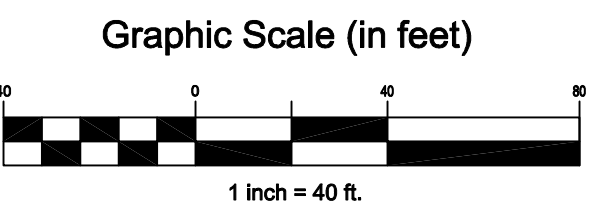
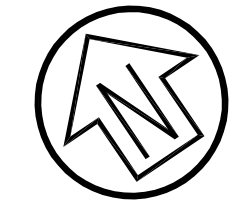

- LEGEND**
- BIORETENTION AREA
 - SELF-TREATING AREA
 - NOT TREATED AREA
 - IMPERVIOUS AREA (PAVEMENT / HARDSCAPE)
 - IMPERVIOUS AREA (ROOF)
 - PERVIOUS AREA (LANDSCAPE)
 - DRAINAGE MANAGEMENT AREA
 - BIO #** BMP IDENTIFICATION
 - DMA #** WATER SHED IDENTIFICATION
 - BMP** BEST MANAGEMENT PRACTICES

Rev	Date	Description	Designed	Drawn	Checked
03/22/2024		SPAR SUBMITTAL			

CSW ST2
CSW/Stuber-Stroeh Engineering Group, Inc.
 Civil Engineering · Planning · Land Surveying & Mapping
 504 Redwood Blvd., Ste 310 Novato, CA 94947
 Tel.: 415.883.9850 Fax: 415.883.9835
 www.cswst2.com © 2023

City: Petaluma
 County: Sonoma
 State: California

DEER CREEK APARTMENTS
 PRELIMINARY STORMWATER CONTROL PLAN - EAST
 ACCLAIM COMPANIES

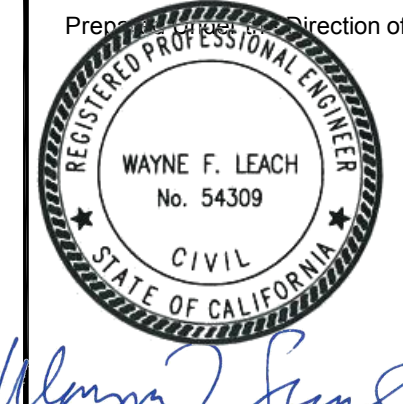

Sheet: **C4.2**
 Scale: 1" = 40'
 Date: 12/11/2023
 Project Number: 23.00.128
 Plan File:

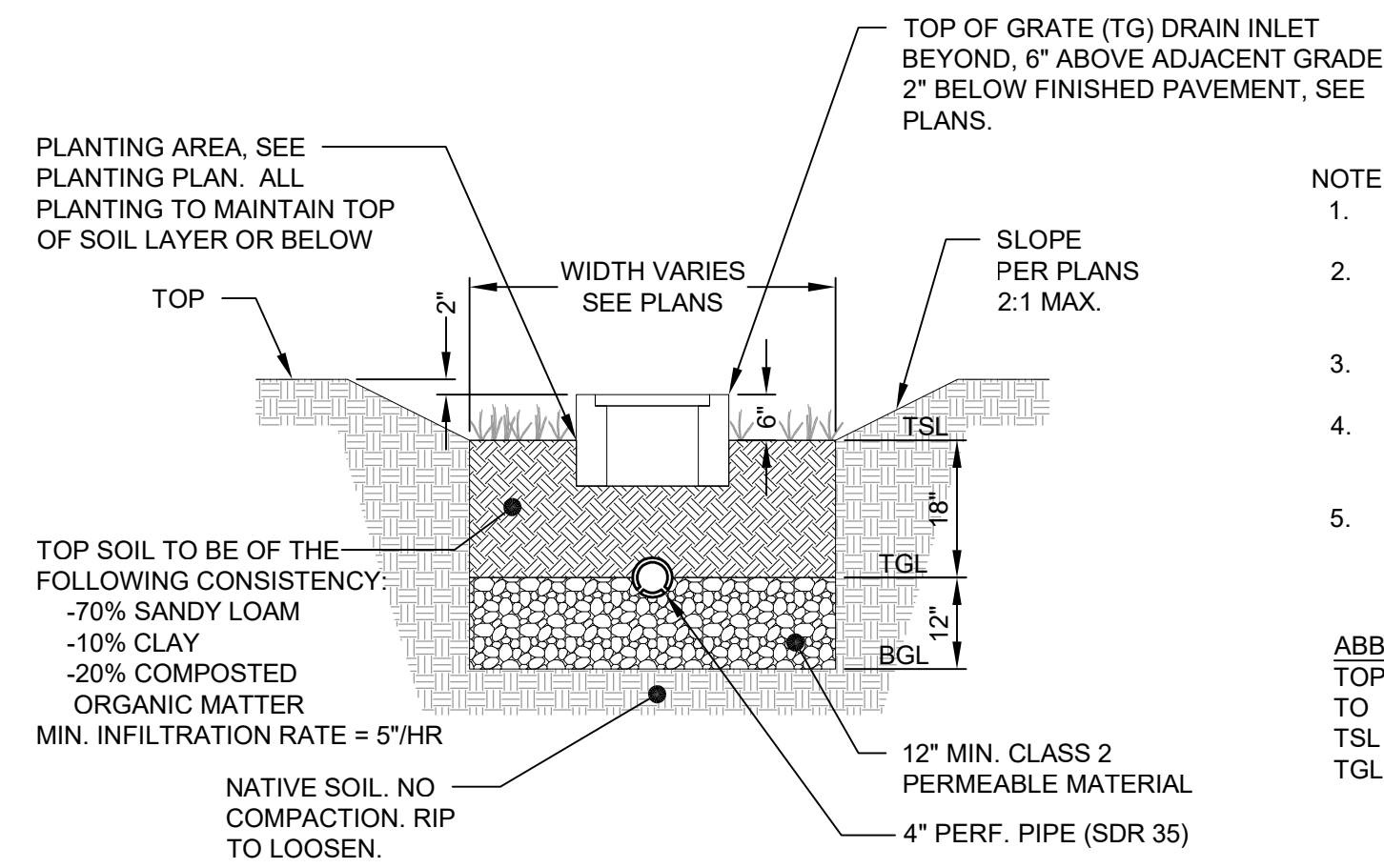

- NOTE:
1. BIORETENTION AREAS HAVE A MINIMUM DEPTH OF 6".
 2. ELEVATION OF UNDERDRAIN DISCHARGE IS AT TOP OF GRAVEL LAYER.
 3. CONNECT TO STORMDRAIN INLET OR OUTFALL.
 4. PROVIDE CLEANOUTS AT ENDS & ANGLE POINTS WITH TOP 2" MIN. ABOVE OVERFLOW LEVEL.
 5. USE CHECK DAM FOR AREAS WHERE LONGITUDINAL SLOPE EXCEEDS 1%.
- ABBREVIATIONS:
 TOP TOP BIORETENTION / TOP PLANTER
 TO TOP OVERFLOW DRAIN
 TSL TOP SOIL LAYER
 TGL TOP GRAVEL LAYER

1 BIORETENTION AREA DETAIL (BIO TYP.)
 SCALE: 1/2" = 1'

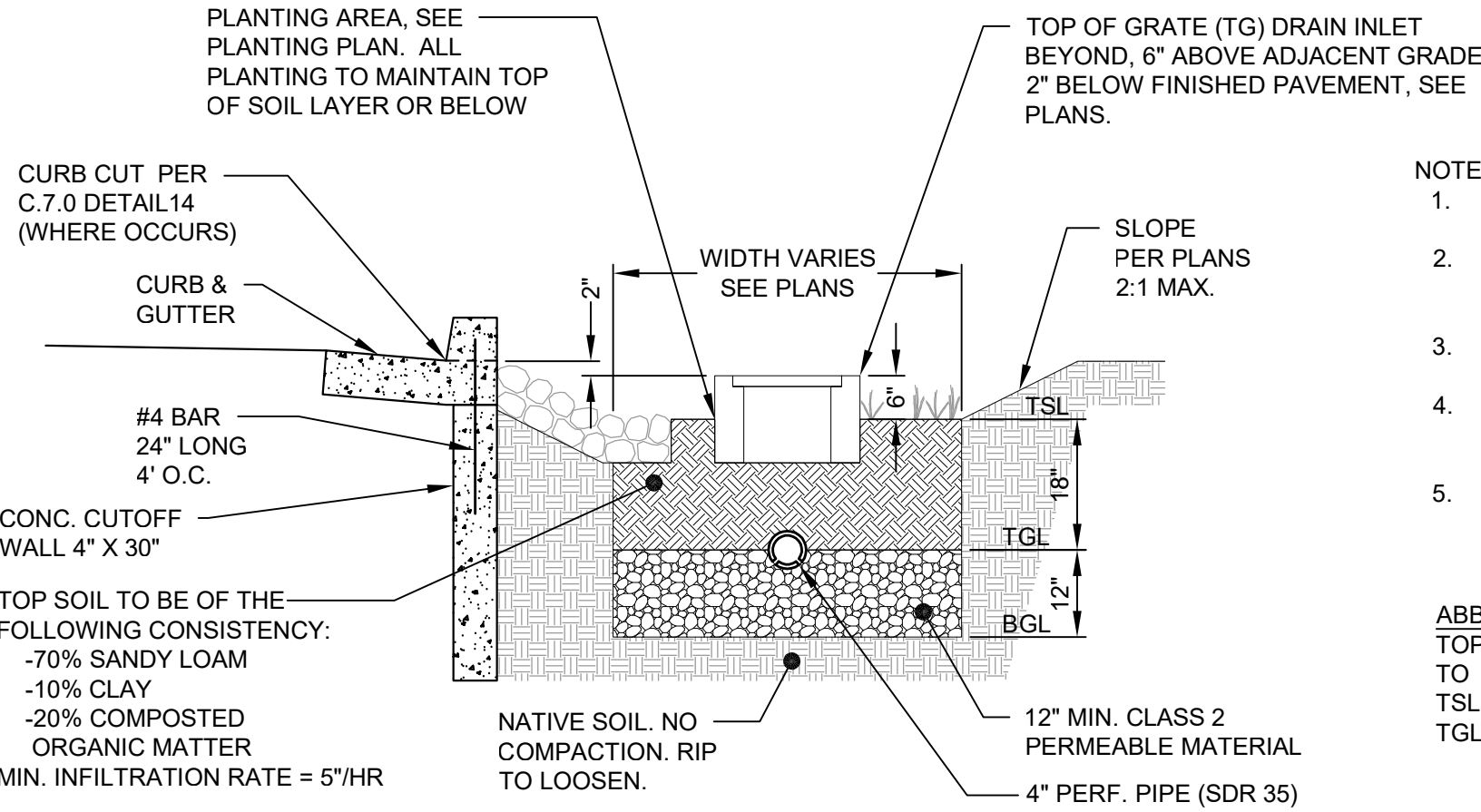

- NOTE:
1. BIORETENTION AREAS HAVE A MINIMUM DEPTH OF 6".
 2. ELEVATION OF UNDERDRAIN DISCHARGE IS AT TOP OF GRAVEL LAYER.
 3. CONNECT TO STORMDRAIN INLET OR OUTFALL.
 4. PROVIDE CLEANOUTS AT ENDS & ANGLE POINTS WITH TOP 2" MIN. ABOVE OVERFLOW LEVEL.
 5. USE CHECK DAM FOR AREAS WHERE LONGITUDINAL SLOPE EXCEEDS 1%.
- ABBREVIATIONS:
 TOP TOP BIORETENTION / TOP PLANTER
 TO TOP OVERFLOW DRAIN
 TSL TOP SOIL LAYER
 TGL TOP GRAVEL LAYER

5 BIORETENTION AREA DETAIL (BIO TYP.)
 SCALE: 1" = 1'

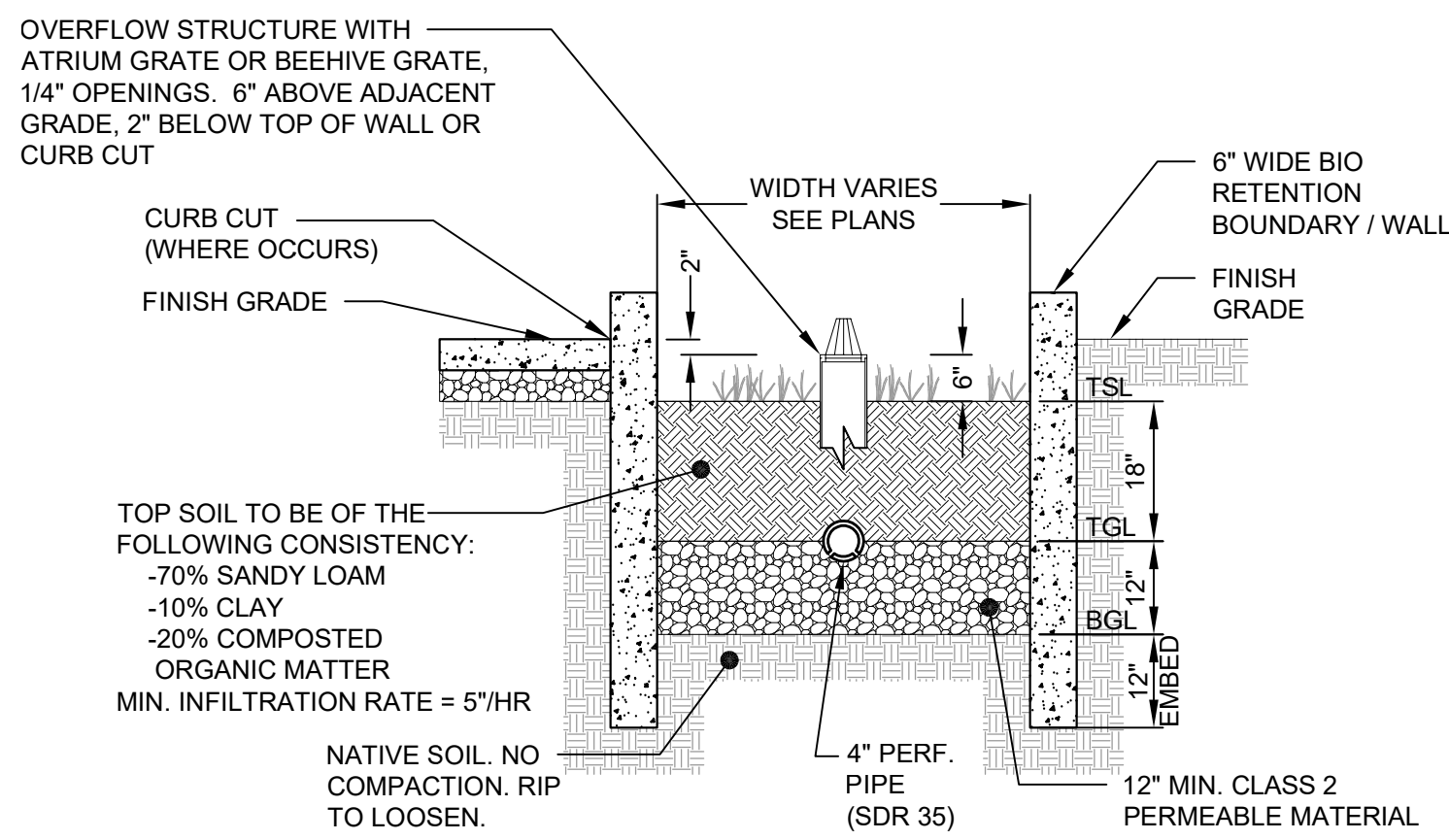

- NOTE:
1. BIORETENTION AREAS HAVE A MINIMUM DEPTH OF 6".
 2. ELEVATION OF UNDERDRAIN DISCHARGE IS AT TOP OF GRAVEL LAYER.
 3. CONNECT TO STORMDRAIN INLET OR OUTFALL.
 4. PROVIDE CLEANOUTS AT ENDS & ANGLE POINTS WITH TOP 2" MIN. ABOVE OVERFLOW LEVEL.
 5. USE CHECKDAM FOR AREAS WHERE LONGITUDINAL SLOPE EXCEEDS 1%.
 6. PROVIDE LATERAL BRACING EVERY 6".
- ABBREVIATIONS:
 TOP TOP BIORETENTION / TOP PLANTER
 TO TOP OVERFLOW DRAIN
 TSL TOP SOIL LAYER
 TGL TOP GRAVEL LAYER

2 BIORETENTION AREA DETAIL (BIO TYP.)
 SCALE: 1/2" = 1'

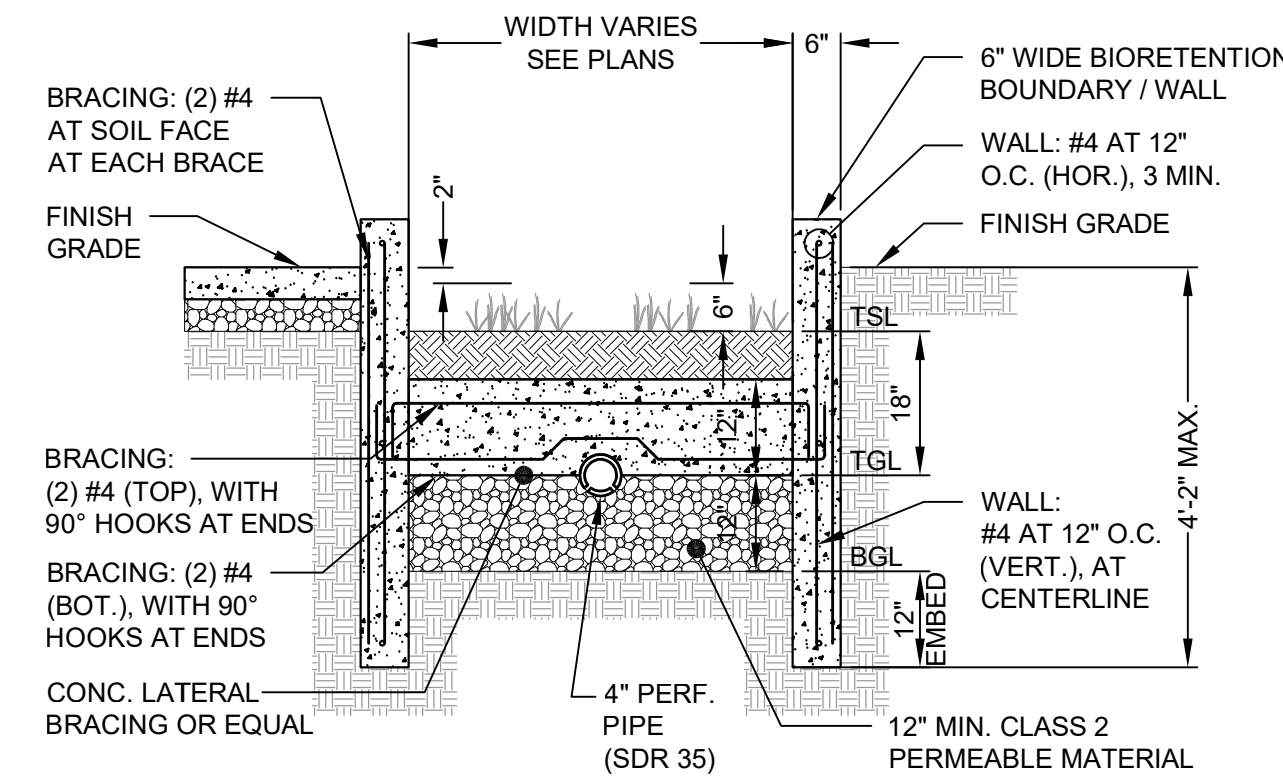

- NOTE:
1. CONCRETE LATERAL BRACING SHALL BE CONTINUOUS (NO JOINTS).
 2. LATERAL BRACING SHALL BE PROVIDED EVERY 6" (MAX.) FOR WALLS UP TO 4 FEET IN HEIGHT.

6 BIORETENTION - WALL REINFORCING AND LATERAL BRACING
 SCALE: 1/2" = 1'

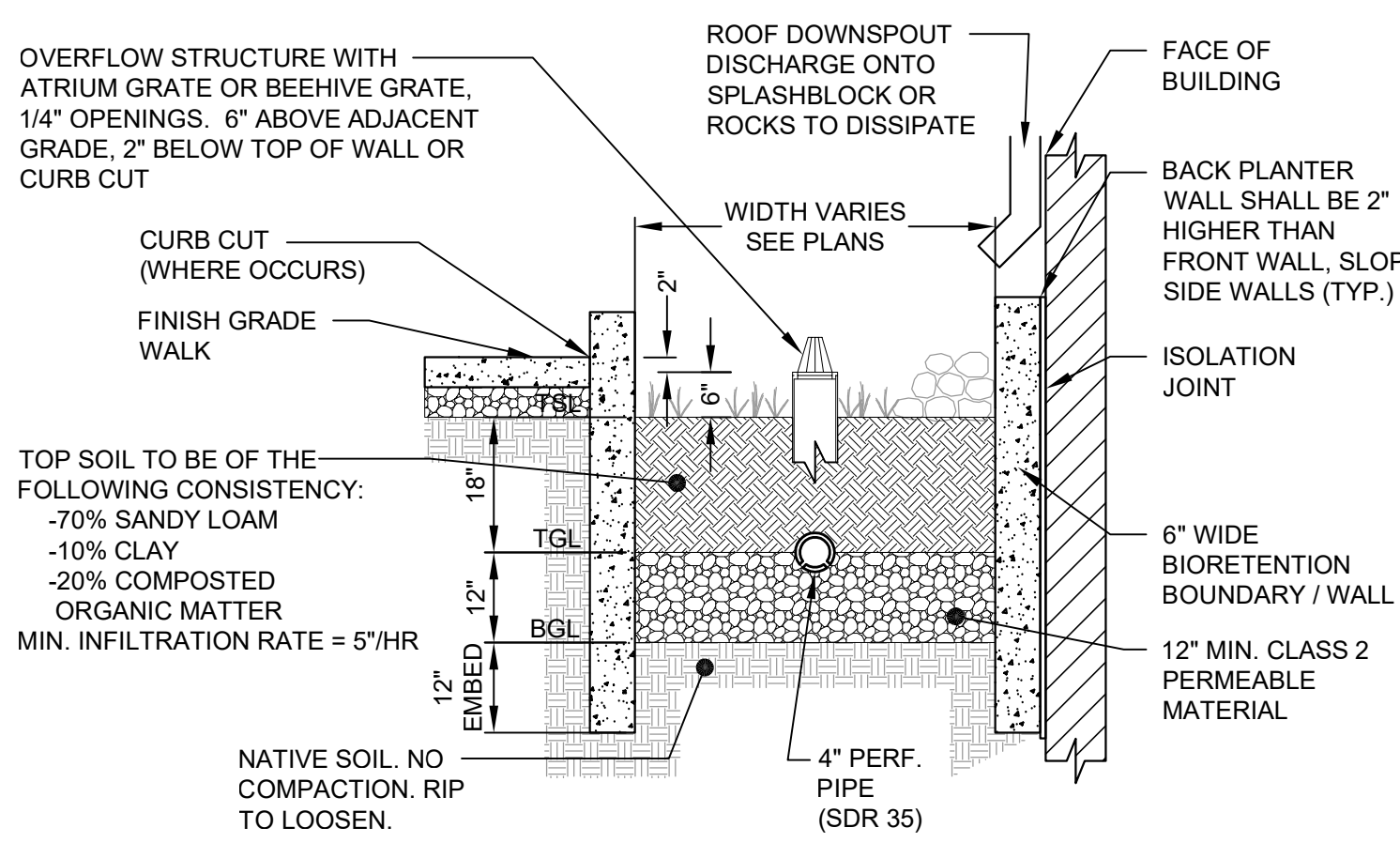

- NOTE:
1. BIORETENTION AREAS HAVE A MINIMUM DEPTH OF 6".
 2. ELEVATION OF UNDERDRAIN DISCHARGE IS AT TOP OF GRAVEL LAYER.
 3. CONNECT TO STORMDRAIN INLET OR OUTFALL.
 4. PROVIDE CLEANOUTS AT ENDS & ANGLE POINTS WITH TOP 2" MIN. ABOVE OVERFLOW LEVEL.
 5. USE CHECKDAM FOR AREAS WHERE LONGITUDINAL SLOPE EXCEEDS 1%.
 6. PROVIDE LATERAL BRACING EVERY 6".
- ABBREVIATIONS:
 TOP TOP BIORETENTION / TOP PLANTER
 TO TOP OVERFLOW DRAIN
 TSL TOP SOIL LAYER
 TGL TOP GRAVEL LAYER

3 BIORETENTION AREA DETAIL (BIO TYP.)
 SCALE: 1" = 1'

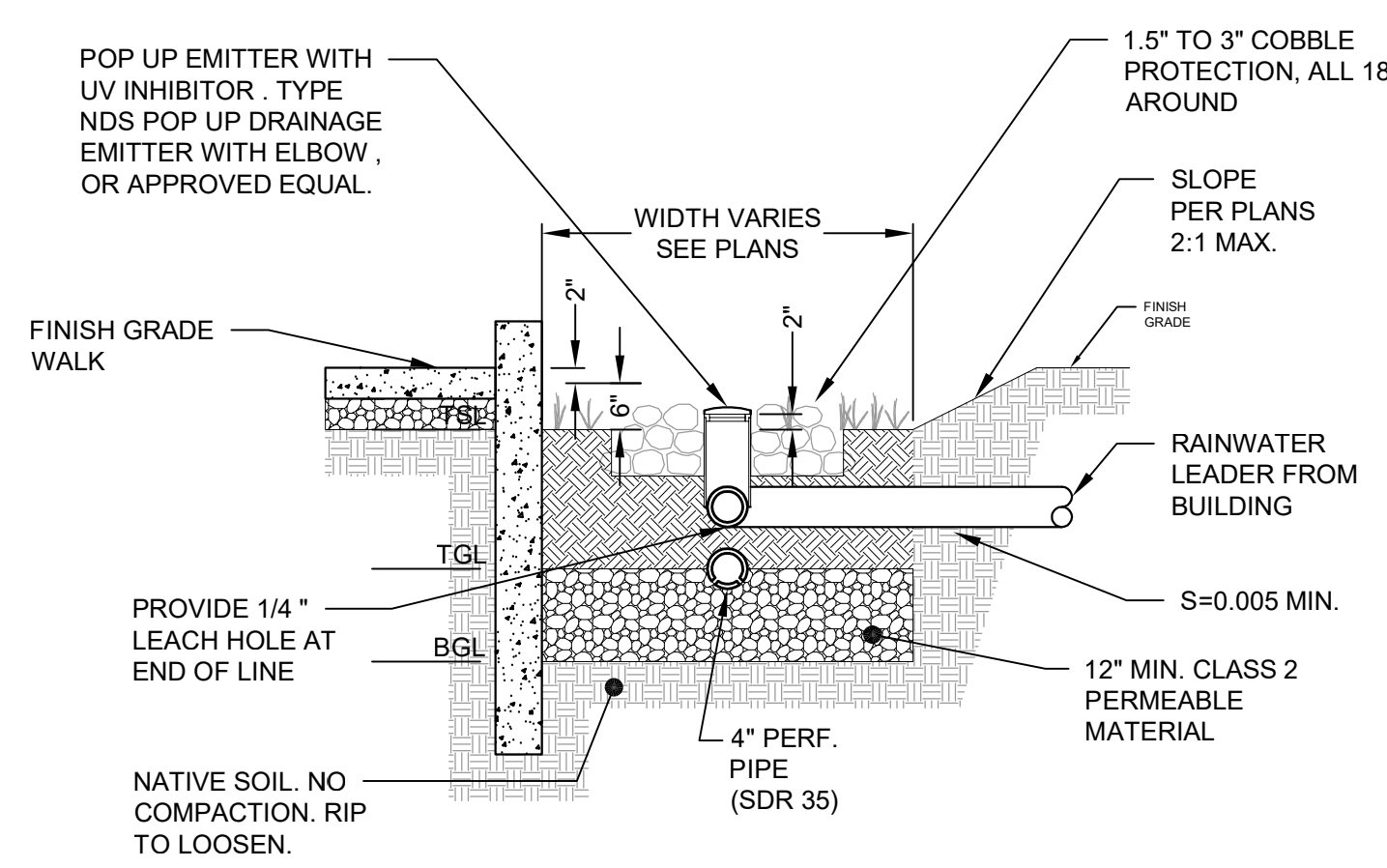

- NOTE:
1. BIORETENTION AREAS HAVE A MINIMUM DEPTH OF 6".
 2. ELEVATION OF UNDERDRAIN DISCHARGE IS AT TOP OF GRAVEL LAYER.
 3. CONNECT TO STORMDRAIN INLET OR OUTFALL.
 4. PROVIDE CLEANOUTS AT ENDS & ANGLE POINTS WITH TOP 2" MIN. ABOVE OVERFLOW LEVEL.
 5. USE CHECKDAM FOR AREAS WHERE LONGITUDINAL SLOPE EXCEEDS 1%.
 6. PROVIDE LATERAL BRACING EVERY 6".
- ABBREVIATIONS:
 TOP TOP BIORETENTION / TOP PLANTER
 TO TOP OVERFLOW DRAIN
 TSL TOP SOIL LAYER
 TGL TOP GRAVEL LAYER

7 BIORETENTION - RAINWATER LEADER BUBBLE UP
 SCALE: 1/2" = 1'

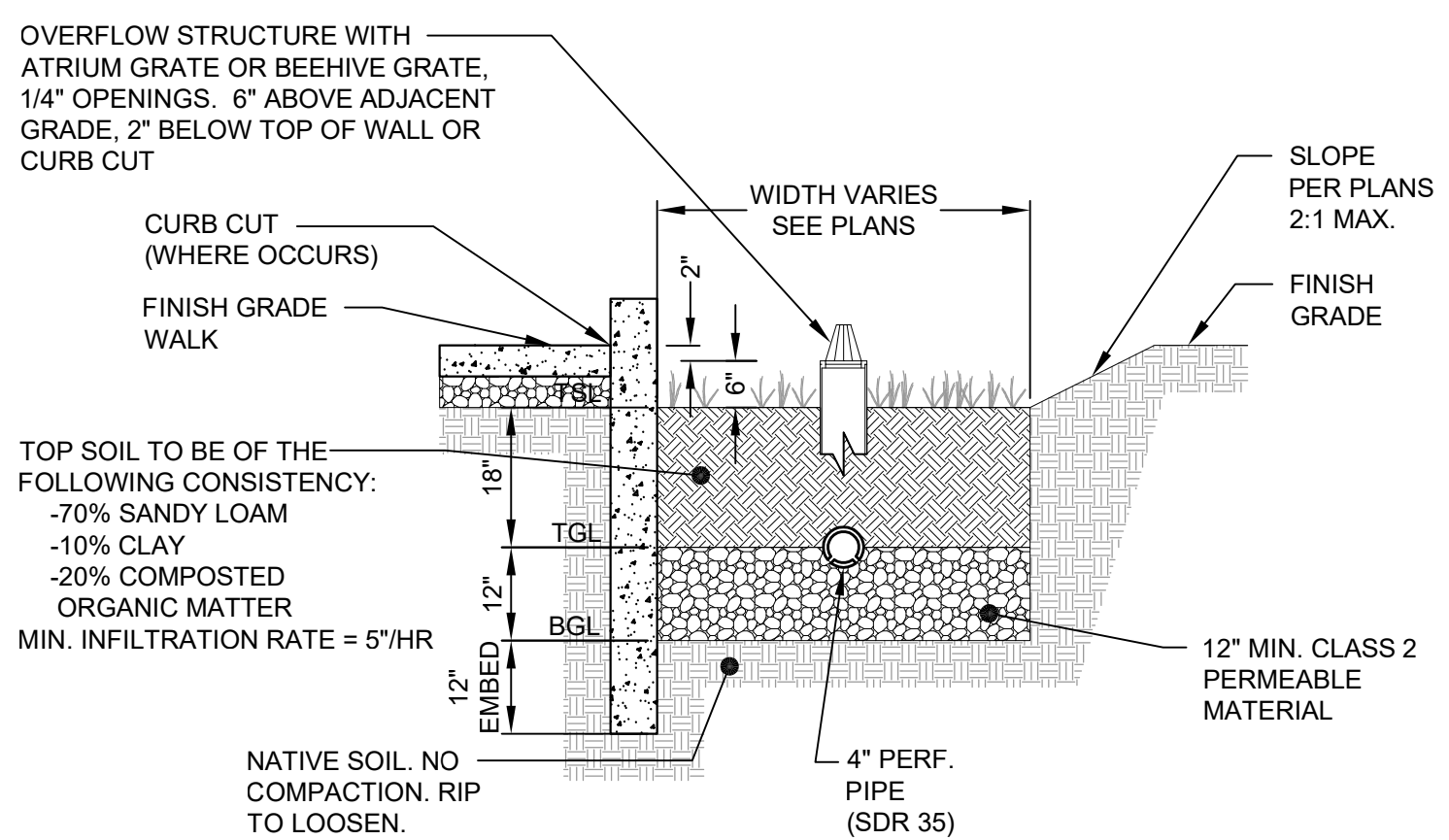

- NOTE:
1. BIORETENTION AREAS HAVE A MINIMUM DEPTH OF 6".
 2. ELEVATION OF UNDERDRAIN DISCHARGE IS AT TOP OF GRAVEL LAYER.
 3. CONNECT TO STORMDRAIN INLET OR OUTFALL.
 4. PROVIDE CLEANOUTS AT ENDS & ANGLE POINTS WITH TOP 2" MIN. ABOVE OVERFLOW LEVEL.
 5. USE CHECKDAM FOR AREAS WHERE LONGITUDINAL SLOPE EXCEEDS 1%.
 6. PROVIDE LATERAL BRACING EVERY 6".
- ABBREVIATIONS:
 TOP TOP BIORETENTION / TOP PLANTER
 TO TOP OVERFLOW DRAIN
 TSL TOP SOIL LAYER
 TGL TOP GRAVEL LAYER

4 BIORETENTION AREA DETAIL (BIO TYP.)
 SCALE: 1" = 1'

Rev	Date	Description	Designed	Drawn	Checked
-	03/22/2024	SPAR SUBMITTAL			

CSW ST2
 CSW/Stuber-Stroeh Engineering Group, Inc.
 Civil Engineering - Planning - Land Surveying & Mapping
 504 Redwood Blvd., Ste 310 Novato, CA 94947
 tel.: 415.883.9850 fax: 415.883.9835
 http://www.cswst2.com © 2023

City	Petaluma
County	Sonoma
State	California

DEER CREEK APARTMENTS
 STORMWATER CONTROL PLAN DETAILS
 ACCLAIM COMPANIES

Professional Engineer
 WAYNE F. LEACH
 No. 54309
 CIVIL
 STATE OF CALIFORNIA

Sheet	C4.3
Scale	N/A
Date	12/11/2023
Project Number	23.00.128
Plan File	

E:\Shared\Projects\2023\2300128\Deer Creek Apartments\DWG\Sheet\C4.3 STORMWATER CONTROL PLAN DETAILS.dwg 03/22/2024 - 09:52 AM User: 131862

