

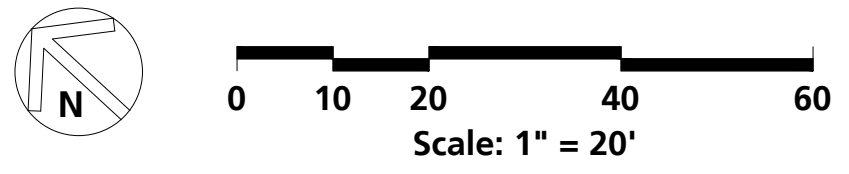

**WATER USE LEGEND**



<span style="color: green;">■</span>	WUCOLS Low: 73,359.0 SF
<span style="color: orange;">■</span>	WUCOLS Moderate: 3,221.0 SF
<span style="color: red;">■</span>	WUCOLS High: 0 SF
<span style="color: blue;">■</span>	Special Landscape Area : 0 SF
<span style="color: cyan;">■</span>	Water Features: N/A

\* Based upon total landscape area of 76,580 SF





**LIGHTING LEGEND**

-  Street Scale Pole Light
-  Pedestrian Scale Pole Light
-  Accent Pole Light
-  Bollard Light
-  Tree Down Light / Moon Light
-  Tree String Light



Street Scale Pole Light by Gardco: OptiForm Medium LED @ 22' on pole H15 house-side shield option and BLC back light control optic for perimeter lights

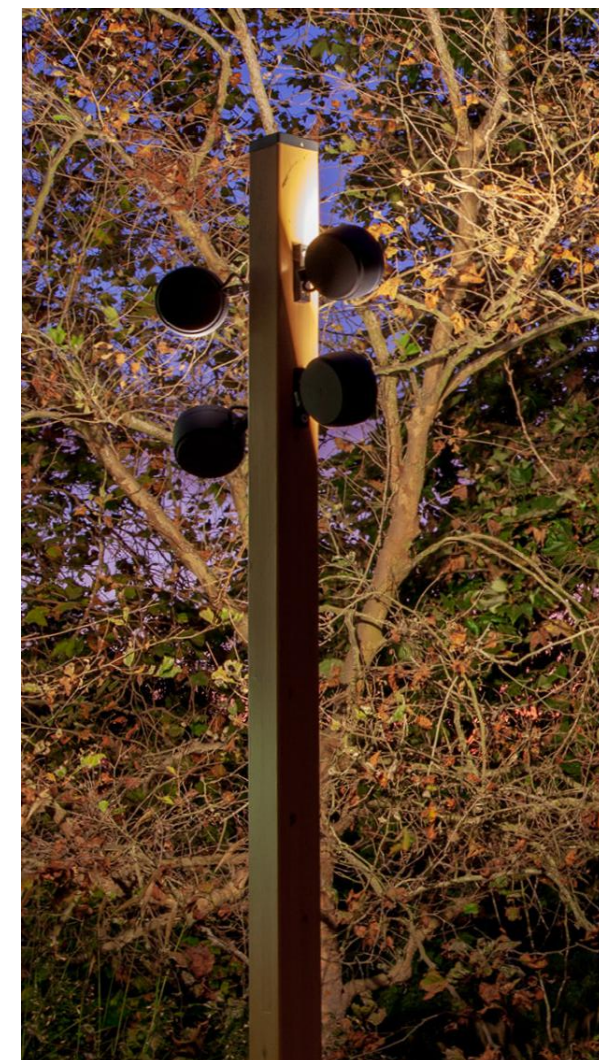

Accent Pole Light by Structura w/ Bega multi-head pole attachment (20' tall pole), 14', 16' and 18' attachment heights



Pedestrian Scale Pole Light by Gardco: PureForm Post Top LED @ 14' on pole

Bollard Light by Gardco: PureForm Post Top LED (3' total height)

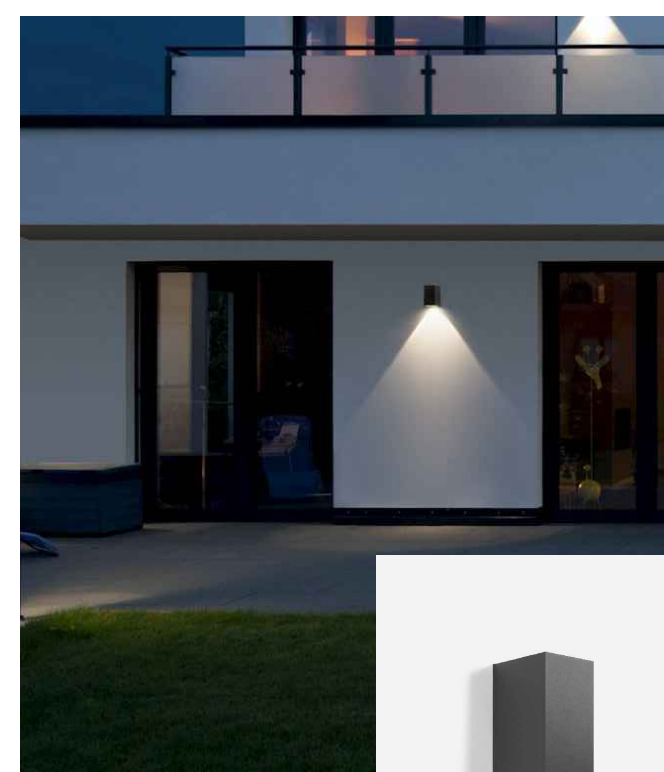

Wall Light - Bega, S.A.D., mounted at 8'



Carport Light - Fluxstream, mounted at 10'

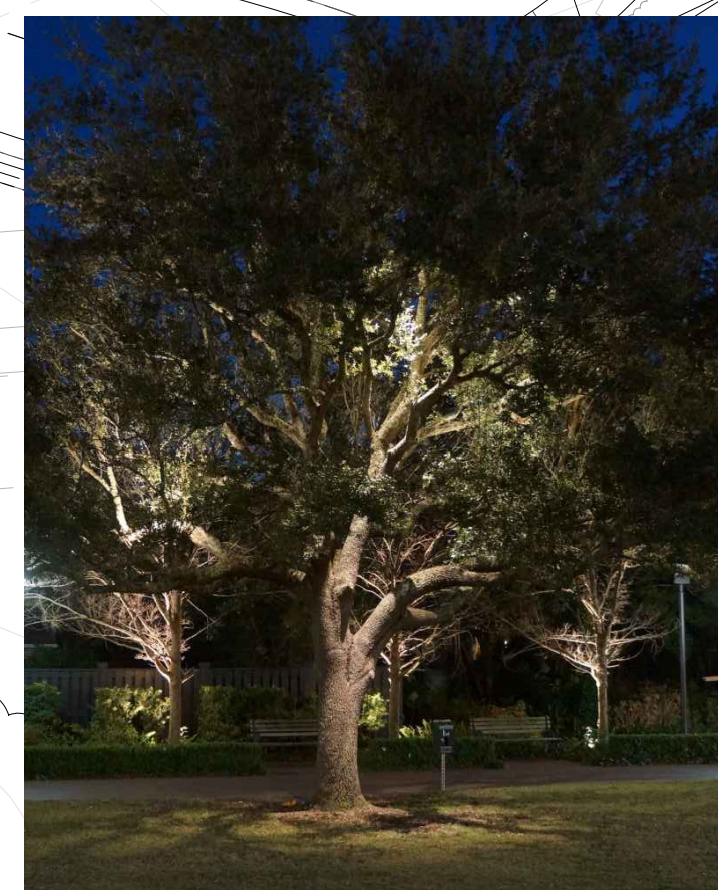

Tree Downlight / Moonlight: by BK Lighting - Nite Star II with tree mounting strap, decorative.

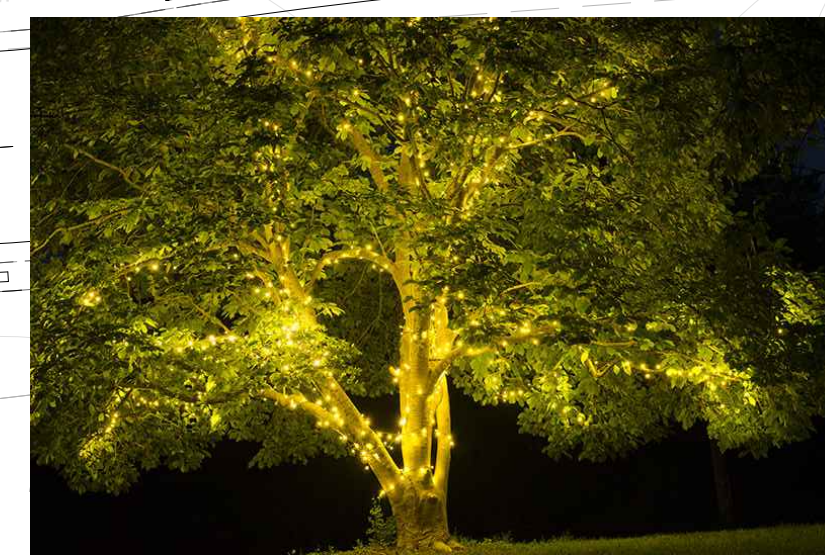

Tree String Light - Tivoli lights, decorative

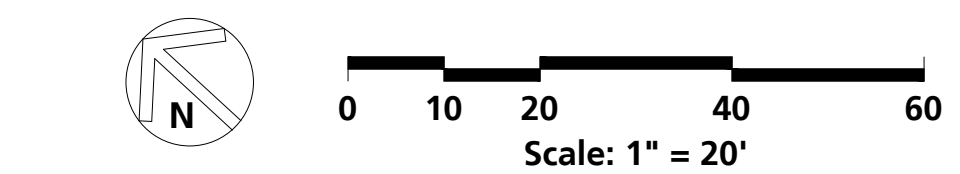

Street Scale Pole Light by Gardco: OptiForm Medium LED

**GARDCO** by @ignify **OptiForm** OPF-M Medium

Site and Area

Gardco OptiForm site and area luminaires are available in three sizes: small, medium and large. Featuring the latest in LED technology, OptiForm achieves up to 192 lumens per watt. Eleven optical distributions are available, suitable for a range of outdoor lighting applications. OptiForm features a unique mounting system with a two-piece housing for hassle-free installation. Mounting options include a standard arm, mast arm, and wall mount bracket. Service Tag is a standard feature with every OptiForm luminaire, providing maintenance or upgrade assistance throughout the life of the product.

Project: \_\_\_\_\_  
Location: \_\_\_\_\_  
City: \_\_\_\_\_  
Type: \_\_\_\_\_  
Lamp: \_\_\_\_\_  
Notes: \_\_\_\_\_

\*Color Temperature 3000 K

Ordering guide Example: OPF-M-A08-840-14M-ARI-240-BL5C-L3-BZ

Luminaire	Configuration	Color Temperature	Distribution	Mounting	Voltage	
OPF-M	OptiForm Medium Area	A08 15,500 lumens A09 17,000 lumens A10 20,000 lumens A11 23,000 lumens A12 28,000 lumens A13 30,000 lumens A14 32,000 lumens A15 34,000 lumens	B27 BICOB-2700K B28 BICOB-3000K B29 BICOB-3500K B30 BICOB-4000K B31 BICOB-4500K B32 BICOB-5000K B33 BICOB-5500K B34 BICOB-6000K	A0R Antifog row T2M Type 2 medium T3M Type 3 medium T4M Type 4 medium T5M Type 5 medium T6M Type 6 medium T7M Type 7 wide	LLC LED corner optic left LCR LED corner optic right BLC Back light control WAL Wall mount MOD Mounting oriented separately UNW 120-277V UNV 120-277V (50/60Hz)	120 120V 208 208V 240 240V 277 277V 347 347V 480 480V 120-277V UNV 120-277V (50/60Hz)

Ordering Controls

The following options include 0-10V Driver

None 0-10V dimming driver  
DLEA Dimming leads externally accessible (controls by others)  
FMSD Field adjustable wattage selector  
BL500H Bi-level with motion sensor

The following options include 0-10V DALI Driver

OSD1\* 0-10V dimming driver  
OSD2\* Medium 20% dimming, 8 hours  
OSD3\* Medium 30% dimming, 8 hours  
OSD4\* Medium 40% dimming, 8 hours

1. Extended lead time apply. Contact factory for details.  
2. Mount to a vertical pole with knockout for 4" O.D. mount pole.  
3. Mount to a horizontal 3-1/4" O.D. x 8" Long tenon.  
4. Must be ordered with mounting accessory. Photocell option (PT) must be selected with mounting accessory. Photocell (PT) must be selected with mounting accessory. Photocell (PT) must be selected with mounting accessory.  
5. Not available with other dimming control options (mutually exclusive).  
6. Not available with motion sensor (mutually exclusive).

7. Must be specified with a motion sensor lens (L2 or L3).  
8. Not available with RFL, TMS, TLM, TLR, TLR7, TLR8, TLR9, TLR10, TLR11, TLR12, TLR13, TLR14, TLR15, TLR16, TLR17, TLR18, TLR19, TLR20, TLR21, TLR22, TLR23, TLR24, TLR25, TLR26, TLR27, TLR28, TLR29, TLR30, TLR31, TLR32, TLR33, TLR34, TLR35, TLR36, TLR37, TLR38, TLR39, TLR40, TLR41, TLR42, TLR43, TLR44, TLR45, TLR46, TLR47, TLR48, TLR49, TLR50, TLR51, TLR52, TLR53, TLR54, TLR55, TLR56, TLR57, TLR58, TLR59, TLR60, TLR61, TLR62, TLR63, TLR64, TLR65, TLR66, TLR67, TLR68, TLR69, TLR70, TLR71, TLR72, TLR73, TLR74, TLR75, TLR76, TLR77, TLR78, TLR79, TLR80, TLR81, TLR82, TLR83, TLR84, TLR85, TLR86, TLR87, TLR88, TLR89, TLR90, TLR91, TLR92, TLR93, TLR94, TLR95, TLR96, TLR97, TLR98, TLR99, TLR100, TLR101, TLR102, TLR103, TLR104, TLR105, TLR106, TLR107, TLR108, TLR109, TLR110, TLR111, TLR112, TLR113, TLR114, TLR115, TLR116, TLR117, TLR118, TLR119, TLR120, TLR121, TLR122, TLR123, TLR124, TLR125, TLR126, TLR127, TLR128, TLR129, TLR130, TLR131, TLR132, TLR133, TLR134, TLR135, TLR136, TLR137, TLR138, TLR139, TLR140, TLR141, TLR142, TLR143, TLR144, TLR145, TLR146, TLR147, TLR148, TLR149, TLR150, TLR151, TLR152, TLR153, TLR154, TLR155, TLR156, TLR157, TLR158, TLR159, TLR160, TLR161, TLR162, TLR163, TLR164, TLR165, TLR166, TLR167, TLR168, TLR169, TLR170, TLR171, TLR172, TLR173, TLR174, TLR175, TLR176, TLR177, TLR178, TLR179, TLR180, TLR181, TLR182, TLR183, TLR184, TLR185, TLR186, TLR187, TLR188, TLR189, TLR190, TLR191, TLR192, TLR193, TLR194, TLR195, TLR196, TLR197, TLR198, TLR199, TLR200, TLR201, TLR202, TLR203, TLR204, TLR205, TLR206, TLR207, TLR208, TLR209, TLR210, TLR211, TLR212, TLR213, TLR214, TLR215, TLR216, TLR217, TLR218, TLR219, TLR220, TLR221, TLR222, TLR223, TLR224, TLR225, TLR226, TLR227, TLR228, TLR229, TLR230, TLR231, TLR232, TLR233, TLR234, TLR235, TLR236, TLR237, TLR238, TLR239, TLR240, TLR241, TLR242, TLR243, TLR244, TLR245, TLR246, TLR247, TLR248, TLR249, TLR250, TLR251, TLR252, TLR253, TLR254, TLR255, TLR256, TLR257, TLR258, TLR259, TLR260, TLR261, TLR262, TLR263, TLR264, TLR265, TLR266, TLR267, TLR268, TLR269, TLR270, TLR271, TLR272, TLR273, TLR274, TLR275, TLR276, TLR277, TLR278, TLR279, TLR280, TLR281, TLR282, TLR283, TLR284, TLR285, TLR286, TLR287, TLR288, TLR289, TLR290, TLR291, TLR292, TLR293, TLR294, TLR295, TLR296, TLR297, TLR298, TLR299, TLR300, TLR301, TLR302, TLR303, TLR304, TLR305, TLR306, TLR307, TLR308, TLR309, TLR310, TLR311, TLR312, TLR313, TLR314, TLR315, TLR316, TLR317, TLR318, TLR319, TLR320, TLR321, TLR322, TLR323, TLR324, TLR325, TLR326, TLR327, TLR328, TLR329, TLR330, TLR331, TLR332, TLR333, TLR334, TLR335, TLR336, TLR337, TLR338, TLR339, TLR340, TLR341, TLR342, TLR343, TLR344, TLR345, TLR346, TLR347, TLR348, TLR349, TLR350, TLR351, TLR352, TLR353, TLR354, TLR355, TLR356, TLR357, TLR358, TLR359, TLR360, TLR361, TLR362, TLR363, TLR364, TLR365, TLR366, TLR367, TLR368, TLR369, TLR370, TLR371, TLR372, TLR373, TLR374, TLR375, TLR376, TLR377, TLR378, TLR379, TLR380, TLR381, TLR382, TLR383, TLR384, TLR385, TLR386, TLR387, TLR388, TLR389, TLR390, TLR391, TLR392, TLR393, TLR394, TLR395, TLR396, TLR397, TLR398, TLR399, TLR400, TLR401, TLR402, TLR403, TLR404, TLR405, TLR406, TLR407, TLR408, TLR409, TLR410, TLR411, TLR412, TLR413, TLR414, TLR415, TLR416, TLR417, TLR418, TLR419, TLR420, TLR421, TLR422, TLR423, TLR424, TLR425, TLR426, TLR427, TLR428, TLR429, TLR430, TLR431, TLR432, TLR433, TLR434, TLR435, TLR436, TLR437, TLR438, TLR439, TLR440, TLR441, TLR442, TLR443, TLR444, TLR445, TLR446, TLR447, TLR448, TLR449, TLR450, TLR451, TLR452, TLR453, TLR454, TLR455, TLR456, TLR457, TLR458, TLR459, TLR460, TLR461, TLR462, TLR463, TLR464, TLR465, TLR466, TLR467, TLR468, TLR469, TLR470, TLR471, TLR472, TLR473, TLR474, TLR475, TLR476, TLR477, TLR478, TLR479, TLR480, TLR481, TLR482, TLR483, TLR484, TLR485, TLR486, TLR487, TLR488, TLR489, TLR490, TLR491, TLR492, TLR493, TLR494, TLR495, TLR496, TLR497, TLR498, TLR499, TLR500, TLR501, TLR502, TLR503, TLR504, TLR505, TLR506, TLR507, TLR508, TLR509, TLR510, TLR511, TLR512, TLR513, TLR514, TLR515, TLR516, TLR517, TLR518, TLR519, TLR520, TLR521, TLR522, TLR523, TLR524, TLR525, TLR526, TLR527, TLR528, TLR529, TLR530, TLR531, TLR532, TLR533, TLR534, TLR535, TLR536, TLR537, TLR538, TLR539, TLR540, TLR541, TLR542, TLR543, TLR544, TLR545, TLR546, TLR547, TLR548, TLR549, TLR550, TLR551, TLR552, TLR553, TLR554, TLR555, TLR556, TLR557, TLR558, TLR559, TLR560, TLR561, TLR562, TLR563, TLR564, TLR565, TLR566, TLR567, TLR568, TLR569, TLR570, TLR571, TLR572, TLR573, TLR574, TLR575, TLR576, TLR577, TLR578, TLR579, TLR580, TLR581, TLR582, TLR583, TLR584, TLR585, TLR586, TLR587, TLR588, TLR589, TLR590, TLR591, TLR592, TLR593, TLR594, TLR595, TLR596, TLR597, TLR598, TLR599, TLR600, TLR601, TLR602, TLR603, TLR604, TLR605, TLR606, TLR607, TLR608, TLR609, TLR610, TLR611, TLR612, TLR613, TLR614, TLR615, TLR616, TLR617, TLR618, TLR619, TLR620, TLR621, TLR622, TLR623, TLR624, TLR625, TLR626, TLR627, TLR628, TLR629, TLR630, TLR631, TLR632, TLR633, TLR634, TLR635, TLR636, TLR637, TLR638, TLR639, TLR640, TLR641, TLR642, TLR643, TLR644, TLR645, TLR646, TLR647, TLR648, TLR649, TLR650, TLR651, TLR652, TLR653, TLR654, TLR655, TLR656, TLR657, TLR658, TLR659, TLR660, TLR661, TLR662, TLR663, TLR664, TLR665, TLR666, TLR667, TLR668, TLR669, TLR670, TLR671, TLR672, TLR673, TLR674, TLR675, TLR676, TLR677, TLR678, TLR679, TLR680, TLR681, TLR682, TLR683, TLR684, TLR685, TLR686, TLR687, TLR688, TLR689, TLR690, TLR691, TLR692, TLR693, TLR694, TLR695, TLR696, TLR697, TLR698, TLR699, TLR700, TLR701, TLR702, TLR703, TLR704, TLR705, TLR706, TLR707, TLR708, TLR709, TLR710, TLR711, TLR712, TLR713, TLR714, TLR715, TLR716, TLR717, TLR718, TLR719, TLR720, TLR721, TLR722, TLR723, TLR724, TLR725, TLR726, TLR727, TLR728, TLR729, TLR730, TLR731, TLR732, TLR733, TLR734, TLR735, TLR736, TLR737, TLR738, TLR739, TLR740, TLR741, TLR742, TLR743, TLR744, TLR745, TLR746, TLR747, TLR748, TLR749, TLR750, TLR751, TLR752, TLR753, TLR754, TLR755, TLR756, TLR757, TLR758, TLR759, TLR760, TLR761, TLR762, TLR763, TLR764, TLR765, TLR766, TLR767, TLR768, TLR769, TLR770, TLR771, TLR772, TLR773, TLR774, TLR775, TLR776, TLR777, TLR778, TLR779, TLR780, TLR781, TLR782, TLR783, TLR784, TLR785, TLR786, TLR787, TLR788, TLR789, TLR790, TLR791, TLR792, TLR793, TLR794, TLR795, TLR796, TLR797, TLR798, TLR799, TLR800, TLR801, TLR802, TLR803, TLR804, TLR805, TLR806, TLR807, TLR808, TLR809, TLR810, TLR811, TLR812, TLR813, TLR814, TLR815, TLR816, TLR817, TLR818, TLR819, TLR820, TLR821, TLR822, TLR823, TLR824, TLR825, TLR826, TLR827, TLR828, TLR829, TLR830, TLR831, TLR832, TLR833, TLR834, TLR835, TLR836, TLR837, TLR838, TLR839, TLR840, TLR841, TLR842, TLR843, TLR844, TLR845, TLR846, TLR847, TLR848, TLR849, TLR850, TLR851, TLR852, TLR853, TLR854, TLR855, TLR856, TLR857, TLR858, TLR859, TLR860, TLR861, TLR862, TLR863, TLR864, TLR865, TLR866, TLR867, TLR868, TLR869, TLR870, TLR871, TLR872, TLR873, TLR874, TLR875, TLR876, TLR877, TLR878, TLR879, TLR880, TLR881, TLR882, TLR883, TLR884, TLR885, TLR886, TLR887, TLR888, TLR889, TLR890, TLR891, TLR892, TLR893, TLR894, TLR895, TLR896, TLR897, TLR898, TLR899, TLR900, TLR901, TLR902, TLR903, TLR904, TLR905, TLR906, TLR907, TLR908, TLR909, TLR910, TLR911, TLR912, TLR913, TLR914, TLR915, TLR916, TLR917, TLR918, TLR919, TLR920, TLR921, TLR922, TLR923, TLR924, TLR925, TLR926, TLR927, TLR928, TLR929, TLR930, TLR931, TLR932, TLR933, TLR934, TLR935, TLR936, TLR937, TLR938, TLR939, TLR940, TLR941, TLR942, TLR943, TLR944, TLR945, TLR946, TLR947, TLR948, TLR949, TLR950, TLR951, TLR952, TLR953, TLR954, TLR955, TLR956, TLR957, TLR958, TLR959, TLR960, TLR961, TLR962, TLR963, TLR964, TLR965, TLR966, TLR967, TLR968, TLR969, TLR970, TLR971, TLR972, TLR973, TLR974, TLR975, TLR976, TLR977, TLR978, TLR979, TLR980, TLR981, TLR982, TLR983, TLR984, TLR985, TLR986, TLR987, TLR988, TLR989, TLR990, TLR991, TLR992, TLR993, TLR994, TLR995, TLR996, TLR997, TLR998, TLR999, TLR1000, TLR1001, TLR1002, TLR1003, TLR1004, TLR1005, TLR1006, TLR1007, TLR1008, TLR1009, TLR1010, TLR1011, TLR1012, TLR1013, TLR1014, TLR1015, TLR1016, TLR1017, TLR1018, TLR1019, TLR1020, TLR1021, TLR1022, TLR1023, TLR1024, TLR1025, TLR1026, TLR1027, TLR1028, TLR1029, TLR1030, TLR1031, TLR1032, TLR1033, TLR1034, TLR1035, TLR1036, TLR1037, TLR1038, TLR1039, TLR1040, TLR1041, TLR1042, TLR1043, TLR1044, TLR1045, TLR1046, TLR1047, TLR1048, TLR1049, TLR1050, TLR1051, TLR1052, TLR1053, TLR1054, TLR1055, TLR1056, TLR1057, TLR1058, TLR1059, TLR1060, TLR1061, TLR1062, TLR1063, TLR1064, TLR1065, TLR1066, TLR1067, TLR1068, TLR1069, TLR1070, TLR1071, TLR1072, TLR1073, TLR1074, TLR1075, TLR1076, TLR1077, TLR1078, TLR1079, TLR1080, TLR1081, TLR1082, TLR1083, TLR1084, TLR1085, TLR1086, TLR1087, TLR1088, TLR1089, TLR1090, TLR1091, TLR1092, TLR1093, TLR1094, TLR1095, TLR1096, TLR1097, TLR1098, TLR1099, TLR1100, TLR1101, TLR1102, TLR1103, TLR1104, TLR1105, TLR1106, TLR1107, TLR1108, TLR1109, TLR1110, TLR1111, TLR1112, TLR1113, TLR1114, TLR1115, TLR1116, TLR1117, TLR1118, TLR1119, TLR1120, TLR1121, TLR1122, TLR1123, TLR1124, TLR1125, TLR1126, TLR1127, TLR1128, TLR1129, TLR1130, TLR1131, TLR1132, TLR1133, TLR1134, TLR1135, TLR1136, TLR1137, TLR1138, TLR1139, TLR1140, TLR1141, TLR1142, TLR1143, TLR1144, TLR1145, TLR1146, TLR1147, TLR1148, TLR1149, TLR1150, TLR1151, TLR1152, TLR1153, TLR1154, TLR1155, TLR1156, TLR1157, TLR1158, TLR1159, TLR1160, TLR1161, TLR1162, TLR1163, TLR1164, TLR1165, TLR1166, TLR1167, TLR1168, TLR1169, TLR1170, TLR1171, TLR1172, TLR1173, TLR1174, TLR1175, TLR1176, TLR1177, TLR1178, TLR1179, TLR1180, TLR1181, TLR1182, TLR1183, TLR1184, TLR1185, TLR1186, TLR1187, TLR1188, TLR1189, TLR1190, TLR1191, TLR1192, TLR1193, TLR1194, TLR1195, TLR1196, TLR1197, TLR1198, TLR1199, TLR1200, TLR1201, TLR1202, TLR1203, TLR1204, TLR1205, TLR1206, TLR1207, TLR1208, TLR1209, TLR1210, TLR1211, TLR1212, TLR1213, TLR1214, TLR1215, TLR1216, TLR1217, TLR1218, TLR1219, TLR1220, TLR1221, TLR1222, TLR1223, TLR1224, TLR1225, TLR1226, TLR1227, TLR1228, TLR1229, TLR1230, TLR1231, TLR1232, TLR1233, TLR1234, TLR1235, TLR1236, TLR1237, TLR1238, TLR1239, TLR1240, TLR1241, TLR1242, TLR1243, TLR1244, TLR1245, TLR1246, TLR1247, TLR1248, TLR1249, TLR1250, TLR1251, TLR1252, TLR1253, TLR1254, TLR1255, TLR1256, TLR1257, TLR1258, TLR1259, TLR1260, TLR1261, TLR1262, TLR1263, TLR1264, TLR1265, TLR1266, TLR1267, TLR1268, TLR1269, TLR1270, TLR1271, TLR1272, TLR1273, TLR1274, TLR1275, TLR1276, TLR1277, TLR1278, TLR1279, TLR1280, TLR1281, TLR1282, TLR1283, TLR1284, TLR1285, TLR1286, TLR1287, TLR1288, TLR1289, TLR1290, TLR1291, TLR1292, TLR1293, TLR1294, TLR1295, TLR1296, TLR1297, TLR1298, TLR1299, TLR1300, TLR1301, TLR1302, TLR1303, TLR1304, TLR1305, TLR1306, TLR1307, TLR1308, TLR1309, TLR1310, TLR1311, TLR1312, TLR1313, TLR1314, TLR1315, TLR1316, TLR1317, TLR1318, TLR1319, TLR1320, TLR1321, TLR1322, TLR1323, TLR1324, TLR1325, TLR1326, TLR1327, TLR1328, TLR1329, TLR1330, TLR1331, TLR1332, TLR1333, TLR1334, TLR1335, TLR1336, TLR1337, TLR1338, TLR1339, TLR1340, TLR1341, TLR1342, TLR1343, TLR1344, TLR1345, TLR1346, TLR1347, TLR1348, TLR1349, TLR1350, TLR1351, TLR1352, TLR1353, TLR1354, TLR1355, TLR1356, TLR1357, TLR1358, TLR1359, TLR1360, TLR1361, TLR1362, TLR1363, TLR1364, TLR1365, TLR1366, TLR1367, TLR1368, TLR1369, TLR1370, TLR1371, TLR1372, TLR1373, TLR1374, TLR1375, TLR1376, TLR1377, TLR1378, TLR1379, TLR1380, TLR1381, TLR1382, TLR1383, TLR1384, TLR1385, TLR1386, TLR1387, TLR1388, TLR1389, TLR1390, TLR1391, TLR1392, TLR1393, TLR1394, TLR1395, TLR1396, TLR1397, TLR1398, TLR1399, TLR1400, TLR1401, TLR1402, TLR1403, TLR1404, TLR1405, TLR1406, TLR1407, TLR1408, TLR1409, TLR1410, TLR1411, TLR1412, TLR1413, TLR1414, TLR1415, TLR1416, TLR1417, TLR1418, TLR1419, TLR1420, TLR1421, TLR1422, TLR1423, TLR1424, TLR1425, TLR1426, TLR1427, TLR1428, TLR1429, TLR1430, TLR1431, TLR1432, TLR1433, TLR1434, TLR1435, TLR1436, TLR1437, TLR1438, TLR1439, TLR1440, TLR1441, TLR1442, TLR1443, TLR1444, TLR1445, TLR1446, TLR1447, TLR1448, TLR1449, TLR1450, TLR1451, TLR1452, TLR1453, TLR1454, TLR1455, TLR1456, TLR1457, TLR1458, TLR1459, TLR1460, TLR1461, TLR1462, TLR1463, TLR1464, TLR1465, TLR1466, TLR1467, TLR1468, TLR1469, TLR1470, TLR1471, TLR1472, TLR1473, TLR1474, TLR1475, TLR1476, TLR1477, TLR1478, TLR1479, TLR1480, TLR1481, TLR1482, TLR1483, TLR1484, TLR1485, TLR1486, TLR1487, TLR1488, TLR1489, TLR1490, TLR1491, TLR1492, TLR1493, TLR1494, TLR1495, TLR1496, TLR1497, TLR1498, TLR1499, TLR1500, TLR1501, TLR1502, TLR1503, TLR1504, TLR1505, TLR1506, TLR1507, TLR1508, TLR1509, TLR1510, TLR1511, TLR1512, TLR1513, TLR1514, TLR1515, TLR1516, TLR1517, TLR1518, TLR1519, TLR1520, TLR1521, TLR1522, TLR1523, TLR1524, TLR1525, TLR1526, TLR1527, TLR1528, TLR1529, TLR1530, TLR1531, TLR1532, TLR1533, TLR1534, TLR1535, TLR1536, TLR1537, TLR1538, TLR1539, TLR1540, TLR1541, TLR1542, TLR1543, TLR1544, TLR1545, TLR1546, TLR1547, TLR1548, TLR1549, TLR1550, TLR1551, TLR1552, TLR1553, TLR1554, TLR1555, TLR1556, TLR1557, TLR1558, TLR1559, TLR1560, TLR1561, TLR1562, TLR1563, TLR1564, TLR1565, TLR1566, TLR1567, TLR1568, TLR1569, TLR1570, TLR1571, TLR1572, TLR1573, TLR1574, TLR1575, TLR1576, TLR1577, TLR1578, TLR1579, TLR1580, TLR1581, TLR1582, TLR1583, TLR1584, TLR1585, TLR1586, TLR1587, TLR1588, TLR1589, TLR1590, TLR1591, TLR1592, TLR1593, TLR1594, TLR1595, TLR1596, TLR1597, TLR1598, TLR1599, TLR1600, TLR1601, TLR1602, TLR1603, TLR1604, TLR1605, TLR1606, TLR1607, TLR1608, TLR1609, TLR1610, TLR1611, TLR1612, TLR1613, TLR1614, TLR1615, TLR1616, TLR1617, TLR1618, TLR1619, TLR1620, TLR1621, TLR1622, TLR1623, TLR1624, TLR1625, TLR1626, TLR1627, TLR1628, TLR1629, TLR1630, TLR1631, TLR1632, TLR1633, TLR1634, TLR1635, TLR1636, TLR1637, TLR1638, TLR1639, TLR1640, TLR1641, TLR1642, TLR1643, TLR1644, TLR1645, TLR1646, TLR1647, TLR1648, TLR1649, TLR1650, TLR1651, TLR1652, TLR1653, TLR1654, TLR1655, TLR1656, TLR1657, TLR1658, TLR1659, TLR1660, TLR1661, TLR1662, TLR1663, TLR1664, TLR1665, TLR1666, TLR1667, TLR1668, TLR1669, TLR1670, TLR1671, TLR1672, TLR1673, TLR1674, TLR1675, TLR1676, TLR1677, TLR1678, TLR1679, TLR1680, TLR1681, TLR1682, TLR1683, TLR1684, TLR1685, TLR1686, TLR1687, TLR1688, TLR1689, TLR1690, TLR1691, TLR1692, TLR1693, TLR1694, TLR1695, TLR1696, TLR1697, TLR1698, TLR1699, TLR1700, TLR1701, TLR1702, TLR1703, TLR1704, TLR1705, TLR1706, TLR1707, TLR1708, TLR1709, TLR1710, TLR1711, TLR1712, TLR1713, TLR1714, TLR1715, TLR1716, TLR1717, TLR1718, TLR1719, TLR1720, TLR1721, TLR1722, TLR1723, TLR1724, TLR1725, TLR1726, TLR1727, TLR1728, TLR1729, TLR1730, TLR1731, TLR1732, TLR1733, TLR1734, TLR1735, TLR1736, TLR1737, TLR1738, TLR1739, TLR1740, TLR1741, TLR1742, TLR1743, TLR1744, TLR1745, TLR1746, TLR1747, TLR1748, TLR1749, TLR1750, TLR1751, TLR1

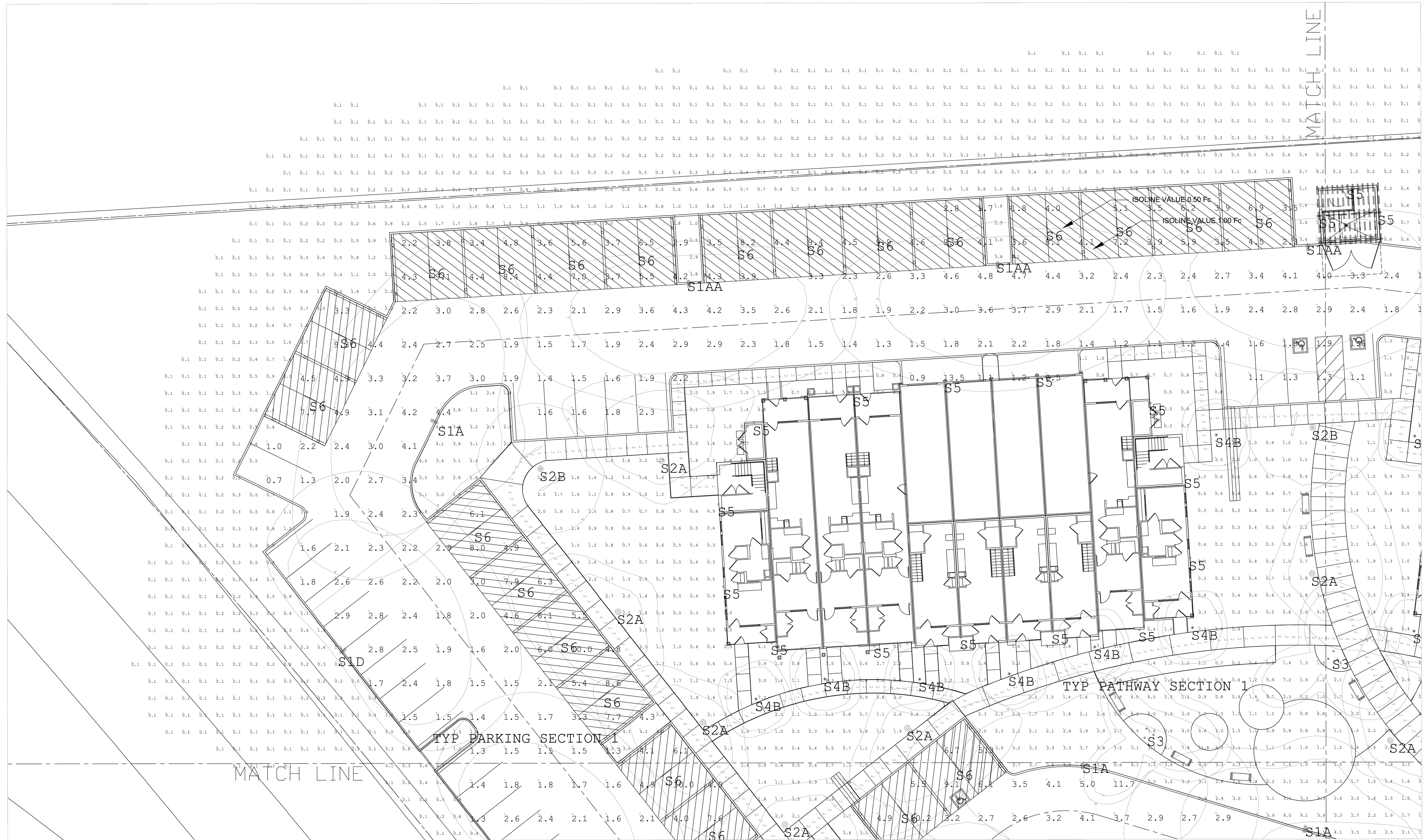

SCALE: 1" = 10'-0"

PLAN VIEW

Symbol	Qty	Label	Arrangement	Description	UDF *	LLF	Sum. Lumens	Sum. Watts	Tot. Watts	ROU Rating	Data Source Filename
1	8	S1A	Single	GARCOO OPP-M-A08-830-T2M - 22" M.H.	N.A.	0.850	11207	74.41	199.28	B1-00-G3	OPP-M-A08-830-T2M.ies
2	5	S1AA	Single	GARCOO OPP-M-A08-830-T2M-HIS - 22" M.H.	N.A.	0.850	8812	74.41	372.05	B1-00-G2	OPP-M-A08-830-T2M-HIS.ies
3	4	S1B	Single	GARCOO OPP-M-A08-830-T2M - 22" M.H.	N.A.	0.850	11415	74.41	297.64	B2-00-G2	OPP-M-A08-830-T2M.ies
4	3	S1C	Single	GARCOO OPP-M-A08-830-T4M - 22" M.H.	N.A.	0.850	11568	74.41	233.23	B2-00-G2	OPP-M-A08-830-T4M.ies
5	3	S1D	Single	GARCOO OPP-M-A08-830-B2C - 22" M.H.	N.A.	0.850	8023	74.41	223.23	B1-00-G2	OPP-M-A08-830-B2C.ies
6	12	S2A	Single	GARCOO PPT-P-A02-830-T2M - 13" x 5" L.C.	N.A.	0.850	3269	22.8	249.6	B1-00-G1	PPT-P-A02-830-T2M.ies
7	3	S2B	Single	GARCOO PPT-P-A02-830-T2M - 13" x 5" L.C.	N.A.	0.850	3245	20.8	62.4	B2-00-G1	PPT-P-A02-830-T2M.ies
8	4	S3	GROUP	BEGA 84 217-K3 8 14" A.F.O. - 84 216-K3 8 16" - 84 215-K3 8 18"	N.A.	0.850	5064	62	248	B2-00-G0	84215K3_BEGA_IES.ies/84216K3_BEGA_IES.ies/84217K3_BEGA_IES.ies
9	3	S4A	Single	GARCOO PHS-141-200-WM-G2-3-DRV - 3" L.C.	0.980	0.833	965	10.6	31.9	B0-00-G0	PHS-141-200-WM-G2-3-DRV.ies
10	35	S4B	Single	GARCOO PHS-141-200-WM-G2-3-DRV - 3" L.C.	0.980	0.833	1055	10.6	371	B1-00-G0	PHS-141-200-WM-G2-3-DRV.ies
11	62	S5	Single	BEGA 33 581-K3 - M.H. VARIIES	N.A.	0.850	747	10.9	675.8	B1-00-G0	33581_BEGA_IES.ies
12	33	S6	Single	DAY-BRITE FSX440L840-DRV-DIM - 10" M.H.	0.950	0.807	3955	32.4	1069.2	B1-03-G2	FSX440L840-DRV.ies

Label	CalcType	Units	Avg	Max	Min	Avg/Min	Max/Min
TYP PARKING SECTION 1	Illuminance	Fc	3.14	10.9	1.8	3.14	10.90
TYP PARKING SECTION 2	Illuminance	Fc	2.76	4.4	2.1	1.31	2.10
TYP PATHWAY SECTION 1	Illuminance	Fc	2.82	6.9	0.5	5.64	13.80
TYP PATHWAY SECTION 2	Illuminance	Fc	3.22	4.2	2.0	1.61	2.10

Note: Unless otherwise specified - the lamp lumen depreciation (LLD) for legacy sources used in these calculations is based on published mean lumen ratings by major lamp manufacturers; 0.80 LLD for pulse start metal halide; 0.90 LLD for high pressure sodium; 0.95 LLD for linear T8 and T5 fluorescent; 0.86 LLD for compact fluorescent and induction; 0.88 LLD for Cosmo and Elite lamps; 0.94 LLD for all LED sources. Unless otherwise noted - 0.90 luminaire dirt depreciation (LDD) is commonly applied. In cases where appropriate - ballast factor (BF) is applied. Additional user defined factors (UDF) may be applied if necessary to represent luminaire performance to a higher degree of accuracy. Total light loss factor (LLF) is the product of all multiplied loss factors.

**LIGHTING PLAN - PHOTOMETRIC ANALYSIS - LAYOUT VERIFICATION**  
 (ALL VALUES SHOWN ARE MAINTAINED HORIZONTAL FOOTCANDLES AT FINISHED GRADE, U.O.N.)

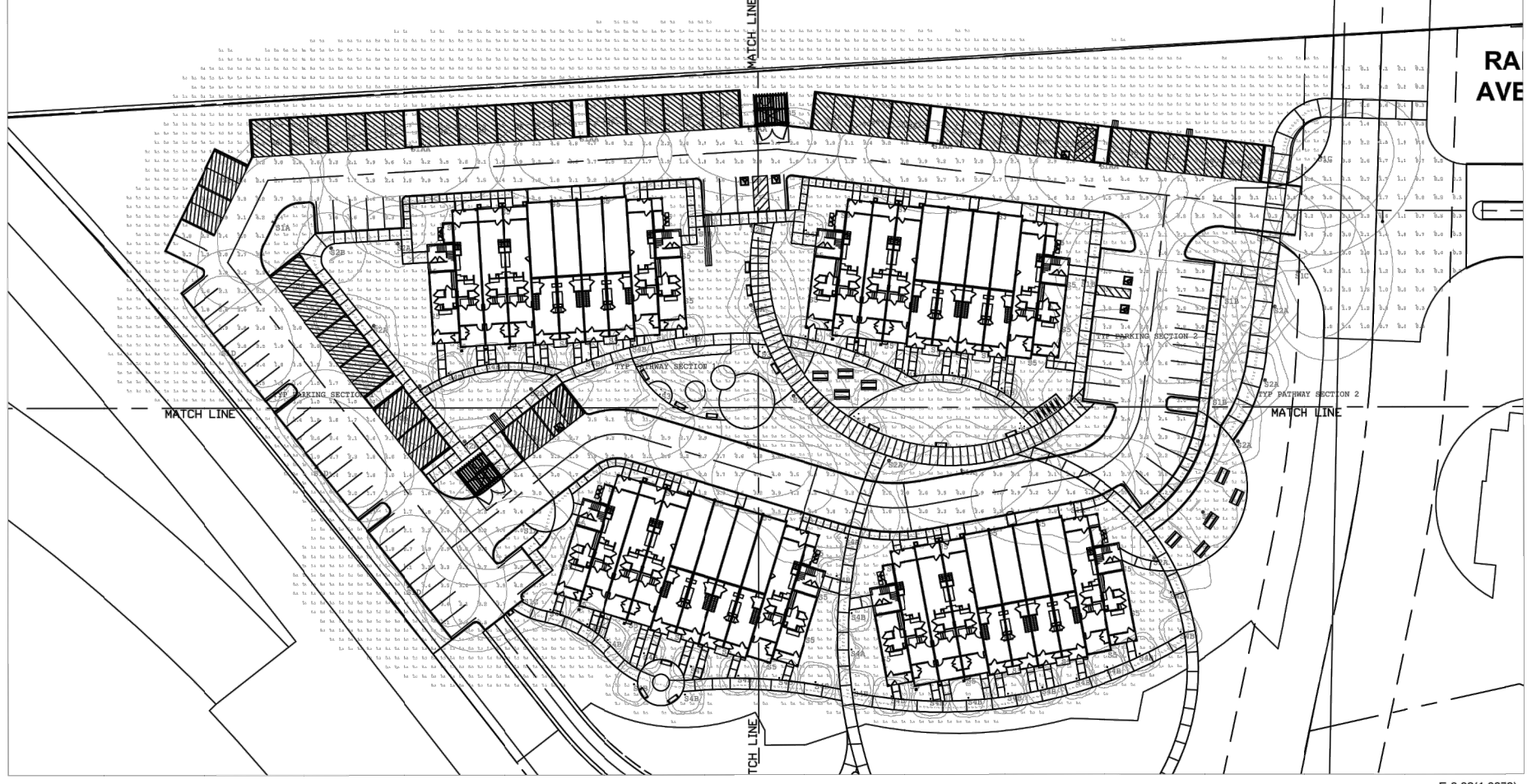

PRELIMINARY - NOT FOR CONSTRUCTION  
 NOT FOR QUOTING PURPOSES

ASSOCIATED LIGHTING REPRESENTATIVES, INC.

PHOTOMETRIC DATA USED AS INPUT FOR THESE CALCULATIONS IS BASED ON MANUFACTURER'S DATA. THIS IS NOT A GUARANTEE OF PERFORMANCE. THE USER SHALL VERIFY THE ACCURACY OF THE DATA AND THE RESULTS OF THESE CALCULATIONS. THE USER SHALL BE RESPONSIBLE FOR OBTAINING THE NECESSARY PERMITS AND APPROVALS FROM THE LOCAL, STATE, AND FEDERAL AUTHORITIES. THE USER SHALL BE RESPONSIBLE FOR OBTAINING THE NECESSARY PERMITS AND APPROVALS FROM THE LOCAL, STATE, AND FEDERAL AUTHORITIES. THE USER SHALL BE RESPONSIBLE FOR OBTAINING THE NECESSARY PERMITS AND APPROVALS FROM THE LOCAL, STATE, AND FEDERAL AUTHORITIES.

ASSOCIATED LIGHTING REPRESENTATIVES, INC.  
 10000 W. CENTRAL EXPRESSWAY  
 SUITE 200  
 DALLAS, TEXAS 75243  
 (972) 412-1111  
 www.airlighting.com

ASSOCIATED LIGHTING REPRESENTATIVES, INC.  
 10000 W. CENTRAL EXPRESSWAY  
 SUITE 200  
 DALLAS, TEXAS 75243  
 (972) 412-1111  
 www.airlighting.com

ASSOCIATED LIGHTING REPRESENTATIVES, INC.  
 10000 W. CENTRAL EXPRESSWAY  
 SUITE 200  
 DALLAS, TEXAS 75243  
 (972) 412-1111  
 www.airlighting.com

ACCENT SCAPES  
 SALES REPRESENTATIVE  
 TIM HALEY  
 ASSOCIATED LIGHTING REPRESENTATIVES, INC.

ASSOCIATED LIGHTING REPRESENTATIVES, INC.  
 10000 W. CENTRAL EXPRESSWAY  
 SUITE 200  
 DALLAS, TEXAS 75243  
 (972) 412-1111  
 www.airlighting.com

ASSOCIATED LIGHTING REPRESENTATIVES, INC.  
 10000 W. CENTRAL EXPRESSWAY  
 SUITE 200  
 DALLAS, TEXAS 75243  
 (972) 412-1111  
 www.airlighting.com

PROJECT: DEER CREEK APARTMENTS II  
 PETALUMA, CA  
 DRAWING NO.: 22801-HAL-RLDWG/A32

DATE: 05-31-2024  
 SHEET: 1 OF 4

SCALE: 1" = 10'-0"

