

GOVERNMENT-TO-GOVERNMENT CONSULTATION

COORDINATION REGARDING CULTURAL RESOURCES AND TRIBAL CULTURAL RESOURCES WILL OCCUR THROUGH THE FORMAL ENTITLEMENT AND ENVIRONMENTAL REVIEW PROCESS CONSISTENT WITH APPLICABLE BEST PRACTICE STANDARDS, CONSULTATION REQUIREMENTS, AND CONFIDENTIALITY PROVISIONS. CONFIDENTIAL SUPPORTING DOCUMENTATION IS NOT INCLUDED IN THE PRELIMINARY APPLICATION SUBMITTAL.



- Roof: GAF Timberline HD Reflector Series - Coastal Slate
 Windows: Anderson 100 Series, Black Composite Frame
 Paint: Sherwin Williams
 A. Agreeable Gray (Stucco) SW7029
 B. Universal Khaki (Siding, Garage Door) SW9130
 C. Extra White (Fascia, Trim) SW7006
 D. Navoi (Entry Door) SW6344

COLOR SCHEME 3

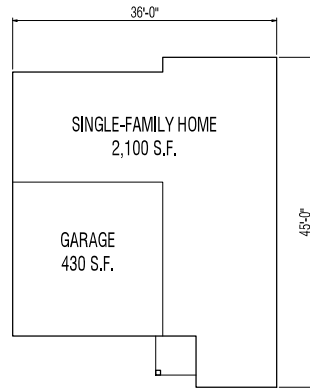

2,530 S.F. TOTAL UNIT

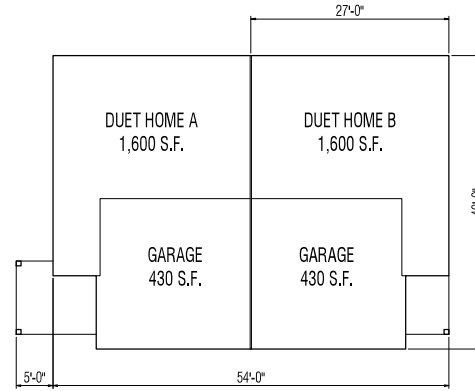

2,030 S.F. TOTAL UNIT

2,030 S.F. TOTAL UNIT



- Roof: Clicklock Premium Standing Seam - Vermont Slate
 AF Timberline HD Reflector Series - Birchwood
 Windows: Anderson 100 Series, Black Composite Frame
 Masonry: Eldorado Stone European Ledge - Zinc
 Paint: Sherwin Williams
 A. Alabaster (Stucco) SW7088
 B. Web Gray (Siding, Garage Door) SW7075
 C. Iron Ore (Fascia, Trim, Entry Door) SW7069

COLOR SCHEME 1

UNIT TYPE	UNIT SIZE (SQ. FT.)	# OF UNITS	TOTAL SQ. FT.
DUET HOMES	2,030	18	36,540
SINGLE-FAMILY HOMES	2,530	21	53,130
TOTAL PROJECT SQUARE FOOTAGE			89,670

PROJECT TABULATION



EXAMPLE 2-STORY SINGLE-FAMILY HOME
AMERICAN COTTAGE STYLING



EXAMPLE 2-STORY DUET HOMES
CONTEMPORARY STYLING

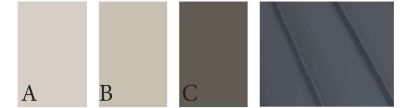

- Roof: Clicklock Premium Standing Seam - Vermont Slate
 AF Timberline HD Reflector Series - Birchwood
 Windows: Anderson 100 Series, Black Composite Frame
 Masonry: Eldorado Stone European Ledge - Zinc
 Paint: Sherwin Williams
 A. Whitford (Stucco) SW9576
 B. High Sierra (Siding) SW9588
 C. Ironwood (Fascia, Trim, Entry Door, Garage Door) SW9570

COLOR SCHEME 2

ARCHITECTURAL EXAMPLES

REVISIONS

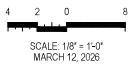

1 & 16 CEDAR GROVE PARK

SB 330 PRELIMINARY APPLICATION

CEDAR GROVE

APN 006-051-065, -006, -079
 PETALUMA, CALIFORNIA

75 ROCCA DRIVE APN 006-423-014

edward c. novak
 ARCHITECT
 1701 S. 1030 E. Heber City, UT 84032
 phone: 1-434-324-5395 email: ed@ecnovak.com

A1