



SOUTH SITE SOUTH ELEVATION 4
D STREET



SOUTH SITE EAST ELEVATION 3
SMART STATION



SOUTH SITE NORTH ELEVATION 2
THOROUGHFARE



SOUTH SITE WEST ELEVATION 1
COPELAND

LIGHTING LEGEND

- ① ▲ Type AS1 - Pool Deck Floodlight
- ② ● Type BH1 - Thoroughfare Bollard
- ③ ● Type BH2 - Courtyard Bollard
- ④ ■ Type LS1 - Shutter Wall Linear Grazer
- ⑤ ■ Type PD1 - Decorative Outdoor Pendant (Matching PD1, WS1)
- ⑥ ● Type PD2 - Catenary Ring Pendant
- ⑦ ● Type PH1 - City Standard Street Light
- ⑧ ■ Type PH1A - City Standard Street Light (Street Light with Acorn Fixture)
- ⑨ ● Type PH2 - Thoroughfare Pedestrian Pole
- ⑩ ● Type PH3 - Thoroughfare Tall Pole
- ⑪ ▲ Type RD1 - Canopy Structure Recessed Downlight
- ⑫ ●●● Type SC1 - Festoon Light
- ⑬ — Type SS1 - Halo Light (LED Tapelight)
- ⑭ ■ Type WS1 - Large Retail Entry Sconce (Matching PD1, PH2)
- ⑮ ■ Type WS2 - Decorative Sconce
- ⑯ ● Type WS3 - Building Entry Sconce
- ⑰ ■ Type XD1 - Theatrical Floodlight

KEY MAP

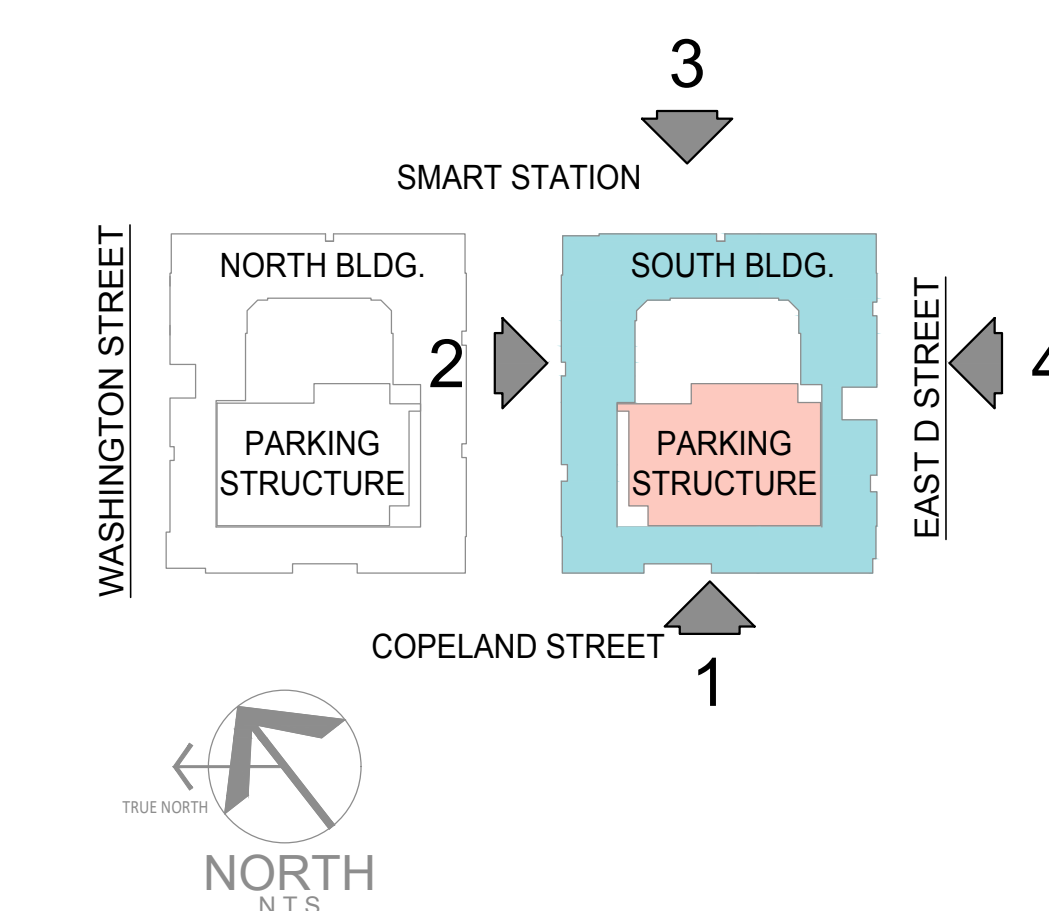

LIGHTING CONSULTANT
LIGHTING DESIGN ALLIANCE
 2830 TEMPLE AVE. LONG BEACH, CA 90806-2213, USA
 T: 562.989.3843 F: 562.989.3847
 www.LightingDesignAlliance.com

LD.1
 Scale 1/16" = 1'-0"
 Job No. 2017-628
 Date 08-21-2020

SOUTH BUILDING LIGHTING ELEVATIONS
 Conceptual Lighting Elevations



NORTH SITE SOUTH ELEVATION 4
THOROUGHFARE



NORTH SITE EAST ELEVATION 3
SMART STATION



NORTH SITE NORTH ELEVATION 2
WASHINGTON STREET



NORTH SITE WEST ELEVATION 1
COPELAND

LIGHTING LEGEND

- ① ▲ Type AS1 - Pool Deck Floodlight
- ② ● Type BH1 - Thoroughfare Bollard
- ③ ● Type BH2 - Courtyard Bollard
- ④ — Type LS1 - Shutter Wall Linear Grazer
- ⑤ ⌵ Type PD1 - Decorative Outdoor Pendant (Matching PD1, WS1)
- ⑥ ● Type PD2 - Catenary Ring Pendant
- ⑦ ● Type PH1 - City Standard Street Light
- ⑧ ● Type PH1A - City Standard Street Light (Street Light with Acorn Fixture)
- ⑨ ● Type PH2 - Thoroughfare Pedestrian Pole
- ⑩ ● Type PH3 - Thoroughfare Tall Pole
- ⑪ ▲ Type RD1 - Canopy Structure Recessed Downlight
- ⑫ ●●● Type SC1 - Festoon Light
- ⑬ — Type SS1 - Halo Light (LED Tapelight)
- ⑭ ■ Type WS1 - Large Retail Entry Sconce (Matching PD1, PH2)
- ⑮ ■ Type WS2 - Decorative Sconce
- ⑯ ● Type WS3 - Building Entry Sconce
- ⑰ ▲ Type XD1 - Theatrical Floodlight

KEY MAP

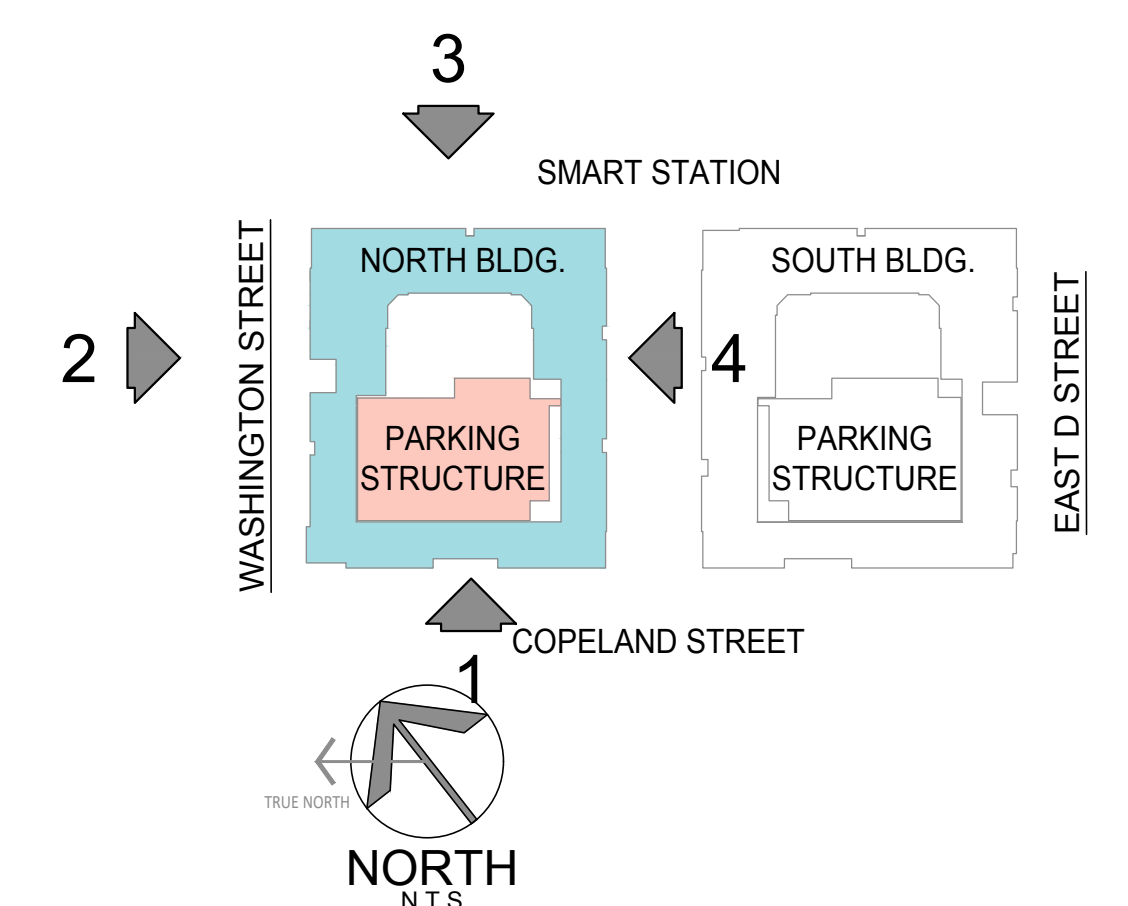

LIGHTING CONSULTANT
LIGHTING DESIGN ALLIANCE
 2830 TEMPLE AVE. LONG BEACH, CA 90806-2213, USA
 T: 562.989.3843 F: 562.989.3847
 www.LightingDesignAlliance.com

LD.2

Scale 1/16" = 1'-0"
 Job No. 2017-628
 Date 08-21-2020

NORTH BUILDING LIGHTING ELEVATIONS
 Conceptual Lighting Elevations

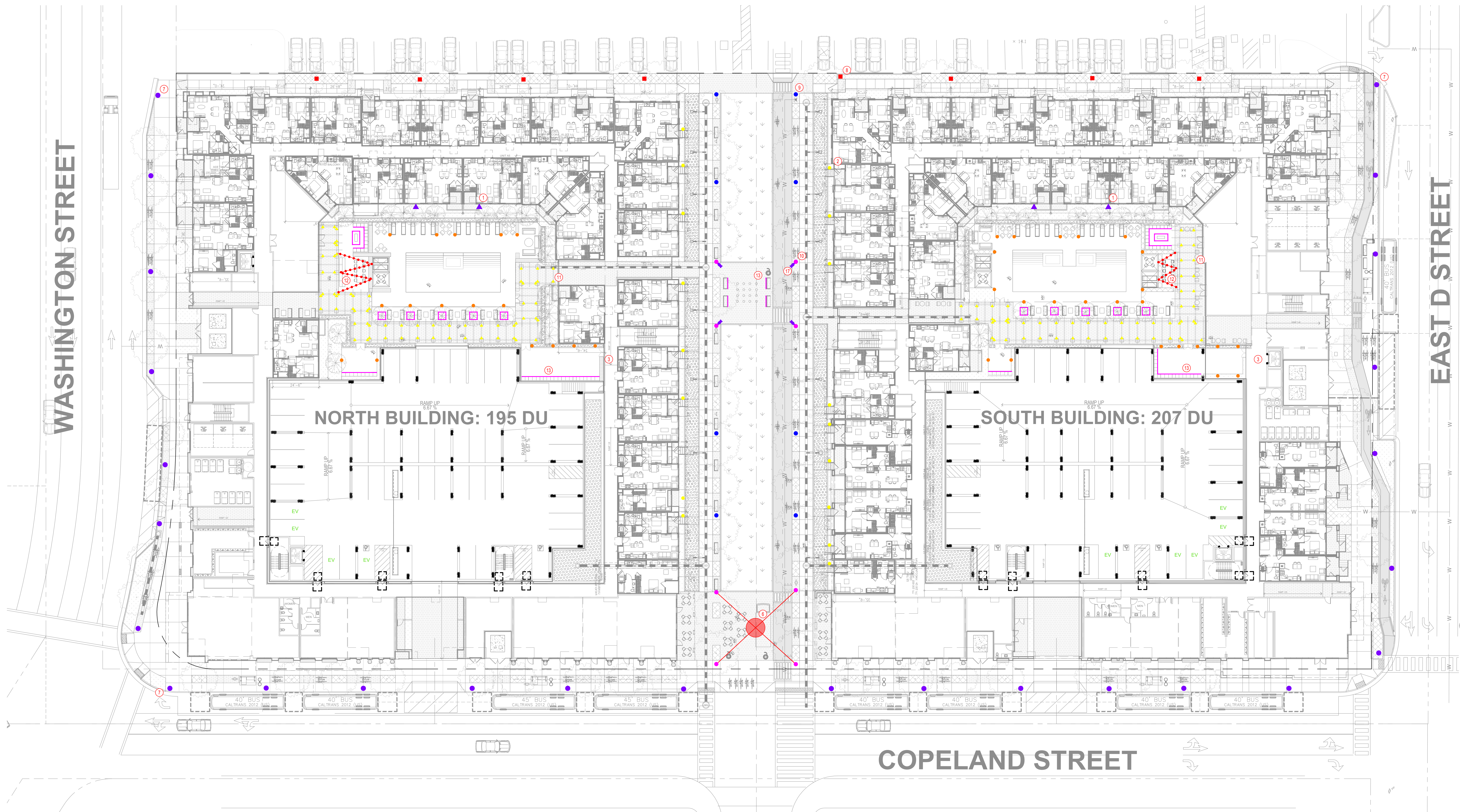

LIGHTING LEGEND

- | | | |
|---|--|--------------------------------------|
| ① ▲ Type AS1 - Pool Deck Floodlight | ⑧ ■ Type PH1A - City Standard Street Light (Street Light with Acorn Fixture) | ⑬ ■ Type WS2 - Decorative Sconce |
| ② ● Type BH1 - Thoroughfare Bollard | ⑨ ● Type PH2 - Thoroughfare Pedestrian Pole | ⑭ ● Type WS3 - Building Entry Sconce |
| ③ ● Type BH2 - Courtyard Bollard | ⑩ ● Type PH3 - Thoroughfare Tall Pole | ⑰ ▲ Type XD1 - Theatrical Floodlight |
| ④ ■ Type LS1 - Shutter Wall Linear Grazer | ⑪ ▲ Type RD1 - Canopy Structure Recessed Downlight | |
| ⑤ ■ Type PD1 - Decorative Outdoor Pendant (Matching PD1, WS1) | ⑫ ●●● Type SC1 - Festoon Light | |
| ⑥ ● Type PD2 - Catenary Ring Pendant | ⑬ — Type SS1 - Halo Light (LED Tapelight) | |
| ⑦ ● Type PH1 - City Standard Street Light | ⑭ ■ Type WS1 - Large Retail Entry Sconce (Matching PD1, PH2) | |

OVERALL SITE LIGHTING PLAN

SITE LIGHTING PLAN
Conceptual Lighting Plans

LIGHTING CONSULTANT
LIGHTING DESIGN ALLIANCE
2830 TEMPLE AVE. LONG BEACH, CA 90806-2213, USA
T: 562.989.3842 F: 562.989.3847
www.LightingDesignAlliance.com

LD.3

Job No. 2017-628
Date 08-21-2020

ERCO **Gecko Floodlight**

34124.023 Gecko m LED 18W 180lm 3000K warm white Trailing edge dimmable Version 5 Spherical lens, oval flood

Suitable for wet location (IP65): dust-proof and water (jet-proof) 120V. Dimming with external dimmers possible (trailing edge). Weight 5.5 lbs / 2.5 kg. Version with 3000K, CRI 97 or 2700K, 3500K, 4000K, CRI 92 available on request.

Product description
Housing, hinge and mounting plate: corrosion-resistant, cast aluminum. No-flare surface treatment. Double powder-coated (Optimized surface for reduced accumulation of dirt). Hinge with scale and internal wiring. Housing 130° tiltable, rotatable through 360°
Control gear, 60Hz, 120V dimmable, 27V switchable, 2 cable entries. Through-wiring possible: 3-pole terminal block.
LED module: high-power LEDs on metal-core PCB. Collimating lens made of optical polymer. Lens rotatable through 360°.
Compact light head with non-reflecting safety glass. Corrosion-resistant cast aluminum, double powder-coated.

Technical data
Luminous flux of the luminaire: 147lm
Connected load: 20.W
Luminance efficacy: 74lm/W
Color rendition: 1.5 SDCM
Color rendering index: CRI 92
Lumen maintenance (LED manufacturer specifications): L80 >= 50000h
LED failure rate: 0.1 failures/10000h
LMF: E

Technical region: 120V/60Hz, 277V/ 60Hz
We reserve the right to make technical and design changes.
Edition: 2010.2020
Current version under
www.ercoco.com/34124.023

LIGHT FIXTURE - TYPE AS1

Reverse Tilt Bollard Illuminated Aluminum Bollard

FIXTURE TYPE: _____
PROJECT NAME: _____

Tilted aluminum bollard with linear LED lighting matching the base details of the Reverse Tilt pole.

FEATURES:
• Smooth, dot-free illumination
• Integral power supply
• Multiple static color options and color-changing RGB available

SPECIFICATIONS:
CONSTRUCTION: Rectangular extruded 6061-T6 aluminum alloy tubes fastened to square 6061-T6 base support welded to 319SR aluminum alloy baseplate.

FINISHES AND MATERIALS: Metal pole shafts and base casting are powder-coated powder coat painted.

ELECTRICAL: Powered by a 90-305VAC primary/24VDC secondary integral power supply. System is 0/10V dimmable. Constructed with a US and Canada UL listed luminaire.

HARDWARE: All hand hole fasteners and luminaire bracket arm hardware are stainless steel. Anchor bolt kits are ASTM F1554 grade 5S steel with galvanized steel free nuts and washers.

LIGHT FIXTURE - TYPE BH1

TURBO BOLLARD **TECH LIGHTING**

The Turbo outdoor LED bollard features a clean, cylindrical silhouette highlighted with decorative fins evenly spaced around the circumference. The Turbo bollard offers unique symmetric optics with beam spread options of 20° or 40° to tailor the installation to each unique setting.

Universal 120-277V driver with integral transient surge protection at 2.5kV per ANSI and IEEE standards

Outstanding protection against the elements:
• Powder coat finishes
• Stainless Steel mounting hardware
• Impact-resistant, UV stabilized frosted acrylic lensing

SPECIFICATIONS

DELIVERED LUMENS	2045 (200V), 957 (120V)
WATTS	24 or 15
VOLTAGE	Universal 120-277V, with integral transient 2.5kV surge protection (delivered on 12V)
SECONDARY SURGE PROTECTOR	18KA (120-277V)
DIMMING	0-10V, 0/10V (0/10V)
LIGHT DISTRIBUTION	Symmetric
OPTICS	30° or 40°
MOUNTING OPTIONS**	Ball
PERFORMANCE OPTIONS	Photocontrol / In-Line Fuse (120V)
CCT	3000K or 4000K
CRI	95+
COLOR BINNING	3 Step
BUS BATTING	30 VDC 60
DARK SKY	Compliant
WET LISTED	IP65
GENERAL LISTING	ETL
CALIFORNIA TITLE 24	Can be used to comply with CEC 2016 Title 24 Part 4 for outdoor use. Registration with CEC Appliance Database not required.
START TEMP	-38°C
FIELD SERVICEABLE LED	Yes
CONSTRUCTION	Aluminum
HARDWARE	Stainless Steel
FINISH	Powder Coat
LED LIFETIME	L70, 70,000 Hours
WARRANTY*	5 Years
WEIGHT	18.3 lbs.

12V AC TRANSFORMERS*
*UL listed transformers, ordered separately.

ITEM	DESCRIPTION	HOUSING	DIMMING
7000T90T	MAGNETIC, 100W, 120V	STAINLESS STEEL	MAGNETIC
7000T90T	MAGNETIC, 300W, 120V	STAINLESS STEEL	MAGNETIC

ORDERING INFORMATION

7000T90T	DRY	LENGTH	BEAM SPREAD	LENS	FINISH	VOLTAGE	DISTRIBUTION	OPTIONS
8	30.0L/30.0W	42"	25°	20°/NARROW	C - FLAT CLEAR	120V	S	NONE
9	30.0L/30.0W	42"	25°	20°/NARROW	C - FLAT CLEAR	120V	S	PHOTOCONTROL
10	30.0L/30.0W	42"	25°	20°/NARROW	C - FLAT CLEAR	120V	S	PHOTOCONTROL & IN-LINE FUSE*

LIGHT FIXTURE - TYPE BH2

boca flasher **NANOLUME** Micro Profile LED Task and Cove Fixture

Customer: _____
Project: _____

PRODUCT SPECIFICATIONS:

Nanolume	WATTAGE	COLOR OPTION	VOLTAGE	OPTIC	FINISH	MOUNTING	LENS	BAFFLE	REFLECTOR
	3W	2000K	120V	10°	W White	S Ball	C Clear	SQ Square	Y Yes
	6W	2400K	277V	15°x40°	B Black	H Hinge	HD Heavy Duty	SL Slanted	N No
		2700K		120°			HD Heavy Duty		
		3000K					HD Heavy Duty		
		3500K					HD Heavy Duty		
		4000K					HD Heavy Duty		

DIMENSIONS:

Plan View: 12" x 1/2" x 1/2" (minimum)
Elevation View: 12" x 1/2" x 1/2" (minimum)
End View: 12" x 1/2" x 1/2" (minimum)

LIGHT FIXTURE - TYPE LS1

VILLAGE

VILLAGE 375U.E. Catenary Mounted Luminaire

The contemporary form of VILLAGE adds a minimalist accent to modern architecture. Fabricated aluminum housing encloses the clear acrylic cylindrical lens. Luminaire is finished in finely textured paint. All hardware is stainless steel. Standard colors: graphite grey. Special colors available. Structural design, stainless steel catenary cable, and fittings for mounting to support structure provided by others. * Listed for Wet Locations.

Model: Lamp
Vkg25K LED / 100 MH / 70 MH

FEATURES:
• Available in 2' to 12' diameters
• >90CRI smooth, dot-free illumination
• Dimmable P67 power supply and P67 luminaire
• Catenary cable, ceiling, and wall mounting options

SPECIFICATIONS:
HOUSING: Solid Accoya wood linear assembled through glulam construction and precision machined using CNC technology. Adhesive complies with ASTM D-2559 glulam construction specifications for extreme exposed weather conditions, waterproof, and rated for wet or dry-use exposure.

ELECTRICAL: Powered by a 90-305VAC primary/24VDC secondary remote dimmable power supply. Driver features built-in short circuit, over temperature, over voltage, and over current. System is 0/10V dimming. Catenary mounted fixtures supplied with 1' infeed cable. A 40' leader cable supplied with infeed only fixtures. Ceiling canopy mounted fixtures supplied with 0' infeed cable. Constructed with a US and Canada UL listed luminaire.

OPTICAL SYSTEM: Available in 2700K, 3000K, 3500K, 4000K color temperatures with smooth, dot-free illumination. Operating temperature of -35°F to 125°F, 50, 100°F, and 160°F HO.

FINISHES AND MATERIALS: Wood is finished with a low VOC waterborne matte exterior finish containing UV and mildew inhibitors.

HARDWARE: All fasteners and non-wood components are stainless steel unless otherwise noted.

WARRANTY: 25-year wood warranty with a 5-year finish warranty. 3-year warranty on LED and driver.

LIGHT FIXTURE - TYPE PD1

Aura Illuminated Wooden Ring Pendant

FIXTURE TYPE: _____
PROJECT NAME: _____

Solid wood exterior/interior LED round pendant.

FEATURES:
• Available in 2' to 12' diameters
• >90CRI smooth, dot-free illumination
• Dimmable P67 power supply and P67 luminaire
• Catenary cable, ceiling, and wall mounting options

SPECIFICATIONS:
HOUSING: Solid Accoya wood linear assembled through glulam construction and precision machined using CNC technology. Adhesive complies with ASTM D-2559 glulam construction specifications for extreme exposed weather conditions, waterproof, and rated for wet or dry-use exposure.

ELECTRICAL: Powered by a 90-305VAC primary/24VDC secondary remote dimmable power supply. Driver features built-in short circuit, over temperature, over voltage, and over current. System is 0/10V dimming. Catenary mounted fixtures supplied with 1' infeed cable. A 40' leader cable supplied with infeed only fixtures. Ceiling canopy mounted fixtures supplied with 0' infeed cable. Constructed with a US and Canada UL listed luminaire.

OPTICAL SYSTEM: Available in 2700K, 3000K, 3500K, 4000K color temperatures with smooth, dot-free illumination. Operating temperature of -35°F to 125°F, 50, 100°F, and 160°F HO.

FINISHES AND MATERIALS: Wood is finished with a low VOC waterborne matte exterior finish containing UV and mildew inhibitors.

HARDWARE: All fasteners and non-wood components are stainless steel unless otherwise noted.

WARRANTY: 25-year wood warranty with a 5-year finish warranty. 3-year warranty on LED and driver.

LIGHT FIXTURE - TYPE PD2

1.16" Schedule #10 Steel Pipe, Arm with Union Metal No. 49-F2 Final (1.16" Thread, or Approved Equal)

Union Metal Design No. 3714 - No. 7.5-30/4-Por Approved Equal.

11 Gauge Steel (0.71" x 0.52" x 33.29" "Klen-Floled Pole Paterns"

33.29"

1.50"

2.16"

1.125"

Face of Curb
Union Metal No. 1.5 Series Cant Iron Pedestal and Base or Approved Equal.
Top of Traveled Way

NOTES:
1. Design shall conform to these requirements except as otherwise approved by the City Engineer by variance.
2. Ground surface at base must be level.
3. (4) 0.60" x 2.50" Large Anchor Bolts (0.33' Proj.) with (2) Hex Nuts shall be used on the 0.87" Base Coupling.

CITY OF PETALUMA
Department of Engineering
23 Street Street, Petaluma, CA 94952
(707) 261-1200
www.ci.petaluma.ca.us

Historic Style Mastarm Street Light

Drawn by: Blatch Smith
Date: N. T. S.
Checked by: June 28th 1999 (Rev.)
Scale: Std Det. SL-S0000.610

LIGHT FIXTURE - TYPE PH1

1914LED LIBERTYVILLE SERIES

EPA 1.55 (87)
WESST 50 LBS (A-LENS)
62 LBS (B-LENS)

7 YEAR WARRANTY

LUMEN RANGE 4,033-34,400

LIFE SPAN 100,000 HOURS

UL LISTED
UL ENEC
UL ENEC
UL ENEC

DLC
DLC
DLC

RATED PH6
PH6

JOB NAME
FITTURE TYPE
MEMO

BUILD A PART NUMBER

ORDERING EXAMPLE: 2A-1914LED-3L40T5-MDL07-A-PEC-HSHS/CA/6420SRTS/RPBP/BKT

Mounting Config	Fixture	Shade	LED	CCT	Type	Driver	Lens	Optional Controls	Optional Control	Optional Fuse	Optional Hang Strait	Optional Termi Block	Optional Pole	Arm	Pole	Finish
-----------------	---------	-------	-----	-----	------	--------	------	-------------------	------------------	---------------	----------------------	----------------------	---------------	-----	------	--------

MOUNTING CONFIGURATION
[Click here to view mounting configuration specification page]
• For use with systems up to 14W.
• For use with systems up to 15W.

SHADE (Optional)
• HSH4LED
• RLM31 • RLM731 • RWLS31

LED
• IL • 3L • 4L

CCT - Color Temperature [K]
• 2700 • 3000 • 4000 • 5000

Type
• T2 • T3 • T4 • T5

Driver
• MDL06 (120v-277v, 600mA) (IL or 3L system)
• MDL07 (120v-277v, 700mA)
• MDH07 (347v-480v, 700mA) (IL system)
• MDH08 (120v-277v, 800mA) (IL system)
• MDH08 (347v-480v, 800mA) (IL system)
• MDL09 (120v-277v, 900mA)
• MDH09 (347v-480v, 900mA) (IL or 4L system)
• MDL10 (120v-277v, 1050mA)
• MDH10 (347v-480v, 1050mA) (IL system)
• MDL12 (120v-277v, 1200mA) (IL or 4L system)
• MDH12 (347v-480v, 1200mA)
• MDL16 (120v-277v, 1600mA)
• MDH16 (347v-480v, 1600mA) (IL system)

Lens
• SG (Sag Glass)
• PFG (Pressed Sag Glass)
• A (Ribbed Acrylic, Teardrop)
• G (Glass Prismatic Teardrop)
• SVISA (Soft Vue Light Diffused Acrylic Sag)

Finish
Standard Finishes*
• BKT Black Textured
• WHT White Textured
• PCT Park Green Textured
• ABZ Architectural Medium Bronze Textured
• DPT Dark Bronze Textured
*Smooth finishes are available upon request.
Custom Finishes*
• CM Custom Match
• CI Cold Iron
• RT Rust
• WBR Weathered Brown
• CD Cedar
• WPK Weathered Black
• TT Two Tone
*Custom colors require upcharge.
Sternberg Select Finishes
• VC Verde Green
• SW Swedish Iron
• OWCT Old World Gray Textured

Specifications
The 1914LED with an "A" lens shall be 17" wide and 35" tall. It shall be made of heavy wall cast aluminum alloy, and offer tool-less access to the driver compartment. The Luminaire shall be UL listed in the US and Canada. The optical mounting plate shall have precision cast mounting sites for CCB chip and optic assemblies. Die-cast mounting plate shall have an integral high performance heat pipe assembly for transferring chip generated heat away from sensitive electronics.
Shade
An optional 31" spun aluminum shade is available in various styles which helps reduce uplight while offering a unique element to the fixture.
LEDs
The luminaire shall use high output, high brightness LEDs, consisting of a two piece assembly complete with Chip on Board (COB). See spec page.

SternbergLighting
ESTABLISHED 1923 / EMPLOYEE OWNED

555 Lawrence Ave., Roseville, IL 60172
info@sternberglighting.com
www.sternberglighting.com

800-621-3376
F: 662-989-3847
www.LightingDesignAlliance.com

LIGHT FIXTURE - TYPE PH1

VILLAGE 375 LVC

Specification

The contemporary form of VILLAGE adds a minimalist accent to modern architecture. The fabricated aluminum housing encircles the clear acrylic cylindrical lens. The housing base includes an integral fitter for pole top mounting. Optics include a choice of symmetric or asymmetric distributions. Electrical components are housed in a spun aluminum enclosure and mounted in the luminaire. Luminaire and stepped pole with double welded transition and flush handle are finished in finely textured paint. Base cover is spun aluminum. All hardware is stainless steel.



LED Model	Color	Temperature	Distribution	Volt	Mounting	Pole	Pole Mat	Finish	Option
VK375	UV-C	3000K	T2 - Type II	105-107 pole w/ 3' step	P-Direct Post Top	105-107 pole w/ 3' step	A - Aluminum	SG - Silver Grey	Dimming
	NW	4000K	T3 - Type III	125-127 pole w/ 4' step			S - Steel	DG - Dark Grey	N - None
			T4 - Type IV	145-147 pole w/ 4' step				GG - Graphite Grey	
			T5 - Type V					BLK - Matte Black	
								BRZ - Dark Bronze	
								CC - Custom RAL Color	

Ordering Information

VK375 UV-C UNV P

Specifications are subject to change without notification
HessAmerica > Products > Lighting Products > Pole Mounted Luminaire > VILLAGE
https://www.hessamerica.com/Products/Lighting/Pole_Mounted_Luminaire/VILLAGE/

LIGHT FIXTURE - TYPE PH2

Bol 8' - 24' Round Tapered and Straight Wood Poles

FIXTURE TYPE: _____
PROJECT NAME: _____



Glulam solid wood and aluminum pole available in 8' - 24' lengths. Tenon adapters, slip fittings and side bracket mounts are available for luminaire mounting.

FEATURES:

- Round tapered aluminum pole base with flush handle/cover held with countersunk stainless steel fasteners.
- Tapered, round, solid glulam wood pole.

SPECIFICATIONS:

HOUSING: Solid wood pole is assembled through glulam construction and precision machined using CNC technology. An electrical raceway is provided in the pole's center for wiring. Laminations measure no more than 2" in thickness. Adhesive complies with ASTM D-2559 glulam construction specifications for extreme exposed weather conditions, is waterproof and rated for wet or dry use exposure.

ELECTRICAL: A 5/16" - 18 grounding point is provided on the aluminum pole base. Wireway access is provided through a 3/4" thick aluminum anchor bolt base. Anchor bolt kit includes (4) 3/4" hot dip galvanized anchor bolts and fasteners and ridged concrete pour template.

FINISHES AND MATERIALS: Woods are finished with a low VOC waterborne matte exterior finish containing UV and mildew inhibitors. All aluminum parts are polyester powder coat painted.

HARDWARE: Fasteners are stainless steel. Anchor bolt kits are hot dip galvanized.

FIXTURE MOUNTING: Fixtures mount either by 2.5/8", 2 7/8", 3 1/2", or 4" diameter by 4" tall tenon or drill mount for arm brackets. Consult factory for other tenon sizes. Luminaires shall be provided by others.

LIGHT FIXTURE - TYPE PH2

VILLAGE

FIXTURE TYPE: _____
PROJECT NAME: _____



www.hessamerica.com

VILLAGE - Pole Mounted Luminaire

Simple styling and meticulous detail exemplify the VILLAGE luminaire. The single piece ringed cage is fabricated from aluminum and intricately constructed to show no visible welds. Cylindrical lens is clear acrylic and houses the optical assembly. Optics are available in symmetric and asymmetric distributions to match site lighting requirements. Stepped pole with double welded transition and flush handle is available in steel or aluminum. Steel pole is hot-dip galvanized prior to being finished in finely textured paint. Base cover is spun aluminum. All hardware is stainless steel. Standard colors; matte silver grey metallic, dark grey, graphite grey, matte black, or dark bronze. Special colors available. CSA Certified for Wet Locations.

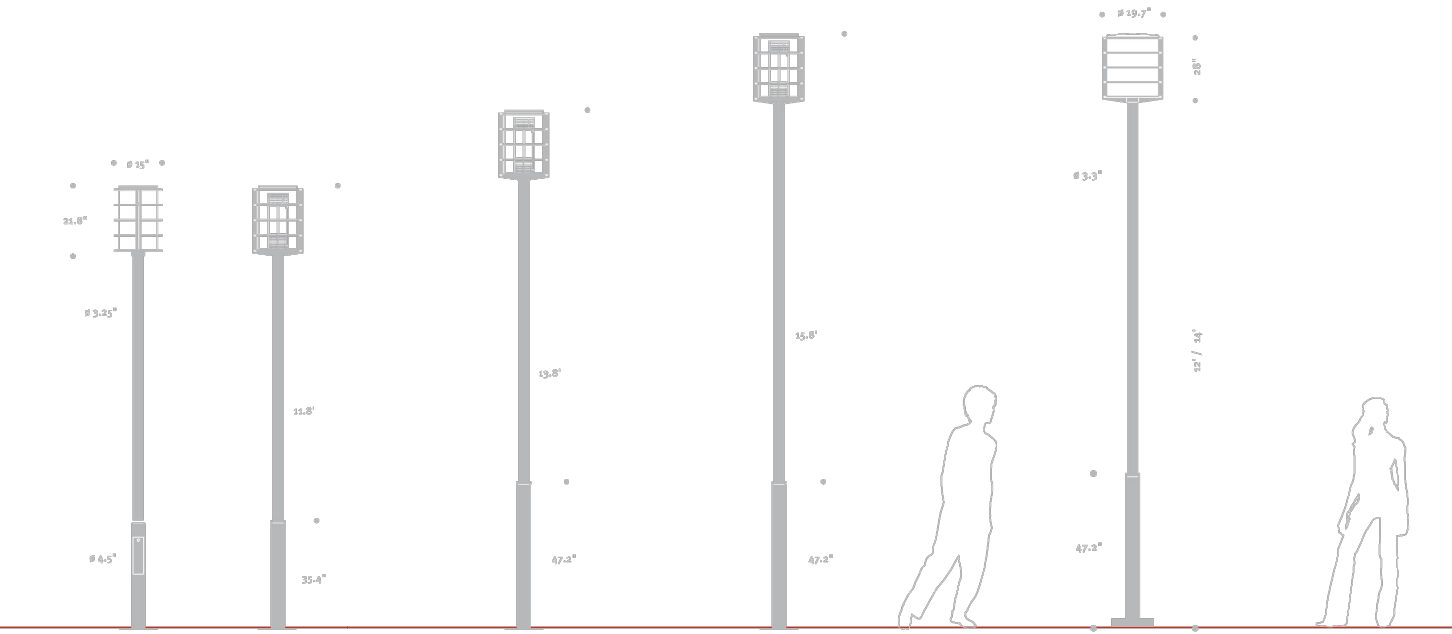

Model	Pole	Lamp
VK375P	10' with 3' step	LED / 100 MH / 70 MH
VK375S	12' or 14' with 4' step	LED / 100 MH / 70 MH
VK450P	12' or 14' with 4' step	LED / 150 MH / 100 MH / 70 MH



LIGHT FIXTURE - TYPE PH3

Beam 12' - 30' Steel Pole

FIXTURE TYPE: _____
PROJECT NAME: _____

Steel H-beam upright with wood accent panels.

FEATURES:

- Roadway or pedestrian pole heights up to 30'
- Catenary cable capabilities.
- Available in 6" and 8" square sizes.

SPECIFICATIONS:

CONSTRUCTION: Formed A992 steel beam welded to an A36 steel baseplate. Solid wood pole is assembled through glulam construction and precision machined using CNC technology. Adhesive complies with ASTM D-2559 glulam construction specifications for extreme exposed weather conditions, is waterproof and rated for wet or dry use exposure.

FINISHES AND MATERIALS: All steel and aluminum parts are polyester powder coat painted. Woods are finished with a low VOC waterborne matte exterior finish containing UV and mildew inhibitors.

ELECTRICAL: A 5/16" - 18 grounding point is provided on the aluminum pole center support. Wireway access is provided through a NEC compliant handle hidden behind access panel.

HARDWARE: All fasteners and hardware are stainless steel. Anchor bolt kits are hot dipped galvanized steel.

FIXTURE MOUNTING: Fixtures mount pole to arm with welded on bolt plate or tenon.

LIGHT FIXTURE - TYPE PH3

KLIK USA 2840 N Brookfield Rd, Suite 3 Brookfield, WI 53045 PH: 262.555.5124 FX: 262.753.6582 www.klikusa.com

Project Name: _____ **Location:** _____
Specifier: _____ **Rep Agency:** _____
Fixture Type: _____ **Product Code:** _____

KLIK LEDpod™ XL50 Patented

Description

Minimalist point source LED fixture with multiple outputs for use in hollow metal structures such as guard rails, awnings, canopies and custom luminaires.

Housing

Clear anodized aluminum body as standard. Color-matched anodized as an option, consult factory.

Aluminum body has a fine 25-micron finish and is hard-coat anodized, thus preventing galvanic corrosion.

Mounting

Unique concealed internal mounting wings hold the fixture in place, deployed via undrillable screw holes with patented spring and tamper screws.

Tube Size:

- XL50 Flat: R55 min 2 7/8" height, Max. wall .3125"
- XL50R55: Ø 3" - 2", Max. wall .3125"
- XL50R85: Ø 6" - 8", Max. wall .3125"
- Other sizes available upon request
- Weight: 0.43 LBS.

Electrical/LED Driver

Input Voltage: 24 VDC *Please note, all KLIK fixtures are now dimmable as standard

Operating Temp: -40 to 120° F

Efficiency: Up to 100 lm/W

Driver: Most use class 2 driver

- Primary Driver: 150-177 VAC UL Listed Constant Voltage
- Secondary Driver: Constant Current (provided with fixture)

Control: DALI, 0-10V, DMX

DMX control typically for dimming only. Contact factory for addressable and RGBW options.

Enclosure: Minimum NEMA 3R required

Wire connectors provided, factory wire-harness available, consult factory

Listings

- ETL listed, UL 1598/CSA 22.2, CE
- IP65 rated at 1" after luminaires tested to A583209 2004 Degree of protection provided by enclosure (IP Code)
- Class 2 device
- Wet location rated

Product Codes	Size	Beam Profile	Color	Wattage	Distribution	Optic	Lens	Custom Bezel ¹
KLK LEDpod XL	Ø 3"	Flat	277K	2700K	12.3-2.3 Watts (Ø Symmetrical)	Spot	Clear lens etched	RAL: Custom
	1.90"	R55	50mmR	30K	3000K	NFL	Narrow Flood	Powdercoat
		R55	50mmR	40K	4000K	FLD	Flood	ANOD Color Anodize
		R55	50mmR	40K	4000K	SPRFL	Spot Reflector	SHR Diode shield for horizontal mount
		R55	50mmR	40K	4000K	FLDRFL	Fluid Reflector	
		R55	50mmR	40K	4000K	FLDRFL	Fluid Reflector	

1. Additional charges and lead time apply for this feature.
2. Contact factory.

LIGHT FIXTURE - TYPE RD1

The Basic System

The Exhibitor Series sockets are permanently sealed to flexible cable with shatterproof polycarbonate globes. Fixtures are wet-location listed and rated IP65. When specifying an Exhibitor Lighting System, take into consideration: Socket Spacing, LED Style and Globe Selection.

EXBK - 6 - VIVW - S14 - C

Cable / Socket Color	Socket Spacing	LED	Globe Style	Globe Color
Code	Color	Code	Color	Code
BK	Black	2000K White	S19	G-19
WH	White	2400K White	G14	G-14
		3000K White	S14	S-14
		2000K White	G14 & S-14 in	A
		2400K White	clear and frosted only	B
		3000K White	clear and frosted only	R
		2400K White	clear and frosted only	V
		3000K White	clear and frosted only	M

Mounting Options

Fastoon Mounting
Part# EX-MDA-WH (White)
Part# EX-MDA-BK (Black)

For fastoon applications to a catenary cable, our wire-rope adaptors securely hold each socket in place to a 1/16" or 1/8" diameter wire rope. Wire rope and associated mounting hardware is not provided with the system.

Surface Mounting with Disks
Part# EX-MD-WH (White)
Part# EX-MD-BK (Black)

Exhibitor Series can be surface mounted to structures using mounting disks. One disk is required for mounting each socket. The socket can be snapped into the disk and screwed in place to the structure.

Surface Mounting with Straps
Part# EX-MS-WH (White)
Part# EX-MS-BK (Black)

Exhibitor Series may be surface mounted to structures using our mounting straps. Two straps are required for mounting each socket. Straps are positioned on either side of the socket, and then screwed securely to the structure.

Panel/Extrusion Mounting
Part# EX-SH

For installations to flat panels or extrusions up to 0.06", offer our stainless-steel panel fasteners. The socket assembly is inserted from below, then the panel fastener and grommet are pressed in place from above.

LIGHT FIXTURE - TYPE SC1

LineLED LL Series Wet Tube

IP65 & IP68 rated Linear LED strip - 24V



LineLED Wet Tube is a new small profile, more energy efficient LED strip for wet locations. The LineLED Wet Tube has superior light output, a durable but flexible circuit board and it is very easy to install.

Due to the sealing band needed to guarantee the wet-rating, exact lengths are required to order the LineLED Wet Tube. Extending and turning corners in the field require custom production.

Mounting

LED strip is equipped with 3M™ VHB™ adhesive transfer tape.

Approvals

IP65 & IP68 rated

Beam Angle

120°

Operating voltage

24 VDC

Average life

50,000 hours

Warranty

3 years

Technical information

MODEL	LL18 WET	LL30 WET	LL36 WET	LL54 WET
LEDs/ft	18	30	36	54
Light output 3000K	121 lum/ft	190 lum/ft	244 lum/ft	353 lum/ft
Average power consumption (for 15' section)	1.5 W/ft	2.5 W/ft	3.0 W/ft	4.5 W/ft
Ordering increment	4.00'	2.50'	2.00'	1.3'
Maximum run length (ft. max)	100 ft.	48 ft.	39 ft.	26 ft.
Profile Dimensions W/connector dimensions, (see line drawing)	0.47" W	0.47" W	0.47" W	0.47" W
	0.24" H	0.24" H	0.24" H	0.24" H

SECTION START/END OPTIONS

72" Sealed end (S14S)

72" Sealed end (S14R)

Female quick connect end (F)

Male quick connect end (M)

No connector (NC) P/N code only

No connector (NC) P/N code only

CCT INFO/LUMEN MULTIPLIER

Color Temperature	Multiplier (calculated from 3000K)	CRI	R _a	R _g
2700K	0.81	98	95	101
3000K	1.00	92	90	99
3500K	1.05	94	90	99

Ordering code

MODEL: LL18WET, LL30WET, LL36WET, LL54WET
PROCESSOR: T, 1-18w, 27K, 30K, 35K
COLOR TEMPERATURE: 27K, 30K, 35K
SECTION START: S14S, S14R, NC
SECTION END: S14S, S14R, NC
CONNECTOR: F, M, NC

• Title 24 JAB Compliant
••• Other color temperatures are available for special order
•••• Only available option with IP62

LIGHT FIXTURE - TYPE SS1

VILLAGE

FIXTURE TYPE: _____
PROJECT NAME: _____



www.hessamerica.com

VILLAGE 375 W, Wall Mounted Luminaire

The contemporary form of VILLAGE adds a minimalist accent to modern architecture. Fabricated aluminum housing encircles the clear acrylic cylindrical lens. Luminaire and bracket are finished in finely textured paint. All hardware is stainless steel. Standard colors; graphite grey. Special colors available. Listed for Wet Locations.

Model	Mounting	Lamp
VK375W	Wall	LED / 100 MH / 70 MH

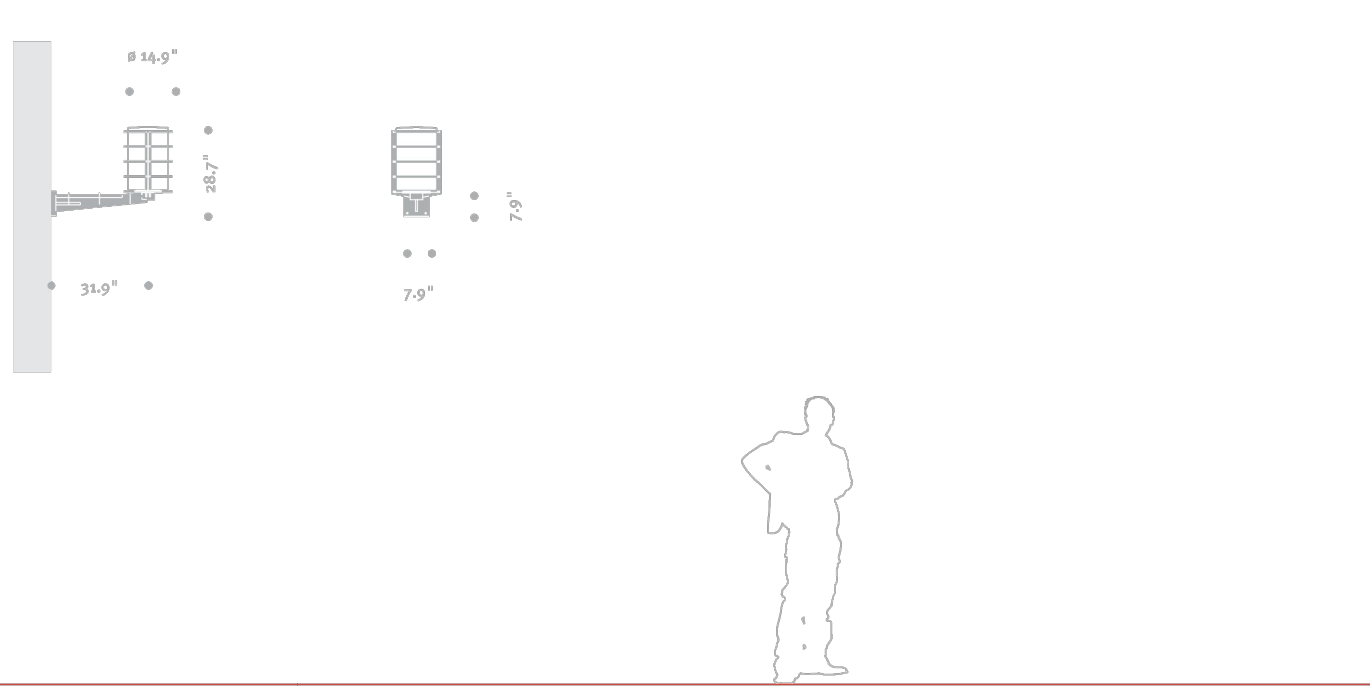

LIGHT FIXTURE - TYPE WS1



LIGHT FIXTURE - TYPE WS2

MEGA Exterior Sconces
WS-W70612

MODERN FORMS

Fixture Type: _____
Catalog Number: _____
Project: _____
Location: _____

PRODUCT DESCRIPTION
A purposeful asymmetrical wall mounted up or down light design brightly illuminates walkways and provides security with an attractive simple architectural form.

FEATURES

- Up or down illumination
- Weather-resistant powder coat
- Luminaire may be rotated 150° when mounting
- Dimmer: ELV 10-10V 100% 100%
- Universal Driver (120-277V) within fixture
- Rated Life: 60,000 hours
- Color temp: 3000K
- CRI: 90

SPECIFICATIONS
Construction: Aluminum
Light Source: High output LED
Finish: Black (BK), Bronze (BZ)
Standards: ETL & cETL Wet Location listed, IP65 Rated, CEC Title 24 Compliant, ADA Compliant, Dark Sky Friendly

ORDER NUMBER

Model	Height	Wattage	Voltage	LED Lumens	Delivered Lumens	Finish
WS-W70612	11"	25W	120-277V	845	670	BK BZ Black Bronze

Example: WS-W70612-BZ

modernforms.com Phone: (866) 810-9815 Fax: (800) 528-2585
Headquarters/Eastern Distribution Center 44 Harbor Park Drive Port Washington, NY 11090
Central Distribution Center 1902 Distribution Ct Lithia Springs, GA 30152
Western Distribution Center 1750 Acropolis Avenue Ontario, CA 91760

Modern Forms retains the right to modify the design of our products at any time as part of the company's continuous improvement program. AUG 2019

LIGHT FIXTURE - TYPE WS3

Specification Sheet

lumenbeam
Large
L8
WHITE AND STATIC COLOURS

Project Name: _____ Qty: _____
Type: _____ Catalog / Part Number: _____

Photometric Summary

Symmetric	Delivered output (lm)	Intensity (cand cd)
XN 4°	2273	295,070
VN 6°	3013*	1,56,978*
NS 10°	5039*	75,098*
NF 20°	5159*	48,366*
M 30°	4725*	25,678*
FL 40°	4225*	10,426*
WL 60°	4005*	4,252*

Asymmetric

	Delivered output (lm)	Intensity (cand cd)
NAS	3352*	51,827*
WW	4131*	12,658*

Optics

XN 4°	VN 6°	NS 10°	NF 20°	M 30°

Colours and Colour Temperatures

2200K	2700K	3000K	3500K	4000K	5700K

Red Green Blue

Description
The Lumenbeam Large is an IP65-rated luminaire for lighting landscapes, trees, columns, monuments, and architectural details. It has numerous options, including optics for flood or accent lighting, a choice of colour temperatures and colours, as well as various accessories, spread lenses, and controls. The luminaire also has an on/off control option for use in harsh, outdoor, or coastal environments.

Features
Colour and Colour Temperature: 2200K, 2700K, 3000K, 3500K, 4000K, 5700K. Also: Green, Blue
Optics (nominal distribution): XN 4°, VN 6°, NS 10°, NF 20°, M 30°, FL 40°, WL 60°, NAS (Narrow Asymmetric), WW (Asymmetric, Washwall)
Optical Option: Linear spread lens horizontal distribution, Linear spread lens vertical distribution
Options: Short Yoke, 3G ANSI C136.31-2010 Vibration Rating for bridge applications, Corrosion-resistant coating for hostile environments
Cable Colour: Black, White
Power Consumption: 50 W
Warranty: 5-year limited warranty
Performance:
Maximum Delivered Output: 5157 lm (4000K, NF 20°)
Maximum Delivered Intensity: 295,070 cd at nadir (4000K, XN 4°)
Illuminance at Distance: Minimum 1 lx at 543 m (4000K, XN 4°)
Colour Consistency: 3 SDCM
Colour Rendering: Minimum CRI 80
Lumen Maintenance: L70 B50 > 250,000 hrs (Ta 25 °C) (≥ 80,000 hrs for XN 4°, VN 6°, NAS optics only)
Physical:
Housing Material: Low copper content high pressure die-cast aluminum
Yoke Material: Heavy aluminum (standard yoke included)
Lens Material: Clear tempered glass

lumenpulse
4th Avenue, The Village, Trafford Park Manchester, M11 1BB GB T: +44(0)161 820 1111 F: +44(0)161 820 1888
www.lumenpulse.com www.lumenpulsegroup.com www.lumenpulse.com/products/1887

Lumenpulse Group Inc. reserves the right to make changes to this product at any time without prior notice and such modification shall be effective immediately. 2020.08.20 copyright © 2020 Lumenpulse Group Inc. 1 / 15 LA-846

LIGHT FIXTURE - TYPE XD1

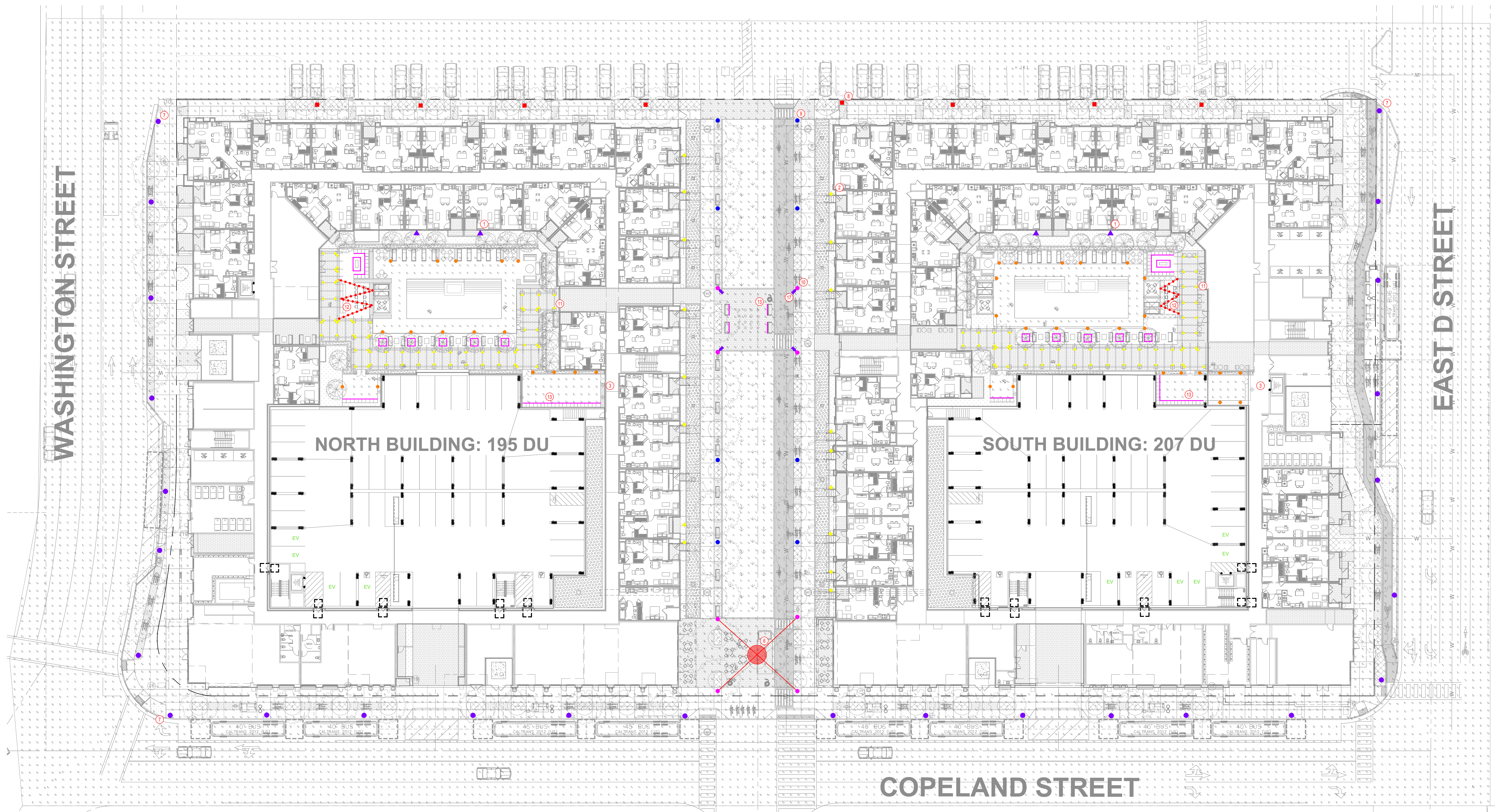

LIGHTING LEGEND

- ① ▲ Type AS1 - Pool Deck Floodlight
- ② ● Type BH1 - Thoroughfare Bollard
- ③ ● Type BH2 - Courtyard Bollard
- ④ - Type LS1 - Shutter Wall Linear Grazer
- ⑤ ⚡ Type PD1 - Decorative Outdoor Pendant (Matching PD1, WS1)
- ⑥ ● Type PD2 - Catenary Ring Pendant
- ⑦ ● Type PH1 - City Standard Street Light
- ⑧ ■ Type PH1A - City Standard Street Light (Street Light with Acorn Fixture)
- ⑨ ● Type PH2 - Thoroughfare Pedestrian Pole
- ⑩ ● Type PH3 - Thoroughfare Tall Pole
- ⑪ ▲ Type RD1 - Canopy Structure Recessed Downlight
- ⑫ ●●● Type SC1 - Festoon Light
- ⑬ - Type SS1 - Halo Light (LED Tapelight)
- ⑭ ■ Type WS1 - Large Retail Entry Sconce (Matching PD1, PH2)
- ⑮ ■ Type WS2 - Decorative Sconce
- ⑯ ● Type WS3 - Building Entry Sconce
- ⑰ ▲ Type XD1 - Theatrical Floodlight

OVERALL SITE LIGHTING PHOTOMETRIC CALCULATION PLAN

Calculation Summary						
Label	CalcType	Units	Avg	Max	Min	Avg/Min
Copeland Street	Illuminance	Fc	2.39	7.0	0.3	7.97
Courtyard East	Illuminance	Fc	1.47	8.5	0.2	7.35
Courtyard West	Illuminance	Fc	2.12	16.0	0.2	10.60
East D Street	Illuminance	Fc	2.04	4.6	0.3	6.80
Park Dining	Illuminance	Fc	4.86	7.5	2.5	1.94
Park Playground	Illuminance	Fc	4.99	11.6	1.0	4.99
Petaluma Station Alley	Illuminance	Fc	0.90	2.9	0.3	3.00
Site_Overall	Illuminance	Fc	2.50	7.1	0.3	8.33
Washington Street	Illuminance	Fc	1.99	6.1	0.3	6.63

SITE LIGHTING CALCULATION PLAN
Conceptual Lighting Plans

LIGHTING CONSULTANT
LIGHTING DESIGN ALLIANCE
2830 TEMPLE AVE. LONG BEACH, CA 90806-2213, USA
T: 562.989.3843 F: 562.989.3847
www.LightingDesignAlliance.com

LD.7

Scale: 1" = 20.00000176'
Job No. 2017-628
Date 08-21-2020