

SOUTH MCDOWELL BOULEVARD
(PUBLIC R/W WIDTH VARIES)

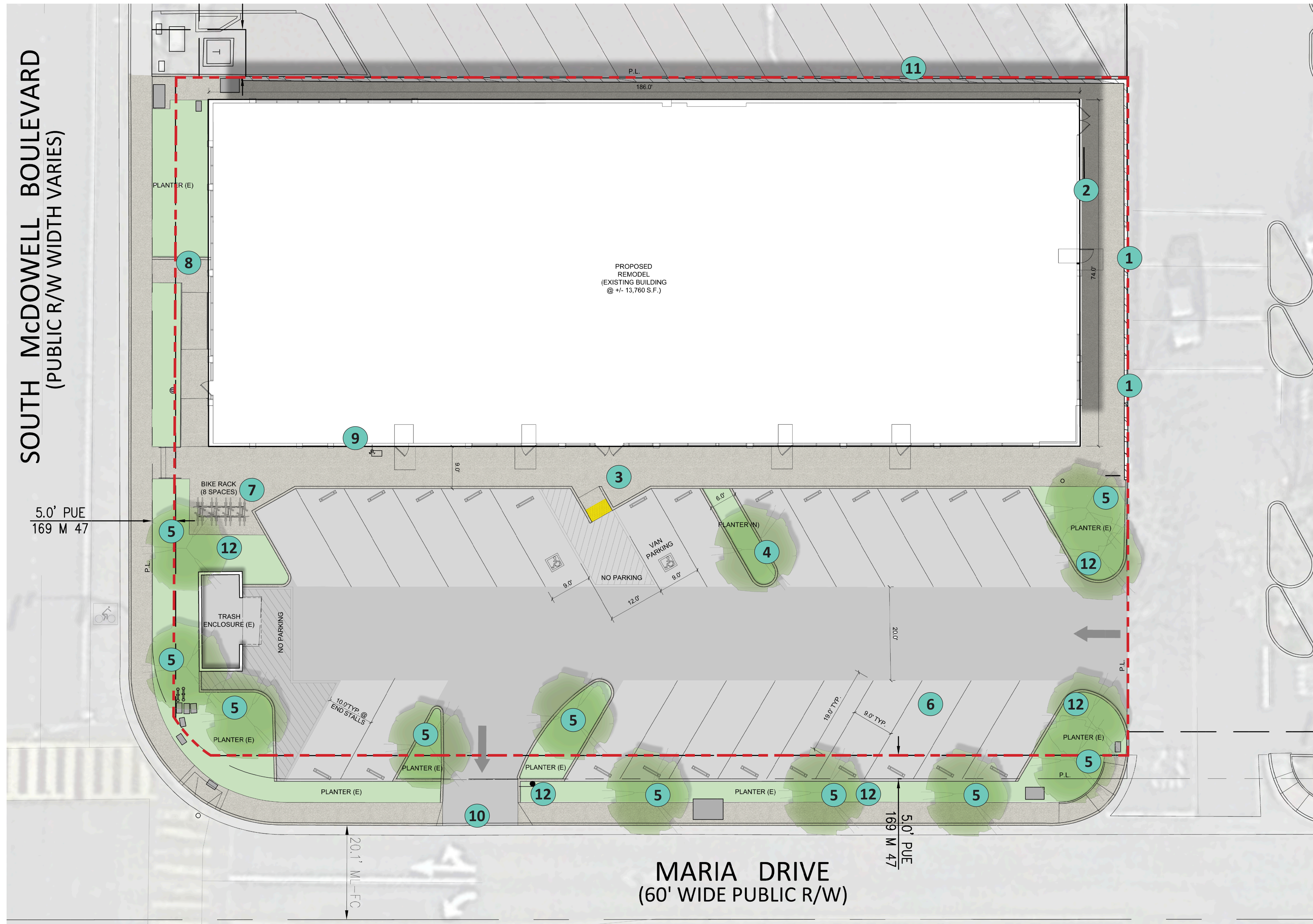

- KEYNOTES**
- 1 REMOVE EXISTING STAIRS AND REPLACE WITH RAILING TO MATCH CURRENT DESIGN
 - 2 GAS METERS (E) TO REMAIN
 - 3 REMOVE/EXPAND EXISTING PATH OF TRAVEL TO COMPLY WITH A.D.A. ACCESSIBILITY REQUIREMENTS
 - 4 NEW 6'-0" WIDE LANDSCAPE STRIP WITH PROPOSED SHADE TREE TO COMPLY WITH SPAR PARKING STANDARDS APPENDIX A
 - 5 EXISTING TREES (TYP.)
 - 6 RE-STRIPE PARKING TO COMPLY WITH SPAR PARKING STANDARDS APPENDIX A. STANDARD 60 DEGREE ANGLED PARKING @ 9'-0" WIDE X 19'-0" DEEP, WITH END STALLS @ 10'-0" WIDE X 19'-0"
 - 7 NEW BIKE PARKING TO COMPLY WITH THE IMPLEMENTING ZONING ORDINANCE CHAPTER 11.090
 - 8 MODIFY/EXTEND LANDING TO COMPLY WITH A.D.A. ACCESSIBILITY REQUIREMENTS
 - 9 HOSE BIB (E)
 - 10 MAINTAIN EXISTING CURB CUTS
 - 11 PROPERTY LINE
 - 12 PARKING LOT LIGHTING (E)

PROPOSED SITE PLAN
SCALE: 1" = 10'-0"

