

# Kenilworth Park Revitalization

## Community Survey Results

---



# Overview

- DIGITAL SURVEY
- OPEN FROM OCT. 19, 2023, TO NOV. 30, 2023
- SHARED VIA:
  - Community Update email (x3)
  - Social posts (x6 - Instagram, Facebook, Nextdoor, and Twitter)
  - QR codes on signs placed at local parks
- 1,012 PEOPLE RESPONDED
- MAJORITY OF RESPONDENTS SUPPORT THE PROPOSED DESIGN

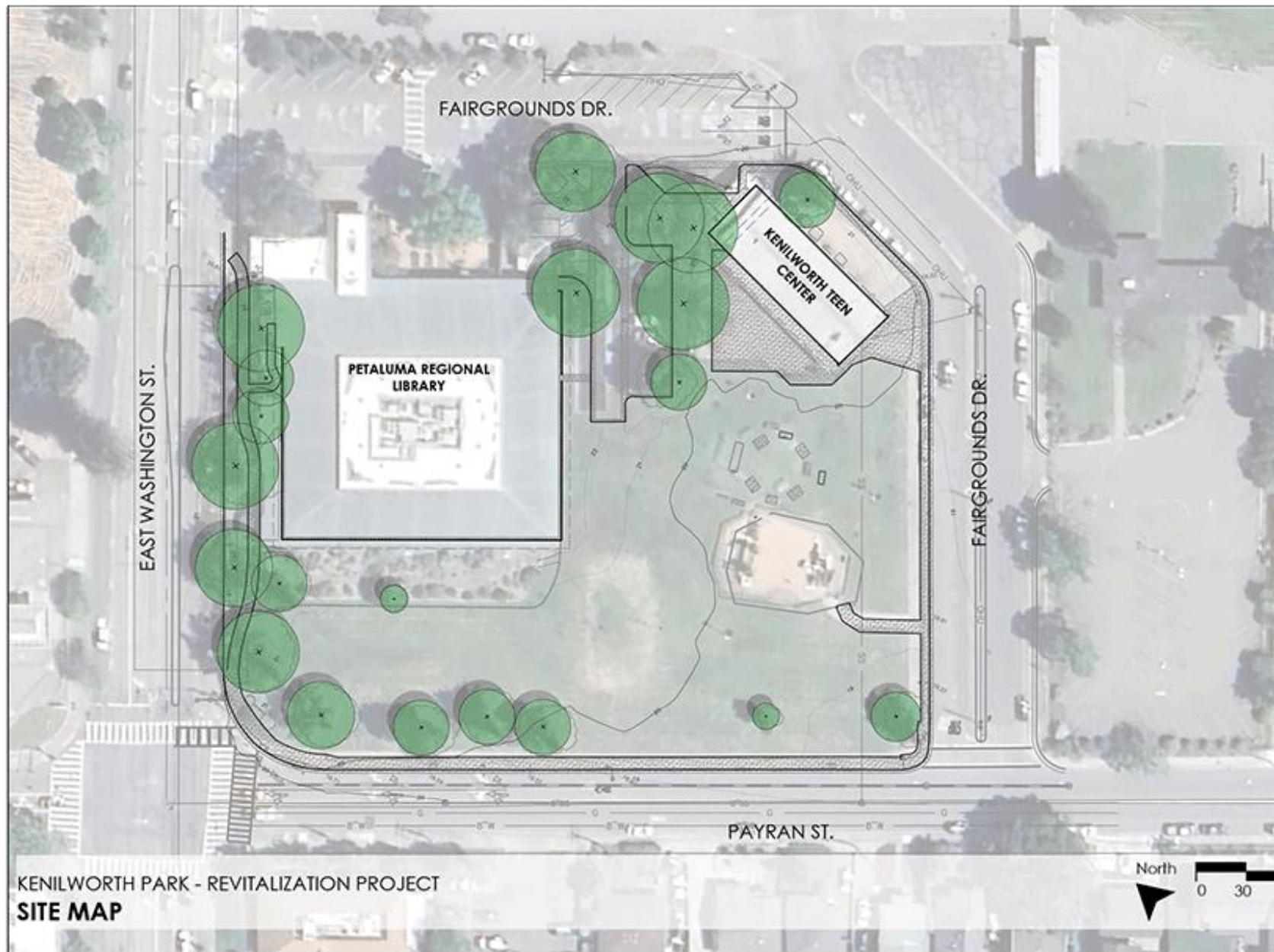

# Key Needs Shared by Survey Respondents

---



Community  
Gatherings



Shade



Active & Physical Play  
Components



Sports Court  
Activities



Natural Play  
Space/Experience  
Nature



Safety

# Q1 Which of the following applies to you? Select all that apply.

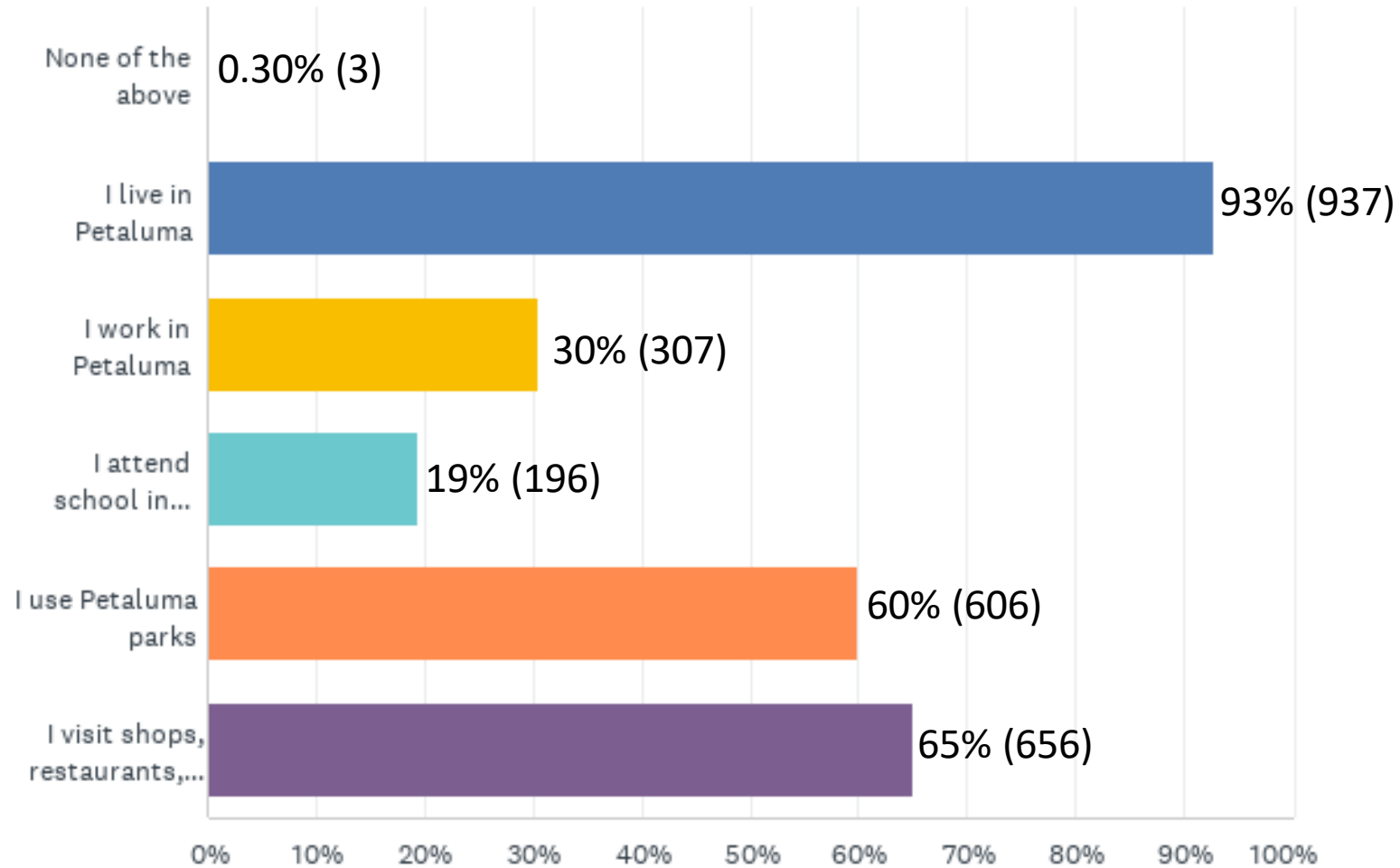

## Q2 What is your age?

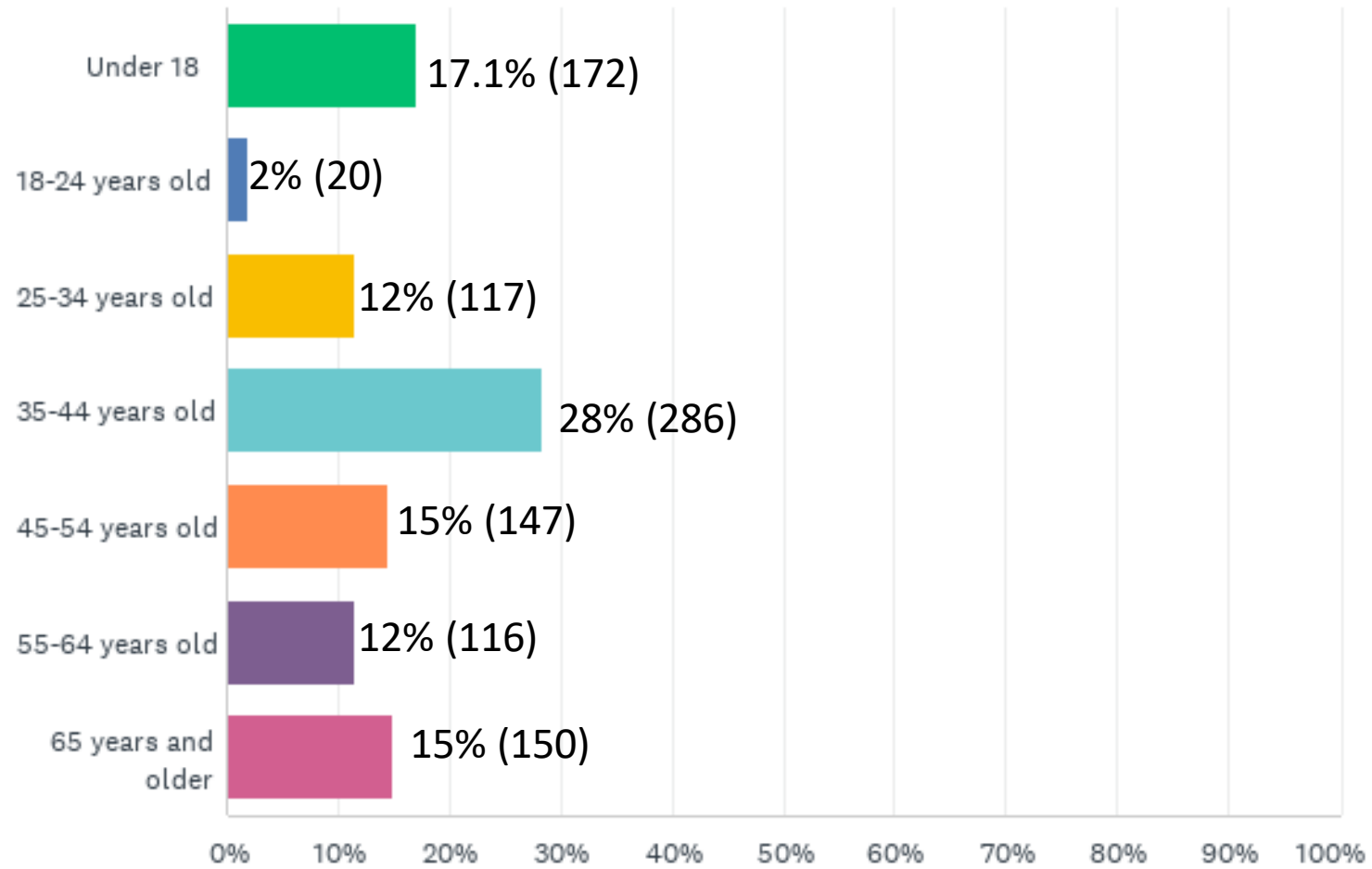

### Q3 How often do you visit Kenilworth Park?

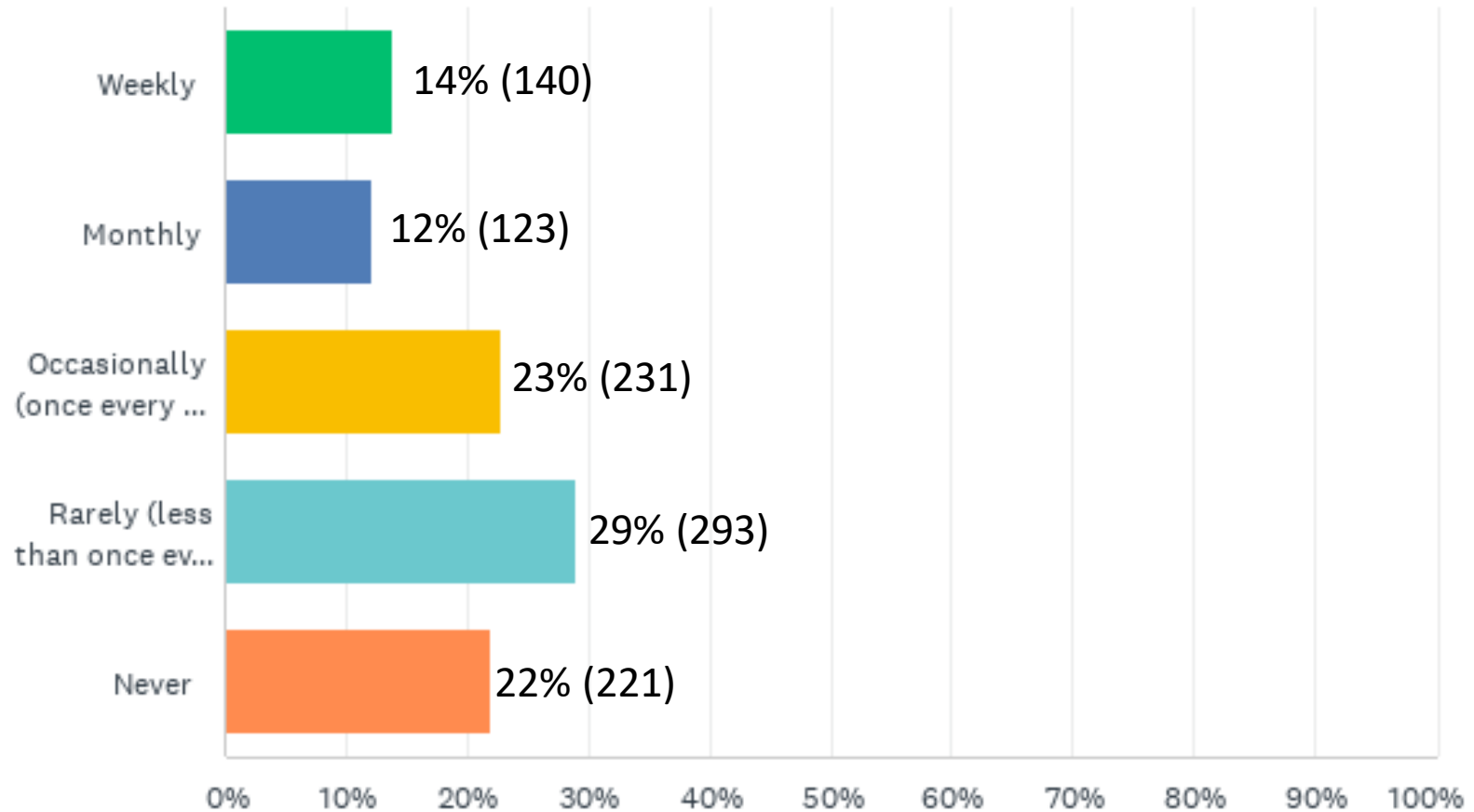

# Q4 How do you or your family get to Kenilworth Park? Select all that apply.

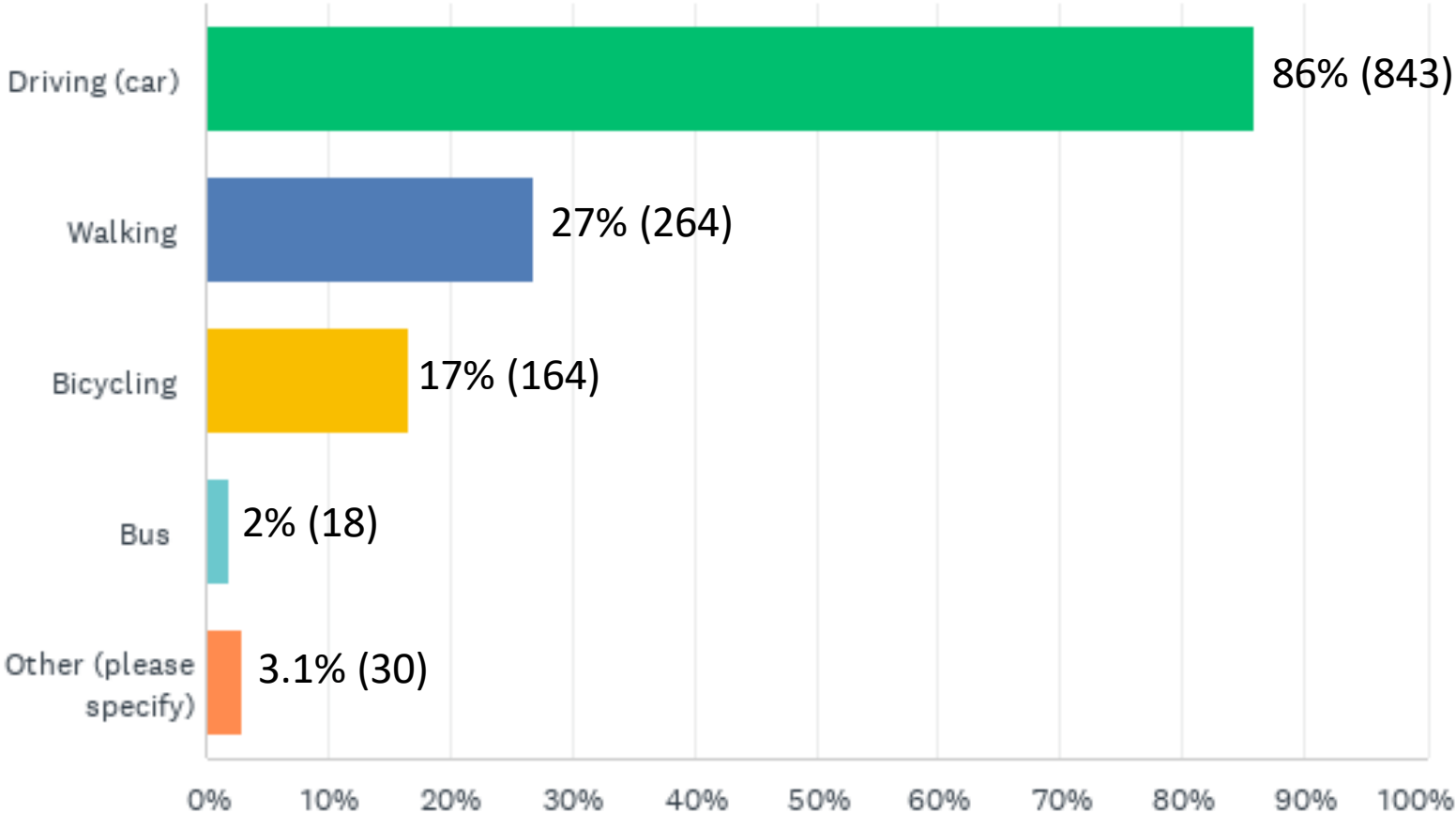

Q 5 Kenilworth Park will feature new spaces for community gathering.  
What type(s) of GATHERING space do you most see yourself using at  
Kenilworth Park? Select your top 3.

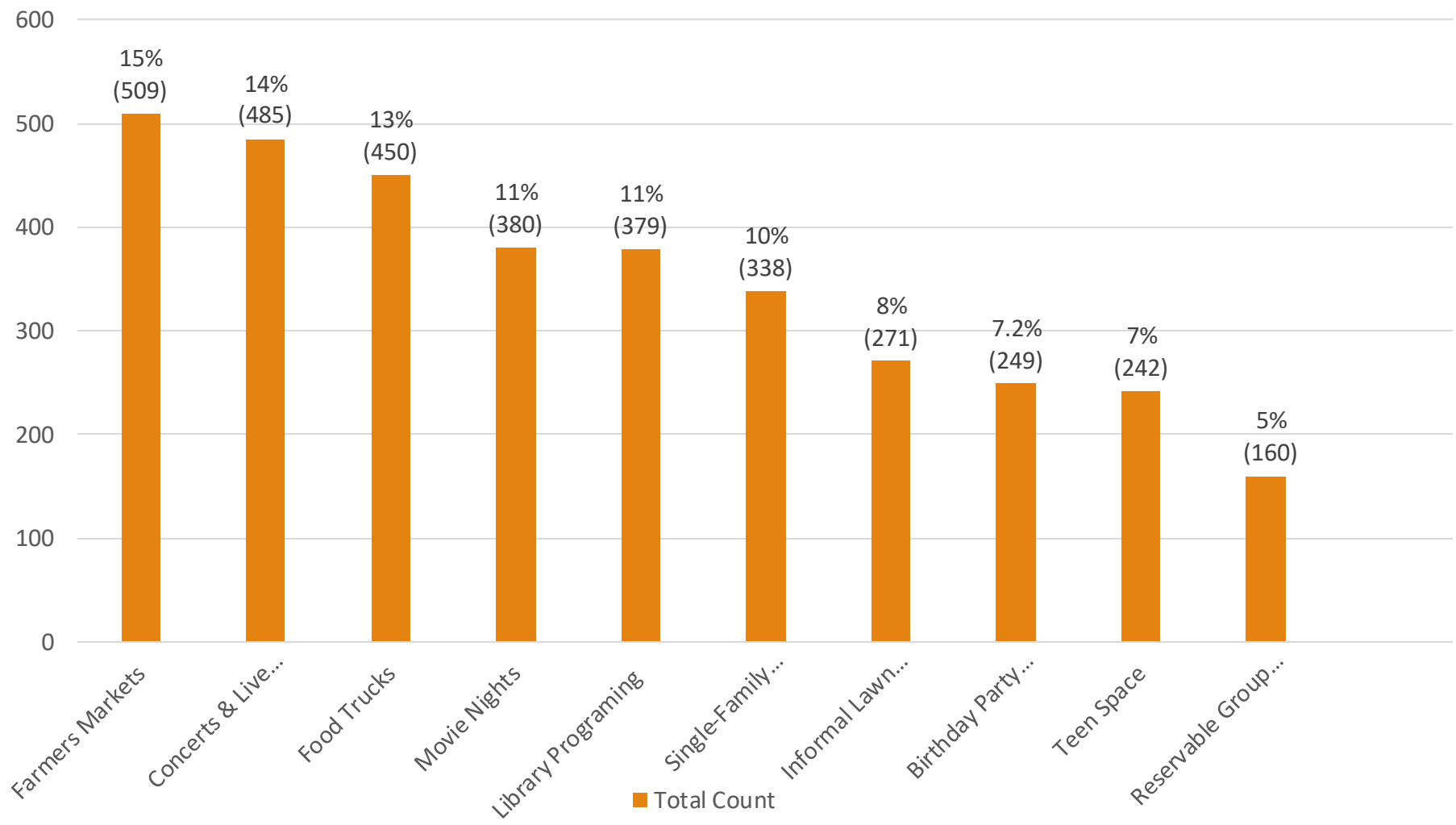



Q6 What other ACTIVE RECREATION elements would you want to see? Select your top 3 active recreation areas proposed at Kenilworth Park.

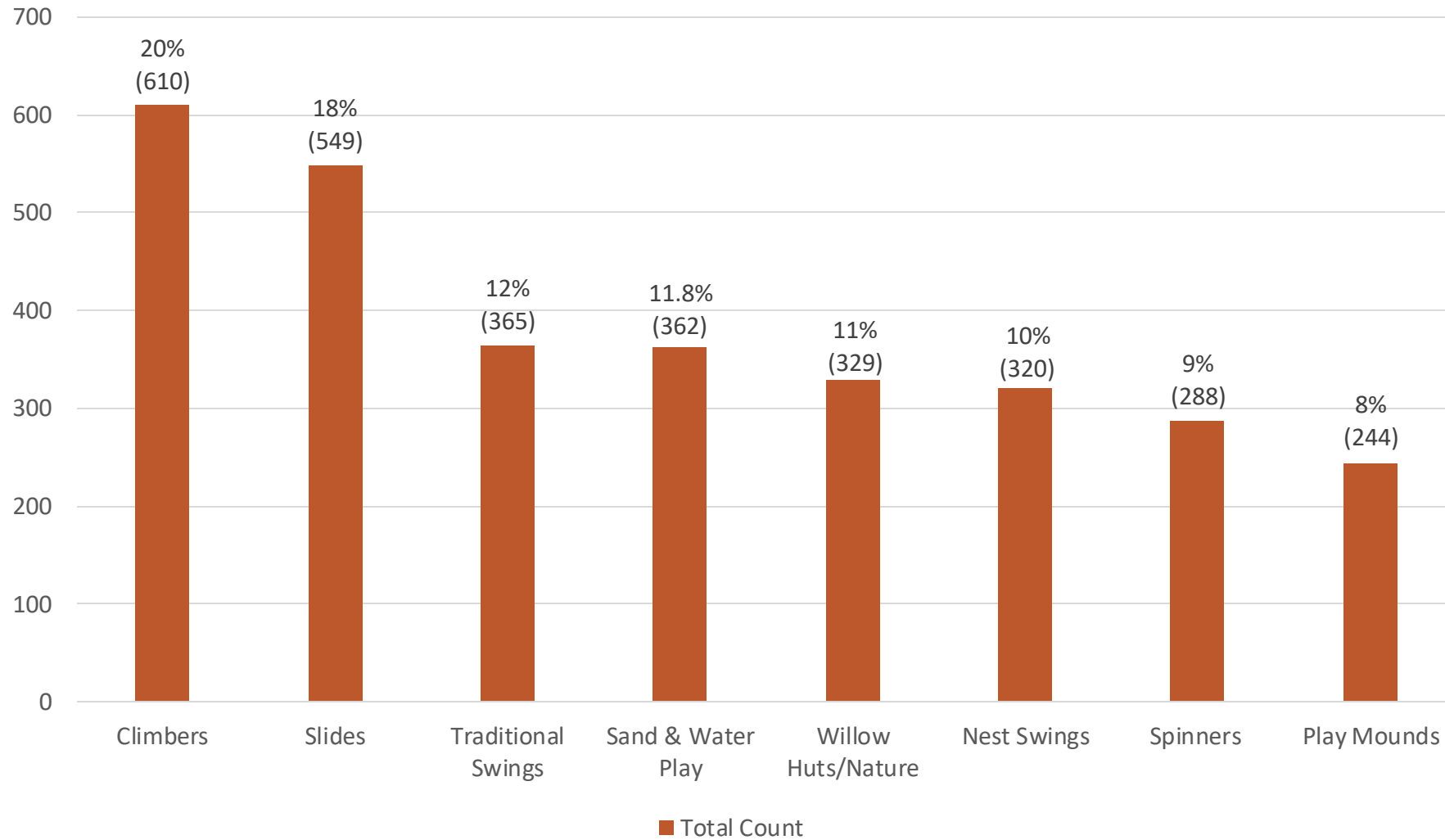

Q 7 A volleyball meadow is proposed in Kenilworth Park's redesign and there may be an opportunity to expand into the adjacent parcel for additional active recreation. What other ACTIVE RECREATION elements would you want to see? Select your top 3

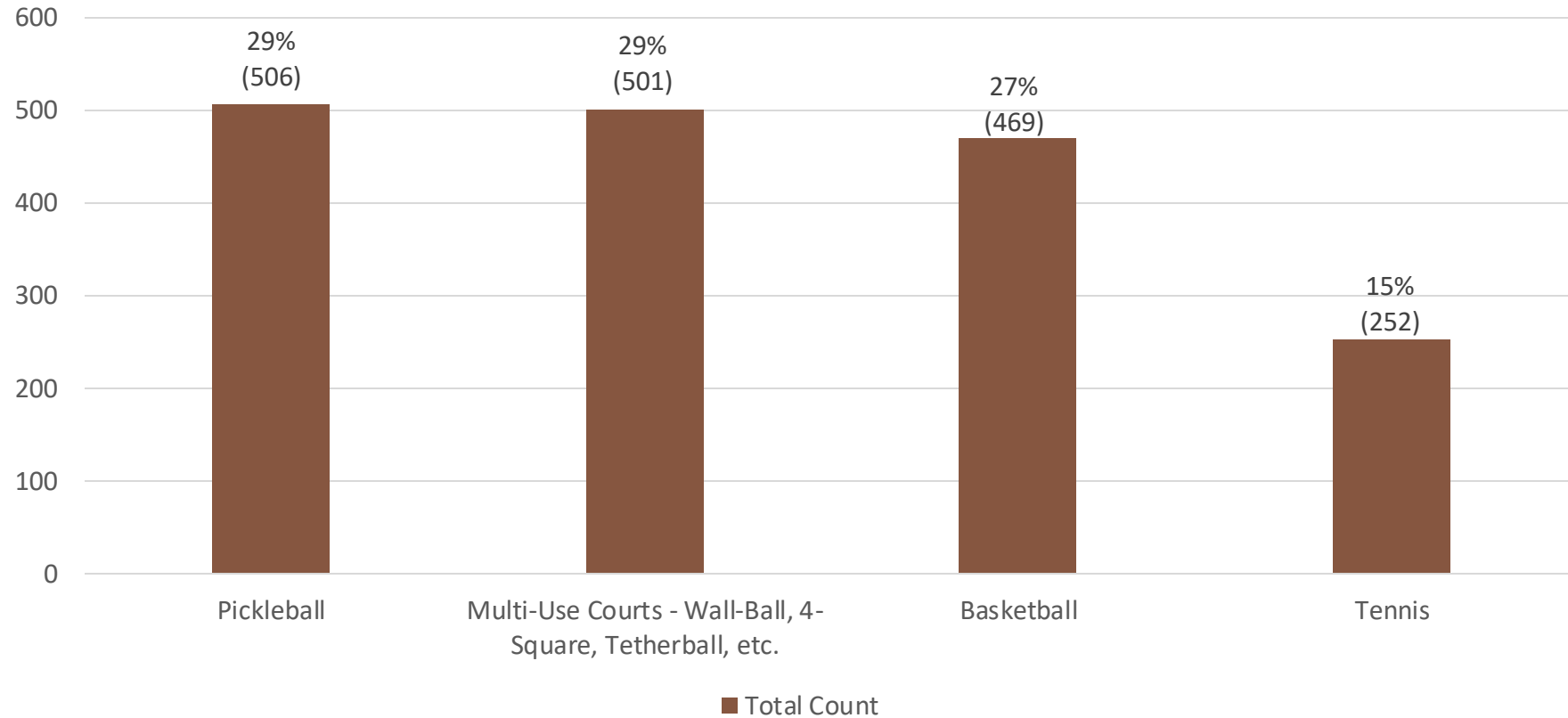

Q8 In terms of CONNECTING TO NATURE, which of the following are the most important to you? Select your top 3 natural connections proposed at Kenilworth Park.

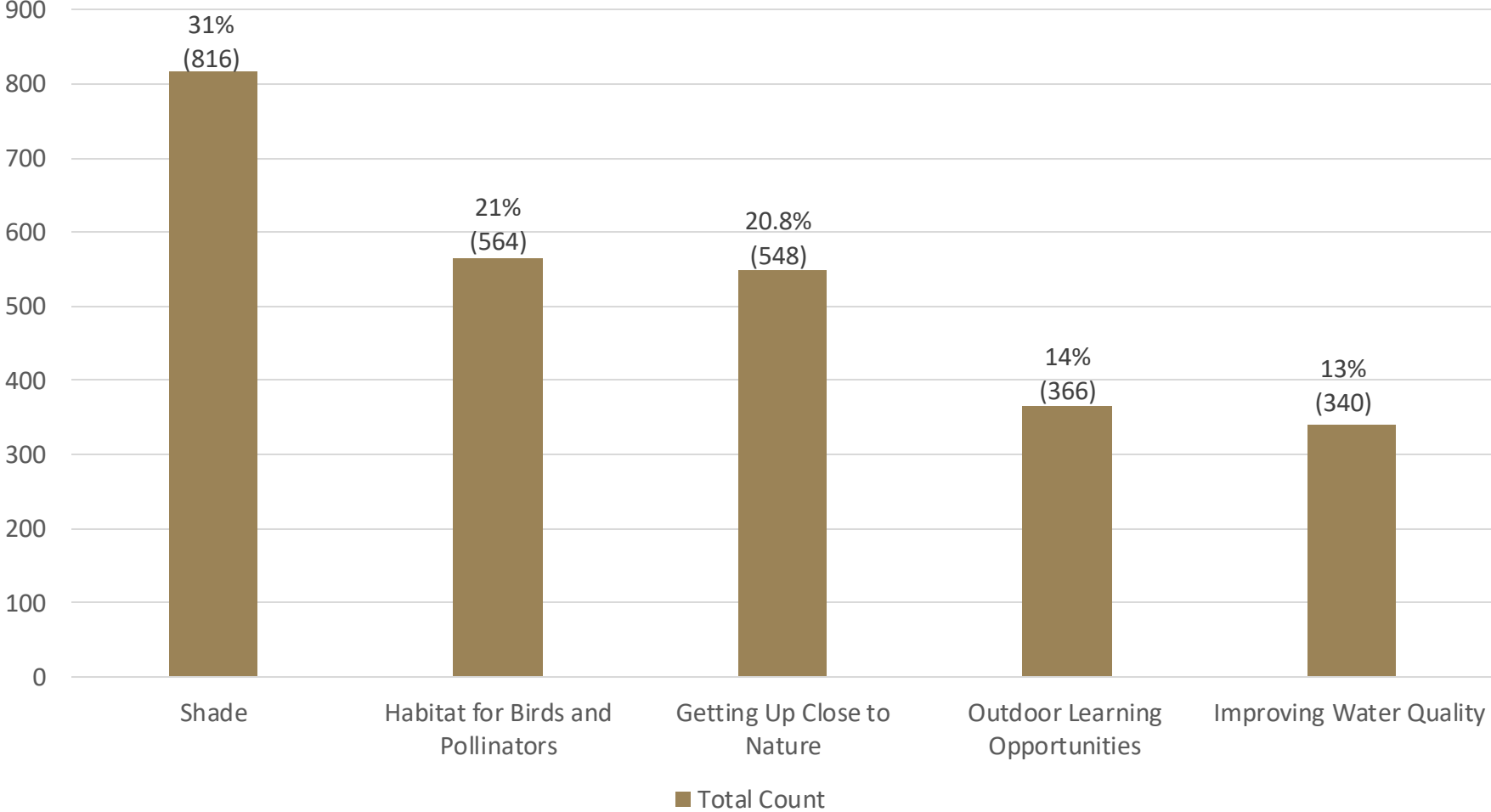

## Q9 Is there anything else you would like to share with us about Kenilworth Park?

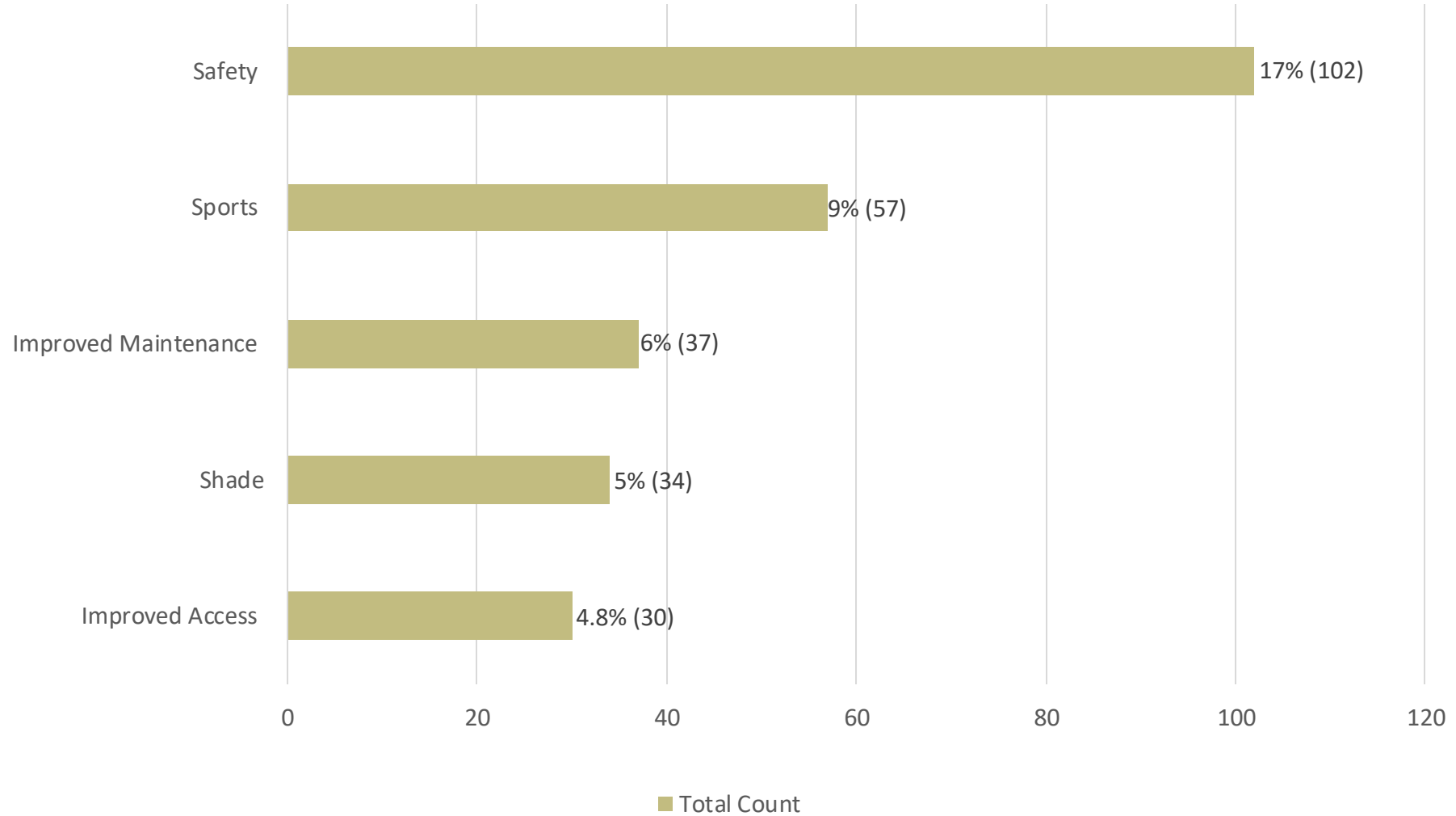



Questions &  
Comments

Thank You!

Visit the link for updates:

<https://cityofpetaluma.org/kenilworthpark/>