

OVERLOOK APARTMENTS PHASE II
 A PORTION OF THE SE 1/4 OF THE SW 1/4 OF SECTION 30, TOWNSHIP 24 NORTH, RANGE 2 EAST W.M.
 CITY OF PORT ORCHARD, KITSAP COUNTY, WASHINGTON

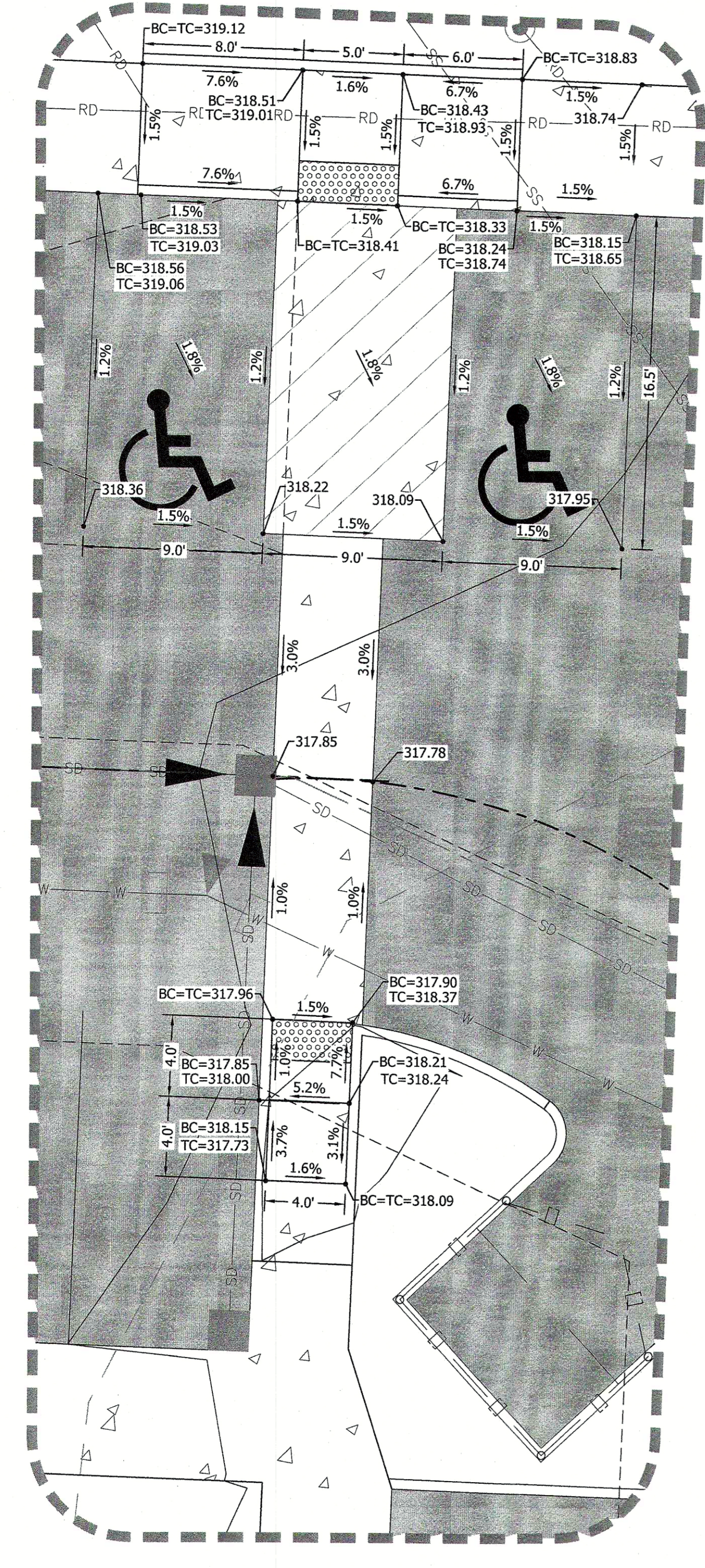

1 BUILDING B SE ADA STALLS, CROSSWALKS AND PEDESTRIAN RAMPS

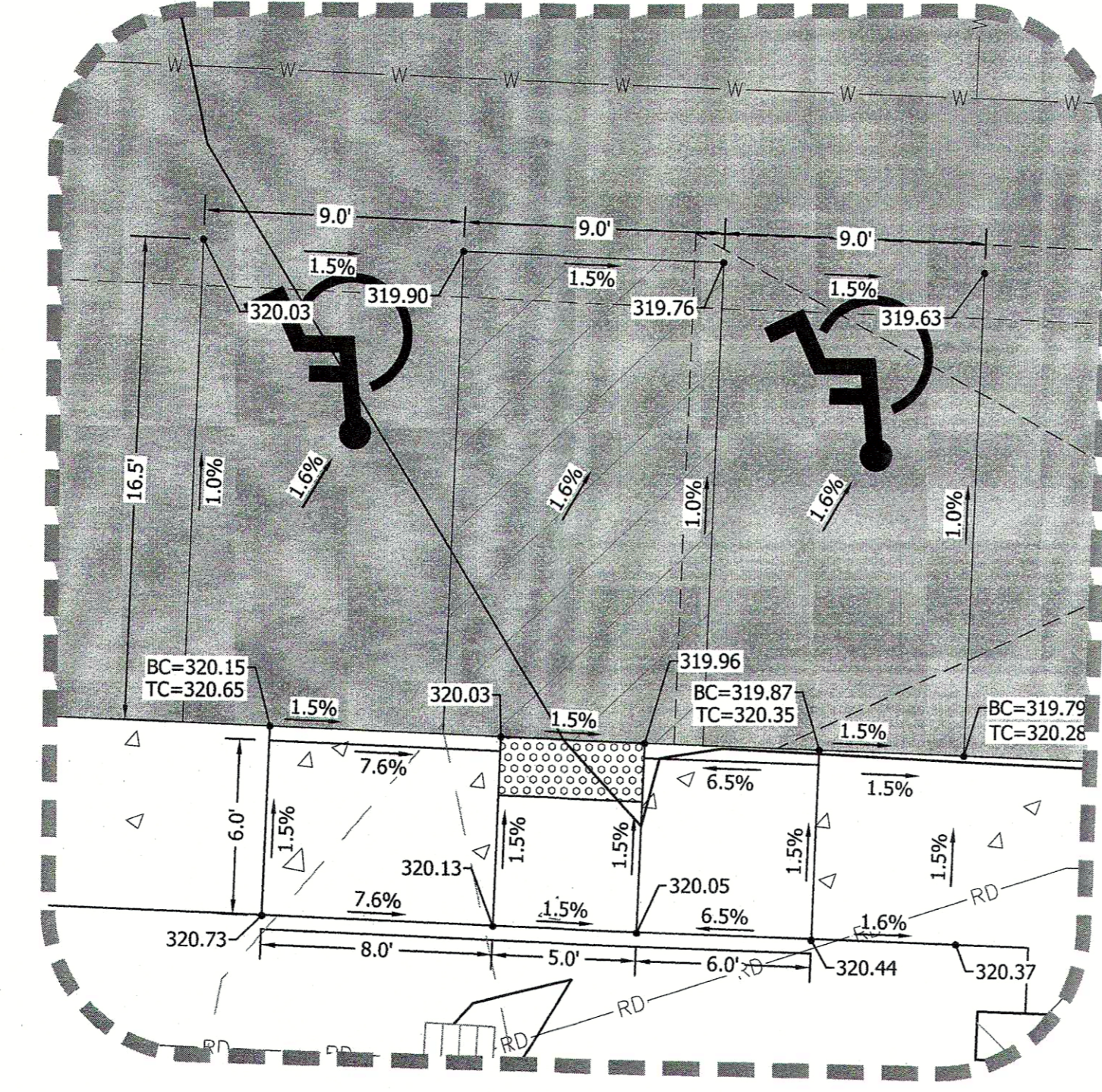

2 BUILDING A EAST ADA STALL AND PEDESTRIAN RAMPS

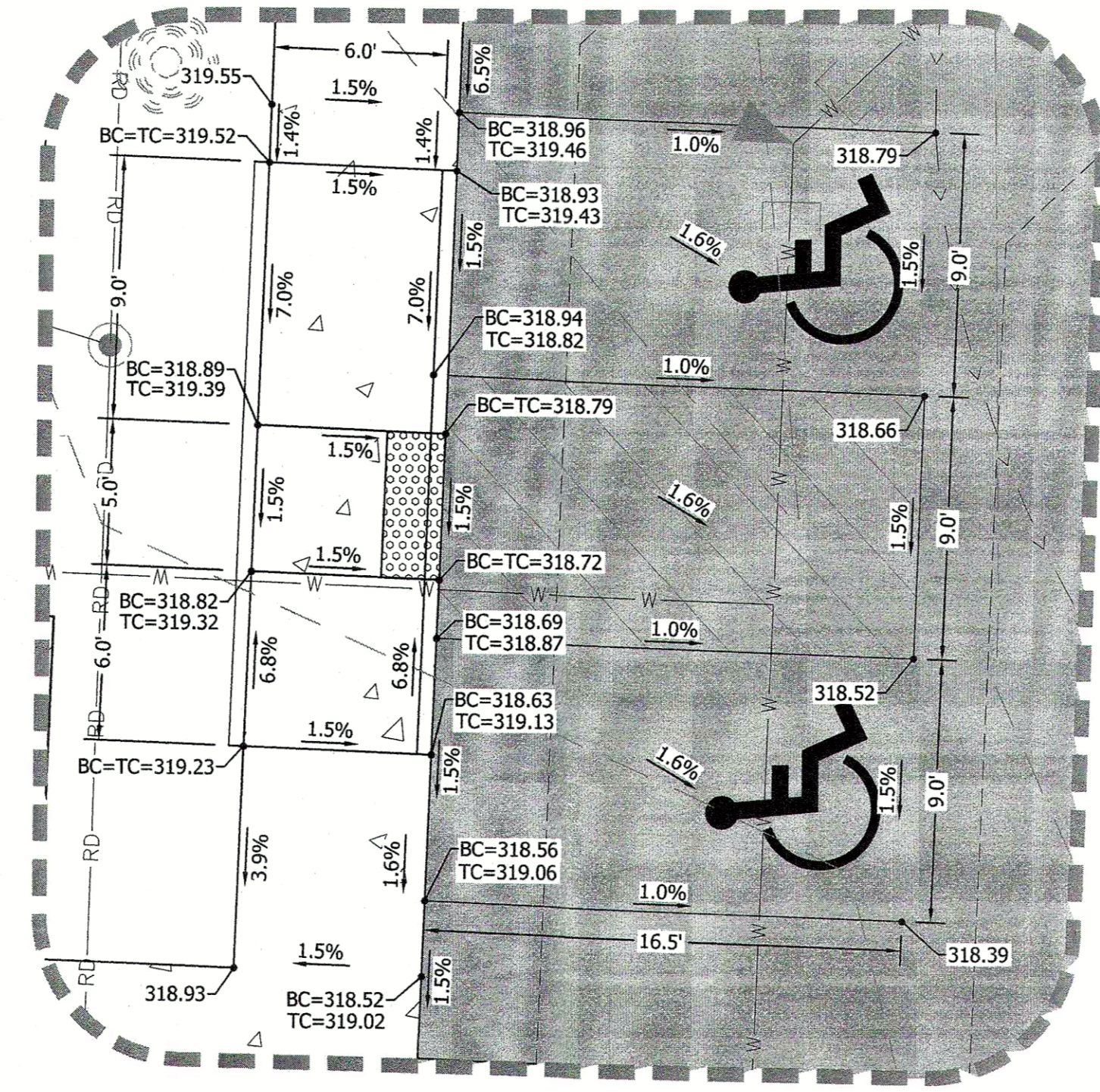

3 BUILDING A EAST ADA STALL AND PEDESTRIAN RAMPS

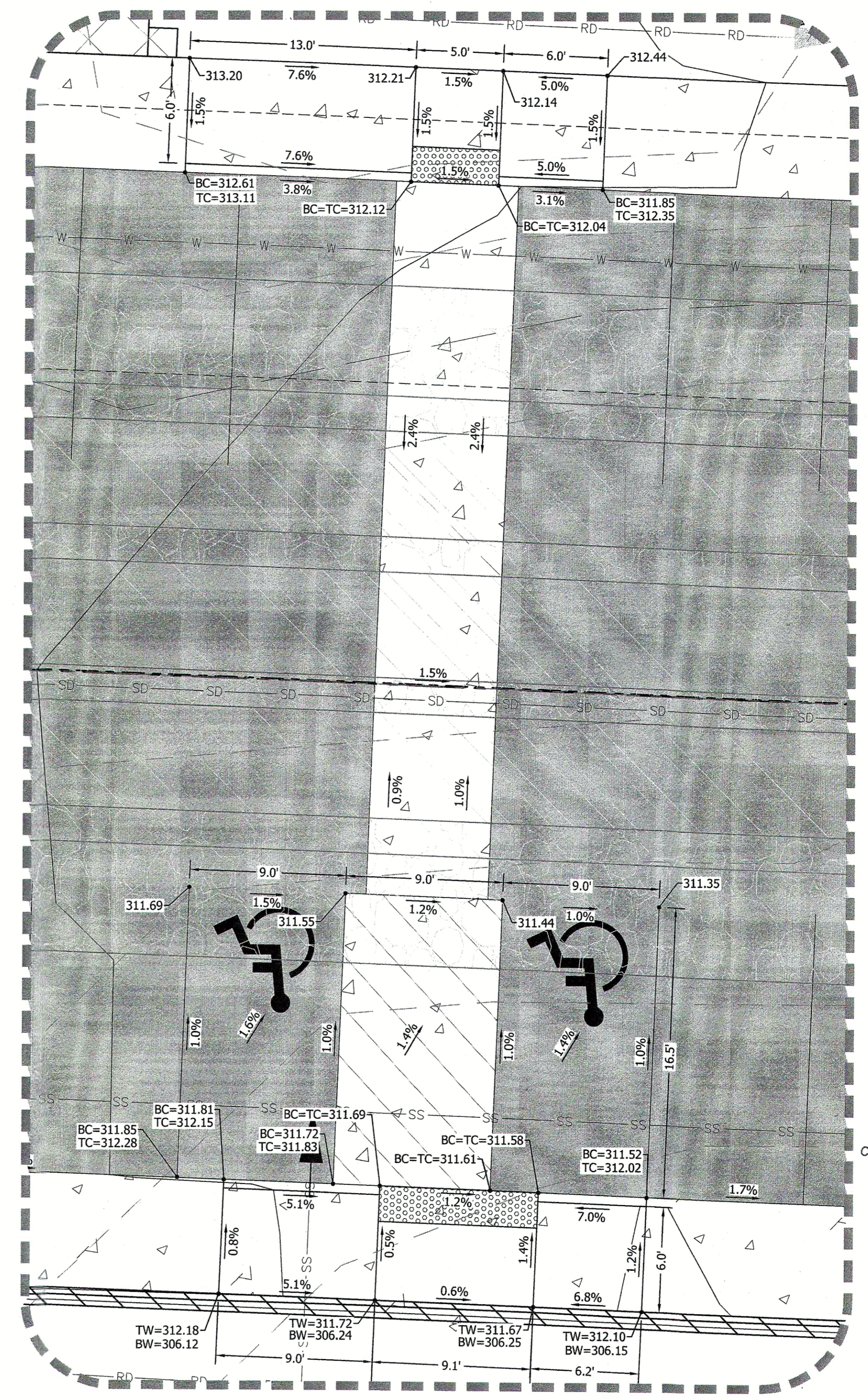

4 BUILDING A WEST ADA STALL AND PEDESTRIAN RAMPS

SIDEWALK & CURBING NOTE

- EXTRUDED CONCRETE CURB (DETAIL 1, SHEET W018) SHALL BE USED WHEN THERE IS NO SIDEWALK PRESENT UNLESS NOTED ON PLAN.
- CEMENT INTEGRAL CURB AND WALK (DETAIL 2, SHEET W018) SHALL BE USED WHEN THERE IS SIDEWALK ADJACENT TO PROPOSED CURBING. FOR ONSITE PRIVATE WORK ONLY, UNLESS SPECIFICALLY NOTED OTHERWISE.
- CEMENT CONCRETE WALK (DETAIL 3, SHEET W015) SHALL BE USED FOR ALL SIDEWALK PROPOSED ON SITE AND WITHIN THE RIGHT-OF-WAY.

CURB AND GUTTER NOTE
 ALL DAMAGED/DEFECTIVE/HAZARDOUS CURB AND GUTTER ALONG THE 1300 BLOCK OF EAST 69TH STREET OR ABUTTING THE SITE SHALL BE REMOVED, AND NEW CEMENT CONCRETE CURB AND GUTTER CONSTRUCTED IN ITS PLACE TO THE APPROVAL OF THE CITY ENGINEER.

GRADING ACRONYMS

BC = BOTTOM OF CURB
 TC = TOP OF CURB
 EG = EXISTING GRADE
 ME = MATCH EXISTING GRADE
 BW = BACK OF WALK
 LP = LOW POINT
 FF = FINISH FLOOR
 FL = FLOW LINE
 HP = HIGH POINT

VERIFICATION NOTE
 ALL EXISTING UTILITIES IN THE CONSTRUCTION AREA SHALL BE IDENTIFIED AND VERIFIED FOR DEPTH AND LOCATION PRIOR TO ANY CONSTRUCTION ACTIVITIES SO TO IDENTIFY ANY POTENTIAL CONFLICTS WITH PROPOSED CONSTRUCTION. CONTACT PROJECT ENGINEER IMMEDIATELY IF ANY CONFLICTS ARE IDENTIFIED.

PRIOR TO ANY CONSTRUCTION ACTIVITIES, VERIFY EXISTING TOPOGRAPHY IS CONSISTENT WITH WHAT IS SHOWN ON PLANS AND IF THERE ARE ANY POTENTIAL CONFLICTS WITH PROPOSED CONSTRUCTION ACTIVITIES. CONTACT PROJECT ENGINEER IMMEDIATELY IF ANY CONFLICTS ARE IDENTIFIED.

CALL 811 AT LEAST 48 HOURS BEFORE YOU DIG

RECEIVED PERMIT CENTER
 FEB 19 2020
 CITY OF PORT ORCHARD COMMUNITY DEVELOPMENT

BY	
DATE	
REVISION	
DESCRIPTION	
 CONTOUR ENGINEERING, L.L.C. CIVIL ENGINEERS~SURVEYORS~LAND PLANNERS 3309 56th Street NW, Suite 106 Gig Harbor, WA 98335 Phone: 253-857-5454 ~ Fax: 253-509-0044 ~ info@contourllc.com	
 KERRY F. ROSE PROFESSIONAL ENGINEER	
SHEET TITLE: ADA GRADING DETAILS 1	PROJECT: OVERLOOK APARTMENTS PHASE II
CLIENT: OLAA, LLC	PHONE: (253) 255-7624
15234 SE 366TH PLACE	
AUBURN, WA 98092	
CONTACT: MARK NORDLE	
DESIGNER: K. ROSE	
ENGINEER: J. HAUG	
DRAWN: B. MORRIS	
S 30 T 24N R 2E WM	
DATE: 2020.02.14	
REVISED:	
PROJECT: 16-300	
DWG NAME: 16-300-C	
SHEET	REV.
C13	
13 OF 42	

OVERLOOK APARTMENTS PHASE II

A PORTION OF THE SE 1/4 OF THE SW 1/4 OF SECTION 30, TOWNSHIP 24 NORTH, RANGE 2 EAST W.M.
CITY OF PORT ORCHARD, KITSAP COUNTY, WASHINGTON

GRAPHIC SCALE

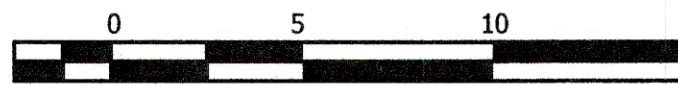

1 INCH = 5 FEET (22"x34")
1 INCH = 10 FEET (11"x17")

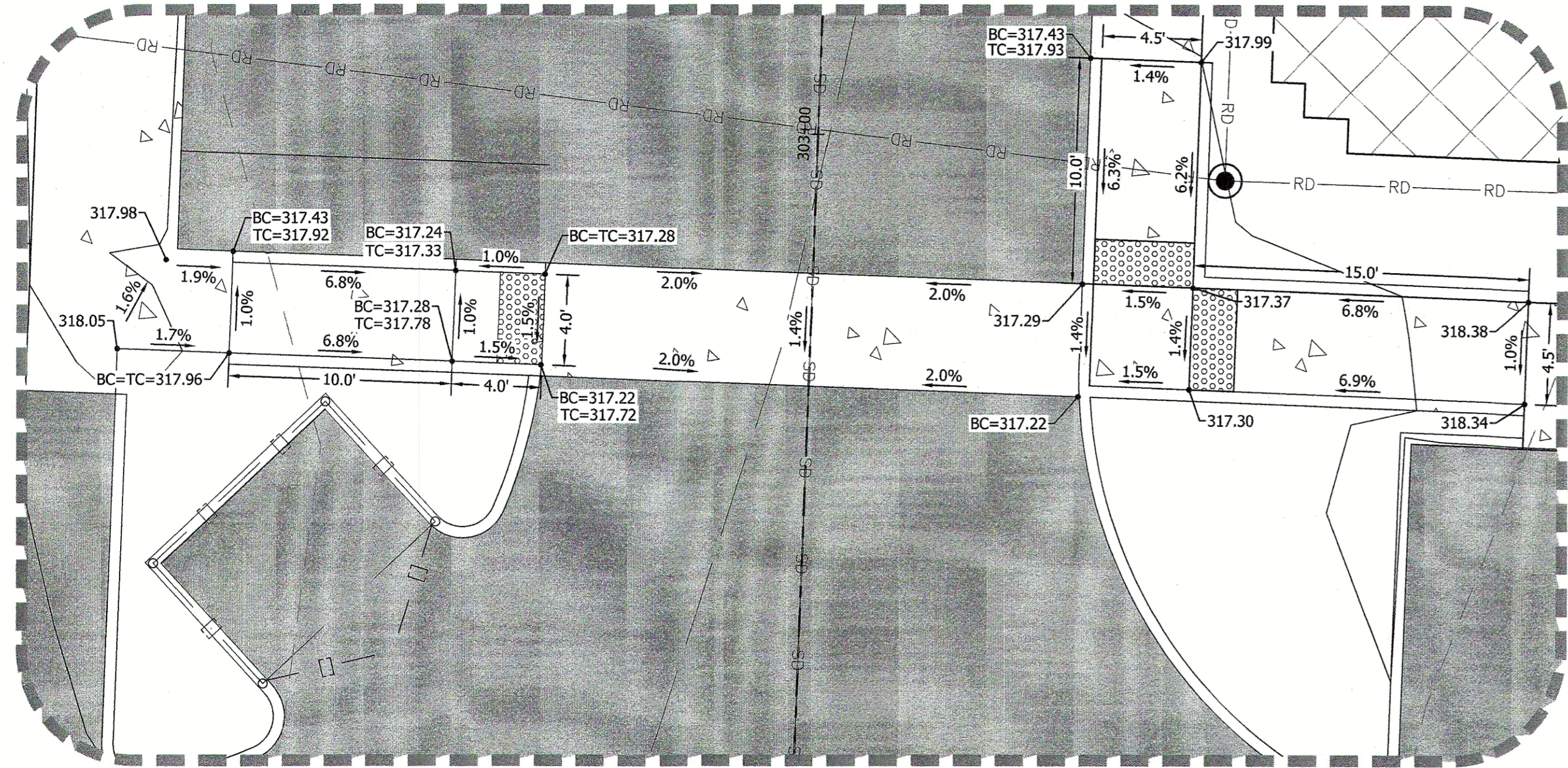

1 BUILDING C SE ADA STALL AND PEDESTRIAN RAMP EAST

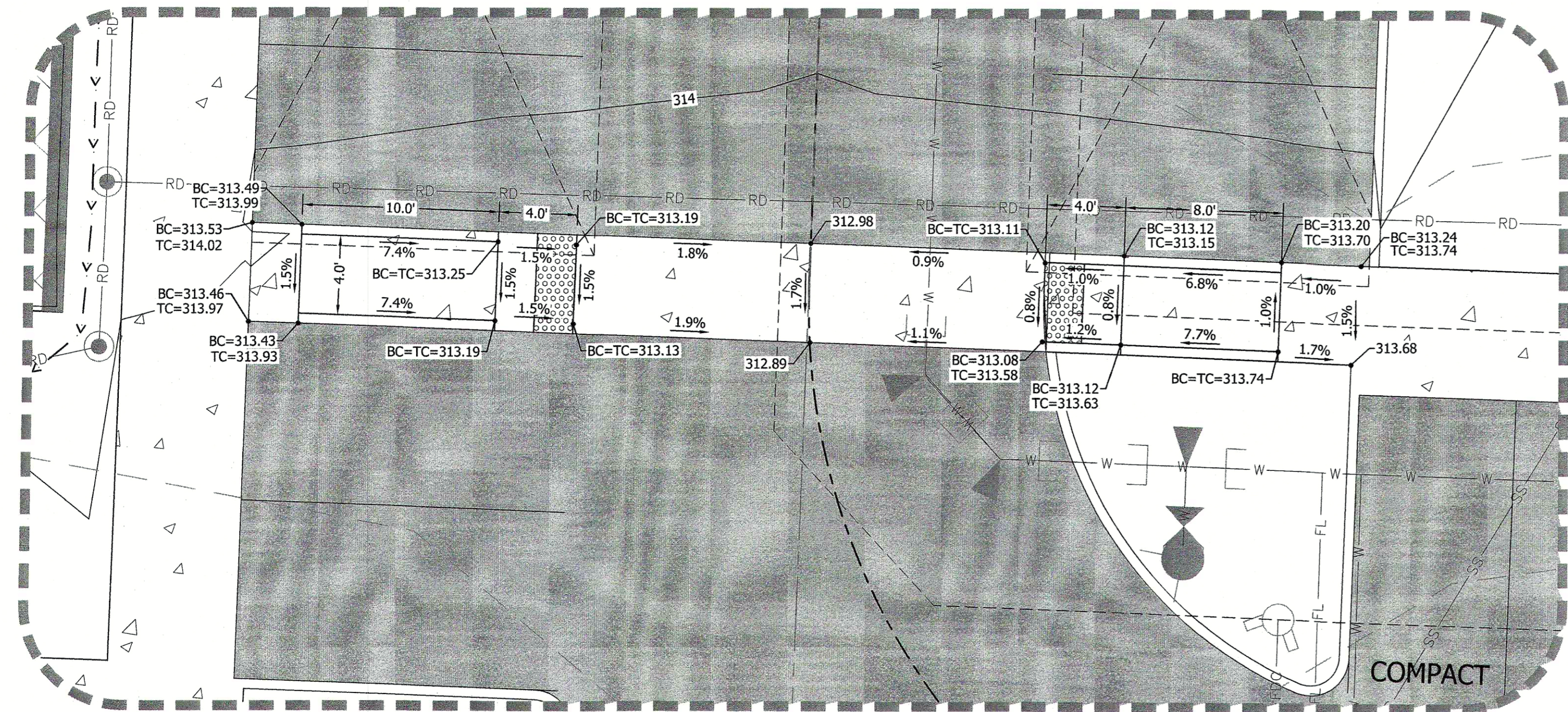

2 BUILDING D SW ADA RAMPS AND CROSSWALK

SIDEWALK & CURBING NOTE

- EXTRUDED CONCRETE CURB (DETAIL 1, SHEET WO18) SHALL BE USED WHEN THERE IS NO SIDEWALK PRESENT UNLESS NOTED ON PLAN.
- CEMENT INTEGRAL CURB AND WALK (DETAIL 2, SHEET WO18) SHALL BE USED WHEN THERE IS SIDEWALK ADJACENT TO PROPOSED CURBING. FOR ON-SITE PRIVATE WORK ONLY, UNLESS SPECIFICALLY NOTED OTHERWISE.
- CEMENT CONCRETE WALK (DETAIL 3, SHEET WO15) SHALL BE USED FOR ALL SIDEWALK PROPOSED ON-SITE AND WITHIN THE RIGHT-OF-WAY.

CURB AND GUTTER NOTE

ALL DAMAGED/DEFECTIVE/HAZARDOUS CURB AND GUTTER ALONG THE 1300 BLOCK OF EAST 69TH STREET OR ABUTTING THE SITE SHALL BE REMOVED, AND NEW CEMENT CONCRETE CURB AND GUTTER CONSTRUCTED IN ITS PLACE TO THE APPROVAL OF THE CITY ENGINEER.

GRADING ACRONYMS

- BC = BOTTOM OF CURB
- TC = TOP OF CURB
- EG = EXISTING GRADE
- ME = MATCH EXISTING GRADE
- BW = BACK OF WALK
- LP = LOW POINT
- FF = FINISH FLOOR
- FL = FLOW LINE
- HP = HIGH POINT

VERIFICATION NOTE

ALL EXISTING UTILITIES IN THE CONSTRUCTION AREA SHALL BE IDENTIFIED AND VERIFIED FOR DEPTH AND LOCATION PRIOR TO ANY CONSTRUCTION ACTIVITIES SO TO IDENTIFY ANY POTENTIAL CONFLICTS WITH PROPOSED CONSTRUCTION. CONTACT PROJECT ENGINEER IMMEDIATELY IF ANY CONFLICTS ARE IDENTIFIED.

PRIOR TO ANY CONSTRUCTION ACTIVITIES, VERIFY EXISTING TOPOGRAPHY IS CONSISTENT WITH WHAT IS SHOWN ON PLANS AND IF THERE ARE ANY POTENTIAL CONFLICTS WITH PROPOSED CONSTRUCTION ACTIVITIES. CONTACT PROJECT ENGINEER IMMEDIATELY IF ANY CONFLICTS ARE IDENTIFIED.

CALL 811 AT LEAST 48 HOURS BEFORE YOU DIG

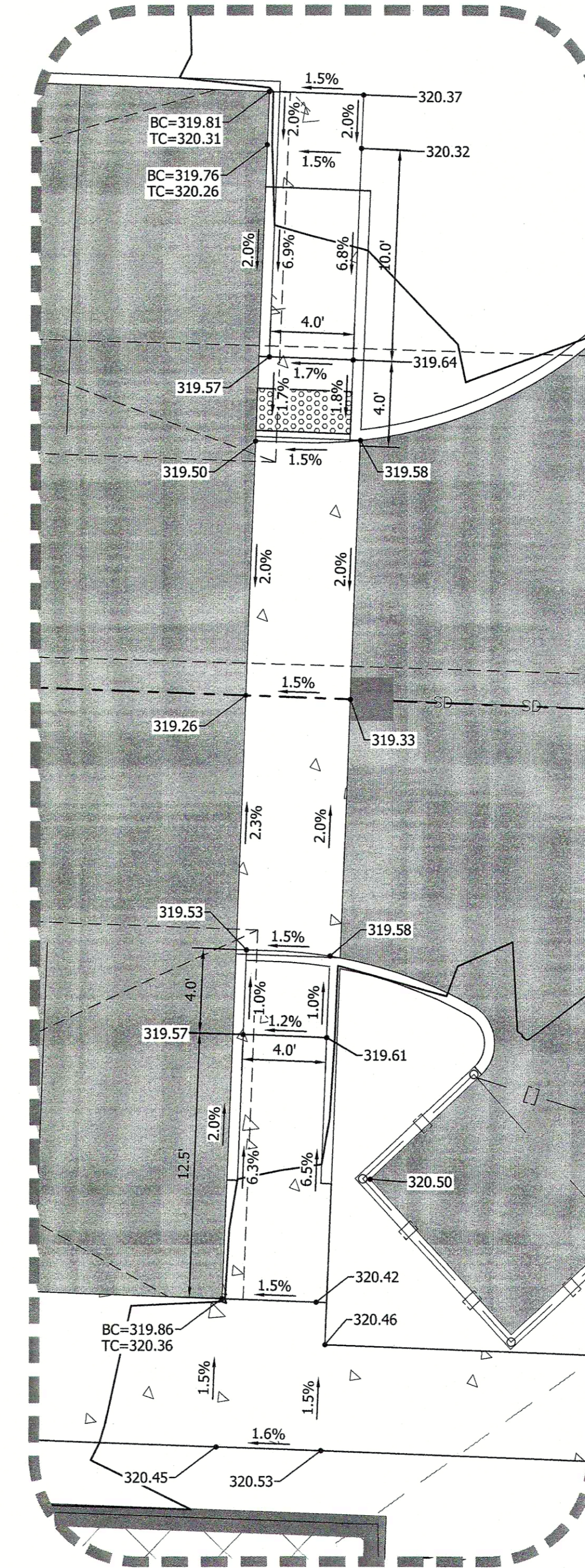

3 BUILDING C SE ADA STALL AND PEDESTRIAN RAMP EAST

RECEIVED
PERMIT CENTER
FEB 19 2020
CITY OF PORT ORCHARD
COMMUNITY DEVELOPMENT

CONTOUR
ENGINEERING • L.L.C.
CIVIL ENGINEERS ~ SURVEYORS ~ LAND PLANNERS
3309 56th Street NW, Suite 106 Gig Harbor, WA 98335
Phone: 253-857-5454 ~ Fax: 253-509-0044 ~ info@contourplc.com

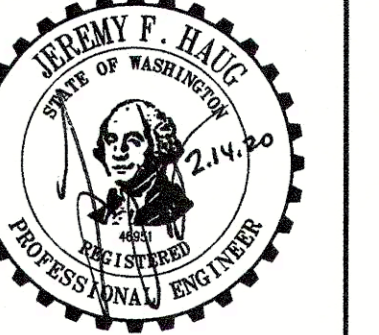

SHEET TITLE: ADA GRADING DETAILS 2

OVERLOOK APARTMENTS PHASE II

CLIENT: OLAA, LLC
13234 SE 366TH PLACE
AUBURN, WA 98092

CONTACT: MARK NORDLIE
PHONE: (253) 255-7624

DESIGNER: K. ROSE
ENGINEER: J. HAUG
DRAWN: B. MORRIS
S 30 T 24N R 2E WM
DATE: 2020.02.14
REVISED:

PROJECT: 16-300
DWG NAME: 16-300-C

SHEET	REV.
C14	
14 OF 42	

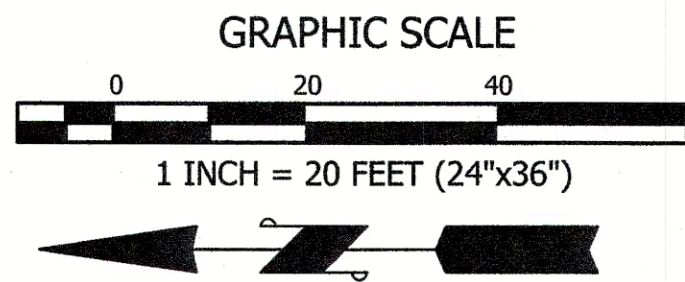

OVERLOOK APARTMENTS PHASE II
 A PORTION OF THE SE 1/4 OF THE SW 1/4 OF SECTION 30, TOWNSHIP 24 NORTH, RANGE 2 EAST W.M.
 CITY OF PORT ORCHARD, KITSAP COUNTY, WASHINGTON

MATCH LINE SEE SHEET C16

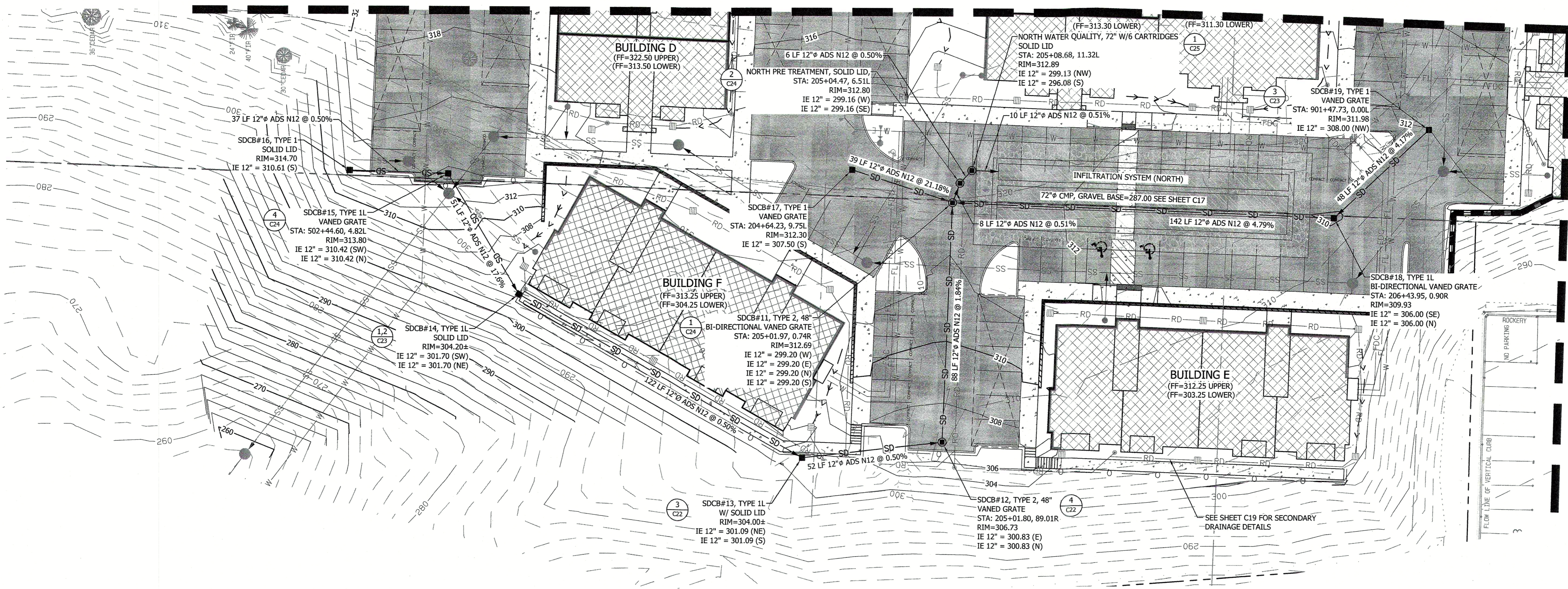

CITY OF PORT ORCHARD STANDARD DRAINAGE NOTES

- ALL STORM PIPE AND APPURTENANCES SHALL BE LAID IN ACCORDANCE WITH CITY OF PORT ORCHARD DESIGN AND CONSTRUCTION STANDARDS. THIS SHALL INCLUDE LEVELING AND COMPACTING THE TRENCH BOTTOM, THE TOP OF THE FOUNDATION MATERIAL AND ANY REQUIRED BEDDING TO A UNIFORM GRADE SO THAT THE ENTIRE DRAINAGE FACILITY IS SUPPORTED BY A UNIFORMLY DENSE UNYIELDING BASE.
- ALL STORM PIPE SHALL BE SUBJECT TO A LOW PRESSURE AIR TEST IN ACCORDANCE WITH WSDOT STANDARD SPECIFICATION 7-04.3(1)F AND A VIDEO INSPECTION IN ACCORDANCE WITH THE PORT ORCHARD DESIGN STANDARDS.
- STORM PIPE COVER, MEASURED FROM THE FINISHED GRADE ELEVATION TO THE TOP OF THE OUTSIDE SURFACE OF THE PIPE, SHALL BE 2 FEET MINIMUM (3 FEET FOR PVC), UNLESS AUTHORIZED BY THE CITY OF PORT ORCHARD CITY ENGINEER UNDER THE FOLLOWING CIRCUMSTANCES: A. UNDER DRAINAGE EASEMENTS, DRIVEWAYS, PARKING STALLS, OR OTHER AREAS SUBJECT TO LIGHT VEHICULAR LOADING, THE PIPE COVER MAY BE REDUCED TO 1 FOOT MINIMUM IF THE COVER IS CONSISTENT WITH THE MANUFACTURER'S RECOMMENDATIONS. B. IN AREAS NOT SUBJECT TO VEHICULAR LOADS, SUCH AS LANDSCAPE PLANTERS AND YARDS, THE PIPE COVER MAY BE REDUCED TO 1 FOOT MINIMUM. C. IF DUCTILE IRON PIPE IS USED, THE PIPE COVER MAY BE REDUCED TO 1 FOOT MINIMUM.
- STEEL PIPE SHALL BE GALVANIZED AND HAVE ASPHALT TREATMENT #1 OR BETTER INSIDE AND OUT (WSDOT STANDARD SPECIFICATION 9-05.4(3)).
- ANY DRAINAGE STRUCTURE, SUCH AS A CATCH BASIN OR A MANHOLE, NOT RECEIVING SURFACE RUNOFF AND NOT LOCATED WITHIN A TRAVELED ROADWAY OR SIDEWALK SHALL HAVE A SOLID LOCKING LID. ANY DRAINAGE STRUCTURE ASSOCIATED WITH A PERMANENT RETENTION/DETENTION FACILITY, NOT RECEIVING SURFACE RUNOFF, SHALL HAVE A SOLID LOCKING LID.
- ALL CATCH BASIN GRATES SHALL CONFORM TO THE 2005 DEPARTMENT OF ECOLOGY STORMWATER MANAGEMENT MANUAL FOR WESTERN WASHINGTON AND THE WSDOT STANDARD PLANS WHEN LOCATED WITHIN THE RIGHT-OF-WAY, AND SHALL INCLUDE A COMBINATION INLET FRAME (OPEN CURB FACE FRAME) WHEN LOCATED IN A SUMP CONDITION OR BEFORE AN INTERSECTION WITH A 4% GRADE OR ABOVE. A HERRINGBONE GRATE MAY BE USED OUTSIDE THE RIGHT-OF-WAY. ALL CATCH BASINS WITHIN THE GUTTER LINE SHALL BE INSTALLED IN ACCORDANCE WITH STANDARD DETAILS AS APPLICABLE. MAXIMUM CATCH BASIN HEIGHT FROM FINISHED GRADE TO PIPE INVERT SHALL BE PER THE APPLICABLE DETAIL.
- FOR ANY CURB GRADE LESS THAN 0.8% (0.0080 FT/FT), INCLUDING CURB RETURNS, A PROFESSIONAL LAND SURVEYOR, CURRENTLY LICENSED IN THE STATE OF WASHINGTON, SHALL VERIFY THAT THE CURB FORMS OR STRING LINES ARE AT THE GRADES NOTED ON THE APPROVED PLANS PRIOR TO PLACEMENT OF CONCRETE. THE CONTRACTOR IS RESPONSIBLE FOR SURVEY COORDINATION AND COSTS.
- FOR ANY DRAINAGE PIPE GRADE LESS THAN 0.5% (0.0050 FT/FT), A PROFESSIONAL LAND SURVEYOR, CURRENTLY LICENSED IN THE STATE OF WASHINGTON, SHALL VERIFY THAT THE AS-BUILT PIPE MATCHES THE GRADES NOTED ON THE APPROVED PLANS PRIOR TO COMPLETION OF SUBGRADE. THE CONTRACTOR IS RESPONSIBLE FOR SURVEY COORDINATION AND COSTS.
- ALL DRIVEWAY CULVERTS LOCATED WITHIN THE CITY OF PORT ORCHARD RIGHT-OF-WAY SHALL BE OF SUFFICIENT LENGTH TO PROVIDE A MINIMUM 3:1 SLOPE FROM THE EDGE OF THE DRIVEWAY TO THE BOTTOM OF THE DITCH. CULVERTS SHALL HAVE BEVELED END SECTIONS TO MATCH THE SIDE SLOPE.
- ROCK FOR EROSION PROTECTION OF DITCHES, WHERE REQUIRED, MUST BE OF SOUND QUARRY ROCK, PLACED TO A DEPTH OF ONE FOOT (1'), AND MUST MEET THE FOLLOWING SPECIFICATIONS: 100% MUST PASS THE 8" SIEVE, 40% MAXIMUM CAN PASS THE 3" SIEVE AND 10% MAXIMUM CAN PASS THE 3/4" SIEVE.
- DRAINAGE OUTLETS (STUB-OUTS) SHALL BE PROVIDED FOR EACH INDIVIDUAL LOT, EXCEPT FOR THOSE LOTS APPROVED FOR INFILTRATION BY THE CITY OF PORT ORCHARD. STUB-OUTS SHALL CONFORM TO THE FOLLOWING:
 - EACH OUTLET SHALL BE SUITABLY LOCATED AT THE LOWEST ELEVATION ON THE LOT TO SERVICE ALL FUTURE ROOF DOWNSPOUTS AND FOOTING DRAINS, DRIVEWAYS, YARD DRAINS, AND ANY OTHER SURFACE OR SUBSURFACE DRAINS NECESSARY TO RENDER THE LOTS SUITABLE FOR THEIR INTENDED USE. EACH OUTLET SHALL HAVE FREE-FLOWING, POSITIVE DRAINAGE TO AN APPROVED STORMWATER CONVEYANCE SYSTEM OR TO AN APPROVED OUTFALL LOCATION.
 - OUTLETS ON EACH LOT SHALL BE LOCATED WITH A FIVE-FOOT-HIGH, 2" X 4" STAKE MARKED "STORM" OR "DRAIN". THE STUB-OUT SHALL EXTEND ABOVE SURFACE LEVEL, BE VISIBLE, AND BE SECURED TO THE STAKE.
 - PIPE MATERIAL SHALL BE IN ACCORDANCE WITH PORT ORCHARD DESIGN STANDARDS. IF NONMETALLIC, THE PIPE SHALL CONTAIN A WIRE OR USE OTHER ACCEPTABLE MEANS OF DETECTION.
 - DRAINAGE EASEMENTS ARE REQUIRED FOR DRAINAGE SYSTEMS DESIGNED TO CONVEY FLOWS THROUGH INDIVIDUAL LOTS.
 - THE APPLICANT/CONTRACTOR IS RESPONSIBLE FOR COORDINATING THE LOCATIONS OF ALL STUB-OUT CONVEYANCE LINES WITH RESPECT TO OTHER UTILITIES (E.G., POWER, GAS, TELEPHONE, TELEVISION, ETC.).
 - ALL INDIVIDUAL STUB-OUTS SHALL BE PRIVATELY OWNED AND MAINTAINED BY THE LOT HOMEOWNER.

STORM DRAINAGE NOTES

- STORM DRAINAGE CONVEYANCE SHALL BE INSTALLED PER CITY STANDARDS AND PER CITY SPECIFICATIONS.
- ALL STORM DRAIN MAINS SHALL BE A MINIMUM 12" HAVING A MINIMUM SLOPE OF 0.50% UNLESS OTHERWISE SPECIFIED ON PLANS OR APPROVED BY THE CITY.
- PIPE SHALL HAVE A MINIMUM COVER OF 1.0' IN NON-TRAFFIC BEARING AREAS AND 2.0' IN TRAFFIC BEARING AREAS UNLESS OTHERWISE SPECIFIED ON PLANS.
- PIPE SHALL BE ADS N-12 OR APPROVED EQUIVALENT UNLESS COVER IS LESS THAN 2.0' IN TRAFFIC BEARING AREAS. IN THIS CASE, DUCTILE IRON PIPE OR APPROVED EQUIVALENT SHALL BE USED PER ALLOWED CITY STANDARDS.
- SEE DETAIL 5 ON SHEET C22 FOR PIPE BEDDING REQUIREMENTS.

RECEIVED
 PERMIT CENTER
 FEB 19 2020
 CITY OF PORT ORCHARD
 COMMUNITY DEVELOPMENT

VERIFICATION NOTE
 ALL EXISTING UTILITIES IN THE CONSTRUCTION AREA SHALL BE IDENTIFIED AND VERIFIED FOR DEPTH AND LOCATION PRIOR TO ANY CONSTRUCTION ACTIVITIES SO TO IDENTIFY ANY POTENTIAL CONFLICTS WITH PROPOSED CONSTRUCTION. CONTACT PROJECT ENGINEER IMMEDIATELY IF ANY CONFLICTS ARE IDENTIFIED.
 PRIOR TO ANY CONSTRUCTION ACTIVITIES VERIFY EXISTING TOPOGRAPHY IS CONSISTENT WITH WHAT IS SHOWN ON PLANS AND IF THERE ARE ANY POTENTIAL CONFLICTS WITH PROPOSED CONSTRUCTION ACTIVITIES, CONTACT PROJECT ENGINEER IMMEDIATELY IF ANY CONFLICTS ARE IDENTIFIED.

CALL 811 AT LEAST 48 HOURS BEFORE YOU DIG

BY	
DATE	
REVISION	
DESCRIPTION	

CONTOUR
 ENGINEERS & SURVEYORS - LAND PLANNERS
 CIVIL ENGINEERS - SURVEYORS - LAND PLANNERS
 3309 56th Street NW, Suite 106 Gig Harbor, WA 98335
 Phone: 253-857-5454 ~ Fax: 253-509-0044 ~ info@contourplc.com

JOSEPH F. HAUG
 STATE OF WASHINGTON
 PROFESSIONAL ENGINEER
 21472

SHEET TITLE: DRAINAGE PLAN 1 (NORTH)
 OVERLOOK APARTMENTS PHASE II
 CLIENT: OLAA, LLC
 15234 SE 366TH PLACE
 AUBURN, WA 98092
 CONTACT: MARK NORDLIE
 PHONE: (253) 255-7624

DESIGNER: K. ROSE
 ENGINEER: J. HAUG
 DRAWN: B. MORRIS
 S 30 T 24N R 2E WM
 DATE: 2020.02.14
 REVISED:
 PROJECT: 16-300
 DWG NAME: 16-300-C

SHEET	REV.
C15	
15 OF 42	

GRAPHIC SCALE

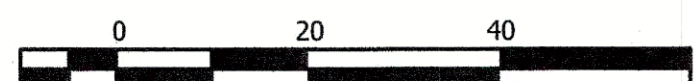

1 INCH = 20 FEET (24"x36")



OVERLOOK APARTMENTS PHASE II
A PORTION OF THE SE 1/4 OF THE SW 1/4 OF SECTION 30, TOWNSHIP 24 NORTH, RANGE 2 EAST W.M.
CITY OF PORT ORCHARD, KITSAP COUNTY, WASHINGTON



MATCH SEE SHEET C15

STORM DRAINAGE NOTES

- STORM DRAINAGE CONVEYANCE SHALL BE INSTALLED PER CITY STANDARDS AND PER CITY SPECIFICATIONS.
- ALL STORM DRAIN MAINS SHALL BE A MINIMUM 12" HAVING A MINIMUM SLOPE OF 0.50% UNLESS OTHERWISE SPECIFIED ON PLANS OR APPROVED BY THE CITY.
- PIPE SHALL HAVE A MINIMUM COVER OF 1.0' IN NON-TRAFFIC BEARING AREAS AND 2.0' IN TRAFFIC BEARING AREAS UNLESS OTHERWISE SPECIFIED ON PLANS.
- PIPE SHALL BE ADS N-12 OR APPROVED EQUIVALENT UNLESS COVER IS LESS THAN 2.0' IN TRAFFIC BEARING AREAS. IN THIS CASE, DUCTILE IRON PIPE OR APPROVED EQUIVALENT SHALL BE USED PER ALLOWED CITY STANDARDS.
- SEE DETAIL 5 ON SHEET C22 FOR PIPE BEDDING REQUIREMENTS.

VERIFICATION NOTE

ALL EXISTING UTILITIES IN THE CONSTRUCTION AREA SHALL BE IDENTIFIED AND VERIFIED FOR DEPTH AND LOCATION PRIOR TO ANY CONSTRUCTION ACTIVITIES SO TO IDENTIFY ANY POTENTIAL CONFLICTS WITH PROPOSED CONSTRUCTION. CONTACT PROJECT ENGINEER IMMEDIATELY IF ANY CONFLICTS ARE IDENTIFIED.

PRIOR TO ANY CONSTRUCTION ACTIVITIES, VERIFY EXISTING TOPOGRAPHY IS CONSISTENT WITH WHAT IS SHOWN ON PLANS AND IF THERE ARE ANY POTENTIAL CONFLICTS WITH PROPOSED CONSTRUCTION ACTIVITIES, CONTACT PROJECT ENGINEER IMMEDIATELY IF ANY CONFLICTS ARE IDENTIFIED.

CALL 811 AT LEAST 48 HOURS BEFORE YOU DIG

DATE	BY
REVISION	DESCRIPTION
<p>ENGINEERING & LAND PLANNERS CIVIL ENGINEERS-SURVEYORS 3309 56th Street, NW, Suite 106 Gig Harbor, WA 98335 Phone: 253-857-5454 ~ Fax: 253-509-0044 ~ info@contourplc.com</p>	
<p>SHEET TITLE: DRAINAGE PLAN 2 (SOUTH)</p> <p>OVERLOOK APARTMENTS PHASE II CLIENT: OJAA, LLC 15234 SE 366TH PLACE AUBURN, WA 98092 CONTACT: MARK NORDLIE PHONE: (253) 255-7624</p>	
<p>DESIGNER: K. ROSE ENGINEER: J. HAUG DRAWN: B. MORRIS S 30 T 24N R 2E WM DATE: 2020.02.14 REVISED: </p>	
<p>PROJECT: 16-300 DWG NAME: 16-300-C</p>	
SHEET	REV.
C16	
16 OF 42	

GRAPHIC SCALE

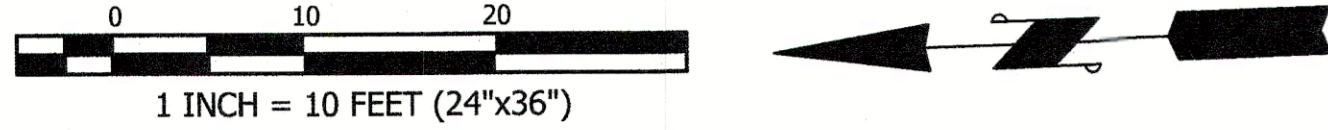

OVERLOOK APARTMENTS PHASE II
A PORTION OF THE SE 1/4 OF THE SW 1/4 OF SECTION 30, TOWNSHIP 24 NORTH, RANGE 2 EAST W.M.
CITY OF PORT ORCHARD, KITSAP COUNTY, WASHINGTON

BUILDING A

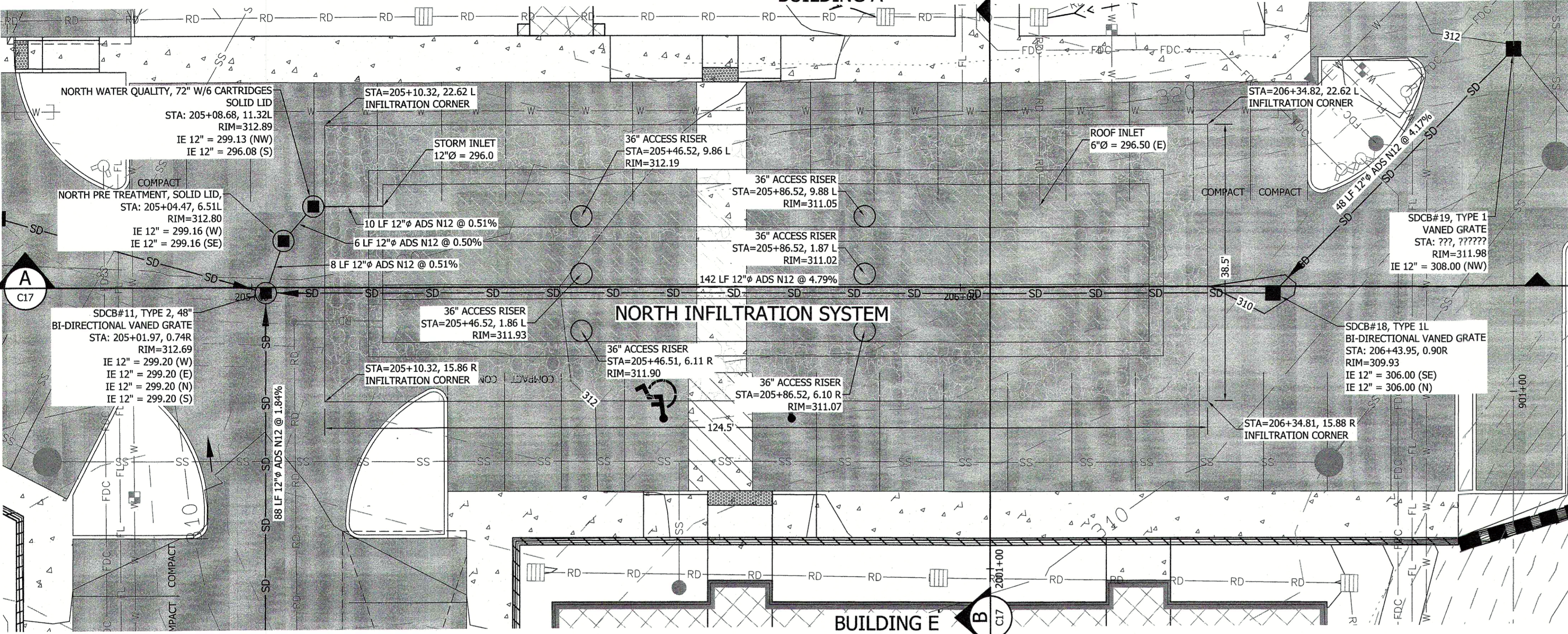

VERIFICATION NOTE

ALL EXISTING UTILITIES IN THE CONSTRUCTION AREA SHALL BE IDENTIFIED AND VERIFIED FOR DEPTH AND LOCATION PRIOR TO ANY CONSTRUCTION ACTIVITIES SO TO IDENTIFY ANY POTENTIAL CONFLICTS WITH PROPOSED CONSTRUCTION. CONTACT PROJECT ENGINEER IMMEDIATELY IF ANY CONFLICTS ARE IDENTIFIED.

PRIOR TO ANY CONSTRUCTION ACTIVITIES, VERIFY EXISTING TOPOGRAPHY IS CONSISTENT WITH WHAT IS SHOWN ON PLANS AND IF THERE ARE ANY POTENTIAL CONFLICTS WITH PROPOSED CONSTRUCTION ACTIVITIES. CONTACT PROJECT ENGINEER IMMEDIATELY IF ANY CONFLICTS ARE IDENTIFIED.

CALL 811 AT LEAST 48 HOURS BEFORE YOU DIG

DRAINAGE NOTE

BEFORE INSTALLATION OF THE INFILTRATION SYSTEM, THE GEOTECHNICAL ENGINEER SHALL INSPECT THE UNDERLYING SOILS AND DETERMINE THE FINAL DEPTH OF THE GRAVEL BED. IF SOILS HAVE DIFFERING DESIGN CRITERIA FROM THOSE FOUND DURING SOIL INVESTIGATIONS NOTIFY PROJECT ENGINEER.

INFILTRATION SYSTEM NOTE

PIPE DIAMETER:	6.0'
PIPE LENGTH:	108 LF x3
GRAVEL BASE AREA:	2,910 SF
GRAVEL TOP AREA:	4,792 SF
TANK STORAGE:	9,161 CF
GRAVEL STORAGE:	13,404 CF
TOTAL STORAGE:	22,564 CF (0.518 AC-FT)
POROSITY:	35%
INFILTRATION RATE:	4.25"/HR
BOTTOM OF GRAVEL ELEV:	287.0
BOTTOM OF TANK ELEV:	281.5

RECEIVED PERMIT CENTER
FEB 19 2020
CITY OF PORT ORCHARD
COMMUNITY DEVELOPMENT

CONTOUR
ENGINEERING • L.L.C.
CIVIL ENGINEERS • SURVEYORS • LAND PLANNERS
3309 56th Street NW, Suite 106 Gig Harbor, WA 98335
Phone: 253-857-5454 ~ Fax: 253-509-0044 ~ info@contourplc.com



A INFILTRATION SYSTEM 1 PROFILE
HORIZONTAL SCALE: 1"=10'
VERTICAL SCALE: 1"=5'

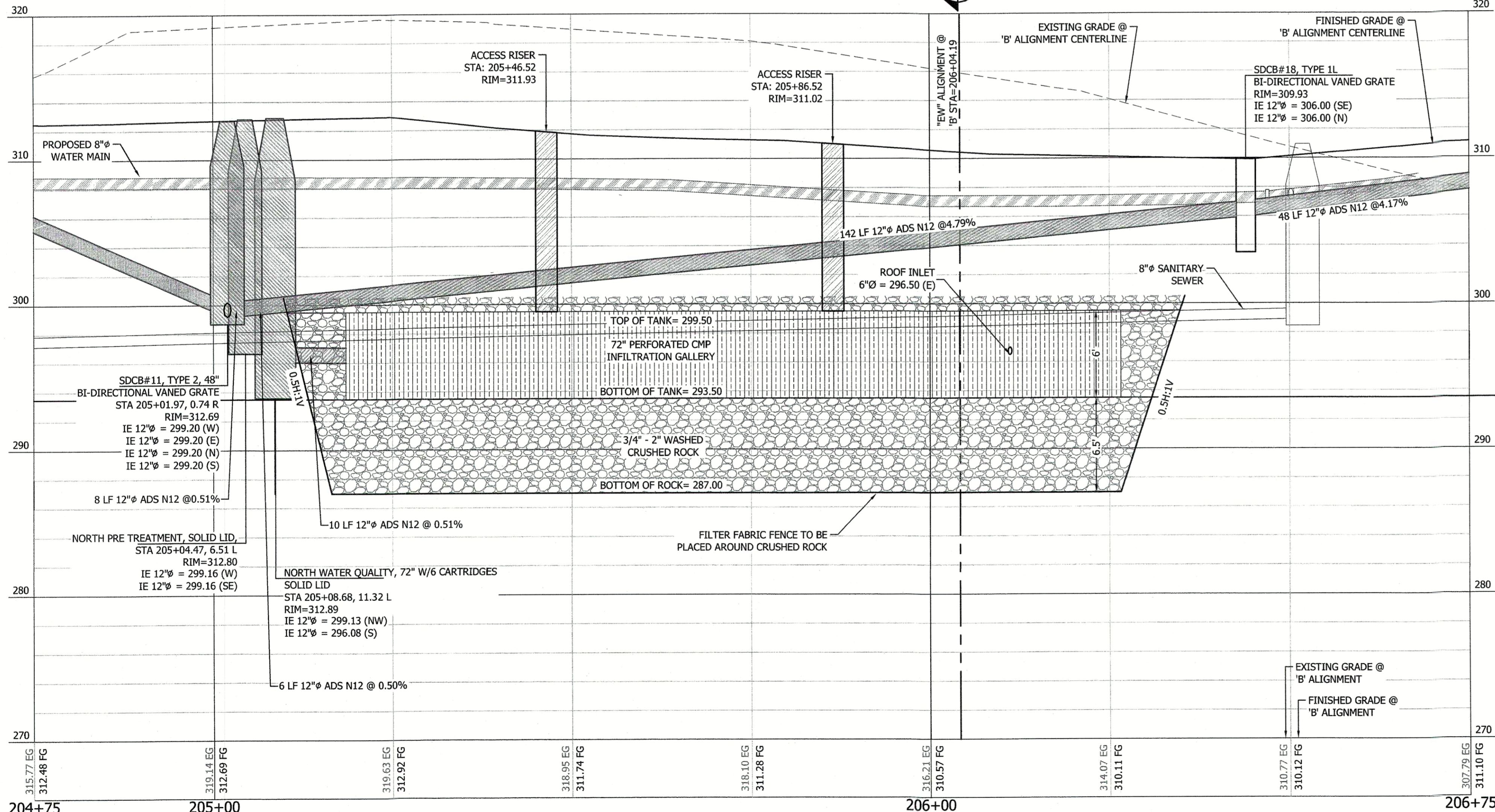

B INFILTRATION SYSTEM 1 SECTION
HORIZONTAL SCALE: 1"=10'
VERTICAL SCALE: 1"=5'

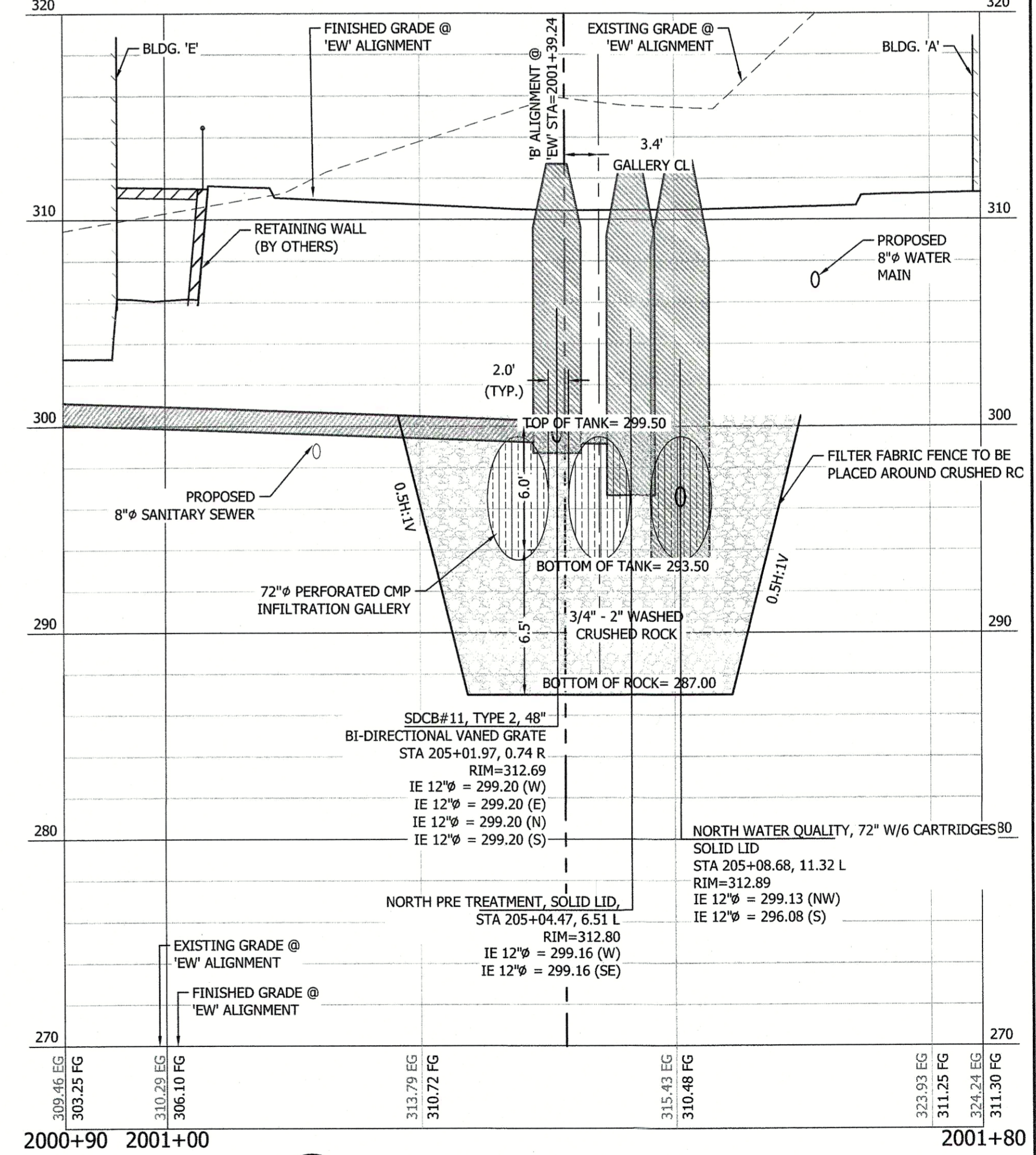

SHEET TITLE: NORTH INFILTRATION SYSTEM PLAN AND PROFILE
OVERLOOK APARTMENTS PHASE II

CLIENT: OLA4, LLC
15234 SE 366TH PLACE
AUBURN, WA 98092
CONTACT: MARK NORDLIE
PHONE: (253) 255-7624

DESIGNER: K ROSE
ENGINEER: J HAUG
DRAWN: B MORRIS
S 30 T 24N R 2E WM
DATE: 2020.02.14
REVISED:
PROJECT: 16-300
DWG NAME: 16-300-C

SHEET	REV.
C17	0
17 OF 42	

OVERLOOK APARTMENTS PHASE II
 A PORTION OF THE SE 1/4 OF THE SW 1/4 OF SECTION 30, TOWNSHIP 24 NORTH, RANGE 2 EAST W.M.
 CITY OF PORT ORCHARD, KITSAP COUNTY, WASHINGTON

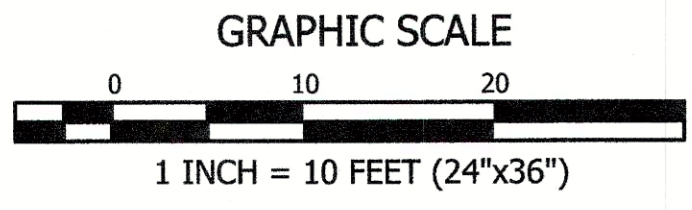

VERIFICATION NOTE
 ALL EXISTING UTILITIES IN THE CONSTRUCTION AREA SHALL BE IDENTIFIED AND VERIFIED FOR DEPTH AND LOCATION PRIOR TO ANY CONSTRUCTION ACTIVITIES SO TO IDENTIFY ANY POTENTIAL CONFLICTS WITH PROPOSED CONSTRUCTION. CONTACT PROJECT ENGINEER IMMEDIATELY IF ANY CONFLICTS ARE IDENTIFIED.

PRIOR TO ANY CONSTRUCTION ACTIVITIES, VERIFY EXISTING TOPOGRAPHY IS CONSISTENT WITH WHAT IS SHOWN ON PLANS AND IF THERE ARE ANY POTENTIAL CONFLICTS WITH PROPOSED CONSTRUCTION ACTIVITIES. CONTACT PROJECT ENGINEER IMMEDIATELY IF ANY CONFLICTS ARE IDENTIFIED.

CALL 811 AT LEAST 48 HOURS BEFORE YOU DIG

DRAINAGE NOTE
 BEFORE INSTALLATION OF THE INFILTRATION SYSTEM, THE GEOTECHNICAL ENGINEER SHALL INSPECT THE UNDERLYING SOILS AND DETERMINE THE FINAL DEPTH OF THE GRAVEL BED. IF SOILS HAVE DIFFERING DESIGN CRITERIA FROM THOSE FOUND DURING SOIL INVESTIGATIONS NOTIFY PROJECT ENGINEER.

INFILTRATION SYSTEM NOTE

PIPE DIAMETER:	6.0'
PIPE LENGTH:	108 LF
GRAVEL BASE AREA:	1,120 SF
GRAVEL TOP AREA:	3,720 SF
TANK STORAGE:	3,053 CF
GRAVEL STORAGE:	14,601 CF
TOTAL STORAGE:	17,654 CF (0.405 AC-FT)
POROSITY:	35%
INFILTRATION RATE:	10"/HR
BOTTOM OF GRAVEL ELEV:	286.0
BOTTOM OF TANK ELEV:	298.5

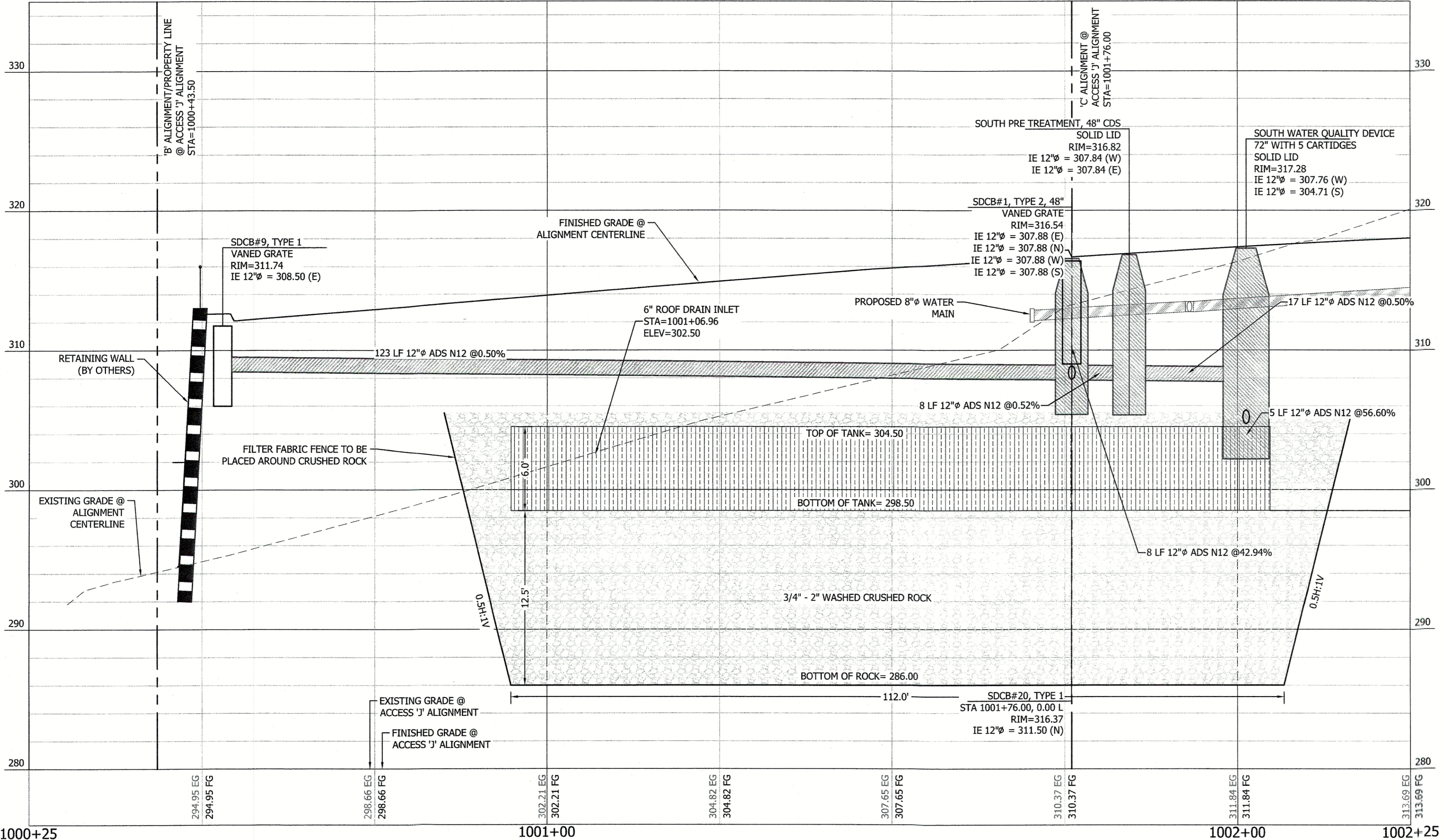
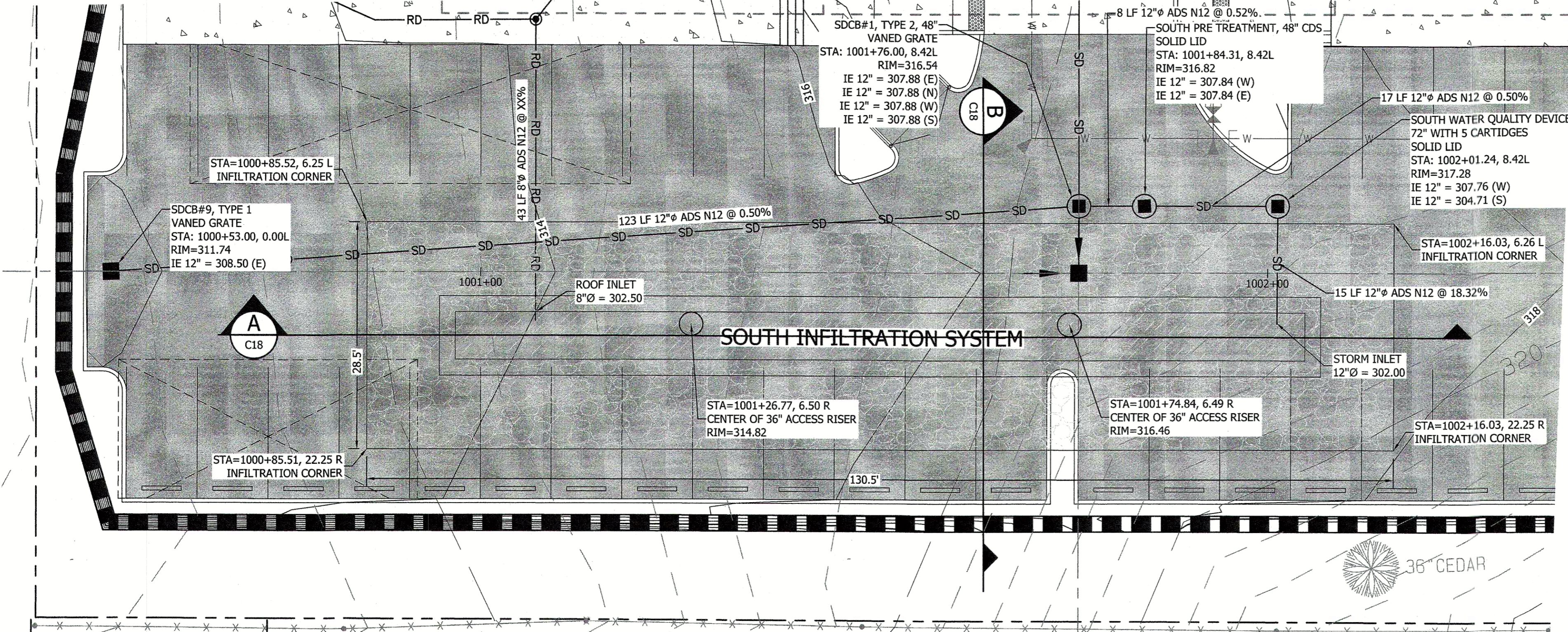

A INFILTRATION SYSTEM 2 PROFILE
 HORIZONTAL SCALE: 1"=10'
 VERTICAL SCALE: 1"=5'

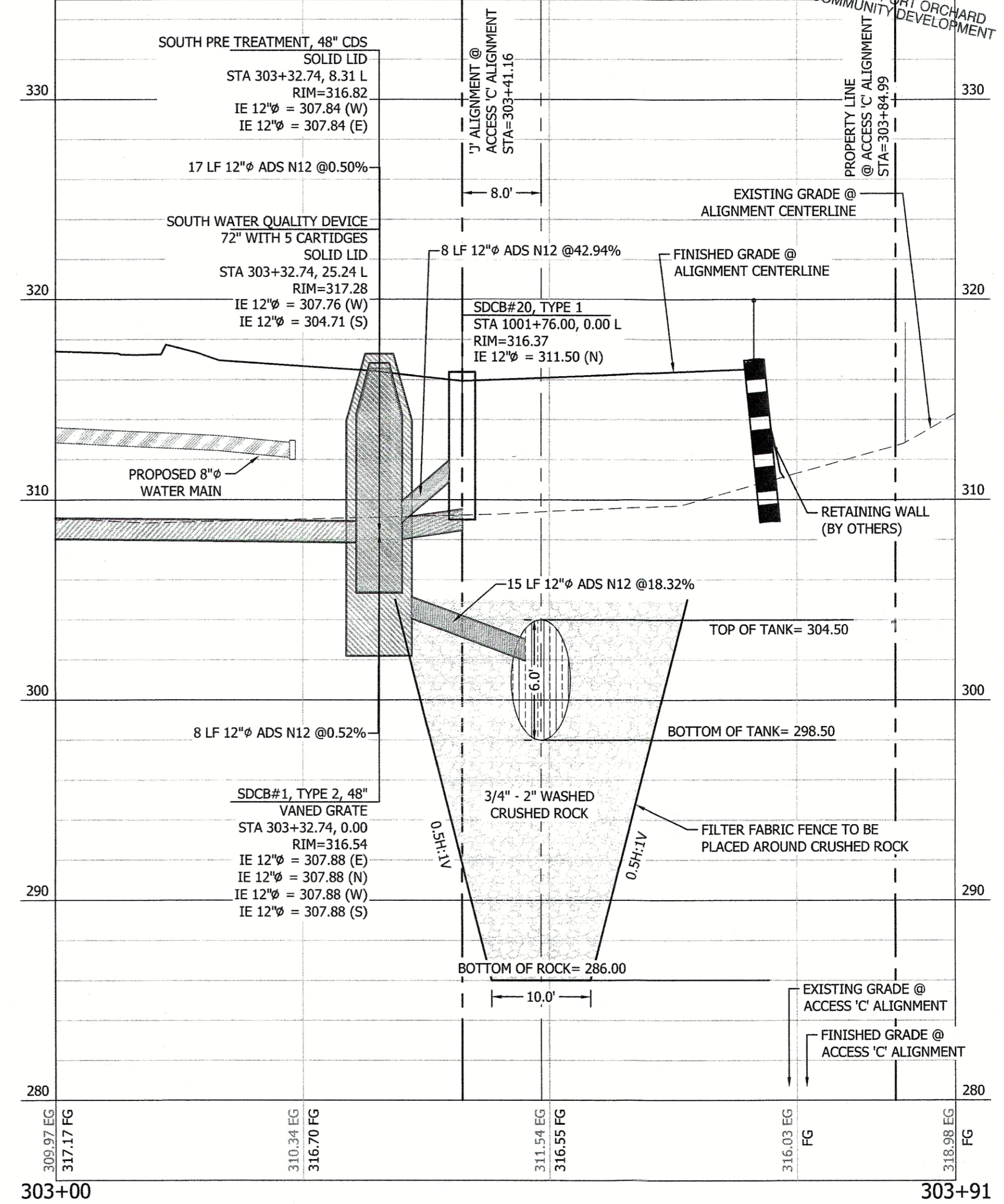

B INFILTRATION SYSTEM 2 SECTION
 HORIZONTAL SCALE: 1"=10'
 VERTICAL SCALE: 1"=5'

RECEIVED PERMIT CENTER
 FEB 19 2020
 CITY OF PORT ORCHARD COMMUNITY DEVELOPMENT

BY	DATE	DESCRIPTION	REVISION

CONTOUR ENGINEERS-SURVEYORS-PLANNERS	
CIVIL ENGINEERS-SURVEYORS-PLANNERS	3309 56th Street NW, Suite 106 Gig Harbor, WA 98335
	Phone: 253-857-9454 ~ Fax: 253-509-0044 ~ info@contourplc.com

PERMIT TO CONSTRUCT	
STATE OF WASHINGTON	PROFESSIONAL ENGINEER
MARK T. HAUG	

SHEET TITLE: SOUTH INFILTRATION SYSTEM PLAN AND PROFILE	
OVERLOOK APARTMENTS PHASE II	
CLIENT: OIAA, LLC	15234 SE 366TH PLACE
	AUBURN, WA 98092
CONTACT: MARK NORDLIE	PHONE: (253) 255-7624

DESIGNER: K. ROSE	ENGINEER: J. HAUG
DRAWN: B. MORRIS	
DATE: 2020.02.14	
PROJECT: 16-300	DWG NAME: 16-300-C

SHEET	REV.
C18	
18 OF 42	