

**GENERAL EROSION AND SEDIMENTATION CONTROL NOTES**

THE FOLLOWING EROSION AND SEDIMENTATION CONTROL NOTES APPLY TO ALL CONSTRUCTION SITE ACTIVITIES AT ALL TIMES, UNLESS OTHERWISE SPECIFIED ON THESE PLANS:

- APPROVAL OF THIS EROSION AND SEDIMENTATION CONTROL PLAN DOES NOT CONSTITUTE AN ACCEPTANCE OF THE PERMANENT ROAD OR DRAINAGE DESIGN.
- THE OWNER AND HIS/HER CONTRACTOR SHALL BE RESPONSIBLE AT ALL TIMES FOR PREVENTING SILT-LADEN RUNOFF FROM DISCHARGING FROM THE PROJECT SITE. FAILURE BY THE OWNER AND/OR CONTRACTOR CAN RESULT IN A FINE. THE DESIGNATED TEMPORARY CONTACT PERSON NOTED ON THIS PLAN MUST BE AVAILABLE FOR CONTACT BY TELEPHONE ON A 24 HOUR BASIS THROUGHOUT CONSTRUCTION AND UNTIL THE PROJECT HAS BEEN COMPLETED AND ACCEPTED BY THE CITY.
- THE IMPLEMENTATION OF THESE ESC PLANS AND THE CONSTRUCTION, MAINTENANCE, REPLACEMENT AND UPGRADING OF THESE FACILITIES IS THE RESPONSIBILITY OF THE OWNER AND/OR CONTRACTOR FROM THE BEGINNING OF CONSTRUCTION UNTIL ALL CONSTRUCTION IS COMPLETED AND ACCEPTED BY THE CITY AND THE SITE IS STABILIZED.
- PRIOR TO BEGINNING ANY WORK ON THE PROJECT SITE, A PRE-CONSTRUCTION CONFERENCE MUST BE HELD, AND SHALL BE ATTENDED BY THE GENERAL CONTRACTOR, THE PROJECT ENGINEER, REPRESENTATIVES FROM THE AFFECTED UTILITIES, AND A REPRESENTATIVE OF THE CITY OF PORT ORCHARD.
- THE EROSION AND SEDIMENTATION CONTROL FACILITIES SHOWN ON THIS PLAN ARE TO BE CONSIDERED ADEQUATE BASIC REQUIREMENTS FOR THE ANTICIPATED SITE CONDITIONS. DURING CONSTRUCTION, DEVIATIONS FROM THIS PLAN MAY BE NECESSARY IN ORDER TO MAINTAIN WATER QUALITY. MINOR DEPARTURES FROM THIS PLAN ARE PERMITTED SUBJECT TO THE APPROVAL OF THE CITY INSPECTOR. HOWEVER EXCEPT FOR EMERGENCY SITUATIONS, ALL OTHER DEVIATIONS FROM THIS PLAN MUST BE DESIGNED BY THE PROJECT ENGINEER AND APPROVED BY THE CITY PRIOR TO INSTALLATION.
- ALL EROSION AND SEDIMENTATION CONTROL MEASURES SHALL BE INSPECTED BY THE OWNER AND/OR CONTRACTOR ON A FREQUENT BASIS AND IMMEDIATELY AFTER EACH RAINFALL, AND MAINTAINED AS NECESSARY TO INSURE THEIR CONTINUED FUNCTIONING. ALL SEDIMENT MUST BE REMOVED FROM THE SILT FENCES, STRAW BALES, SEDIMENT POND, ETC. PRIOR TO THE SEDIMENT REACHING 1/2 ITS MAXIMUM POTENTIAL DEPTH.
- AT NO TIME SHALL CONCRETE, CONCRETE BYPRODUCTS, VEHICLE FLUIDS, PAINT, CHEMICALS, OR OTHER POLLUTING MATTER BE PERMITTED TO DISCHARGE TO THE TEMPORARY OR PERMANENT DRAINAGE SYSTEM, OR TO DISCHARGE FROM THE PROJECT SITE.
- PERMANENT DETENTION/RETENTION PONDS, PIPES, TANKS OR VAULTS MAY ONLY BE USED FOR SEDIMENT CONTAINMENT WHEN SPECIFICALLY INDICATED ON THESE PLANS.
- ALL WORKMANSHIP AND MATERIALS SHALL CONFORM TO THE MOST CURRENT STANDARD SPECIFICATIONS FOR ROAD, BRIDGE AND MUNICIPAL CONSTRUCTION PREPARED BY WSDOT AND APWA AS ADOPTED BY THE CITY OF PORT ORCHARD.
- ANY REVISIONS TO THE ACCEPTED CONSTRUCTION PLANS SHALL BE REVIEWED AND APPROVED BY THE CITY PRIOR TO IMPLEMENTATION IN FIELD.
- THE CONTRACTOR SHALL MAINTAIN A SET OF ACCEPTED CONSTRUCTION DRAWINGS ON SITE AT ALL TIMES WHILE CONSTRUCTION IS IN PROGRESS.
- IT SHALL BE THE RESPONSIBILITY OF THE CONTRACTOR TO OBTAIN ALL NECESSARY PERMITS FROM THE CITY OF PORT ORCHARD PRIOR TO COMMENCING ANY WORK WITHIN CITY RIGHT-OF-WAY.
- THE CONTRACTOR SHALL BE RESPONSIBLE FOR PROVIDING ADEQUATE TRAFFIC CONTROL AT ALL TIMES DURING CONSTRUCTION ALONGSIDE OR WITHIN ALL PUBLIC ROADWAYS. TRAFFIC FLOW ON EXISTING PUBLIC ROADWAYS SHALL BE MAINTAINED AT ALL TIMES, UNLESS PERMISSION IS OBTAINED FROM THE CITY FOR ROAD CLOSURE AND/OR DETOURS.

**TEMPORARY & PERMANENT HYDROSEEDING**

- ALL AREAS CLEARED OR OTHERWISE DISTURBED SHALL BE APPROPRIATELY STABILIZED IN ACCORDANCE WITH THE NOTES & DETAILS SPECIFIED HEREWITH, AND THE TIMES SPECIFIED BY SECTION 8-01.3 OF THE CURRENT EDITION OF THE W.S.D.O.T. STANDARD SPECIFICATIONS FOR ROAD, BRIDGE, AND MUNICIPAL CONSTRUCTION.
- PERMANENT HYDROSEEDING - IN AREAS NOT INCLUDED WITHIN THE PROJECT BOUNDARY OR NOT INCLUDED IN THE PROPOSED LANDSCAPE PLAN SHALL ADHERE TO THE FOLLOWING SPECS:

MINIMUM 80 LBS./ACRE MIXTURE OF:  
 15% KENTUCKY BLUEGRASS  
 40% TALL FESCUE  
 30% PERENNIAL RYE  
 15% CHEWINGS FESCUE  
 FERTILIZER - 400 LBS./ACRE OF 10-20-20  
 MULCH - 2000 LBS./ACRE

- TEMPORARY HYDROSEEDING - IN ALL AREAS DISTURBED DURING CONSTRUCTION THAT WILL RECEIVE PERMANENT LANDSCAPING SHALL BE SEEDED WITH TEMPORARY EROSION CONTROL SEED MIXTURE AS REQUIRED TO PRODUCE A SUITABLE TEMPORARY GROUND COVER.

APPLY AT A RATE OF 120 LBS./ACRE.  
 10% REDTOP (AGROSTIS ABLI)  
 40% ANNUAL RYE (LOLIUM MULIFLORUM)  
 40% CHEWING FESCUE (FESTUCA REBRA COMMUTATA) (JAMESTOWN, BANNER, SHADOW OR KOKE)  
 10% WHITE DUTCH CLOVER (TRIFOLIUM)

**MINIMUM EROSION AND SEDIMENTATION CONTROL REQUIREMENTS**

- STABILIZATION AND SEDIMENT TRAPPING.** ALL EXPOSED AND UNWORKED SOILS, INCLUDING SOIL STOCKPILES, SHALL BE STABILIZED BY SUITABLE APPLICATION OF BMP'S WHICH PROTECT SOIL FROM THE EROSION FORCES OF RAINDROP IMPACT AND FLOWING WATER. APPLICABLE PRACTICES INCLUDE, BUT ARE NOT LIMITED TO VEGETATIVE ESTABLISHMENT, MULCHING, PLASTIC COVERING, AND THE EARLY APPLICATION OF GRAVEL BASE ON AREAS TO BE PAVED. FROM OCTOBER 1 TO APRIL 30, NO SOILS SHALL REMAIN UNSTABILIZED FOR MORE THAN 2 DAYS. FROM MAY 1 TO SEPTEMBER 30, NO SOILS SHALL REMAIN UNSTABILIZED FOR MORE THAN 7 DAYS.
- AT ALL TIMES OF THE YEAR, THE CONTRACTOR SHALL HAVE SUFFICIENT MATERIALS, EQUIPMENT AND LABOR ON-SITE TO STABILIZE AND PREVENT EROSION FROM ALL DENUDEED AREAS WITHIN 12-HOURS AS SITE AND WEATHER CONDITIONS DICTATE.
- FROM OCTOBER 1ST TO APRIL 30TH, THE PROJECT ENGINEER SHALL VISIT THE DEVELOPMENT SITE A MINIMUM OF ONCE PER WEEK FOR THE PURPOSE OF INSPECTING THE EROSION AND SEDIMENTATION CONTROL FACILITIES, REVIEWING THE PROGRESS OF CONSTRUCTION, AND VERIFYING THE EFFECTIVENESS OF THE EROSION CONTROL MEASURES BEING UNDERTAKEN. THE PROJECT ENGINEER SHALL IMMEDIATELY INFORM THE CITY OF ANY PROBLEMS OBSERVED DURING SAID SITE VISITS, AS WELL AS OF ANY RECOMMENDED CHANGES IN THE EROSION CONTROL MEASURES TO BE UNDERTAKEN. WHEN REQUESTED BY THE CITY, THE PROJECT ENGINEER SHALL PROVIDE THE CITY WITH WRITTEN RECORDS OF SAID WEEKLY SITE VISITS, INCLUDING DATES OF VISITS AND NOTED SITE OBSERVATIONS.
- IN THE EVENT THAT THE GROUND ON A PROJECT SITE IS LEFT BARE AFTER SEPTEMBER 30TH, THE CITY MAY ISSUE A STOP WORK ORDER FOR THE ENTIRE PROJECT UNTIL SATISFACTORY CONTROLS ARE PROVIDED. IN ADDITION, THE OWNER WILL BE SUBJECT TO THE PENALTIES PROVIDED IN SECTION 10 AND SECTION 11 OF THE CITY OF PORT ORCHARD STORMWATER ORDINANCE.
- IN THE EVENT THAT GROUND ON A PROJECT SITE IS LEFT BARE AFTER SEPTEMBER 30TH, AND THE CITY IS UNSUCCESSFUL IN CONTACTING THE OWNER OR HIS/HER DESIGNATED EMERGENCY CONTACT PERSON, THE CITY MAY ENTER THE PROJECT SITE AND INSTALL TEMPORARY GROUND COVER MEASURES AND BILL THE OWNER FOR ALL EXPENSES INCURRED BY THE CITY. THESE COSTS WILL BE IN ADDITION TO ANY MONETARY PENALTIES LEVIED AGAINST THE OWNER.
- DELINEATION OF CLEARING AND EASEMENT LIMITS.** CLEARING LIMITS, SETBACKS, BUFFERS OR SENSITIVE OR CRITICAL AREAS SUCH AS STEEP SLOPES, WETLANDS AND RIPARIAN CORRIDORS SHALL BE CLEARLY MARKED IN THE FIELD AND INSPECTED BY CITY PRIOR TO COMMENCEMENT OF LAND CLEARING ACTIVITIES
- PROTECTION OF ADJACENT PROPERTIES.** ADJACENT PROPERTIES SHALL BE PROTECTED FROM SEDIMENT DEPOSITION BY APPROPRIATE USE OF VEGETATIVE BUFFER STRIPS, SEDIMENT BARRIERS OR FILTERS, DIKES OR MULCHING, OR BY A COMBINATION OF THESE MEASURES AND OTHER APPROPRIATE BMP'S.
- TIMING AND STABILIZATION OF SEDIMENT TRAPPING MEASURES.** SEDIMENT PONDS AND TRAPS, PERIMETER DIKES, SEDIMENT BARRIERS AND OTHER BMP'S INTENDED TO TRAP SEDIMENT ON-SITE SHALL BE CONSTRUCTED AS A FIRST STEP IN GRADING. THIS BMP'S SHALL BE FUNCTIONAL BEFORE LAND DISTURBING ACTIVITIES TAKE PLACE. EARTHEN STRUCTURES SUCH AS DAMS, DIKES, AND DIVERSIONS SHALL BE STABILIZED ACCORDING TO THE TIMING INDICATED IN ITEM (1) ABOVE.
- SLOPE STABILIZATION.** CUT AND FILL SLOPES SHALL BE CONSTRUCTED IN A MANNER THAT WILL MINIMIZE EROSION. ROUGHENED SOIL SURFACES ARE PREFERRED TO SMOOTH SURFACES. INTERCEPTORS SHOULD BE CONSTRUCTED AT THE TOP OF LONG, STEEP SLOPES WHICH HAVE SIGNIFICANT AREAS ABOVE THAT CONTRIBUTE RUNOFF. CONCENTRATED RUNOFF SHOULD NOT BE ALLOWED TO FLOW DOWN THE FACE OF A CUT OR FILL SLOPE UNLESS CONTAINED WITHIN AN ADEQUATE CHANNEL OR PIPE SLOPE DRAIN. WHEREVER A SLOPE FACE CROSSES A WATER SEEPAGE PLANE, ADEQUATE DRAINAGE OR OTHER PRO-SECTION SHOULD BE PROVIDED. IN ADDITION, SLOPES SHOULD BE STABILIZED IN ACCORDANCE WITH ITEM (1) ABOVE.
- CONTROLLING OFF-SITE EROSION.** PROPERTIES AND WATERWAYS DOWNSTREAM FROM DEVELOPMENT SITES SHALL BE PROTECTED FROM EROSION DUE TO INCREASES IN THE VOLUME, VELOCITY, AND PEAK FLOW RATE OF STORMWATER RUNOFF FROM THE DEVELOPMENT SITE BY THE IMPLEMENTATION OF APPROPRIATE BMP'S TO MINIMIZE ADVERSE DOWNSTREAM IMPACTS.
- STABILIZATION OF TEMPORARY CONVEYANCE CHANNELS AND OUTLETS.** ALL TEMPORARY ON-SITE CONVEYANCE CHANNELS SHALL BE DESIGNED, CONSTRUCTED AND STABILIZED TO PREVENT EROSION FROM THE EXPECTED FLOW VELOCITY FROM A 2-YR FREQUENCY, 24-HOUR DURATION STORM FOR THE POST-DEVELOPMENTAL CONDITION. STABILIZATION ADEQUATE TO PREVENT EROSION OF OUTLETS, ADJACENT STREAM BANKS, SLOPES AND DOWNSTREAM REACHES SHALL BE PROVIDED AT THE OUTLETS OF ALL CONVEYANCE SYSTEMS.
- STORM DRAIN INLET PROTECTION.** ALL STORM DRAIN INLETS MADE OPERABLE DURING CONSTRUCTION SHALL BE PROTECTED SO THAT STORMWATER RUNOFF SHALL NOT ENTER THE CONVEYANCE SYSTEM WITHOUT FIRST BEING FILTERED OR OTHERWISE TREATED TO REMOVE SEDIMENT. AFTER PROPER WRITTEN APPLICATION, THE REQUIREMENT FOR INLET PROTECTION MAY BE WAIVED BY THE CITY ON A SITE-SPECIFIC BASIS WHEN THE CONVEYANCE SYSTEM DOWNSTREAM OF THE INLET DISCHARGES TO AN APPROPRIATE SEDIMENT CONTAINMENT BMP AND THE CONVEYANCE SYSTEM CAN BE ADEQUATELY CLEANED FOLLOWING SITE STABILIZATION.
- UNDERGROUND UTILITY CONSTRUCTION.** THE CONSTRUCTION OF UNDERGROUND UTILITY LINES SHALL BE LIMITED, WHERE FEASIBLE, TO NO MORE THAN 500 FEET OF OPEN TRENCH AT ANY ONE TIME, WHERE CONSISTENT WITH SAFETY AND SPACE CONSIDERATIONS. EXCAVATED MATERIAL SHALL BE PLACED ON THE UPHILL SIDE OF THE TRENCH. DEWATERING DEVICES SHALL DISCHARGE TO AN APPROPRIATE SEDIMENT TRAP OR POND, PRECEDED BY ADEQUATE ENERGY DISSIPATION, PRIOR TO RUNOFF LEAVING THE SITE.
- CONSTRUCTED ACCESS ROUTES.** WHEREVER CONSTRUCTION VEHICLE ACCESS ROUTES INTERSECT PAVED ROADS, PROVISIONS MUST BE MADE TO MINIMIZE THE TRANSPORT OF SEDIMENT (MUD) ONTO THE PAVED ROAD BY USE OF APPROPRIATE BMP'S SUCH AS STABILIZED CONSTRUCTION ENTRANCE. IF SEDIMENT IS TRANSPORTED ONTO A ROAD SURFACE, THE ROADS SHALL BE CLEANED THOROUGHLY, AS A MINIMUM, AT THE END OF EACH DAY. SEDIMENT SHALL BE REMOVED FROM ROADS BY SHOVELING OR SWEEPING AND BE TRANSPORTED TO A CONTROLLED SEDIMENT DISPOSAL AREA. STREET WASHING SHALL BE ALLOWED ONLY AFTER SEDIMENT IS REMOVED IN THIS MANNER.
- REMOVAL OF TEMPORARY BMP'S.** ALL TEMPORARY EROSION AND SEDIMENT CONTROL BMP'S SHALL BE REMOVED WITHIN 30 DAYS AFTER FINAL SITE STABILIZATION IS ACHIEVED OR AFTER THE TEMPORARY BMP'S ARE NO LONGER NEEDED. TRAPPED SEDIMENT SHALL BE REMOVED OR STABILIZED ON-SITE. DISTURBED SOIL AREAS RESULTING FROM THE REMOVAL OF TEMPORARY BMP'S SHALL BE PERMANENTLY STABILIZED. THE REMOVAL OF TEMPORARY EROSION AND SEDIMENT CONTROL BMP'S MAY NOT BE REQUIRED FOR THOSE PROJECTS, SUCH AS SINGLE FAMILY PLATS, THAT WILL BE FOLLOWED BY ADDITIONAL CONSTRUCTION UNDER A DIFFERENT PERMIT. IN THESE CIRCUMSTANCES, THE NEED FOR REMOVING OR RETAINING THE MEASURES WILL BE EVALUATED ON A SITE-SPECIFIC BASIS.
- DEWATERING CONSTRUCTION SITES.** DEWATERING DEVICES SHALL DISCHARGE INTO AN APPROPRIATE SEDIMENT TRAP OR POND, DESIGNED TO ACCEPT SUCH A DISCHARGE, PRECEDED BY ADEQUATE ENERGY DISSIPATION, PRIOR TO RUNOFF LEAVING THE SITE.
- CONTROL OF POLLUTANTS OTHER THAN SEDIMENT ON CONSTRUCTION SITES.** ALL POLLUTANTS OTHER THAN SEDIMENTS THAT OCCUR ON-SITE DURING CONSTRUCTION SHALL BE HANDLED AND LEGALLY DISPOSED OF IN A MANNER THAT DOES NOT CAUSE CONTAMINATION OF STORM OR SURFACE WATERS. POLLUTANTS OF CONCERN INCLUDE, BUT ARE NOT LIMITED TO, FUELS, LUBRICANTS, SOLVENTS, CONCRETE BYPRODUCTS AND CONSTRUCTION MATERIALS.
- MAINTENANCE.** ALL TEMPORARY AND PERMANENT EROSION AND SEDIMENT CONTROL BMP'S SHALL BE MAINTAINED AND REPAIRED AS NEEDED TO INSURE CONTINUED PERFORMANCE OF THEIR INTENDED FUNCTION. ALL MAINTENANCE AND REPAIR SHALL BE CONDUCTED IN ACCORDANCE WITH THE MANUAL. THE APPLICANT SHALL BE RESPONSIBLE FOR ASSURING THAT ANY SUCH FACILITIES DAMAGED DURING FLOODS, STORMS OR OTHER ADVERSE WEATHER CONDITIONS ARE IMMEDIATELY RETURNED TO NORMAL OPERATING CONDITION.
- FINANCIAL LIABILITY.** A PERFORMANCE COVENANT OR PERFORMANCE SURETY, SHALL BE REQUIRED FOR ALL PROJECTS TO ENSURE COMPLIANCE WITH THE APPROVED EROSION AND SEDIMENT CONTROL PLAN, AS OUTLINED IN THE CITY OF PORT ORCHARD STORMWATER ORDINANCE.

**CONSTRUCTION SEQUENCE**

- APPLY FOR AND PICK UP ANY REQUIRED ROAD APPROACH, OR RIGHT OF WAY PERMITS FROM THE CITY OF PORT ORCHARD.
- CONSTRUCT STABILIZED CONSTRUCTION ENTRANCE(S).
- CONSTRUCT FILTER FENCE BARRIERS.
- CONSTRUCT SEDIMENTATION BASINS AND DISCHARGE PIPES.
- CONSTRUCT RUNOFF INTERCEPTION AND DIVERSION DITCHES.
- CLEAR AND GRADE THE MINIMUM SITE AREA REQUIRED FOR CONSTRUCTION OF THE VARIOUS PHASES OF WORK.
- PROVIDE TEMPORARY HYDROSEEDING OR OTHER SOURCE CONTROL STABILIZATION MEASURES ON ALL DISTURBED SOILS.
- MAINTAIN ALL EROSION AND SEDIMENTATION CONTROL FACILITIES TO PROVIDE THE REQUIRED PROTECTION OF DOWNSTREAM WATER QUALITY.
- PROVIDE PERMANENT SITE STABILIZATION.
- EROSION AND SEDIMENTATION CONTROL FACILITIES SHALL NOT BE REMOVED UNTIL CONSTRUCTION IS COMPLETE AND ACCEPTED BY THE CITY OF PORT ORCHARD.

**INSPECTION SCHEDULE**

- THE CONTRACTOR SHALL NOTIFY THE CITY OF PORT ORCHARD TO ARRANGE FOR INSPECTION OF THE VARIOUS PHASES OF WORK CHECKED BELOW. ALL INSPECTIONS SHALL BE COMPLETED PRIOR TO PROCEEDING WITH THE NEXT PHASE OF WORK.

- LOCATION OF THE ROAD APPROACH
- CLEARING LIMITS
- IMPLEMENTATION OF THE VARIOUS PHASES OF THE EROSION AND SEDIMENTATION CONTROL PLAN
- PLACEMENT OF DRAINAGE STRUCTURES PRIOR TO BACK FILLING, INCLUDING POND EMBANKMENTS
- PRIOR TO PLACEMENT OF THE DETENTION OUTLET CONTROL STRUCTURE
- INSPECTION OF PREPARED SUB-GRADE
- INSPECTION OF GRAVEL BASE PLACEMENT
- INSPECTION OF FINE-GRADING PRIOR TO PAVING
- INSPECTION OF PAVING OPERATIONS
- FINAL INSPECTION

- THE CONTRACTOR SHALL BE RESPONSIBLE FOR ALL WORK PERFORMED AND SHALL ENSURE THAT CONSTRUCTION IS ACCEPTABLE TO THE CITY OF PORT ORCHARD.
- IF INSPECTION IS NOT CALLED FOR PRIOR TO COMPLETION OF ANY ITEM OF WORK SO DESIGNATED, SPECIAL DESTRUCTIVE AND/OR NON-DESTRUCTIVE TESTING PROCEDURES MAY BE REQUIRED TO ENSURE THE ACCEPTABILITY OF THE WORK. IF SUCH PROCEDURES ARE REQUIRED, THE CONTRACTOR SHALL BE RESPONSIBLE FOR ALL COSTS ASSOCIATED WITH THE TESTING AND/OR RESTORATION OF THE WORK.

**T. E. S. C. MAINTENANCE REQUIREMENTS**

- EROSION AND SEDIMENTATION CONTROL FACILITIES SHALL BE INSPECTED AFTER EACH STORM EVENT AND DAILY DURING PROLONGED RAINFALL.
- NECESSARY REPAIRS OR REPLACEMENT OF FACILITIES SHALL BE ACCOMPLISHED PROMPTLY.
- SEDIMENT DEPOSITS SHALL BE REMOVED AFTER EACH STORM EVENT OR WHEN THE LEVEL OF DEPOSITION REACHES APPROXIMATELY ONE-HALF OF THE MAXIMUM POTENTIAL DEPTH.
- SEDIMENT DEPOSITS REMAINING IN PLACE AFTER THE ESC FACILITIES ARE NO LONGER REQUIRED SHALL BE DRESSED TO CONFORM TO THE EXISTING GRADE, PREPARED AND SEEDED.
- TEMPORARY EROSION AND SEDIMENTATION CONTROL FACILITIES SHALL BE MAINTAINED BY:

\_\_\_\_\_

\_\_\_\_\_

EMERGENCY PHONE NUMBER

THE OWNER'S REPRESENTATIVE SHALL BE:

\_\_\_\_\_

\_\_\_\_\_

EMERGENCY PHONE NUMBER

- THE LOCATIONS OF EXISTING UTILITIES ON THIS PLAN ARE APPROXIMATE ONLY. THE CONTRACTOR SHALL CONTACT THE "UNDERGROUND LOCATE" CENTER AT PH: 1-800-424-5555, AND NON-SUBSCRIBING INDIVIDUAL UTILITY COMPANIES 48 HOURS IN ADVANCE OF THE COMMENCEMENT OF ANY CONSTRUCTION ACTIVITY. THE CONTRACTOR SHALL PROVIDE FOR PROTECTION OF EXISTING UTILITIES FROM DAMAGE CAUSED BY THE CONTRACTOR'S OPERATIONS.
- ROCKERIES OR OTHER RETAINING FACILITIES EXCEEDING 4 FT. IN HEIGHT REQUIRE A SEPARATE PERMIT FROM CITY OF PORT ORCHARD BUILDING DEPARTMENT.
- A "FORESTRY PRACTICES" PERMIT MAY BE REQUIRED PRIOR TO CLEARING OF THE SITE. CONTACT CITY OF PORT ORCHARD DEPARTMENT OF COMMUNITY DEVELOPMENT FOR FURTHER INFORMATION.

**NOTE**

THE APPROXIMATE LOCATION OF EXISTING UNDERGROUND UTILITIES ARE SHOWN ON THE PLANS. IT IS THE CONTRACTOR'S RESPONSIBILITY TO DETERMINE THE LOCATION OF EXISTING UTILITIES PRIOR TO COMMENCING WORK. THE CONTRACTOR SHALL BE RESPONSIBLE FOR DAMAGES THAT MIGHT BE OCCASIONED BY THE CONTRACTOR'S FAILURE TO LOCATE, PRESERVE AND PROTECT UNDERGROUND UTILITIES.

**CALL 48 HOURS BEFORE YOU DIG**  
 811

EXISTING TREES TO BE REMOVED	
Point #	Description
721	TRD 21N ALDER
723	TRD CLUSTER 12N 12N 10N 12N 10N MAPLE
724	TRD CLUSTER 15N 9N 14N 15N 10N MAPLE
725	TRD CLUSTER 10N 12N 15N 18N 15N 8N 8N MAPLE
726	TRD CLUSTER 19N 18N 11N 15N 12N 8N MAPLE
751	TRD CLUSTER 12N 18N 15N 11N 16N MAPLE
752	TRD CLUSTER 20N 12N 12N 16N 19N 12N MAPLE
753	TRD CLUSTER 22N 18N 9N 17N 15N MAPLE
754	TRD CLUSTER 26N 16N 27N 24N MAPLE
755	TRC 28N FIR
794	TRD 18N MAPLE X2
795	TRD CLUSTER 18N 16N 12N 12N MAPLE
796	TRC 22N FIR
797	TRC 24N CEDAR
816	TRD 18N MAPLE
817	TRC 23N HEMLOCK
818	TRD CLUSTER 21N 18N 12N 9N MAPLE
819	TRD CLUSTER 21N 16N 12N 12N 15N 15N MAPLE
820	TRC 35N CEDAR
821	TRC 25N CEDAR
823	TRD 18N MAPLE
824	TRD CLUSTER 18N 20N 16N 12N 15N MAPLE
825	TRD 18N MAPLE
826	TRD CLUSTER 16N 10N 10N MAPLE
827	TRD CLUSTER 17N 14N 13N 10N 15N MAPLE
828	TRD 18N MAPLE
829	TRD 18N MAPLE
831	TRD CLUSTER 14N 18N 18N 10N MAPLE
832	TRD CLUSTER 22N 30N 20N MAPLE
833	TRD 22N MAPLE
834	TRD 20N MAPLE
835	TRD CLUSTER 19N 18N 19N MAPLE
836	TRD 22N MAPLE
837	TRC 22N CEDAR X2
838	TRC 22N HEMLOCK
839	TRC 20N HEMLOCK
840	TRC 20N HEMLOCK
842	TRC 26N CEDAR
843	TRD 26N MAPLE
844	TRD 20N MAPLE
845	TRD CLUSTER 16N 18N 14N 14N MAPLE
846	TRD 18N 10N MAPLE
847	TRD 26N MAPLE
848	TRC 20N HEMLOCK
849	TRC 26N CEDAR
850	TRD 24N MAPLE
851	TRD 20N MAPLE
852	TRC 20N CEDAR
853	TRD 30N MAPLE
854	TRC 32N CEDAR
855	TRC 32N CEDAR
858	TRD 22N MAPLE
863	TRD 20N 24N MAPLE
867	TRD 18N MAPLE
869	TRD 22N MAPLE
870	TRD 20N MAPLE
874	TRD 24N 18N MAPLE
875	TRD 18N MAPLE
876	TRD CLUSTER 14N 18N 18N MAPLE
877	TRC 28N CEDAR
878	TRC 20N 24N CEDAR
879	TRC 28N CEDAR
880	TRD 36N MAPLE
881	TRC 30N CEDAR
882	TRD 40N MAPLE

COUNTER COMPLETE  
 Permit Center  
 APR 21, 2021  
 City of Port Orchard  
 Community Development

REVISIONS			
NO.	DATE	BY	DESCRIPTION

**N.L. Olson & Associates, Inc.**  
 Engineering, Planning and Surveying  
 (360) 895-2350 or (360) 876-2284  
 2453 Bethel Avenue, P.O. Box 637, Port Orchard, WA 98366



**T.E.S.C. NOTES**  
**BRIDGE VIEW TRAIL APARTMENTS - HAROLD DR SE**  
 Portion of the Southeast Quarter of Section 35,  
 Township 24 North, Range 1 East, W.M. in Kitsap County, Washington

FOR: **Harbor Custom Development, Inc.**  
 Attn: Sterling Griffin  
 11505 Burnham Dr. Suite 301  
 Gig Harbor, WA 98332

SCALE: N.T.S.
DATE: March 12, 2021
DRAWING NUMBER
<b>11331</b>
SHEET C3.1



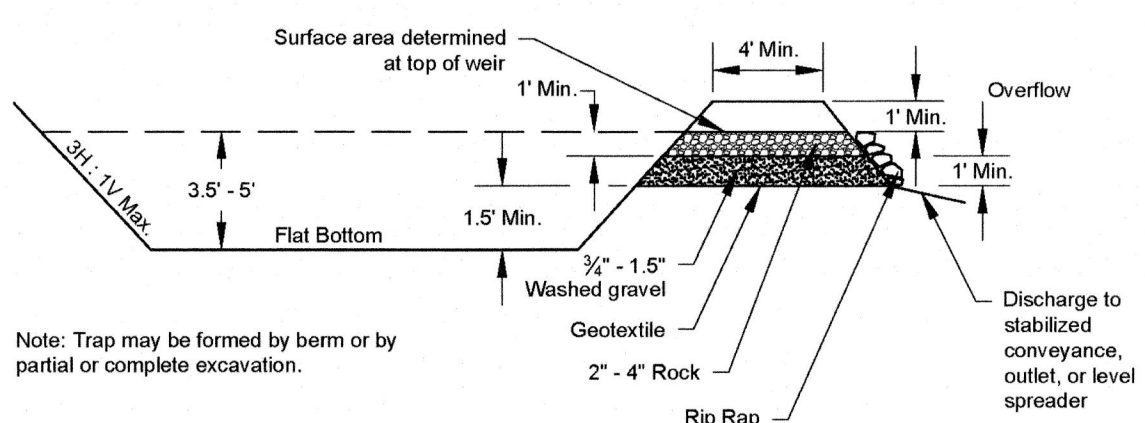

**SEDIMENT TRAP CROSS SECTION**  
NOT TO SCALE

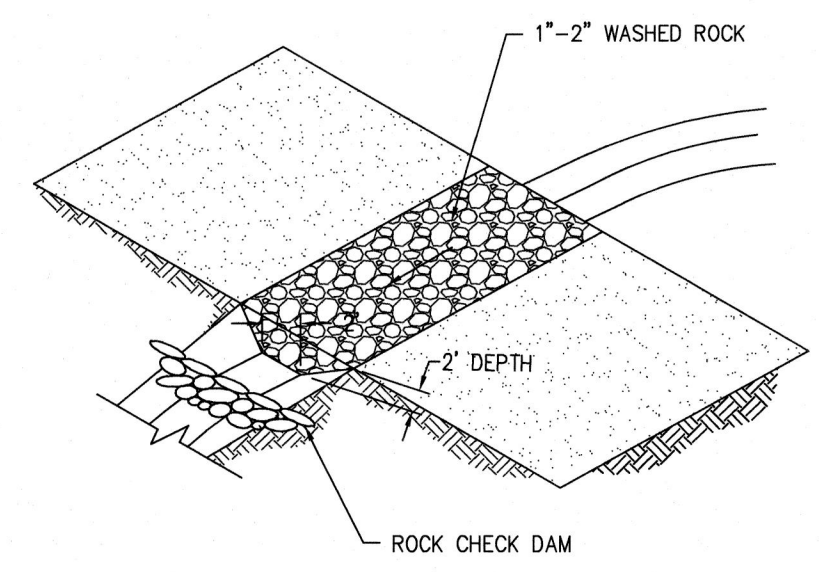

**CUT-OFF TRENCH WITH GRAVEL FILTER DIKE DETAIL**  
NOT TO SCALE

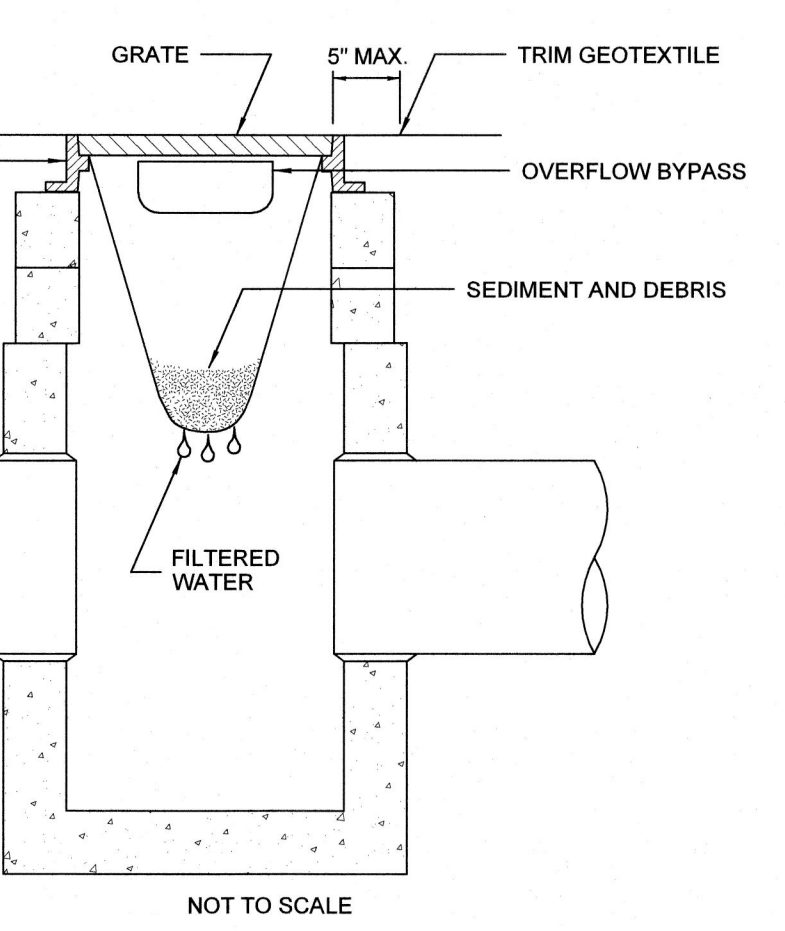
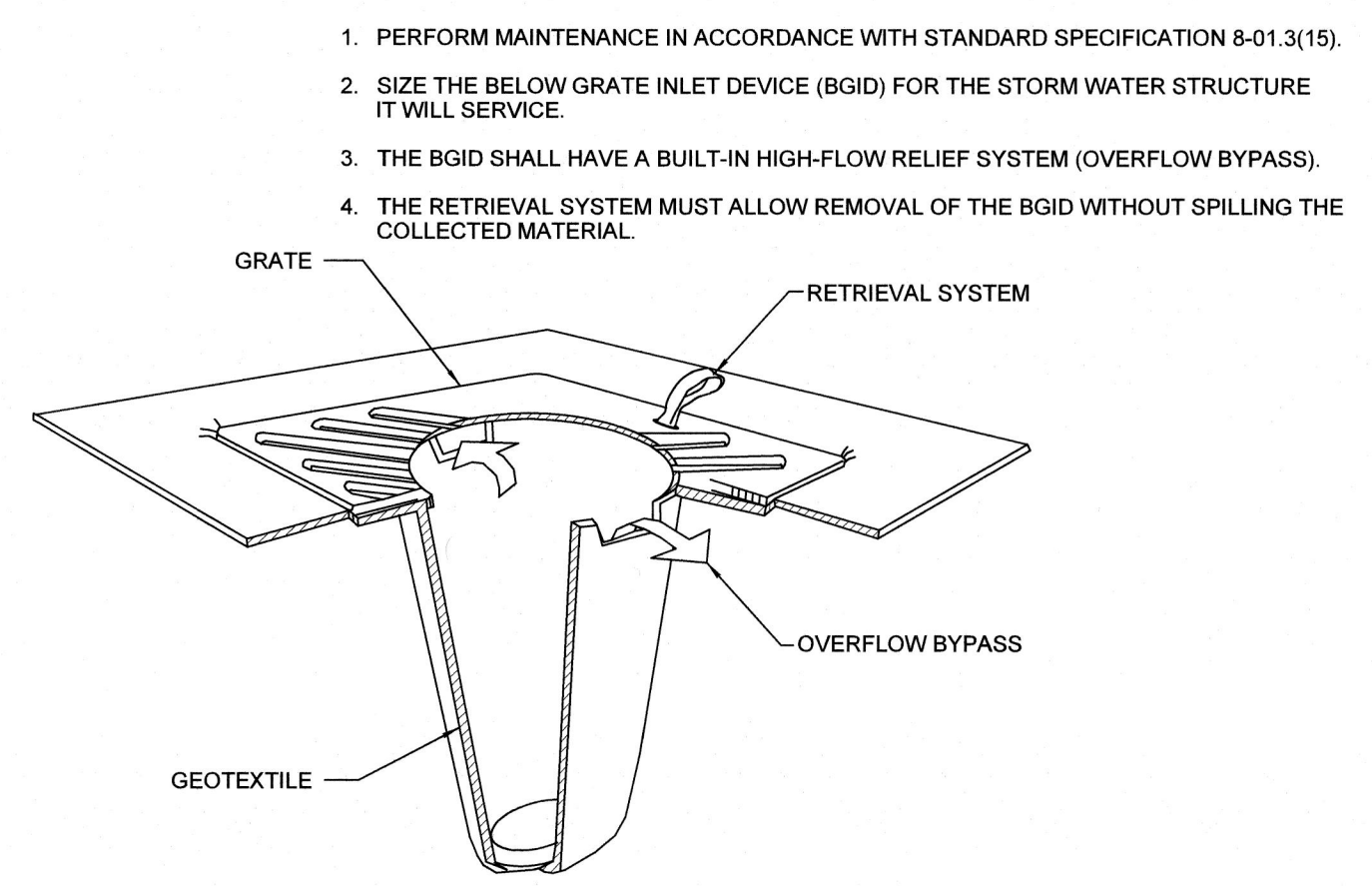

**INLET PROTECTION DETAIL**  
NOT TO SCALE

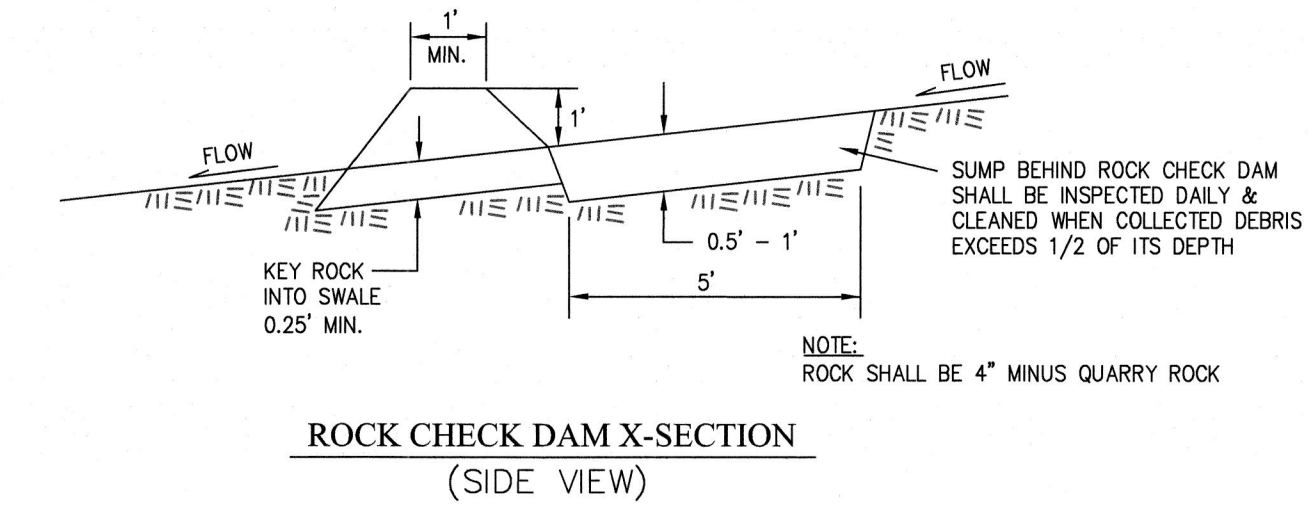
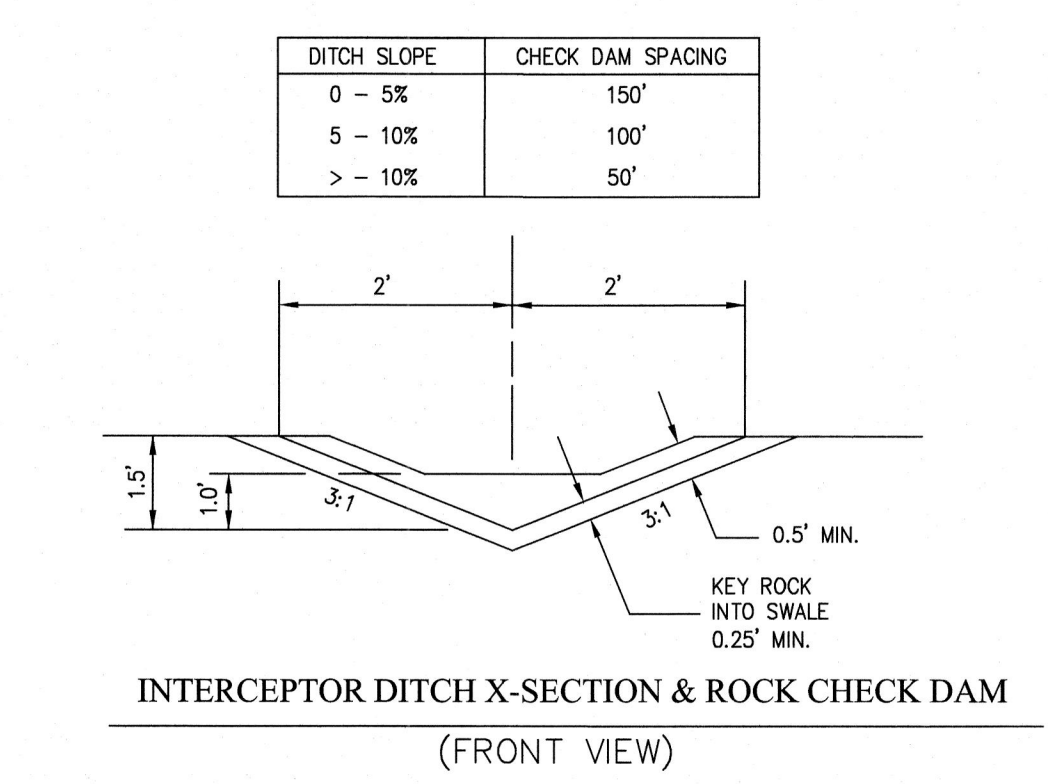

**TYPICAL INTERCEPTOR DITCH W/ROCK CHECK DAM**  
NOT TO SCALE

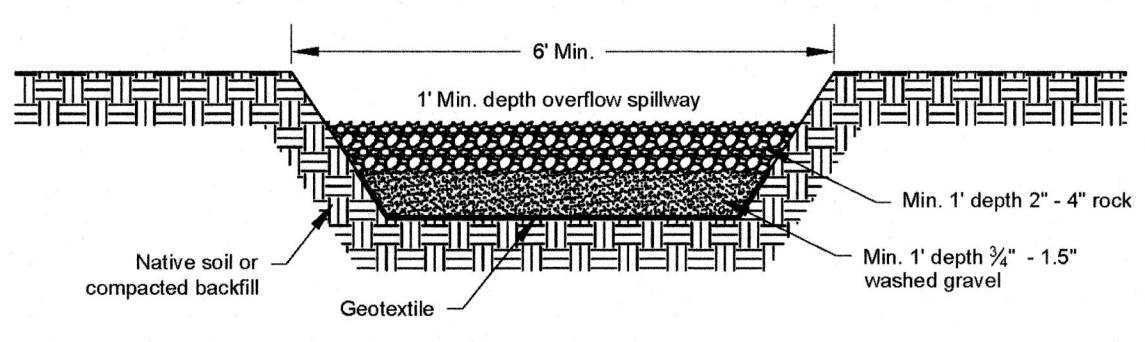

**SEDIMENT TRAP OUTLET**  
NOT TO SCALE

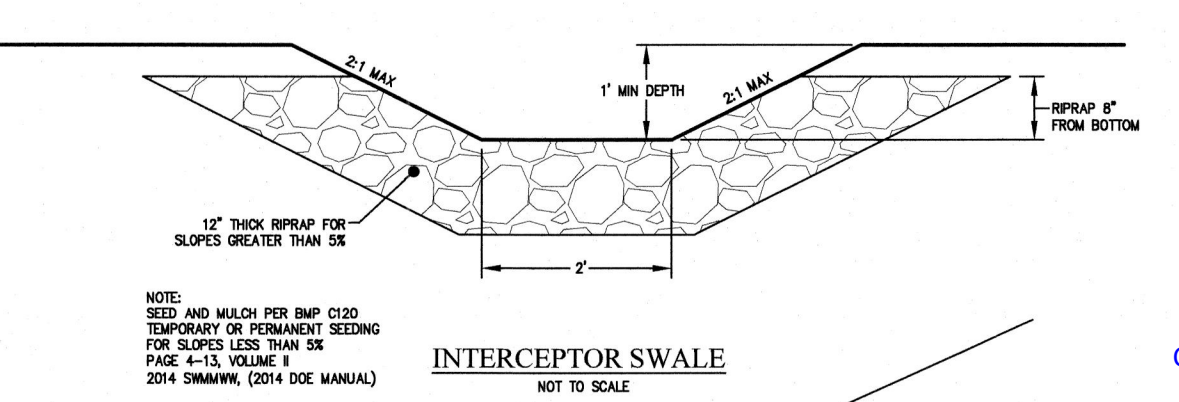

**INTERCEPTOR SWALE**  
NOT TO SCALE

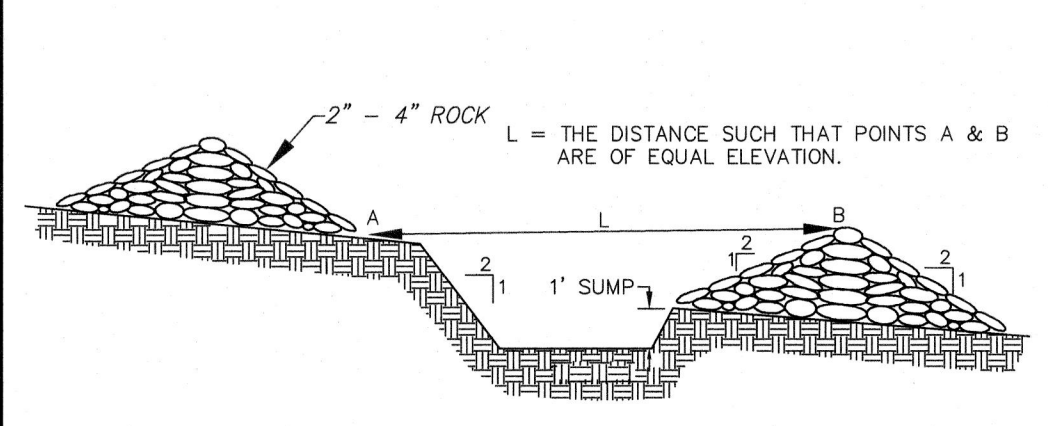

**CHECK DAMS**  
NOT TO SCALE  
(BMP E2.60)

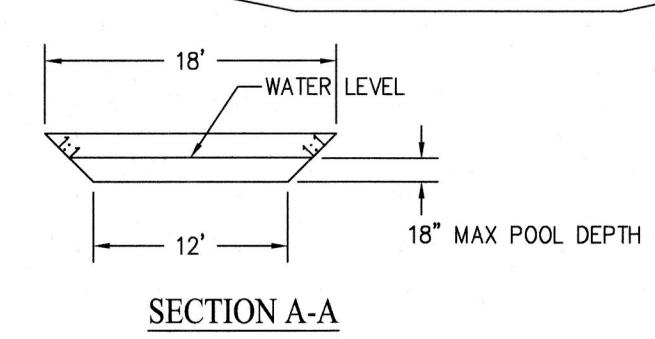
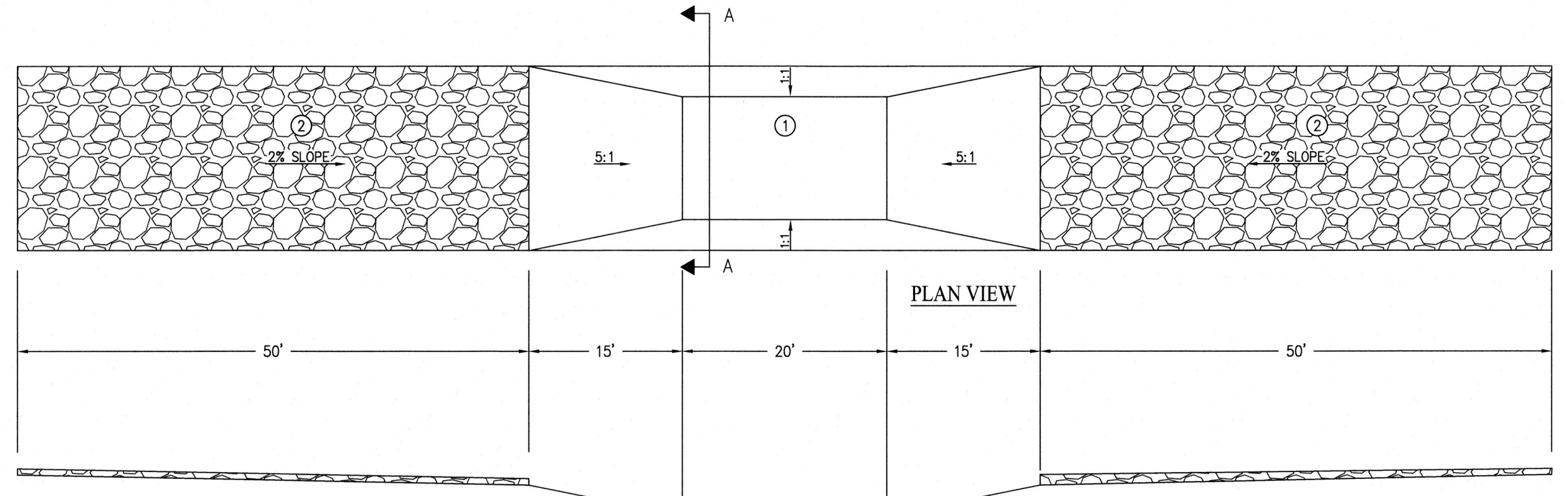

**WHEEL WASH**  
NOT TO SCALE

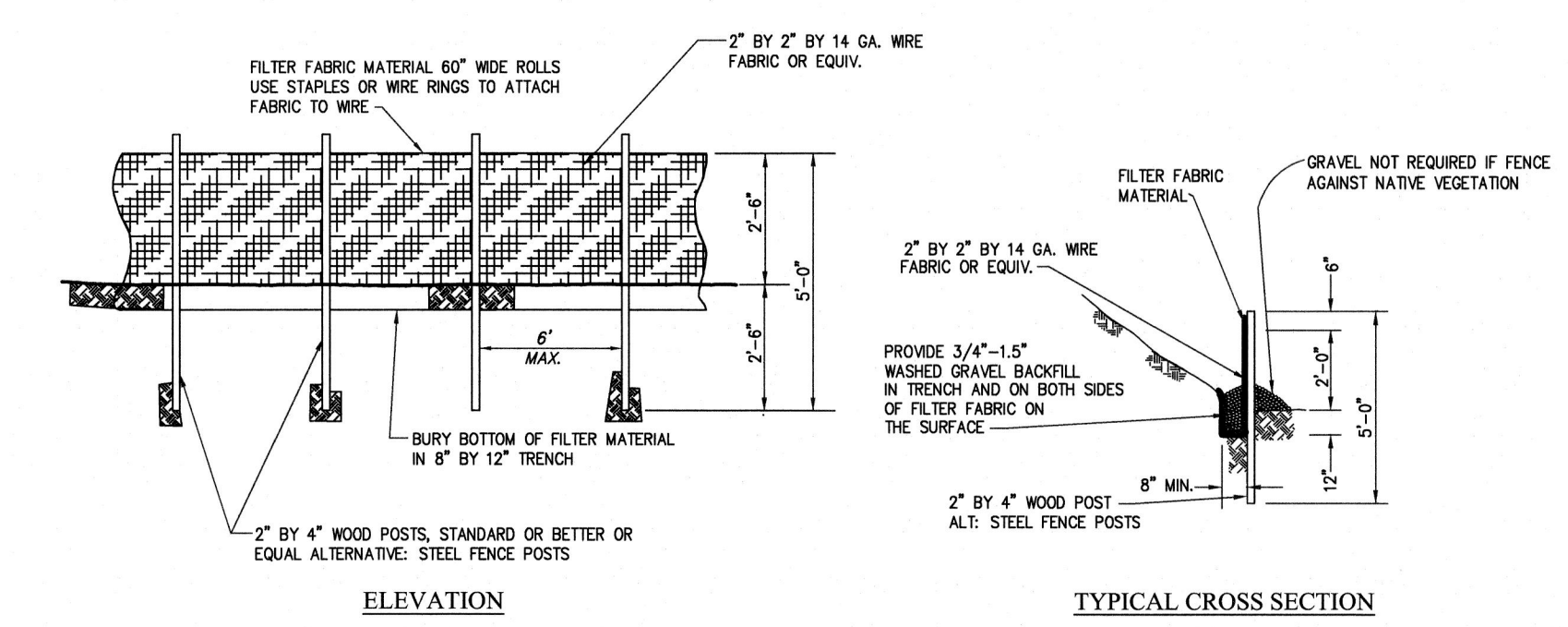

**FILTER FABRIC FENCE**  
NOT TO SCALE  
(BMP E3.10)

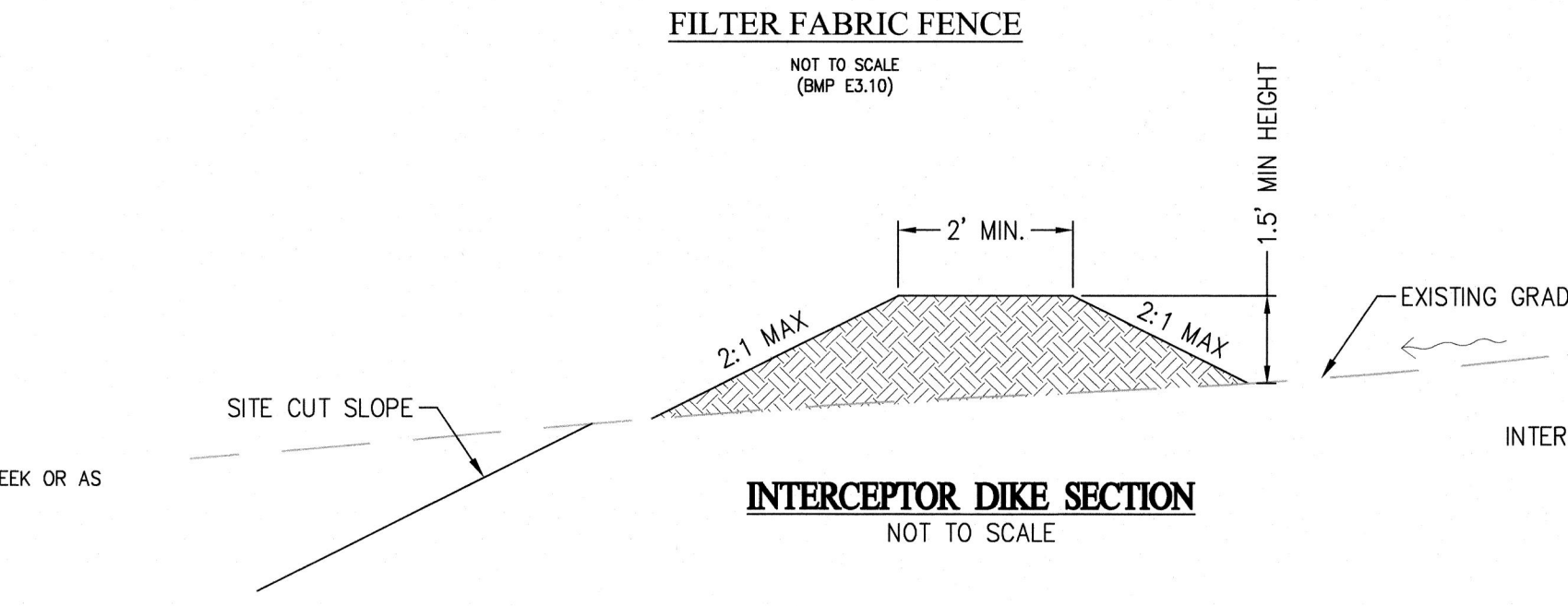

**INTERCEPTOR DIKE SECTION**  
NOT TO SCALE

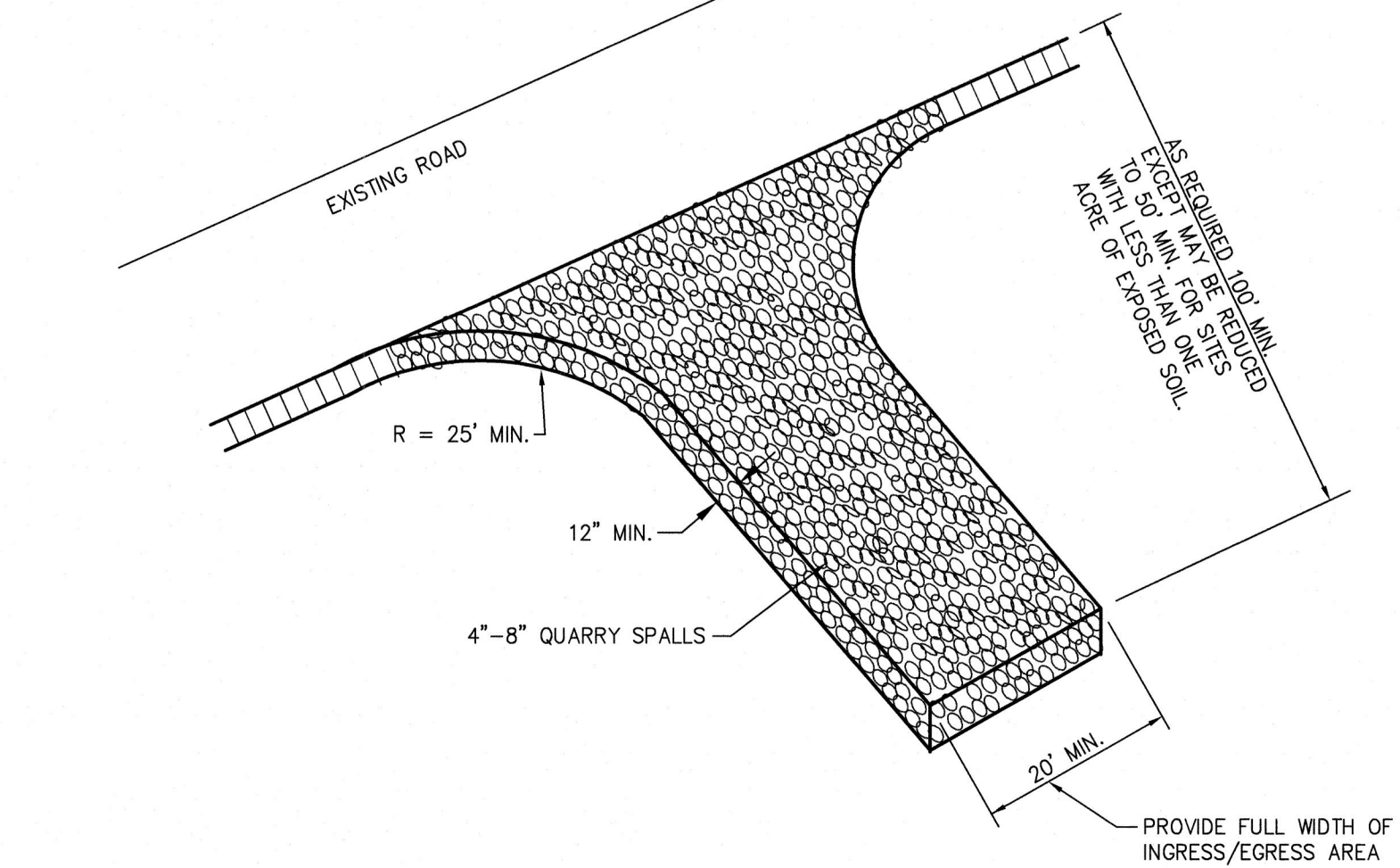

**STABILIZED CONSTRUCTION ENTRANCE**  
NOT TO SCALE  
(BMP E2.10)

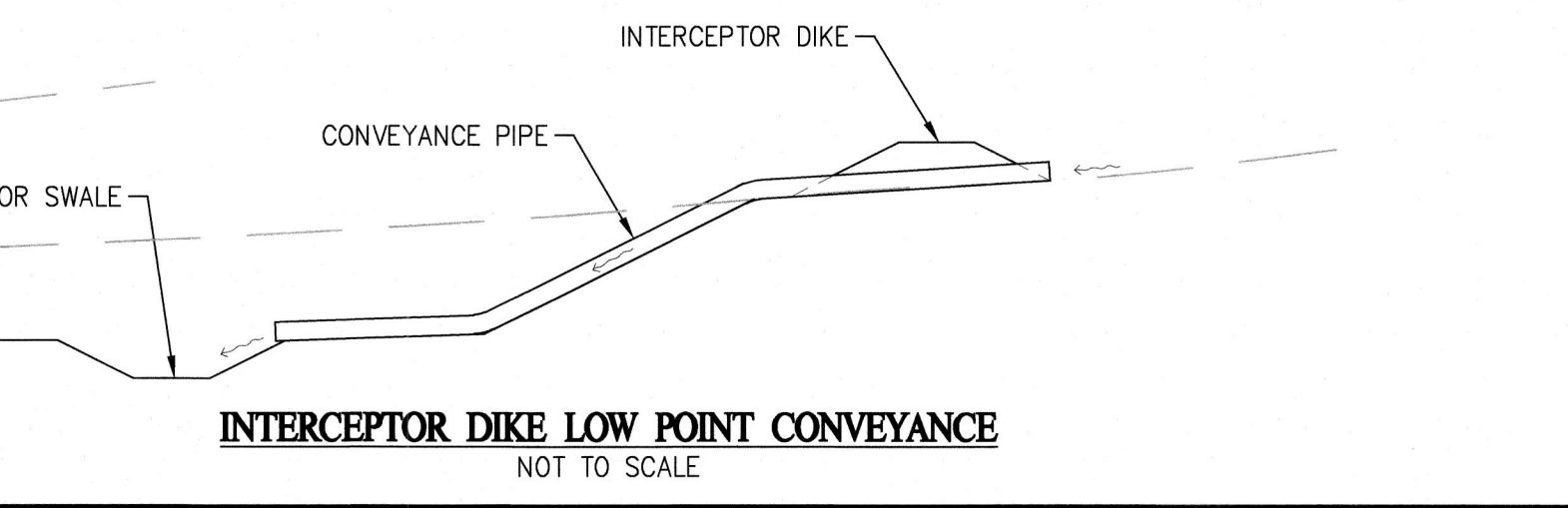

**INTERCEPTOR DIKE LOW POINT CONVEYANCE**  
NOT TO SCALE

**NOTE**  
THE APPROXIMATE LOCATION OF EXISTING UNDERGROUND UTILITIES ARE SHOWN ON THE PLANS. IT IS THE CONTRACTOR'S RESPONSIBILITY TO DETERMINE THE LOCATION OF EXISTING UTILITIES PRIOR TO COMMENCING WORK. THE CONTRACTOR SHALL BE RESPONSIBLE FOR DAMAGES THAT MIGHT BE OCCASIONED BY THE CONTRACTOR'S FAILURE TO LOCATE, PRESERVE AND PROTECT UNDERGROUND UTILITIES.

**CALL 48 HOURS BEFORE YOU DIG 811**

- NOTES:**
- ASPHALT POOL AREA, 6 IN. ASPHALT OVER 6" GRAVEL BASE
  - 50 FT. RIP-RAP APRON & 50 FT. RIP-RAP ENTRANCE.
  - DIRTY WATER TO BE PUMPED OUT AND REPLACED ONCE PER WEEK OR AS REQUIRED. WATER TO BE DISPOSED OF IN APPROVED MANNER.
  - WHEEL WASH FOR SUMMER USE ONLY.
  - DEPTH OF WATER IN WHEEL WASH POOL TO BE 18" MAXIMUM.

REVISIONS			
NO.	DATE	BY	DESCRIPTION

DESIGNED	BY	DATE
RHL	RHL	2/21
JAT	JAT	2/21
NLOII	NLOII	2/21

**N.L. Olson & Associates, Inc.**  
Engineering, Planning and Surveying  
(360) 895-2350 or (360) 876-2284  
2453 Bethel Avenue, P.O. Box 637, Port Orchard, WA 98366

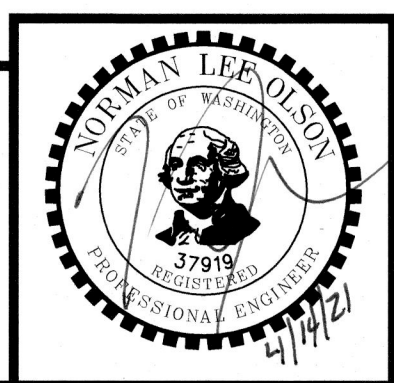

**T.E.S.C. DETAILS**  
**BRIDGE VIEW TRAIL APARTMENTS - HAROLD DR SE**  
Portion of the Southeast Quarter of Section 35,  
Township 24 North, Range 1 East, W.M. in Kitsap County, Washington

FOR: **Harbor Custom Development, Inc.**  
Attn: Sterling Griffin  
11505 Burnham Dr. Suite 301  
Gig Harbor, WA 98332

SCALE:	N.T.S.
DATE:	March 12, 2021
DRAWING NUMBER	<b>11331</b>
SHEET	C3.2



- ① SINGLE DIRECTION CURB RAMP  
PER WSDOT STANDARD PLAN F-40.16-03
- ② PARALLEL CURB RAMP  
PER WSDOT STANDARD PLAN F-40.12-03

CURB RAMP NOTES:  
1.50% OR FLATTER CROSS SLOPE RECOMMENDED FOR DESIGN/FORMWORK (2.00% MAX.)

7.50% OR FLATTER RECOMMENDED FRO DESIGN/FORMWORK (8.33% MAX.)

THE CURB RAMP LENGTH IS NOT REQUIRED TO EXCEED 15'. WHEN APPLYING THE 15' MAX. LENGTH THE RUNNING SLOPE OF THE CURB RAMP IS ALLOWED TO EXCEED 8.33%.

SEE DETAILS ON SHEET C4.4

**NOTE**

THE APPROXIMATE LOCATION OF EXISTING UNDERGROUND UTILITIES ARE SHOWN ON THE PLANS. IT IS THE CONTRACTOR'S RESPONSIBILITY TO DETERMINE THE LOCATION OF EXISTING UTILITIES PRIOR TO COMMENCING WORK. THE CONTRACTOR SHALL BE RESPONSIBLE FOR DAMAGES THAT MIGHT BE OCCASIONED BY THE CONTRACTOR'S FAILURE TO LOCATE, PRESERVE AND PROTECT UNDERGROUND UTILITIES.

**CALL 48 HOURS  
BEFORE YOU DIG  
811**

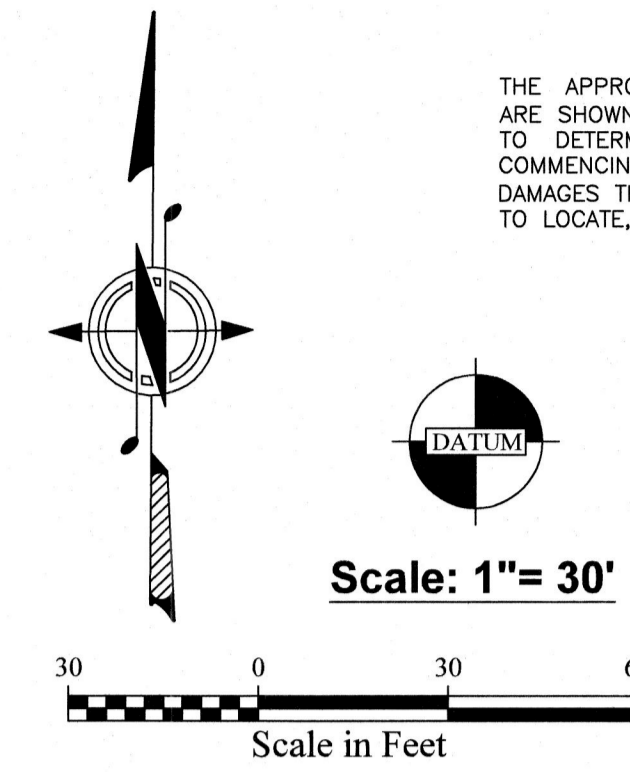

COUNTER COMPLETE  
Permit Center  
APR 21, 2021  
City of Port Orchard  
Community Development

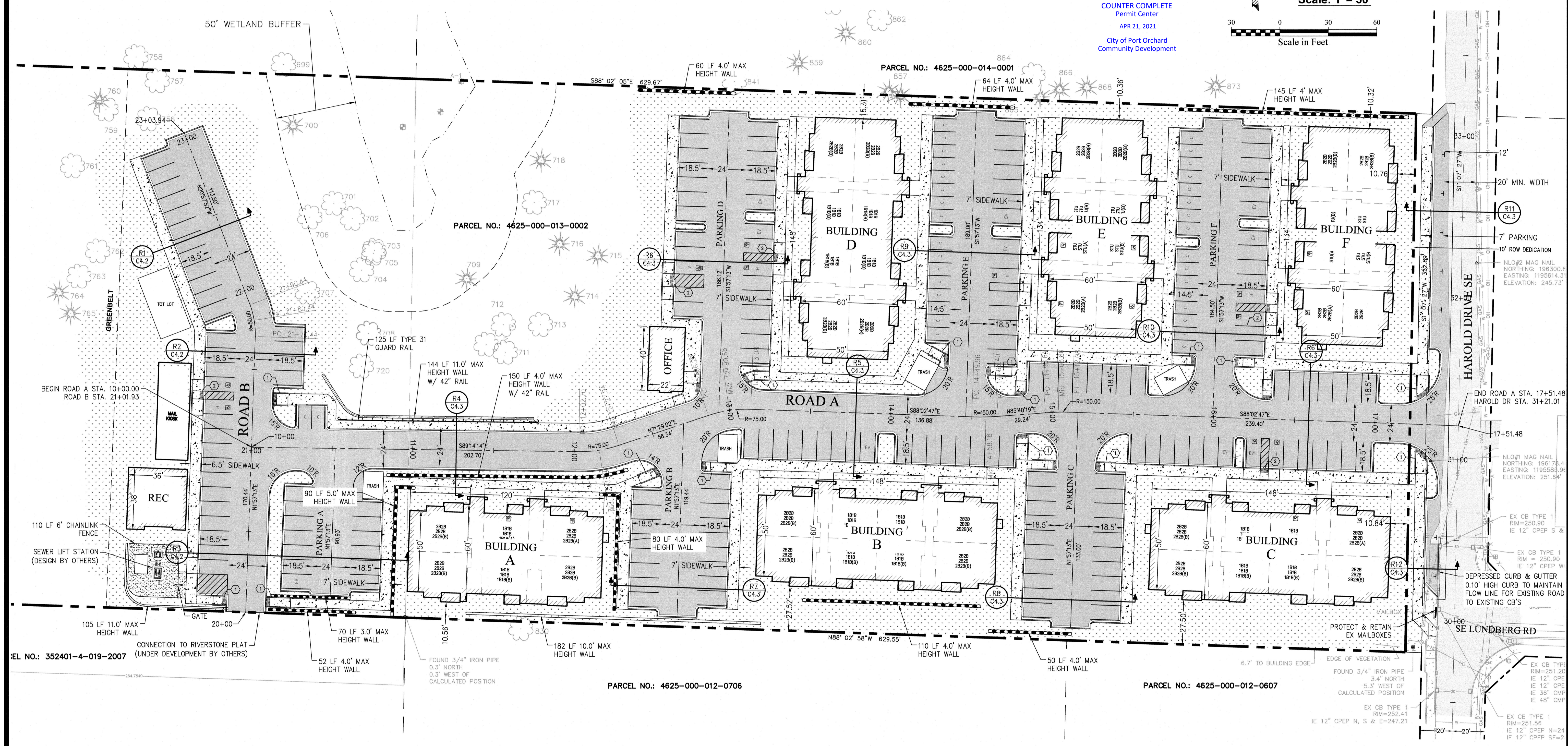

L:\11331 HAROLD DRIVE BRIDGE view APT\11331 C4.0 SITE PLAN.dwg, 4/13/2021 11:06:46 PM, DWG TO PDF.p3

REVISIONS			
NO.	DATE	BY	DESCRIPTION

DESIGNED	BY	DATE
RHL	RHL	2/21
JAT	JAT	2/21
NLOII	NLOII	2/21

**N.L. Olson & Associates, Inc.**  
Engineering, Planning and Surveying  
(360) 895-2350 or (360) 876-2284  
2453 Bethel Avenue, P.O. Box 637, Port Orchard, WA 98366

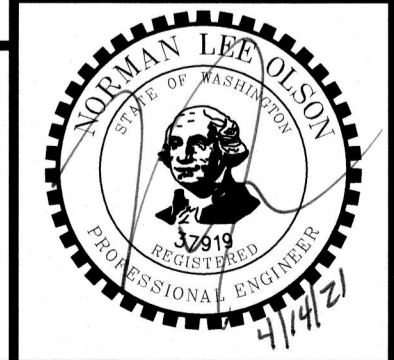

**SITE PLAN**  
**BRIDGE VIEW TRAIL APARTMENTS - HAROLD DR SE**  
Portion of the Southeast Quarter of Section 35,  
Township 24 North, Range 1 East, W.M. in Kitsap County, Washington

FOR: **Harbor Custom Development, Inc.**  
Attn: Sterling Griffin  
11505 Burnham Dr. Suite 301  
Gig Harbor, WA 98332

SCALE:	1" = 30'
DATE:	March 12, 2021
DRAWING NUMBER	<b>11331</b>
SHEET	C4.00

PW21-019  
PW21-020



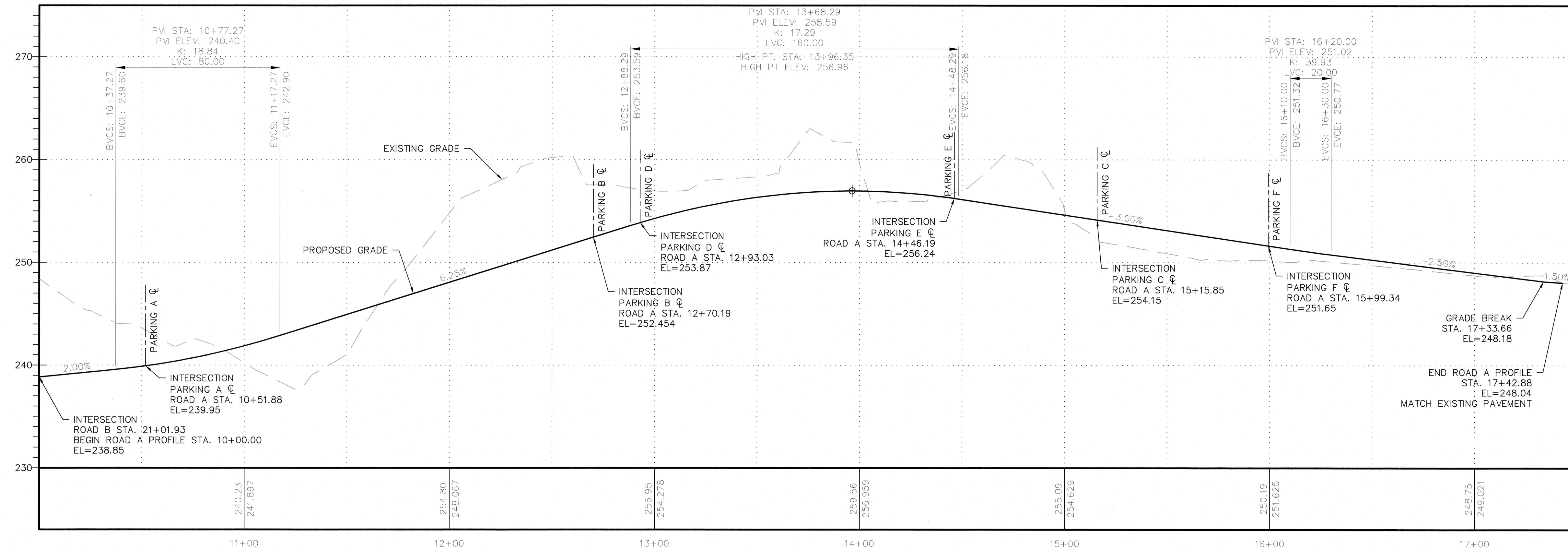

**ROAD A PROFILE**  
 SCALE HORIZ: 1"=30'  
 VERT.=1"=6'

COUNTER COMPLETE  
 Permit Center  
 APR 21, 2021  
 City of Port Orchard  
 Community Development

**NOTE**

THE APPROXIMATE LOCATION OF EXISTING UNDERGROUND UTILITIES ARE SHOWN ON THE PLANS. IT IS THE CONTRACTOR'S RESPONSIBILITY TO DETERMINE THE LOCATION OF EXISTING UTILITIES PRIOR TO COMMENCING WORK. THE CONTRACTOR SHALL BE RESPONSIBLE FOR DAMAGES THAT MIGHT BE OCCASIONED BY THE CONTRACTOR'S FAILURE TO LOCATE, PRESERVE AND PROTECT UNDERGROUND UTILITIES.

**CALL 48 HOURS  
 BEFORE YOU DIG  
 811**



Scale: 1" = 30'

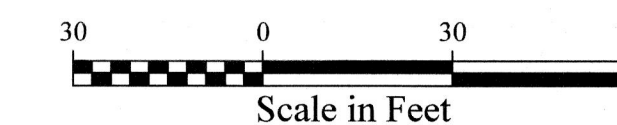

REVISIONS				BY	DATE
NO.	DATE	BY	DESCRIPTION	DESIGNED	RHL 2/21
				DRAWN	JAT 2/21
				CHECKED	NLOII 2/21
				APPROVED	
				ACCEPTED	

**N.L. Olson & Associates, Inc.**  
 Engineering, Planning and Surveying  
 (360) 895-2350 or (360) 876-2284  
 2453 Bethel Avenue, P.O. Box 637, Port Orchard, WA 98366

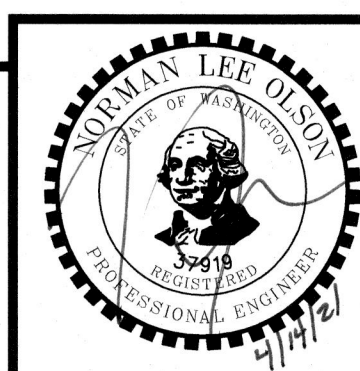

**ROAD A PROFILE**  
**BRIDGE VIEW TRAIL APARTMENTS - HAROLD DR SE**  
 Portion of the Southeast Quarter of Section 35,  
 Township 24 North, Range 1 East, W.M. in Kitsap County, Washington

FOR: **Harbor Custom Development, Inc.**  
 Attn: Sterling Griffin  
 11505 Burnham Dr. Suite 301  
 Gig Harbor, WA 98332

SCALE:	1" = 30'
DATE:	March 12, 2021
DRAWING NUMBER	<b>11331</b>
SHEET	C4.1