

# LIPPERT PAVEMENT REPAIR AND SIDEWALK RETROFIT

## CITY OF PORT ORCHARD PUBLIC WORKS DEPARTMENT

### SHEET INDEX

SHEET TITLE	DRAWING #	SHEET #
COVER SHEET	CV1	1
SITE PREPARATION PLAN	SP1-SP3	2-4
PAVING PLAN	PV1-PV3	5-7
CHANNELIZATION AND SIGNING PLAN	CH1-CH3	8-10

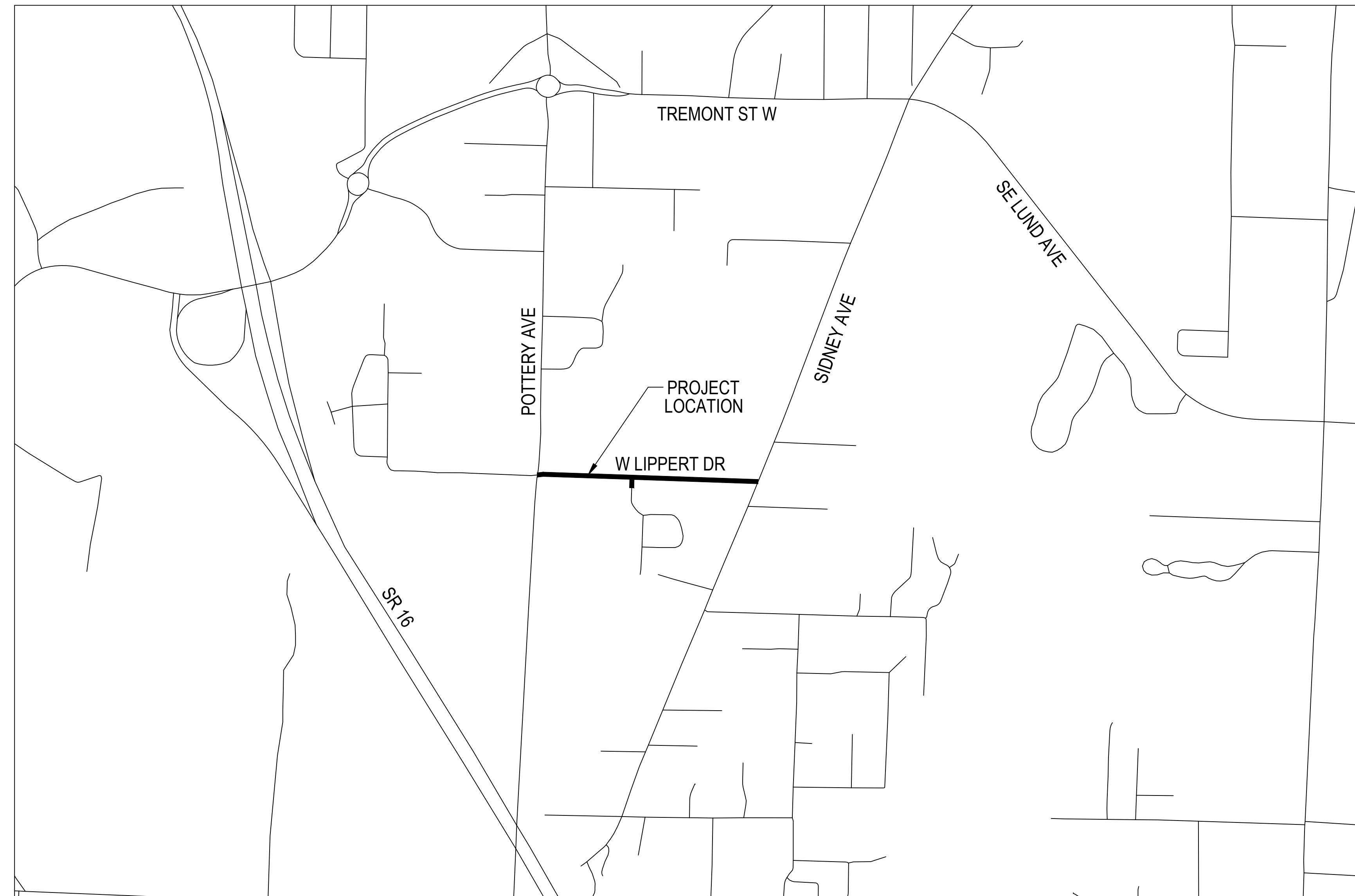

VICINITY MAP  
N.T.S

APPROVED BY: \_\_\_\_\_ DATE \_\_\_\_\_  
MARK R. DORSEY, P.E.  
PUBLIC WORKS DIRECTOR/CITY ENGINEER  
CITY OF PORT ORCHARD

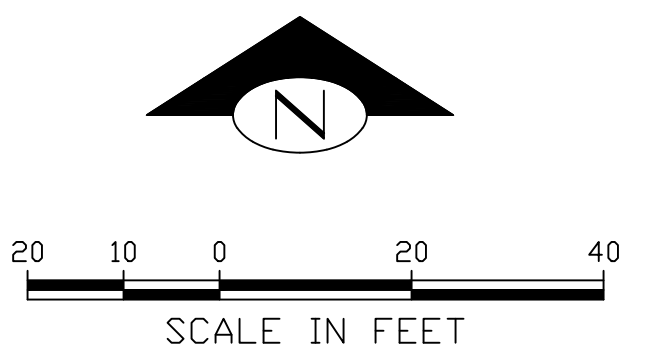

CITY OF PORT ORCHARD CAPITAL PROJECTS  
216 PROSPECT STREET, PORT ORCHARD, WA 98366  
PHONE: 360.876.4991

NAME OR INITIALS AND DATE		NAME OR INITIALS AND DATE	
DESIGNED	CAW NOV 2021	PROJECT MANAGER:	K. CHRIS HAMMER
CHECKED	KCH NOV 2021	REVIEWED:	NOV 2021
DRAWN	CAW NOV 2021	REVISED AS-BUILT	
CHECKED	KCH NOV 2021		

All work done in accordance with the City of Port Orchard Public Works Engineering Standards and Specifications in effect on the date shown above, and supplemented by Project Provisions.



LIPPERT PAVEMENT REPAIR AND SIDEWALK  
RETROFIT  
COVER SHEET

PLAN NO.  
**CV1**  
SHEET  
1 OF 10

DESIGN'D CHECK'D REVIEW'D  
REVISION TYPE REVISIONS  
DATE

Engineer's Stamp

SEC. 2 T.23N. R.1E. W.M.





GENERAL NOTES:

1. FULL DEPTH PAVEMENT DIG OUTS SHALL BE COORDINATED WITH THE CITY OF PORT ORCHARD ENGINEER.
2. STORM DRAIN INLET PROTECTION PER WSDOT STD. PLAN I-40.20 SHALL BE INSTALLED ON ALL NEW CATCH BASINS AT THE TIME OF INSTALLATION AND IN ALL EXISTING CATCH BASINS BEFORE COMMENCING WORK PER THESE PLANS.
3. IT SHALL BE THE CONTRACTOR'S RESPONSIBILITY TO OBTAIN EXISTING HORIZONTAL AND VERTICAL CURB RETURN INFORMATION REQUIRED TO REPLACE EXISTING CURB AND GUTTER IN THE SAME LOCATION.
4. APPROXIMATE CLEARING AND GRUBBING LIMITS ARE SHOWN ON THE PLAN. ACTUAL CLEARING AND GRUBBING LIMITS WILL BE STAKED BY THE CONTRACTOR AND APPROVED BY THE ENGINEER. TREES WITHIN THE CLEARING AND GRUBBING LIMITS SHALL BE PROTECTED UNLESS SHOWN ON THE PLANS AS TO BE REMOVED.
5. THE CONTRACTOR SHALL KEEP A MINIMUM 4 FOOT WIDE ACCESSIBLE PATHWAY AT ALL TIMES ON BOTH SIDES OF THE ROADWAY, THROUGH THE SITE OR AS DIRECTED BY THE ENGINEER.
6. ADDITIONAL SAWCUT MAY BE REQUIRED FOR UTILITIES AND/OR PAVING WORK.
7. ALL ITEMS SHALL BE PROTECTED AND MAINTAINED UNLESS OTHERWISE NOTED.
8. REMOVE EXISTING IRRIGATION HEADS, VALVES, AND ALL OTHER RELATED IRRIGATION EQUIPMENT AS NECESSARY FOR CONSTRUCTION WORK. CAP EXISTING IRRIGATION LINES AT RIGHT-OF-WAY LINE. IRRIGATION SHALL BE REINSTALLED AND DEEMED OPERATIONAL BY COPO MAINTENANCE PERSONNEL PRIOR TO PROJECT ACCEPTANCE.
9. ALL SIDEWALK MATCH-IN LOCATIONS SHALL PROVIDE A SAWCUT AT THE NEAREST JOINT.
10. CONTRACTOR SHALL COORDINATE WITH KITSAP TRANSIT ON SHELTER RELOCATION AND TEMPORARY BUS STOP LOCATION A MINIMUM OF 5 BUSINESS DAYS PRIOR TO SHELTER REMOVAL.
11. CONSTRUCTION ENTRANCE SHALL BE INSTALLED PER WSDOT STD. PLAN I-80.10.
12. STORMWATER AND EROSION CONTROL BMP'S SHALL BE FOLLOWED IN ACCORDANCE WITH THE 2014 STORMWATER MANAGEMENT MANUAL FOR WESTERN WASHINGTON.

CONSTRUCTION NOTES:

- ① INSTALL INLET PROTECTION PER WSDOT STD. PLAN I-40.20
- ② SAWCUT
- ③ REMOVE EXISTING FENCE AND POSTS AS DIRECTED BY THE ENGINEER
- ④ PROTECT AND MAINTAIN EXISTING UTILITY POLE
- ⑤ REMOVE EXISTING CURB AND GUTTER (INCL. IN ROADWAY EXCAVATION INCL. HAUL)
- ⑥ REMOVE EXISTING CURB (INCL. IN ROADWAY EXCAVATION INCL. HAUL)
- ⑦ PROTECT AND MAINTAIN EXISTING POWER PEDESTAL
- ⑧ PROTECT AND MAINTAIN EXISTING ASPHALT WEDGE
- ⑨ EXISTING BUS SHELTER TO BE REMOVED AND RELOCATED BY KITSAP TRANSIT

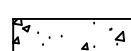
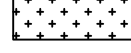
LEGEND:

-  ROADWAY EXCAVATION INCL. HAUL
-  PLANING BITUMINOUS PAVEMENT - 2" AT EDGES, 0" IN CENTER. SEE SECTION AND BUTT JOINT DETAILS ON PV1
-  REMOVING CEMENT CONC. SIDEWALK
-  CLEARING AND GRUBBING
-  SAWCUTTING

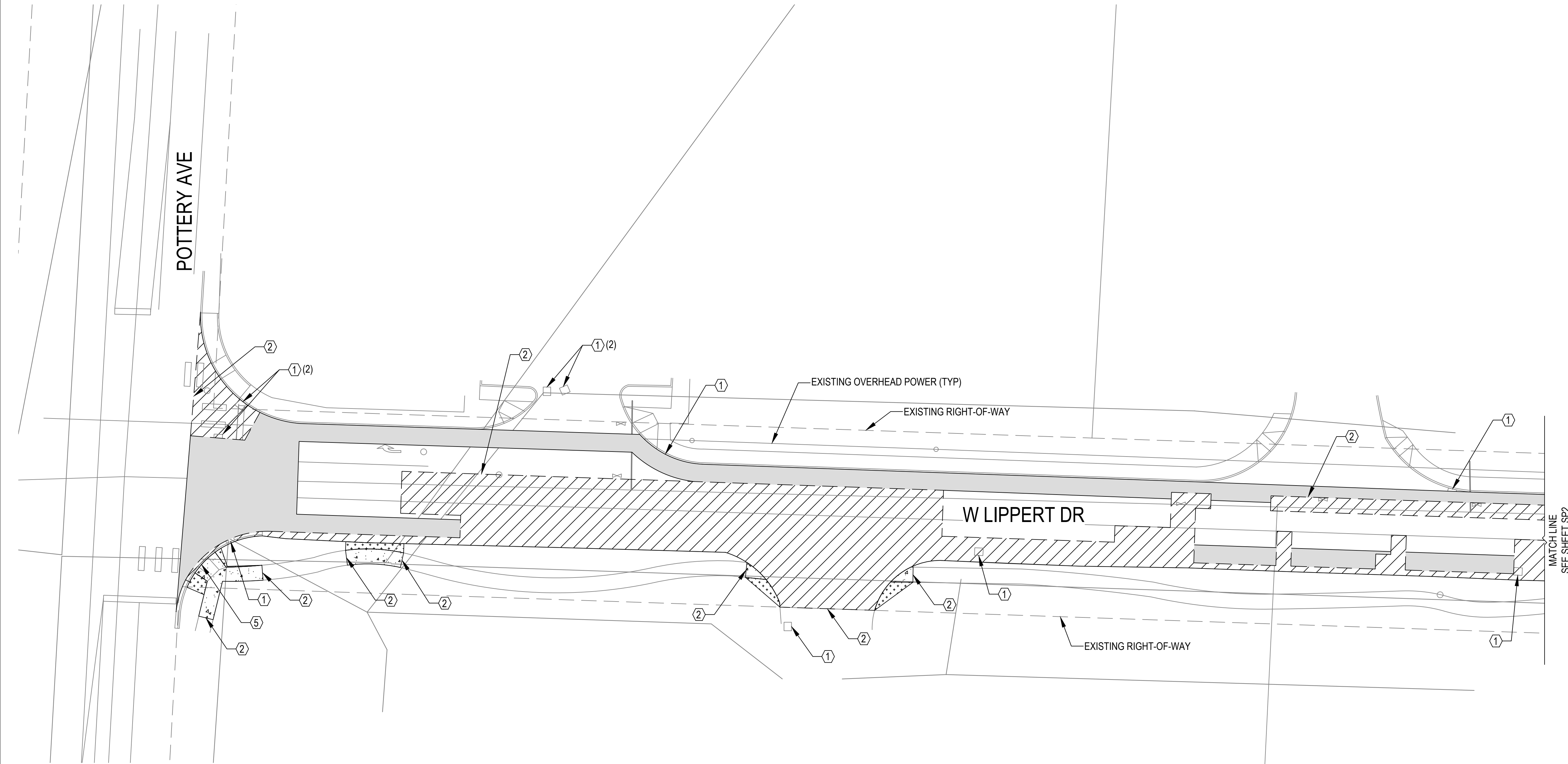

DESIGN'D	CHECK'D	REVIEW'D
REVISION	TYPE	REVISIONS
DATE		

DISCLAIMER: THIS PLAN WAS DEVELOPED FROM CITY OF PORT ORCHARD AND KITSAP COUNTY GIS INFORMATION ALONG WITH AERIAL IMAGERY AND MAY NOT REPRESENT TRUE CONDITIONS IN THE FIELD.

CITY OF PORT ORCHARD CAPITAL PROJECTS  
 216 PROSPECT STREET, PORT ORCHARD, WA 98366  
 PHONE: 360.876.4991

NAME OR INITIALS AND DATE		NAME OR INITIALS AND DATE	
DESIGNED	CAW NOV 2021	PROJECT MANAGER:	K. CHRIS HAMMER
CHECKED	KCH NOV 2021	REVIEWED:	NOV 2021
DRAWN	CAW NOV 2021	REVISED AS-BUILT	
CHECKED	KCH NOV 2021		



LIPPERT PAVEMENT REPAIR AND SIDEWALK  
 RETROFIT  
 SITE PREPARATION PLAN

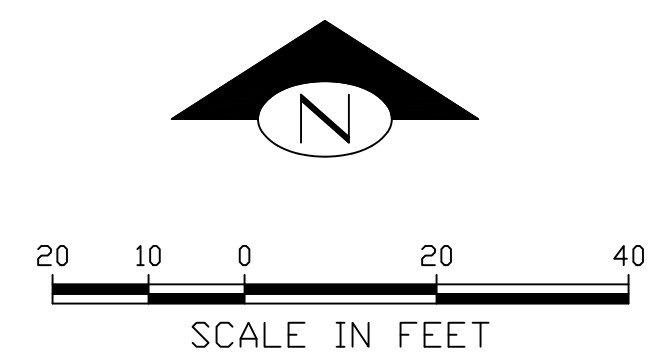

PLAN NO.  
**SP1**  
 SHEET  
 2 OF 10

Engineer's Stamp

All work done in accordance with the City of Port Orchard Public Works Engineering Standards and Specifications in effect on the date shown above, and supplemented by Project Provisions.



SEC. 2 T.23N. R.1E. W.M.



GENERAL NOTES:

1. FULL DEPTH PAVEMENT DIG OUTS SHALL BE COORDINATED WITH THE CITY OF PORT ORCHARD ENGINEER.
2. STORM DRAIN INLET PROTECTION PER WSDOT STD. PLAN I-40.20 SHALL BE INSTALLED ON ALL NEW CATCH BASINS AT THE TIME OF INSTALLATION AND IN ALL EXISTING CATCH BASINS BEFORE COMMENCING WORK PER THESE PLANS.
3. IT SHALL BE THE CONTRACTOR'S RESPONSIBILITY TO OBTAIN EXISTING HORIZONTAL AND VERTICAL CURB RETURN INFORMATION REQUIRED TO REPLACE EXISTING CURB AND GUTTER IN THE SAME LOCATION.
4. APPROXIMATE CLEARING AND GRUBBING LIMITS ARE SHOWN ON THE PLAN. ACTUAL CLEARING AND GRUBBING LIMITS WILL BE STAKED BY THE CONTRACTOR AND APPROVED BY THE ENGINEER. TREES WITHIN THE CLEARING AND GRUBBING LIMITS SHALL BE PROTECTED UNLESS SHOWN ON THE PLANS AS TO BE REMOVED.
5. THE CONTRACTOR SHALL KEEP A MINIMUM 4 FOOT WIDE ACCESSIBLE PATHWAY AT ALL TIMES ON BOTH SIDES OF THE ROADWAY, THROUGH THE SITE OR AS DIRECTED BY THE ENGINEER.
6. ADDITIONAL SAWCUT MAY BE REQUIRED FOR UTILITIES AND/OR PAVING WORK.
7. ALL ITEMS SHALL BE PROTECTED AND MAINTAINED UNLESS OTHERWISE NOTED.
8. REMOVE EXISTING IRRIGATION HEADS, VALVES, AND ALL OTHER RELATED IRRIGATION EQUIPMENT AS NECESSARY FOR CONSTRUCTION WORK. CAP EXISTING IRRIGATION LINES AT RIGHT-OF-WAY LINE. IRRIGATION SHALL BE REINSTALLED AND DEEMED OPERATIONAL BY COPO MAINTENANCE PERSONNEL PRIOR TO PROJECT ACCEPTANCE.
9. ALL SIDEWALK MATCH-IN LOCATIONS SHALL PROVIDE A SAWCUT AT THE NEAREST JOINT.
10. CONTRACTOR SHALL COORDINATE WITH KITSAP TRANSIT ON SHELTER RELOCATION AND TEMPORARY BUS STOP LOCATION A MINIMUM OF 5 BUSINESS DAYS PRIOR TO SHELTER REMOVAL.
11. CONSTRUCTION ENTRANCE SHALL BE INSTALLED PER WSDOT STD. PLAN I-80.10.
12. STORMWATER AND EROSION CONTROL BMP'S SHALL BE FOLLOWED IN ACCORDANCE WITH THE 2014 STORMWATER MANAGEMENT MANUAL FOR WESTERN WASHINGTON.

CONSTRUCTION NOTES:

- ① INSTALL INLET PROTECTION PER WSDOT STD. PLAN I-40.20
- ② SAWCUT
- ③ REMOVE EXISTING FENCE AND POSTS AS DIRECTED BY THE ENGINEER
- ④ PROTECT AND MAINTAIN EXISTING UTILITY POLE
- ⑤ REMOVE EXISTING CURB AND GUTTER (INCL. IN ROADWAY EXCAVATION INCL. HAUL)
- ⑥ REMOVE EXISTING CURB (INCL. IN ROADWAY EXCAVATION INCL. HAUL)
- ⑦ PROTECT AND MAINTAIN EXISTING POWER PEDESTAL
- ⑧ PROTECT AND MAINTAIN EXISTING ASPHALT WEDGE
- ⑨ EXISTING BUS SHELTER TO BE REMOVED AND RELOCATED BY KITSAP TRANSIT

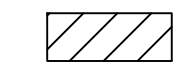
LEGEND:

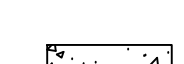
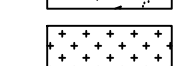
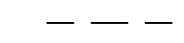
-  ROADWAY EXCAVATION INCL. HAUL
-  PLANING BITUMINOUS PAVEMENT - 2" AT EDGES, 0" IN CENTER. SEE SECTION AND BUTT JOINT DETAILS ON PV1
-  REMOVING CEMENT CONC. SIDEWALK
-  CLEARING AND GRUBBING
-  SAWCUTTING

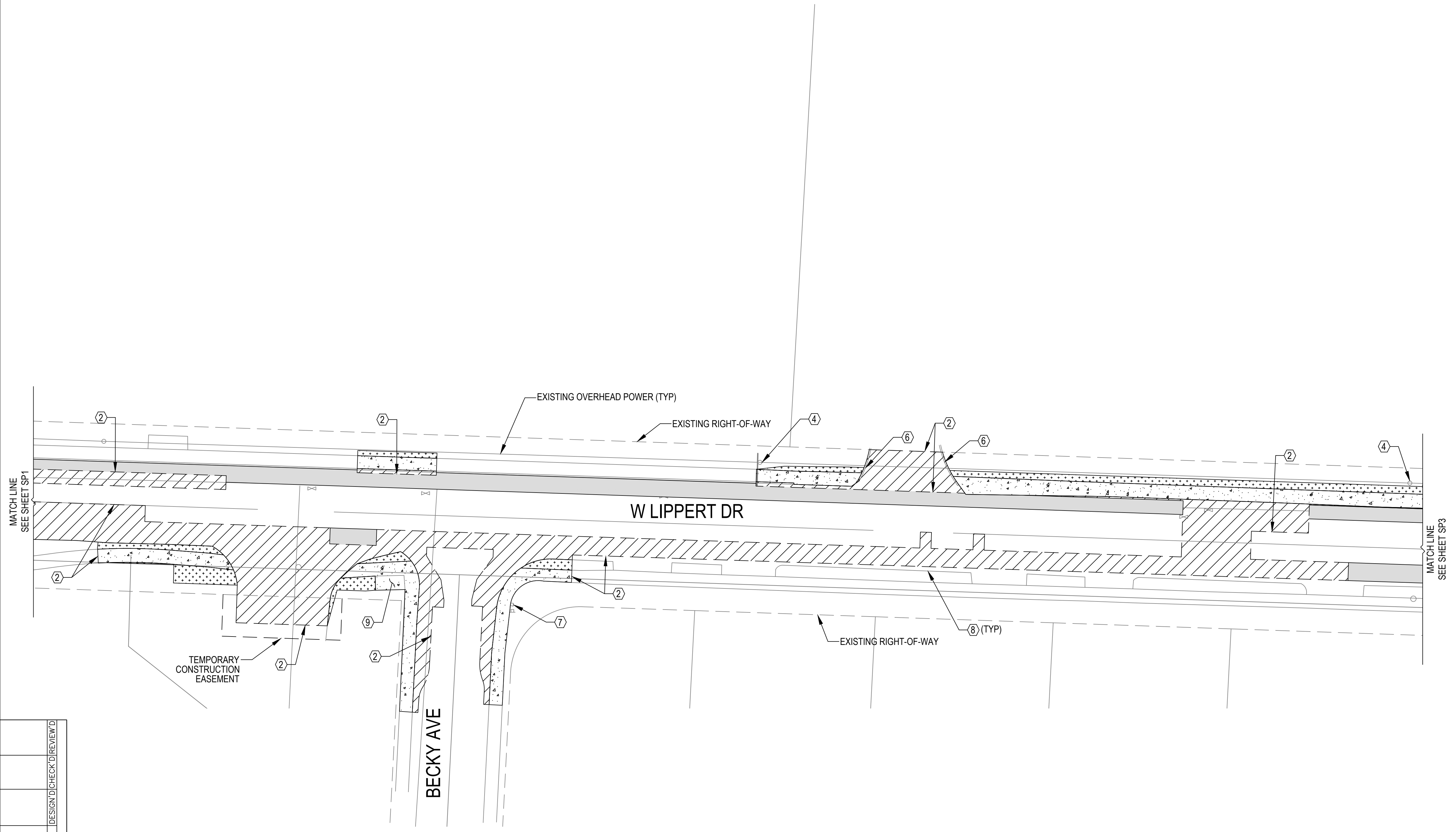

DESIGN'D	CHECK'D	REVIEW'D
DATE	REVISION	TYPE
		REVISIONS

DISCLAIMER: THIS PLAN WAS DEVELOPED FROM CITY OF PORT ORCHARD AND KITSAP COUNTY GIS INFORMATION ALONG WITH AERIAL IMAGERY AND MAY NOT REPRESENT TRUE CONDITIONS IN THE FIELD.

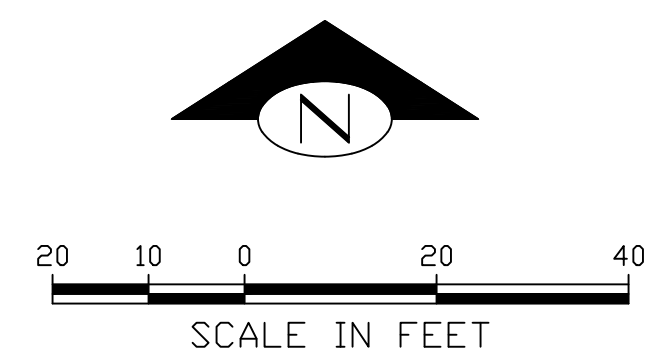

Engineer's Stamp

CITY OF PORT ORCHARD CAPITAL PROJECTS  
 216 PROSPECT STREET, PORT ORCHARD, WA 98366  
 PHONE: 360.876.4991

NAME OR INITIALS AND DATE		NAME OR INITIALS AND DATE	
DESIGNED	CAW NOV 2021	PROJECT MANAGER:	K. CHRIS HAMMER
CHECKED	KCH NOV 2021	REVIEWED:	NOV 2021
DRAWN	CAW NOV 2021	REVISED AS-BUILT	
CHECKED	KCH NOV 2021		



LIPPERT PAVEMENT REPAIR AND SIDEWALK  
 RETROFIT  
 SITE PREPARATION PLAN

PLAN NO.  
**SP2**  
 SHEET  
 3 OF 10

SEC. 2 T.23N. R.1E. W.M.



GENERAL NOTES:

1. FULL DEPTH PAVEMENT DIG OUTS SHALL BE COORDINATED WITH THE CITY OF PORT ORCHARD ENGINEER.
2. STORM DRAIN INLET PROTECTION PER WSDOT STD. PLAN I-40.20 SHALL BE INSTALLED ON ALL NEW CATCH BASINS AT THE TIME OF INSTALLATION AND IN ALL EXISTING CATCH BASINS BEFORE COMMENCING WORK PER THESE PLANS.
3. IT SHALL BE THE CONTRACTOR'S RESPONSIBILITY TO OBTAIN EXISTING HORIZONTAL AND VERTICAL CURB RETURN INFORMATION REQUIRED TO REPLACE EXISTING CURB AND GUTTER IN THE SAME LOCATION.
4. APPROXIMATE CLEARING AND GRUBBING LIMITS ARE SHOWN ON THE PLAN. ACTUAL CLEARING AND GRUBBING LIMITS WILL BE STAKED BY THE CONTRACTOR AND APPROVED BY THE ENGINEER. TREES WITHIN THE CLEARING AND GRUBBING LIMITS SHALL BE PROTECTED UNLESS SHOWN ON THE PLANS AS TO BE REMOVED.
5. THE CONTRACTOR SHALL KEEP A MINIMUM 4 FOOT WIDE ACCESSIBLE PATHWAY AT ALL TIMES ON BOTH SIDES OF THE ROADWAY, THROUGH THE SITE OR AS DIRECTED BY THE ENGINEER.
6. ADDITIONAL SAWCUT MAY BE REQUIRED FOR UTILITIES AND/OR PAVING WORK.
7. ALL ITEMS SHALL BE PROTECTED AND MAINTAINED UNLESS OTHERWISE NOTED.
8. REMOVE EXISTING IRRIGATION HEADS, VALVES, AND ALL OTHER RELATED IRRIGATION EQUIPMENT AS NECESSARY FOR CONSTRUCTION WORK. CAP EXISTING IRRIGATION LINES AT RIGHT-OF-WAY LINE. IRRIGATION SHALL BE REINSTALLED AND DEEMED OPERATIONAL BY COPO MAINTENANCE PERSONNEL PRIOR TO PROJECT ACCEPTANCE.
9. ALL SIDEWALK MATCH-IN LOCATIONS SHALL PROVIDE A SAWCUT AT THE NEAREST JOINT.
10. CONTRACTOR SHALL COORDINATE WITH KITSAP TRANSIT ON SHELTER RELOCATION AND TEMPORARY BUS STOP LOCATION A MINIMUM OF 5 BUSINESS DAYS PRIOR TO SHELTER REMOVAL.
11. CONSTRUCTION ENTRANCE SHALL BE INSTALLED PER WSDOT STD. PLAN I-80.10.
12. STORMWATER AND EROSION CONTROL BMP'S SHALL BE FOLLOWED IN ACCORDANCE WITH THE 2014 STORMWATER MANAGEMENT MANUAL FOR WESTERN WASHINGTON.

CONSTRUCTION NOTES:

- ① INSTALL INLET PROTECTION PER WSDOT STD. PLAN I-40.20
- ② SAWCUT
- ③ REMOVE EXISTING FENCE AND POSTS AS DIRECTED BY THE ENGINEER
- ④ PROTECT AND MAINTAIN EXISTING UTILITY POLE
- ⑤ REMOVE EXISTING CURB AND GUTTER (INCL. IN ROADWAY EXCAVATION INCL. HAUL)
- ⑥ REMOVE EXISTING CURB (INCL. IN ROADWAY EXCAVATION INCL. HAUL)
- ⑦ PROTECT AND MAINTAIN EXISTING POWER PEDESTAL
- ⑧ PROTECT AND MAINTAIN EXISTING ASPHALT WEDGE
- ⑨ EXISTING BUS SHELTER TO BE REMOVED AND RELOCATED BY KITSAP TRANSIT

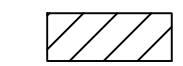
LEGEND:

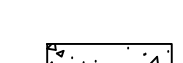
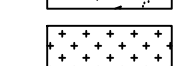
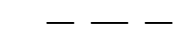
-  ROADWAY EXCAVATION INCL. HAUL
-  PLANING BITUMINOUS PAVEMENT - 2" AT EDGES, 0" IN CENTER. SEE SECTION AND BUTT JOINT DETAILS ON PV1
-  REMOVING CEMENT CONC. SIDEWALK
-  CLEARING AND GRUBBING
-  SAWCUTTING

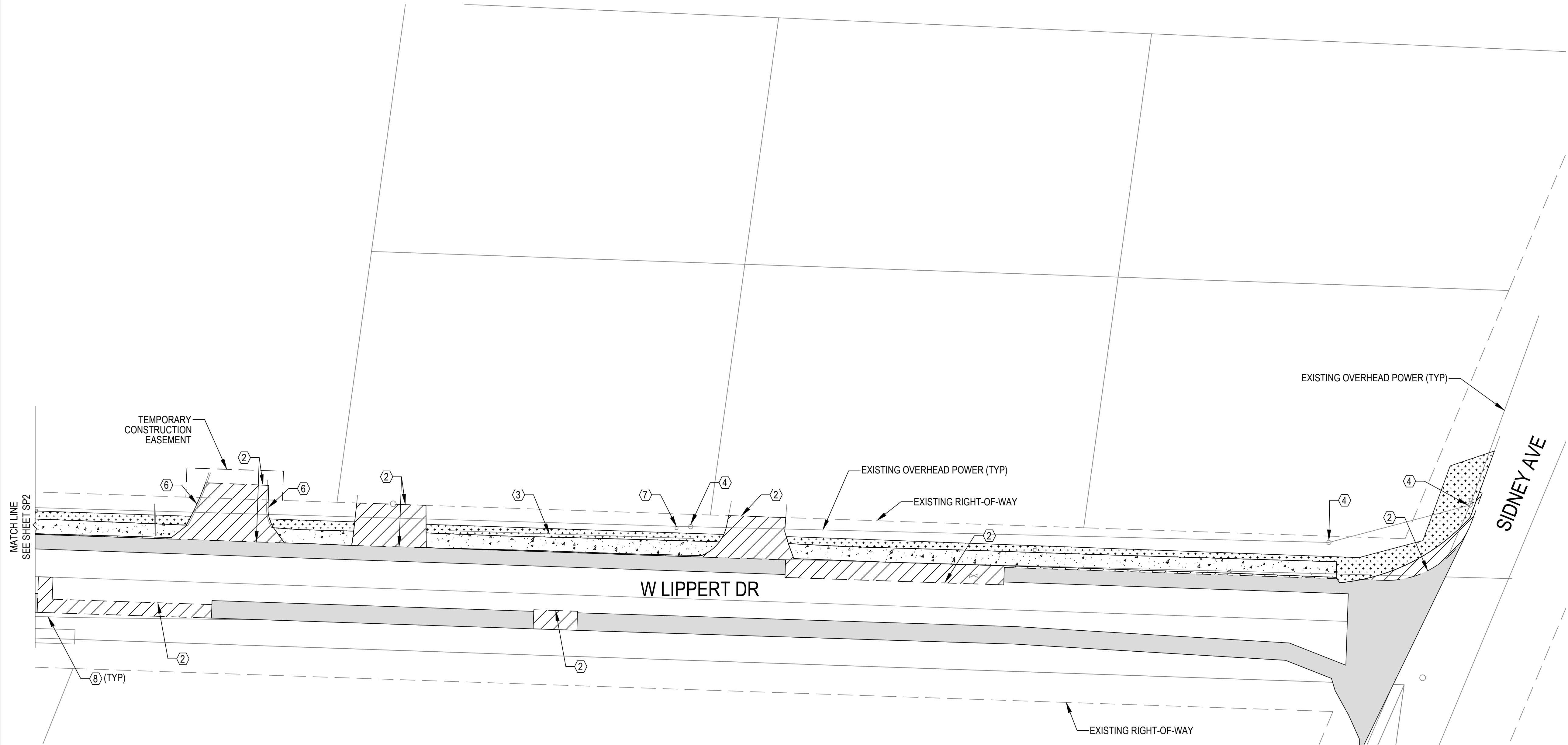

DESIGN'D	CHECK'D	REVIEW'D
REVISION	TYPE	REVISIONS
DATE		

DISCLAIMER: THIS PLAN WAS DEVELOPED FROM CITY OF PORT ORCHARD AND KITSAP COUNTY GIS INFORMATION ALONG WITH AERIAL IMAGERY AND MAY NOT REPRESENT TRUE CONDITIONS IN THE FIELD.

Engineer's Stamp

CITY OF PORT ORCHARD CAPITAL PROJECTS  
 216 PROSPECT STREET, PORT ORCHARD, WA 98366  
 PHONE: 360.876.4991

NAME OR INITIALS AND DATE		NAME OR INITIALS AND DATE	
DESIGNED	CAW NOV 2021	PROJECT MANAGER:	K. CHRIS HAMMER
CHECKED	KCH NOV 2021	REVIEWED:	NOV 2021
DRAWN	CAW NOV 2021	REVISED AS-BUILT	
CHECKED	KCH NOV 2021		

All work done in accordance with the City of Port Orchard Public Works Engineering Standards and Specifications in effect on the date shown above, and supplemented by Project Provisions.



LIPPERT PAVEMENT REPAIR AND SIDEWALK  
 RETROFIT  
 SITE PREPARATION PLAN

PLAN NO.  
**SP3**  
 SHEET  
 4 OF 10



SEC. 2 T.23N. R.1E. W.M.

GENERAL NOTES:

- FULL DEPTH PAVEMENT DIG OUTS SHALL BE COORDINATED WITH THE CITY OF PORT ORCHARD ENGINEER.
- STORM DRAIN INLET PROTECTION PER WSDOT STD. PLAN I-40.20 SHALL BE INSTALLED ON ALL NEW CATCH BASINS AT THE TIME OF INSTALLATION AND IN ALL EXISTING CATCH BASINS BEFORE COMMENCING WORK PER THESE PLANS.
- IT SHALL BE THE CONTRACTOR'S RESPONSIBILITY TO OBTAIN EXISTING HORIZONTAL AND VERTICAL CURB RETURN INFORMATION REQUIRED TO REPLACE EXISTING CURB AND GUTTER IN THE SAME LOCATION.
- ALL SIDEWALKS SHALL MATCH INTO EXISTING AT THE NEAREST JOINT.
- CONTRACTOR SHALL CRACK SEAL ALL PAVEMENT CRACKS IN LOCATIONS OUTSIDE OF PAVEMENT PATCHES PRIOR TO OVERLAY IN ACCORDANCE WITH THE PROJECT SPECIFICATIONS.

CONSTRUCTION NOTES:

- INSTALL CEMENT CONC. DRIVEWAY ENTRANCE TYPE B PER COPO STD. PLAN 321
- INSTALL CEMENT CONC. DRIVEWAY ENTRANCE TYPE 1 PER WSDOT STD. PLAN F-80.10
- INSTALL CEMENT CONC. CURB RAMP TYPE PERPENDICULAR A PER WSDOT STD. PLAN F-40.15
- INSTALL CEMENT CONC. CURB RAMP TYPE PARALLEL A PER WSDOT STD. PLAN F-40.12
- INSTALL CEMENT CONC. TRAFFIC CURB AND GUTTER PER COPO STD. PLAN 300
- ADJUST VALVE BOX TO GRADE
- ADJUST CATCH BASIN TO GRADE
- ADJUST MANHOLE TO GRADE
- ADJUST UTILITY VAULT CASTING TO GRADE
- PROVIDE AND INSTALL CATCH BASIN TYPE 1 PER WSDOT STD. PLAN B-5.20
- CEMENT CONC. BUS PAD PER SPECIFICATIONS. SHELTER TO BE RELOCATED BY KITSAP TRANSIT
- CONNECTION TO DRAINAGE STRUCTURE
- CEMENT CONC. ROLLED CURB AND GUTTER PER COPO STD. PLAN 300
- CEMENT CONC. TRANSITION CURB PER DETAIL, DWG. PV2
- CEMENT CONC. PEDESTRIAN CURB PER COPO STD. PLAN 301
- 4" CEMENT CONC. TRAFFIC CURB AND GUTTER
- INSTALL CEMENT CONC. DRIVEWAY ENTRANCE TYPE 2 PER WSDOT STD. PLAN F-80.10

LEGEND:

- 4" HMA CL. 1/2 IN. PG 58H-22 OVER 2" CSTC
- 2" HMA CL. 1/2 IN. PG 58H-22
- DETECTABLE WARNING SURFACE PER COPO STD. PLAN 341
- CEMENT CONC. SIDEWALK PER COPO STD. PLAN 340
- 3" HMA FOR APPROACH CL. 1/2 IN. PG 58H-22 OVER 2" CSTC
- LANDSCAPING AND LANDSCAPE RESTORATION
- CURB RETURN. SEE TABLES ON PV2

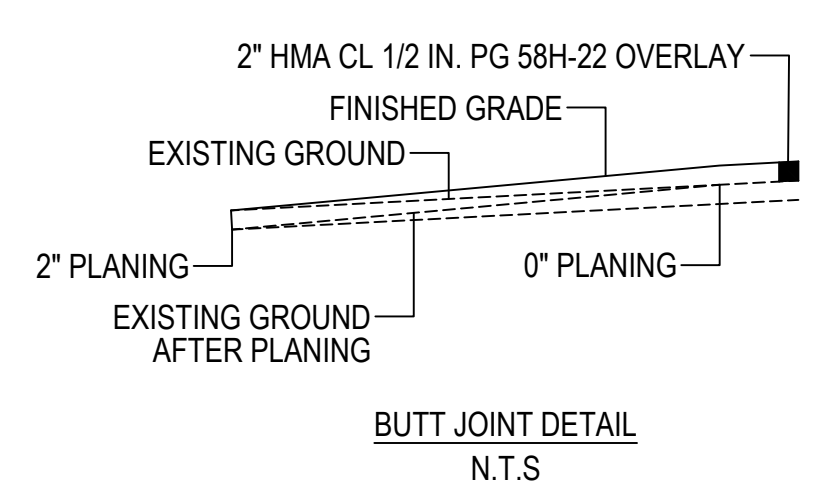
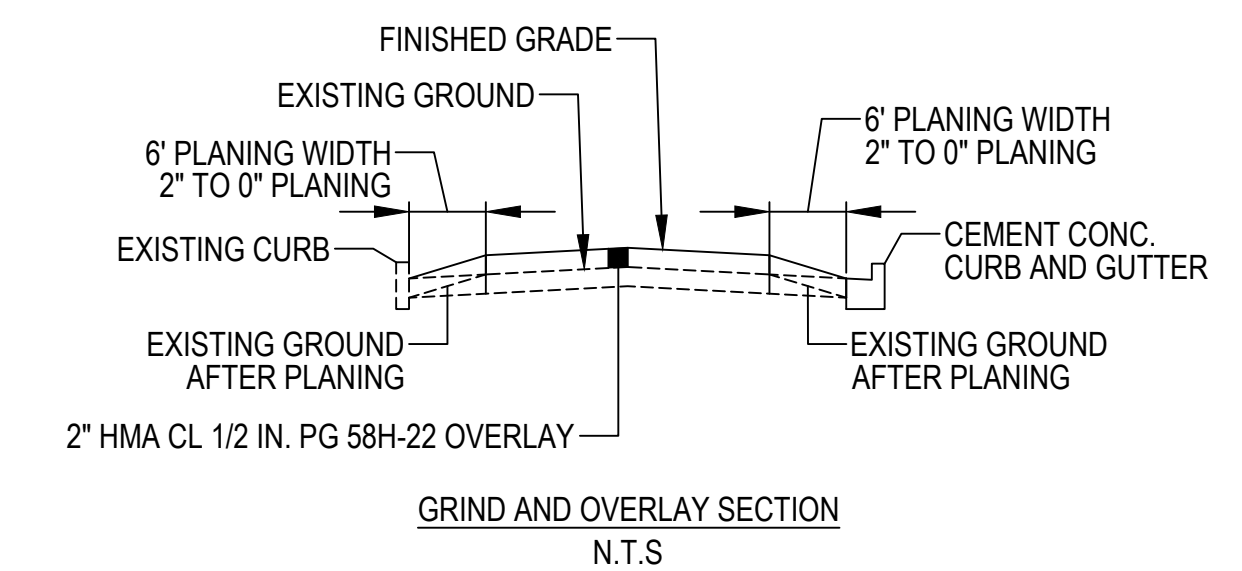
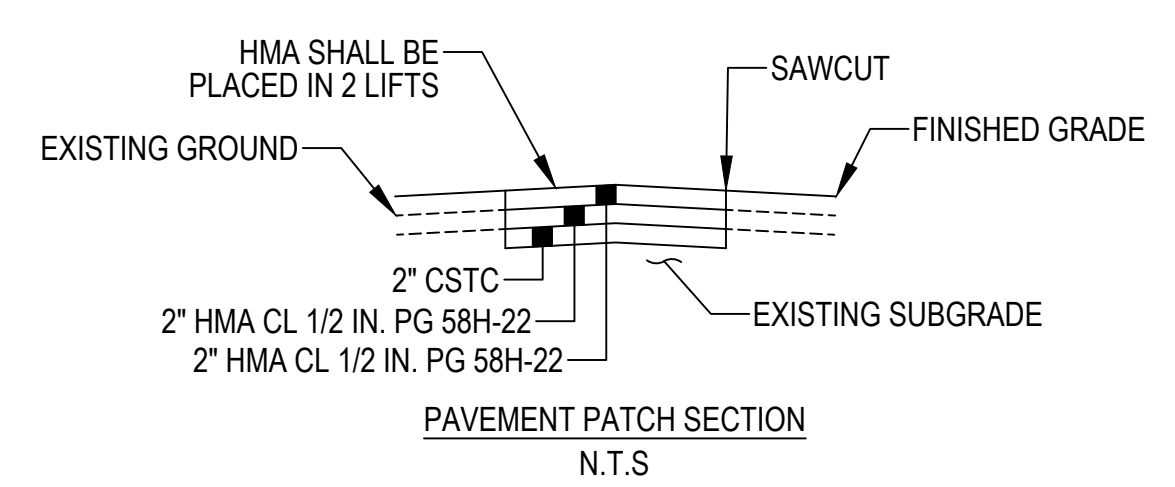
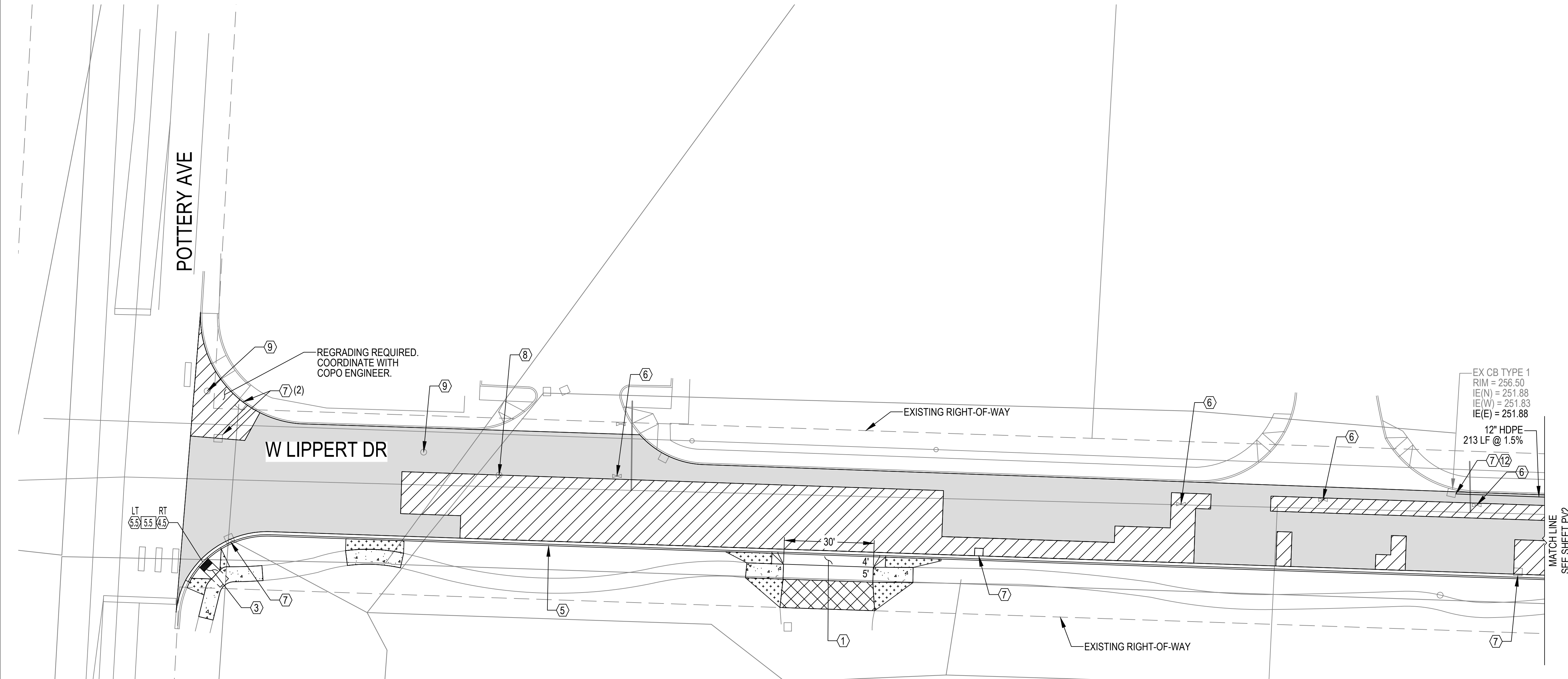
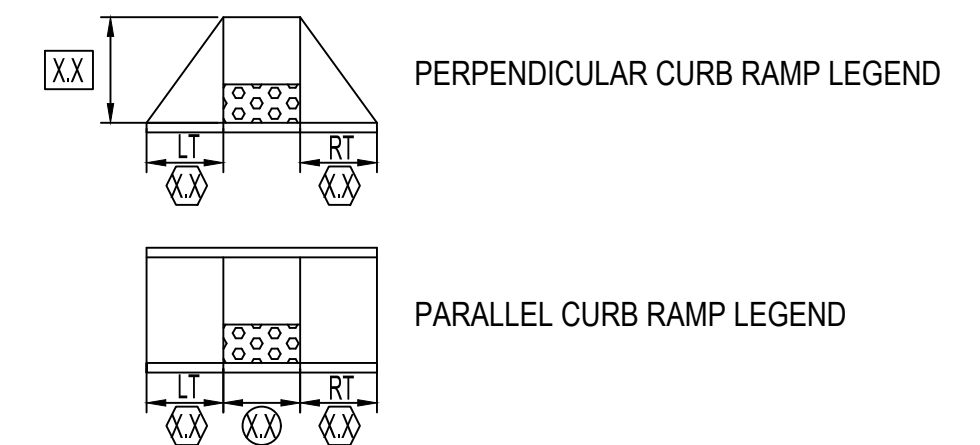

DESIGN	CHECK	REVIEW	D
REVISION	TYPE	DATE	REVISIONS

DISCLAIMER: THIS PLAN WAS DEVELOPED FROM CITY OF PORT ORCHARD AND KITSAP COUNTY GIS INFORMATION ALONG WITH AERIAL IMAGERY AND MAY NOT REPRESENT TRUE CONDITIONS IN THE FIELD.

CITY OF PORT ORCHARD CAPITAL PROJECTS  
 216 PROSPECT STREET, PORT ORCHARD, WA 98366  
 PHONE: 360.876.4991

NAME OR INITIALS AND DATE		NAME OR INITIALS AND DATE	
DESIGNED	CAW NOV 2021	PROJECT MANAGER:	K. CHRIS HAMMER
CHECKED	KCH NOV 2021	REVIEWED:	NOV 2021
DRAWN	CAW NOV 2021	REVISED AS-BUILT	
CHECKED	KCH NOV 2021		



LIPPERT PAVEMENT REPAIR AND SIDEWALK  
 RETROFIT  
 PAVING PLAN

PLAN NO.  
**PV1**  
 SHEET  
 5 OF 10

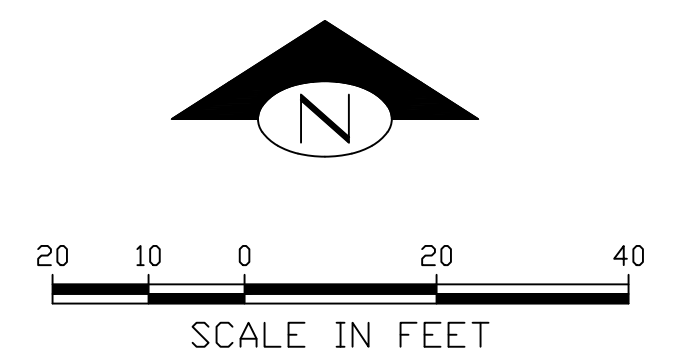



SEC. 2 T.23N. R.1E. W.M.

GENERAL NOTES:

- FULL DEPTH PAVEMENT DIG OUTS SHALL BE COORDINATED WITH THE CITY OF PORT ORCHARD ENGINEER.
- STORM DRAIN INLET PROTECTION PER WSDOT STD. PLAN I-40.20 SHALL BE INSTALLED ON ALL NEW CATCH BASINS AT THE TIME OF INSTALLATION AND IN ALL EXISTING CATCH BASINS BEFORE COMMENCING WORK PER THESE PLANS.
- IT SHALL BE THE CONTRACTOR'S RESPONSIBILITY TO OBTAIN EXISTING HORIZONTAL AND VERTICAL CURB RETURN INFORMATION REQUIRED TO REPLACE EXISTING CURB AND GUTTER IN THE SAME LOCATION.
- ALL SIDEWALKS SHALL MATCH INTO EXISTING AT THE NEAREST JOINT.
- CONTRACTOR SHALL CRACK SEAL ALL PAVEMENT CRACKS IN LOCATIONS OUTSIDE OF PAVEMENT PATCHES PRIOR TO OVERLAY IN ACCORDANCE WITH THE PROJECT SPECIFICATIONS.

CONSTRUCTION NOTES:

- INSTALL CEMENT CONC. DRIVEWAY ENTRANCE TYPE B PER COPO STD. PLAN 321
- INSTALL CEMENT CONC. DRIVEWAY ENTRANCE TYPE 1 PER WSDOT STD. PLAN F-80.10
- INSTALL CEMENT CONC. CURB RAMP TYPE PERPENDICULAR A PER WSDOT STD. PLAN F-40.15
- INSTALL CEMENT CONC. CURB RAMP TYPE PARALLEL A PER WSDOT STD. PLAN F-40.12
- INSTALL CEMENT CONC. TRAFFIC CURB AND GUTTER PER COPO STD. PLAN 300
- ADJUST VALVE BOX TO GRADE
- ADJUST CATCH BASIN TO GRADE
- ADJUST MANHOLE TO GRADE
- ADJUST UTILITY VAULT CASTING TO GRADE
- PROVIDE AND INSTALL CATCH BASIN TYPE 1 PER WSDOT STD. PLAN B-5.20
- CEMENT CONC. BUS PAD PER SPECIFICATIONS. SHELTER TO BE RELOCATED BY KITSAP TRANSIT
- CONNECTION TO DRAINAGE STRUCTURE
- CEMENT CONC. ROLLED CURB AND GUTTER PER COPO STD. PLAN 300
- CEMENT CONC. TRANSITION CURB PER DETAIL, DWG. PV2
- CEMENT CONC. PEDESTRIAN CURB PER COPO STD. PLAN 301
- 4" CEMENT CONC. TRAFFIC CURB AND GUTTER
- INSTALL CEMENT CONC. DRIVEWAY ENTRANCE TYPE 2 PER WSDOT STD. PLAN F-80.10

LEGEND:

- 4" HMA CL. 1/2 IN. PG 58H-22 OVER 2" CSTC
- 2" HMA CL. 1/2 IN. PG 58H-22
- DETECTABLE WARNING SURFACE PER COPO STD. PLAN 341
- CEMENT CONC. SIDEWALK PER COPO STD. PLAN 340
- 3" HMA FOR APPROACH CL. 1/2 IN. PG 58H-22 OVER 2" CSTC
- LANDSCAPING AND LANDSCAPE RESTORATION
- CURB RETURN. SEE TABLES ON PV2

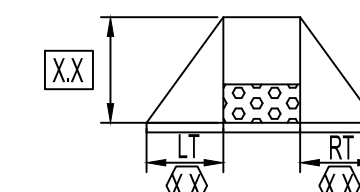

PERPENDICULAR CURB RAMP LEGEND

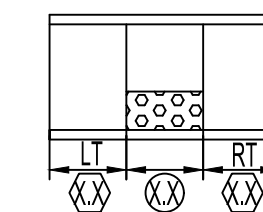

PARALLEL CURB RAMP LEGEND

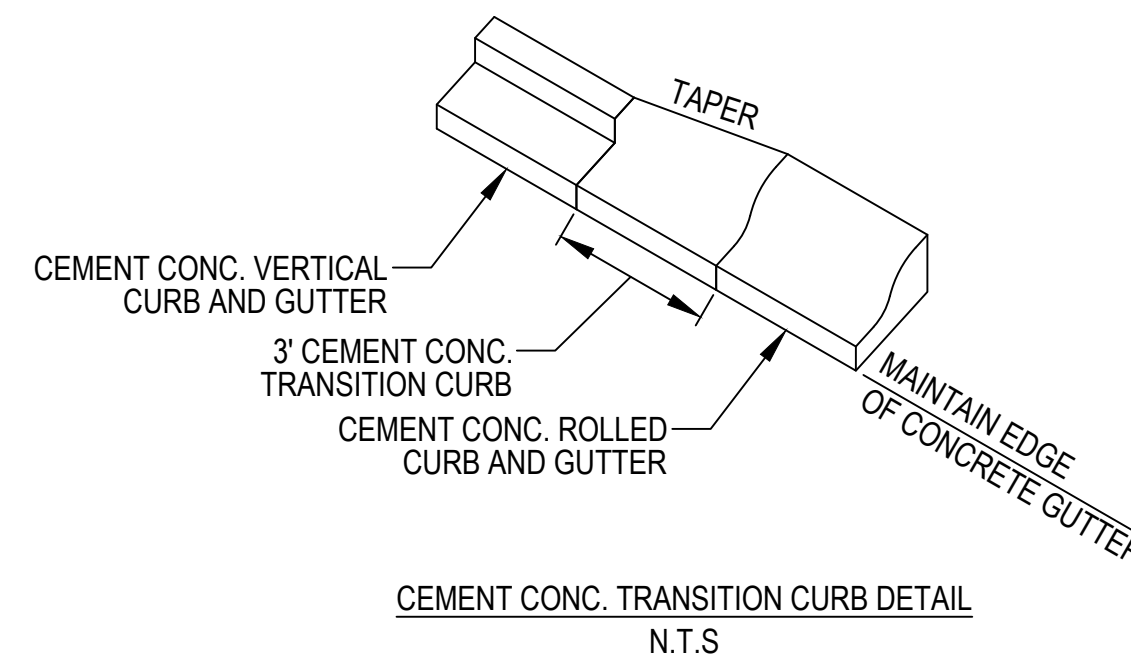

CEMENT CONC. TRANSITION CURB DETAIL  
N.T.S

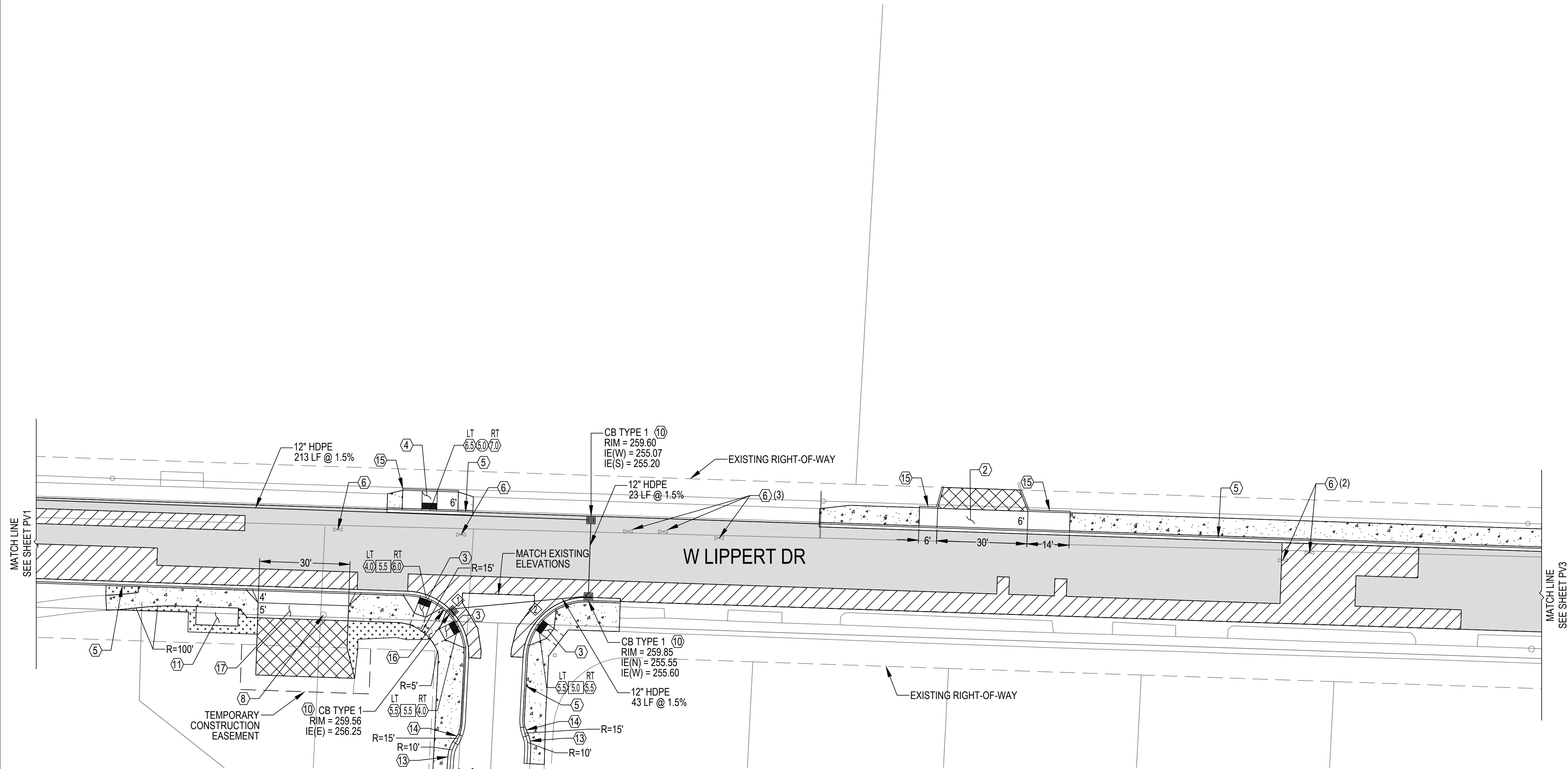

SW CORNER W LIPPERT DR & BECKY AVE CURB RETURN TABLE		
POINT	FLOWLINE ELEV.	
PC (W LIPPERT DR)	259.64	$\Delta = 91^\circ 0' 37''$
1/4	259.60	$L = 31.77'$
1/2	259.56	$T = 20.36'$
3/4	259.60	$R = 20'$
PT (BECKY AVE)	259.64	

SE CORNER W LIPPERT DR & BECKY AVE CURB RETURN TABLE		
POINT	FLOWLINE ELEV.	
PC (BECKY AVE)	259.66	$\Delta = 88^\circ 59' 23''$
1/4	259.70	$L = 31.06'$
1/2	259.75	$T = 19.65'$
3/4	259.80	$R = 20'$
PT (W LIPPERT DR)	259.85	

DESIGN	CHECK	REVIEW	D
REVISION	TYPE	REVISIONS	
DATE			

DISCLAIMER: THIS PLAN WAS DEVELOPED FROM CITY OF PORT ORCHARD AND KITSAP COUNTY GIS INFORMATION ALONG WITH AERIAL IMAGERY AND MAY NOT REPRESENT TRUE CONDITIONS IN THE FIELD.

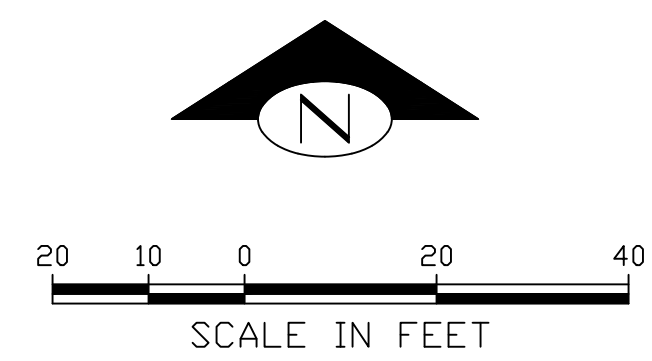

Engineer's Stamp

CITY OF PORT ORCHARD CAPITAL PROJECTS  
216 PROSPECT STREET, PORT ORCHARD, WA 98366  
PHONE: 360.876.4991

NAME OR INITIALS AND DATE		NAME OR INITIALS AND DATE	
DESIGNED	CAW NOV 2021	PROJECT MANAGER:	K. CHRIS HAMMER
CHECKED	KCH NOV 2021	REVIEWED:	NOV 2021
DRAWN	CAW NOV 2021		
CHECKED	KCH NOV 2021	REVISED AS-BUILT	



LIPPERT PAVEMENT REPAIR AND SIDEWALK  
RETROFIT  
PAVING PLAN

PLAN NO.  
PV2  
SHEET  
6 OF 10



SEC. 2 T.23N. R.1E. W.M.

GENERAL NOTES:

1. FULL DEPTH PAVEMENT DIG OUTS SHALL BE COORDINATED WITH THE CITY OF PORT ORCHARD ENGINEER.
2. STORM DRAIN INLET PROTECTION PER WSDOT STD. PLAN I-40.20 SHALL BE INSTALLED ON ALL NEW CATCH BASINS AT THE TIME OF INSTALLATION AND IN ALL EXISTING CATCH BASINS BEFORE COMMENCING WORK PER THESE PLANS.
3. IT SHALL BE THE CONTRACTOR'S RESPONSIBILITY TO OBTAIN EXISTING HORIZONTAL AND VERTICAL CURB RETURN INFORMATION REQUIRED TO REPLACE EXISTING CURB AND GUTTER IN THE SAME LOCATION.
4. ALL SIDEWALKS SHALL MATCH INTO EXISTING AT THE NEAREST JOINT.
5. CONTRACTOR SHALL CRACK SEAL ALL PAVEMENT CRACKS IN LOCATIONS OUTSIDE OF PAVEMENT PATCHES PRIOR TO OVERLAY IN ACCORDANCE WITH THE PROJECT SPECIFICATIONS.

CONSTRUCTION NOTES:

- ① INSTALL CEMENT CONC. DRIVEWAY ENTRANCE TYPE B PER COPO STD. PLAN 321
- ② INSTALL CEMENT CONC. DRIVEWAY ENTRANCE TYPE 1 PER WSDOT STD. PLAN F-80.10
- ③ INSTALL CEMENT CONC. CURB RAMP TYPE PERPENDICULAR A PER WSDOT STD. PLAN F-40.15
- ④ INSTALL CEMENT CONC. CURB RAMP TYPE PARALLEL A PER WSDOT STD. PLAN F-40.12
- ⑤ INSTALL CEMENT CONC. TRAFFIC CURB AND GUTTER PER COPO STD. PLAN 300
- ⑥ ADJUST VALVE BOX TO GRADE
- ⑦ ADJUST CATCH BASIN TO GRADE
- ⑧ ADJUST MANHOLE TO GRADE
- ⑨ ADJUST UTILITY VAULT CASTING TO GRADE
- ⑩ PROVIDE AND INSTALL CATCH BASIN TYPE 1 PER WSDOT STD. PLAN B-5.20
- ⑪ CEMENT CONC. BUS PAD PER SPECIFICATIONS. SHELTER TO BE RELOCATED BY KITSAP TRANSIT
- ⑫ CONNECTION TO DRAINAGE STRUCTURE
- ⑬ CEMENT CONC. ROLLED CURB AND GUTTER PER COPO STD. PLAN 300
- ⑭ CEMENT CONC. TRANSITION CURB PER DETAIL, DWG. PV2
- ⑮ CEMENT CONC. PEDESTRIAN CURB PER COPO STD. PLAN 301
- ⑯ 4" CEMENT CONC. TRAFFIC CURB AND GUTTER
- ⑰ INSTALL CEMENT CONC. DRIVEWAY ENTRANCE TYPE 2 PER WSDOT STD. PLAN F-80.10

LEGEND:

- 4" HMA CL. 1/2 IN. PG 58H-22 OVER 2" CSTC
- 2" HMA CL. 1/2 IN. PG 58H-22
- DETECTABLE WARNING SURFACE PER COPO STD. PLAN 341
- CEMENT CONC. SIDEWALK PER COPO STD. PLAN 340
- 3" HMA FOR APPROACH CL. 1/2 IN. PG 58H-22 OVER 2" CSTC
- LANDSCAPING AND LANDSCAPE RESTORATION
- CURB RETURN. SEE TABLES ON PV2

PERPENDICULAR CURB RAMP LEGEND

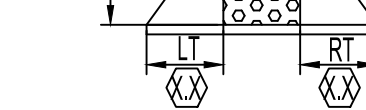

PARALLEL CURB RAMP LEGEND

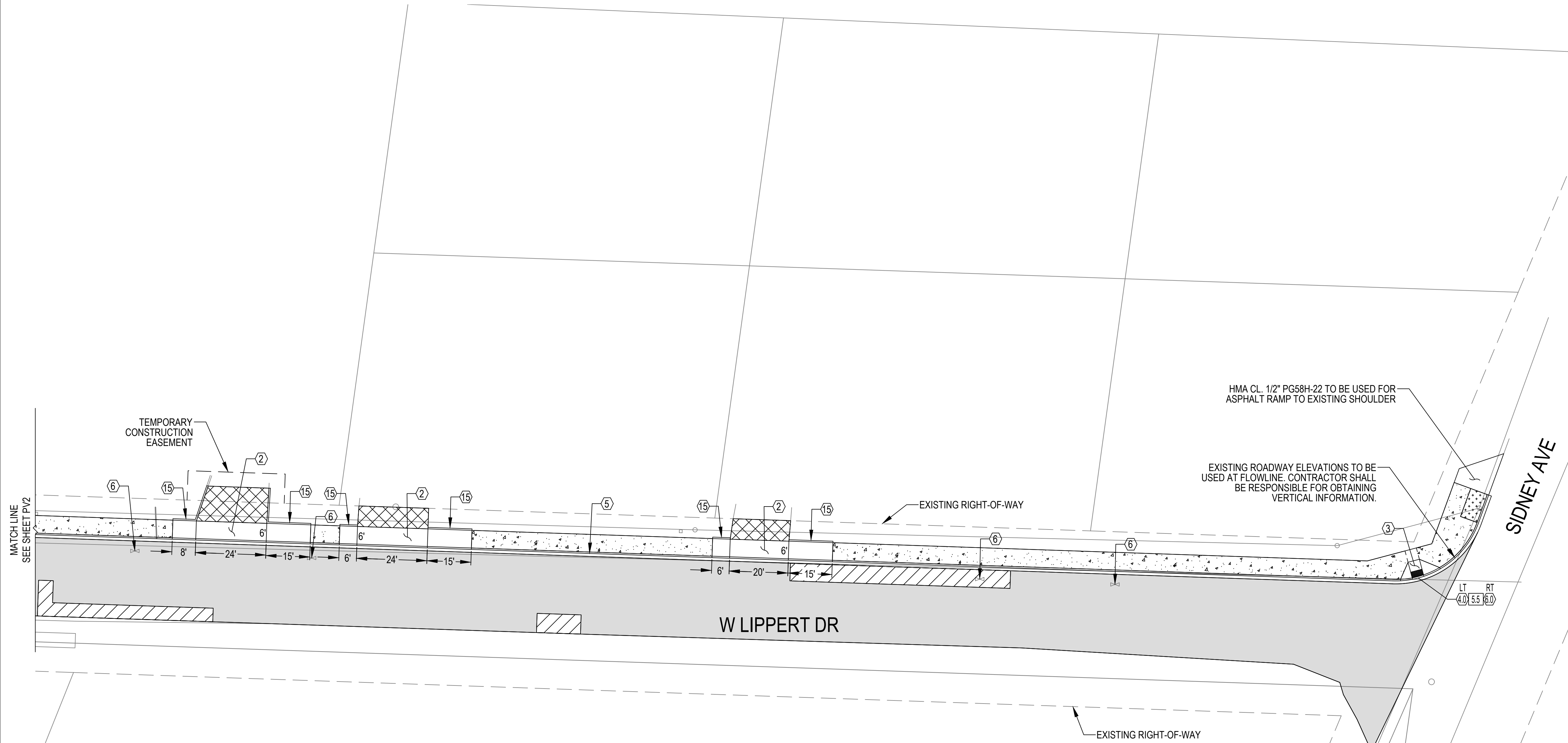
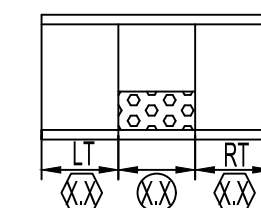

HMA CL. 1/2" PG58H-22 TO BE USED FOR ASPHALT RAMP TO EXISTING SHOULDER

EXISTING ROADWAY ELEVATIONS TO BE USED AT FLOWLINE. CONTRACTOR SHALL BE RESPONSIBLE FOR OBTAINING VERTICAL INFORMATION.

DESIGN'D	CHECK'D	REVIEW'D
REVISION	TYPE	REVISIONS
DATE		

DISCLAIMER: THIS PLAN WAS DEVELOPED FROM CITY OF PORT ORCHARD AND KITSAP COUNTY GIS INFORMATION ALONG WITH AERIAL IMAGERY AND MAY NOT REPRESENT TRUE CONDITIONS IN THE FIELD.

CITY OF PORT ORCHARD CAPITAL PROJECTS  
 216 PROSPECT STREET, PORT ORCHARD, WA 98366  
 PHONE: 360.876.4991

NAME OR INITIALS AND DATE	NAME OR INITIALS AND DATE
DESIGNED: CAW NOV 2021	PROJECT MANAGER: K. CHRIS HAMMER
CHECKED: KCH NOV 2021	REVIEWED: NOV 2021
DRAWN: CAW NOV 2021	
CHECKED: KCH NOV 2021	REVISED AS-BUILT



LIPPERT PAVEMENT REPAIR AND SIDEWALK  
 RETROFIT  
 PAVING PLAN

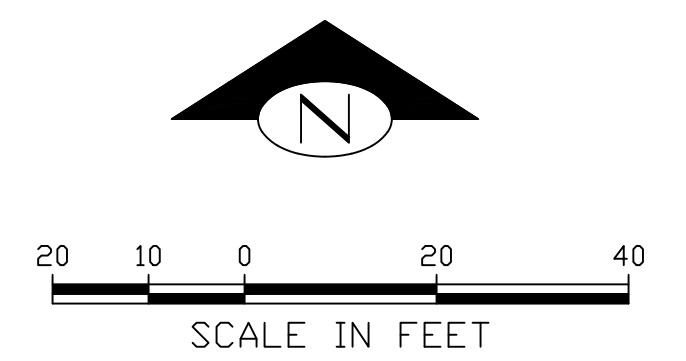

PLAN NO.  
**PV3**  
 SHEET  
 7 OF 10

SEC. 2 T.23N. R.1E. W.M.

- GENERAL NOTES:**
- EXISTING PAVEMENT MARKINGS AND SIGNS THAT CONFLICT WITH CHANNELIZATION AND SIGNING PLAN SHALL BE REMOVED.
  - CONTRACTOR SHALL COORDINATE WITH COPO OPERATIONS AND MAINTENANCE PRIOR TO STRIPING AND SIGNING.
  - DIMENSIONS ADJACENT TO CURB AND GUTTER ARE MEASURED FROM FACE OF CURB.
  - ALL PLASTIC PAVEMENT MARKINGS SHALL UTILIZE TYPE A - LIQUID HOT APPLIED THERMOPLASTIC PER WSDOT SPECIFICATIONS.

- CHANNELIZATION NOTES:**
- INSTALL PLASTIC 18" STOP LINE PER COPO STD. PLANS 427 AND 430
  - INSTALL PLASTIC CROSSWALK LINE PER COPO STD. PLAN 427
  - INSTALL PLASTIC TYPE 2R TRAFFIC ARROW PER COPO STD. PLAN 430
  - INSTALL PAINTED DOUBLE YELLOW CENTERLINE PER COPO STD. PLAN 424
  - INSTALL PAINTED WHITE WIDE EDGE LINE PER WSDOT STD. PLAN M-20.10
  - INSTALL PLASTIC WHITE WIDE SOLID LANE LINE PER WSDOT STD. PLAN M-20.10

- LEGEND:**
- NEW SIGN
  - REMOVE EXISTING SIGN
  - NEW SIGN
  - EXISTING SIGN

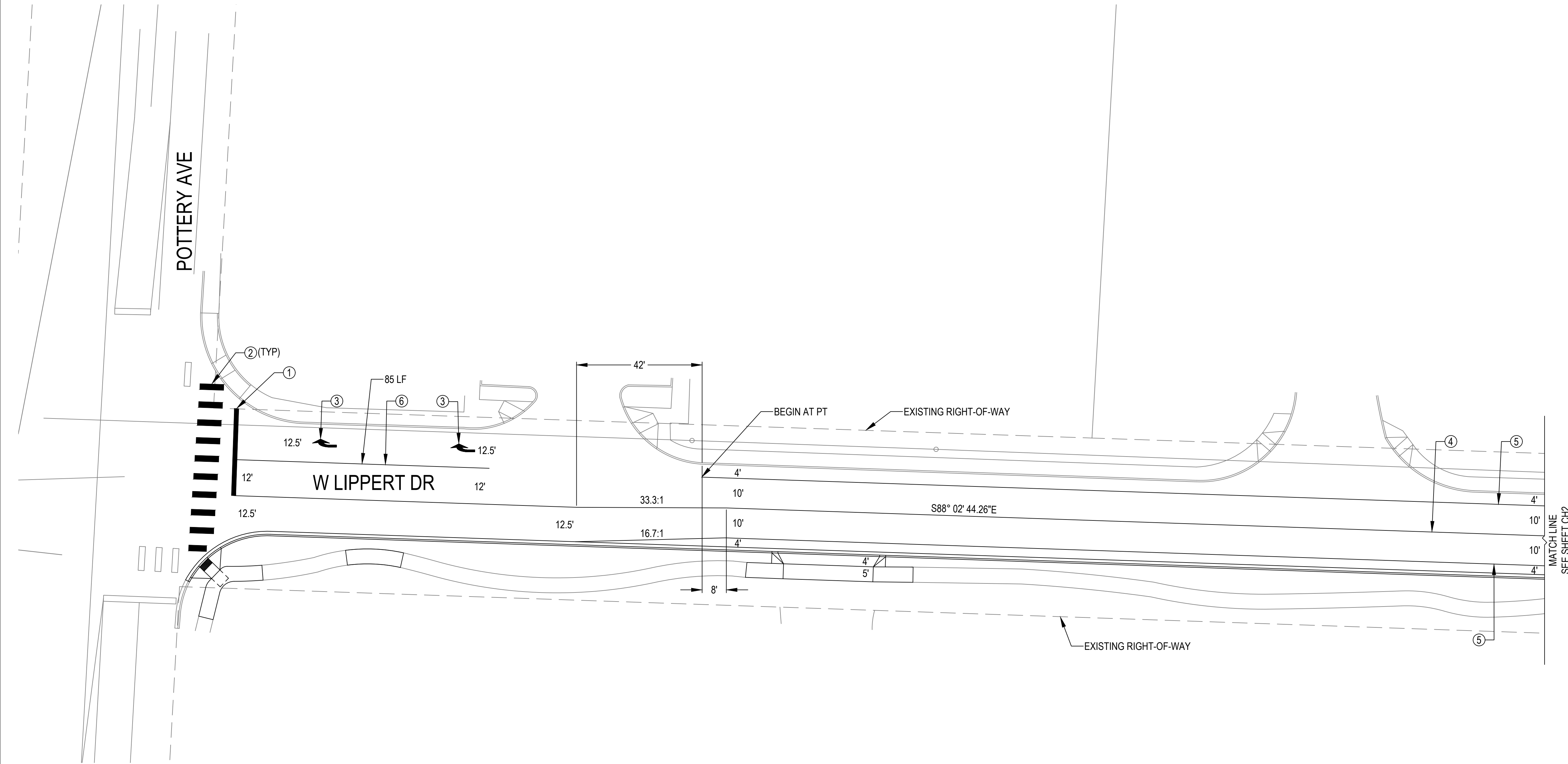

DATE	REVISION	TYPE	CHECK'D	REVIEW'D

DISCLAIMER: THIS PLAN WAS DEVELOPED FROM CITY OF PORT ORCHARD AND KITSAP COUNTY GIS INFORMATION ALONG WITH AERIAL IMAGERY AND MAY NOT REPRESENT TRUE CONDITIONS IN THE FIELD.

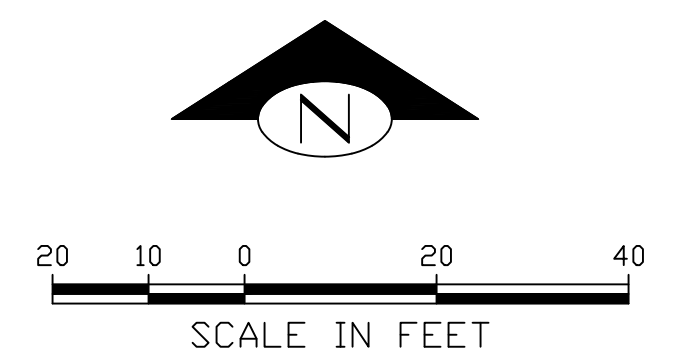

Engineer's Stamp

CITY OF PORT ORCHARD CAPITAL PROJECTS  
 216 PROSPECT STREET, PORT ORCHARD, WA 98366  
 PHONE: 360.876.4991

NAME OR INITIALS AND DATE		NAME OR INITIALS AND DATE	
DESIGNED	CAW NOV 2021	PROJECT MANAGER:	K. CHRIS HAMMER
CHECKED	KCH NOV 2021	REVIEWED:	NOV 2021
DRAWN	CAW NOV 2021	REVISED AS-BUILT	
CHECKED	KCH NOV 2021		



LIPPERT PAVEMENT REPAIR AND SIDEWALK  
 RETROFIT  
 CHANNELIZATION AND SIGNING PLAN

PLAN NO.  
**CH1**  
 SHEET  
 8 OF 10



SEC. 2 T.23N. R.1E. W.M.



GENERAL NOTES:

- EXISTING PAVEMENT MARKINGS AND SIGNS THAT CONFLICT WITH CHANNELIZATION AND SIGNING PLAN SHALL BE REMOVED.
- CONTRACTOR SHALL COORDINATE WITH COPO OPERATIONS AND MAINTENANCE PRIOR TO STRIPING AND SIGNING.
- DIMENSIONS ADJACENT TO CURB AND GUTTER ARE MEASURED FROM FACE OF CURB.
- ALL PLASTIC PAVEMENT MARKINGS SHALL UTILIZE TYPE A - LIQUID HOT APPLIED THERMOPLASTIC PER WSDOT SPECIFICATIONS.

CHANNELIZATION NOTES:

- INSTALL PLASTIC 18" STOP LINE PER COPO STD. PLANS 427 AND 430
- INSTALL PLASTIC CROSSWALK LINE PER COPO STD. PLAN 427
- INSTALL PLASTIC TYPE 2R TRAFFIC ARROW PER COPO STD. PLAN 430
- INSTALL PAINTED DOUBLE YELLOW CENTERLINE PER COPO STD. PLAN 424
- INSTALL PAINTED WHITE WIDE EDGE LINE PER WSDOT STD. PLAN M-20.10
- INSTALL PLASTIC WHITE WIDE SOLID LANE LINE PER WSDOT STD. PLAN M-20.10

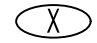
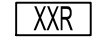
LEGEND:

-  NEW SIGN
-  REMOVE EXISTING SIGN
-  NEW SIGN
-  EXISTING SIGN

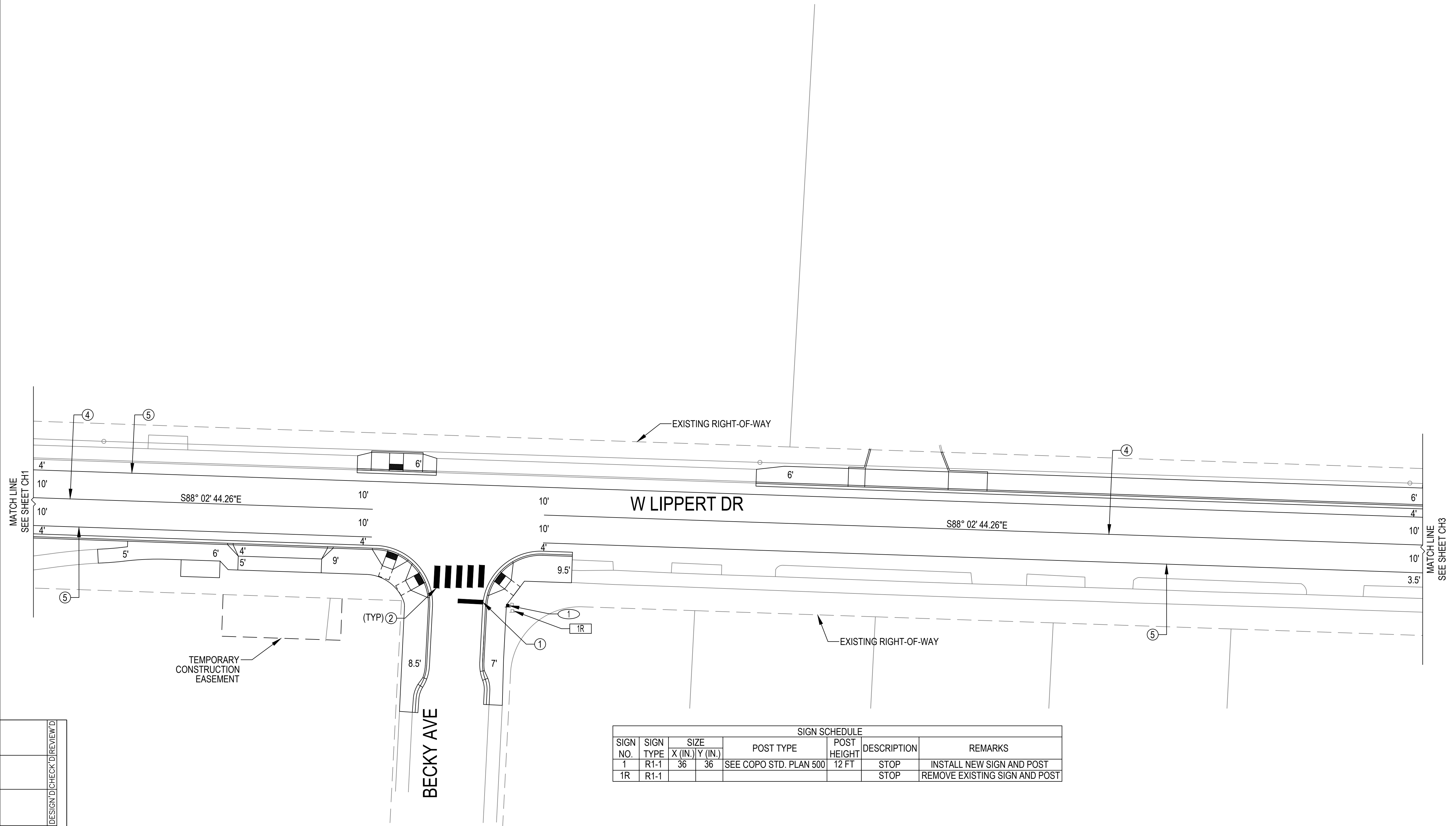

SIGN SCHEDULE							
SIGN NO.	SIGN TYPE	SIZE (IN.)		POST TYPE	POST HEIGHT	DESCRIPTION	REMARKS
1	R1-1	36	36	SEE COPO STD. PLAN 500	12 FT	STOP	INSTALL NEW SIGN AND POST
1R	R1-1					STOP	REMOVE EXISTING SIGN AND POST

DESIGN'D	CHECK'D	REVIEW'D
REVISION	TYPE	REVISIONS
DATE		

DISCLAIMER: THIS PLAN WAS DEVELOPED FROM CITY OF PORT ORCHARD AND KITSAP COUNTY GIS INFORMATION ALONG WITH AERIAL IMAGERY AND MAY NOT REPRESENT TRUE CONDITIONS IN THE FIELD.

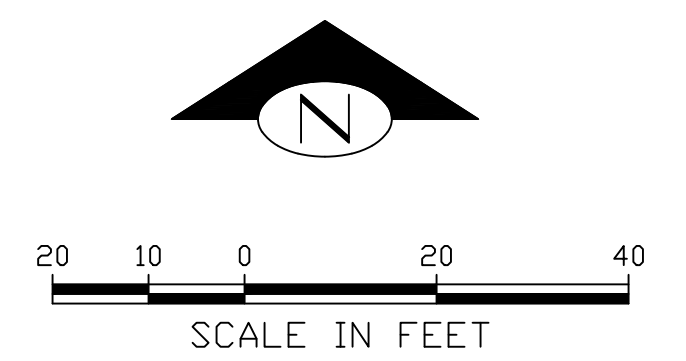

Engineer's Stamp

CITY OF PORT ORCHARD CAPITAL PROJECTS  
 216 PROSPECT STREET, PORT ORCHARD, WA 98366  
 PHONE: 360.876.4991

NAME OR INITIALS AND DATE		NAME OR INITIALS AND DATE	
DESIGNED	CAW NOV 2021	PROJECT MANAGER:	K. CHRIS HAMMER
CHECKED	KCH NOV 2021	REVIEWED:	NOV 2021
DRAWN	CAW NOV 2021		
CHECKED	KCH NOV 2021	REVISED AS-BUILT	



LIPPERT PAVEMENT REPAIR AND SIDEWALK  
 RETROFIT  
 CHANNELIZATION AND SIGNING PLAN

PLAN NO.  
**CH2**  
 SHEET  
 9 OF 10

SEC. 2 T.23N. R.1E. W.M.



GENERAL NOTES:

- EXISTING PAVEMENT MARKINGS AND SIGNS THAT CONFLICT WITH CHANNELIZATION AND SIGNING PLAN SHALL BE REMOVED.
- CONTRACTOR SHALL COORDINATE WITH COPO OPERATIONS AND MAINTENANCE PRIOR TO STRIPING AND SIGNING.
- DIMENSIONS ADJACENT TO CURB AND GUTTER ARE MEASURED FROM FACE OF CURB.
- ALL PLASTIC PAVEMENT MARKINGS SHALL UTILIZE TYPE A - LIQUID HOT APPLIED THERMOPLASTIC PER WSDOT SPECIFICATIONS.

CHANNELIZATION NOTES:

- INSTALL PLASTIC 18" STOP LINE PER COPO STD. PLANS 427 AND 430
- INSTALL PLASTIC CROSSWALK LINE PER COPO STD. PLAN 427
- INSTALL PLASTIC TYPE 2R TRAFFIC ARROW PER COPO STD. PLAN 430
- INSTALL PAINTED DOUBLE YELLOW CENTERLINE PER COPO STD. PLAN 424
- INSTALL PAINTED WHITE WIDE EDGE LINE PER WSDOT STD. PLAN M-20.10
- INSTALL PLASTIC WHITE WIDE SOLID LANE LINE PER WSDOT STD. PLAN M-20.10

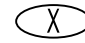
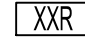
LEGEND:

-  NEW SIGN
-  REMOVE EXISTING SIGN
-  NEW SIGN
-  EXISTING SIGN

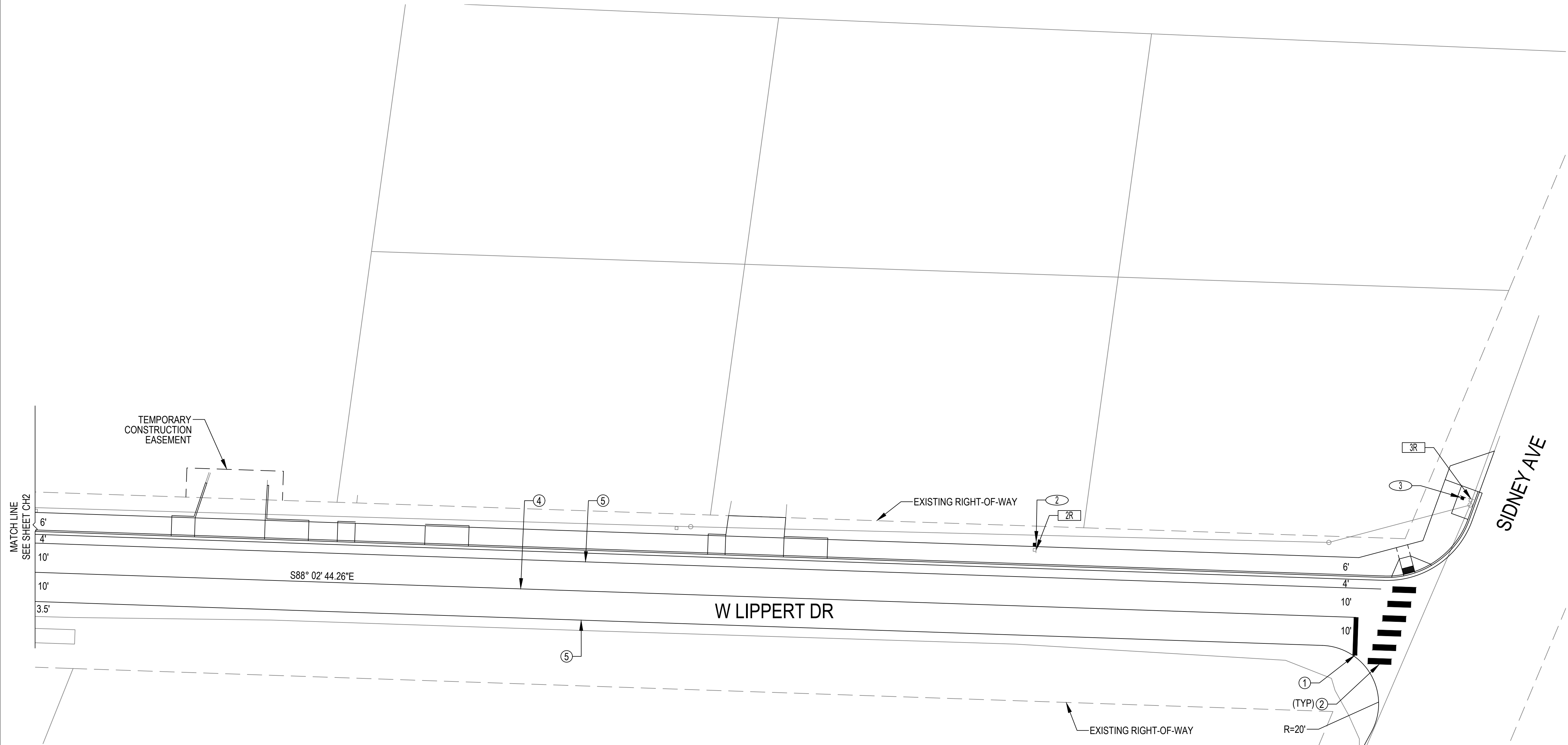

SIGN SCHEDULE							
SIGN NO.	SIGN TYPE	SIZE		POST TYPE	POST HEIGHT	DESCRIPTION	REMARKS
		X (IN.)	Y (IN.)				
2	R2-1	30	36	SEE COPO STD. PLAN 500	12 FT	25 MPH SPEED LIMIT	INSTALL NEW SIGN AND POST
2R	R2-1					25 MPH SPEED LIMIT	REMOVE EXISTING SIGN AND POST
3	R1-1	36	36	SEE COPO STD. PLAN 500	12 FT	STOP	INSTALL NEW SIGN AND POST
3R	R1-1					STOP	REMOVE EXISTING SIGN AND POST

DESIGN'D	CHECK'D	REVIEW'D
REVISION	TYPE	REVISIONS
DATE		

DISCLAIMER: THIS PLAN WAS DEVELOPED FROM CITY OF PORT ORCHARD AND KITSAP COUNTY GIS INFORMATION ALONG WITH AERIAL IMAGERY AND MAY NOT REPRESENT TRUE CONDITIONS IN THE FIELD.

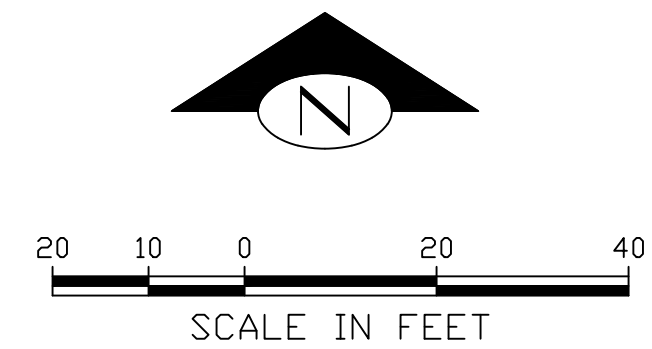

CITY OF PORT ORCHARD CAPITAL PROJECTS  
 216 PROSPECT STREET, PORT ORCHARD, WA 98366  
 PHONE: 360.876.4991

NAME OR INITIALS AND DATE		NAME OR INITIALS AND DATE	
DESIGNED	CAW NOV 2021	PROJECT MANAGER:	K. CHRIS HAMMER
CHECKED	KCH NOV 2021	REVIEWED:	NOV 2021
DRAWN	CAW NOV 2021	REVISED AS-BUILT	
CHECKED	KCH NOV 2021		



LIPPERT PAVEMENT REPAIR AND SIDEWALK  
 RETROFIT  
 CHANNELIZATION AND SIGNING PLAN

PLAN NO.  
**CH3**  
 SHEET  
 10 OF 10

Engineer's Stamp

All work done in accordance with the City of Port Orchard Public Works Engineering Standards and Specifications in effect on the date shown above, and supplemented by Project Provisions.