

4 21

SAMPLE IMPROVEMENT PLAN

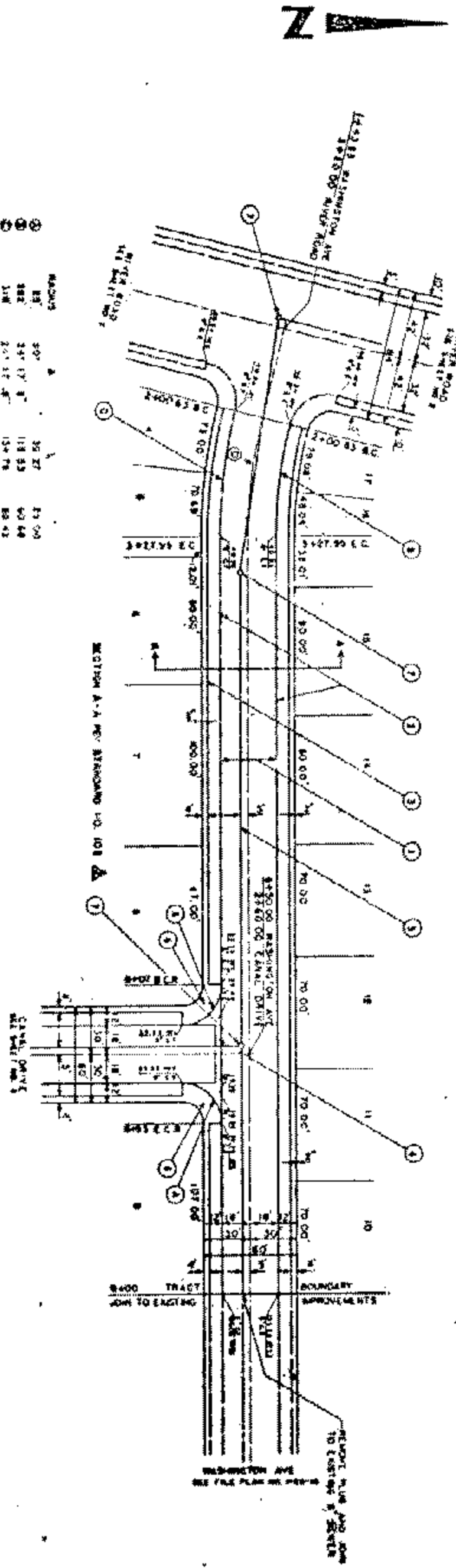
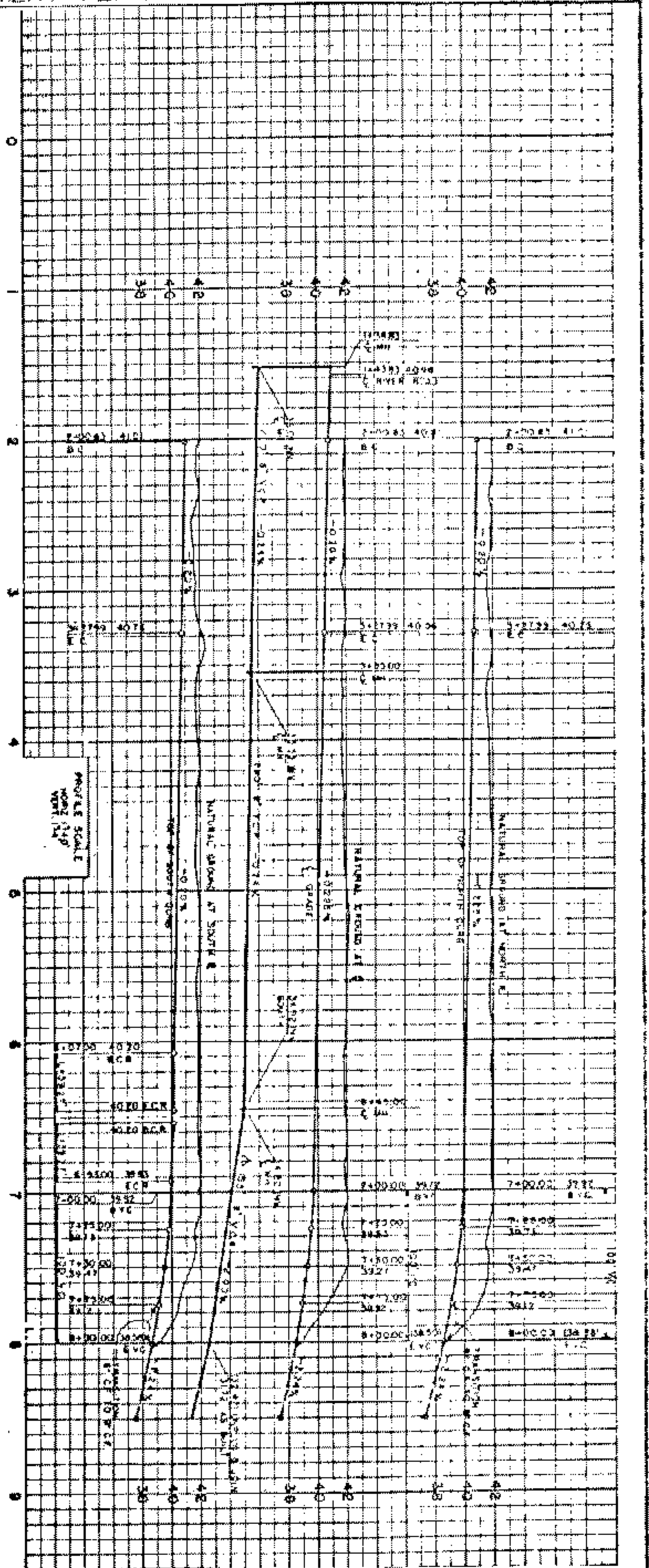

NO.	DATE	REVISION
1	11/21/10	AS SHOWN
2	11/21/10	AS SHOWN
3	11/21/10	AS SHOWN
4	11/21/10	AS SHOWN
5	11/21/10	AS SHOWN
6	11/21/10	AS SHOWN
7	11/21/10	AS SHOWN
8	11/21/10	AS SHOWN
9	11/21/10	AS SHOWN
10	11/21/10	AS SHOWN
11	11/21/10	AS SHOWN
12	11/21/10	AS SHOWN
13	11/21/10	AS SHOWN
14	11/21/10	AS SHOWN
15	11/21/10	AS SHOWN
16	11/21/10	AS SHOWN
17	11/21/10	AS SHOWN
18	11/21/10	AS SHOWN
19	11/21/10	AS SHOWN
20	11/21/10	AS SHOWN

REVISIONS

REFERENCES

NO.	DATE	REVISION
1	11/21/10	AS SHOWN
2	11/21/10	AS SHOWN
3	11/21/10	AS SHOWN
4	11/21/10	AS SHOWN
5	11/21/10	AS SHOWN
6	11/21/10	AS SHOWN
7	11/21/10	AS SHOWN
8	11/21/10	AS SHOWN
9	11/21/10	AS SHOWN
10	11/21/10	AS SHOWN
11	11/21/10	AS SHOWN
12	11/21/10	AS SHOWN
13	11/21/10	AS SHOWN
14	11/21/10	AS SHOWN
15	11/21/10	AS SHOWN
16	11/21/10	AS SHOWN
17	11/21/10	AS SHOWN
18	11/21/10	AS SHOWN
19	11/21/10	AS SHOWN
20	11/21/10	AS SHOWN

TRACT NO. 0123  
WASHINGTON AVENUE  
DEPARTMENT OF PUBLIC WORKS  
CITY OF SANTA ANA

SAMPLE IMPROVEMENT PLANS  
NOT TO SCALE

GENERAL NOTES

1. ALL WORK SHOWN HEREON SHALL BE CONSTRUCTED IN ACCORDANCE WITH THE PROVISIONS OF THE STANDARD SPECIFICATIONS OF THE CITY OF SANTA ANA, CALIFORNIA.
2. LEAVE 2" x 4" RECORD HEADERS IN PLACE ON ALL SIDES OF ALL PAVING WHICH DOES NOT JOIN OTHER PAVING OR CURB OR CONCRETE CURBS OR SUTTER.
3. FEATURES AS SHOWN EXISTING EXCEPT AS NOTED OTHERWISE OR AS DIRECTED BY THE ENGINEER.
4. THE ENGINEER FROM THE DISTRICT SHALL PROVIDE THE LOCATION OF ALL EXISTING UTILITIES AND RECORDS TO BE SHOWN ON THE PLAN, AND AT ALL POINTS WHERE ELEVATIONS ARE SHOWN ON THE PLAN, AND AT ALL ADDITIONAL POINTS REQUIRED BY THE CITY ENGINEER.
5. WATER MAINS ARE SHOWN TO BE LOCATED BY THE CITY OF SANTA ANA UNDER THE CURB AND OTHER IS CONSTRUCTED AND BEFORE THE THE DISTRICT SHALL BE LOCATED BY THE CITY ENGINEER.
6. THE DISTRICT SHALL BE LOCATED BY THE CITY ENGINEER.
7. ALL WORK CONNECTIONS TO BE CONSTRUCTED FROM SEWER MAINS TO THE PROPERTY LINE FROM WHICH THE CONNECTION IS TO BE MADE TO THE CITY ENGINEER.
8. WITHIN 3 DAYS AFTER FINAL SURVEYING IS COMPLETED, ALL SANITARY AND WATER MAINS SHALL BE COVERED WITH 18" MINIMUM THICKNESS CONCRETE SLABS WITH 4" MINIMUM REINFORCEMENT. THIS IS TO BE DONE PRIOR TO THE START OF CONSTRUCTION.
9. PAVEMENT SHALL BE COVERED WITH PENETRATION TYPE ASPHALTIC EMULSION, (OI) GAL PER SQ. YD) AFTER STREET PAVEMENT HAS BEEN CLEANED.

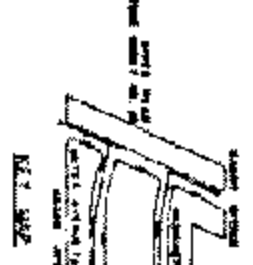

7-100