

ALL IDEAS, DESIGN, ARRANGEMENTS AND PLANS INDICATED OR REPRESENTED BY THIS DRAWING ARE OWNED BY, AND THE PROPERTY OF, CARRIER JOHNSON AND WERE CREATED, EVOLVED AND DEVELOPED FOR USE ON, AND IN CONNECTION WITH THIS PROJECT. NONE OF SUCH IDEAS, DESIGN, ARRANGEMENTS, OR PLANS SHALL BE USED BY, OR DISCLOSED TO ANY PERSON, FIRM, OR CORPORATION FOR ANY PURPOSE WHATSOEVER WITHOUT THE WRITTEN PERMISSION OF CARRIER JOHNSON. FILING THESE DRAWINGS OR SPECIFICATIONS WITH ANY PUBLIC AGENCY IS NOT A PUBLICATION OF SAME. NO COPYING, REPRODUCTION OR USE THEREOF IS PERMISSIBLE WITHOUT THE CONSENT OF CARRIER JOHNSON.

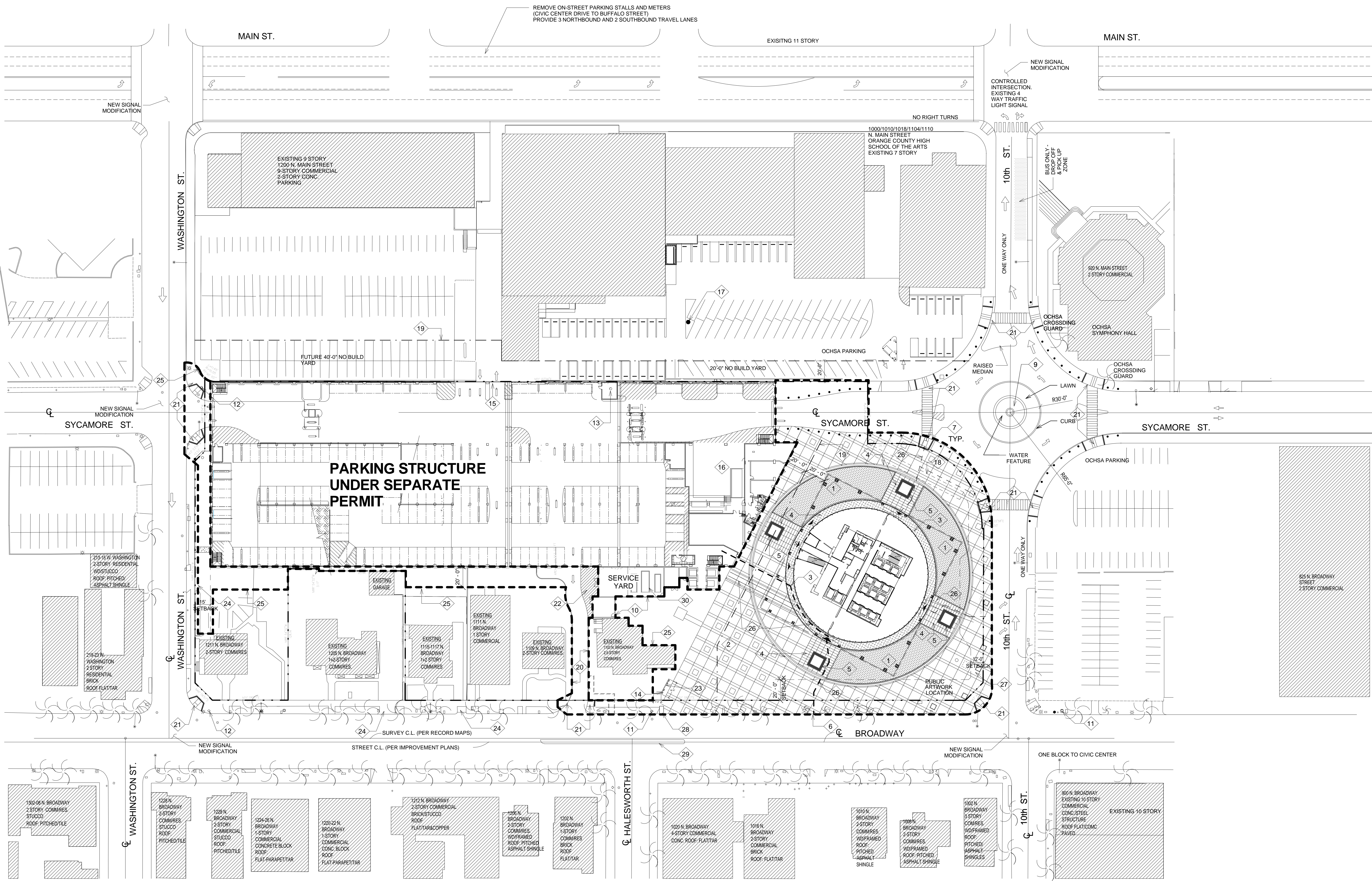

**SITE ACCESS LEGEND**

- PRIMARY ACCESSIBLE ROUTE (PATH OF TRAVEL, P.O.T.) 5% MAX. SLOPE OTHER THAN RAMPS. P.O.T. SHALL BE FIRM, STABLE SURFACE 48" IN WIDTH MINIMUM, OF NO MORE THAN 5% SLOPE, WITH A MAXIMUM CROSS SLOPE OF 2%. HAVE NO ABRUPT LEVEL CHANGES EXCEEDING 1/2" AT 2'-11"(H-V) SLOPE (EXCEPT THAT LEVEL CHANGES OF 1/4" AND LESS MAY BE VERTICAL).
- ▶ MAJOR ACCESSIBLE BUILDING ENTRY
- MINOR ACCESSIBLE ROUTE 5% MAX. SLOPE OTHER THAN RAMPS.
- ▶ MINOR ACCESSIBLE BUILDING ENTRY (TO INDIVIDUAL UNIT OR SPACE)
- Ⓢ BUILDING SERVICE / MAINTENANCE ENTRY (ACCESSIBLE)
- REQUIRED 60" SQUARE DOOR LANDING W/ 2% MAX SLOPE

SIGNAGE: SIGNAGE SHALL BE PROVIDED IN ACCORDANCE WITH SPEC SECTION 10430 AND SIGNAGE NOTES SHEET A0.3.

P.O.T. SLIP - RESISTANCE: REFER TO SHEET A0.3 WALKS & SIDEWALKS NOTE 8, a, b. PATH OF TRAVEL TO BE AT LEAST AS SLIP - RESISTANT AS MEDIUM BROOM (1/8" TO 1/16" AMPLITUDE) AT STEEPER SLOPE.

CERTIFIED NOTE: THIS IS TO CERTIFY THAT, TO THE BEST OF OUR KNOWLEDGE, ALL PATHS OF TRAVEL (P.O.T.) INDICATED ARE IN COMPLIANCE WITH O.C.R. T-24 AS DEFINED BY THE 2001 CALIFORNIA BUILDING CODE (CBC), INCLUDING ALL WALKS, CURB RAMP(S), LIFT(S), AND ELEVATOR(S) (AS APPLY).

THE CONTRACTOR SHALL VERIFY THAT THE INDICATED PATH OF TRAVEL HAS BEEN CONSTRUCTED WITHOUT BARRIERS, AND SHALL TAKE SUCH STEPS AS REQUIRED TO CORRECT AND DEFICIENCIES FOUND.

THIS MAY RESULT IN CONSTRUCTION CHANGE ORDERS AS NECESSARY TO MITIGATE THE NON-COMPLYING CONDITIONS.

PROJECT ARCHITECT (AT TIME DOCUMENT APPROVAL)

PROJECT CONSTRUCTION SUPERVISOR (AFTER CHECKING THE SITE)

**KEYNOTES**

- 1 REFLECTING POOL WATER FEATURE. PROVIDE FOUNTAIN AT TWO LOCATIONS IN EACH POOL.
- 2 PLAZA PAVING, COLORED CONCRETE, 2-CUSTOM COLORS IN A DIAGONAL PATTERN WITH SANDBLAST FINISH (SEE LANDSCAPE PLANS).
- 3 THICK SET STONE PAVING AT PERIMETER TO MATCH LOBBY STONE AND PATTERN.
- 4 THICK SET STONE
- 5 RAISED CAST-IN-PLACE CONCRETE PLANTER WITH PERIMETER BENCH, STAINLESS STEEL SEAT FRAME AND WOOD SLATS.
- 6 REPAIR OR REPLACE SIDEWALK TO MATCH DECORATIVE HARDSCAPE.
- 7 ARCHITECTURAL PRECAST CONCRETE LIGHT BOLLARDS. SEE DETAIL A5/A8.11
- 8 WATER FEATURE AND ROUNDABOUT PART OF OFF-SITE SCOPE OF WORK.
- 9 12" HIGH CMU SCREEN WALL WITH CEMENT PLASTER FINISH, ALUMINUM REVEALS AND STEEL DOORS AND GATES. BY OTHERS UNDER SEPARATE PERMIT.
- 10 EXISTING FIRE HYDRANT TO REMAIN.
- 11 RELOCATED FIRE HYDRANT.
- 12 EXISTING FIRE HYDRANT TO BE REMOVED.
- 13 FIRE DEPARTMENT CONNECTION.
- 14 MAINTAIN ACCESS TO EXISTING DRIVE.
- 15 OFF STREET LOADING AND TRASH COMPACTOR. AS PART OF PARKING STRUCTURE. UNDER SEPARATE PERMIT
- 16 NEW FIRE HYDRANT
- 17 UNDERGROUND FIRE WATER STORAGE TANK WITH 6" GOOSENECK VENT IN PLANTER AND 24"x24" CONCRETE MAN-HOLE COVER TO MATCH PAVING.
- 18 ASSUMED PROPERTY LINE.
- 19 6" CONCRETE CURB
- 20 NEW CURB RAMP WITH DETECTABLE WARNING SURFACE
- 21 LOADING ZONE
- 22 5'-6" HIGH CONCRETE WALL REFER TO LANDSCAPE.
- 23 EXISTING DRIVEWAY APRON TO REMAIN (REFER TO ALTA SURVEY).
- 24 LIMIT OF WORK LINE
- 25 ACCESSIBLE AND/OR EGRESS PATH OF TRAVEL
- 26 6'X6' LIFT STATION BASIN CONCRETE LID TO MATCH PAVING.
- 27 WATER METER VAULT
- 28 FINAL MEDIAN DESIGN/ LOCATION PER STREET IMPROVEMENT PLANS
- 29 EMERGENCY POWER GENERATOR FOR THE TOWER LIFE SAFETY SYSTEMS.
- 30 ACCESSIBLE PASSENGER LOADING ZONE. 5' X 20' STRIPED ACCESS AISLE, 2% MAX. SLOPE IN ANY DIRECTION. PROVIDE WHITE POST MOUNTED SIGN WITH INTERNATIONAL SYMBOL OF ACCESSIBILITY. STATING "PASSENGER LOADING ONLY - NO PARKING."
- 31 HEDGE AND 36" TALL FENCE.

**LEGEND**

- LIMIT OF WORK LINE
- ASSUMED PROPERTY LINE
- PROPERTY LINE

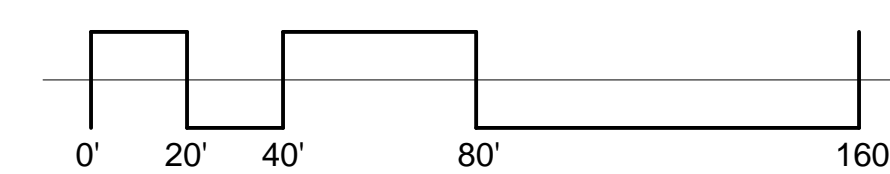

PERMIT SET	05/16/08
CITY RESUBMITTAL	02/04/08
AS NOTED	10/25/07
CITY RESUBMITTAL	05/02/07
SUPER STRUCT PERMIT	01/16/07
FOUNDATION PERMIT	11/15/06
08/30/06 100% DESIGN DEVELOPMENT	
ISSUES:	



PROJECT NO:	4788.00
SCALE:	AS NOTED
DRAWN BY:	CHECKED BY:
PLOT DATE:	08-30-06
TITLE:	SITE PLAN

DRAWING NO: