

Community Meeting Held Tuesday, May 4, 2021
Supporting Documentation

Attachments:

1. Community Notice
2. Photo of Notices Posted on Each Property
3. Community Notice Mailing List
4. Map of Mailing Area
5. Affidavit of Mailing
6. Notification Published in Orange County Register
7. Affidavit of Publication
8. Community Outreach Meeting Presentation
9. Screenshot of Meeting Attendees
10. Meeting Minutes & Public Comment

Attachment

1. Community Notice



Innovative Housing Opportunities, Inc. (IHO)

&

Orange County Community Housing Corporation (OCCHC)

Cordially invite you to a community information meeting for:

Golden Circle



160 units of affordable housing to be developed at
601 N. Golden Circle Drive and 2021 E. 4th Street, Santa Ana, CA 92705



At this meeting we will provide project information, solicit community input, and answer questions.
Please virtually attend and share your thoughts and ideas.

**In effort to protect public health and prevent the spread of COVID-19 (Coronavirus), this meeting will take place virtually via Zoom.

Meeting Date and Time:

Tuesday, May 4, 2021 at 5:00PM

Online:

Location: <https://zoom.us/j/98793324002>

Meeting ID: 987 9332 4002

OR

Conference Call:

Phone #: (669) 900-6833

Meeting ID: 987 9332 4002

For more information, please visit our website at www.innovativehousing.com or send an email to:
goldencirclecommunitymeeting@innovativehousing.com

If you have any questions regarding this event or if you require language interpretation services, please contact IHO at (949) 863-9740



Innovative Housing Opportunities, Inc. (IHO)

Y

Orange County Community Housing Corporation (OCCHC)

los invita a una junta comunitaria para:

Golden Circle



Una proyecto de 160-unidad para personas de ingresos bajos para ser construido en
601 N. Golden Circle Drive y 2021 E. 4th Street, Santa Ana, CA 92705



En esta reunión, proporcionaremos información sobre el proyecto, solicitaremos la opinión de la comunidad y responderemos preguntas. Asista virtualmente y comparta sus pensamientos e ideas.

** En un esfuerzo por proteger la salud pública y prevenir la propagación del COVID-19 (Coronavirus), esta reunión se llevará a cabo virtualmente a través de Zoom.

Fecha y Hora de la Reunión:

Martes, 4 de Mayo de 2021 a las 5:00 PM

En Línea:

Locación: <https://zoom.us/j/98793324002>

ID de Reunión: 987 9332 4002

O

En el Teléfono:

Número de teléfono: (669) 900-6833

ID de Reunión: 987 9332 4002

Para obtener más información, visite nuestro sitio web en www.innovativehousing.com o envíenos un correo electrónico a:
goldencirclecommunitymeeting@innovativehousing.com

Si tiene preguntas sobre el evento o requiere traducción en otros lenguajes, por favor contacte IHO en (949) 863-9740

Attachment

2. Photo of Notices Posted on Each Property

IHO INNOVATIVE HOUSING OPPORTUNITIES

Innovative Housing Opportunities, Inc. (IHO)
 y
 Orange County Community Housing Corporation (OCCHC)
 los invita a una junta comunitaria para:

Golden Circle

Una propuesta de 160 unidades para personas de Ingreso Bajo para ser construido en
 601 N. Golden Circle Drive y 2021 E. 4th Street, Santa Ana, CA, 92705



En esta reunión, proporcionaremos información sobre el proyecto, solicitaremos la opinión de la comunidad y responderemos preguntas. Añada virtualmente y comparte tus pensamientos e ideas.

**** En un esfuerzo por proteger la salud pública y prevenir la propagación del COVID-19 (Coronavirus), esta reunión se llevará a cabo virtualmente a través de Zoom.**

Fecha y Hora de la Reunión:
 Martes, 4 de Mayo de 2021 a las 5:00 PM
 En Línea:
 Ubicación: <https://zoom.us/j/78793324002>
 ID de Reunión: 787 9332 4002
 O
 En el Teléfono:
 Número de teléfono: (649) 900-6833
 ID de Reunión: 787 9332 4002

Para obtener más información, visita nuestro sitio web en www.innovativehousing.com o envíenos un correo electrónico a golden@occhc.com

Si tienes preguntas sobre el evento o requiere traducción en otros idiomas, por favor contáctate a IHO en (649) 863-9140

IHO INNOVATIVE HOUSING OPPORTUNITIES

Innovative Housing Opportunities, Inc. (IHO)
 y
 Orange County Community Housing Corporation (OCCHC)
 Cordially invites you to a community information meeting for:

Golden Circle

160 units of affordable housing to be developed at
 601 N. Golden Circle Drive and 2021 E. 4th Street, Santa Ana, CA, 92705



At this meeting we will provide project information, solicit community input, and answer questions. Please virtually attend and share your thoughts and ideas.

****In effort to protect public health and prevent the spread of COVID-19 (Coronavirus), this meeting will take place virtually via Zoom.**

Meeting Date and Time:
 Tuesday, May 4, 2021 at 5:00PM
 Online:
 Location: <https://zoom.us/j/78793324002>
 Meeting ID: 787 9332 4002
 OR
 Conference Call:
 Phone #: (649) 900-6833
 Meeting ID: 787 9332 4002

For more information, please visit our website at www.innovativehousing.com or send an email to golden@occhc.com

If you have any questions regarding this event or if you require language interpretation services, please contact IHO at (649) 863-9140

SUITE 105



2021 BUILDING

**100 ANGELES OPTOMETRIC CENTER
DR. DAWN VU, O.D.**

102 LAW OFFICES OF VIVIAN N. SZAWARC

**108 F. MICHAEL STONE,
AN ACCOUNTANCY CORP.**

112 S & N LABS

**116 ERIC W. GRUVER, Ph.D
FORENSIC AND CLINICAL PSYCHOLOGY**

120 AGAPE INSURANCE

**200 LAW OFFICE
MICHAEL G. NUTTER**

**201 LAW OFFICES OF
NICHOLAS J. COCHRAN**

202 BEHAVIORAL CONCEPTS

208 PACIFIC PARTS SALES

209 WELLNET, INC.

215 RONALD D. GODDU, C.P.A.

215 JEFFREY G. VESELY, C.P.A.

216 DAVID L. SCARBROUGH, C.P.A.

217 LEAR SOLUTIONS INC

219 CRAIG W. KLUMP, C.P.A.

220 MORRIS ENGINEERING



UPDATED

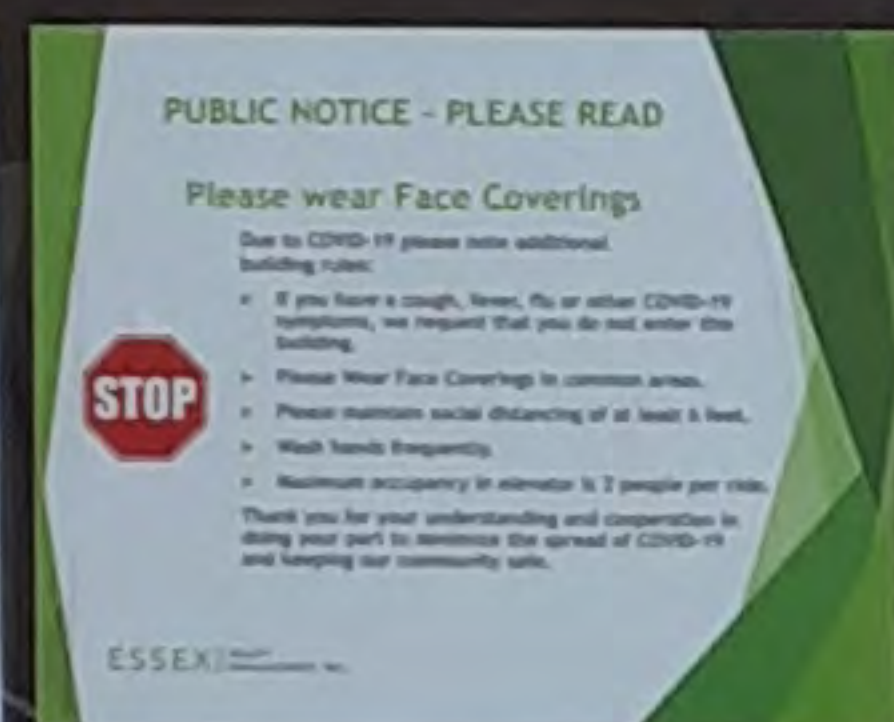

ACTUALIZADO



108

F. MICHAEL STONE,
AN ACCOUNTANCY CORP.

112

S & N LABS

116

ERIC W. GRUVER, Ph.D
FORENSIC AND CLINICAL PSYCHOLOGY

120

AGAPE INSURANCE

iHO INNOVATIVE HOUSING OPPORTUNITIES

Innovative Housing Opportunities, Inc. (IHO)
&
Orange County Community Housing Corporation (OCCHC)
Cordially invite you to a community information meeting for:

Golden Circle

140 units of affordable housing to be developed at
601 N. Golden Circle Drive and 2021 E. 4th Street, Santa Ana, CA 92705



At this meeting we will provide project information, solicit community input, and answer questions. Please virtually attend and share your thoughts and ideas.

**In effort to protect public health and prevent the spread of COVID-19 (Coronavirus), this meeting will take place virtually via Zoom.

Meeting Date and Time:
Tuesday, May 4, 2021 at 5:00PM

Online:
Location: <https://zoom.us/j/98793324002>
Meeting ID: 987 9332 4002
OR

Conference Call:
Phone #: (649) 900-6833
Meeting ID: 987 9332 4002

For more information, please visit our website at www.innovativehousing.com or send an email to goldencirclecommunitymeeting@innovativehousing.com

If you have any questions regarding this event or if you require language interpretation services, please contact IHO at (949) 863-9740

UPDATED

PUBLIC NOTICE - PLEASE READ

Please wear Face Coverings

Due to COVID-19 please note additional building rules:

- ▶ If you have a cough, fever, flu or other COVID-19 symptoms, we request that you do not enter this building.
- ▶ Please Wear Face Coverings in common areas.
- ▶ Please maintain social distancing of at least 6 feet.
- ▶ Wash hands frequently.
- ▶ Maximum occupancy in elevator is 2 people per ride.

Thank you for your understanding and cooperation in doing your part to minimize the spread of COVID-19 and keeping our community safe.

STOP

ESSEX REALTY MANAGEMENT, INC.

iHO INNOVATIVE HOUSING OPPORTUNITIES

Innovative Housing Opportunities, Inc. (IHO)
&
Orange County Community Housing Corporation (OCCHC)
Cordially invite you to a community information meeting for:

Golden Circle

Una propuesta de 140 unidades para personas de ingresos bajos para ser construido en
601 N. Golden Circle Drive y 2021 E. 4th Street, Santa Ana, CA 92705



En esta reunión proporcionaremos información sobre el proyecto, solicitaremos la opinión de la comunidad y responderemos preguntas. Asista virtualmente y comparte sus pensamientos e ideas.

** En un esfuerzo por proteger la salud pública y prevenir la propagación del COVID-19 (Coronavirus), esta reunión se llevará a cabo virtualmente a través de Zoom.

Fecha y Hora de la Reunión:
Martes, 4 de Mayo de 2021 a las 5:00 PM

En Línea:
Localización: <https://zoom.us/j/98793324002>
ID de Reunión: 987 9332 4002
O

En el Teléfono:
Número de teléfono: (649) 900-6833
ID de Reunión: 987 9332 4002

Para obtener más información, visite nuestro sitio web en www.innovativehousing.com o envíenos un correo electrónico a goldencirclecommunitymeeting@innovativehousing.com

Si tiene preguntas sobre el evento o requiere traducción en otros idiomas, por favor contacte IHO en (949) 863-9740

ACTUALIZADO

Attachment

3. Community Notice Mailing List

**CITY OF SANTA ANA PLANNING DEPARTMENT
LETTER OF CERTIFICATION**

**STATE OF CALIFORNIA
COUNTY OF ORANGE**

I, **ROBERT E. CUELLAR**, hereby certify that the attached list contains the addresses of all persons to whom reside within the area described and for a distance of **Five Hundred (500) feet** from the exterior boundaries of property legally described as:

See Attached Application

Signed

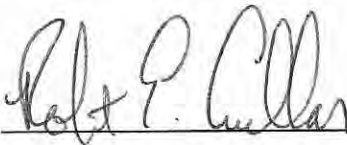

Date

FEBRUARY 3, 2021

601 N. GOLDEN CIRCLE DRIVE

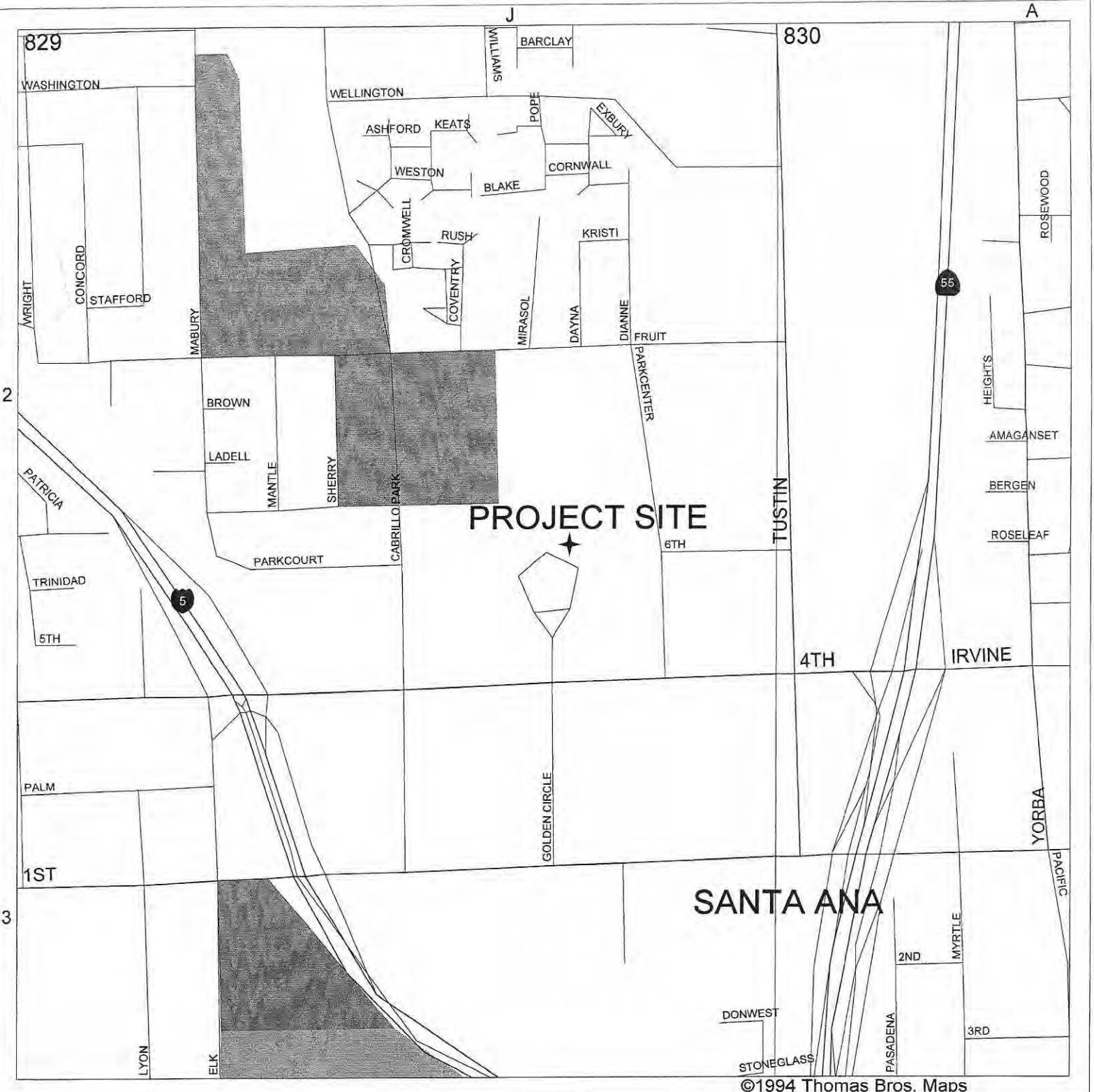

©1994 Thomas Bros. Maps

VICINITY MAP

SITE : 601 N. GOLDEN CIRCLE DRIVE

GC MAPPING SERVICE, INC.
 3055 WEST VALLEY BOULEVARD
 ALHAMBRA CA 91803
 (626) 441-1080, FAX (626) 441-8850
GCMAPPING@RADIUSMAPS.COM

INNOVATIVE HOUSING OPPORTUNITIES

ANTONIO RAMON

601 N. GOLDEN CIRCLE DR.

SANTA ANA - 500' OCCUPANT LIST

≈ 490 address

OCCUPANTS	SITE NO	DIR	SITE STREET	SFX	UNIT	SITE CITY	STATE	ZIP
OCCUPANT	2101	E	4TH	ST	#100	SANTA ANA	CA	92705
OCCUPANT	2101	E	4TH	ST	#110A	SANTA ANA	CA	92705
OCCUPANT	2101	E	4TH	ST	#140A	SANTA ANA	CA	92705
OCCUPANT	2101	E	4TH	ST	#150B	SANTA ANA	CA	92705
OCCUPANT	2101	E	4TH	ST	#160B	SANTA ANA	CA	92705
OCCUPANT	2101	E	4TH	ST	#165B	SANTA ANA	CA	92705
OCCUPANT	2101	E	4TH	ST	#170B	SANTA ANA	CA	92705
OCCUPANT	2101	E	4TH	ST	#180B	SANTA ANA	CA	92705
OCCUPANT	2101	E	4TH	ST	#185B	SANTA ANA	CA	92705
OCCUPANT	2101	E	4TH	ST	#195B	SANTA ANA	CA	92705
OCCUPANT	2101	E	4TH	ST	#200A	SANTA ANA	CA	92705
OCCUPANT	2101	E	4TH	ST	#200B	SANTA ANA	CA	92705
OCCUPANT	2101	E	4TH	ST	#220A	SANTA ANA	CA	92705
OCCUPANT	2101	E	4TH	ST	#230A	SANTA ANA	CA	92705
OCCUPANT	600		PARKCENTER	DR		SANTA ANA	CA	92705
OCCUPANT	550		PARKCENTER	DR	#100	SANTA ANA	CA	92705
OCCUPANT	550		PARKCENTER	DR	#102	SANTA ANA	CA	92705
OCCUPANT	550		PARKCENTER	DR	#104	SANTA ANA	CA	92705
OCCUPANT	550		PARKCENTER	DR	#105	SANTA ANA	CA	92705
OCCUPANT	550		PARKCENTER	DR	#150	SANTA ANA	CA	92705
OCCUPANT	550		PARKCENTER	DR	#200	SANTA ANA	CA	92705
OCCUPANT	550		PARKCENTER	DR	#202	SANTA ANA	CA	92705
OCCUPANT	550		PARKCENTER	DR	#204	SANTA ANA	CA	92705
OCCUPANT	550		PARKCENTER	DR	#205	SANTA ANA	CA	92705
OCCUPANT	601		PARKCENTER	DR	#101	SANTA ANA	CA	92705
OCCUPANT	601		PARKCENTER	DR	#102	SANTA ANA	CA	92705
OCCUPANT	601		PARKCENTER	DR	#103	SANTA ANA	CA	92705
OCCUPANT	601		PARKCENTER	DR	#104	SANTA ANA	CA	92705
OCCUPANT	601		PARKCENTER	DR	#105	SANTA ANA	CA	92705
OCCUPANT	601		PARKCENTER	DR	#106	SANTA ANA	CA	92705
OCCUPANT	601		PARKCENTER	DR	#107	SANTA ANA	CA	92705
OCCUPANT	601		PARKCENTER	DR	#108	SANTA ANA	CA	92705
OCCUPANT	601		PARKCENTER	DR	#109	SANTA ANA	CA	92705
OCCUPANT	601		PARKCENTER	DR	#201	SANTA ANA	CA	92705
OCCUPANT	601		PARKCENTER	DR	#202	SANTA ANA	CA	92705

INNOVATIVE HOUSING OPPORTUNITIES

ANTONIO RAMON

601 N. GOLDEN CIRCLE DR.

SANTA ANA - 500' OCCUPANT LIST

OCCUPANT	601		PARKCENTER	DR	#203	SANTA ANA	CA	92705
OCCUPANT	601		PARKCENTER	DR	#204	SANTA ANA	CA	92705
OCCUPANT	601		PARKCENTER	DR	#205	SANTA ANA	CA	92705
OCCUPANT	601		PARKCENTER	DR	#206	SANTA ANA	CA	92705
OCCUPANT	601		PARKCENTER	DR	#207	SANTA ANA	CA	92705
OCCUPANT	601		PARKCENTER	DR	#208	SANTA ANA	CA	92705
OCCUPANT	601		PARKCENTER	DR	#209	SANTA ANA	CA	92705
OCCUPANT	603		PARKCENTER	DR	#101	SANTA ANA	CA	92705
OCCUPANT	603		PARKCENTER	DR	#102	SANTA ANA	CA	92705
OCCUPANT	603		PARKCENTER	DR	#103	SANTA ANA	CA	92705
OCCUPANT	603		PARKCENTER	DR	#104	SANTA ANA	CA	92705
OCCUPANT	603		PARKCENTER	DR	#105	SANTA ANA	CA	92705
OCCUPANT	603		PARKCENTER	DR	#106	SANTA ANA	CA	92705
OCCUPANT	603		PARKCENTER	DR	#107	SANTA ANA	CA	92705
OCCUPANT	603		PARKCENTER	DR	#108	SANTA ANA	CA	92705
OCCUPANT	501		PARKCENTER	DR		SANTA ANA	CA	92705
OCCUPANT	555		PARKCENTER	DR	#100	SANTA ANA	CA	92705
OCCUPANT	555		PARKCENTER	DR	#102	SANTA ANA	CA	92705
OCCUPANT	555		PARKCENTER	DR	#110	SANTA ANA	CA	92705
OCCUPANT	555		PARKCENTER	DR	#115	SANTA ANA	CA	92705
OCCUPANT	555		PARKCENTER	DR	#116	SANTA ANA	CA	92705
OCCUPANT	555		PARKCENTER	DR	#118	SANTA ANA	CA	92705
OCCUPANT	555		PARKCENTER	DR	#200	SANTA ANA	CA	92705
OCCUPANT	555		PARKCENTER	DR	#202	SANTA ANA	CA	92705
OCCUPANT	555		PARKCENTER	DR	#204	SANTA ANA	CA	92705
OCCUPANT	555		PARKCENTER	DR	#206	SANTA ANA	CA	92705
OCCUPANT	555		PARKCENTER	DR	#215	SANTA ANA	CA	92705
OCCUPANT	555		PARKCENTER	DR	#221	SANTA ANA	CA	92705
OCCUPANT	555		PARKCENTER	DR	#223	SANTA ANA	CA	92705
OCCUPANT	555		PARKCENTER	DR	#225	SANTA ANA	CA	92705
OCCUPANT	1971	E	4TH	ST	#100	SANTA ANA	CA	92705
OCCUPANT	1971	E	4TH	ST	#130	SANTA ANA	CA	92705
OCCUPANT	1971	E	4TH	ST	#140	SANTA ANA	CA	92705
OCCUPANT	1971	E	4TH	ST	#180	SANTA ANA	CA	92705
OCCUPANT	1971	E	4TH	ST	#200	SANTA ANA	CA	92705
OCCUPANT	1971	E	4TH	ST	#220	SANTA ANA	CA	92705

INNOVATIVE HOUSING OPPORTUNITIES

ANTONIO RAMON

601 N. GOLDEN CIRCLE DR.

SANTA ANA - 500' OCCUPANT LIST

OCCUPANT	1971	E	4TH	ST	#240	SANTA ANA	CA	92705
OCCUPANT	1971	E	4TH	ST	#280	SANTA ANA	CA	92705
OCCUPANT	1971	E	4TH	ST	#290	SANTA ANA	CA	92705
OCCUPANT	1971	E	4TH	ST	#320	SANTA ANA	CA	92705
OCCUPANT	1971	E	4TH	ST	#130A	SANTA ANA	CA	92705
OCCUPANT	1971	E	4TH	ST	#130B	SANTA ANA	CA	92705
OCCUPANT	1971	E	4TH	ST	#130C	SANTA ANA	CA	92705
OCCUPANT	1971	E	4TH	ST	#325	SANTA ANA	CA	92705
OCCUPANT	1971	E	4TH	ST	#340	SANTA ANA	CA	92705
OCCUPANT	1901	E	4TH	ST	#100	SANTA ANA	CA	92705
OCCUPANT	1901	E	4TH	ST	#150	SANTA ANA	CA	92705
OCCUPANT	1901	E	4TH	ST	#180	SANTA ANA	CA	92705
OCCUPANT	1901	E	4TH	ST	#200	SANTA ANA	CA	92705
OCCUPANT	1901	E	4TH	ST	#210	SANTA ANA	CA	92705
OCCUPANT	1901	E	4TH	ST	#250	SANTA ANA	CA	92705
OCCUPANT	1901	E	4TH	ST	#300	SANTA ANA	CA	92705
OCCUPANT	1901	E	4TH	ST	#350	SANTA ANA	CA	92705
OCCUPANT	1901	E	4TH	ST	#360	SANTA ANA	CA	92705
OCCUPANT	515		CABRILLO PARK	DR	#100	SANTA ANA	CA	92705
OCCUPANT	515		CABRILLO PARK	DR	#102	SANTA ANA	CA	92705
OCCUPANT	515		CABRILLO PARK	DR	#120	SANTA ANA	CA	92705
OCCUPANT	515		CABRILLO PARK	DR	#140	SANTA ANA	CA	92705
OCCUPANT	515		CABRILLO PARK	DR	#200	SANTA ANA	CA	92705
OCCUPANT	515		CABRILLO PARK	DR	#225	SANTA ANA	CA	92705
OCCUPANT	515		CABRILLO PARK	DR	#250	SANTA ANA	CA	92705
OCCUPANT	515		CABRILLO PARK	DR	#300	SANTA ANA	CA	92705
OCCUPANT	515		CABRILLO PARK	DR	#301	SANTA ANA	CA	92705
OCCUPANT	515		CABRILLO PARK	DR	#310	SANTA ANA	CA	92705
OCCUPANT	515		CABRILLO PARK	DR	#311	SANTA ANA	CA	92705
OCCUPANT	515		CABRILLO PARK	DR	#312	SANTA ANA	CA	92705
OCCUPANT	515		CABRILLO PARK	DR	#315	SANTA ANA	CA	92705
OCCUPANT	515		CABRILLO PARK	DR	#320	SANTA ANA	CA	92705
OCCUPANT	525		CABRILLO PARK	DR	#100	SANTA ANA	CA	92705
OCCUPANT	525		CABRILLO PARK	DR	#104	SANTA ANA	CA	92705
OCCUPANT	525		CABRILLO PARK	DR	#125	SANTA ANA	CA	92705
OCCUPANT	525		CABRILLO PARK	DR	#140	SANTA ANA	CA	92705

INNOVATIVE HOUSING OPPORTUNITIES

ANTONIO RAMON

601 N. GOLDEN CIRCLE DR.

SANTA ANA - 500' OCCUPANT LIST

OCCUPANT	525		CABRILLO PARK	DR	#150	SANTA ANA	CA	92705
OCCUPANT	525		CABRILLO PARK	DR	#200	SANTA ANA	CA	92705
OCCUPANT	525		CABRILLO PARK	DR	#220	SANTA ANA	CA	92705
OCCUPANT	525		CABRILLO PARK	DR	#250	SANTA ANA	CA	92705
OCCUPANT	525		CABRILLO PARK	DR	#280	SANTA ANA	CA	92705
OCCUPANT	525		CABRILLO PARK	DR	#300	SANTA ANA	CA	92705
OCCUPANT	525		CABRILLO PARK	DR	#105	SANTA ANA	CA	92705
OCCUPANT	2001	E	4TH	ST	#100	SANTA ANA	CA	92705
OCCUPANT	2001	E	4TH	ST	#102	SANTA ANA	CA	92705
OCCUPANT	2001	E	4TH	ST	#103	SANTA ANA	CA	92705
OCCUPANT	2001	E	4TH	ST	#104	SANTA ANA	CA	92705
OCCUPANT	2001	E	4TH	ST	#106	SANTA ANA	CA	92705
OCCUPANT	2001	E	4TH	ST	#110	SANTA ANA	CA	92705
OCCUPANT	2001	E	4TH	ST	#112	SANTA ANA	CA	92705
OCCUPANT	2001	E	4TH	ST	#114	SANTA ANA	CA	92705
OCCUPANT	2001	E	4TH	ST	#116	SANTA ANA	CA	92705
OCCUPANT	2001	E	4TH	ST	#120	SANTA ANA	CA	92705
OCCUPANT	2001	E	4TH	ST	#125	SANTA ANA	CA	92705
OCCUPANT	2001	E	4TH	ST	#200	SANTA ANA	CA	92705
OCCUPANT	2001	E	4TH	ST	#201	SANTA ANA	CA	92705
OCCUPANT	2001	E	4TH	ST	#202	SANTA ANA	CA	92705
OCCUPANT	2001	E	4TH	ST	#205	SANTA ANA	CA	92705
OCCUPANT	2001	E	4TH	ST	#206	SANTA ANA	CA	92705
OCCUPANT	2001	E	4TH	ST	#207	SANTA ANA	CA	92705
OCCUPANT	2001	E	4TH	ST	#208	SANTA ANA	CA	92705
OCCUPANT	2001	E	4TH	ST	#210	SANTA ANA	CA	92705
OCCUPANT	2001	E	4TH	ST	#215	SANTA ANA	CA	92705
OCCUPANT	2001	E	4TH	ST	#216	SANTA ANA	CA	92705
OCCUPANT	2001	E	4TH	ST	#217	SANTA ANA	CA	92705
OCCUPANT	2001	E	4TH	ST	#219	SANTA ANA	CA	92705
OCCUPANT	2001	E	4TH	ST	#220	SANTA ANA	CA	92705
OCCUPANT	2001	E	4TH	ST	#224	SANTA ANA	CA	92705
OCCUPANT	601	N	GOLDEN CIRCLE	DR		SANTA ANA	CA	92705
OCCUPANT	550	N	GOLDEN CIRCLE	DR	#A	SANTA ANA	CA	92705
OCCUPANT	550	N	GOLDEN CIRCLE	DR	#B	SANTA ANA	CA	92705
OCCUPANT	540	N	GOLDEN CIRCLE	DR	#104	SANTA ANA	CA	92705

INNOVATIVE HOUSING OPPORTUNITIES

ANTONIO RAMON

601 N. GOLDEN CIRCLE DR.

SANTA ANA - 500' OCCUPANT LIST

OCCUPANT	540	N	GOLDEN CIRCLE	DR	#105	SANTA ANA	CA	92705
OCCUPANT	540	N	GOLDEN CIRCLE	DR	#107	SANTA ANA	CA	92705
OCCUPANT	540	N	GOLDEN CIRCLE	DR	#108	SANTA ANA	CA	92705
OCCUPANT	540	N	GOLDEN CIRCLE	DR	#111	SANTA ANA	CA	92705
OCCUPANT	540	N	GOLDEN CIRCLE	DR	#112	SANTA ANA	CA	92705
OCCUPANT	540	N	GOLDEN CIRCLE	DR	#113	SANTA ANA	CA	92705
OCCUPANT	540	N	GOLDEN CIRCLE	DR	#114	SANTA ANA	CA	92705
OCCUPANT	540	N	GOLDEN CIRCLE	DR	#115	SANTA ANA	CA	92705
OCCUPANT	540	N	GOLDEN CIRCLE	DR	#200	SANTA ANA	CA	92705
OCCUPANT	540	N	GOLDEN CIRCLE	DR	#201	SANTA ANA	CA	92705
OCCUPANT	540	N	GOLDEN CIRCLE	DR	#202	SANTA ANA	CA	92705
OCCUPANT	540	N	GOLDEN CIRCLE	DR	#203	SANTA ANA	CA	92705
OCCUPANT	540	N	GOLDEN CIRCLE	DR	#204	SANTA ANA	CA	92705
OCCUPANT	540	N	GOLDEN CIRCLE	DR	#205	SANTA ANA	CA	92705
OCCUPANT	540	N	GOLDEN CIRCLE	DR	#206	SANTA ANA	CA	92705
OCCUPANT	540	N	GOLDEN CIRCLE	DR	#210	SANTA ANA	CA	92705
OCCUPANT	540	N	GOLDEN CIRCLE	DR	#211	SANTA ANA	CA	92705
OCCUPANT	540	N	GOLDEN CIRCLE	DR	#212	SANTA ANA	CA	92705
OCCUPANT	540	N	GOLDEN CIRCLE	DR	#213	SANTA ANA	CA	92705
OCCUPANT	540	N	GOLDEN CIRCLE	DR	#214	SANTA ANA	CA	92705
OCCUPANT	540	N	GOLDEN CIRCLE	DR	#215	SANTA ANA	CA	92705
OCCUPANT	540	N	GOLDEN CIRCLE	DR	#300	SANTA ANA	CA	92705
OCCUPANT	540	N	GOLDEN CIRCLE	DR	#301	SANTA ANA	CA	92705
OCCUPANT	540	N	GOLDEN CIRCLE	DR	#302	SANTA ANA	CA	92705
OCCUPANT	540	N	GOLDEN CIRCLE	DR	#304	SANTA ANA	CA	92705
OCCUPANT	540	N	GOLDEN CIRCLE	DR	#305	SANTA ANA	CA	92705
OCCUPANT	540	N	GOLDEN CIRCLE	DR	#310	SANTA ANA	CA	92705
OCCUPANT	540	N	GOLDEN CIRCLE	DR	#312	SANTA ANA	CA	92705
OCCUPANT	540	N	GOLDEN CIRCLE	DR	#315	SANTA ANA	CA	92705
OCCUPANT	540	N	GOLDEN CIRCLE	DR	#316	SANTA ANA	CA	92705
OCCUPANT	501	N	GOLDEN CIRCLE	DR	#108	SANTA ANA	CA	92705
OCCUPANT	501	N	GOLDEN CIRCLE	DR	#200	SANTA ANA	CA	92705
OCCUPANT	501	N	GOLDEN CIRCLE	DR	#206	SANTA ANA	CA	92705
OCCUPANT	501	N	GOLDEN CIRCLE	DR	#208	SANTA ANA	CA	92705
OCCUPANT	2021	E	4TH	ST	#100	SANTA ANA	CA	92705
OCCUPANT	2021	E	4TH	ST	#102	SANTA ANA	CA	92705

INNOVATIVE HOUSING OPPORTUNITIES

ANTONIO RAMON

601 N. GOLDEN CIRCLE DR.

SANTA ANA - 500' OCCUPANT LIST

OCCUPANT	2021	E	4TH	ST	#104	SANTA ANA	CA	92705
OCCUPANT	2021	E	4TH	ST	#106	SANTA ANA	CA	92705
OCCUPANT	2021	E	4TH	ST	#108	SANTA ANA	CA	92705
OCCUPANT	2021	E	4TH	ST	#110	SANTA ANA	CA	92705
OCCUPANT	2021	E	4TH	ST	#112	SANTA ANA	CA	92705
OCCUPANT	2021	E	4TH	ST	#114	SANTA ANA	CA	92705
OCCUPANT	2021	E	4TH	ST	#115	SANTA ANA	CA	92705
OCCUPANT	2021	E	4TH	ST	#116	SANTA ANA	CA	92705
OCCUPANT	2021	E	4TH	ST	#118	SANTA ANA	CA	92705
OCCUPANT	2021	E	4TH	ST	#119	SANTA ANA	CA	92705
OCCUPANT	2021	E	4TH	ST	#120	SANTA ANA	CA	92705
OCCUPANT	2021	E	4TH	ST	#122	SANTA ANA	CA	92705
OCCUPANT	2021	E	4TH	ST	#200	SANTA ANA	CA	92705
OCCUPANT	2021	E	4TH	ST	#201	SANTA ANA	CA	92705
OCCUPANT	2021	E	4TH	ST	#202	SANTA ANA	CA	92705
OCCUPANT	2021	E	4TH	ST	#204	SANTA ANA	CA	92705
OCCUPANT	2021	E	4TH	ST	#207	SANTA ANA	CA	92705
OCCUPANT	2021	E	4TH	ST	#208	SANTA ANA	CA	92705
OCCUPANT	2021	E	4TH	ST	#209	SANTA ANA	CA	92705
OCCUPANT	2021	E	4TH	ST	#210	SANTA ANA	CA	92705
OCCUPANT	2021	E	4TH	ST	#215	SANTA ANA	CA	92705
OCCUPANT	2021	E	4TH	ST	#216	SANTA ANA	CA	92705
OCCUPANT	2021	E	4TH	ST	#217	SANTA ANA	CA	92705
OCCUPANT	2021	E	4TH	ST	#218	SANTA ANA	CA	92705
OCCUPANT	2021	E	4TH	ST	#219	SANTA ANA	CA	92705
OCCUPANT	2021	E	4TH	ST	#220	SANTA ANA	CA	92705
OCCUPANT	700		PARKCENTER	DR	#1	SANTA ANA	CA	92705
OCCUPANT	700		PARKCENTER	DR	#10	SANTA ANA	CA	92705
OCCUPANT	700		PARKCENTER	DR	#2	SANTA ANA	CA	92705
OCCUPANT	700		PARKCENTER	DR	#3	SANTA ANA	CA	92705
OCCUPANT	700		PARKCENTER	DR	#4	SANTA ANA	CA	92705
OCCUPANT	700		PARKCENTER	DR	#5	SANTA ANA	CA	92705
OCCUPANT	700		PARKCENTER	DR	#6	SANTA ANA	CA	92705
OCCUPANT	700		PARKCENTER	DR	#7	SANTA ANA	CA	92705
OCCUPANT	700		PARKCENTER	DR	#8	SANTA ANA	CA	92705
OCCUPANT	700		PARKCENTER	DR	#9	SANTA ANA	CA	92705

INNOVATIVE HOUSING OPPORTUNITIES

ANTONIO RAMON

601 N. GOLDEN CIRCLE DR.

SANTA ANA - 500' OCCUPANT LIST

OCCUPANT	702		PARKCENTER	DR	#11	SANTA ANA	CA	92705
OCCUPANT	702		PARKCENTER	DR	#12	SANTA ANA	CA	92705
OCCUPANT	702		PARKCENTER	DR	#13	SANTA ANA	CA	92705
OCCUPANT	702		PARKCENTER	DR	#14	SANTA ANA	CA	92705
OCCUPANT	702		PARKCENTER	DR	#15	SANTA ANA	CA	92705
OCCUPANT	702		PARKCENTER	DR	#16	SANTA ANA	CA	92705
OCCUPANT	702		PARKCENTER	DR	#17	SANTA ANA	CA	92705
OCCUPANT	702		PARKCENTER	DR	#18	SANTA ANA	CA	92705
OCCUPANT	702		PARKCENTER	DR	#19	SANTA ANA	CA	92705
OCCUPANT	702		PARKCENTER	DR	#20	SANTA ANA	CA	92705
OCCUPANT	704		PARKCENTER	DR	#21	SANTA ANA	CA	92705
OCCUPANT	704		PARKCENTER	DR	#22	SANTA ANA	CA	92705
OCCUPANT	704		PARKCENTER	DR	#23	SANTA ANA	CA	92705
OCCUPANT	704		PARKCENTER	DR	#24	SANTA ANA	CA	92705
OCCUPANT	704		PARKCENTER	DR	#25	SANTA ANA	CA	92705
OCCUPANT	704		PARKCENTER	DR	#26	SANTA ANA	CA	92705
OCCUPANT	704		PARKCENTER	DR	#27	SANTA ANA	CA	92705
OCCUPANT	704		PARKCENTER	DR	#28	SANTA ANA	CA	92705
OCCUPANT	704		PARKCENTER	DR	#29	SANTA ANA	CA	92705
OCCUPANT	704		PARKCENTER	DR	#30	SANTA ANA	CA	92705
OCCUPANT	710		PARKCENTER	DR	#31	SANTA ANA	CA	92705
OCCUPANT	710		PARKCENTER	DR	#32	SANTA ANA	CA	92705
OCCUPANT	710		PARKCENTER	DR	#33	SANTA ANA	CA	92705
OCCUPANT	710		PARKCENTER	DR	#34	SANTA ANA	CA	92705
OCCUPANT	710		PARKCENTER	DR	#35	SANTA ANA	CA	92705
OCCUPANT	710		PARKCENTER	DR	#36	SANTA ANA	CA	92705
OCCUPANT	710		PARKCENTER	DR	#37	SANTA ANA	CA	92705
OCCUPANT	710		PARKCENTER	DR	#38	SANTA ANA	CA	92705
OCCUPANT	710		PARKCENTER	DR	#39	SANTA ANA	CA	92705
OCCUPANT	710		PARKCENTER	DR	#40	SANTA ANA	CA	92705
OCCUPANT	710		PARKCENTER	DR	#41	SANTA ANA	CA	92705
OCCUPANT	710		PARKCENTER	DR	#42	SANTA ANA	CA	92705
OCCUPANT	710		PARKCENTER	DR	#43	SANTA ANA	CA	92705
OCCUPANT	710		PARKCENTER	DR	#44	SANTA ANA	CA	92705
OCCUPANT	710		PARKCENTER	DR	#45	SANTA ANA	CA	92705
OCCUPANT	710		PARKCENTER	DR	#46	SANTA ANA	CA	92705

INNOVATIVE HOUSING OPPORTUNITIES

ANTONIO RAMON

601 N. GOLDEN CIRCLE DR.

SANTA ANA - 500' OCCUPANT LIST

OCCUPANT	710		PARKCENTER	DR	#47	SANTA ANA	CA	92705
OCCUPANT	710		PARKCENTER	DR	#48	SANTA ANA	CA	92705
OCCUPANT	712		PARKCENTER	DR	#157	SANTA ANA	CA	92705
OCCUPANT	712		PARKCENTER	DR	#158	SANTA ANA	CA	92705
OCCUPANT	712		PARKCENTER	DR	#159	SANTA ANA	CA	92705
OCCUPANT	712		PARKCENTER	DR	#160	SANTA ANA	CA	92705
OCCUPANT	712		PARKCENTER	DR	#161	SANTA ANA	CA	92705
OCCUPANT	712		PARKCENTER	DR	#162	SANTA ANA	CA	92705
OCCUPANT	712		PARKCENTER	DR	#163	SANTA ANA	CA	92705
OCCUPANT	712		PARKCENTER	DR	#164	SANTA ANA	CA	92705
OCCUPANT	712		PARKCENTER	DR	#165	SANTA ANA	CA	92705
OCCUPANT	712		PARKCENTER	DR	#166	SANTA ANA	CA	92705
OCCUPANT	714		PARKCENTER	DR	#147	SANTA ANA	CA	92705
OCCUPANT	714		PARKCENTER	DR	#148	SANTA ANA	CA	92705
OCCUPANT	714		PARKCENTER	DR	#149	SANTA ANA	CA	92705
OCCUPANT	714		PARKCENTER	DR	#150	SANTA ANA	CA	92705
OCCUPANT	714		PARKCENTER	DR	#151	SANTA ANA	CA	92705
OCCUPANT	714		PARKCENTER	DR	#152	SANTA ANA	CA	92705
OCCUPANT	714		PARKCENTER	DR	#153	SANTA ANA	CA	92705
OCCUPANT	714		PARKCENTER	DR	#154	SANTA ANA	CA	92705
OCCUPANT	714		PARKCENTER	DR	#155	SANTA ANA	CA	92705
OCCUPANT	714		PARKCENTER	DR	#156	SANTA ANA	CA	92705
OCCUPANT	716		PARKCENTER	DR	#137	SANTA ANA	CA	92705
OCCUPANT	716		PARKCENTER	DR	#138	SANTA ANA	CA	92705
OCCUPANT	716		PARKCENTER	DR	#139	SANTA ANA	CA	92705
OCCUPANT	716		PARKCENTER	DR	#140	SANTA ANA	CA	92705
OCCUPANT	716		PARKCENTER	DR	#141	SANTA ANA	CA	92705
OCCUPANT	716		PARKCENTER	DR	#142	SANTA ANA	CA	92705
OCCUPANT	716		PARKCENTER	DR	#143	SANTA ANA	CA	92705
OCCUPANT	716		PARKCENTER	DR	#144	SANTA ANA	CA	92705
OCCUPANT	716		PARKCENTER	DR	#145	SANTA ANA	CA	92705
OCCUPANT	716		PARKCENTER	DR	#146	SANTA ANA	CA	92705
OCCUPANT	718		PARKCENTER	DR	#119	SANTA ANA	CA	92705
OCCUPANT	718		PARKCENTER	DR	#120	SANTA ANA	CA	92705
OCCUPANT	718		PARKCENTER	DR	#121	SANTA ANA	CA	92705
OCCUPANT	718		PARKCENTER	DR	#122	SANTA ANA	CA	92705

INNOVATIVE HOUSING OPPORTUNITIES

ANTONIO RAMON

601 N. GOLDEN CIRCLE DR.

SANTA ANA - 500' OCCUPANT LIST

OCCUPANT	718		PARKCENTER	DR	#123	SANTA ANA	CA	92705
OCCUPANT	718		PARKCENTER	DR	#124	SANTA ANA	CA	92705
OCCUPANT	718		PARKCENTER	DR	#125	SANTA ANA	CA	92705
OCCUPANT	718		PARKCENTER	DR	#126	SANTA ANA	CA	92705
OCCUPANT	718		PARKCENTER	DR	#127	SANTA ANA	CA	92705
OCCUPANT	718		PARKCENTER	DR	#128	SANTA ANA	CA	92705
OCCUPANT	718		PARKCENTER	DR	#129	SANTA ANA	CA	92705
OCCUPANT	718		PARKCENTER	DR	#130	SANTA ANA	CA	92705
OCCUPANT	718		PARKCENTER	DR	#131	SANTA ANA	CA	92705
OCCUPANT	718		PARKCENTER	DR	#132	SANTA ANA	CA	92705
OCCUPANT	718		PARKCENTER	DR	#133	SANTA ANA	CA	92705
OCCUPANT	718		PARKCENTER	DR	#134	SANTA ANA	CA	92705
OCCUPANT	718		PARKCENTER	DR	#135	SANTA ANA	CA	92705
OCCUPANT	718		PARKCENTER	DR	#136	SANTA ANA	CA	92705
OCCUPANT	722		PARKCENTER	DR	#100	SANTA ANA	CA	92705
OCCUPANT	722		PARKCENTER	DR	#101	SANTA ANA	CA	92705
OCCUPANT	722		PARKCENTER	DR	#102	SANTA ANA	CA	92705
OCCUPANT	722		PARKCENTER	DR	#103	SANTA ANA	CA	92705
OCCUPANT	722		PARKCENTER	DR	#104	SANTA ANA	CA	92705
OCCUPANT	722		PARKCENTER	DR	#105	SANTA ANA	CA	92705
OCCUPANT	722		PARKCENTER	DR	#106	SANTA ANA	CA	92705
OCCUPANT	722		PARKCENTER	DR	#107	SANTA ANA	CA	92705
OCCUPANT	722		PARKCENTER	DR	#108	SANTA ANA	CA	92705
OCCUPANT	722		PARKCENTER	DR	#99	SANTA ANA	CA	92705
OCCUPANT	724		PARKCENTER	DR	#89	SANTA ANA	CA	92705
OCCUPANT	724		PARKCENTER	DR	#90	SANTA ANA	CA	92705
OCCUPANT	724		PARKCENTER	DR	#91	SANTA ANA	CA	92705
OCCUPANT	724		PARKCENTER	DR	#92	SANTA ANA	CA	92705
OCCUPANT	724		PARKCENTER	DR	#93	SANTA ANA	CA	92705
OCCUPANT	724		PARKCENTER	DR	#94	SANTA ANA	CA	92705
OCCUPANT	724		PARKCENTER	DR	#95	SANTA ANA	CA	92705
OCCUPANT	724		PARKCENTER	DR	#96	SANTA ANA	CA	92705
OCCUPANT	724		PARKCENTER	DR	#97	SANTA ANA	CA	92705
OCCUPANT	724		PARKCENTER	DR	#98	SANTA ANA	CA	92705
OCCUPANT	726		PARKCENTER	DR	#79	SANTA ANA	CA	92705
OCCUPANT	726		PARKCENTER	DR	#80	SANTA ANA	CA	92705

INNOVATIVE HOUSING OPPORTUNITIES

ANTONIO RAMON

601 N. GOLDEN CIRCLE DR.

SANTA ANA - 500' OCCUPANT LIST

OCCUPANT	726		PARKCENTER	DR	#81	SANTA ANA	CA	92705
OCCUPANT	726		PARKCENTER	DR	#82	SANTA ANA	CA	92705
OCCUPANT	726		PARKCENTER	DR	#83	SANTA ANA	CA	92705
OCCUPANT	726		PARKCENTER	DR	#84	SANTA ANA	CA	92705
OCCUPANT	726		PARKCENTER	DR	#85	SANTA ANA	CA	92705
OCCUPANT	726		PARKCENTER	DR	#86	SANTA ANA	CA	92705
OCCUPANT	726		PARKCENTER	DR	#87	SANTA ANA	CA	92705
OCCUPANT	726		PARKCENTER	DR	#88	SANTA ANA	CA	92705
OCCUPANT	728		PARKCENTER	DR	#69	SANTA ANA	CA	92705
OCCUPANT	728		PARKCENTER	DR	#70	SANTA ANA	CA	92705
OCCUPANT	728		PARKCENTER	DR	#71	SANTA ANA	CA	92705
OCCUPANT	728		PARKCENTER	DR	#72	SANTA ANA	CA	92705
OCCUPANT	728		PARKCENTER	DR	#73	SANTA ANA	CA	92705
OCCUPANT	728		PARKCENTER	DR	#74	SANTA ANA	CA	92705
OCCUPANT	728		PARKCENTER	DR	#75	SANTA ANA	CA	92705
OCCUPANT	728		PARKCENTER	DR	#76	SANTA ANA	CA	92705
OCCUPANT	728		PARKCENTER	DR	#77	SANTA ANA	CA	92705
OCCUPANT	728		PARKCENTER	DR	#78	SANTA ANA	CA	92705
OCCUPANT	730		PARKCENTER	DR	#59	SANTA ANA	CA	92705
OCCUPANT	730		PARKCENTER	DR	#60	SANTA ANA	CA	92705
OCCUPANT	730		PARKCENTER	DR	#61	SANTA ANA	CA	92705
OCCUPANT	730		PARKCENTER	DR	#62	SANTA ANA	CA	92705
OCCUPANT	730		PARKCENTER	DR	#63	SANTA ANA	CA	92705
OCCUPANT	730		PARKCENTER	DR	#64	SANTA ANA	CA	92705
OCCUPANT	730		PARKCENTER	DR	#65	SANTA ANA	CA	92705
OCCUPANT	730		PARKCENTER	DR	#66	SANTA ANA	CA	92705
OCCUPANT	730		PARKCENTER	DR	#67	SANTA ANA	CA	92705
OCCUPANT	730		PARKCENTER	DR	#68	SANTA ANA	CA	92705
OCCUPANT	732		PARKCENTER	DR	#49	SANTA ANA	CA	92705
OCCUPANT	732		PARKCENTER	DR	#50	SANTA ANA	CA	92705
OCCUPANT	732		PARKCENTER	DR	#51	SANTA ANA	CA	92705
OCCUPANT	732		PARKCENTER	DR	#52	SANTA ANA	CA	92705
OCCUPANT	732		PARKCENTER	DR	#53	SANTA ANA	CA	92705
OCCUPANT	732		PARKCENTER	DR	#54	SANTA ANA	CA	92705
OCCUPANT	732		PARKCENTER	DR	#55	SANTA ANA	CA	92705
OCCUPANT	732		PARKCENTER	DR	#56	SANTA ANA	CA	92705

INNOVATIVE HOUSING OPPORTUNITIES

ANTONIO RAMON

601 N. GOLDEN CIRCLE DR.

SANTA ANA - 500' OCCUPANT LIST

OCCUPANT	732		PARKCENTER	DR	#57	SANTA ANA	CA	92705
OCCUPANT	732		PARKCENTER	DR	#58	SANTA ANA	CA	92705
OCCUPANT	750		PARKCENTER	DR		SANTA ANA	CA	92705
OCCUPANT	802		PARKCENTER	DR	#100	SANTA ANA	CA	92705
OCCUPANT	802		PARKCENTER	DR	#101	SANTA ANA	CA	92705
OCCUPANT	802		PARKCENTER	DR	#102	SANTA ANA	CA	92705
OCCUPANT	802		PARKCENTER	DR	#103	SANTA ANA	CA	92705
OCCUPANT	802		PARKCENTER	DR	#104	SANTA ANA	CA	92705
OCCUPANT	802		PARKCENTER	DR	#105	SANTA ANA	CA	92705
OCCUPANT	802		PARKCENTER	DR	#106	SANTA ANA	CA	92705
OCCUPANT	802		PARKCENTER	DR	#107	SANTA ANA	CA	92705
OCCUPANT	802		PARKCENTER	DR	#108	SANTA ANA	CA	92705
OCCUPANT	802		PARKCENTER	DR	#99	SANTA ANA	CA	92705
OCCUPANT	804		PARKCENTER	DR	#109	SANTA ANA	CA	92705
OCCUPANT	804		PARKCENTER	DR	#110	SANTA ANA	CA	92705
OCCUPANT	804		PARKCENTER	DR	#111	SANTA ANA	CA	92705
OCCUPANT	804		PARKCENTER	DR	#112	SANTA ANA	CA	92705
OCCUPANT	804		PARKCENTER	DR	#113	SANTA ANA	CA	92705
OCCUPANT	804		PARKCENTER	DR	#114	SANTA ANA	CA	92705
OCCUPANT	804		PARKCENTER	DR	#115	SANTA ANA	CA	92705
OCCUPANT	804		PARKCENTER	DR	#116	SANTA ANA	CA	92705
OCCUPANT	804		PARKCENTER	DR	#117	SANTA ANA	CA	92705
OCCUPANT	804		PARKCENTER	DR	#118	SANTA ANA	CA	92705
OCCUPANT	806		PARKCENTER	DR	#89	SANTA ANA	CA	92705
OCCUPANT	806		PARKCENTER	DR	#90	SANTA ANA	CA	92705
OCCUPANT	806		PARKCENTER	DR	#91	SANTA ANA	CA	92705
OCCUPANT	806		PARKCENTER	DR	#92	SANTA ANA	CA	92705
OCCUPANT	806		PARKCENTER	DR	#93	SANTA ANA	CA	92705
OCCUPANT	806		PARKCENTER	DR	#94	SANTA ANA	CA	92705
OCCUPANT	806		PARKCENTER	DR	#95	SANTA ANA	CA	92705
OCCUPANT	806		PARKCENTER	DR	#96	SANTA ANA	CA	92705
OCCUPANT	806		PARKCENTER	DR	#97	SANTA ANA	CA	92705
OCCUPANT	806		PARKCENTER	DR	#98	SANTA ANA	CA	92705
OCCUPANT	808		PARKCENTER	DR	#61	SANTA ANA	CA	92705
OCCUPANT	808		PARKCENTER	DR	#62	SANTA ANA	CA	92705
OCCUPANT	808		PARKCENTER	DR	#63	SANTA ANA	CA	92705

INNOVATIVE HOUSING OPPORTUNITIES

ANTONIO RAMON

601 N. GOLDEN CIRCLE DR.

SANTA ANA - 500' OCCUPANT LIST

OCCUPANT	808		PARKCENTER	DR	#64	SANTA ANA	CA	92705
OCCUPANT	808		PARKCENTER	DR	#65	SANTA ANA	CA	92705
OCCUPANT	808		PARKCENTER	DR	#66	SANTA ANA	CA	92705
OCCUPANT	808		PARKCENTER	DR	#67	SANTA ANA	CA	92705
OCCUPANT	808		PARKCENTER	DR	#68	SANTA ANA	CA	92705
OCCUPANT	808		PARKCENTER	DR	#69	SANTA ANA	CA	92705
OCCUPANT	808		PARKCENTER	DR	#70	SANTA ANA	CA	92705
OCCUPANT	810		PARKCENTER	DR	#51	SANTA ANA	CA	92705
OCCUPANT	810		PARKCENTER	DR	#52	SANTA ANA	CA	92705
OCCUPANT	810		PARKCENTER	DR	#53	SANTA ANA	CA	92705
OCCUPANT	810		PARKCENTER	DR	#54	SANTA ANA	CA	92705
OCCUPANT	810		PARKCENTER	DR	#55	SANTA ANA	CA	92705
OCCUPANT	810		PARKCENTER	DR	#56	SANTA ANA	CA	92705
OCCUPANT	810		PARKCENTER	DR	#57	SANTA ANA	CA	92705
OCCUPANT	810		PARKCENTER	DR	#58	SANTA ANA	CA	92705
OCCUPANT	810		PARKCENTER	DR	#59	SANTA ANA	CA	92705
OCCUPANT	810		PARKCENTER	DR	#60	SANTA ANA	CA	92705
OCCUPANT	812		PARKCENTER	DR	#41	SANTA ANA	CA	92705
OCCUPANT	812		PARKCENTER	DR	#42	SANTA ANA	CA	92705
OCCUPANT	812		PARKCENTER	DR	#43	SANTA ANA	CA	92705
OCCUPANT	812		PARKCENTER	DR	#44	SANTA ANA	CA	92705
OCCUPANT	812		PARKCENTER	DR	#45	SANTA ANA	CA	92705
OCCUPANT	812		PARKCENTER	DR	#46	SANTA ANA	CA	92705
OCCUPANT	812		PARKCENTER	DR	#47	SANTA ANA	CA	92705
OCCUPANT	812		PARKCENTER	DR	#48	SANTA ANA	CA	92705
OCCUPANT	812		PARKCENTER	DR	#49	SANTA ANA	CA	92705
OCCUPANT	812		PARKCENTER	DR	#50	SANTA ANA	CA	92705
OCCUPANT	814		PARKCENTER	DR	#31	SANTA ANA	CA	92705
OCCUPANT	814		PARKCENTER	DR	#32	SANTA ANA	CA	92705
OCCUPANT	814		PARKCENTER	DR	#33	SANTA ANA	CA	92705
OCCUPANT	814		PARKCENTER	DR	#34	SANTA ANA	CA	92705
OCCUPANT	814		PARKCENTER	DR	#35	SANTA ANA	CA	92705
OCCUPANT	814		PARKCENTER	DR	#36	SANTA ANA	CA	92705
OCCUPANT	814		PARKCENTER	DR	#37	SANTA ANA	CA	92705
OCCUPANT	814		PARKCENTER	DR	#38	SANTA ANA	CA	92705
OCCUPANT	814		PARKCENTER	DR	#39	SANTA ANA	CA	92705

INNOVATIVE HOUSING OPPORTUNITIES

ANTONIO RAMON

601 N. GOLDEN CIRCLE DR.

SANTA ANA - 500' OCCUPANT LIST

OCCUPANT	814		PARKCENTER	DR	#40	SANTA ANA	CA	92705
OCCUPANT	816		PARKCENTER	DR	#21	SANTA ANA	CA	92705
OCCUPANT	816		PARKCENTER	DR	#22	SANTA ANA	CA	92705
OCCUPANT	816		PARKCENTER	DR	#23	SANTA ANA	CA	92705
OCCUPANT	816		PARKCENTER	DR	#24	SANTA ANA	CA	92705
OCCUPANT	816		PARKCENTER	DR	#25	SANTA ANA	CA	92705
OCCUPANT	816		PARKCENTER	DR	#26	SANTA ANA	CA	92705
OCCUPANT	816		PARKCENTER	DR	#27	SANTA ANA	CA	92705
OCCUPANT	816		PARKCENTER	DR	#28	SANTA ANA	CA	92705
OCCUPANT	816		PARKCENTER	DR	#29	SANTA ANA	CA	92705
OCCUPANT	816		PARKCENTER	DR	#30	SANTA ANA	CA	92705
OCCUPANT	818		PARKCENTER	DR	#11	SANTA ANA	CA	92705
OCCUPANT	818		PARKCENTER	DR	#12	SANTA ANA	CA	92705
OCCUPANT	818		PARKCENTER	DR	#13	SANTA ANA	CA	92705
OCCUPANT	818		PARKCENTER	DR	#14	SANTA ANA	CA	92705
OCCUPANT	818		PARKCENTER	DR	#15	SANTA ANA	CA	92705
OCCUPANT	818		PARKCENTER	DR	#16	SANTA ANA	CA	92705
OCCUPANT	818		PARKCENTER	DR	#17	SANTA ANA	CA	92705
OCCUPANT	818		PARKCENTER	DR	#18	SANTA ANA	CA	92705
OCCUPANT	818		PARKCENTER	DR	#19	SANTA ANA	CA	92705
OCCUPANT	818		PARKCENTER	DR	#20	SANTA ANA	CA	92705
OCCUPANT	820		PARKCENTER	DR	#1	SANTA ANA	CA	92705
OCCUPANT	820		PARKCENTER	DR	#10	SANTA ANA	CA	92705
OCCUPANT	820		PARKCENTER	DR	#2	SANTA ANA	CA	92705
OCCUPANT	820		PARKCENTER	DR	#3	SANTA ANA	CA	92705
OCCUPANT	820		PARKCENTER	DR	#4	SANTA ANA	CA	92705
OCCUPANT	820		PARKCENTER	DR	#5	SANTA ANA	CA	92705
OCCUPANT	820		PARKCENTER	DR	#6	SANTA ANA	CA	92705
OCCUPANT	820		PARKCENTER	DR	#7	SANTA ANA	CA	92705
OCCUPANT	820		PARKCENTER	DR	#8	SANTA ANA	CA	92705
OCCUPANT	820		PARKCENTER	DR	#9	SANTA ANA	CA	92705
OCCUPANT	822		PARKCENTER	DR	#71	SANTA ANA	CA	92705
OCCUPANT	822		PARKCENTER	DR	#72	SANTA ANA	CA	92705
OCCUPANT	822		PARKCENTER	DR	#73	SANTA ANA	CA	92705
OCCUPANT	822		PARKCENTER	DR	#74	SANTA ANA	CA	92705
OCCUPANT	822		PARKCENTER	DR	#75	SANTA ANA	CA	92705

INNOVATIVE HOUSING OPPORTUNITIES

ANTONIO RAMON

601 N. GOLDEN CIRCLE DR.

SANTA ANA - 500' OCCUPANT LIST

OCCUPANT	822		PARKCENTER	DR	#76	SANTA ANA	CA	92705
OCCUPANT	822		PARKCENTER	DR	#77	SANTA ANA	CA	92705
OCCUPANT	822		PARKCENTER	DR	#78	SANTA ANA	CA	92705
OCCUPANT	822		PARKCENTER	DR	#79	SANTA ANA	CA	92705
OCCUPANT	822		PARKCENTER	DR	#80	SANTA ANA	CA	92705
OCCUPANT	822		PARKCENTER	DR	#81	SANTA ANA	CA	92705
OCCUPANT	822		PARKCENTER	DR	#82	SANTA ANA	CA	92705
OCCUPANT	822		PARKCENTER	DR	#83	SANTA ANA	CA	92705
OCCUPANT	822		PARKCENTER	DR	#84	SANTA ANA	CA	92705
OCCUPANT	822		PARKCENTER	DR	#85	SANTA ANA	CA	92705
OCCUPANT	822		PARKCENTER	DR	#86	SANTA ANA	CA	92705
OCCUPANT	822		PARKCENTER	DR	#87	SANTA ANA	CA	92705
OCCUPANT	822		PARKCENTER	DR	#88	SANTA ANA	CA	92705
OCCUPANT	701		PARKCENTER	DR	#110	SANTA ANA	CA	92705
OCCUPANT	701		PARKCENTER	DR	#200	SANTA ANA	CA	92705
OCCUPANT	801		PARKCENTER	DR	#101	SANTA ANA	CA	92705
OCCUPANT	801		PARKCENTER	DR	#103	SANTA ANA	CA	92705
OCCUPANT	801		PARKCENTER	DR	#104	SANTA ANA	CA	92705
OCCUPANT	801		PARKCENTER	DR	#105	SANTA ANA	CA	92705
OCCUPANT	801		PARKCENTER	DR	#106	SANTA ANA	CA	92705
OCCUPANT	801		PARKCENTER	DR	#107	SANTA ANA	CA	92705
OCCUPANT	801		PARKCENTER	DR	#110	SANTA ANA	CA	92705
OCCUPANT	801		PARKCENTER	DR	#202	SANTA ANA	CA	92705
OCCUPANT	801		PARKCENTER	DR	#205	SANTA ANA	CA	92705
OCCUPANT	801		PARKCENTER	DR	#220	SANTA ANA	CA	92705
OCCUPANT	801		PARKCENTER	DR	#225	SANTA ANA	CA	92705
OCCUPANT	801		PARKCENTER	DR	#235	SANTA ANA	CA	92705
OCCUPANT	801		PARKCENTER	DR	#255	SANTA ANA	CA	92705

Attachment

4. Map of Mailing Area

Residential area included in 500' radius is highlighted in yellow.

CITY OF SANTA ANA



500' RADIUS MAP

GC MAPPING SERVICE, INC.

3055 WEST VALLEY BOULEVARD
ALHAMBRA CA 91803
(626) 441-1080 FAX (626) 441-8850
GCMAPPING@RADIUSMAPS.COM

SITE ADDRESS:
601 N. GOLDEN CIRCLE

CASE NO.

DATE: 11-04-2020

SCALE: 1" = 100'

LOCATION MAP

Attachment

5. Affidavit of Mailing

Affidavit of Mailing

I hereby certify that on Tuesday, April 20, 2021, at 3:00 pm, GC Mapping mailed notifications regarding "COMMUNITY MEETING".

Notice was sent out to 495 occupants, and interested persons.

Project site: 601 N. Golden Circle, Santa Ana

The letters were mailed at the US Post Office located at 10 W Bay State Street in the City of Alhambra.

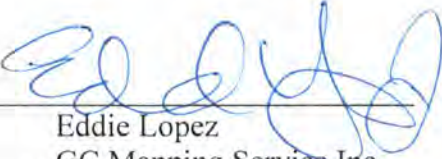

Eddie Lopez
GC Mapping Service Inc

April 21, 2021
Date

Attachment

6. Notification Published in Orange County Register

The Orange County Register

1771 S. Lewis Street
Anaheim, CA 92805
714-796-2209

5274846

INNOVATIVE HOUSING OPPORTUNITIES, INC.
501 GOLDEN CIRCLE SUITE 100
ATTN: MIGUEL GARCIA
SANTA ANA, CA 92705

AFFIDAVIT OF PUBLICATION

STATE OF CALIFORNIA, }
County of Orange } SS.

I am a citizen of the United States and a resident of the County aforesaid; I am over the age of eighteen years, and not a party to or interested in the above entitled matter. I am the principal clerk of The Orange County Register, a newspaper of general circulation, published in the city of Santa Ana, County of Orange, and which newspaper has been adjudged to be a newspaper of general circulation by the Superior Court of the County of Orange, State of California, under the date of November 19, 1905, Case No. A-21046, that the notice, of which the annexed is a true printed copy, has been published in each regular and entire issue of said newspaper and not in any supplement thereof on the following dates, to wit:

04/22/2021

I certify (or declare) under the penalty of perjury under the laws of the State of California that the foregoing is true and correct:

Executed at Anaheim, Orange County, California, on Date: April 22, 2021.



Signature

PROOF OF PUBLICATION

Legal No. 0011457042

Innovative Housing Opportunities, Inc. (IHO)

Orange County Community Housing Corporation (OCCHC) Cordially invite you to a community information meeting for:

Golden Circle

160 units of affordable housing to be developed at 601 N. Golden Circle Drive and 2021 E. 4th Street, Santa Ana, CA 92705

At this meeting we will provide project information, solicit community input, and answer questions. Please virtually attend and share your thoughts and ideas.

**In effort to protect public health and prevent the spread of COVID-19 (Coronavirus), this meeting will take place virtually via Zoom.

Meeting Date and Time:

Tuesday, May 4, 2021 at 5:00PM

Online:

Location: <https://zoom.us/j/98793324002>

Meeting ID: 987 9332 4002

OR

Conference Call:

Phone #: (669) 900-6833

Meeting ID: 987 9332 4002

For more information, please visit our website at www.innovativehousing.com or send an email to: goldencirclecommunitymeeting@innovativehousing.com

If you have any questions regarding this event or if you require language interpretation services, please contact IHO at (949) 863-9740

Innovative Housing Opportunities, Inc. (IHO)

Orange County Community Housing Corporation (OCCHC) los invita a una junta comunitaria para:

Golden Circle

Una proyecto de 160-unidad para personas de ingresos bajos para ser construido en 601 N. Golden Circle Drive y 2021 E. 4th Street, Santa Ana, CA 92705

En esta reunión, proporcionaremos información sobre el proyecto, solicitaremos la opinión de la comunidad y responderemos preguntas. Asista virtualmente y comparte sus pensamientos e ideas.

** En un esfuerzo por proteger la salud pública y prevenir la propagación del COVID-19 (Coronavirus), esta reunión se llevará a cabo virtualmente a través de Zoom.

Fecha y Hora de la Reunión:

Martes, 4 de Mayo de 2021 a las 5:00 PM

En Línea:

Locación: <https://zoom.us/j/98793324002>

ID de Reunión: 987 9332 4002

O

En el Teléfono:

Número de teléfono: (669) 900-6833

ID de Reunión: 987 9332 4002

Para obtener más información, visite nuestro sitio web en www.innovativehousing.com o envíenos un correo electrónico a: goldencirclecommunitymeeting@innovativehousing.com

Si tiene preguntas sobre el evento o requiere traducción en otros lenguajes, por favor contacte IHO en (949) 863-9740

Publish: Orange County Register April 22, 2021

Attachment

7. Affidavit of Publication

The Orange County Register

1771 S. Lewis Street
Anaheim, CA 92805
714-796-2209

5274846

INNOVATIVE HOUSING OPPORTUNITIES, INC.
501 GOLDEN CIRCLE SUITE 100
ATTN: MIGUEL GARCIA
SANTA ANA, CA 92705

AFFIDAVIT OF PUBLICATION

STATE OF CALIFORNIA, }
County of Orange } SS.

I am a citizen of the United States and a resident of the County aforesaid; I am over the age of eighteen years, and not a party to or interested in the above entitled matter. I am the principal clerk of The Orange County Register, a newspaper of general circulation, published in the city of Santa Ana, County of Orange, and which newspaper has been adjudged to be a newspaper of general circulation by the Superior Court of the County of Orange, State of California, under the date of November 19, 1905, Case No. A-21046, that the notice, of which the annexed is a true printed copy, has been published in each regular and entire issue of said newspaper and not in any supplement thereof on the following dates, to wit:

04/22/2021

I certify (or declare) under the penalty of perjury under the laws of the State of California that the foregoing is true and correct:

Executed at Anaheim, Orange County, California, on Date: April 22, 2021.



Signature

PROOF OF PUBLICATION

Legal No. 0011457042

Innovative Housing Opportunities, Inc. (IHO)

Orange County Community Housing Corporation (OCCHC) Cordially invite you to a community information meeting for:

Golden Circle

160 units of affordable housing to be developed at 601 N. Golden Circle Drive and 2021 E. 4th Street, Santa Ana, CA 92705

At this meeting we will provide project information, solicit community input, and answer questions. Please virtually attend and share your thoughts and ideas.

**In effort to protect public health and prevent the spread of COVID-19 (Coronavirus), this meeting will take place virtually via Zoom.

Meeting Date and Time:

Tuesday, May 4, 2021 at 5:00PM

Online:

Location: <https://zoom.us/j/98793324002>

Meeting ID: 987 9332 4002

OR

Conference Call:

Phone #: (669) 900-6833

Meeting ID: 987 9332 4002

For more information, please visit our website at www.innovativehousing.com or send an email to: goldencirclecommunitymeeting@innovativehousing.com

If you have any questions regarding this event or if you require language interpretation services, please contact IHO at (949) 863-9740

Innovative Housing Opportunities, Inc. (IHO)

Orange County Community Housing Corporation (OCCHC) los invita a una junta comunitaria para:

Golden Circle

Una proyecto de 160-unidad para personas de ingresos bajos para ser construido en 601 N. Golden Circle Drive y 2021 E. 4th Street, Santa Ana, CA 92705

En esta reunión, proporcionaremos información sobre el proyecto, solicitaremos la opinión de la comunidad y responderemos preguntas. Asista virtualmente y comparte sus pensamientos e ideas.

** En un esfuerzo por proteger la salud pública y prevenir la propagación del COVID-19 (Coronavirus), esta reunión se llevará a cabo virtualmente a través de Zoom.

Fecha y Hora de la Reunión:

Martes, 4 de Mayo de 2021 a las 5:00 PM

En Línea:

Locación: <https://zoom.us/j/98793324002>

ID de Reunión: 987 9332 4002

O

En el Teléfono:

Número de teléfono: (669) 900-6833

ID de Reunión: 987 9332 4002

Para obtener más información, visite nuestro sitio web en www.innovativehousing.com o envíenos un correo electrónico a: goldencirclecommunitymeeting@innovativehousing.com

Si tiene preguntas sobre el evento o requiere traducción en otros idiomas, por favor contacte IHO en (949) 863-9740

Publish: Orange County Register April 22, 2021

Attachment

8. Community Outreach Meeting Presentation



studioneleven

Golden Circle

Mixed-Use Development

Santa Ana, CA

May 4, 2021

Tonight's Agenda

- 5:00 pm – Welcome
- 5:15 pm – Project Presentation
- 5:30 pm – Community Input
- 6:00 pm – Meeting Adjourned

Meet the Team



Nora Mendez
Executive Director
OCCHC



Rochelle Mills
President & CEO
IHO



Miguel Garcia
Director of Real Estate
Development
IHO



Antonio Ramon
Project Manager
IHO



Xochitl Medrano
Assistant Project Manager
IHO



Justin Roth
Project Manager
Studio One Eleven



Terri Dickerhoff
Principal
CGR Development

About Innovative Housing Opportunities (IHO)

- IHO is a Santa Ana-based nonprofit developer serving low to moderate-income individuals and families for 45 years. We enrich communities by advocating for and developing high-quality, affordable housing.
- “***It Starts with Housing***” reflects IHO’s core belief that high-quality affordable housing is the foundation of healthy, catalytic, and economically vibrant communities where residents can dream of and reach for new possibilities

Our Development Goals

- Develop vibrant, comprehensive, catalytic ***communities***
- Develop resilient, self-reliant residents through transformative services and programs
- Develop economic empowerment opportunities

Our Work



About Orange County Community Housing Corporation (OCCHC) – Project Partner

- OCCHC is a Santa-Ana based non-profit organization whose mission is to transition extremely low-income families to greater self-sufficiency by assisting with housing and education
- OCCHC's signature program, SteppingUP, builds upon the continuum of care for families by providing a stable environment conducive to learning and self-improvement



OCCHC's Work



For over 40 years, OCCHC has:

- Created over 300 affordable housing units throughout Orange County for families in need;
- Educated thousands of at-risk youth and their parents on not just getting to, through college earning a degree that will lead to higher paying jobs and economic self-sufficiency through their *SteppingUP* program;
- Provided financial education and a plan for families that will lead to economic independence and one day homeownership.

Studio One Eleven



The Vision

Existing



Proposed Development

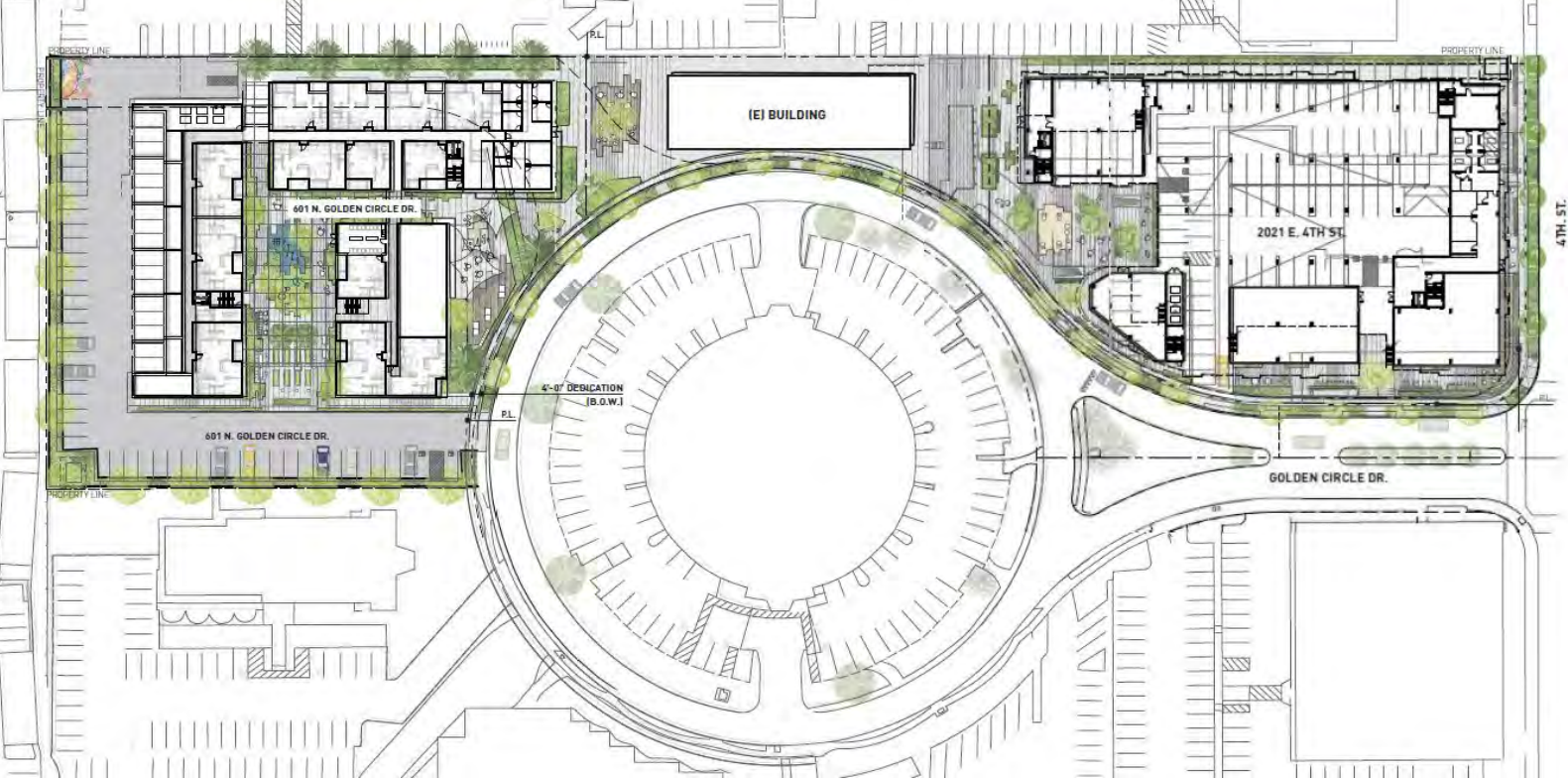

Golden Circle Development



601 N. Golden Circle Drive and 2021 E. 4th Street

Projected Timeline:

- Construction Start: February 2023
- Construction Completion: February 2025



Residential Units:

- 40 1 Bedroom | 1 Bath
- 56 2 Bedroom | 1 Bath
- 47 3 Bedroom | 2 Bath
- 15 4 Bedroom | 2 Bath
- 2 Managers' Units

160 Units Total

Golden Circle Development



2021 E. 4th Street

Commercial Space:

- Retail -
4,612 & 539 Square Feet
- Office -
6,602 & 3,406 Square Feet

Resident and Supportive Services

- Responsive and tailored services to the whole person
- Integrated and coordinated programs that foster healthy aging, personal and economic resiliency
- Centered on strategic partnerships and community connection
- Educational, health/wellness, and skill-building classes
- Afterschool Programs

Contacts

Nora Mendez, CEO

Orange County Community Housing Corporation

nora@occhc.org

Miguel Garcia, Director of Real Estate Development

Innovative Housing Opportunities

mgarcia@innovativehousing.com

Antonio Ramon, Project Manager

Innovative Housing Opportunities

aramon@innovativehousing.com

Attachment

9. Screenshot of Meeting Attendees

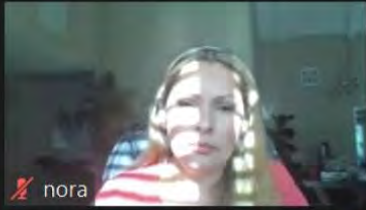

nora



Xochitl Medrano, IHO



Justin Roth



Dcato



Dave Levy - Fair Housing



Angelica



Emilie Dang



Antonio Ramon



Miguel Garcia, IHO



iPhone



Oscar Rodriguez



Jasmine Lowe

Malinda

Brenda Magana...

Becky Firey



Michele Rinehart



Rochelle Mills



Jerry Guevara

Terri's iPad



12134221450



17145888402

Attachment

10. Meeting Minutes & Public Comment

601 N. Golden Circle & 2021 E. 4th Street
Santa Ana, CA 92701
Sunshine Ordinance – Community Meeting
Meeting Minutes

In compliance with the Sunshine Ordinance, a community meeting was held virtually on May 4, 2021 at 5:00 pm.

Representatives from the Developer were as follows:

- Miguel Garcia – Innovative Housing Opportunities, Inc. (IHO)
- Antonio Ramon – Innovative Housing Opportunities, Inc. (IHO)
- Xochitl Medrano – Innovative Housing Opportunities, Inc. (IHO)
- Nora Mendez – Orange County Community Housing Corporation (OCCHC)

Representative from the Architect were as follows:

- Justin Roth – Studio One Eleven

Representative from Entitlements Consultant:

- Terri Dickerhoff – CGR Development

Representatives from the City of Santa Ana:

- Jerry Guevara (assigned Case Planner)

Representatives of the Community

- Becky Firey
- David Levy
- Denise Cato
- Brenda Magana
- Angelica
- Malinda
- Matthew

The seven members of the community attended the virtual meeting, and some identified themselves as current tenants at the 2021 E. 4th Street property. IHO and OCCHC waited additional members of the community to arrive before giving their presentation. An overview of the project, as well as the plans of the project were presented to the attendees.

Questions & Comments from Becky Firey:

- What is the plan for parking?
- Will there be a wall around the northern property?
- She would like a copy of the presentation.

Questions & Comments from David Levy:

- When will construction begin?
- When will we have to move out of the 2021 E. 4th Street property?

- Will the 501 Golden Circle building be demolished?
- He would like to see if there is an opportunity for current tenants to move into office space.
- The spaces facing 4th Street should consider sound mitigation as the traffic is very noisy.

Questions & Comments from Denise Cato:

- How many offices will there be in the project?
- She would like to see more office spaces in the proposed project.

Comments from Brenda Magana:

- She wants retail space for Fair Housing Services.

Questions from Angelica:

- Can a single person live in the new residential units?
- What is the income threshold for a single person?

No additional members of the community attended the event. IHO and OCCHC stayed on the virtual meeting until 6:00 pm.