

BEAR FLAG ENGINEERING INC.

CIVIL ENGINEERING
LAND DEVELOPMENT
SEPTIC SYSTEM DESIGN
PROJECT MANAGEMENT
SURVEYING
FORENSIC ENGINEERING

322 BROADWAY #302
SONOMA, CA 94966
PHONE: 707/792-8888
OFFICE@BEARFLAGENGINEERING.COM

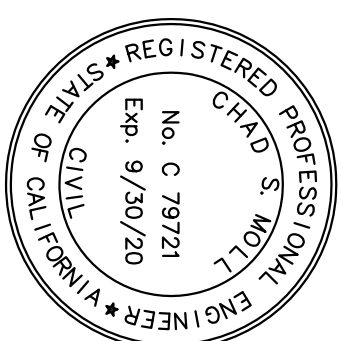

CHAD S. KROLL
REGISTERED PROFESSIONAL ENGINEER
No. C 79721
Exp. 9/20/20
STATE OF CALIFORNIA

NEIGHBORHOOD FRONTAGE EXHIBIT LIAM LANE PLACE MINOR SUBDIVISION 249 FIRST STREET WEST, SONOMA, CA 95476 APN: 018-121-019

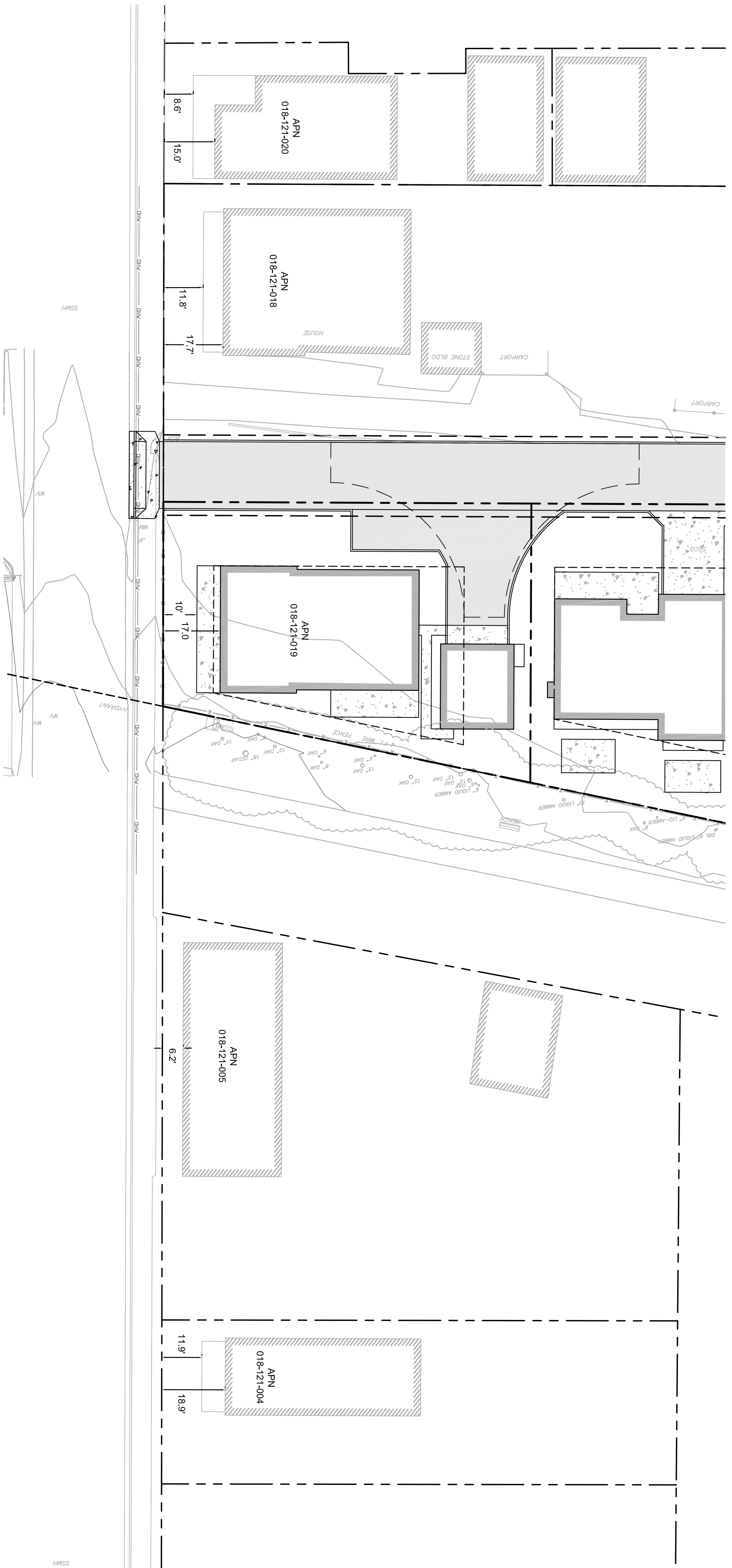

SEWER NOTE:

FRONT SETBACKS FOR NEW INFILL DEVELOPMENT SHOULD FOLLOW EITHER OF THE FOLLOWING CRITERIA:

- I. EQUAL TO THE AVERAGE FRONT SETBACK OF ALL RESIDENTIAL ADJOINING STRUCTURES OF THE PROPERTY LINES OF THE NEW PROJECT OR
- II. EQUAL TO THE AVERAGE FRONT SETBACK OF THE TWO IMMEDIATELY ADJOINING STRUCTURES ON EACH SIDE OF THE NEW PROJECT.

AVERAGE FRONT SETBACK TO BUILDING = $(15.0 + 17.7 + 6.2 + 18.9 \text{ FT}) / 4 = 14.5 \text{ FT}$

PROPOSED PROJECT FRONT SETBACK = 17.0 FT

PROPOSED FRONT SETBACK EXCEEDS REQUIREMENT BASED ON AVERAGE OF TWO IMMEDIATELY ADJOINING STRUCTURES ON EACH SIDE

NEIGHBORHOOD FRONTAGE EXHIBIT

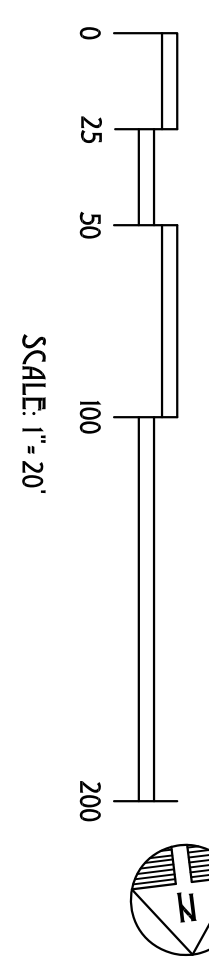

REV	DATE	DESCRIPTION

DATE: 12/3/2018
DESIGN: GSM
PROJECT: 16075
SHEET
1
OF 1 SHEET