



MacARTHUR
PLACE
SONOMA



USE PERMIT DRAWINGS
REMODEL & EXPANSION OF EXISTING SPA & POOL

The SPA
at MacARTHUR

RossDrulisCusenbery ARCHITECTURE

SITE LOCATION



EXISTING SITE PLAN



EXISTING SITE PLAN

Sonoma Valley Unified
School District
APN 018-421-092

BUILDING LEGEND

- | | | |
|------------------------|---------------|-------------------------------|
| A Guest House | H Guest House | O Guest House |
| B Guest House | I Guest House | P Barn / Meeting / Restaurant |
| C Carriage House | J Guest House | Q Coach House |
| D Guest House | K Guest House | R Guest House |
| E Maintenance Building | L SPA | S Chef's Cottage |
| F Guest House | M Guest House | T Guest House |
| G Guest House | N Guest House | |

PARKING COUNT

West Lot	89
Auto Court	11
East Lot	31
Total	131 Spaces



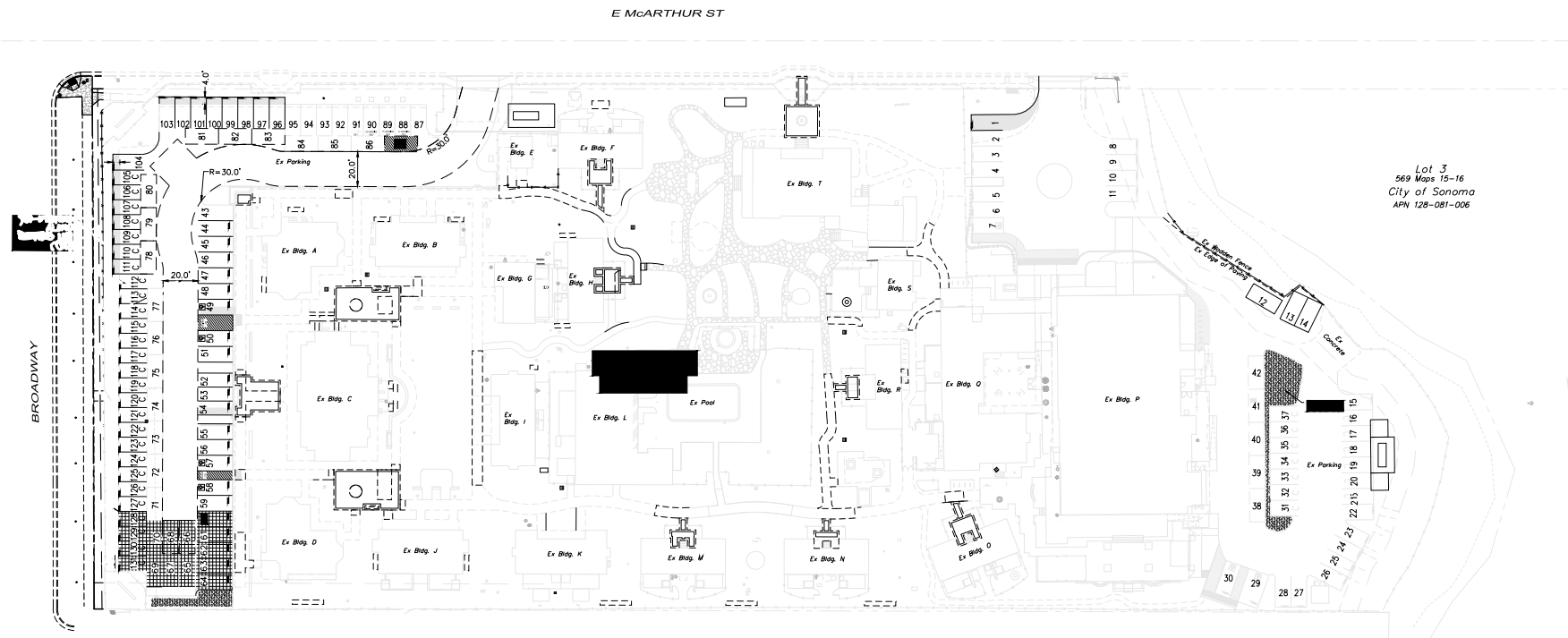

EXISTING SITE CONDITIONS



Lot 3
569 Maps 15-16
City of Sonoma
APN 128-081-006

Sonoma Valley Unified
School District
APN 018-421-002

HATCHING LEGEND:
 AC OVER
 CL II AB
 PARKING STALLS TO
 BE PAINTED YELLOW

PARKING LOT STATISTICS	
STANDARD	53
COMPACT	40
VALET	27
ADA	6
VAN ADA	1
STANDARD CHARGING STATION	4
TOTAL	131