

Round Rock Learning Community High School

Student Item Pick / Drop-off Plan

Expectations

- We LOVE our Dragons and truly want to see every one of you. However, to ensure we can accommodate item pick-up and drop-off in a timely manner, only students who need to pick up essential items will be allowed in the buildings. We ask that you wait until school resumes in August to collect any non-essential items.
- When students enter the building, they will need to have a face covering (not provided).
- As students enter the building, they will need to use hand sanitizer (provided).
- **Only students may enter the building** (parents please stay in your car). Teachers and staff will be in the building to assist students with whatever they need and to monitor the number of students in any area. In addition, we will ensure that all students maintain a safe distance from each other while in the building. The students will not be able to have contact with the staff (no hugs or high 5's at this time). All staff will have face coverings and gloves on at all times.
- Please do not arrive before 9 am. This is a come-and-go event so that we can stagger the number of students in the building.
- As students leave a building, they will be required to use hand sanitizer.
- We are excited about getting a chance to see you, but we need everyone to leave the property as you finish.

Schedule for Drop Off and Pickup of personal items

<i>Group/Subject</i>	<i>Location</i>	<i>Parking</i>	<i>Additional Instructions</i>
<i>Tuesday, May 19th (9:00 to 12:00)</i>			
Fine Arts - Drop-off	(Please refer to the plan for specific group directions.)	No parking needed for Fine Arts Items as all items will be dropped off while you are in your car	
<i>Wednesday, May 20th (9:00 to 12:00) (PE will be from 12:00 to 2:00) (SEE MAPS BELOW)</i>			

<p>Seniors and Students not returning to RRHS- Drop-off of Textbooks, Device/chargers, library books, fundraiser money, and any money owed.</p>	<p>Report to the main entrance of the 1200 building</p>	<p>In front of the 1200 building</p>	<p>If you still need your device and/or textbook to help you prepare for an AP test, you may keep them. We will have another collection day.</p>
<p>Athletic Drop-off (All Grades & all sports)</p>	<p>Report to the Fieldhouse gym</p>	<p>No parking needed for Athletic equipment drop off at the Fieldhouse as all items will be dropped off while you are in your car.</p>	<p>Athletic Equipment/Uniforms - Items need to be placed in a sealed bag and labeled with Uniform Type, Student Name, ID number, and Class period. All these items need to be dropped off at the Fieldhouse gym. Stay in your car. A RRHS staff member will collect the items from you.</p>
<p>Athletics/PE Pick-up - See the list of locations to report to below.</p> <ul style="list-style-type: none"> ● <i>Athletics - Last Names A-M</i> 9:00 to 10:30 ● <i>Athletics - Last Names N-Z</i> 10:30 to 12:00 ● <i>All PE students</i> 12:00 to 2:00 	<p>400 Fieldhouse Gym</p> <ul style="list-style-type: none"> ● Football ● Soccer ● Track ● Xcountry ● Trainers <p>1100 gym</p> <ul style="list-style-type: none"> ● Basketball ● Volleyball ● Swim ● Tennis ● Golf 	<p>Parking lot A</p> <ul style="list-style-type: none"> ● Varsity and JV Football, Soccer, Track, Xcountry for items needing to be picked up <p>Visitor Parking</p> <ul style="list-style-type: none"> ● Freshman Football <p>Parking lot C and D</p> <ul style="list-style-type: none"> ● Basketball, Volleyball, Tennis, Golf, and Swim for items needing to be picked up 	

	<ul style="list-style-type: none"> • PE (from 12:00 to 2:00) <p>Baseball portable</p> <ul style="list-style-type: none"> • Baseball <p>Softball shed</p> <ul style="list-style-type: none"> • Softball <p>100 hallway near 300 bldg</p> <ul style="list-style-type: none"> • Wrestling 	<p>Parking along the street near baseball portable</p> <ul style="list-style-type: none"> • Baseball <p>Parking lot B</p> <ul style="list-style-type: none"> • Softball <p>100 parking lot (old front of the school)</p> <ul style="list-style-type: none"> • Wrestling for items needing to be picked up 	
Thursday, May 21st (9:00 to 12:00)			
ROTC - Drop-off and Pick-up	Report to the 1000 bldg	Parking lot C	
AUTO - Drop-off and Pick-up	Report to the 1000 bldg	AUTO Garage	

Fine-Arts Drop-off (May 19)



Senior item Drop-off (May 20)



Athletic Drop-off (All Sports - May 20)

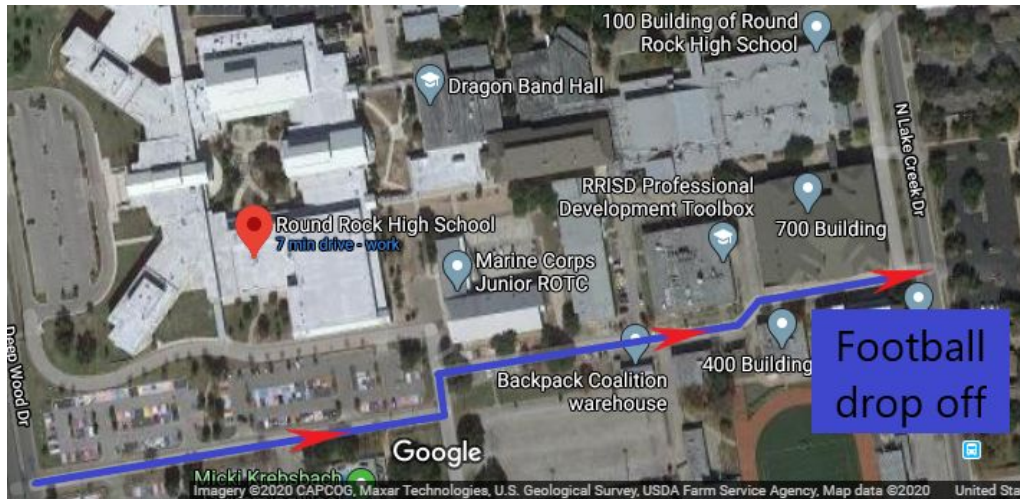

Basketball, Volleyball, Swim, Tennis, & Golf Drop-off & Pick-up 9:00-12:00 - May 20
PE will follow this same follow from 12:00 to 2:00 on May 20

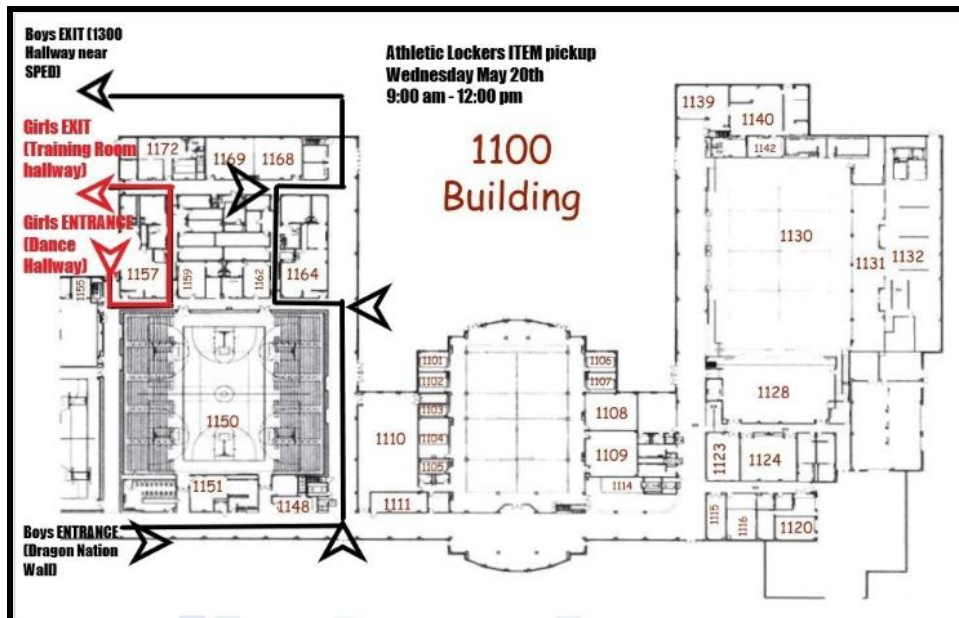

ROTC item Pick-up & Drop-off (May 21)



Auto Shop item Pick-up & Drop-off (May 21)

